

Frederick County

By Virtue of a Warrant granted out of the Lord Proprietary's Land Office unto Feleber Gant of said County to Recover the following Tracts or parcels of Land lying and being in the County aforesaid and contiguous to each other Viz^t The Forrest of Newwood Originally on the 1st Day of March Anno 1744 granted unto John Hawkins for three Hundred Acres. Hawkins Plains Originally on the 31st Day of October Anno 1752 granted unto John Hawkins for three Hundred and Seventy Acres. fifty three Acres part of Sweden March Originally on the 10th Day of August Anno 1753 granted unto the aforesaid Feleber Gant for three Hundred Acres and ninety seven Acres part of Fildoria Manor Originally on the 15th Day of January Anno 1772 granted unto the said Feleber Gant for ten Thousand four Hundred and Seventy seven Acres one Quarter of an Acre all undivided to correct and amend all Errors of the Original Surveys and to add any vacant Land thence contiguous bearing Date the 2nd Day of April 1774 which said Warrant being assigned unto the Rev^d Bartholomew Booth and renewed in his name the 9th Day of September 1774 I Confirmed Deputy Surveyor of the County aforesaid under the best Smith Esq^r Surveyor General of the Western Shore of Maryland. That I have carefully Reviewed for and in the name of Him the aforesaid Bartholomew Booth the several Tracts or parcels of Land aforesaid according to their antient Maps and Bounds and find that they contain in the whole eight Hundred and seventy eight Acres and one half Acre being thirty Acres and a half Acre more than they were granted and conveyed for That I have added two pieces of Vacancy containing sixty six Acres and a half Acre and reduced the whole into one entire Tract. Beginning for the out line thereof at the end of the tenth line of a Tract of Land called The Recovery on Uncle's Gift and running thence South forty nine Degrees West six 1/2 South fifty seven Degrees West fifty six 1/2 South sixty seven Degrees

West forty four 1/2 North twenty nine Degrees West thirty four 1/2 South sixty two Degrees West twenty eight 1/2 South twenty two Degrees West twenty eight 1/2 South fifty seven Degrees East twenty eight 1/2 South thirty one Degrees East Eighteen 1/2 South twenty two Degrees West thirty 1/2 South fifty four Degrees West Eighty nine 1/2 South twenty Degrees West one Hundred 1/2 North seventy six Degrees one half Degree West forty four 1/2 South six Degrees East forty eight 1/2 and one half 1/2 to two Boundaries White Oaks the beginning Tree of part of Fildoria Manor one of the Original Tracts then South Eighty one Degree and one half Degree East five Hundred and fifty 1/2 to two Marked Stones standing at the end of the first line of part of Fildoria Manor one of the Original Tracts then North three Quarters of a Degree East two Hundred and fifty one 1/2 North twenty four Degrees West thirty six 1/2 to the end of thirty four 1/2 on the first line of a Tract of Land called Alexandria it being the end of the third line of said part of Fildoria Manor one of the Original Tracts then South twenty two Degrees West twenty six 1/2 North sixty five Degrees West fifty six 1/2 to the third line of Hawkins Plains one of the Original Tracts then with the said Land North twelve Degrees East one Hundred and twenty one 1/2 to the end of the said line still with the said Land North forty four Degrees West Eighty 1/2 South fifty two Degrees West twenty eight 1/2 then with a straight line to the beginning containing nine Hundred forty five Acres to a field of Manocoy Manor by the name of The Forrest of Newwood Recovered the 10th Day of March 1775

John Hanson Jun^r

- A the beginning of Hawkins Plains granted for 300 Acres
- B Ditto of The Forrest of Newwood 300
- C Ditto of part of Sweden March 53
- D Ditto of part of Fildoria Manor 97
- These Tracts contain in the whole 1078 1/2 Acres
- a^o Vacancy added 57 1/2
- b^o Ditto 8 1/2
- E the beginning of the whole 945 Acres

Confined as follows Viz^t
 10 to 12 with the Recovery on Uncle's Gift
 10 to 12 with Uncle's Tract 12 with Fildoria Manor
 13 with Lost Pen and Ink 14 with the Recovery on Maryland part of 15 with Sweden March
 the other part with Fildoria Manor 16 with Fildoria Manor
 17 and part of 18 with Alexandria the other part of 19 with Fildoria 20 to the Green line with Manocoy but when well looked to the Green line with The Recovery on Uncle's Gift

Improvements Viz^t
 about 1 Acre of Cleared Land about 20 Rail Runs

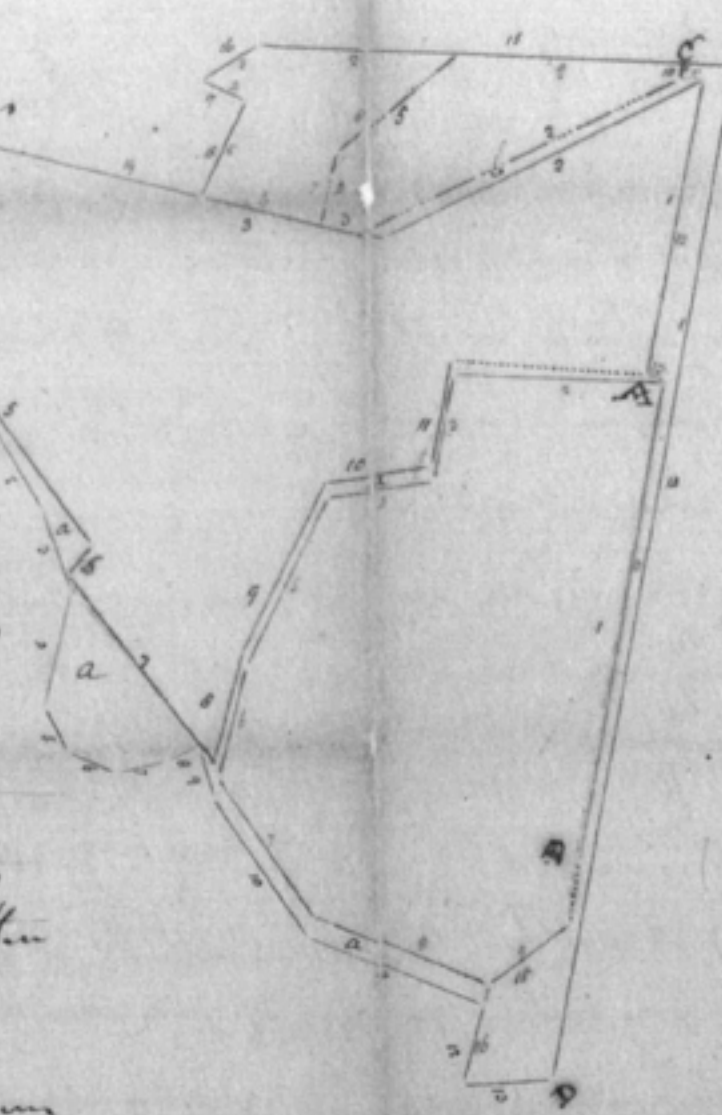

The Courses of Manocoy Plains A.		The Courses of the whole B.		The Courses of part of Sweden March C.	
1	S. 81. E. 160	1	S. 49. W. 60	1	N. 81. W. 8
2	N. 23. W. 190	2	S. 37. W. 56	2	N. 28. W. 190
3	N. 12. E. 220	3	S. 67. W. 44	3	N. 12. E. 20
4	N. 44. W. 80	4	N. 79. W. 64	4	S. 79. E. 40
5	S. 52. W. 200	5	S. 62. W. 28	5	S. 41. E. 80
6	N. 54. W. 20	6	S. 22. W. 28	6	then to the beg ^g
7	S. 80. W. 127	7	S. 15. E. 28		
8	S. 77. E. 62	8	S. 31. E. 18		
9	S. 66. E. 100	9	S. 72. W. 30		
10	S. 9. E. 55	10	S. 54. W. 80		
11	S. 81. E. 58	11	S. 20. W. 100		
12	then to the beg ^g	12	N. 76. W. 44		
		13	S. 6. E. 48		
		14	S. 81. E. 530		
		15	N. 74. E. 251		
		16	N. 34. W. 36		
		17	S. 22. W. 26		
		18	N. 63. W. 56		
		19	S. 12. W. 66		
		20	S. 79. E. 40		
		21	S. 41. E. 80		
		22	S. 74. W. 120		
		23	N. 81. W. 8		
		24	S. 52. W. 28		
		25	South 12		
		26	N. 81. W. 160		
		27	S. 14. W. 15		
		28	N. 81. W. 207		
		29	N. 40. W. 52		
		30	N. 76. W. 55		
			then to the beg ^g		