

INVENTORY FORM FOR STATE HISTORIC SITES SURVEY

1 NAME

HISTORIC Mendelsohn Terrace

AND/OR COMMON

2 LOCATION

STREET & NUMBER Route 122 and Gladhill Roads

CITY, TOWN Browningsville VICINITY OF CONGRESSIONAL DISTRICT 6

STATE Maryland COUNTY Montgomery

3 CLASSIFICATION

CATEGORY	OWNERSHIP	STATUS	PRESENT USE
<input type="checkbox"/> DISTRICT	<input type="checkbox"/> PUBLIC	<input checked="" type="checkbox"/> OCCUPIED	<input checked="" type="checkbox"/> AGRICULTURE <input type="checkbox"/> MUSEUM
<input checked="" type="checkbox"/> BUILDING(S)	<input checked="" type="checkbox"/> PRIVATE	<input type="checkbox"/> UNOCCUPIED	<input type="checkbox"/> COMMERCIAL <input type="checkbox"/> PARK
<input type="checkbox"/> STRUCTURE	<input type="checkbox"/> BOTH	<input type="checkbox"/> WORK IN PROGRESS	<input type="checkbox"/> EDUCATIONAL <input checked="" type="checkbox"/> PRIVATE RESIDENCE
<input type="checkbox"/> SITE	PUBLIC ACQUISITION	ACCESSIBLE	<input type="checkbox"/> ENTERTAINMENT <input type="checkbox"/> RELIGIOUS
<input type="checkbox"/> OBJECT	<input type="checkbox"/> IN PROCESS	<input type="checkbox"/> YES: RESTRICTED	<input type="checkbox"/> GOVERNMENT <input type="checkbox"/> SCIENTIFIC
	<input type="checkbox"/> BEING CONSIDERED	<input type="checkbox"/> YES: UNRESTRICTED	<input type="checkbox"/> INDUSTRIAL <input type="checkbox"/> TRANSPORTATION
		<input checked="" type="checkbox"/> NO	<input type="checkbox"/> MILITARY <input type="checkbox"/> OTHER

4 OWNER OF PROPERTY

NAME Stewart E. & Eunice E. Walker Telephone #: 253-2725

STREET & NUMBER

CITY, TOWN Browningsville VICINITY OF STATE Maryland zip code

5 LOCATION OF LEGAL DESCRIPTION

COURTHOUSE, REGISTRY OF DEEDS, ETC. Montgomery County Courthouse

Liber #: 1640
Folio #: 195

STREET & NUMBER

CITY, TOWN Rockville STATE Maryland

6 REPRESENTATION IN EXISTING SURVEYS

TITLE M-NCPPC Inventory of Historical Sites

DATE 1976 FEDERAL STATE COUNTY LOCAL

DEPOSITORY FOR SURVEY RECORDS Park Historian's Office

CITY, TOWN Rockville STATE Maryland 20855

7 DESCRIPTION

M:10-12

CONDITION		CHECK ONE	CHECK ONE
<input checked="" type="checkbox"/> EXCELLENT	<input type="checkbox"/> DETERIORATED	<input checked="" type="checkbox"/> UNALTERED	<input checked="" type="checkbox"/> ORIGINAL SITE
<input type="checkbox"/> GOOD	<input type="checkbox"/> RUINS	<input type="checkbox"/> ALTERED	<input type="checkbox"/> MOVED DATE _____
<input type="checkbox"/> FAIR	<input type="checkbox"/> UNEXPOSED		

DESCRIBE THE PRESENT AND ORIGINAL (IF KNOWN) PHYSICAL APPEARANCE

This lovely Gothic Revival style farmhouse sits on a hill facing south.

Built on fieldstone foundations, this two and a half story, three bay by five bay, L-shape frame house has been expanded to serve the six generations of Walkers who built the house and have lived here continuously. The house used to have novelty siding, but this was recently replaced by aluminum siding. The south (front) porch has a flat roof with a turned balustrade railing at the roof line and supported by four wooden columns. The porch area is enclosed by a railing with turned balusters similar to that on the porch roof. This porch is smaller than the original. The south door has two round-headed lights over two lower wooden panels. The doorway is surmounted by a transom light.

One over one and two over two double hung windows are flanked by black aluminum louvered shutters. On the west elevation there is a one story bay window. The house has an unusual cross gable roof, there are three cross gables on the south elevation. Two light Gothic windows are set into these cross gables, these gables also have decorative scalloped bargeboards. The north and east gable ends have two small windows: one is a four light casement window and one is a louvered ventilator window. The roof has corrugated metal covering. There is one interior end chimney on the east elevation.

The south door leads into a central hallway. An open string single run staircase ascends from south to north along the west interior wall. The stairway has a round newel post, a carved banister and turned balusters. To the east is a parlor and to the west is the music room. North of the hall is an enclosed porch with a modern bay window set into the west interior wall opening onto the dining room. The kitchen is north of the dining room and porch. A sun room is located west of the dining room.

There are random width floors. The floor in the parlor was replaced when termites destroyed the original flooring. There are ten foot ceilings in the south section of the house. The walls and ceilings are plaster over lath. The molded door frames accepted the wooden paneled doors. There are plaster ceiling medallions in the parlor and music room, the dining room medallion was removed sometime ago. The house when it was first built had a bathroom complete with a wooden copper-lined tub. In addition, closets were built into the house.

A clapboarded, gabled meat house is located northeast of the house. The dinner bell hangs at the peak of the gable; its ring can be heard all over the farm.

CONTINUE ON SEPARATE SHEET IF NECESSARY

8 SIGNIFICANCE

PERIOD		AREAS OF SIGNIFICANCE -- CHECK AND JUSTIFY BELOW				
<input type="checkbox"/> PREHISTORIC	<input type="checkbox"/> ARCHEOLOGY-PREHISTORIC	<input type="checkbox"/> COMMUNITY PLANNING	<input type="checkbox"/> LANDSCAPE ARCHITECTURE	<input type="checkbox"/> RELIGION		
<input type="checkbox"/> 1400-1499	<input type="checkbox"/> ARCHEOLOGY-HISTORIC	<input type="checkbox"/> CONSERVATION	<input type="checkbox"/> LAW	<input type="checkbox"/> SCIENCE		
<input type="checkbox"/> 1500-1599	<input type="checkbox"/> AGRICULTURE	<input type="checkbox"/> ECONOMICS	<input type="checkbox"/> LITERATURE	<input type="checkbox"/> SCULPTURE		
<input type="checkbox"/> 1600-1699	<input type="checkbox"/> ARCHITECTURE	<input type="checkbox"/> EDUCATION	<input type="checkbox"/> MILITARY	<input type="checkbox"/> SOCIAL/HUMANITARIAN		
<input type="checkbox"/> 1700-1799	<input type="checkbox"/> ART	<input type="checkbox"/> ENGINEERING	<input checked="" type="checkbox"/> MUSIC	<input type="checkbox"/> THEATER		
<input checked="" type="checkbox"/> 1800-1899	<input type="checkbox"/> COMMERCE	<input type="checkbox"/> EXPLORATION/SETTLEMENT	<input type="checkbox"/> PHILOSOPHY	<input type="checkbox"/> TRANSPORTATION		
<input type="checkbox"/> 1900-	<input type="checkbox"/> COMMUNICATIONS	<input type="checkbox"/> INDUSTRY	<input type="checkbox"/> POLITICS/GOVERNMENT	<input type="checkbox"/> OTHER (SPECIFY)		
		<input type="checkbox"/> INVENTION				

SPECIFIC DATES 1880

BUILDER/ARCHITECT John Mount

STATEMENT OF SIGNIFICANCE

"Mendelsohn Terrace" is significant for having been the "musical and literary center of the community where Professor George Washington Wesley Walker's choirs and schools gathered for musical and social occasions" during the late nineteenth century in upper Montgomery County. He led singing, directed the choir, played the organ in the Bethesda Church near his home for 56 years. Professor Walker had everyone in the upper part of the county singing.¹ The house is currently owned and occupied by one of G. W. Walker's grandchildren.

In April, 1830, George Brian Walker was deeded some land called "Henry & Elizabeth Enlarged" from Peter Boyer. One hundred and forty-four acres of this land descended first to his son, Nathan James Walker, to hold for his younger son, George Washington Wesley Walker. In his will of May 16, 1857, George Brian Walker left the farm to George W. Walker.² The deed, however, did not transfer to George W. Walker until Dec. 20, 1875. He had to buy out his brothers' and sisters' interest in the estate for \$2,400 before he obtained ownership.

George Washington Wesley Walker, the Professor of Music, was responsible for the building of "Mendelsohn Terrace". He was born in a log cabin on the farm in Oct. 1837. Only the stone chimney of that original family cabin remains on the farm. George Walker married Rachel Browning Purdum in 1858, and they had eight children. In the census records of 1870 & 1880, he is listed as a farmer. In his early years, however, he showed a marked interest in music, and learned avidly from local teachers. He received more formal training and recognition when in the summer of 1870 he attended the "Normal Institute" in Florida, New York. There he studied under music master, Lowell Mason,³ and, also, established several close professional friendships that continued throughout the rest of his life. For over forty years the original picture of his class at the "Normal Institute" hung in the music room at Mendelsohn Terrace.⁴

According to assessment records, George W. W. Walker's farm consisted of 144 acres. Between the 1873 and 1882 assessments, the price per acre decreased, and although the value of the land property was declared the same, \$2460, the 1882 assessment shows that \$1020 of that went for improvements,⁵ perhaps for construction of the grand new farm house. A date marker on the house indicates construction was in 1880. John Mount, a local builder, was builder of both "Mendelsohn Terrace" and the Bethesda Church up the road, which the Walker family started. Seventh and eighth generation Walkers continue to farm the land and occupy the lovely "Mendelsohn Terrace".

FOOTNOTES: (See Attachment Sheet A)

CONTINUE ON SEPARATE SHEET IF NECESSARY

9 MAJOR BIBLIOGRAPHICAL REFERENCES

See Attachment Sheet A

CONTINUE ON SEPARATE SHEET IF NECESSARY

10 GEOGRAPHICAL DATA

ACREAGE OF NOMINATED PROPERTY 150.582 acres

VERBAL BOUNDARY DESCRIPTION

LIST ALL STATES AND COUNTIES FOR PROPERTIES OVERLAPPING STATE OR COUNTY BOUNDARIES

STATE	COUNTY

11 FORM PREPARED BY

Candy Reed - Architectural Description

NAME / TITLE

Carole U. Marks

ORGANIZATION

Sugarloaf Regional Trails

DATE

11/28/78

STREET & NUMBER

Box 87

TELEPHONE

926-4510

CITY OR TOWN

Dickerson

STATE

Maryland 20753

The Maryland Historic Sites Inventory was officially created by an Act of the Maryland Legislature, to be found in the Annotated Code of Maryland, Article 41, Section 181 KA, 1974 Supplement.

The Survey and Inventory are being prepared for information and record purposes only and do not constitute any infringement of individual property rights.

RETURN TO: ~~Maryland Historical Trust
The Shaw House, 21 State Circle
Annapolis, Maryland 21401
(301) 267-1438~~

SUGARLOAF REGIONAL TRAILS
Box 87, Stronghold
Dickerson, Md. 20753
(301) 926-4510

ACHS SUMMARY FORM

1. Name Mendelsohn Terrace

2. Planning Area/Site Number 10/12

3. MNCPPC Atlas Reference Map 2

Coord: F-11

4. Address Rt. 122 and Gladhill Roads, Browningsville

5. Classification Summary

Category building

Ownership private

Public Acquisition N.A.

Status occupied

Accessible no

Present use agriculture private residence

Previous Survey Recording M-NCPPC Federal State County X Local

(Title and date: Historical Sites Inventory 1976)

6. Date 1880

7. Original Owner:

George Washington W. Walker

8. Apparent Condition

a. Excellent

c. Original Site

b. Unaltered

9. Description: This lovely Gothic Revival three bay by five bay two and a half story L-shape frame farm house sits on a hill facing south. The house used to have novelty siding but recently was covered by aluminum siding. The south (front) porch has a flat roof with a turned balustraded roof railing and supported by four wooden columns. The porch is enclosed by a turned balustraded railing. There are one over one and two over two double hung windows flanked by black aluminum siding. There are three cross gables on the south elevation. Two eight light Gothic windows are set into each of these cross gables.

10. Significance: The land on which Mendelsohn Terrace sits has been in the same family since 1830 and is still a viable family farm. The house itself is an important example of Gothic Revival architecture in Montgomery County. George Brian Walker was deeded the land in 1830. His son, George Washington Wesley Walker was born in a log cabin on the farm in 1837; the stone chimney of the original family log cabin still remains on the farm. Mendelsohn Terrace was built in 1880 for George W. Walker by John Mount, a local builder. Mount also constructed Bethesda Church nearby, founded by the Walkers. For over 50 years Mendelsohn Terrace was the musical and literary center of Browningsville as Professor Walker's choirs and schools gathered for musical and social occasions. It has been stated that Walker had everyone in the upper county singing. Seventh and eighth generation Walkers continue to live here and run the dairy farm.

11. Date researched and researcher Fall 1978 Carole U. Marks

Compiler Gail Rothrock

13. Date Compiled 12/78

Candy Reed - Architectural Description

14. Designation Approval

15. Acreage 150.582 acres

"Mendelsohn Terrace"

Attachment Sheet A

FOOTNOTES:

1. Mary B. Scanlon, "Pioneer Music Masters", Music Educators Journal, p. 2.
2. Wills of Montgomery County, Md., JWS1, 63.
3. Land Records of Montgomery County, EBP 15/103 (1875).
4. Scanlon, OP. Cit., p. 2.
5. Tax Assessment, 1876-1896, District 2, p. 33.

BIBLIOGRAPHY

PRIMARY SOURCES

Montgomery County Land Records
Tax Assessment Records 1876-1896, District 2, Montgomery County.
U.S. Census Records, Montgomery County, Md., 1870 & 1880.
Will Records, Montgomery County.

SECONDARY SOURCES

- Day, Jackson. The Story of the Maryland Walker Family.
Including the descendants of George Brian
Walker and Elizabeth Walker Beall.
August 24, 1957.
Montgomery County Historical Society
- Scanlon, Mary Browning. "Pioneer Music Masters"
Music Educators Journal, September, 1938.

MENDELSONH TERRACEDEED HISTORY

land known originally as "Henry & Elizabeth Enlarged"

7th generation	12 March 1952 - Present	Stewart E. Walker and Eunice E. Walker
	L 1640	F 185 & 195
6th generation	1924- 1951	Eugene Samuel Wesley Walker & Mary R. (d. 18 July 1951)
	L	F
5th generation	31 May 1917- 1924	John Lewis Walker & Hattie A.(Harriet)
	L 264	F 312
5th generation	June 1911- 1917	Fidilia W. Snyder & other family (G.W.W.Walker's daughter)
	L 224	F 318
4th generation	20 Dec 1875- June 1911	George W. W. Walker & Rachel B.
	L EBP 15	F 103
4th generation	c. 1860- 20 Dec 1875	Nathan James Walker & other family members
	L	F
3rd generation	28 Apr 1830- 1860	George Brian Walker & Margaret (d. 11 Sep 1860)
	L BS 2	F 524
	1803 1795	- 28 Apr 1830 Peter Boyer
	7 Oct 1803	Peter Boyer buys from James Day L L F 77
	25 July 1795	Peter Boyer buys from William Ballenger L F-7 F22

Original Grant to Henry Hall for 2,302 $\frac{1}{4}$ acres and called "Henry & Elizabeth Enlarged"

MARYLAND HISTORICAL TRUST WORKSHEET

1600125604

NOMINATION FORM
for the
NATIONAL REGISTER OF HISTORIC PLACES, NATIONAL PARKS SERVICE

SEE INSTRUCTIONS

1. NAME				
COMMON:				
AND/OR HISTORIC: Mendelsohn Terrace				
2. LOCATION				
STREET AND NUMBER: Rte. 122 and Gladhill Road				
CITY OR TOWN: Browingsville				
STATE: Maryland		COUNTY: Montgomery		
3. CLASSIFICATION				
CATEGORY (Check One)	OWNERSHIP		STATUS	ACCESSIBLE TO THE PUBLIC
<input type="checkbox"/> District <input checked="" type="checkbox"/> Building <input type="checkbox"/> Site <input type="checkbox"/> Structure <input type="checkbox"/> Object	<input type="checkbox"/> Public <input checked="" type="checkbox"/> Private <input type="checkbox"/> Both	Public Acquisition: <input type="checkbox"/> In Process <input type="checkbox"/> Being Considered	<input type="checkbox"/> Occupied <input type="checkbox"/> Unoccupied <input type="checkbox"/> Preservation work in progress	Yes: <input type="checkbox"/> Restricted <input type="checkbox"/> Unrestricted <input checked="" type="checkbox"/> No
PRESENT USE (Check One or More as Appropriate)				
<input checked="" type="checkbox"/> Agricultural <input type="checkbox"/> Commercial <input type="checkbox"/> Educational <input type="checkbox"/> Entertainment	<input type="checkbox"/> Government <input type="checkbox"/> Industrial <input type="checkbox"/> Military <input type="checkbox"/> Museum	<input type="checkbox"/> Park <input checked="" type="checkbox"/> Private Residence <input type="checkbox"/> Religious <input type="checkbox"/> Scientific	<input type="checkbox"/> Transportation <input type="checkbox"/> Other (Specify) _____ _____ _____	<input type="checkbox"/> Comments _____ _____ _____
4. OWNER OF PROPERTY				
OWNER'S NAME: Stewart E. Walker				
STREET AND NUMBER:				
CITY OR TOWN: Browingsville			STATE: Maryland	
5. LOCATION OF LEGAL DESCRIPTION				
COURTHOUSE, REGISTRY OF DEEDS, ETC.: Montgomery County Courthouse				
STREET AND NUMBER:				
CITY OR TOWN: Rockville			STATE: Maryland	
Title Reference of Current Deed (Book & Pg. #):				
6. REPRESENTATION IN EXISTING SURVEYS				
TITLE OF SURVEY: None				
DATE OF SURVEY: <input type="checkbox"/> Federal <input type="checkbox"/> State <input type="checkbox"/> County <input type="checkbox"/> Local				
DEPOSITORY FOR SURVEY RECORDS:				
STREET AND NUMBER:				
CITY OR TOWN:			STATE:	

7. DESCRIPTION

CONDITION	(Check One)					
	<input type="checkbox"/> Excellent	<input checked="" type="checkbox"/> Good	<input type="checkbox"/> Fair	<input type="checkbox"/> Deteriorated	<input type="checkbox"/> Ruins	<input type="checkbox"/> Unexposed
	(Check One)			(Check One)		
	<input checked="" type="checkbox"/> Altered	<input type="checkbox"/> Unaltered	<input type="checkbox"/> Moved	<input checked="" type="checkbox"/> Original Site		

DESCRIBE THE PRESENT AND ORIGINAL (if known) PHYSICAL APPEARANCE

The house is a two-story, frame structure with a three, bay main facade, composed of double windows flanking a double door. The facade has three dormers that break through the boxed cornice; the central dormer has the date 1880 in large wooden numerals.

In plan, the house has a central hall and flanking parlours. The oval staircase is open to the third floor.

The present house replaced an earlier one on a nearby site. The earlier house was an A-roofed, log structure of two parts; originally a single house with external chimney, an addition made it a central chimney house. Each half had a central doorway and flanking windows. The chimneys and parts of the foundation and walls remain standing.

SEE INSTRUCTIONS

8. SIGNIFICANCE

PERIOD (Check One or More as Appropriate)

- Pre-Columbian
- 15th Century
- 16th Century
- 17th Century
- 18th Century
- 19th Century
- 20th Century

SPECIFIC DATE(S) (If Applicable and Known) 1880

AREAS OF SIGNIFICANCE (Check One or More as Appropriate)

- | | | | |
|--|--|---|--|
| <input type="checkbox"/> Aboriginal
<input type="checkbox"/> Prehistoric
<input type="checkbox"/> Historic
<input type="checkbox"/> Agriculture
<input type="checkbox"/> Architecture
<input type="checkbox"/> Art
<input type="checkbox"/> Commerce
<input type="checkbox"/> Communications
<input type="checkbox"/> Conservation | <input type="checkbox"/> Education
<input type="checkbox"/> Engineering
<input type="checkbox"/> Industry
<input type="checkbox"/> Invention
<input type="checkbox"/> Landscape
<input type="checkbox"/> Architecture
<input type="checkbox"/> Literature
<input type="checkbox"/> Military
<input type="checkbox"/> Music | <input type="checkbox"/> Political
<input type="checkbox"/> Religion/Philosophy
<input type="checkbox"/> Science
<input type="checkbox"/> Sculpture
<input type="checkbox"/> Social/Humanitarian
<input type="checkbox"/> Theater
<input type="checkbox"/> Transportation | <input type="checkbox"/> Urban Planning
<input type="checkbox"/> Other (Specify)
<hr/>
<hr/>
<hr/>
<hr/>
<hr/> |
|--|--|---|--|

STATEMENT OF SIGNIFICANCE

Prof. George Wesley Walker named the farm Mendelsohn Terrace. He is responsible for the present structure.

SEE INSTRUCTIONS

9. MAJOR BIBLIOGRAPHICAL REFERENCES

10. GEOGRAPHICAL DATA

LATITUDE AND LONGITUDE COORDINATES DEFINING A RECTANGLE LOCATING THE PROPERTY			O R	LATITUDE AND LONGITUDE COORDINATES DEFINING THE CENTER POINT OF A PROPERTY OF LESS THAN TEN ACRES		
CORNER	LATITUDE	LONGITUDE		LATITUDE	LONGITUDE	
	Degrees Minutes Seconds	Degrees Minutes Seconds		Degrees Minutes Seconds	Degrees Minutes Seconds	
NW	° ' "	° ' "		° ' "	° ' "	
NE	° ' "	° ' "		° ' "	° ' "	
SE	° ' "	° ' "		° ' "	° ' "	
SW	° ' "	° ' "		° ' "	° ' "	

APPROXIMATE ACREAGE OF NOMINATED PROPERTY:

Acreage Justification:

LIST ALL STATES AND COUNTIES FOR PROPERTIES OVERLAPPING STATE OR COUNTY BOUNDARIES

STATE:		COUNTY:	
STATE:		COUNTY:	
STATE:		COUNTY:	
STATE:		COUNTY:	

11. FORM PREPARED BY

NAME AND TITLE:
Christopher Owens, Park Historian

ORGANIZATION: M-NCPPC DATE:

STREET AND NUMBER:
8787 Georgia Avenue

CITY OR TOWN: Silver Spring STATE: Maryland

12. State Liaison Officer Review: (Office Use Only)

Significance of this property is:
 National State Local

Signature _____

SEE INSTRUCTIONS

the following tracts or parts of tracts of land situated in Montgomery County in the State of Maryland, which is described as follows; part of a tract of land called "Honor & Elizabeth Enlarged", part of "Flag Patch", and part of the "Resurvey on Solomon's Discovery", lying in Montgomery County and State aforesaid - Beginning at the beginning of that part of "Honor & Elizabeth Enlarged", which was conveyed by William Ballenger to Peter Boyer, dec^d, on the 25th day of July, 1795, for one hundred and twenty eight acres of land - it being at the end of the 18th line of the whole tract where a stone is planted, and run with a half degree allowance for variation, to the West, to correspond with a former location, North fifty and one half degrees East eighty perches to the end of the ninth line expressed in a deed from James Day to Peter Boyer for one hundred and sixty acres, three quarters and sixteen perches part of "Flag Patch", and a part of the "Resurvey on Solomon's Discovery"; then by and with the said deed allowing, as aforesaid, North fifty and one half degrees East, sixteen perches; North seventy eight and one half degrees East, twenty seven perches then North one half degree East, eighty three and one half perches, to the end of the 4th line of the said deed from William Ballenger to Peter Boyer; and with the lines of the said deed as aforesaid North 15 $\frac{1}{2}$ ° West, fifty perches to a stone; then North thirty three and one half degrees East, twenty perches, to a stone; then North 29 $\frac{1}{2}$ ° West, sixty nine and one half perches to a stone; then South 33 $\frac{1}{2}$ ° West, thirty nine and three quarters perches to a stone; then South 30 $\frac{1}{2}$ ° West, one hundred and eleven and a half perches to a stone then with a straight line to the beginning Containing one hundred and forty two acres, three quarters of an acre, and twenty nine perches, more or less - laid off by William Morcell and a reference to the Plat returned by him will more fully show.

Jest J. Kemp, ^{S. Walker} as to Mr. Walker & wife
 Albert F. Miles wife & Sarah A. Glaze

J. J. Waifield as to N. J. Walker wife

N. A. Hourley, as to Mr. M. Glaze

Nathan J. Walker Real

Everline Walker Real

W. R. Walker Real

Mary A. E. Walker Real

Albert F. Miles Real

Mary M. J. Miles Real

Mr. M. Glaze Real

Sarah A. Glaze Real

State of Maryland, Montgomery County, Oct: -

I hereby Certify, that on this twentieth day of December in the year Eighteen hundred and Seventy five, before the Subscriber, a Justice of the Peace of said State in and for said County, personally appeared Nathan J. Walker and Everline Walker, his wife, and did each acknowledge the foregoing Deed to be their respective act.

John T. Waifield J. P.

State of Maryland, Montgomery County, Oct: -

I hereby Certify, that on this twentieth day of December in the year Eighteen hundred and Seventy five, before me the Subscriber, a Justice of the Peace of said State, in and for said County, personally appeared William R. Walker and Mary E. Walker, his wife, Albert F. Miles, and Mary M. J. Miles, his wife, and Sarah A. Glaze wife of William M. Glaze, and did each acknowledge the foregoing Deed to be their respective act.

J. C. W. Kemp J. P.

forty five degrees West, twenty nine and eight tenths perches to a stone, then North, the end of two perches on a line drawn North forty eight and one half degrees East from a stone heretofore planted; then with the given line of Fellowship; North forty four and one fourth degrees West, one hundred and seven perches to the place of beginning, containing one hundred and thirty seven and one eighth acres of land, more or less.

The second part- Part of a tract of land called "The Resurvey on Dublin" - it being that same piece or parcel of land which was conveyed by Deed made September the 29th in the year Eighteen hundred and Sixty five by Edwin M. Muncaster and others to Charles Saffell for seven acres, three rods and twenty seven and seven tenths square perches of land

Beginning at the end of the fourteenth line of the whole tract called "The Resurvey on Dublin"; and running thence with said tract North seventy five degrees West, thirty four perches, North eighty five degrees West fourteen perches to the eleventh line of a tract of land called "Fellowship"; then with said line South seven degrees East, fifty four perches; then North forty five degrees East, fifty eight and twenty one twenty fifths perches to the place of beginning, containing seven acres, three rods and twenty seven and seven tenths square perches of land, more or less, and making in all one hundred and forty five acres and seven and seven tenths square perches of land, more or less.

In fee simple, and the said Mary Sophia Mills and Richard H. Mills, her husband and Arv. Matilda Saffell will warrant generally the property herein before particularly mentioned and described.

Test: John F. Walker.
John F. Warfield.

Witness our hands as seals.
Mary Sophia Mills Seal
Richard H. Mills Seal
Arv. Matilda Saffell Seal

State of Maryland Montgomery County, Oct. -

I hereby certify, that on this eighth day of April in the year one thousand eight hundred and seventy six, before me the subscriber a Justice of the Peace of Montgomery County in the State of Maryland, personally appeared Mary Sophia Mills and R. H. Mills, her husband and Arv. Matilda Saffell the wife of Charles Saffell, deceased, and did acknowledge the foregoing Deed, to be in fact.

John F. Warfield J. P.

At the request of George W. Walker the following Deed was recorded the 9th day of May 1876, to wit:-

This Deed made this 30th day of December in the year of our Lord Eighteen hundred and Seventy five, by Nathaniel J. Walker and Eveline Walker, his wife of Montgomery County in the State of Maryland and William R. Walker and Mary A. E. Walker his wife, Albert F. Miles and Mary M. Miles, his wife, William M. Glaze and Sarah A. Glaze, his wife, of Frederick County, in the State aforesaid Witnesseth, That in consideration of Two thousand and four hundred dollars paid us, by George W. Walker, of Montgomery County in the State of Maryland, We, the said Nathaniel J. Walker and Eveline Walker his wife, William R. Walker and Mary A. E. Walker, his wife, Albert F. Miles and Mary M. J. Miles, his wife and William M. Glaze and Sarah A. Glaze, his wife, of the Counties and State aforesaid, do grant, bargain, sell and convey unto the said George W. Walker, all our right, title, claim and interest, both at law and equity, in and to

George W. Walker
Nathaniel J. Walker
Eveline Walker
William R. Walker
Mary A. E. Walker
Albert F. Miles
Mary M. Miles
William M. Glaze
Sarah A. Glaze

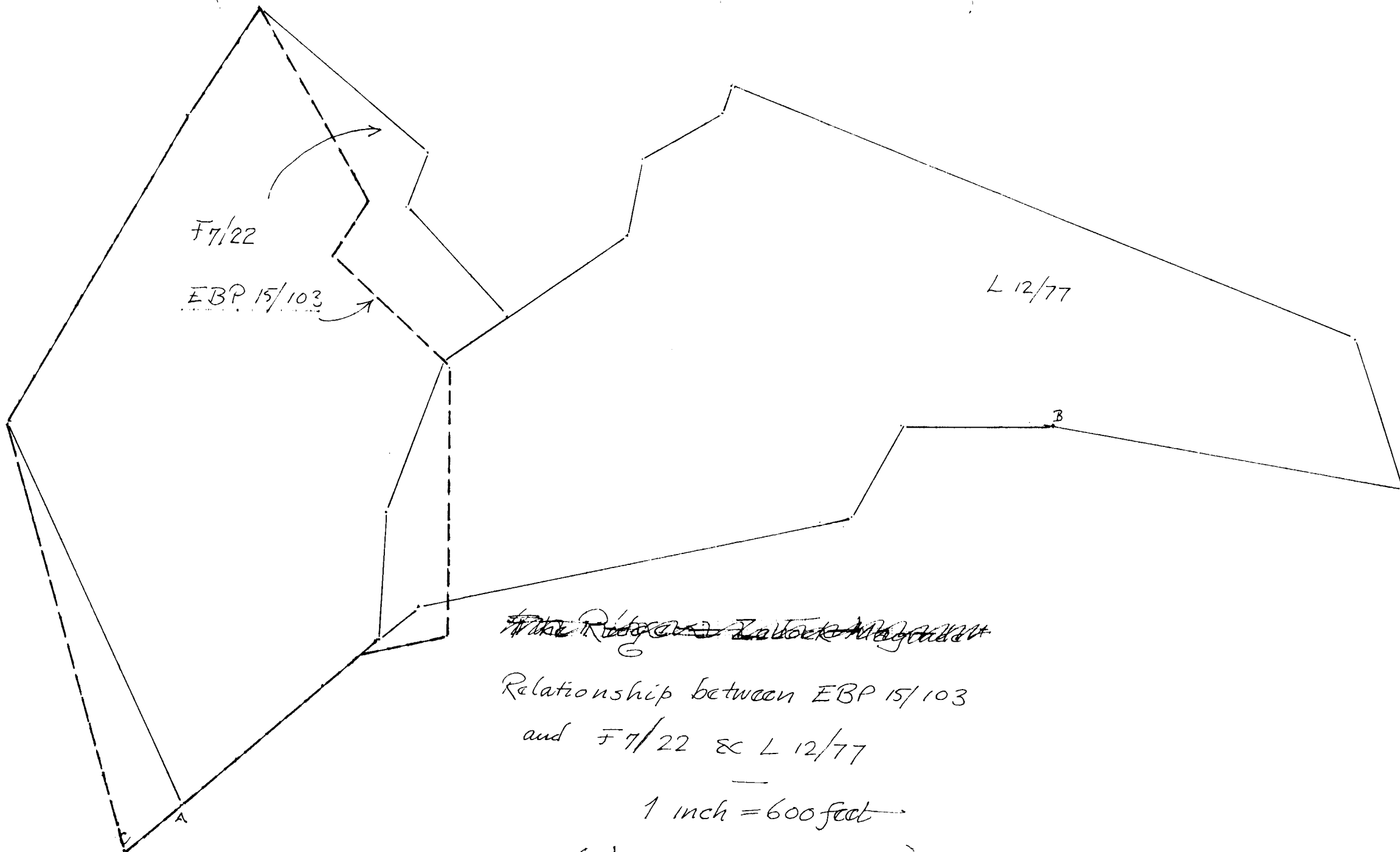

~~The Ridge and Valley Region~~

Relationship between EBP 15/103
and F7/22 & L 12/77

1 inch = 600 feet

(Mendelsohn Terrace)

TOWN



Store
Olea Walker
G. Grimes & O. Nelson
Horn, Tubb & Stone
L. Thelove Thelove
The Clarksville Baptist Church

Forney's Branch

Clarksville P.O.

Magruder's Branch

Branch

Hyattstown

Bennett Cr.

Goshen

Cracklintown

Laytonsville

Paluxy River

Paluxy River

Paluxy River

Paluxy River

Paluxy River

Paluxy River

Paluxy River

Paluxy River

Paluxy River

Paluxy River

Paluxy River

"Mendelsohn Terrace"
Attachment Sheet C

M: 30/12

MAGI#

Martinet - Bond 1865



NAME MENDELSSOHN TERRACE M: #10-12

LOCATION Rt. 122 & GLADHILL Rd BROWNSVILLE, Md

FACADE E

PHOTO TAKEN 1/23/74 M. DWYER



NAME MENDELSSOHN TERRACE / WALKER FARM

M; #10-12

LOCATION Rt. 122 BROWNSVILLE, Md

FACADE W

PHOTO TAKEN 1/23/74 M. DWYER



NAME MENDELSSOHN TERRACE - RUINS OF CAPT. BOYER DOUBLE/KOG HOUSE

LOCATION Rt. 122 BROWNSVILLE, MD

M: #10-12

FACADE N

PHOTO TAKEN 1/23/74 M. DWYER



NAME MENDELSOHN TERRACE / BOYER-WALKER FARM - RUINS, BOYER LOG HSE

LOCATION Rt. 122 BROWNSVILLE, Md

M: #10-12

FACADE SW

PHOTO TAKEN 1/23/74 M. DWYER



NAME MENDELSSOHN TERRACE / WALKER FARM

M: #10-12

LOCATION RT. 122 BROWNSVILLE, Md

FACADE LOOKING SE

PHOTO TAKEN 1/23/74 M. DWYER



NAME BROWNINGSVILLE Md

M: #10-12

LOCATION FROM WALKER FARM Rt. 122

FACADE LOOKING S

PHOTO TAKEN 1/23/74 M. DWYER



NAME MENDELSSOHN TERRACE - WACKER FARM N1; #10-12

LOCATION Rt. 122 BROWNSVILLE, Md

FACADE

PHOTO TAKEN 1/23/74 M. DWYER