

HO-556
Keewaydin Farm
Ellicott City
Private

circa 1913

Keewaydin Farm faces southeast* on the northeast corner of Old Columbia Pike and Toll House Road. It is a five bay wide, two bay deep, two and a half story high, gabled roof (running north-south) frame (covered with wooden shingles) house, resting on a cement foundation, with wide, brick, exterior chimneys placed on the east side of its south wall and on the west side of its north wall.

A central gabled roof portico is placed before the entrance. Flanking, north and south, one story high, flat roofed, open and screened in porches, supported by three doric columns are placed along the north and south walls of the building, creating a terminating frame for the central building block, with a kitchen wing on the north side of the west wall creating an off center "T" plan for the house.

The east elevation features the central, open bible and cross paneled entrance door, flanked by six vertical side lights, surmounted by roman arched transom with thirteen lights, six of which spring from a central half circle to form an open fan. Two gabled roof, attic dormers, holding roman arched windows rest above.

Keewaydin Farm was constructed by James Clark, who later became a Circuit Court Judge of Howard County, for his bride, Alda Hopkins Clark in 1913.

MARYLAND HISTORICAL TRUST

H0-556
Ellicott City Quad
District 2
MAGI #1405565704

INVENTORY FORM FOR STATE HISTORIC SITES SURVEY

1 NAME

HISTORIC The Keewaydin Farm

AND/OR COMMON

2 LOCATION

STREET & NUMBER 4090 Old Columbia Pike (MD 987)

CITY, TOWN

Ellicott City

— VICINITY OF

CONGRESSIONAL DISTRICT

6th

STATE

Maryland

COUNTY

Howard

3 CLASSIFICATION

CATEGORY	OWNERSHIP	STATUS	PRESENT USE	
<input type="checkbox"/> DISTRICT	<input type="checkbox"/> PUBLIC	<input checked="" type="checkbox"/> OCCUPIED	<input type="checkbox"/> AGRICULTURE	<input type="checkbox"/> MUSEUM
<input checked="" type="checkbox"/> BUILDING(S)	<input checked="" type="checkbox"/> PRIVATE	<input type="checkbox"/> UNOCCUPIED	<input type="checkbox"/> COMMERCIAL	<input type="checkbox"/> PARK
<input type="checkbox"/> STRUCTURE	<input type="checkbox"/> BOTH	<input type="checkbox"/> WORK IN PROGRESS	<input type="checkbox"/> EDUCATIONAL	<input checked="" type="checkbox"/> PRIVATE RESIDENCE
<input type="checkbox"/> SITE	PUBLIC ACQUISITION	ACCESSIBLE	<input type="checkbox"/> ENTERTAINMENT	<input type="checkbox"/> RELIGIOUS
<input type="checkbox"/> OBJECT	<input type="checkbox"/> IN PROCESS	<input checked="" type="checkbox"/> YES: RESTRICTED	<input type="checkbox"/> GOVERNMENT	<input type="checkbox"/> SCIENTIFIC
	<input type="checkbox"/> BEING CONSIDERED	<input type="checkbox"/> YES: UNRESTRICTED	<input type="checkbox"/> INDUSTRIAL	<input type="checkbox"/> TRANSPORTATION
		<input type="checkbox"/> NO	<input type="checkbox"/> MILITARY	<input type="checkbox"/> OTHER

4 OWNER OF PROPERTY

NAME

Mr. & Mrs. Rene' Gelber

Telephone #:

STREET & NUMBER

4090 Old Columbia Pike

CITY, TOWN

Ellicott City

— VICINITY OF

STATE, zip code

Maryland

5 LOCATION OF LEGAL DESCRIPTION

COURTHOUSE Tax Map 24 p. 1092
REGISTRY OF DEEDS, ETC. Hall of Records

Liber #: 707

Folio #: 662

STREET & NUMBER

Howard County Court House

CITY, TOWN

Ellicott City

STATE

Maryland

6 REPRESENTATION IN EXISTING SURVEYS

TITLE

Howard County Historic Sites Inventory

DATE

1978-1979

—FEDERAL STATE —COUNTY —LOCAL

DEPOSITORY FOR SURVEY RECORDS

Maryland Historical Trust

CITY, TOWN

21 State Circle, Annapolis

STATE

Maryland

7 DESCRIPTION

CONDITION		CHECK ONE	CHECK ONE
<input checked="" type="checkbox"/> EXCELLENT	<input type="checkbox"/> DETERIORATED	<input type="checkbox"/> UNALTERED	<input checked="" type="checkbox"/> ORIGINAL SITE
<input type="checkbox"/> GOOD	<input type="checkbox"/> RUINS	<input checked="" type="checkbox"/> ALTERED	<input type="checkbox"/> MOVED DATE _____
<input type="checkbox"/> FAIR	<input type="checkbox"/> UNEXPOSED		

DESCRIBE THE PRESENT AND ORIGINAL (IF KNOWN) PHYSICAL APPEARANCE

*Note - The building faces southeast, but for simplification of building description, we will use east for the principle facade and west for the back of the house, etc.

Keewaydin Farm faces southeast* on the northeast corner of Old Columbia Pike and Toll House Road. It is a five bay wide, two bay deep, two and a half story high, gabled roof (running north-south) frame (covered with wooden shingles) house, resting on a cement foundation, with wide, brick, exterior chimneys placed on the east side of its south wall and on the west side of its north wall.

A central gabled roof portico is placed before the entrance. Flanking, north and south, one story high, flat roofed, open and screened in porches, supported by three doric columns are placed along the north and south walls of the building, creating a terminating frame for the central building block, with a kitchen wing on the north side of the west wall, creating an off center "T" plan for the house.

THE EAST FACADE

The east elevation features the central, open bible and cross paneled entrance door, flanked by six vertical side lights, surmounted by a roman arched transom with thirteen lights, six of which spring from a central half circle to form an open fan.

Fenestration for the house is vertically aligned and proportionally scaled.

Windows on the north and south sides of the central entrance bay are paired. They are rectangular, with double-hung sashes, holding six-over-six lights, underlined by projecting wooden sills and decorated with shutters. A wooden water table runs along the base of the building, terminating the basement wall section, which holds four three-light, horizontal, rectangular basement windows, inset into the two north and south bays of this elevation.

Two poured-in-place concrete steps, flanked by an iron railing, lead to the central, gabled roof portico, supported by two doric columns, which covers the central entrance door.

A second floor window, similar to those described is vertically aligned to the entrance.

Two gabled roof dormer windows, with broken pediments, held by flanking pilasters encasing roman arched, double-hung windows, with six-over-six lights, are placed in the roof at this elevation.

The gable roof overhangs on both the east and west elevations, as well as the west elevation of the kitchen wing. These walls are decorated with a plain box cornice, decorated with a row of brackets.

Two wide wooden steps lead on the south, to the open porch, and on the north, to the screened in porch, previously mentioned.

THE WEST ELEVATION

The west elevation has been some what altered. Originally the two north bays of this wall held a one story high, kitchen appendage with one story high, open porch along its west wall. This kitchen was extended to enclose the open porch and a second floor added.

A second alteration to the house occurs in the central bay of the main building block, which originally held a central west entrance, from the hall, covered by a gabled roof hood, supported by two wooden brackets. This central door has now become a central bay window, similar, but smaller than the others described.

The second floor staircase landing of this central bay holds a charming tripartite, rectangular, window, each section a fifteen light, rectangular, casement window, whose central section is flanked by flat pilasters, the whole of which is underlined by a projecting wooden sill and encased in a rectangular molding.

The two south bays of the west wall hold two first and second floor windows, similar to those described. Centered beneath these two lines of windows rests a cellar door.

The two north bays of this wall now hold a two bay wide, two bay deep, two story high, shed roofed, frame (covered with wooden shingles) kitchen wing, resting on a cement foundation.

The wooden belt which runs around the perimeter of the building, terminating the foundation level, continues around the north, south and west walls of this section of the house.

A rectangular entrance door is placed in the south bay of the west wall of the kitchen wing, covered by the gabled roof hood, previously mentioned, which once covered the central west door of the main building block. Four open, wooden steps, flanked by a wooden railing, lead to its wooden landing.

The north bay of the kitchen's west wall holds a first and second floor window, similar to those described. The roofline of the west wall is decorated with a cornice, similar to those found on the east and west elevations of the main building block.

THE SOUTH ELEVATION

The south elevation holds a proportionally scaled, six-six light, rectangular, french door, flanked by shutters in its west bay. A wide brick, exterior chimney takes up a large section of the east side of this wall. A similar, second floor, french door, without shutters, rests just west of the brick chimney, with a six-over-six light, second floor window placed west of it.

Two, similar, but smaller, attic windows are set into the center of the "A" line formed by the gabled roof.

THE NORTH ELEVATION

The north elevation of the main building block holds a six-six, proportionally scaled, light, rectangular, french door, flanked by shutters, which is placed just east of center. A smaller, but similar, first floor window lies west of it.

A similar, second floor, french door, located on the east side of this wall, leads out to the terrace, formed by the flat roof of the one story high, screened in porch, running along this elevation. A rectangular, second floor window, similar to those already described, rests in the west bay. Two attic windows similar to those on the south elevation are placed above.

The north elevation of the kitchen wing holds a shed roofed, oriele, tripartite window, each section one large rectangular light covered by an eight light divider.

A second floor window, similar to those featured throughout the house, rests on the east side of this wall.

THE INTERIOR

The interior features a wide, central hall and spiral staircase, with large rooms on either side.

A tent roofed, smoke house and shed roofed tool shed are located west of the house, with a large, one and a half story high, gabled roof stable, featuring an intersecting east gable and central, tent roofed, cupola, lying southwest of the house.

8 SIGNIFICANCE

HO-556
Ellicott City Quad
District 2

PERIOD	AREAS OF SIGNIFICANCE -- CHECK AND JUSTIFY BELOW			
<input type="checkbox"/> PREHISTORIC	<input type="checkbox"/> ARCHEOLOGY-PREHISTORIC	<input type="checkbox"/> COMMUNITY PLANNING	<input type="checkbox"/> LANDSCAPE ARCHITECTURE	<input type="checkbox"/> RELIGION
<input type="checkbox"/> 1400-1499	<input checked="" type="checkbox"/> ARCHEOLOGY-HISTORIC	<input type="checkbox"/> CONSERVATION	<input type="checkbox"/> LAW	<input type="checkbox"/> SCIENCE
<input type="checkbox"/> 1500-1599	<input type="checkbox"/> AGRICULTURE	<input type="checkbox"/> ECONOMICS	<input type="checkbox"/> LITERATURE	<input type="checkbox"/> SCULPTURE
<input type="checkbox"/> 1600-1699	<input checked="" type="checkbox"/> ARCHITECTURE	<input type="checkbox"/> EDUCATION	<input type="checkbox"/> MILITARY	<input type="checkbox"/> SOCIAL/HUMANITARIAN
<input type="checkbox"/> 1700-1799	<input type="checkbox"/> ART	<input type="checkbox"/> ENGINEERING	<input type="checkbox"/> MUSIC	<input type="checkbox"/> THEATER
<input type="checkbox"/> 1800-1899	<input type="checkbox"/> COMMERCE	<input type="checkbox"/> EXPLORATION/SETTLEMENT	<input type="checkbox"/> PHILOSOPHY	<input type="checkbox"/> TRANSPORTATION
<input checked="" type="checkbox"/> 1900-	<input type="checkbox"/> COMMUNICATIONS	<input type="checkbox"/> INDUSTRY	<input type="checkbox"/> POLITICS/GOVERNMENT	<input type="checkbox"/> OTHER (SPECIFY)
		<input type="checkbox"/> INVENTION		

SPECIFIC DATES Date 1913

BUILDER/ARCHITECT

STATEMENT OF SIGNIFICANCE

Keewaydin Farm is significant historically and architecturally to the State of Maryland and Howard County as the home which Judge James Clark built for his bride, Alda Tyson Hopkins, in 1913, in the Neo-colonial style, featuring a two and a half story high, central building block, with a central, gabled roof portico, flanked by one story high porches.

James Clark and his wife, Alda Hopkins Clark, were active community leaders of Howard County. According to the history of Keewaydin Farm, written by Mrs. Cecelia Holland in her book entitled, Ellicott City, Maryland, Mill Town, U.S.A., the following "firsts" took place at Keewaydin:

.... the annual suppers for the benefit of St. John's Church were initiated by the Clarks and held here for a number of years; the first meeting of the Ellicott City Parent-Teacher Association was also held in this house; and the Howard County Health Department held its first official meeting within these walls. Meanwhile, Judge Clark was one of the promoters of the Rotary Club and served as its first president, even as Mrs. Clark was instrumental in promoting the annual County Fairs. Realizing that money was due the County for such a program, she had her husband speak to Mr. Warren G. (Buddy) Myers, County Agent for many years. Mr. Myers wrote to the Maryland State Fair Association and obtained the allotted money, making possible the first official fair.

An avid horsewoman, Mrs. Clark rode, bred and broke her own colts, as late as age 76, and was instrumental in initiating the Doughoregan Horse Shows in 1921, the first being held at Keewaydin Farm.

Not only were Judge and Mrs. Clark active community leaders, but they exemplified the finest qualities of family life, a gleaming of which can be found in Mrs. Clark's book, Hold Hard. The Clarks were successful in instilling in their four sons a desire to serve their County and State and to become, themselves, leaders in the community. Their son, John Clark, served as Judge of the Orphans' Court, while their son, James Clark, now serves as President of the Maryland Senate.

All have indicated an interest in furthering and preserving the history of their County, so actively pursued by their mother, who not only founded the Howard County Historical Society and served as first president, but also purchased the First Presbyterian Church in 1960 to present to that Society in memory of her late husband.

As one of the several fine houses along Old Columbia Pike, Kee-waydin Farm would serve as an anchor, along with "Search Enclosed," its neighbor on the opposite side of the road as the southern boundary of an extension of the Ellicott City National Register Historic District, should its owners so desire.

9 MAJOR BIBLIOGRAPHICAL REFERENCES

Howard County Land Records
Interview with Mrs. Rene' Gelber at Keewaydin Farm, April, 1980.
Holland, Celia, Ellicott City, Maryland, Milltown, U.S.A.,
Tuxedo, 1970.

CONTINUE ON SEPARATE SHEET IF NECESSARY

10 GEOGRAPHICAL DATA

ACREAGE OF NOMINATED PROPERTY 10.239 acres

Please see Attachment 1, Tax Map 24

VERBAL BOUNDARY DESCRIPTION

Please see Howard County Land Records, Liber 707 Folio 662

LIST ALL STATES AND COUNTIES FOR PROPERTIES OVERLAPPING STATE OR COUNTY BOUNDARIES

STATE Maryland COUNTY Howard

STATE _____ COUNTY _____

11 FORM PREPARED BY

NAME / TITLE

Cleora Barnes Thompson, Archivist

ORGANIZATION

Office of Planning & Zoning-Comprehensive Planning Section

DATE

STREET & NUMBER

3450 Court House Drive

TELEPHONE

CITY OR TOWN

Ellicott City

STATE

Maryland

The Maryland Historic Sites Inventory was officially created by an Act of the Maryland Legislature, to be found in the Annotated Code of Maryland, Article 41, Section 181 KA, 1974 Supplement.

The Survey and Inventory are being prepared for information and record purposes only and do not constitute any infringement of individual property rights.

RETURN TO: Maryland Historical Trust
The Shaw House, 21 State Circle
Annapolis, Maryland 21401
(301) 267-1438

TITLE SEARCH

HO-556 Keewaydin Farm

Prepared by Cleora Thompson, AICP

DATE	LIBER FOLIO	GRANTOR	GRANTEE	ACREAGE
31 Dec 74	707 - 662	Joseph Hopkins Clark	Rene L. Gelber	
30 Mar 67	466 - 652	John L. Clark	Joseph Hopkins Clark (subject to life estate of mother, Alda Hopkins Clark, Nov. 5, 1969)	
19 Aug 13	95 - 371	John L. Clark & Mary Corinne Clark	James Clark	10.01 Acres This is the tract upon which Keewaydin Farm was constructed.
<p>Note: The following three parcels were acquired later by James Clark, Grantee.</p>				
7 July 25	124 - 214	Wm. & Margaret Windsor	James Clark	6.1 acres
3 Aug 27	130 - 60	W. Arnold Brinkman	James Clark	19 acres
5 Oct 50	220 - 242	Interfield Realty	James Clark	0.913 acres

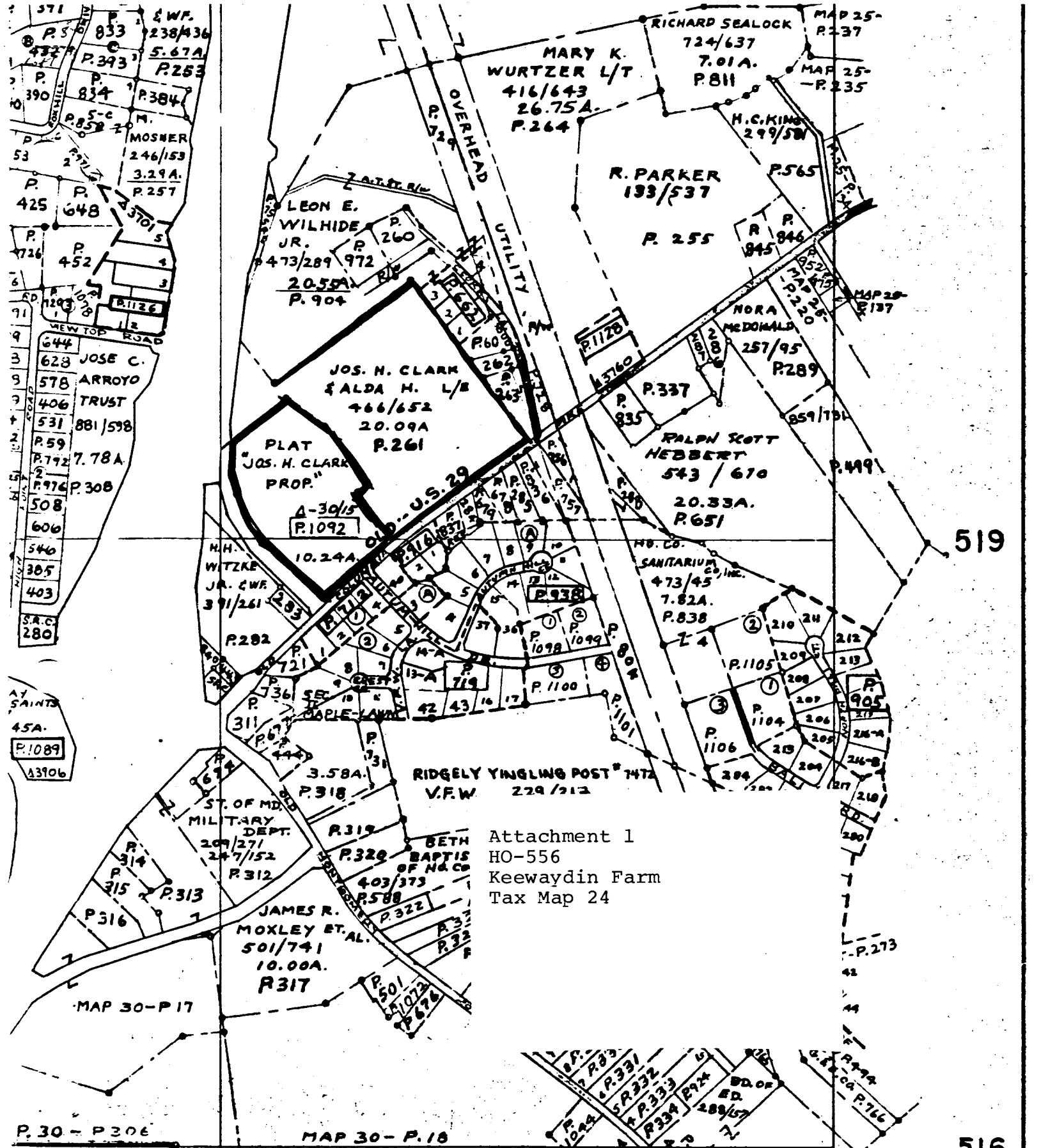

Attachment 1
 HO-556
 Keewaydin Farm
 Tax Map 24

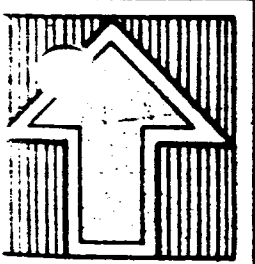

851 600 0 600 1200 1800 854

MAP NO
 24

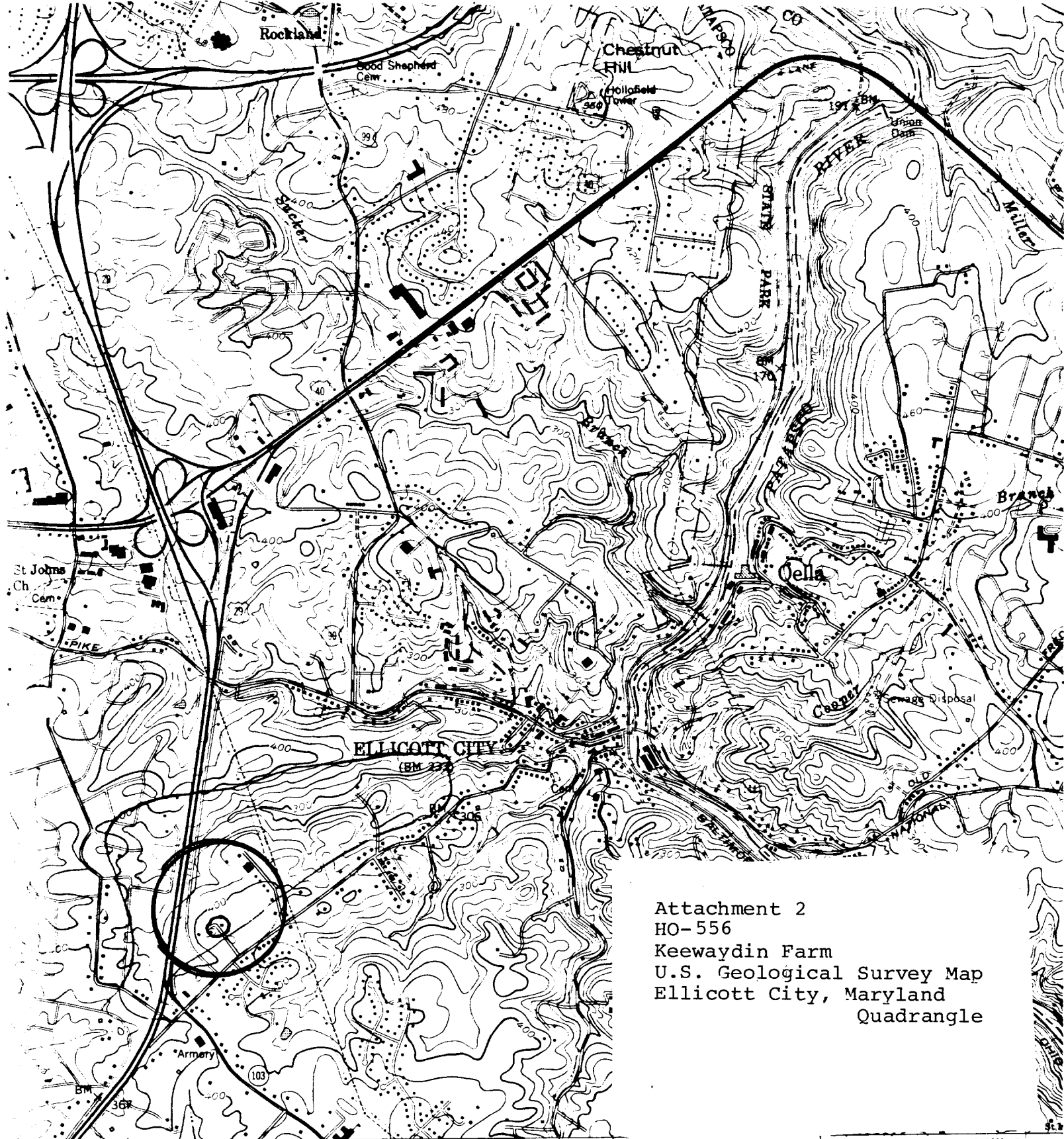

Attachment 2
 HO-556
 Keewaydin Farm
 U.S. Geological Survey Map
 Ellicott City, Maryland
 Quadrangle

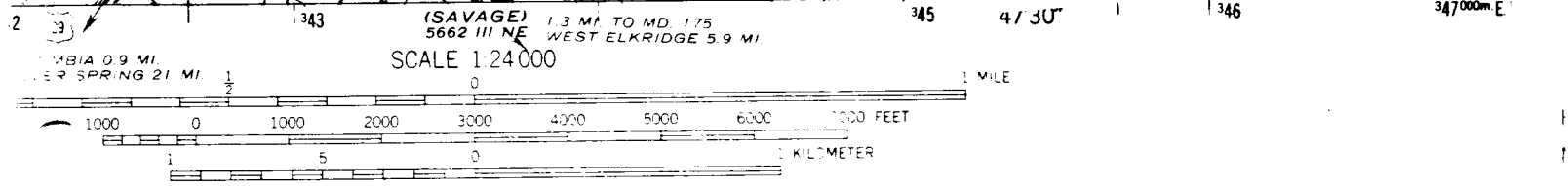

CONTOUR INTERVAL 20 FEET
 NATIONAL GEODETIC VERTICAL DATUM OF 1929

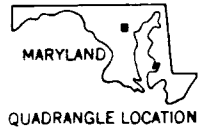



Name: HO-556
KeeWaydin Farm
Location: 4090 Old Columbia Pike
Ellicott City, Maryland 21043
Photographer: Cleora B. Thompson, A.I.C.P.
Date of Photograph: April, 1980
Negatives in possession of the Maryland Historical Trust
View: Southeast
Photographer looking: Northwest
Photograph number: 1 of 1