

HO-274

The Hubert Black House
Woodbine
Private

circa 1860

The Hubert Black House, now Larriland Farm, faces west on the northeast corner of Route 94 and Florence Road. It comprises some 250 acres of land on both the east and west sides of Route 94. During the tenure of Hubert Black this property was a dairy farm. Bought circa 1963 by Mr. Lawrence Moore, it was placed under sod and now for the past five or six years has been a farm, where one can pick one's own fruit and vegetables.

The house is a three bay wide, one room deep, two and a half story high, gabled roof (running north-south) frame (covered with clapboard) structure, resting on a stone foundation, with a square brick chimney inset into its south wall and another square brick interior chimney on the north side of the house.

It features a central, intersecting, gable on its west elevation, holding a three light fan light, with scrolled barge boards running along the eave line of the north, south and west elevations, as well as the central intersecting gable. A three bay wide, two bay deep, two story high, intersecting gable roof (running east-west), frame (covered with German siding), east wing, resting on a stone foundation, runs along two thirds of the building's east wall, creating an "L" plan. A square brick chimney is centered onto its east wall.

Fenestration for both sections of the house is rectangular and double-hung, holding two-over-two lights, with the exception of

those on the first and second floors of the main section of the house, the latter of which holds four-over-four lights. All are decorated with shutters and underlined with projecting wooden sills.

The Hubert Black House is a good example of vernacular, frame, domestic architecture, with elements of the Victorian Style, dating back to the mid-nineteenth century. In addition, the property has been agriculturally significant as a working farm from that time associated with the Black, Warfield and Jarden families of Howard County.

MARYLAND HISTORICAL TRUST

INVENTORY FORM FOR STATE HISTORIC SITES SURVEY

1 NAME

HISTORIC The Hubert Black House

AND/OR COMMON

Larriland Farm

2 LOCATIONSTREET & NUMBER E Corner Rt. 94^A and Florence Road
(Ellicott Road)

CITY, TOWN 2416 Woodbine Road (MD 94)

WOODBINE

VICINITY OF

CONGRESSIONAL DISTRICT
6th

STATE Maryland

COUNTY
Howard**3 CLASSIFICATION**

CATEGORY	OWNERSHIP	STATUS	PRESENT USE
<input checked="" type="checkbox"/> DISTRICT	<input type="checkbox"/> PUBLIC	<input checked="" type="checkbox"/> OCCUPIED	<input checked="" type="checkbox"/> AGRICULTURE <input type="checkbox"/> MUSEUM
<input type="checkbox"/> BUILDING(S)	<input checked="" type="checkbox"/> PRIVATE	<input type="checkbox"/> UNOCCUPIED	<input checked="" type="checkbox"/> COMMERCIAL <input type="checkbox"/> PARK
<input type="checkbox"/> STRUCTURE	<input type="checkbox"/> BOTH	<input type="checkbox"/> WORK IN PROGRESS	<input type="checkbox"/> EDUCATIONAL <input type="checkbox"/> PRIVATE RESIDENCE
<input type="checkbox"/> SITE	PUBLIC ACQUISITION	ACCESSIBLE	<input type="checkbox"/> ENTERTAINMENT <input type="checkbox"/> RELIGIOUS
<input type="checkbox"/> OBJECT	<input type="checkbox"/> IN PROCESS	<input checked="" type="checkbox"/> YES: RESTRICTED	<input type="checkbox"/> GOVERNMENT <input type="checkbox"/> SCIENTIFIC
	<input type="checkbox"/> BEING CONSIDERED	<input type="checkbox"/> YES: UNRESTRICTED	<input type="checkbox"/> INDUSTRIAL <input type="checkbox"/> TRANSPORTATION
		<input type="checkbox"/> NO	<input type="checkbox"/> MILITARY <input type="checkbox"/> OTHER

4 OWNER OF PROPERTY

NAME Mr. and Mrs. G. Laurence Moore

Telephone #:

STREET & NUMBER 2525 Florence Road

Maryland 21797

CITY, TOWN Woodbine

VICINITY OF

STATE, zip code

5 LOCATION OF LEGAL DESCRIPTION

COURTHOUSE, Tax Map 13 blk 3 p. 15

Liber #: 403

REGISTRY OF DEEDS, ETC. Hall of Records

Folio #: 235

STREET & NUMBER Howard County Court House

CITY, TOWN Ellicott City

STATE Maryland

6 REPRESENTATION IN EXISTING SURVEYS

TITLE Howard County Historic Sites Inventory

DATE 1978-1979

 FEDERAL STATE COUNTY LOCAL

DEPOSITORY FOR SURVEY RECORDS Maryland Historical Trust

CITY, TOWN 21 State Circle, Annapolis

STATE Maryland

7 DESCRIPTIONHO-274
Woodbine Quad
Dist. 4

CONDITION		CHECK ONE	CHECK ONE
<input type="checkbox"/> EXCELLENT	<input type="checkbox"/> DETERIORATED	<input type="checkbox"/> UNALTERED	<input checked="" type="checkbox"/> ORIGINAL SITE
<input checked="" type="checkbox"/> GOOD	<input type="checkbox"/> RUINS	<input checked="" type="checkbox"/> ALTERED	<input type="checkbox"/> MOVED DATE _____
<input type="checkbox"/> FAIR	<input type="checkbox"/> UNEXPOSED		

DESCRIBE THE PRESENT AND ORIGINAL (IF KNOWN) PHYSICAL APPEARANCE

The Hubert Black House, now Larriland Farm, faces west on the northeast corner of Route 94 and Florence Road. It comprises some 250 acres of land on both the east and west sides of Route 94. During the tenure of Hubert Black this property was a dairy farm. Bought circa 1963 by Mr. Lawrence Moore, it was placed under sod and now for the past five or six years has been a farm, where one can pick one's own fruit and vegetables.

The house is a three bay wide, one room deep, two and a half story high, gabled roof (running north-south) frame (covered with clapboard) structure, resting on a stone foundation, with a square brick chimney inset into its south wall and another square brick interior chimney on the north side of the house.

It features a central, intersecting, gable on its west elevation, holding a three light fan light, with scrolled barge boards running along the eave line of the north, south and west elevations, as well as the central intersecting gable. A three bay wide, two bay deep, two story high, intersecting gable roof (running east-west), frame (covered with German siding), east wing, resting on a stone foundation, runs along two thirds of the building's east wall, creating an "L" plan. A square brick chimney is centered onto its east wall.

Fenestration for both sections of the house is rectangular and

double-hung, holding two-over-two lights, with the exception of those on the first and second floors of the main section of the house, the latter of which holds four-over-four lights. All are decorated with shutters and underlined with projecting wooden sills.

THE WEST ELEVATION

The west elevation of the house is essentially a Victorian Cottage. It features tall, floor-to-ceiling first floor windows, which hold two-over-four lights, one of which flanks each side of the central rectangular, cross paneled entrance door, which is flanked by three vertical side lights and surmounted by a three light transom.

Three, segmental arched, double-hung, second floor windows are vertically aligned and proportionally scaled to the openings below. Three wide, brick steps lead to the wooden landing of a one story high, hipped roof, open porch, running along the entire west and south elevations, held by eight square posts and supported by a series of square stone piles. Four wooden steps lead to its south landing. A section on the east side of the south wall is screened in. The porch's west wall features scrolled barge boards, matching those of the house. Those on the south elevation of the main section have been cut off.

THE NORTH AND SOUTH ELEVATIONS OF THE WEST WING

The window treatment for these two walls are identical, on the second floor and attic, holding two four-over-four light, rectangular, second floor windows and a three light, attic fan light, which matches that of the intersecting, west gable. The scrolled barge boards along the gable roof line are also identical features.

No porch runs along the north elevation, however, and thence, its first floor windows are not as tall and hold two-over-two lights. The open porch, however, does run along its south elevation and so its two first floor windows match those on the west elevation. Four wooden steps lead to the landing along this south wall.

THE SOUTH ELEVATION OF THE EAST WING

A rectangular, cross paneled entrance door, surmounted by a two light transom, rests in the west bay of this section, with a second floor, rectangular, vertically aligned, two-over-two light window above. East of this door rests a rectangular, two-over-two light, first floor window, proportionally scaled and vertically aligned to one above.

Another cross paneled entrance door, covered by the screened in section of the porch, rests at the east end of this wall and

is also vertically aligned to a second floor window, similar to those described.

THE EAST WALL OF THE EAST WING

Three wide brick steps lead to the rectangular, screened-in entrance door for the screen porch. A cellar door is located on the south side of the stone foundation of this east wall. Two first and second floor, vertically aligned, proportionally scaled windows rest above. The first floor windows hold two-over-two lights and those on the second floor nine-over-six.

THE EAST WALL OF THE WEST WING

The east wall of this wing holds a first and second floor window in its north bay. Its central bay holds a rectangular, cross paneled entrance door, surmounted by a three light transom with a second floor, four-over-four light window above.

THE NORTH ELEVATION OF THE EAST WING

The north elevation of the east wing holds two first floor, two-over-two light, rectangular windows in its two west bays. A similar, rectangular, second floor window rests in the second west bay with a rectangular, second floor entrance in the west bay. The second floor entrance leads on to the second floor of a two

story high, shed roofed, open porch, constructed along this entire north wall. The east half of this porch has been enclosed with its north wall, holding a two-over-two light, first and second floor window. Its west wall holds a rectangular, first floor entrance, surmounted by a one light transom. Its east wall is an extension of the gable line of the east wing, lying flush with its east wall. It holds a one-over-one light, rectangular, first floor window, with a square, two-over-two light, double-hung, second floor window above.

East of the house is a one story high, gabled roof (running north-south) log, smoke house, as well as a shed, two barns and other auxiliary buildings associated with the operation of Larri-land Farm.

8 SIGNIFICANCE

HO-274
Woodbine
Dist. 4

PERIOD	AREAS OF SIGNIFICANCE -- CHECK AND JUSTIFY BELOW				
—PREHISTORIC	—ARCHEOLOGY-PREHISTORIC	—COMMUNITY PLANNING	—LANDSCAPE ARCHITECTURE	—RELIGION	
—1400-1499	—ARCHEOLOGY-HISTORIC	—CONSERVATION	—LAW	—SCIENCE	
—1500-1599	X AGRICULTURE	—ECONOMICS	—LITERATURE	—SCULPTURE	
—1800-1899	X ARCHITECTURE	—EDUCATION	—MILITARY	—SOCIAL/HUMANITARIAN	
—1700-1799	—ART	—ENGINEERING	—MUSIC	—THEATER	
—1800-1899	—COMMERCE	—EXPLORATION/SETTLEMENT	—PHILOSOPHY	—TRANSPORTATION	
—1900-	—COMMUNICATIONS	—INDUSTRY	—POLITICS/GOVERNMENT	—OTHER (SPECIFY)	Local History
		—INVENTION			

SPECIFIC DATES circa 1860

BUILDER/ARCHITECT

STATEMENT OF SIGNIFICANCE

The Hubert Black House is a good example of vernacular, frame, domestic architecture, with elements of the Victorian Style, dating back to the mid-nineteenth century. In addition, the property has been agriculturally significant as a working farm from that time² associated with the Black, Warfield and Jarden families of Howard County.³

Explanatory Notes

1. Architecturally, this frame farmhouse is an interesting composite, constructed in a typical "L" plan, but containing stylistic features of the Victorian and Italianate on its front facade. This is seen in its floor to ceiling first floor windows, which are sheltered by a one story high, hipped roof, open porch, decorated with gingerbread along its eave line. This porch runs along the entire west facade and almost all its south elevation. The second floor windows are arched, a very nice feature of this facade, which also features a central, intersecting, attic gable, decorated with matching gingerbread. An addition appears to have been constructed on the east elevation, which does not destroy the basic integrity of the house, but extends the east wing of the "L" and partially

encloses a two story high, open porch along the north elevation. Although typical in plan and materials to many frame farm houses in Howard County, its stylistic detail, fine proportions and proportionally scaled, arched fenestration lend it distinction.

2. This building is set upon a tract of land of some 250 acres which has been farmed since the mid-nineteenth century. The Black family owned the property from 1883 to 1963 and ran cattle. J. Hubert and Ada J. Black sold the farm in 1963 to C. Lawrence Moore, who initially stored hay here and planted sod, but for the past five years has had a "Pick Your Own Fruits and Vegetables" operation. Ninety of the 250 acres are given over to this.

Larriland Farm is now a part of an agricultural district in the Maryland Agricultural Land Preservation Program. This program prevents the subdividing of farm land, while the property is within the agricultural district and helps to insure the continuance of Maryland's working farms.

3. Historically, this property is notable as a part of several contiguous tracts of land, to wit: "Hobson's Choice", "Wise Man's Folly", "Additional Defense", "Range Declined", "Acorn Hill", "Ridgely's Great Park", "The Dispute", and the "Dispute Ended". References in the 1864 deed from J. D. Warfield to Mr. Owings (Howard County Land Records, Liber 23, folio 254) are made to an 1808 deed from John Welsh to Philip Welsh and from Philip Welsh to Thomas Meredith. By 1860 the Warfields owned this property for a building is noted here under the ownership of the "heirs of Mrs. Warfield." In 1864 Mr. J. D. Warfield deeded

this farm to Mr. Owings and after several transactions it was again deeded by him to a Mr. Samuel Jarden. In 1883 it was acquired by Samuel Black of Baltimore City and was owned by this family until 1963. J. Hubert Black, the last of this family to occupy the house was the warden of a prison in Jessup, Maryland.

9 MAJOR BIBLIOGRAPHICAL REFERENCES

Interview with Mrs. Edwin Grawcow,
July 29, 1980
Howard County Land Records

CONTINUE ON SEPARATE SHEET IF NECESSARY

10 GEOGRAPHICAL DATA

ACREAGE OF NOMINATED PROPERTY 250 acres

Please see Attachment 1, Tax Map 13, pg. 35

VERBAL BOUNDARY DESCRIPTION

Please see Howard County Land Records, Liber 403 Folio 235

LIST ALL STATES AND COUNTIES FOR PROPERTIES OVERLAPPING STATE OR COUNTY BOUNDARIES

STATE Maryland COUNTY Howard

STATE _____ COUNTY _____

11 FORM PREPARED BY

NAME / TITLE

Cleora Barnes Thompson, Archivist

ORGANIZATION

Office of Planning & Zoning-Comprehensive Planning Section

DATE

STREET & NUMBER

3450 Court House Drive

TELEPHONE

CITY OR TOWN

Ellicott City

STATE

Maryland

The Maryland Historic Sites Inventory was officially created by an Act of the Maryland Legislature, to be found in the Annotated Code of Maryland, Article 41, Section 181 KA, 1974 Supplement.

The Survey and Inventory are being prepared for information and record purposes only and do not constitute any infringement of individual property rights.

RETURN TO: Maryland Historical Trust
The Shaw House, 21 State Circle
Annapolis, Maryland 21401
(301) 267-1438

TITLE SEARCH
 HO-274 Hubert Black House
 Prepared By Cleora B. Thompson, A.I.C.P.

<u>DATE</u>	<u>LIBER-FOLIO</u>	<u>GRANTOR</u>	<u>GRANTEE</u>	<u>TRANSACTION</u>
July 6, 1963	403-235	J. Hubert Black & Ada J. Black	G. Laurence Moore and Nancy S. Moore	Deed to 250 Acres
		Walter E. Black & Margaret R. Black, Margaret B. Pels, widow A. Evelyn Black, unnm.		
		"upon which Samuel Black, his son, Walter S. Black and his grandson, the said J. Hubert Black and their families, have resided for many years - ref. to a survey made in Nov. 1880. Walter S. Black died in Dec. 4, 1945 intestate -leaving widow, Katherine and 4 children (1) J. Hubert Black, (2) Walter B. Black, (3) Margaret B. Pels, and (4) Evelyn Black."		
June 15, 1889	54-602	Samuel Black & wife	Walter S. Black	Deed to 253 3/4 Acres with exceptions - (1) 1871 - 31-373 (2) 1872 - 33-131 "Florence School House" (3) 1883 - 46-617 (4) 1887 - 52-556 (5) 1895 - 63-35 (6) 1923 - 118-162 (7) 1923 - 118-515
Oct. 29, 1883	47-178	Samuel Jarden and Amelia Jarden	Samuel Black of Baltimore City	Deed tp 253 3/4 Acres with exceptions for \$14,000
Jan. 27, 1872	31-383	Mary T. Ligon & T. Watkins Ligon	Samuel Jarden	Deed
	30-197	Joshua D. Warfield	Samuel Jarden	Deed
	30-183	Joshua D. Warfield	Samuel Jarden	Deed

TITLE SEARCH
 HO-274 Hubert Black House
 Prepared By Cleora B. Thompson, A.I.C.P.

<u>DATE</u>	<u>LIBER-FOLIO</u>	<u>GRANTOR</u>	<u>GRANTEE</u>	<u>TRANSACTION</u>
Dec. 1, 1869	29-489	Joshua D. Warfield	Samuel Jarden	Deed for \$2,500
		"being the parcel of land and premises conveyed by J. D. Warfield to Mary T. Ligon on Sept. 27, 1867 and which was leased for 5 years to J. D. Warfield with a yearly rent of \$180."		
Sept. 27, 1867	27-291	Mary T. Ligon	J. D. Warfield	Lease
Sept. 27, 1867	27-288	J. D. Warfield	Mary T. Ligon	Deed for \$3,000 for 253 Acres, 2 roods + 20 perches
Mar. 14, 1967	26-351	J. D. Warfield	M.M. Bldg. Association	Mortgage to Mechanic's Mutual Building Association for \$1,365 of 253 Acres + 2 roods, 20 perches
June 18, 1864	23-254	J. D. Warfield	Mr. Owings	Deed to 250 Acres +
		Parts of several contiguous tracts, to wit: "Hobson's Choice", "Wise Man's Folly", "Additional Defense", "Range Declined", "Acorn Hill", "Ridgely's Great Park", "The Dispute", and "The Dispute Ended" References in this mortgage are made to deeds from John Welsh to Philip Welsh on March 1, 1808 and from Philip Welsh to Thomas Meredith		



Attachment 4
 HO-274
 The Hubert Black House
 Martenet Map of 1860



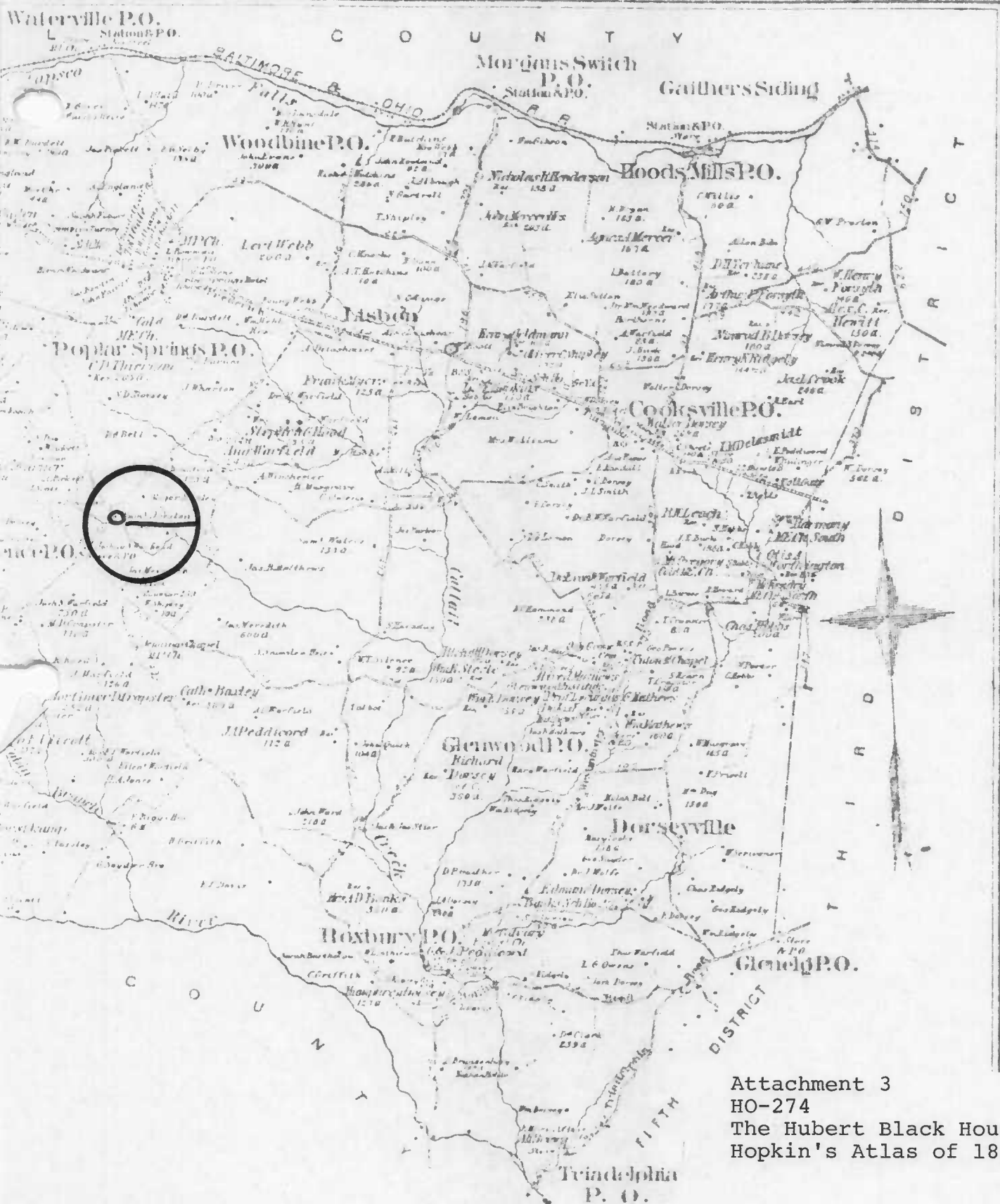

Attachment 3
 HO-274
 The Hubert Black House
 Hopkin's Atlas of 1878

Entered according to act of Congress in the year 1878 by H. Hopkin in Ch...

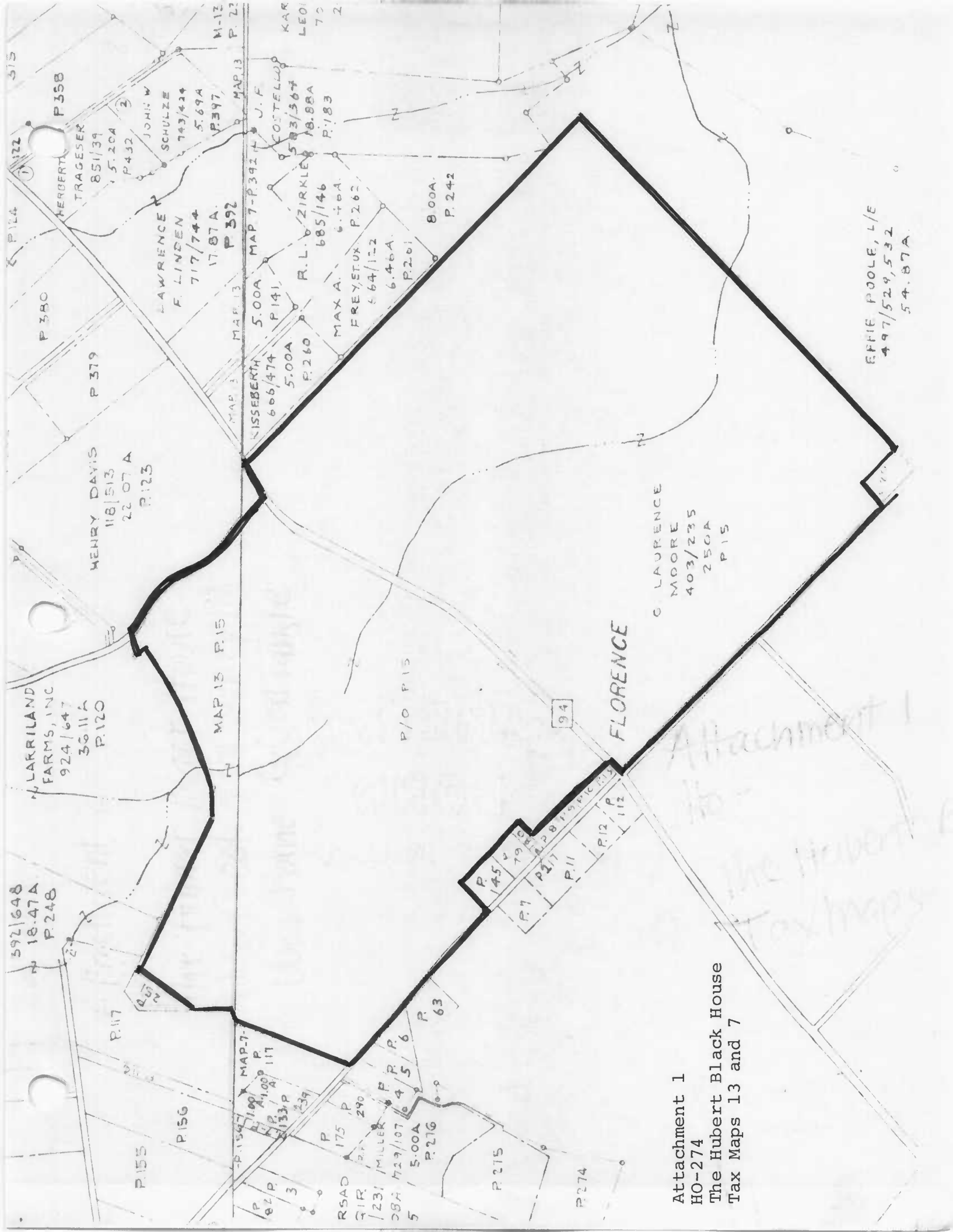

EFFIE POOLE, L/E
 497/529,532
 54.87A

C. LAURENCE
 MOORE
 403/235
 250A
 P.15

Attachment 1
 to
 The Hubert Black House
 Tax Maps

Attachment 1
 HO-274
 The Hubert Black House
 Tax Maps 13 and 7

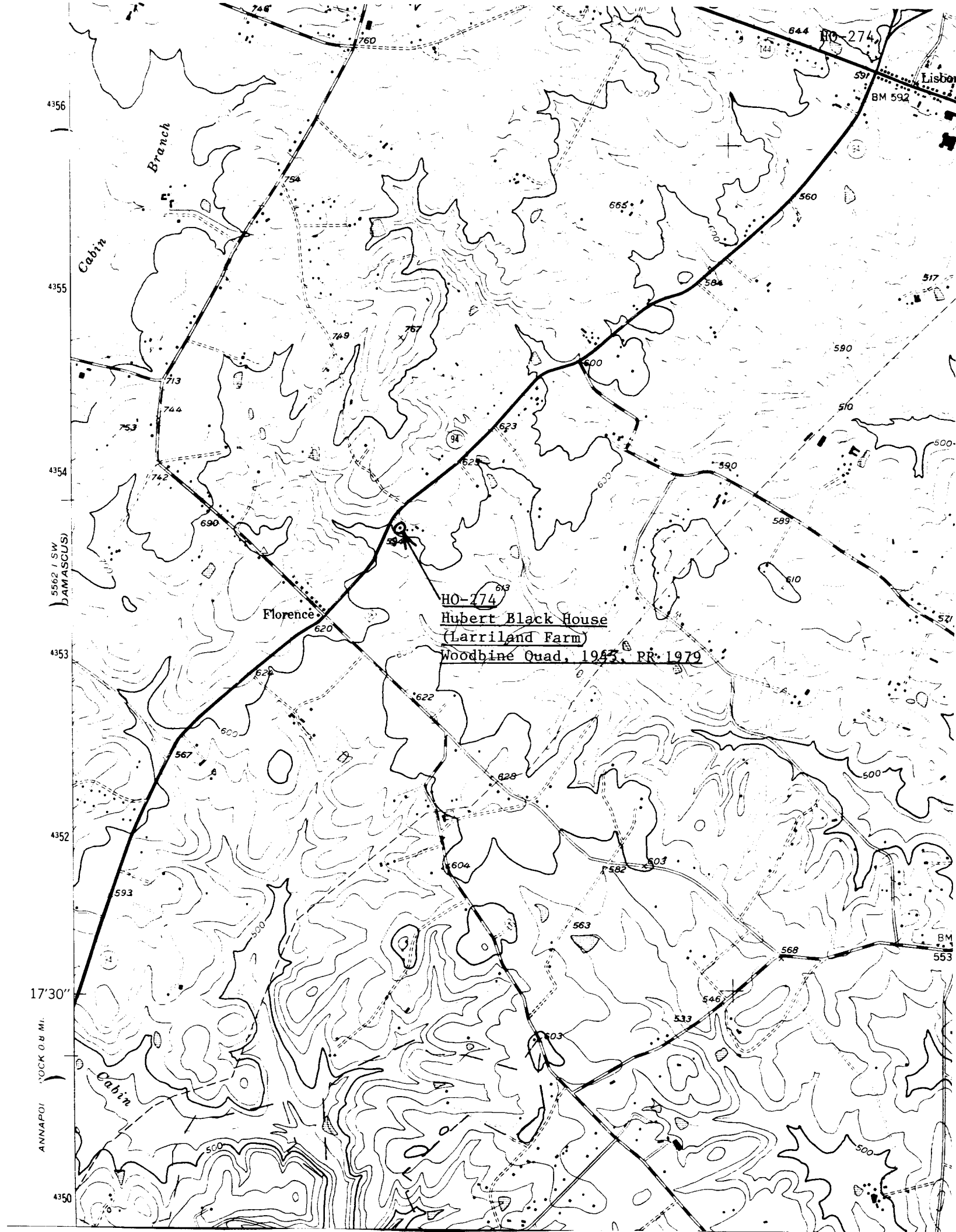

4356
4355
4354
4353
4352
1730'
ANNAPOLIS ROCK O.R. MI.
4350

5562 / SW DAMASCUS

Cabin Branch

Cabin

Florence

HO-274
Hubert Black House
(Larriland Farm)
Woodbine Quad, 1943, RR-1979

Lisbon

BM 553



Name: HO-274
The Hubert Black House
Location: N.E. corner Route .94 and Florence Road
Woodbine, Maryland
Photographer: Cleora B. Thompson, A.I.C.P.
Date of photograph: July, 1980
Negatives in possession of the Maryland Historical Trust
View: West elevation
Photographer looking: East
Photograph number: No. 1 of 1