

corr. copy

HO-266
PHELP'S RESIDENCE/WARFIELD'S RANGE
Laurel
Private

eighteenth and nineteenth
centuries

The Phelp's Residence with its adjoining log cabin is located on the northern most survey of Warfield's Range. (Please see HO-265).

It was built in three clearly defined frame sections. The original house, the present kitchen, is a two story high, two bay wide, one room deep, gabled roof (running north-south) frame structure, placed on a fieldstone foundation whose wide stone south chimney rises from a mammoth blocked fireplace base in the cellar. It at one time may have been a cooking fireplace. Entrances are located on its east and west elevations. At a very early date a single bay was added to the south wall, one room deep, two stories high, gabled roof (running north-south). It rests on a stone foundation but does not have a full basement, but a crawl space. Log beams support its first floor.

The third section of the house forms the L plan, facing south on Gorman Road and constructed by Dr. Thomas Chew Worthington, circa 1845. It is a five bay wide, one room deep, two and a half story high, gable roof (running east-west) frame structure built on a stone foundation with central hall and north and south entrances. Its south entrance is noteworthy, flanked by three side lights and surmounted by a six light transom which extends on either side over the vertical lights. A central intersecting "A" roofed dormer window is flanked by gabled roof dormers, each of which hold roman arched, double-hung windows with two-over-two lights. A one story high, shed roofed porch has been enclosed, lying along the entire east elevation of the north wing.

MARYLAND HISTORICAL TRUST

INVENTORY FORM FOR STATE HISTORIC SITES SURVEY

1 NAME Warfield's Range/"Pilla Terra"/Dr. Thomas Chew Worthington's homestead.
HISTORIC

AND/OR COMMON
Phelp's Residence/Twin Cedars

2 LOCATION

STREET & NUMBER 10504 Gorman Road (now on Patuxent Ridge Way)

CITY, TOWN Laurel VICINITY OF CONGRESSIONAL DISTRICT 6th

STATE Maryland COUNTY Howard

3 CLASSIFICATION

CATEGORY	OWNERSHIP	STATUS	PRESENT USE
<input checked="" type="checkbox"/> DISTRICT	<input type="checkbox"/> PUBLIC	<input checked="" type="checkbox"/> OCCUPIED	<input type="checkbox"/> AGRICULTURE <input type="checkbox"/> MUSEUM
<input type="checkbox"/> BUILDING(S)	<input type="checkbox"/> PRIVATE	<input type="checkbox"/> UNOCCUPIED	<input type="checkbox"/> COMMERCIAL <input type="checkbox"/> PARK
<input type="checkbox"/> STRUCTURE	<input type="checkbox"/> BOTH	<input type="checkbox"/> WORK IN PROGRESS	<input type="checkbox"/> EDUCATIONAL <input checked="" type="checkbox"/> PRIVATE RESIDENCE
<input type="checkbox"/> SITE	PUBLIC ACQUISITION	ACCESSIBLE	<input type="checkbox"/> ENTERTAINMENT <input type="checkbox"/> RELIGIOUS
<input type="checkbox"/> OBJECT	<input type="checkbox"/> IN PROCESS	<input checked="" type="checkbox"/> YES: RESTRICTED	<input type="checkbox"/> GOVERNMENT <input type="checkbox"/> SCIENTIFIC
	<input type="checkbox"/> BEING CONSIDERED	<input type="checkbox"/> YES: UNRESTRICTED	<input type="checkbox"/> INDUSTRIAL <input type="checkbox"/> TRANSPORTATION
		<input type="checkbox"/> NO	<input type="checkbox"/> MILITARY <input type="checkbox"/> OTHER

4 OWNER OF PROPERTY

NAME Mrs. Janet W. Phelps

Home: 725-0737

Telephone #: Office 344-2222(USDA)

STREET & NUMBER
Twin Cedars 10504 Gorman Road

CITY, TOWN Laurel VICINITY OF STATE, zip code Maryland 20810

5 LOCATION OF LEGAL DESCRIPTION

COURTHOUSE, REGISTRY OF DEEDS, ETC. Hall of Records

Liber #: 706
Folio #: 340
Tax Maps 41 and 42, p. 80

STREET & NUMBER
Howard County Court House

CITY, TOWN Ellicott City STATE Maryland

6 REPRESENTATION IN EXISTING SURVEYS

TITLE
Howard County Historic Sites Inventory

DATE 1977 FEDERAL STATE COUNTY LOCAL

DEPOSITORY FOR SURVEY RECORDS Maryland Historical Trust

CITY, TOWN 21 State Circle, Annapolis STATE Maryland

DESCRIPTION

HO-266
District 6

CONDITION		CHECK ONE	CHECK ONE
<input type="checkbox"/> EXCELLENT	<input type="checkbox"/> DETERIORATED	<input type="checkbox"/> UNALTERED	<input checked="" type="checkbox"/> ORIGINAL SITE
<input checked="" type="checkbox"/> GOOD	<input type="checkbox"/> RUINS	<input checked="" type="checkbox"/> ALTERED	<input type="checkbox"/> MOVED DATE _____
<input type="checkbox"/> FAIR	<input type="checkbox"/> UNEXPOSED		

DESCRIBE THE PRESENT AND ORIGINAL (IF KNOWN) PHYSICAL APPEARANCE

The Phelps's Residence is composed of two sections, a south and north section, which form an L plan.

The south section is a five bay wide, two bay deep, two and a half story gabled roof (running east-west) white frame structure, with brick chimneys inset into its east and west walls. A central intersecting gabled roof dormer window lies flush with the south wall and holds a roman arched, double-hung window with two-over-two lights. Gabled roof dormer windows are set into the south elevation of the gable roof on each side of this central gable. They hold similar windows.

A central rectangular open bible and cross paneled door is surmounted by an eight light transom and flanked by four vertical side lights. The entrance faces south and is approached by three wide brick steps. A brick patio lies along the south elevation. Two double-hung rectangular windows holding six-over-six lights are decorated with projecting flat wooden sills, and rest on each side of the entrance. Five second floor windows, vertically aligned and proportionally scaled are similar to the first floor windows.

The east and west walls hold a similar first and second floor window in their north bay and two small rectangular double-hung attic windows with two-over-two lights above.

North Elevation:

The north wall of the house has a first and second floor rectangular window, similar to the others, in its east bay and a similar central bay second floor window.

Springing from the west bay of the north wall is a three bay wide, one bay deep intersecting gabled roof (running north-south) white frame north wing. A giant cornerstone for this section's southeast corner, is located under the one story high shed roofed enclosed porch which runs along its entire east elevation. Large stone pillars with hatch marks support this porch. An early date of construction is also indicated by the hand hewn logs supporting its floor. The basement foundation of the early section also has hand hewn log supporting beams.

Examination of the foundation of the newer south wing section reveals the use of giant granite blocks, while that of the earlier north wing has fewer of these giant granite blocks and more fieldstone.

The shed roofed enclosed porch along the east elevation has a north and east rectangular entrance door and three rectangular double-hung windows with six-over-six lights. Three second floor windows rest in the east wall. A first and second floor window, similar to those described is centered into its north wall. An exterior square brick chimney is located east of these windows. A rectangular cellar entrance lies west.

The west elevation of this section hold a central rectangular door with a first floor rectangular, double-hung window holding six-over-six lights in its north bay and a first floor double window in the south bay, composed of two double-hung rectangular windows with four-over-four lights. Three second floor rectangular windows holding six-over-six lights rest above.

CONTINUE ON SEPARATE SHEET IF NECESSARY

Phelp's Residence - Description
Continued

HO-266
District 6

A large brick chimney is inset into the roof between the south and central bays of the east and west walls. The foundation of the north wing indicates two separate construction periods with a deeply cut root cellar used as the foundation for this frame structure located under the present kitchen in the central and west bays of the east and west walls.

The crawl space beyond this section which is separated by a mammoth stone chimney foundation is under the south bay of the east and west walls and also has hand hewn log supporting beams. This fact indicates a period of early construction circa 1820, for the entire north wing with perhaps an 18th century date for the kitchen section with root cellar foundation. Two interesting log insets into the stone foundation are found on either side of the foundation entrance. It may have been used to pull a log across the door and form a lock.

A peg barn lies northwest and a log cabin (please see HO-265) due north with an Indian mound further north in the woods, surrounding the house which faces Gorman Road, .9 miles east of Route 29.

The interior features random width floors, central hall and staircase, and cross paneled doors.

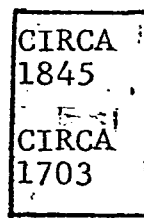
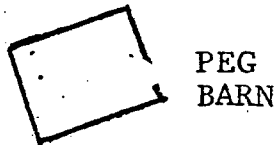

LOG CABIN

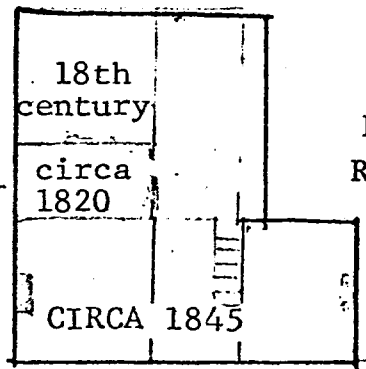

FRAME RESIDENCE

EARLY LOG-
ADDITION

ROUGH SITE PLAN

SIGNIFICANCE

PERIOD	AREAS OF SIGNIFICANCE -- CHECK AND JUSTIFY BELOW			
<input type="checkbox"/> PREHISTORIC	<input type="checkbox"/> ARCHEOLOGY-PREHISTORIC	<input type="checkbox"/> COMMUNITY PLANNING	<input type="checkbox"/> LANDSCAPE ARCHITECTURE	<input type="checkbox"/> RELIGION
<input type="checkbox"/> 1400-1499	<input checked="" type="checkbox"/> ARCHEOLOGY-HISTORIC	<input type="checkbox"/> CONSERVATION	<input type="checkbox"/> LAW	<input type="checkbox"/> SCIENCE
<input type="checkbox"/> 1500-1599	<input type="checkbox"/> AGRICULTURE	<input type="checkbox"/> ECONOMICS	<input type="checkbox"/> LITERATURE	<input type="checkbox"/> SCULPTURE
<input type="checkbox"/> 1600-1699	<input type="checkbox"/> ARCHITECTURE	<input type="checkbox"/> EDUCATION	<input type="checkbox"/> MILITARY	<input type="checkbox"/> SOCIAL/HUMANITARIAN
<input checked="" type="checkbox"/> 1700-1799	<input type="checkbox"/> ART	<input type="checkbox"/> ENGINEERING	<input type="checkbox"/> MUSIC	<input type="checkbox"/> THEATER
<input type="checkbox"/> 1800-1899	<input type="checkbox"/> COMMERCE	<input type="checkbox"/> EXPLORATION/SETTLEMENT	<input type="checkbox"/> PHILOSOPHY	<input type="checkbox"/> TRANSPORTATION
<input type="checkbox"/> 1900-	<input type="checkbox"/> COMMUNICATIONS	<input type="checkbox"/> INDUSTRY	<input type="checkbox"/> POLITICS/GOVERNMENT	<input type="checkbox"/> OTHER (SPECIFY)
		<input type="checkbox"/> INVENTION		

SPECIFIC DATES circa 1820 and 1845 BUILDER/ARCHITECT
and eighteenth century

STATEMENT OF SIGNIFICANCE

Research in the Howard County Hall of Records revealed the following property transactions:

1. 18 Day Dec, 1974 (706-340) Ronald S. Goldberg for estate of Charles A. Phelps to Janet Phelps.
2. May 4, 1965 - 434 596 by Strawman, Inc. to Charles & Janet Phelps.
3. Oct 9, 1939 BM 165-294 by George E Daniel - Chester Gilbert. 226 A. except 96.8/10 A. by deed March 24 1948 203-592 was conveyed to Edith at Glen Wiltroof.
4. June 30, 1937 (157-315) fr. Citizens National Bank, of Laurel to George Daniel
5. August 16, 1933 (146-111) fr. John S. Stanley, Assignee
6. November 29, 1920 (111-349) fr. James W. Baxley to Citizen's National Bank of Laurel Mortgage for \$6,000 of 226 11/16 Acres.
7. July 9, 1900 (72-231) to Ella Baxley.

The mortgage transaction November 29, 1920 of James W. Baxley mentions the 10 1/2 acres conveyed to Arthur Pue Gorman on August 28, 1903 (77-532).. This was a transaction made by the old senator to take care of Mr. Hobbs, father of his manager, and give him a place to live and care for.

An additional transaction shows Ella Baxley conveyed her interest to Joshva W Baxley (husband) June 25, 1915. (99-537).

8. July 1900 72-231 from Bradley and Mary Worthington to Ella H. Baxley & James W. Baxley (heirs and assigns: in fee simple) for \$2,660.

copy

The property is so described in this deed as "Being all those pieces or parcels of land consisting in the aggregate of 236 13/16 acres of land, more or less, which are conveyed in a deed to The said Bradley Worthington from Thomas Worthington Ridgely and Joshua W. Dorsey, exc. & trustees, dated July 9, 1900. 72.-229. It is important to note the following: The land hereby conveyed comprising the farm upon which the late Dr. Thomas Chew Worthington resided in Howard County, Maryland." He was a prominent physician of Baltimore and was a descendent of Captain John Worthington and his Son Charles Worthington (1701-1773) whose second wife was Sarah Chew. The deed goes on to enumerate:

"Together with buildings and improvements thereupon erected, made or being; and all and every, the rights, alleys, ways, waters, privileges, appurtenances and advantages belonging or in anywise appertaining."

Thomas Worthington acquired four pieces of land. The first and largest was acquired on March 17, 1845 consisting of 153 acres and 9 square perches by deed (5-472) from John Warfield of Joshua, trustee for the estate of Charles G. Worthington. The second tract of land, consisting of 80 $\frac{1}{2}$ acres was acquired in March 31, 1862 (22-54) from Benjamin H. Dorsey and William H. Warfield, executors.

The third and fourth transactions consisted of 2 $\frac{3}{4}$ acres on Sept. 1, 1888 from Isabella Magruder and husband (53-494) and 2 acres on April 17, 1869 (29-132) from Seth W. Warfield. This latter transaction probably straightened adjoining property lines.

In tracing the 153 acre tract of land, the first transaction in 1845, we find it was.

Part of a tract called "Broken Land", part of a tract called, "Worthingtons Addition" and part of or the entire tract called "Long and Narrow," lying and being in Howard District of Anne Arundel County which included 147 acres. It also comprised the tract of land known as "Pilla Terra" patented to William Sellman. Originally this tract comprised 23 acres but was found by a subsequent survey to contain only six acres and 90 sq. perches, "together with all and singular the buildings, improvements, ways, waters, water courses etc. A William Sellman born, 1689, is noted in Mr. Stein's book on Howard County.

An examination of the basement reveals what once might have been a roof cellar (below the present kitchen) a place for storage, or prison for slaves. Two built in recesses on either side of the cellar door might have been used to put a log beam across the entrance, preventing recalcitrant slaves egress from the basement.

The original framehouse on this property is the present kitchen with second floor above, which may date from the eighteenth century or early nineteenth century. An addition was built which takes in the remainder of the north wing, and stems from a very early date.

During the tenure of Dr. Thomas C. Worthington, who acquired the property in 1845, the south wing facing Gorman Road was constructed. This section of the house is reminiscent of the romanesque revival which hit American domestic architecture in the mid-nineteenth century.

For these reasons, its historic associations and its architectural composition, this building should be considered for inclusion to the National Register & any future local landmark legislation.

9 MAJOR BIBLIOGRAPHICAL REFERENCES

1. Stein, C.F. Origins and History of Howard County, Maryland. Baltimore, 1972
pp 309, 315.
- Warfield, J.D. Founders of Anne Arundel and Howard Counties, Maryland. Baltimore, 1973.
pp 366, 399, 388, 365.
3. Interview with Mrs. Harwood Owings, Sr.

CONTINUE ON SEPARATE SHEET IF NECESSARY

10 GEOGRAPHICAL DATA

ACREAGE OF NOMINATED PROPERTY 57.907 Acres

Please see Attachment 1
Tax Maps 41 and 42 p. 80.

VERBAL BOUNDARY DESCRIPTION

Please see Attachment 1
Tax Maps 41 and 42 p.80.

LIST ALL STATES AND COUNTIES FOR PROPERTIES OVERLAPPING STATE OR COUNTY BOUNDARIES

STATE	COUNTY
STATE	COUNTY

11 FORM PREPARED BY

NAME / TITLE

Cleora Barnes Thompson, Archivist

ORGANIZATION

Office of Planning & Zoning-Comprehensive Planning Section 465-5000 x257

DATE

STREET & NUMBER

3450 Court House Drive

TELEPHONE

CITY OR TOWN

Ellicott City

STATE

Maryland

The Maryland Historic Sites Inventory was officially created by an Act of the Maryland Legislature, to be found in the Annotated Code of Maryland, Article 41, Section 181 KA, 1974 Supplement.

The Survey and Inventory are being prepared for information and record purposes only and do not constitute any infringement of individual property rights.

RETURN TO: Maryland Historical Trust
The Shaw House, 21 State Circle
Annapolis, Maryland 21401
(301) 267-1438

SELL SR. EWF.
759/220
A.

WESSELL
59/220

1.67A
AD9

11
23A
P.20

MAP 46-P.2
P.21
P.174

COLUMBIA
MD. 196

REPETTO HO. CO.
530/364
7-11A
343
P.401
WELKER 6.15A
717/278
6.21A
363
P.312

FISHER
647/558
S.78A
P.386
A.M. YOUNG, JR. INC.
624/681
S.19A
P.245
R.L. REVER
697/172
S.28A
P.395
CARL
FETCHER
649/523
S.27A
P.395

ALMA MACK
161/415
P.280
S.R.C.
9.01A
P.11

440/295
T.77A
P.7
440/299
10.29A
P.306
3.42
P.16
440/288
4.5A
P.288

KINDLER
307
308
309
HAYES PROP PARTNERSHIP
448/103 - 448/112
43.67A
P.17

BORIS F. KIM W.F.
653/554
10.12A
P.384

Attachment 1
HO-266
Janet Phelps Residence
Tax Maps 41 and 42
800 scale

MAN
RD.
P.252
P.251
P.250
P.249
P.248
P.247
P.246
P.245
P.244
P.243
P.242
P.241
P.240
P.239
P.238
P.237
P.236
P.235
P.234
P.233
P.232
P.231
P.230
P.229
P.228
P.227
P.226
P.225
P.224
P.223
P.222
P.221

MAP 42-P.80
P.257
P.256
P.255
P.254
P.253
P.252
P.251
P.250
P.249
P.248
P.247
P.246
P.245
P.244
P.243
P.242
P.241
P.240
P.239
P.238
P.237
P.236
P.235
P.234
P.233
P.232
P.231
P.230
P.229
P.228
P.227
P.226
P.225
P.224
P.223
P.222
P.221

BD. OF CO. COMM.
498/301
8.77A
P.230
18.16A
P.244

HOWARD CO.
23.18A.
P.140

HOWARD CO.
525/107
36.26A
P.341

MAP 42-P.
BD. OF CO. COMM.
494/320
8.77A
P.230

DEV CORP
400/709
160.28A.
P.54

2.70A
P.380

JANET W PHELPS
706/340
57.91A.
P.80

HOWARD RESEARCH
& DEV. CORP.
406/565
86.8A.
P.327

BD. OF CO. COMM. OF HO. CO.
497/201
59.18A.
P.379

NOAH P. SOWERS
201/418
63.67A.
P.81

ES WILTROUT
203/542
6.8A
P.84

ROUSSEAUHANNA TRANS CO
12.68A
P.82
P.81

BD. OF
OF
67:
3
F

PRINCE

GEORGE

COCK

Sixth District

GENERAL MERCHANT.

A. J. GALL.

Dealer in Groceries, Provisions, Liquors, &c.

Hooversville.

EXPLANATIONS

Dist. & Co. Lines
 County Roads
 Private "
 Turnpike "
 Rail Roads
 Streams
 The figures along the Roads shows the distance in Rods, from junction to junction thereof

Laurel Factory P.O.

Laurel City Factory

Savage Factory Savage P.O.

Attachment 3
 HO-266
 Janet Phelps's Residence
 Hopkin's Atlas
 District 6
 1878

GUILFORD DISTRICT

HOWARD COUNTY

Scale 2 1/4 inches per Mile

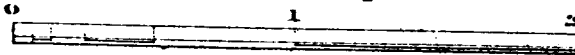

Entered according to act of Congress in the year 1878 by G. M. Hopkins in the Office of the Librarian of Congress at Washington.

Attachment 2
H0-266
Janet Phelp's Residence
U.S. Geological Survey Map
Savage, Maryland Quad

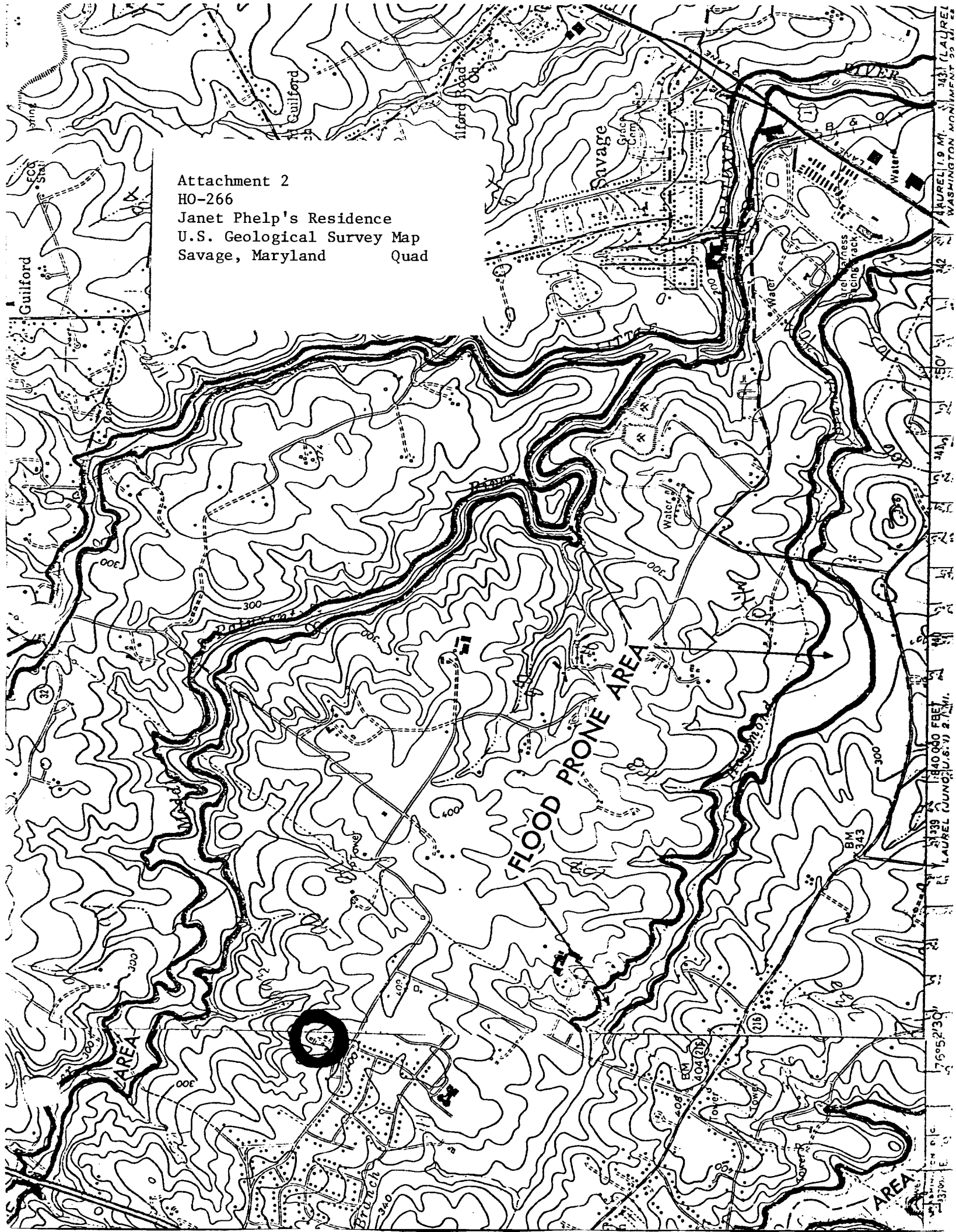

LAUREL 1.9 M. (LAUREL WASHINGTON MONUMENT 90 21 22 31)
31
32
33
34
35
36
37
38
39
40
41
42
43
44
45
46
47
48
49
50
51
52
53
54
55
56
57
58
59
60
61
62
63
64
65
66
67
68
69
70
71
72
73
74
75
76
77
78
79
80
81
82
83
84
85
86
87
88
89
90
91
92
93
94
95
96
97
98
99
100
101
102
103
104
105
106
107
108
109
110
111
112
113
114
115
116
117
118
119
120
121
122
123
124
125
126
127
128
129
130
131
132
133
134
135
136
137
138
139
140
141
142
143
144
145
146
147
148
149
150
151
152
153
154
155
156
157
158
159
160
161
162
163
164
165
166
167
168
169
170
171
172
173
174
175
176
177
178
179
180
181
182
183
184
185
186
187
188
189
190
191
192
193
194
195
196
197
198
199
200
201
202
203
204
205
206
207
208
209
210
211
212
213
214
215
216
217
218
219
220
221
222
223
224
225
226
227
228
229
230
231
232
233
234
235
236
237
238
239
240
241
242
243
244
245
246
247
248
249
250
251
252
253
254
255
256
257
258
259
260
261
262
263
264
265
266
267
268
269
270
271
272
273
274
275
276
277
278
279
280
281
282
283
284
285
286
287
288
289
290
291
292
293
294
295
296
297
298
299
300
301
302
303
304
305
306
307
308
309
310
311
312
313
314
315
316
317
318
319
320
321
322
323
324
325
326
327
328
329
330
331
332
333
334
335
336
337
338
339
340
341
342
343
344
345
346
347
348
349
350
351
352
353
354
355
356
357
358
359
360
361
362
363
364
365
366
367
368
369
370
371
372
373
374
375
376
377
378
379
380
381
382
383
384
385
386
387
388
389
390
391
392
393
394
395
396
397
398
399
400
401
402
403
404
405
406
407
408
409
410
411
412
413
414
415
416
417
418
419
420
421
422
423
424
425
426
427
428
429
430
431
432
433
434
435
436
437
438
439
440
441
442
443
444
445
446
447
448
449
450
451
452
453
454
455
456
457
458
459
460
461
462
463
464
465
466
467
468
469
470
471
472
473
474
475
476
477
478
479
480
481
482
483
484
485
486
487
488
489
490
491
492
493
494
495
496
497
498
499
500
501
502
503
504
505
506
507
508
509
510
511
512
513
514
515
516
517
518
519
520
521
522
523
524
525
526
527
528
529
530
531
532
533
534
535
536
537
538
539
540
541
542
543
544
545
546
547
548
549
550
551
552
553
554
555
556
557
558
559
560
561
562
563
564
565
566
567
568
569
570
571
572
573
574
575
576
577
578
579
580
581
582
583
584
585
586
587
588
589
590
591
592
593
594
595
596
597
598
599
600
601
602
603
604
605
606
607
608
609
610
611
612
613
614
615
616
617
618
619
620
621
622
623
624
625
626
627
628
629
630
631
632
633
634
635
636
637
638
639
640
641
642
643
644
645
646
647
648
649
650
651
652
653
654
655
656
657
658
659
660
661
662
663
664
665
666
667
668
669
670
671
672
673
674
675
676
677
678
679
680
681
682
683
684
685
686
687
688
689
690
691
692
693
694
695
696
697
698
699
700
701
702
703
704
705
706
707
708
709
710
711
712
713
714
715
716
717
718
719
720
721
722
723
724
725
726
727
728
729
730
731
732
733
734
735
736
737
738
739
740
741
742
743
744
745
746
747
748
749
750
751
752
753
754
755
756
757
758
759
760
761
762
763
764
765
766
767
768
769
770
771
772
773
774
775
776
777
778
779
780
781
782
783
784
785
786
787
788
789
790
791
792
793
794
795
796
797
798
799
800
801
802
803
804
805
806
807
808
809
810
811
812
813
814
815
816
817
818
819
820
821
822
823
824
825
826
827
828
829
830
831
832
833
834
835
836
837
838
839
840
841
842
843
844
845
846
847
848
849
850
851
852
853
854
855
856
857
858
859
860
861
862
863
864
865
866
867
868
869
870
871
872
873
874
875
876
877
878
879
880
881
882
883
884
885
886
887
888
889
890
891
892
893
894
895
896
897
898
899
900
901
902
903
904
905
906
907
908
909
910
911
912
913
914
915
916
917
918
919
920
921
922
923
924
925
926
927
928
929
930
931
932
933
934
935
936
937
938
939
940
941
942
943
944
945
946
947
948
949
950
951
952
953
954
955
956
957
958
959
960
961
962
963
964
965
966
967
968
969
970
971
972
973
974
975
976
977
978
979
980
981
982
983
984
985
986
987
988
989
990
991
992
993
994
995
996
997
998
999
1000



DIORNA BARBER THOMPSON
FARMING COMPANY
LAWRENCE, MISSOURI

HO-266

THELPS RESIDENCE

JUNE-1977