

Brooks

Tax. May 10

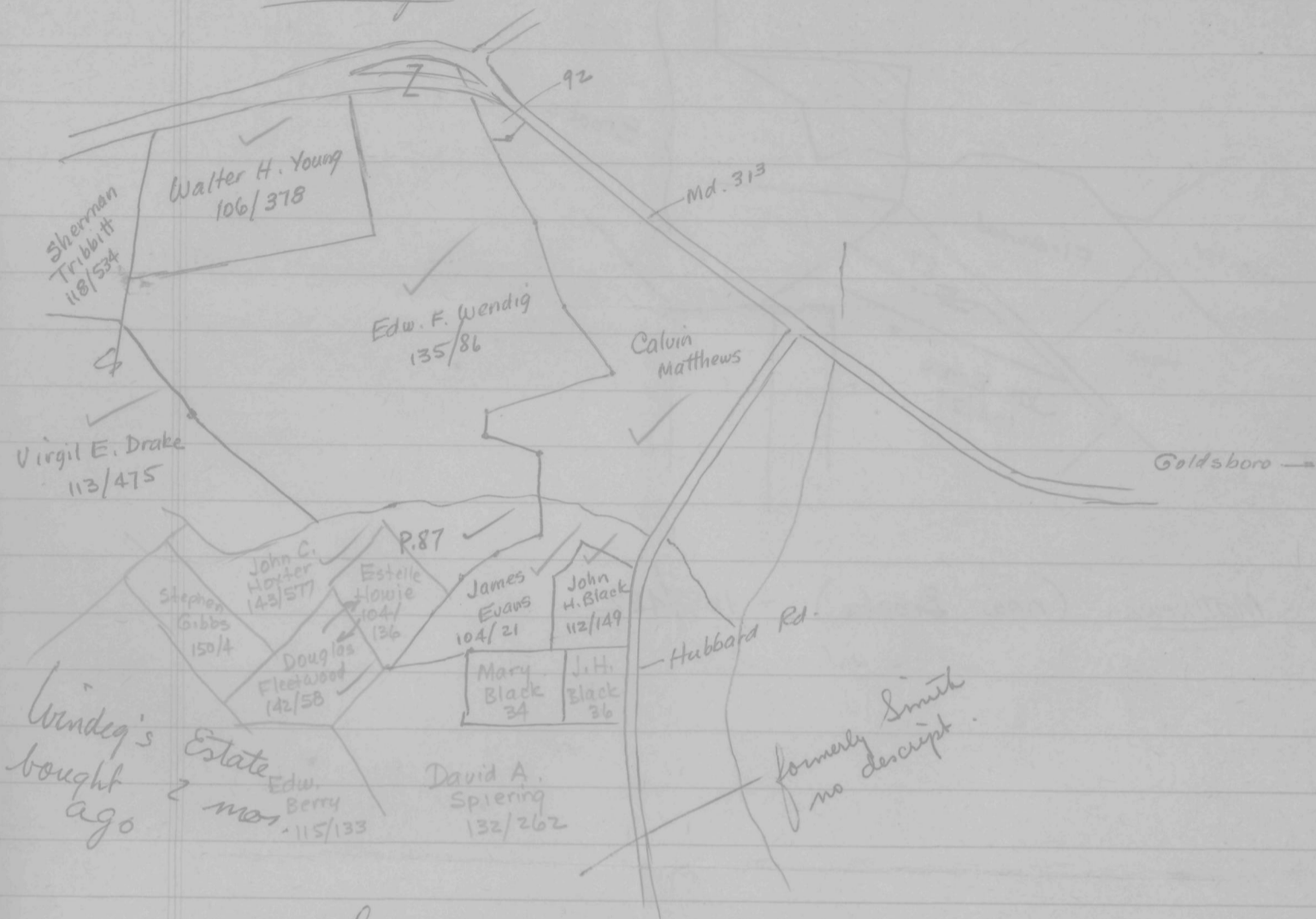

87 - George E. Kleean 159/275 1.003  
 does not apply

\* Matthews, W.D. 74/254 & 79/330 8.00

Fleetwood

Parcel 2 - Begin at stone at cor. of James Henry lot  
 on line of Jos. Ross - N47 1/2° E - 264.0 to lge. gum

N45° E - 12<sup>198</sup> to gum

N75 1/2° E - 16<sup>264.0</sup>

N81 1/2° E - 9<sup>148.5</sup>

S71 1/2° E - 6<sup>99.0</sup>

N78 1/2° E - 6<sup>99.0</sup>

S16 1/2° E - 12<sup>198</sup>

\* S47 1/2° W - 53.5<sup>882.75</sup> to stone

N42 1/2° W - 28<sup>462.0</sup> to begin

9 acres.

165	165
99	33
264	198

825
49.5
8.25
<u>882.75</u>

330
132
<u>462</u>



