

No. 6045 County

Exhibit No. 4.

Nov 1<sup>st</sup> 1892

Part of a tract of land called "Bear Swamp Forest" beginning at a heap of stones at a poplar tree, it being the beginning of the seventh line of the whole tract called "Bear Swamp Forest" it being also the end of the eighth line of the deed from Alexander Mitchell and wife to Samuel Palmer, and running thence with the 7<sup>th</sup> line of "Bear Swamp Forest" S 12° W 83<sup>33</sup>/<sub>100</sub> ft to a stone pile and rock, thence S 81° E 58 ft then N 21<sup>1</sup>/<sub>2</sub>° E 43<sup>7</sup>/<sub>100</sub> ft, then S 65° E 16 ft then N 72° E 34<sup>7</sup>/<sub>100</sub> ft to the beginning of a tract of land called "Littworth". Thence N 78° E 57<sup>3</sup>/<sub>100</sub> ft on the top of a rock then N 9° W 90 ft to the west side of the Public Road, then in pairs or odd N 7<sup>1</sup>/<sub>2</sub>° E 26 ft, N 4<sup>1</sup>/<sub>2</sub>° W 23<sup>7</sup>/<sub>100</sub> ft, S 75° W 14<sup>3</sup>/<sub>100</sub> ft, S 1<sup>1</sup>/<sub>2</sub>° W 29<sup>1</sup>/<sub>100</sub> ft, S 85<sup>1</sup>/<sub>2</sub>° W 31<sup>7</sup>/<sub>100</sub> ft, N 82° W 19<sup>7</sup>/<sub>100</sub> ft to a planted Stone thence S 18° W 60<sup>7</sup>/<sub>100</sub> ft to the beginning containing 86<sup>1</sup>/<sub>4</sub> acres of land more or less.

John Hoogle  
Surveyor

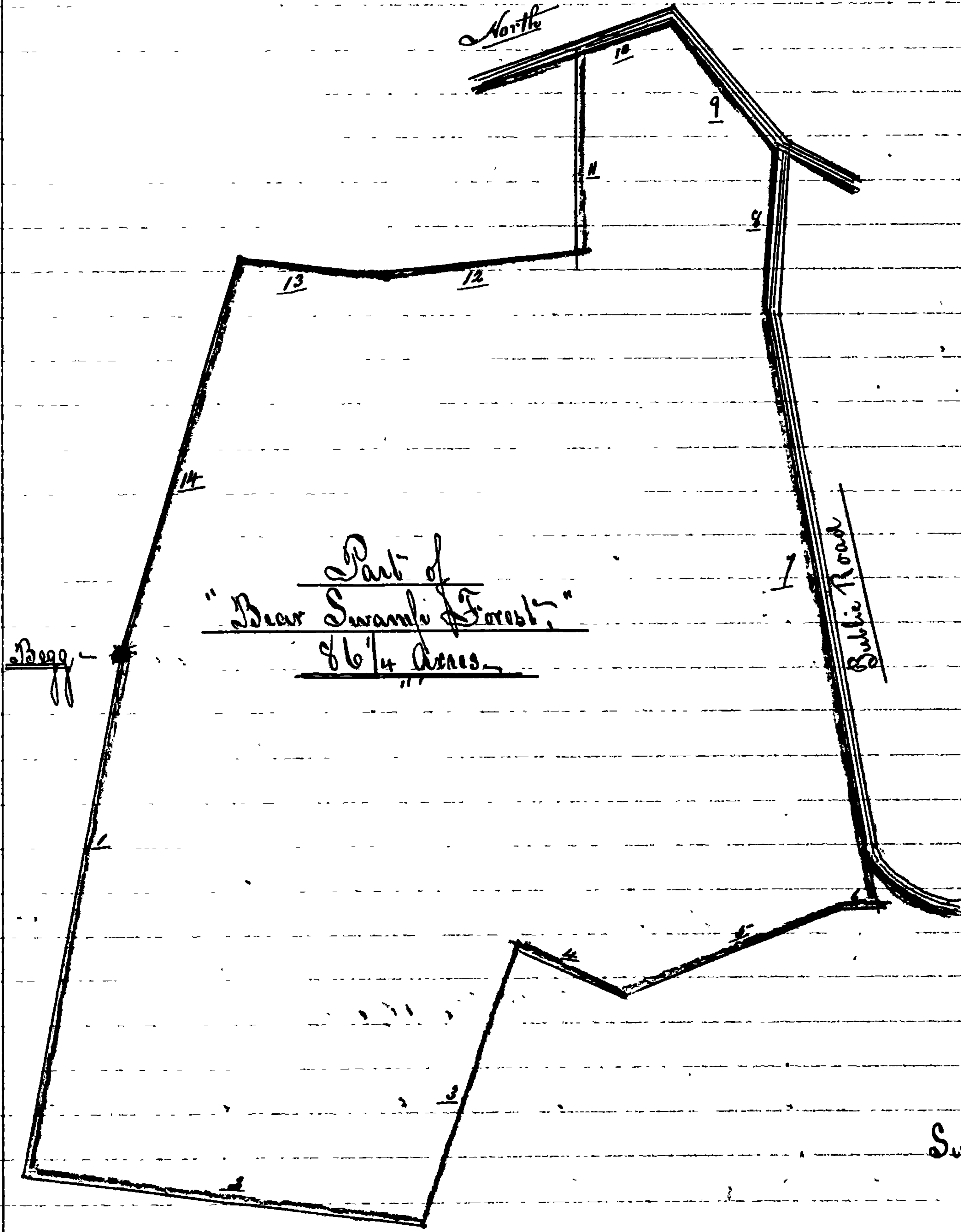

Surveyed Nov 1<sup>st</sup> 1892  
John Hoogle