

No. 5331 Equity

Order nisi

Order nisi on Sales

Robert Todd and
Mabel Todd his wife et al

Elizabeth Rontzsch
Daniel H. Rontzsch et al

No 5331 Equity.
In the Circuit Court for Frederick County
sitting in Equity
January Term 1890

In the matter of the Report of Sales filed the 21st day of January 1890.
Ordered that on the 15th day of February 1890 the Court will proceed to
act upon the Report of Sales of real estate, reported to said Court by John C.
Mottet and Milton G. Warner Trustees, in the above cause and filed therein as
aforesaid, to finally ratify and confirm the same, unless cause to the contrary
thereof be shown before said day - Provided a copy of this order be inserted
in some newspaper published in Frederick County for three successive weeks
prior to said day

The Report states the amount of Sales to be \$2520.

Dated this 21st day of January 1890

Examiner

Wm Irving Parsons
Clerk of the Circuit Court for Frederick County

Print. Certs

Office of the Examiner Frederick Md. February 15. 1890

This is to certify that the annexed Order nisi was published in
"The Examiner" a newspaper published in Frederick County once a week
for three successive weeks prior to the 15th day of February 1890.

Keifer & Krauff

(Filed February 15. 1890)

Fund Redemption

Ordered by the Court on this 15th day of February 1890 that the above stated
be and the same are hereby finally ratified and confirmed, no cause to
the contrary being shown, although it appears that the notice required
in the previous Order has been given and the Trustees are authorized
to receive all the purchase money from either of said purchasers -
and the papers are hereby referred to the auditor to state an account

John A. Lynch
Judge of the Cir Court

(Filed February 15 1890)

Plat and
Certificate

- Course from A
- 1 S 27 1/2 W 15 10 1/2
 - 2 N 63 1/2 W 28 6
 - 3 N 74 W 7.9
 - 4 N 67 W 215.9
 - 5 N 19 3/4 E 17.2
 - 6 S 67 E 225.
 - 7 S 64 3/4 E 28.6
 - 8 S 27 1/2 W 1 4 1/2
- to Beginning

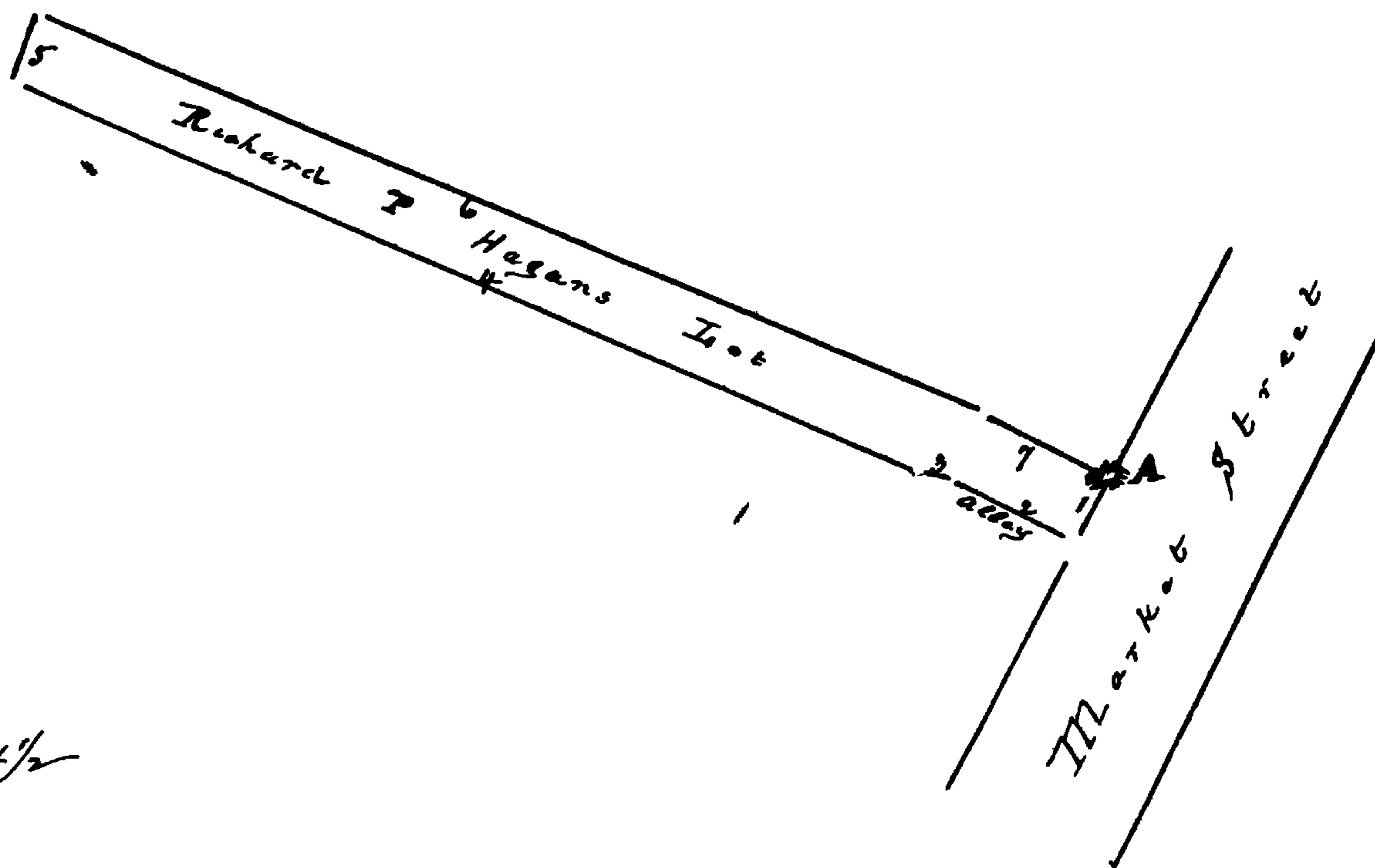

Certificate

Auditors
Report