

No. 4770 Equity.

Exhibit No. 7

Lot No. 1 to No. 10, inclusion front on the Harpersferry Road each 30 feet, and at the back end 25 feet. All the lots have a depth of 130 feet more or less.

No. 11 front on Harpersferry Road 32 feet more or less, and at the back end 24 feet more or less, and back 130 feet more or less.

Filed March 1, 1882

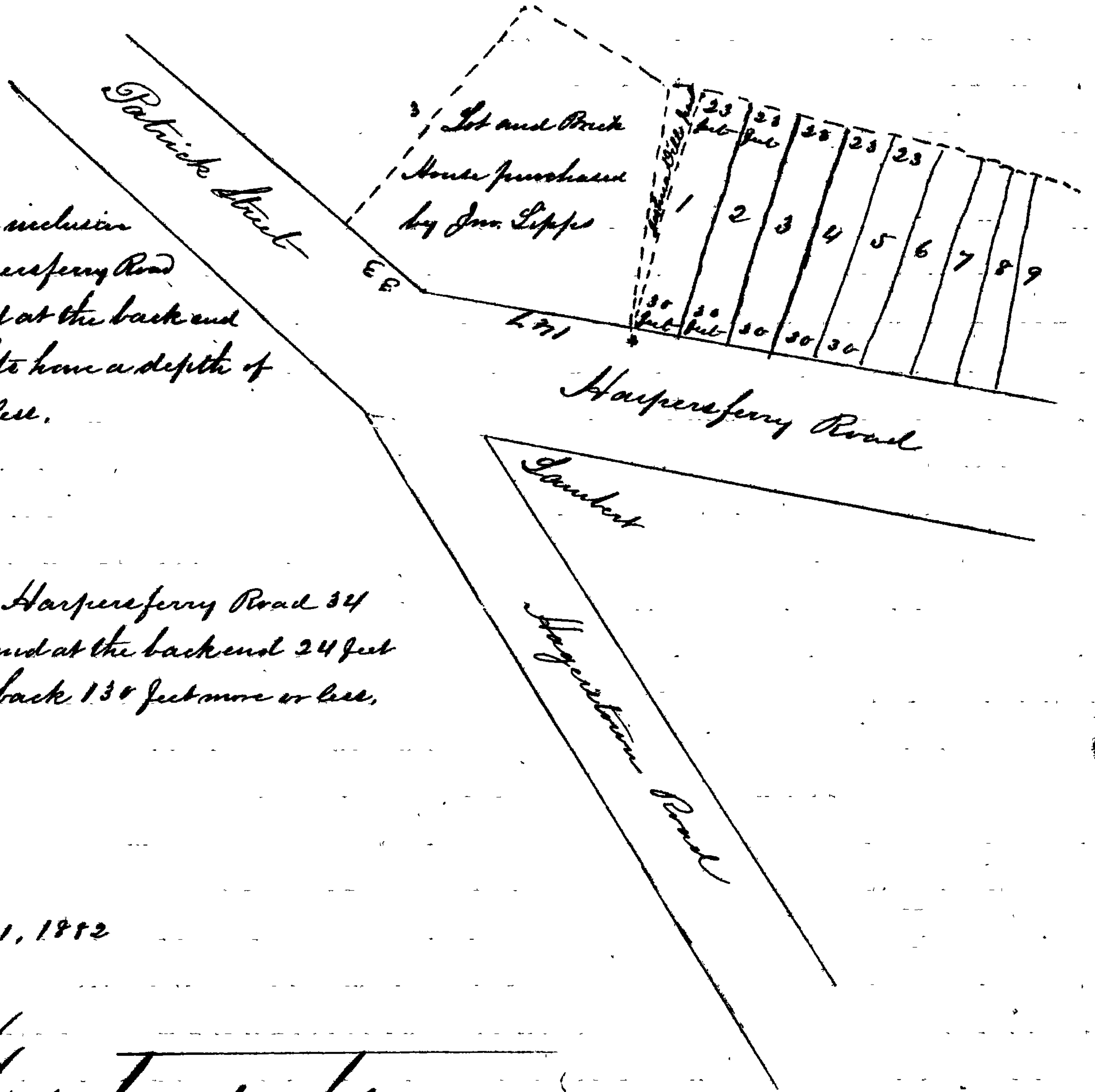

Maryland, ss

The State of Maryland.

To Catharine Lippe widow of John George Lippe and Catharine E. Lippe of Frederick County.

Greeting. You are hereby commanded that all expenses set apart, you personally appear before the Judges of the Circuit Court for Frederick County, sitting as a Court of Equity, to be held at the Court House in Frederick Town, in and for said County, on the second Monday of May next, to answer the bill and complaint of John A. C. Lippe and Eleanor Lippe his wife, Cornelius J. Main and Sophia B. Main his wife and others, against you in said Court exhibited, and so forth.

Hereof fail you not, as you will answer the contrary at your peril.

Witness, the Hon. John Ritchie, Chief Judge of the said Court, the 20 day of February A. D. 1882.

Issued the first day of March, A. D. 1882.

To the Sheriff of Frederick County.

Adolphus Fairbake Jr. Clerk

Rose

Endorsed - "Summoned"

Robert Parrick

Sheriff.

Filed March 6th 1882

Subpoena



Copy to ill. mill print

Copy to ill. app. ill.