

No. 4430, Equity

(Scale of 3 Equal parts)

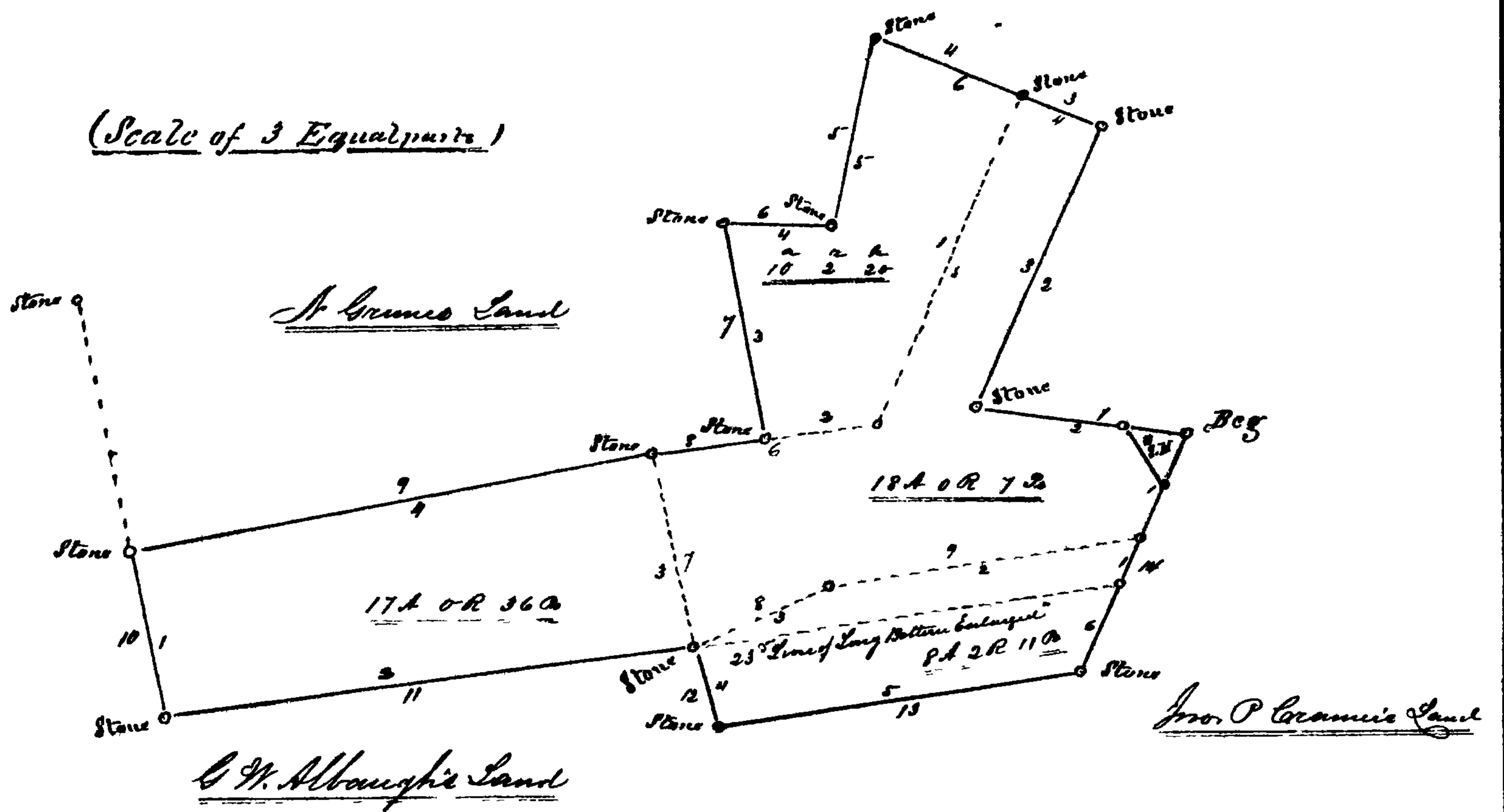

a	r	p	
8	2	11	
18	5	7	
10	2	20	
17	0	36	
54	1	34	Total of Meas.
53	3	16 1/2	Measured by Survey
<hr/>			
2	17 1/2		Acres

Whole tract measured	53	3	16 1/2
School House Lot	0	1	01
In the clear as hereby returned	53	2	15 1/4

Filed Nov 13, 1878

Plat of Lands of Mich. Hoyle dec'd

Petition of John Vingling

To the Honorable the Judges of the Circuit Court for Frederick County, in Equity,
 The Petition of John Vingling of Frederick County, State of Maryland respectfully shows to your Honors that your Petitioner purchased of Michael Hoyle Trustee in No. 4430, Equity, in the Circuit Court for Frederick County in Equity, the farm containing fifty three and a half acres, more or less, at and for the sum of Fifty two dollars per acre, and upon the terms of sale as prescribed by the Decree, that said sale was duly reported by said Trustee, but has never yet been ratified by your Honorable Court.

Your Petitioner states that he purchased said Land in good faith, and expected to comply with the terms of sale, but your Petitioner now states that from circumstances over which he has no control, he is now unable to comply with the terms of said sale.

Your Petitioner states that after said sale he took possession of said property and commenced the cultivation of the same, and has expended considerable labor, and some little money in improving said property.

And your Petitioner further states that he is willing that your Honors shall pass an order rescinding said sale - and agrees to give possession of the same whenever demanded, and he prays your Honorable Court to pass an order rescinding said sale.

And said Petitioner further represents that Michael Hoyle, the said Trustee is willing to rent the property aforesaid to your Petitioner upon such terms of renting as may be agreed upon between them until the 1st day of April 1880, and he prays your Honors to pass an order directing said Trustee to rent the property mentioned in these proceedings to your Petitioner upon a share renting of the half of the produce raised, with the right to your Petitioner to put out a full crop of grain. Your Petitioner praying to give possession of the property on the 1st April 1880

John Vingling

ing
 Flat
 Land
 enlarged
 and
 the
 total
 same
 words
 said
 viz -
 a stone
 by Spring
 and
 color
 lines
 a stone
 the deed
 with line
 in
 a and
 date
 of said
 case
 indeed
 1/2 to a
 called
 acres
 and con-
 among
 with
 planted
 line
 acres and
 eto fore
 County
 and
 but
 the Ex-
 succed-