

in order to agree with the former location. (1) N 34° E 130 paces to a stone formerly planted (2) North 67° E 82 paces to a stone formerly planted and a corner (3) N 34° E 118 paces to the beginning of one acre lot part of 'Gandy Garden' and 'Little did I think it' which was conveyed by Adam Thomas & wife to Dennis J. Thomas by deed dated June 18th 1828 and running thence with the western of said lot around (4) South 53° West 8 paces (5) N 54° E 20 paces (6) S 54° E 8 paces to the end of the 1st line of said lot, it being also the end of 38 paces on the 2nd line of the 'Runway of Hope' and thence with said line connecting as aforesaid (7) N 34° E 53 paces to the end of 91 paces on said 2nd line, it being also the beginning of 93 1/2 acres part of 'Dennis Beginning' part of 'Gandy Garden' and part of 'Little did I think it' which was conveyed by the representatives of Dennis Jacob to Adam Thomas and wife by deed dated March 7th 1801 and recorded in Liber 47. P. 20 folio 506 one of the Land Records of Frederick County, and running thence with the closing line of said deed by it over bears (8) North 83° West 138 1/2 paces to the beginning of said line, it being the end of 46 paces on the 4th line of the aforesaid 82 acre parcel, and with said line connecting the same for location (9) N 27° E 165 paces to the end thereof - still with the western of said 82 acre parcel (10) South 86° West 89 paces to a stake and pile of stones formerly put up (11) S 33° E 60 paces to a stake and pile (12) S 9° E 78 paces to a stake and pile (13) S 49° W 31 1/2 paces to a stone formerly planted for the end of the 3rd line of Lot No. 7 part of 'New Bremen', thence with said line around as it now bears (14) S 42° E 108 1/2 paces to the first mentioned place of beginning containing 165 1/4 acres

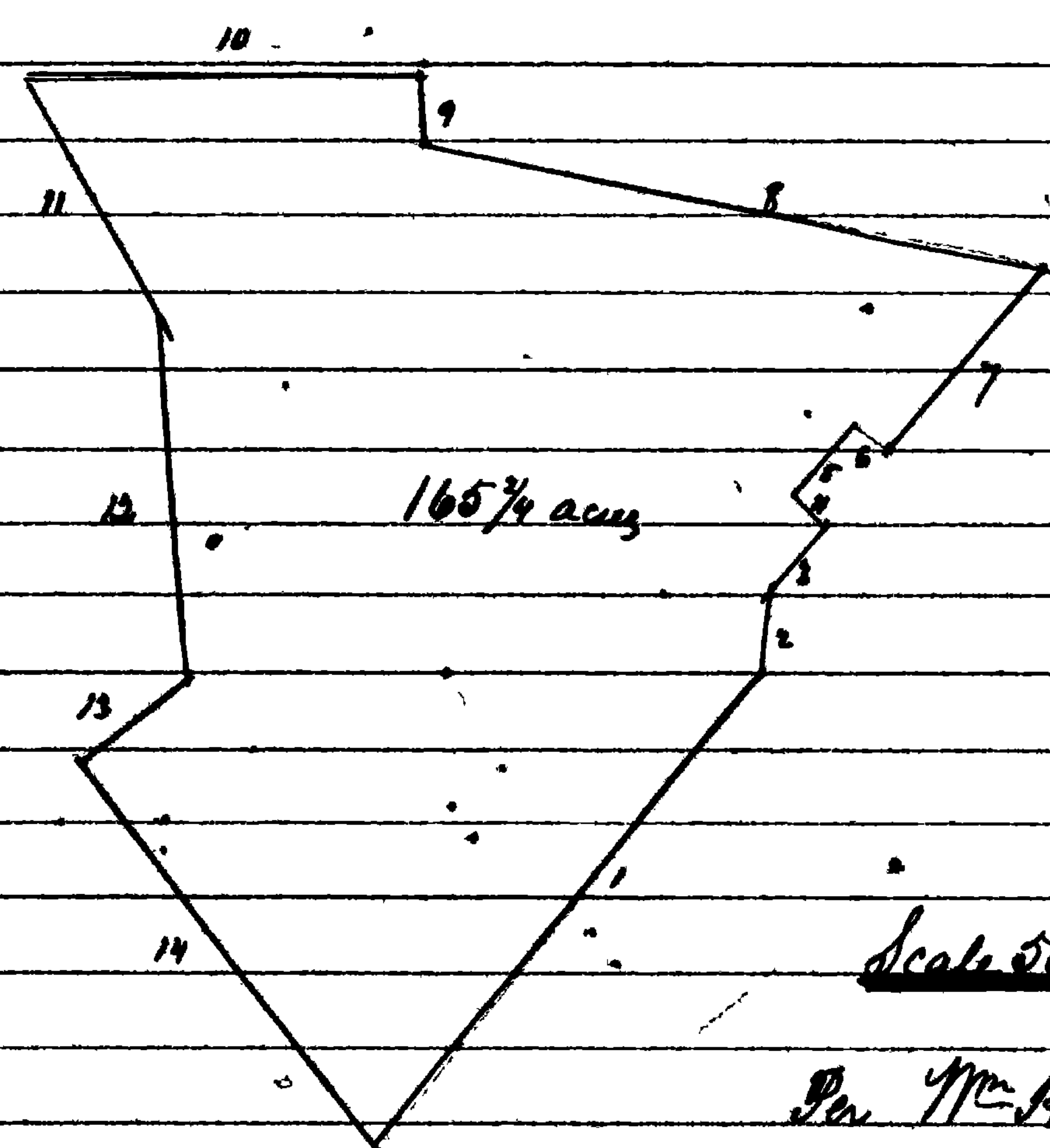

Scale 50 to the inch
Per Wm. H. Hilleney Sur.
June 1st 1862

Copy "Exhibit C" "Bloomberg"

At the request of Lewis M. and Henry M. Bixdorff, Executors for the estate of the Real estate of Henry Bixdorff late of Frederick County, deceased, I have carefully surveyed part of a tract of land called "Bloomberg" being the parcel of land deeded the 31st day of March 1834 by Joseph A. Johnson and Charles Johnson, Executors, to Henry Bixdorff for 60 acres, and have divided the same into 2 lots as follows -
 Lot No. 1. Beginning at the beginning of the whole parcel aforesaid 60 acres, and running thence with the 1st line thereof with the direction required to agree with the former surveying: N 28° E 120 paces to a stake and pile of stones, then N 25° W 86 paces to the old Yuman road, and to the end of the 7th line S 58° W 144 paces of the whole parcel aforesaid, then with the line of said whole parcel and by and with said road courses and distances, connecting as aforesaid, S 72° W 119 paces, S 83° W 110 paces, S 75° W 110 paces then S 22° E 107 paces to the place of Beginning, containing 33 acres and 29 square paces.
 Lot No. 2. Beginning at a stake and pile of stones at the end of the 1st line of Lot No. 1 it also being at the end of 42 1/2 paces on the 1st line of the whole deed for 60 acres aforesaid, and running thence with the 1st line of the whole deed parcel with such variations as is found necessary to compare with the former location and call viz: N 58 1/4° E 12 1/2 paces to a stone formerly planted and on the 2nd line