

William Holzger Surveyor & Chain Carrier for five days amounting  
 at \$5 per day for Surveyor & Chain Carrier

\$ 22.00  
 \$ 26.00

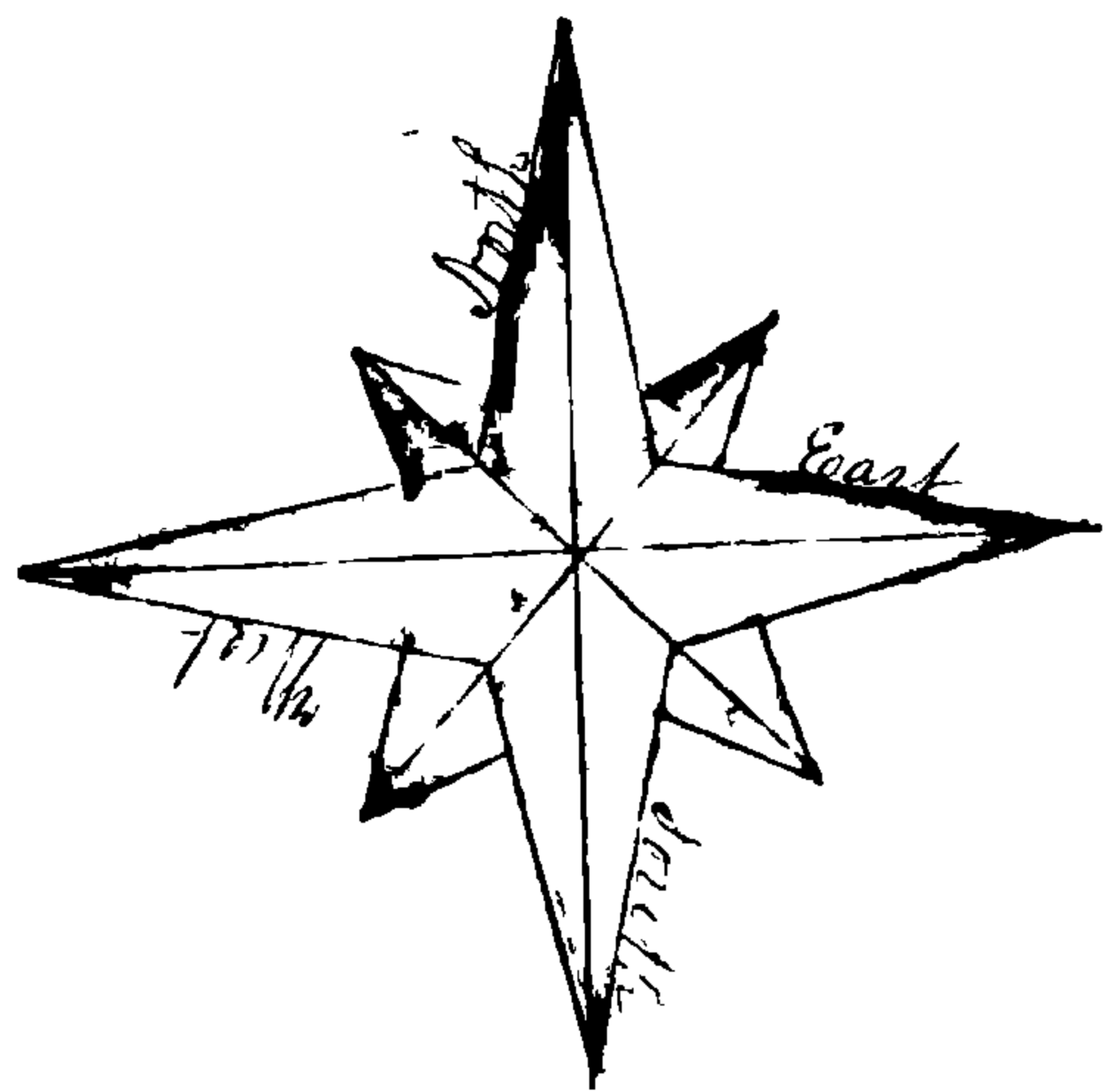

By a Scale of 10

S A Schick rechts  
 Moore bei Lot 4 2/80 acres

A  
 Beginning

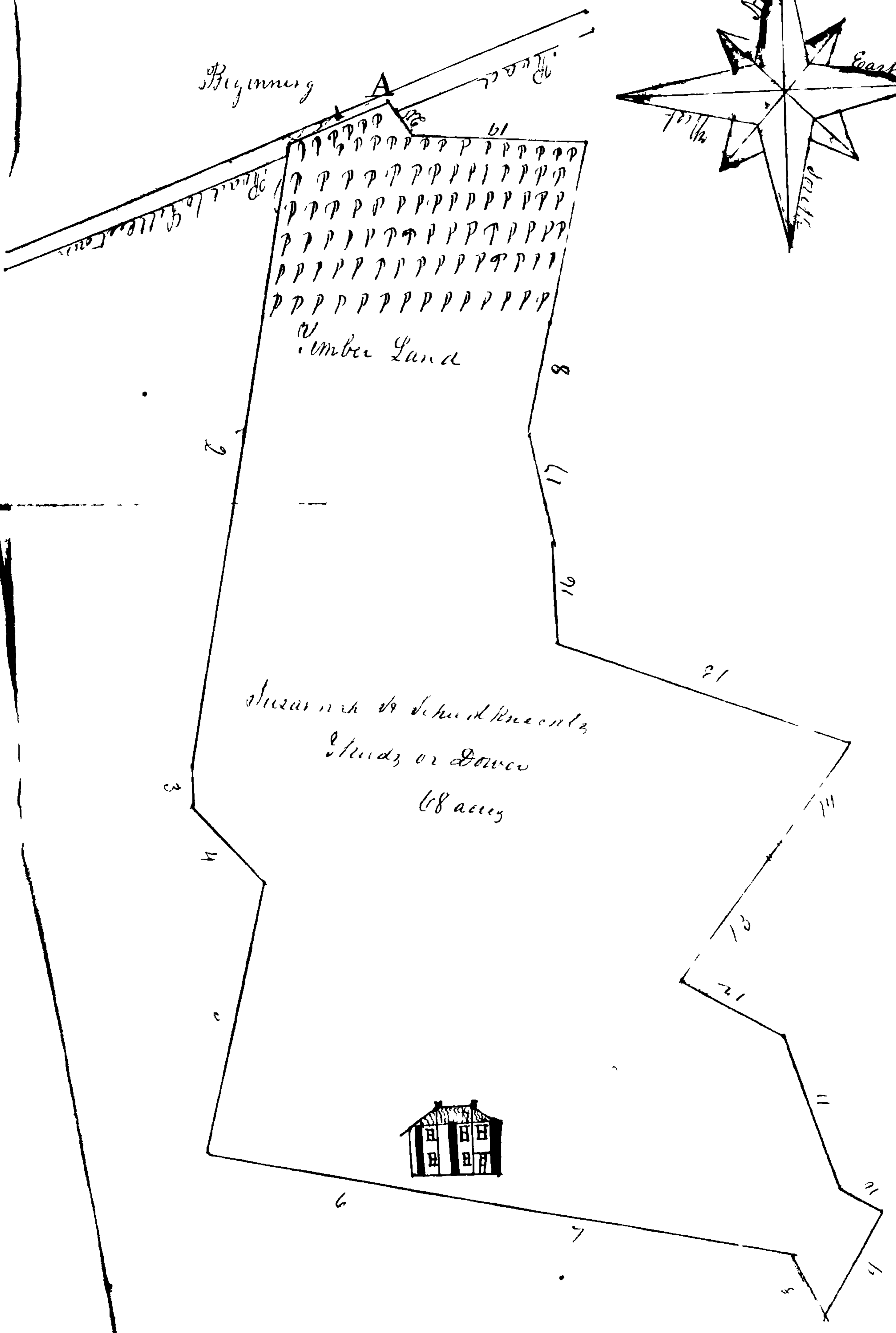

Courses of the Town

170° 48'	15	Ps
180° 00'	96 3/4	ps
110° 00'	5 1/2	ps
127° 00'	16	ps
110° 48'	42 3/4	ps
181° 00'	10	ps
181° 00'	10	ps
122° 00'	10	ps
126° 00'	19	ps
161° 00'	7	ps
121° 00'	25	ps
161° 00'	18	ps
138° 00'	24	ps
132° 00'	20	ps
172° 00'	27	ps
122° 00'	15	ps
113° 00'	17	ps
110° 00'	20 3/4	ps
187° 00'	25	ps
187° 00'	6	ps

(Contains 68 acres  
 more or less of land)

Courses of the Moore's Land

112° 00'	15	Ps
188° 00'	11 1/4	ps
155° 00'	16	ps
187° 00'	41 1/4	ps