

George Clune & Sarah E. Clune his wife to Lott Norris dated on the 27th day of May 1848 and running with the outlines thereof connecting the courses & distances to correspond with the former location

20 S 43 1/2° W 12 perches to a stone

21 S 41° E 22 1/4 " " "

22 S 76° W 31 1/10 " " "

23 N 5 1/4° E 38 3/10 " intersecting the gum line of

Lott Norris part of Ashes Herhold and with it

24 N 79 3/4° W 124 7/10 perches to the place of beginning

Containing 141 3/4 acres & 8 square perches of land

Survey & Calculated & plotted Sept 1860

By Geo W Tupper

E. E.

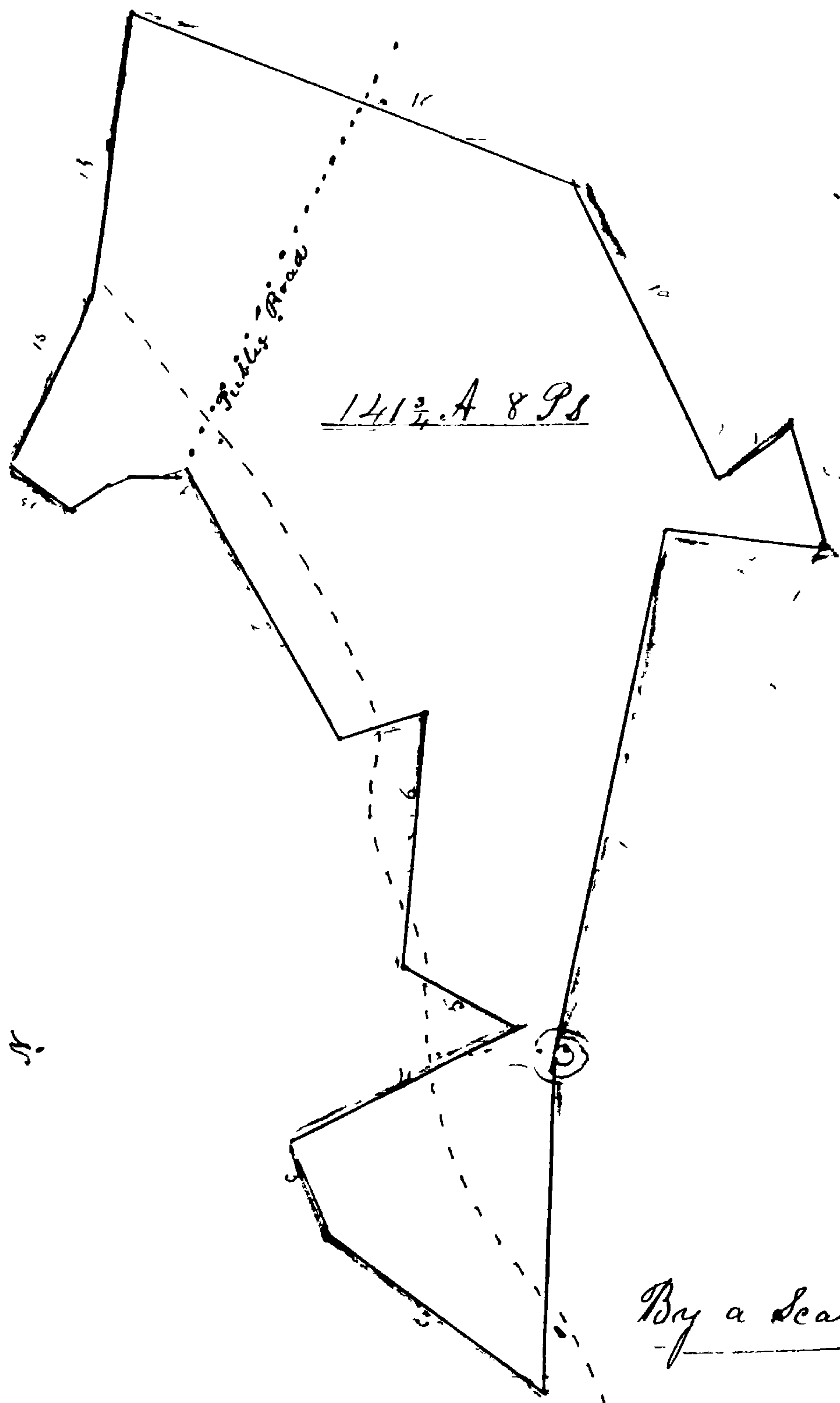

By a Scale of 40

Courses and distances of Road around with the Gran Yard commencing at a stone standing on the South side of the public road running as follows

S 62 1/2° W 8 1/2 ps

S 55 1/2° W 2 ps

N 24 1/4° E 10 1/2 ps

S 38° W 5 1/2 "

S 6 1/2° E 2 1/10 "

N 60 1/4° W 8 1/10 " to the place

S 69 1/4° W 20 "

S 57° E 9 3/4 "

of beginning Containing 110

S 29 1/2° W 11 "

S 87 1/2° E 12 "

square perches of land.

S 27 1/4° W 10 "

N 10 1/2° E 20 "

S 33° W 13 "

N 32 1/2° E 13 4/10 "

S 11° W 17 1/2 "

N 26 1/4° W 9 1/2 "

N 88° W 10 3/4 "

N 30° E 10 8/10 "

N 55 1/2° W 8 9/10 "

N 68 3/4° E 19 "

N 6 1/4° W 2 9/10 "

N 43° E 3 3/4 "