

running back Southwardly Three hundred feet more or less the same width a reference being had to the mill of Elizabeth Saggerson Lib. & M. C. N^o 2 folio 234, may more fully appear together with all and singular the buildings improvements ways water Courses rights members privileges advantages and appurtenances thereunto belonging or in any wise appertaining and all the estate right title and interest trust property claim and demands whatsoever at Law and in Equity of her the said Ann Elizabeth Stummel of in and to the same, I have and to hold herein described lot and premises with the appurtenances thereunto belonging unto the said Mahlon Davis from his heirs and assigns for the only proper use of the said Mahlon Davis from his heirs and assigns forever

In testimony whereof the said Ann Elizabeth Stummel has hereunto set her hand and seal on the day and year first above written

signed sealed & delivered in presence of
 John A. Simmons
 A. W. Marriott

} Ann Elizabeth Stummel (Seal)

State of Maryland Frederick County to Wit
 Be it remembered and it is hereby certified that on the 11th day of April in the year of our Lord 1857 before us the subscribers two Justices of the Peace of the State and County aforesaid personally appear Ann Elizabeth Stummel - she being known to us to be the person who is named and described as and professing to be a party to the within and foregoing deed or indenture and doth acknowledge the said indenture or instrument of writing to be her act and deed. In testimony whereof our hereunto subscribe our names on the day and year aforesaid

John A. Simmons
 A. W. Marriott

State of Maryland Frederick County to Wit
 I hereby certify that the foregoing is a true Copy of the original deed as taken from Lib. & M. C. N^o 12 folio 292 - one of the Land Records of Frederick County

In testimony whereof I hereunto subscribe my name and affix the seal of the Circuit Court for Frederick County this 7th day of January 1858

(Seal) R. D. Fitzhugh Clerk

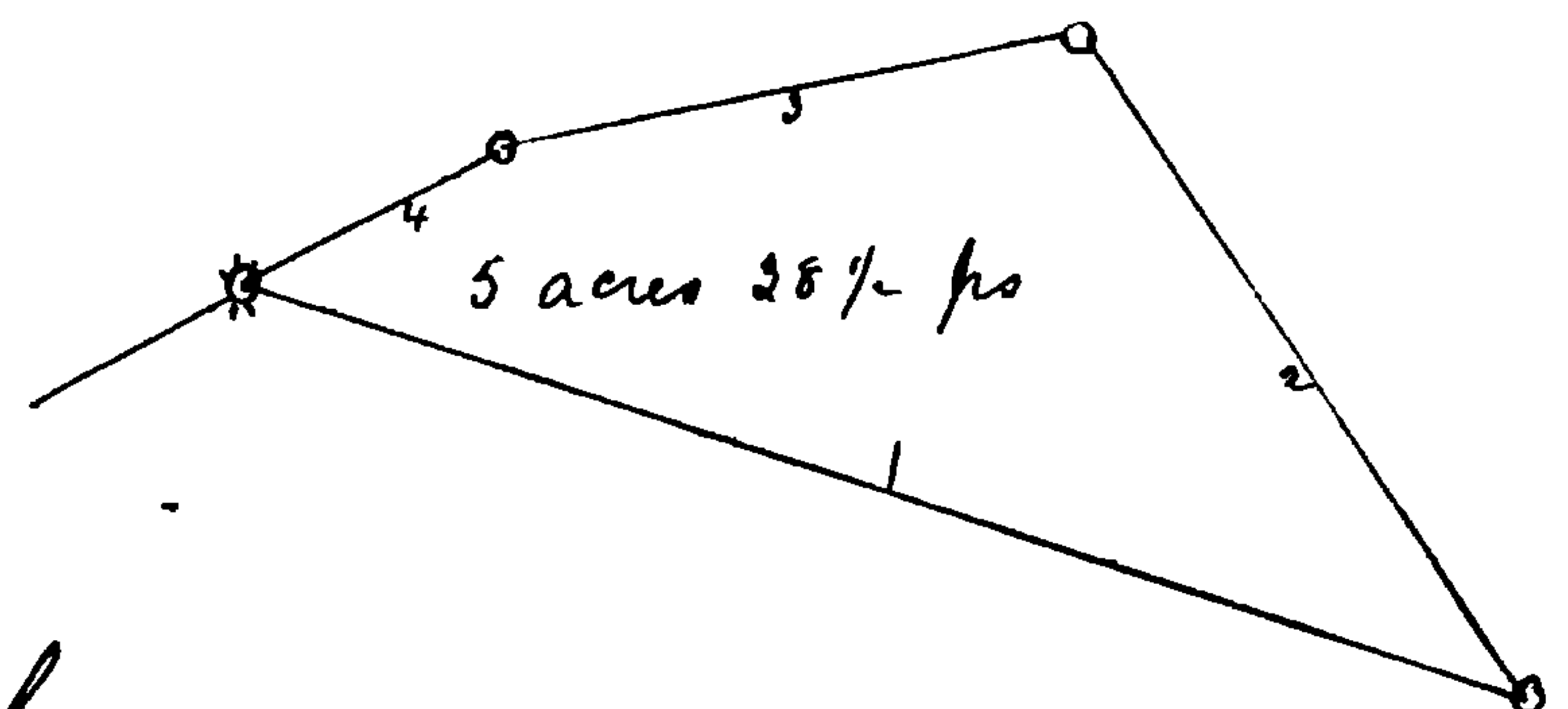

Daniel Swadner &
 Rebecca his wife
 to
 Mahlon Davis

} Part of the Presumptions or Inclosure