

and running thence with said deed correcting the Courses, S 22 1/2° W, 22 perches, S, 41 1/2° E 40 perches to a large stone in the public road, thence with said road 2 Courses S 4 1/2° E, 60 perches, S 3 1/4° E 23 1/4 perches to a stone, S, 88° W, 31 1/2 perches to a stone, N, 88 1/2° W, 26 perches to a stone, S 24 1/2° W 22 1/2 perches to a stone, N, 13 1/2° E 10 perches to a stone, N, 2 1/2° E 5 perches, N 79 1/2° W 100 perches S 67 1/2° W 2 perches to a stone, N 44 1/2° W 40 perches to a stone, N, 3 1/2° W 60 perches to the end of the 14th line of Division No. 1, and with the outlines thereof reversed 8 Courses viz: S, 84 1/2° E 26 3/4 perches, S 1° W 36 perches, N, 73 1/2° E 92 1/2 perches, S 4 1/2° E 21 perches, N, 73 1/2° E 1 perches, N, 4 1/2° W 20 perches, N 73 1/2° E 48 1/2 perches, N 69 1/2° E 57 1/2 perches to the beginning, containing 138 1/4 Acres & 16 perches.

For that part of the Mountain designated on the plat as Division No. 3, deeded to Daniel Smeltzer & Charles P. Morris by George Shafer and Samuel Remsburg on the 22nd day of February 1857 for thirty one acres, being part of a tract of land called 'Ebenezer' beginning for said part at a stone standing at the end of the first line of said deed and running thence with said deed 5 Courses, correcting the same viz: N 2 1/2° E 40 perches to a stone, S 87 1/2° E 42 perches to a stone, S 67° East 25 perches to a stone, S, 3 1/4° W 34 perches to a stone, S 8 1/2° W 44 perches to a stone, thence by a divisional line now made N 42 3/4° W 56 1/2 perches to the beginning containing 39 acres, 3 rods, 12 perches.

For that part of the Mountain land designated on the plat as Division No. 4 Assigned to Mary W. Smeltzer Widow of Daniel Smeltzer, being part of the same land last above described called 'Ebenezer', beginning for the same at a stone standing at the end of 17th line of the whole tract called 'Ebenezer' and running thence with said land one course correcting the same N, 70 1/2° E, 28 perches to a stone then with the last line of division No. 3 reversed, S 43 1/4° E 56 1/2 perches to a stone at the end of the 31st line of said whole tract called 'Ebenezer', and with said tract 2 Courses correcting the same S 73 1/2° W, 41 1/2 perches to a stone N, 57 1/2° W 25 perches to a stone then N 18 1/4° W, 24 3/4 perches to the beginning containing 9 1/4 Acres & 26 perches.

December 1866

John W. Remsburg  
Surveyor

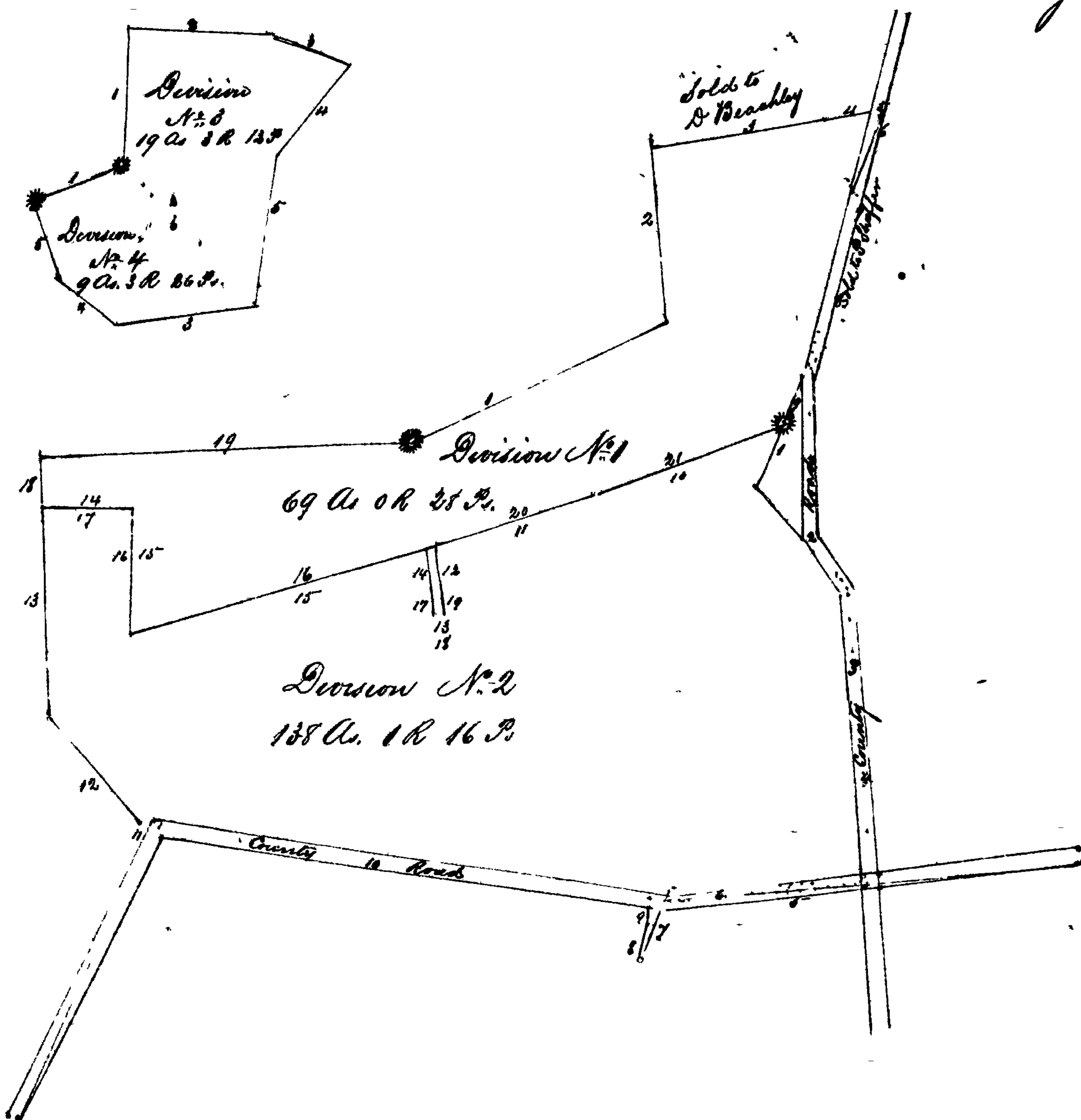

Plat of Real Estate of Daniel Smeltzer

is, relating to the plat, be returned Equity, the before county for taken to on the to them d that they ely or at S.P id. ~ ven ~ ir by for 2147 Smeltzer robes, 2, and to Joel to with 5 1/2° E 58 1/2 by dated 4 the hole tract wife to Daniel deed cor blic road to tract said = 1858 ~ 19 3/4° W 32 1/2 Smeltzer 1, then by 48 1/2 perches of water N, 84 1/2° W, 26 1/2 id line & beginning d part Fore deeded 1/2 1854 for 1.