

to be paid in cash on the day of sale or at the ratification thereof by the Court, the balance in two equal annual payments the purchaser giving bond with approved security, bearing interest from the day of sale

Examined Buildings, Frederick Md July 11 1853
Suzatt D Warfield John A Warfield Trustees

We hereby certify that the annexed advertisement of S D & J A Warfield was published in the Examiner a newspaper printed in Frederick, for more than three weeks prior to July 8th 1853

D Schley & J Haller

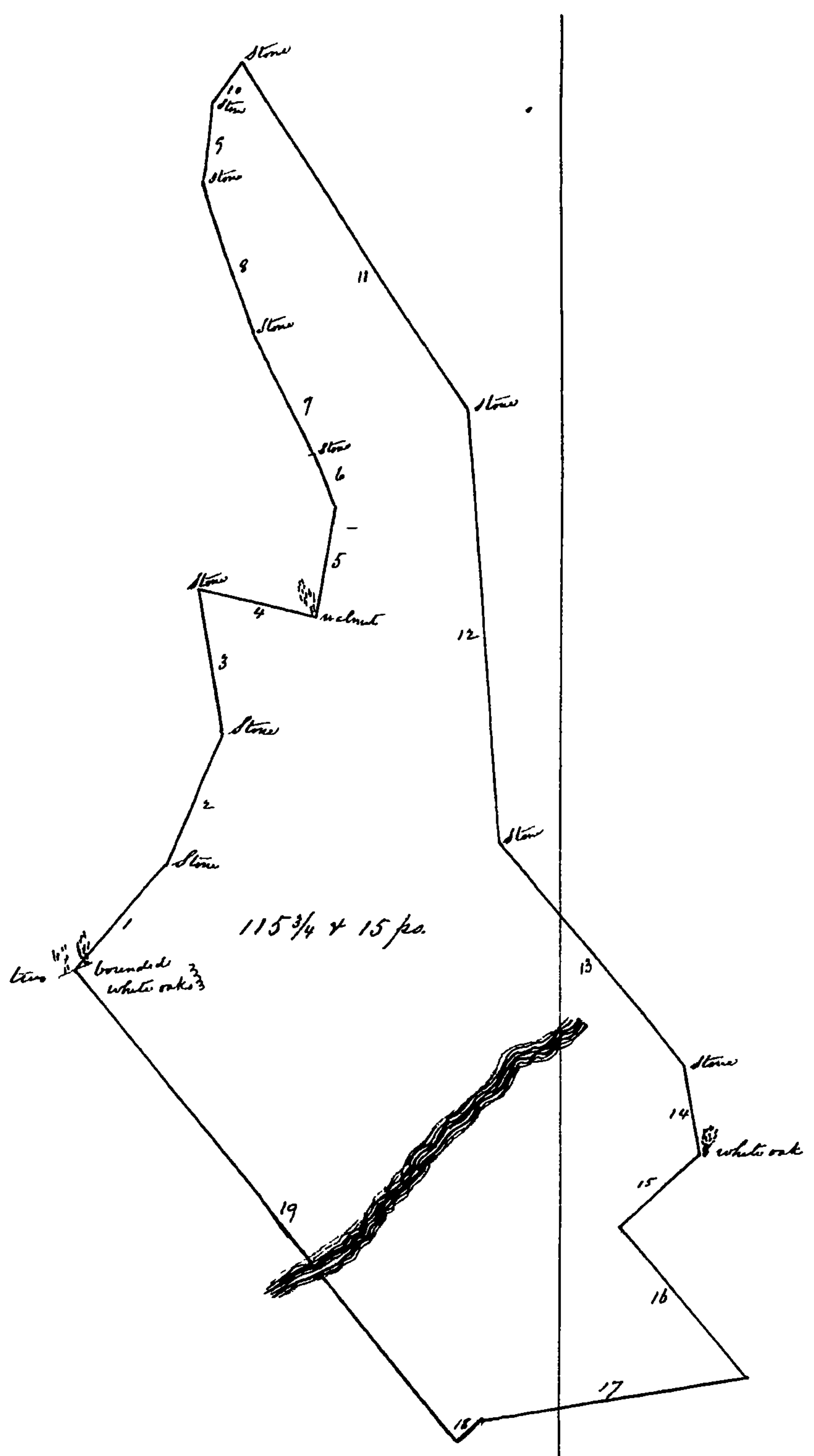

(Scale 40)

John A. Warfield & S D Warfield
Trustees
To
R. D. Warfield

Part of a tract of land called 'Warfields Lot' beginning at the beginning of the whole tract and running thence 1) N 41 1/2° E 31 ps to a stone; 2) N 21 1/2° E 32 ps to a stone; 3) N 10° W 32 ps to a stone; 4) S 77 3/4° E 27 1/4 ps to a walnut tree; 5) N 7 1/2° E 25 ps; 6) N 21 1/2° W 12 ps to a stone; 7) N 26 3/4° W 30 ps & N 17 1/2° W 36 ps to a stone; 8) N 7 1/4° E 15 3/4 ps to a stone; 9) N 35 1/2° E 9 6/10 ps to a stone; 10) S 33° E 92 ps to a stone; 11) S 4 3/4° E 95 9/10 ps to a stone; 12) S 39 1/2° E 63 1/10 ps to a stone; 13) S 10 1/2° E 19 1/2 ps to a marked white oak tree; 14) S 46 1/4° W 24 ps; 15) S 39° E 45 1/2 ps to the 27th line of the whole tract then with the outlines; 16) S 80° W 60 ps to a stone; 17) S 53° W 6 1/4 ps then with a straight line to the beginning containing one hundred fifteen acres three rods and fifteen perches

Elehu H Rockwell - Surveyor
Dec 28. 1852