

Ex. No 3

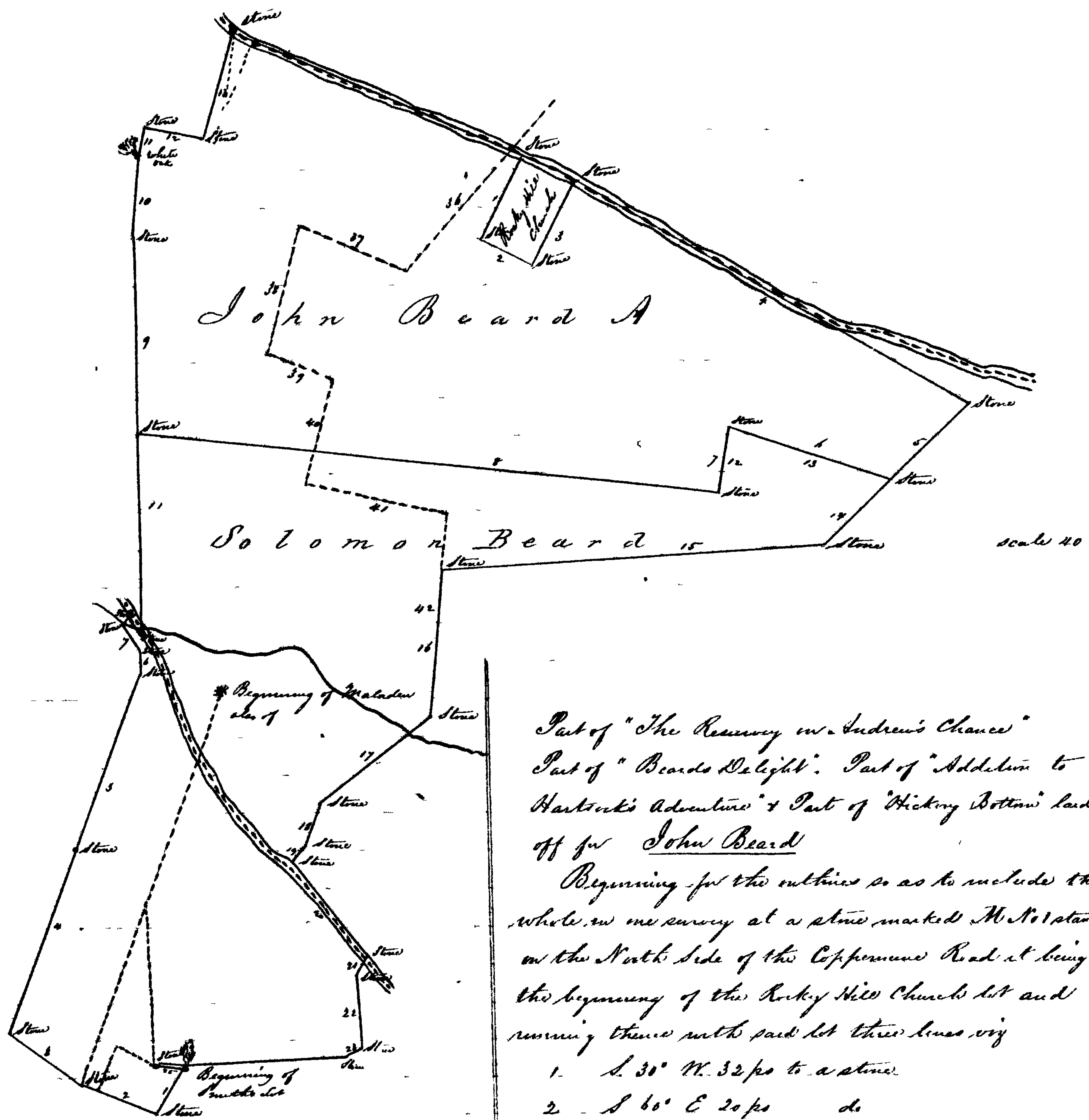

Part of "The Resurvey in Andrew's Chance"  
 Part of "Beards Delight". Part of "Addition to  
 Hartout's Adventure" & Part of "Hickory Bottom" land  
 off for John Beard

Beginning for the outline so as to include the  
 whole in one survey at a stone marked M No 1 standing  
 on the North side of the Coppermine Road at being  
 the beginning of the Rocky Hill Church lot and  
 running thence with said lot three lines viz

- 1 S 30° W 32 ps to a stone
- 2 S 60° E 20 ps do
- 3 N 30° E 32 ps do
- 4 S 58.34° E 158 1/2 ps do at the beginning of  
 "Fogles Inheritance"
- 5 S 49° W 20 ps to a stone
- 6 N 68° W 59 1/2 ps do
- 7 S 83 1/4° W 23 1/2 ps do
- 8 N 82° W 205 ps do on the 5<sup>th</sup> line of  
 Beards Delight as per said and with it connected to  
 correspond with former running
- 9 N 1° E 68 ps to a stone
- 10 N 10 1/2° E 30 ps to a large white oak tree
- 11 N 10 1/2° E 9 ps to a stone
- 12 S 75° E 21 ps to a stone at the end of  
 the 2<sup>d</sup> line of a deed from Jacob Stittly to Peter Beard  
 dated June 15 1773 for 75 perches of land thence with the  
 given line thence reversed N 19° E 37 1/2 ps to a stone  
 in the middle of the road thence with a straight line  
 to the beginning containing 162 1/4 a + 27 ps

E N Rockwell  
 Surveyor 1848