

892

RATIO - 24

1

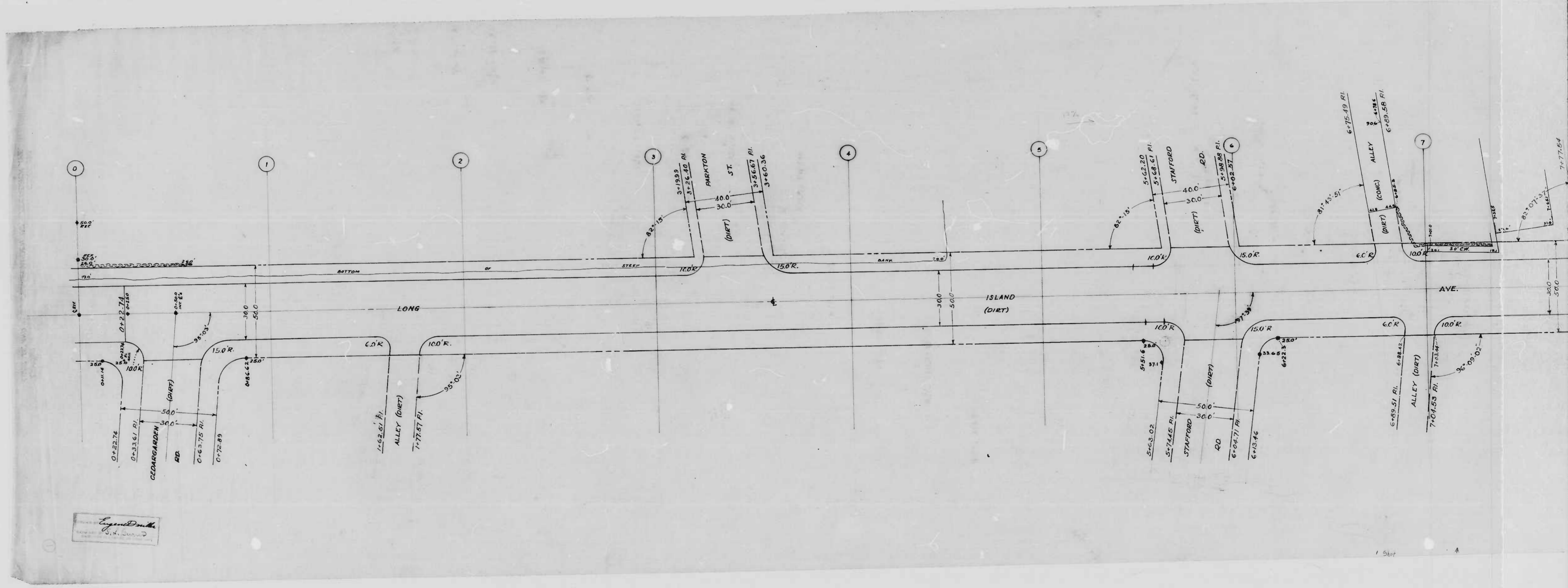

Engineer
S. J. ...

1 Sheet

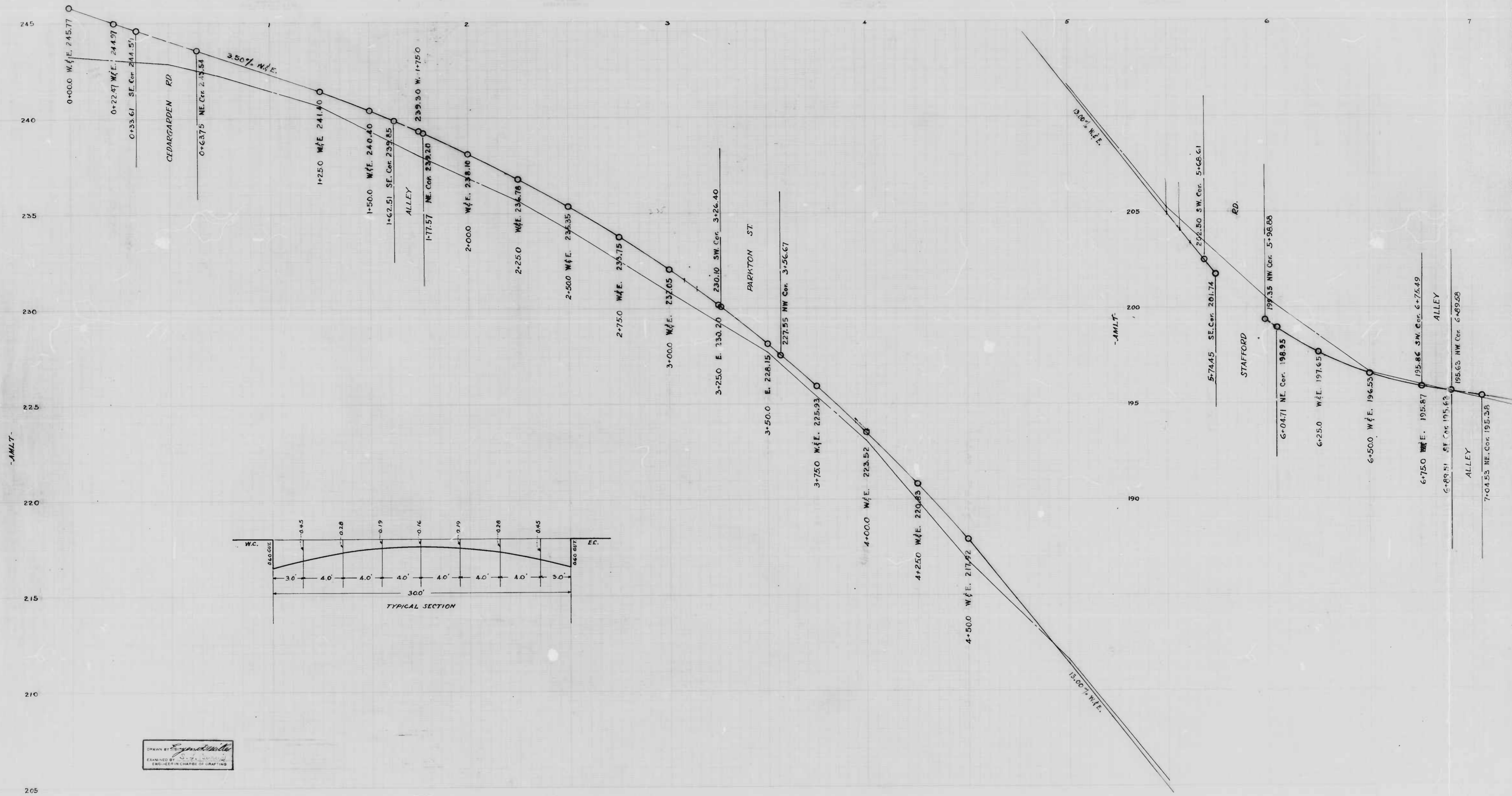

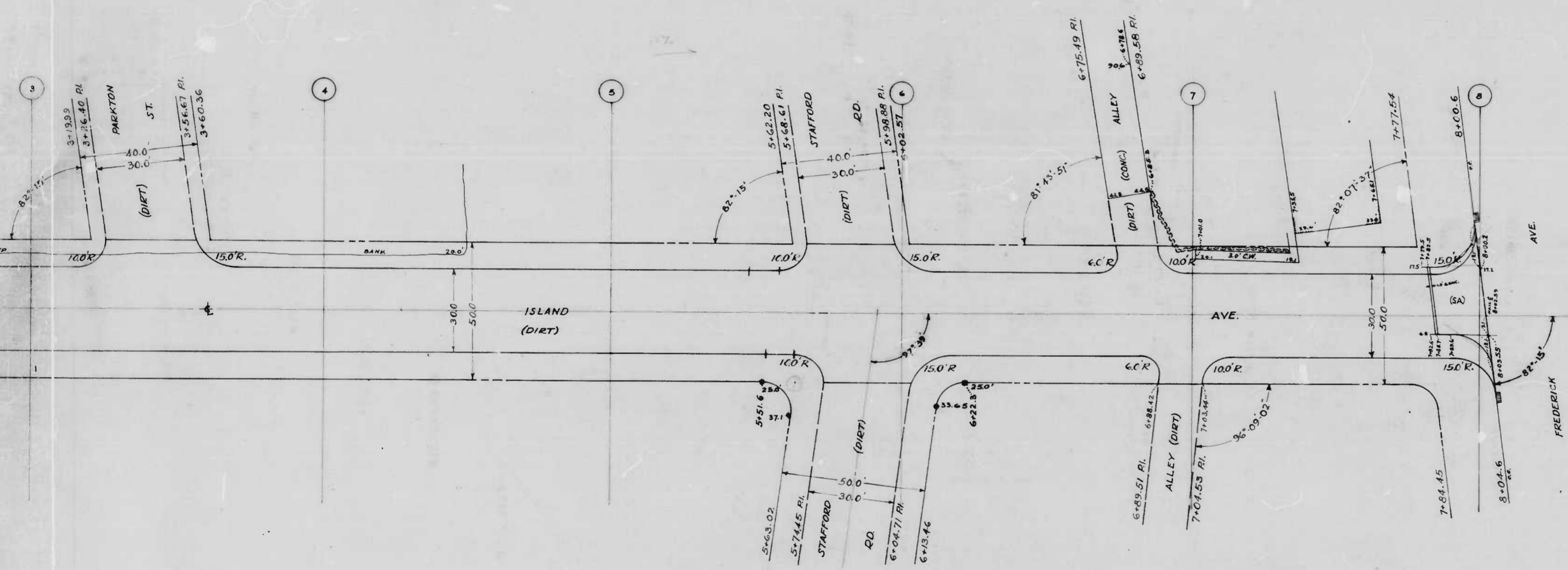

THE ISSUANCE OF THIS PLAN DOES NOT COMMIT THE CITY TO THE ACCEPTANCE AND/OR IMPROVEMENT OF ANY THOROUGHFARE SHOWN HEREON.

SOIL STABILIZATION MATERIALS AND/OR UNDERDRAINS ARE NOT REQUIRED.

TO BE CEM CONC. SEVEN (7") INCHES THICK.

CITY OF BALTIMORE
 DEPARTMENT OF PUBLIC WORKS
 BUREAU OF HIGHWAYS
 LAYOUT
 LONG ISLAND AVE - CEDARGARDEN RD - FREDERICK AVE.
 SCALE 1"=200' BOOK #243
 MAY 28, 1948 CONT 892

APPROVED - *Henry M. ...* ASSOCIATE ENGINEER
 APPROVED - *James H. ...* HIGHWAYS ENGINEER
 APPROVED - *Edmund ...* ENGR. OF SURVEYS
 APPROVED - *P. L. Holland* DIRECTOR OF PUBLIC WORKS

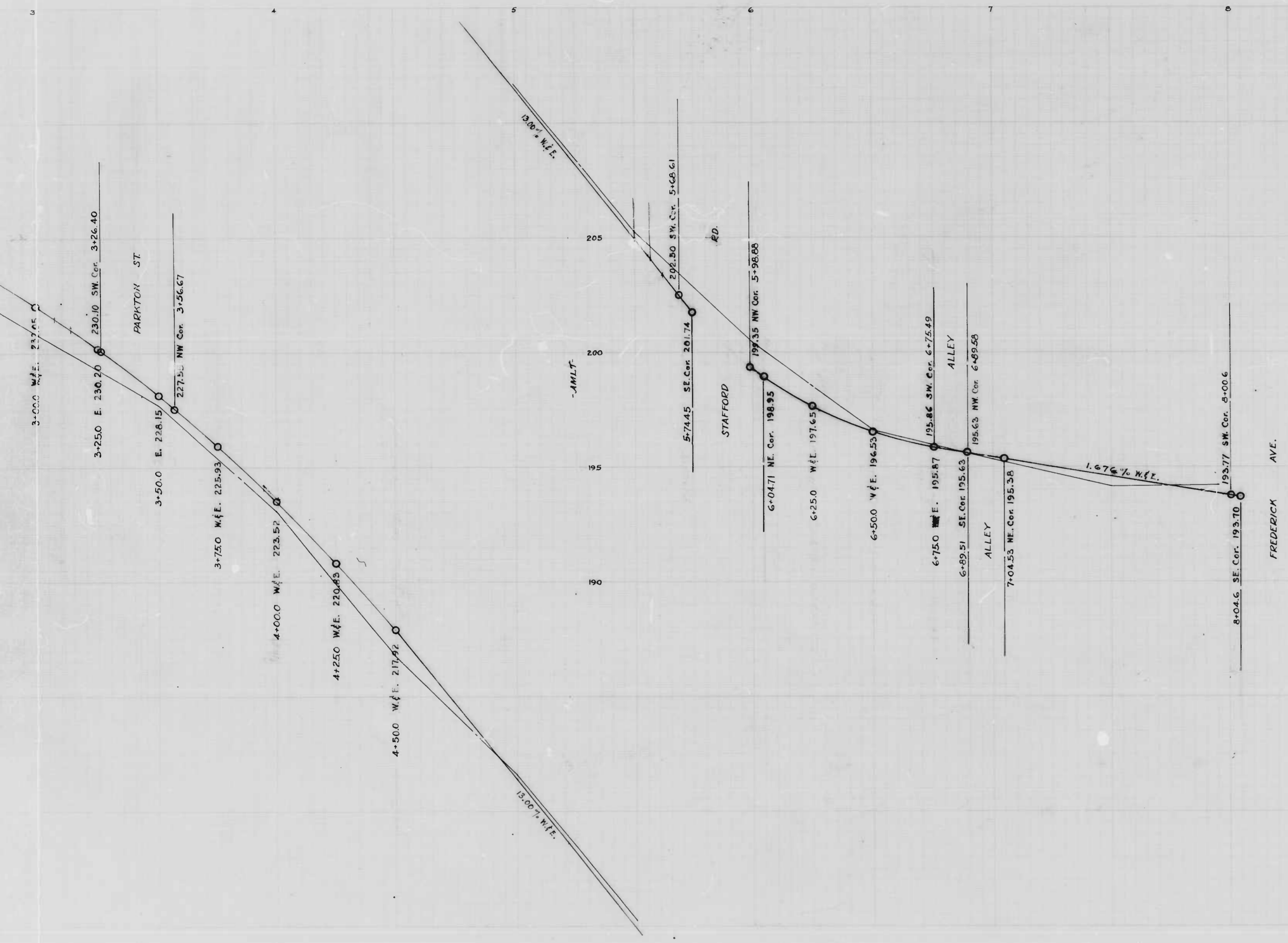

THE ISSUANCE OF THIS PROFILE DOES NOT COMMIT THE CITY TO THE ACCEPTANCE AND OR IMPROVEMENT OF ANY THROUGHFARE SHOWN HEREON.

CITY OF BALTIMORE
 DEPARTMENT OF PUBLIC WORKS
 BUREAU OF HIGHWAYS
 Profile Of
 LONG ISLAND AVE. - CEDARGARDEN RD. - FREDERICK AVE.
 SCALES - HOR. 1" = 200' CONT. 892 BOOK X-243
 VER. 1" = 20.0' DATE JUNE 12, 1948

APPROVED -
Henry M. ...
 ASSOCIATE ENGINEER

APPROVED -
James ...
 HIGHWAYS ENGINEER

APPROVED -
Edward J. ...
 ENGINEER OF SURVEYS

APPROVED -
P. L. Hollands
 DIRECTOR OF PUBLIC WORKS

892

RATIO - 24 **3**

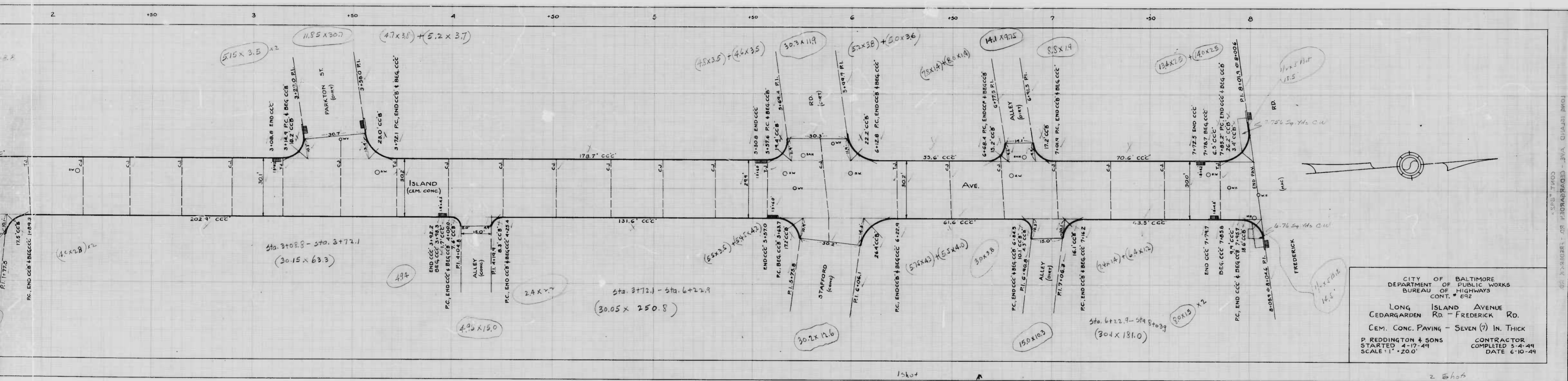

CITY OF BALTIMORE
 DEPARTMENT OF PUBLIC WORKS
 BUREAU OF HIGHWAYS
 CONT. # 892

LONG ISLAND AVENUE
 CEDARGARDEN RD - FREDERICK RD.
 CEM. CONC. PAVING - SEVEN (7) IN. THICK

P. REDDINGTON & SONS
 STARTED 4-17-49
 SCALE 1" = 20.0'

CONTRACTOR
 COMPLETED 5-4-49
 DATE 6-10-49

LONG ISLAND AVE - CEDARGARDEN RD - FREDERICK RD
 CONT. # 892

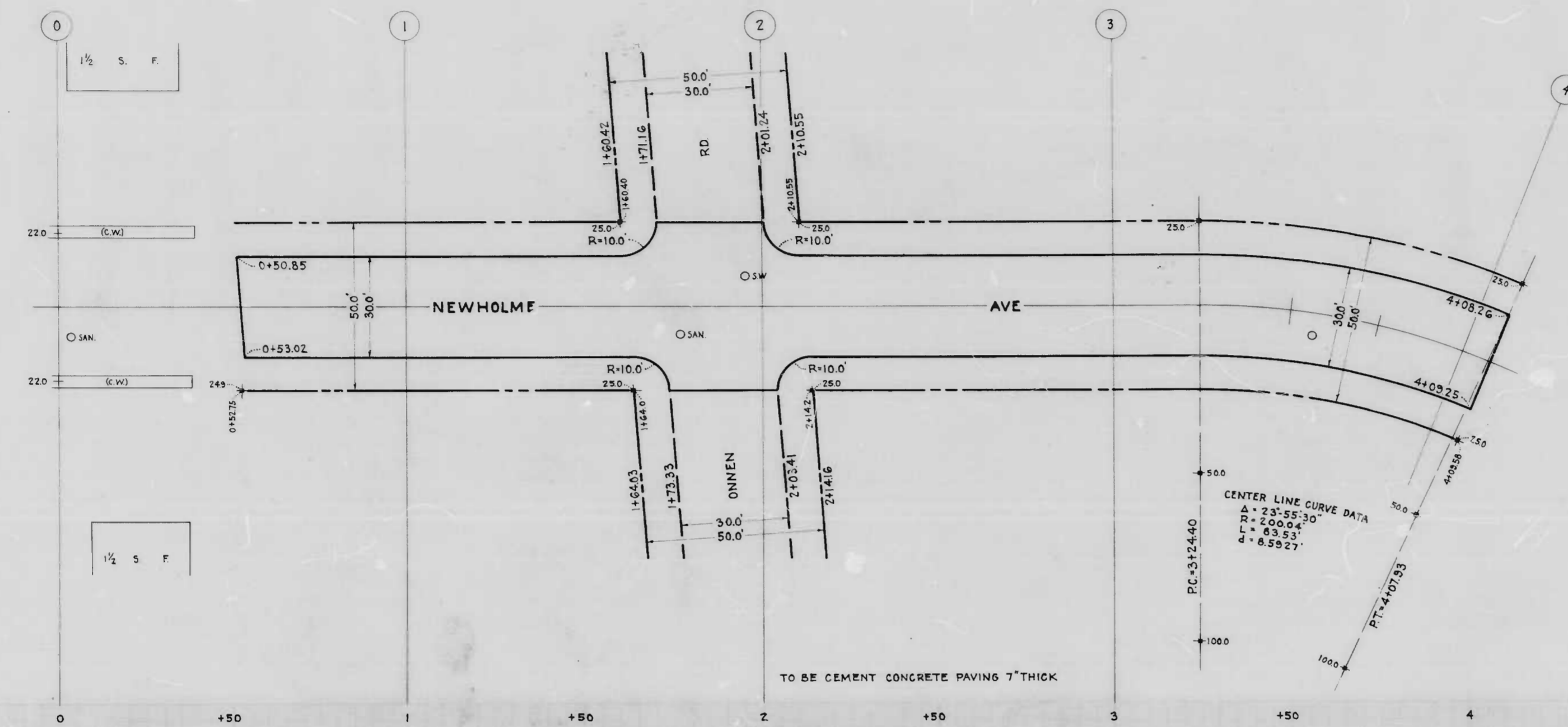

THE ISSUANCE OF THIS PLAN AND PROFILE DOES NOT COMMIT THE CITY TO THE ACCEPTANCE AND OR IMPROVEMENT OF ANY THOROUGHFARE SHOWN HEREON.

SOIL STABILIZATION MATERIALS AND OR UNDERDRAINS ARE NOT REQUIRED.

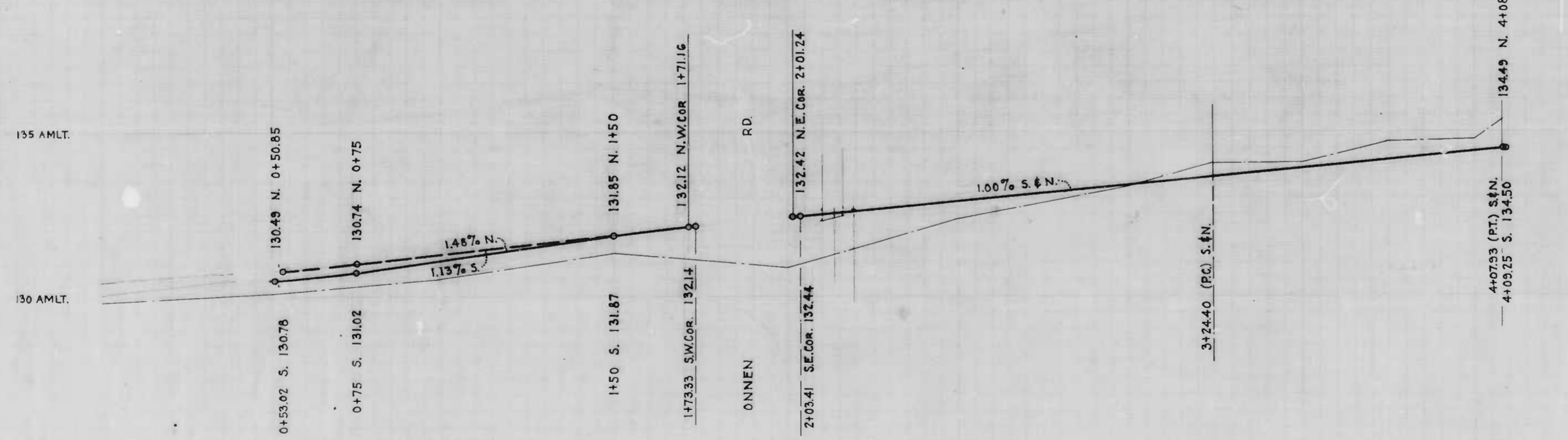
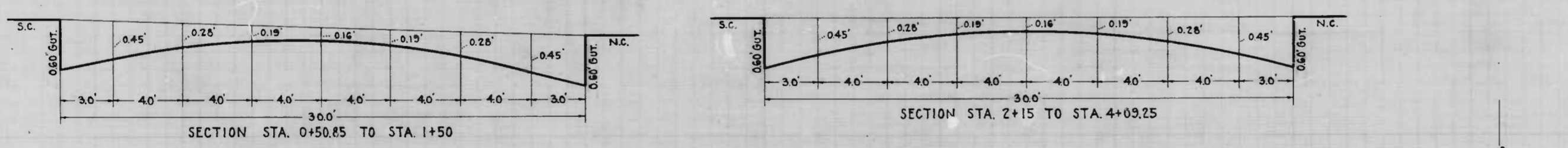

CITY OF BALTIMORE
DEPARTMENT OF PUBLIC WORKS
BUREAU OF HIGHWAYS

**PLAN AND PROFILE OF
NEWHOLME AVE
1110'± W. OF ONNEN RD. - 1970'± E. OF ONNEN RD.**

PLAN - 1" = 20'
SCALES - PROFILE - HOR. 1" = 20'
VER. 1" = 2'

CONT. NO. 892
BOOK - X206A
DATE - JULY 24, 1948

APPROVED
Henry Weisberg
ASSOCIATE ENGINEER

APPROVED
Edward H. Hester
ENGINEER OF SURVEYS

APPROVED
Samuel A. Mezey
HIGHWAYS ENGINEER

APPROVED
C. L. Hollands
DIRECTOR OF PUBLIC WORKS

DESIGNED BY JESSIE D. CARTER
ENGINEER

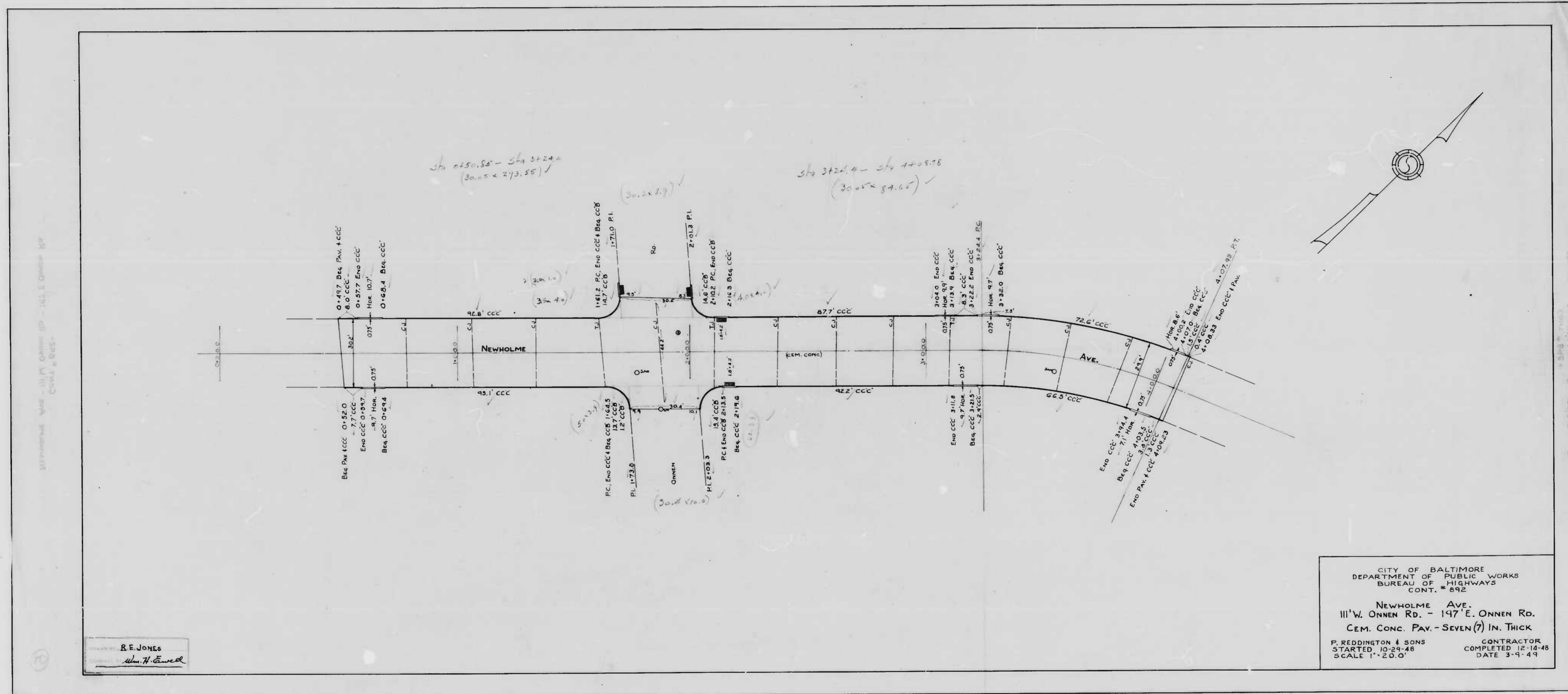

SECTIONAL VIEW - 11 1/4" CENTER TO CENTER OF CURVES
 CONT. & REVS.

R. E. JONES
Wm. H. Evers

CITY OF BALTIMORE
 DEPARTMENT OF PUBLIC WORKS
 BUREAU OF HIGHWAYS
 CONT. # 892
 NEWHOLME AVE.
 111' W. ONNEN RD. - 197' E. ONNEN RD.
 CEM. CONC. PAY - SEVEN (7) IN. THICK
 P. REDDINGTON & SONS
 STARTED 10-24-48
 SCALE 1" = 20.0'
 CONTRACTOR
 COMPLETED 12-14-48
 DATE 3-9-49

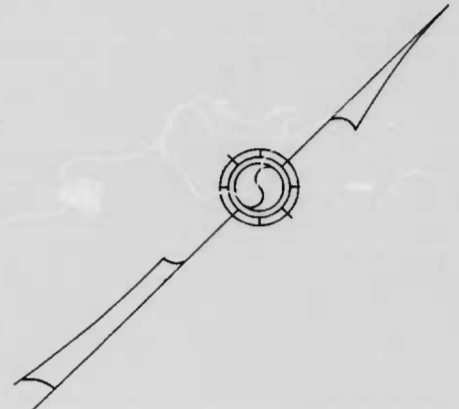

Sta 0+50.80 - Sta 3+24.2
 (30.73 x 273.85) ✓

Sta 3+22.4 - Sta 4+05.78
 (30.56 x 83.38) ✓

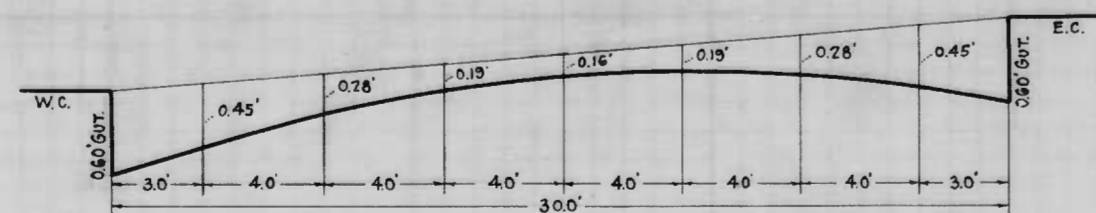
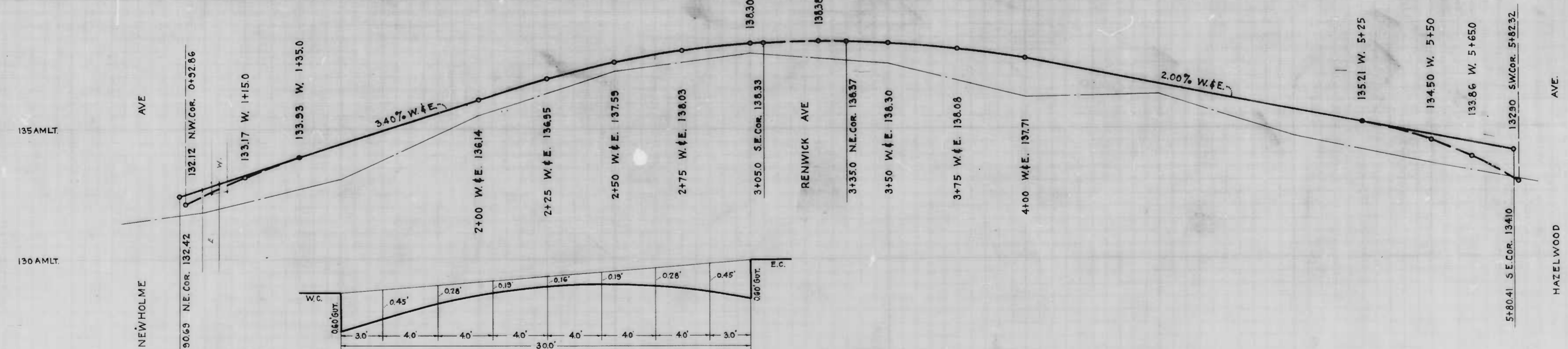
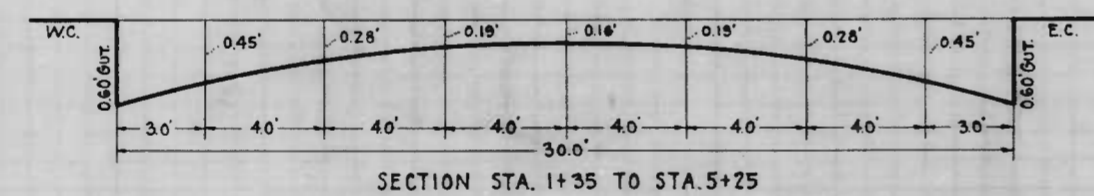
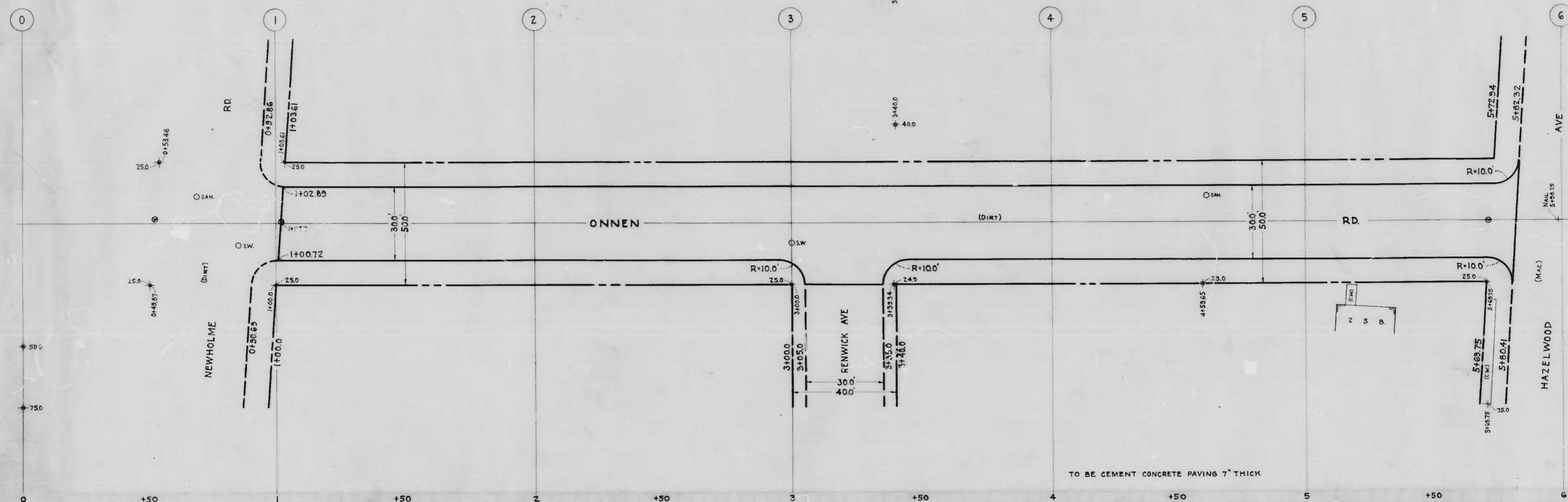

THE ISSUANCE OF THIS PLAN AND PROFILE DOES NOT COMMIT THE CITY TO THE ACCEPTANCE AND OR IMPROVEMENT OF ANY THOROUGHFARE SHOWN HEREON.

SOIL STABILIZATION MATERIALS AND OR UNDERDRAINS ARE NOT REQUIRED.

CITY OF BALTIMORE
DEPARTMENT OF PUBLIC WORKS
BUREAU OF HIGHWAYS
**PLAN AND PROFILE OF
ONNEN RD. - NEWHOLME AVE - HAZELWOOD**

PLAN: 1"=20'
SCALE: PROFILE: HOR: 1"=20'
VER: 1"=2'

CONT. No. 88
BOOK: X 20
DATE: JULY

APPROVED: *Henry Weisberg*
ASSOCIATE ENGINEER

APPROVED: *Edward J. Hatcher*
ENGINEER OF SURVEYS

APPROVED: *James S. M.*
HIGHWAYS ENGINEER

APPROVED: *P. L. Hollander*
DIRECTOR OF PUBLIC WORKS

DRAWN BY: JESSE D. CARTER
EXAMINED BY: *S. D. Burns*
ENGINEER-IN-CHIEF OF DRAFTING

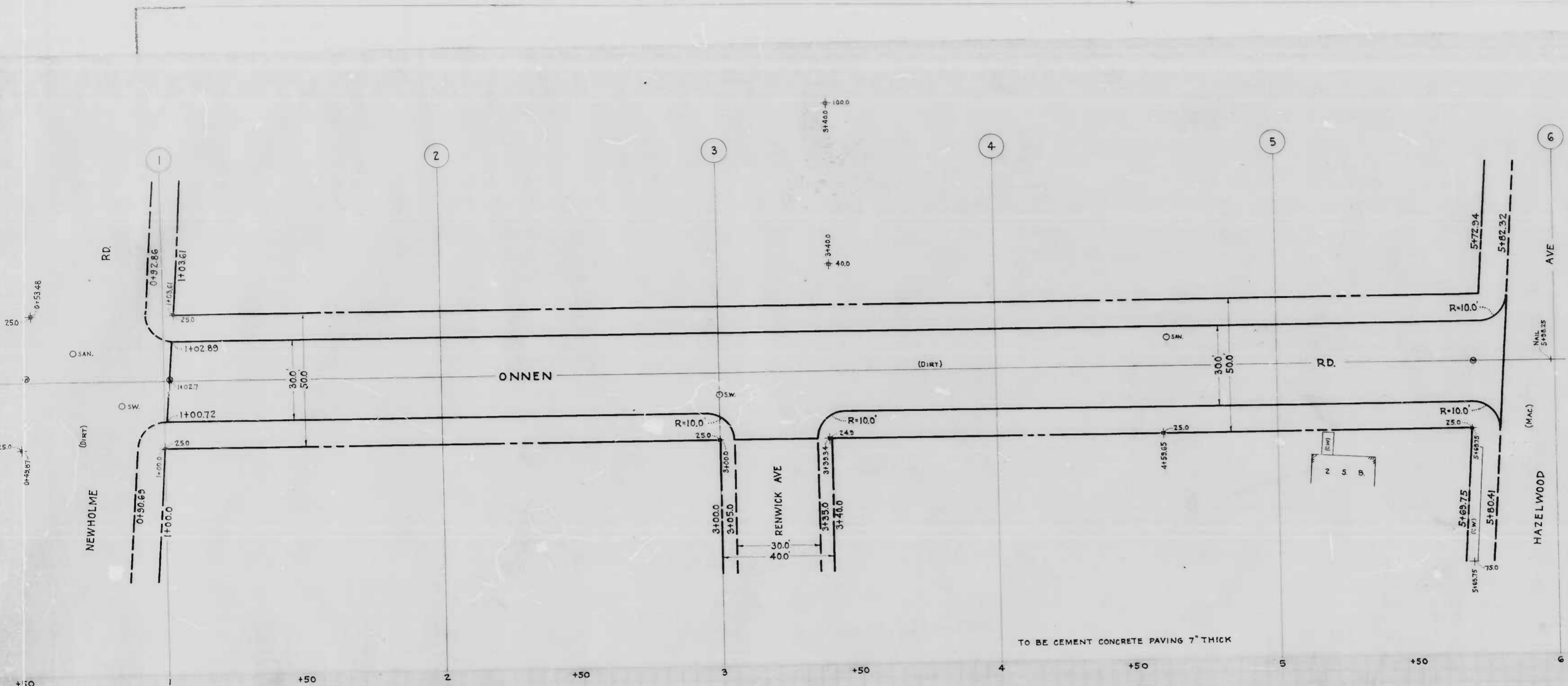

TO BE CEMENT CONCRETE PAVING 7" THICK

THE ISSUANCE OF THIS PLAN AND PROFILE DOES NOT COMMIT THE CITY TO THE ACCEPTANCE AND OR IMPROVEMENT OF ANY THOROUGHFARE SHOWN HEREON.

SOIL STABILIZATION MATERIALS AND OR UNDERDRAINS ARE NOT REQUIRED.

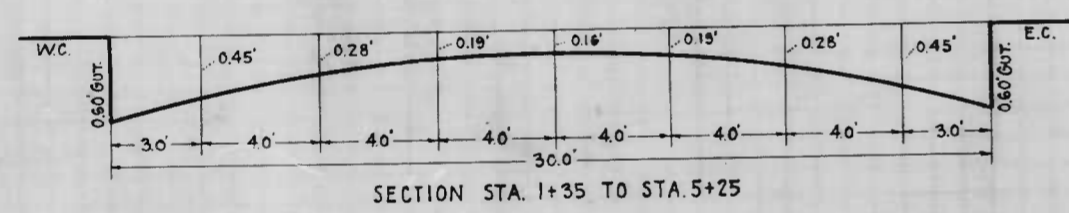

SECTION STA. 1+35 TO STA. 1+50

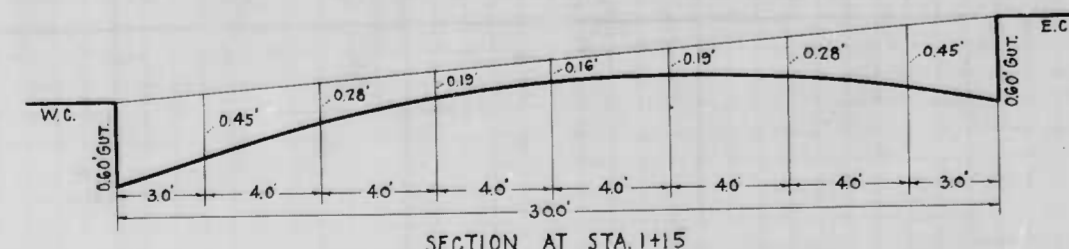
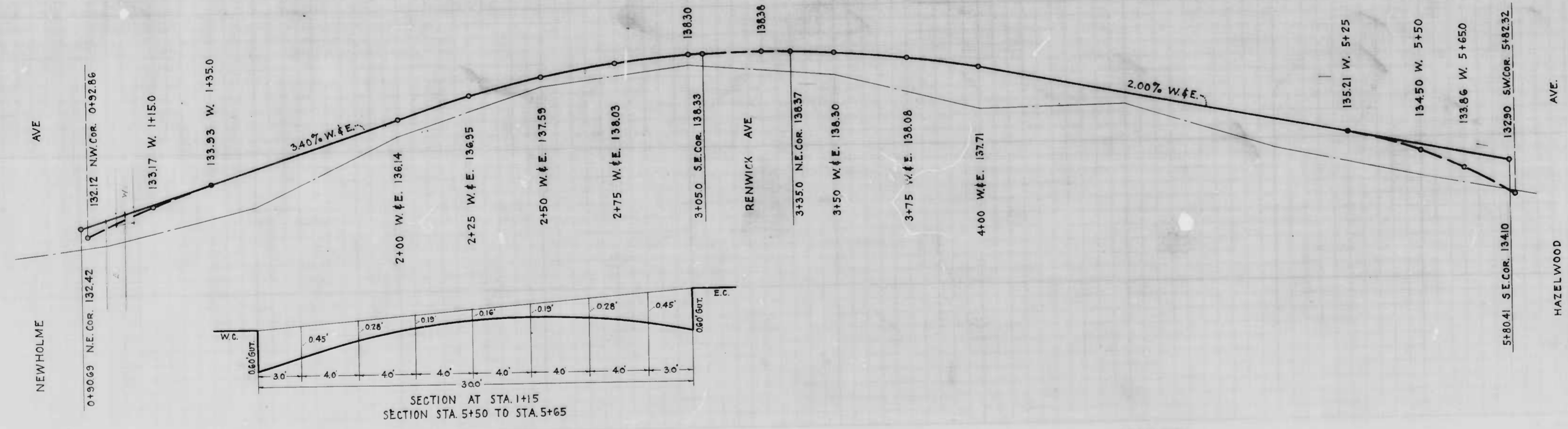

SECTION AT STA. 1+15
SECTION STA. 5+50 TO STA. 5+65

CITY OF BALTIMORE
DEPARTMENT OF PUBLIC WORKS
BUREAU OF HIGHWAYS
**PLAN AND PROFILE OF
ONNEN RD. - NEWHOLME AVE - HAZELWOOD AVE**
PLAN: 1" = 20'
SCALES: PROFILE: 1" = 2'
CONT. No. 892
BOOK: X 206A
DATE: JULY 22, 1948

APPROVED
Henry Weisberg
ASSOCIATE ENGINEER

APPROVED
James A. DeLoach
HIGHWAYS ENGINEER

APPROVED
Edward J. Hachler
ENGINEER OF SURVEYS

APPROVED
P. L. Hollands
DIRECTOR OF PUBLIC WORKS

892

RATIO - 24 **7**

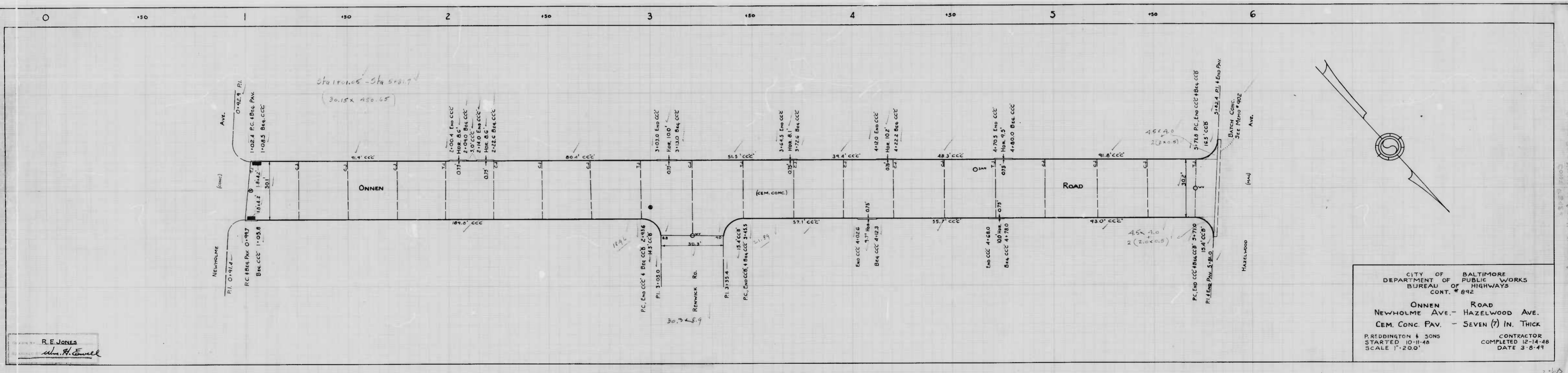

DESIGNED BY
R. E. JONES
 CHECKED BY
Wm. H. Conwell

CITY OF BALTIMORE
 DEPARTMENT OF PUBLIC WORKS
 BUREAU OF HIGHWAYS
 CONT. # 892

ONNEN ROAD
 NEWHOLME AVE. - HAZELWOOD AVE.
 CEM. CONC. PAV. - SEVEN (7) IN. THICK

P. REDDINGTON & SONS
 STARTED 10-11-48
 SCALE 1"=200'

CONTRACTOR
 COMPLETED 12-14-48
 DATE 3-6-49

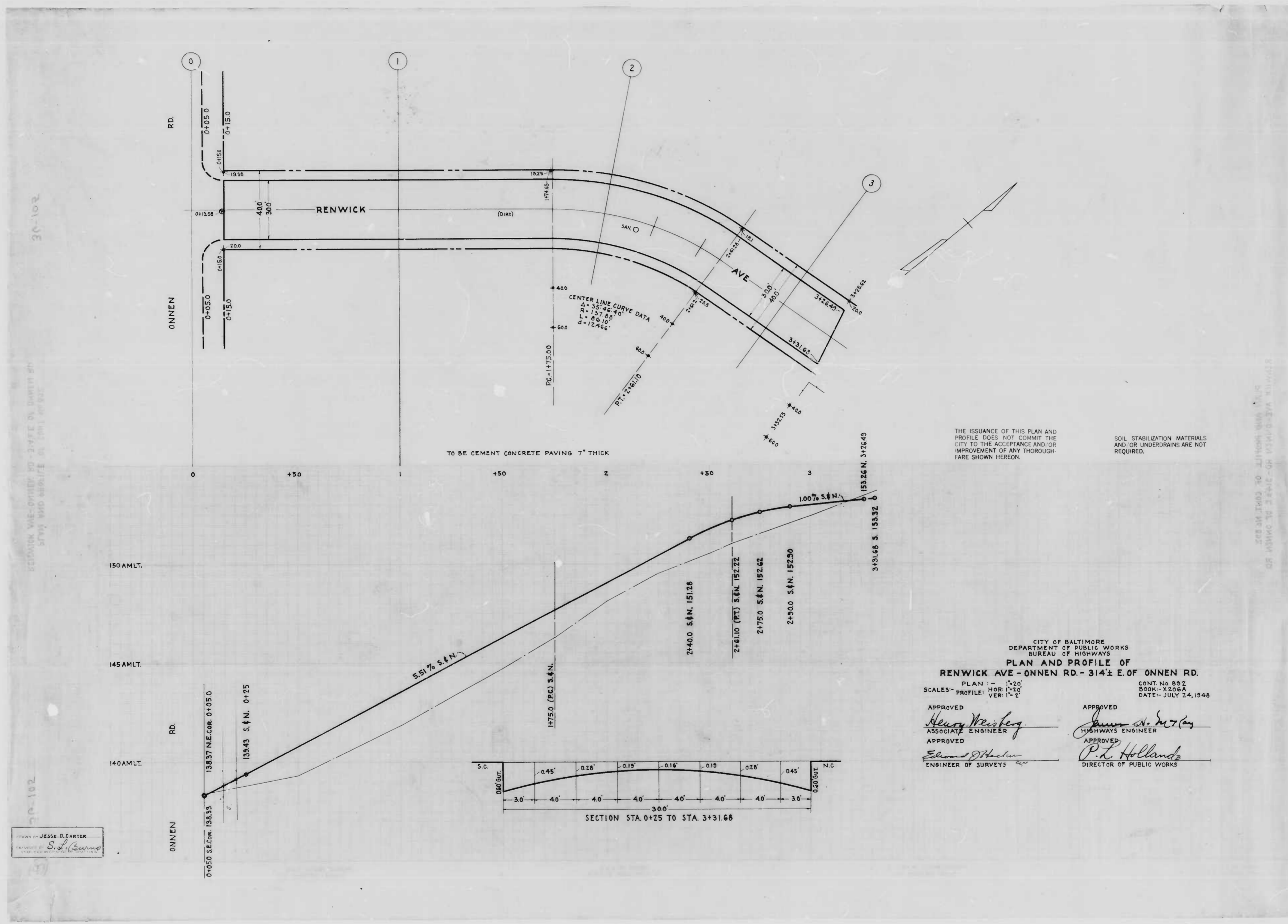

31-102

SECTION AVE-DIVISION RD - 314 1/2 E. OF ONNEN RD. STAY AND ABANDON IN THIS ORDER

31-102

DESIGNED BY JESSE D. CARTER
FOR ENGINEER
S. L. GARDNER

THE ISSUANCE OF THIS PLAN AND PROFILE DOES NOT COMMIT THE CITY TO THE ACCEPTANCE AND/OR IMPROVEMENT OF ANY THROUGHFARE SHOWN HEREON.
SOIL STABILIZATION MATERIALS AND/OR UNDERDRAINS ARE NOT REQUIRED.

CITY OF BALTIMORE
DEPARTMENT OF PUBLIC WORKS
BUREAU OF HIGHWAYS
**PLAN AND PROFILE OF
RENWICK AVE - ONNEN RD. - 314 1/2 E. OF ONNEN RD.**
PLAN: 1"=20'
SCALES: PROFILE: HOR: 1"=20' VER: 1"=2'
CONT. No. 892
BOOK - X206A
DATE - JULY 24, 1948
APPROVED: *Henry Weisberg*
ASSOCIATE ENGINEER
APPROVED: *Edward J. Hatcher*
ENGINEER OF SURVEYS
APPROVED: *James N. Dwyer*
HIGHWAYS ENGINEER
APPROVED: *P.L. Hollands*
DIRECTOR OF PUBLIC WORKS

892

RATIO - 24

10

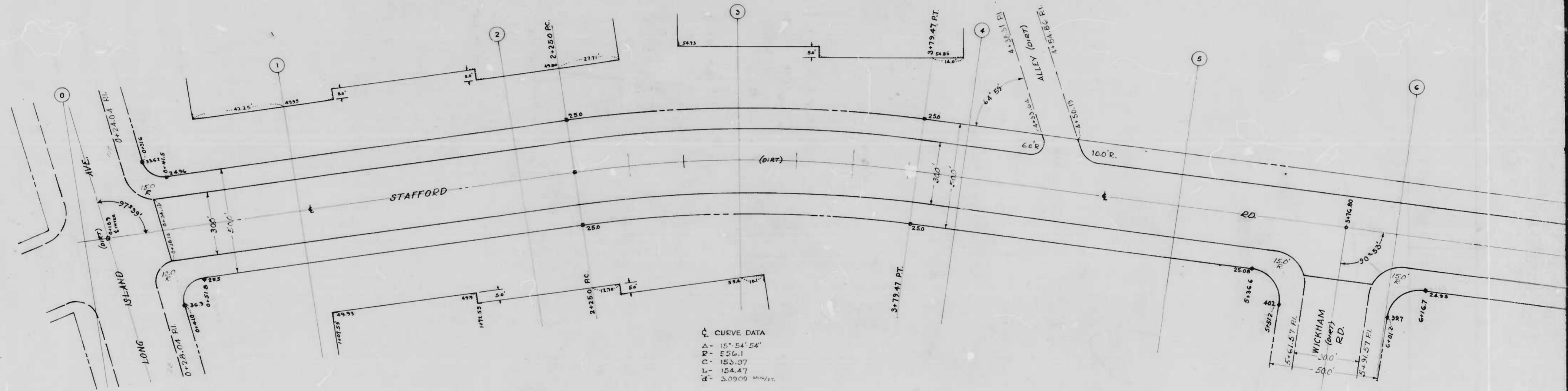

CURVE DATA
A - 15° 54' 54"
R - 556.1
C - 152.07
L - 154.47
d - 3.0909 MIN/FT

DRAWN BY *[Signature]*
EXAMINED BY S.L. BURNS
ENGINEER IN CHARGE OF DRAFTING

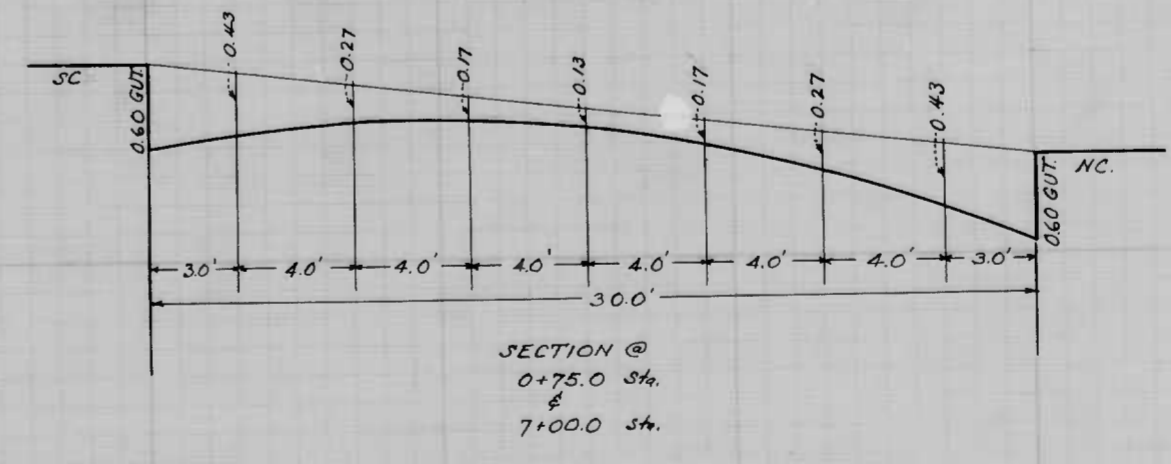
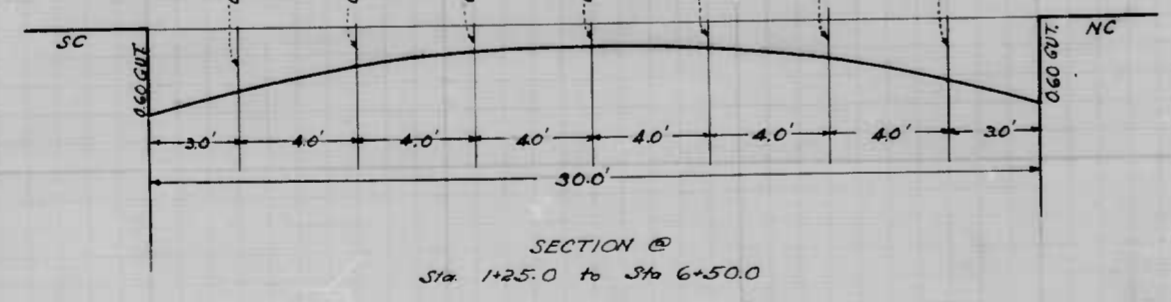
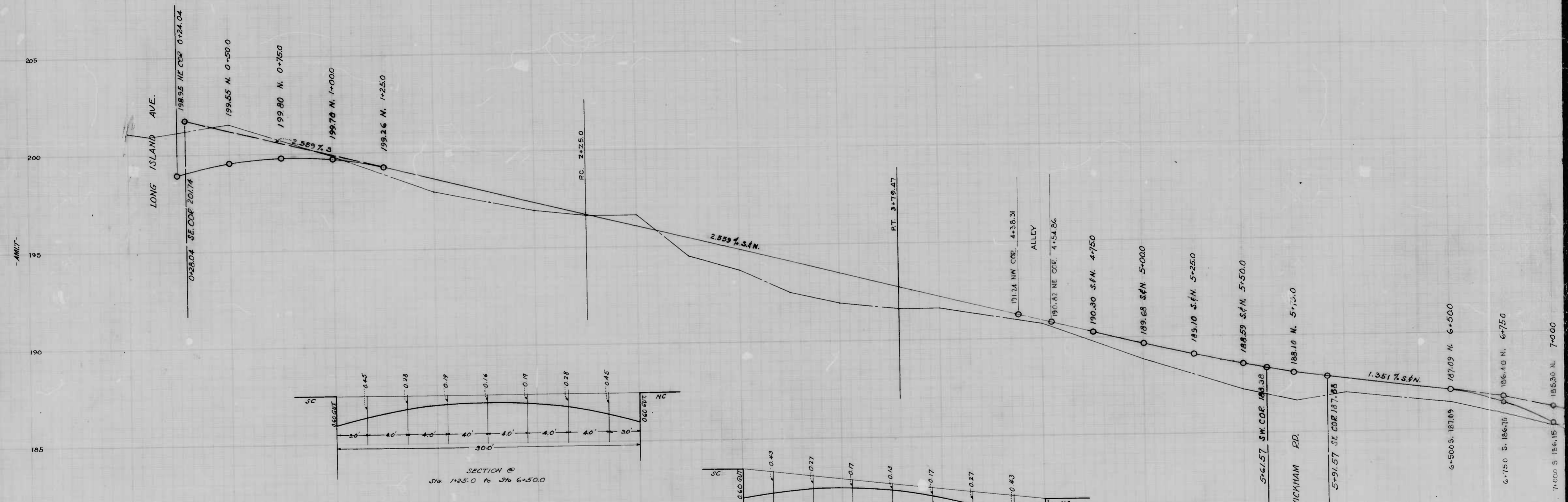

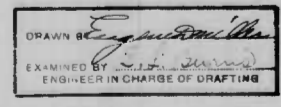

 ENGINEER IN CHARGE OF DRAFTING

892

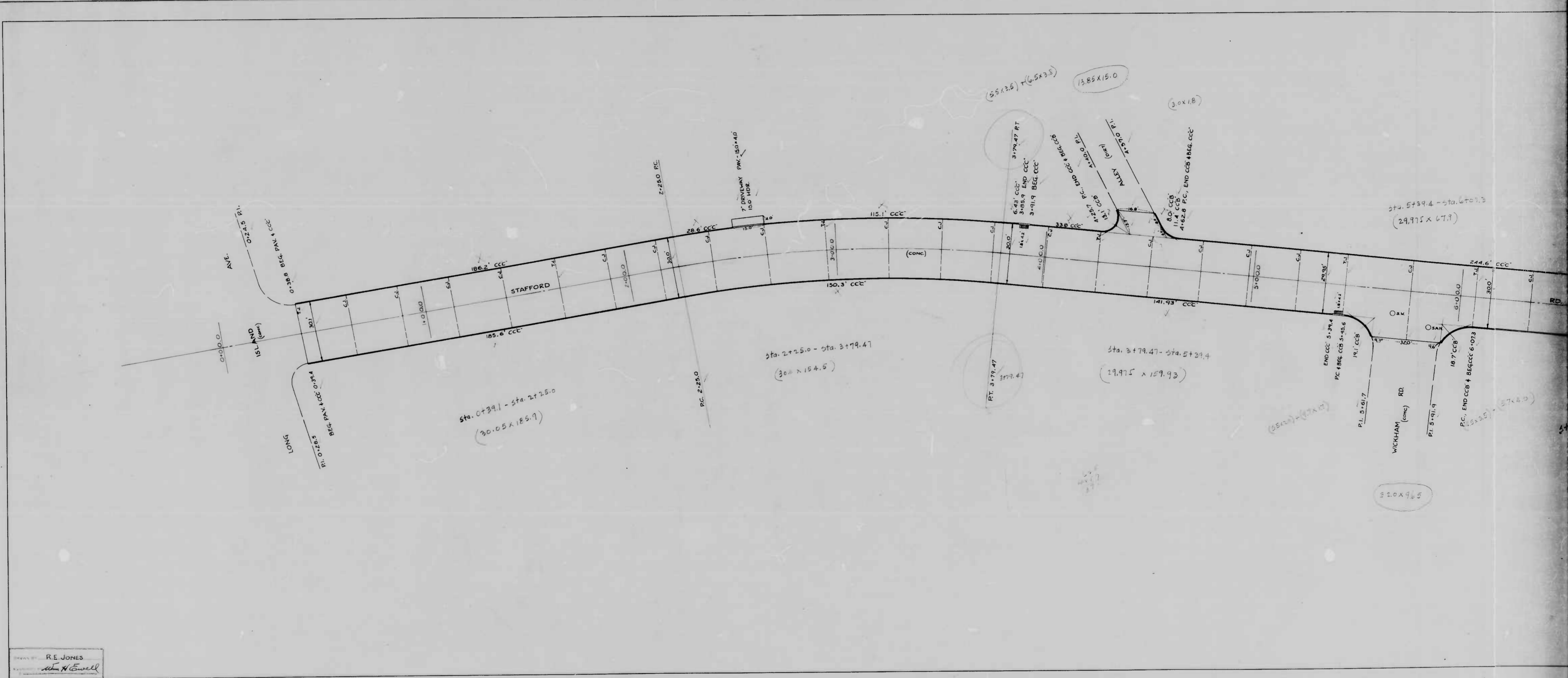
RATIO - 24 **12**

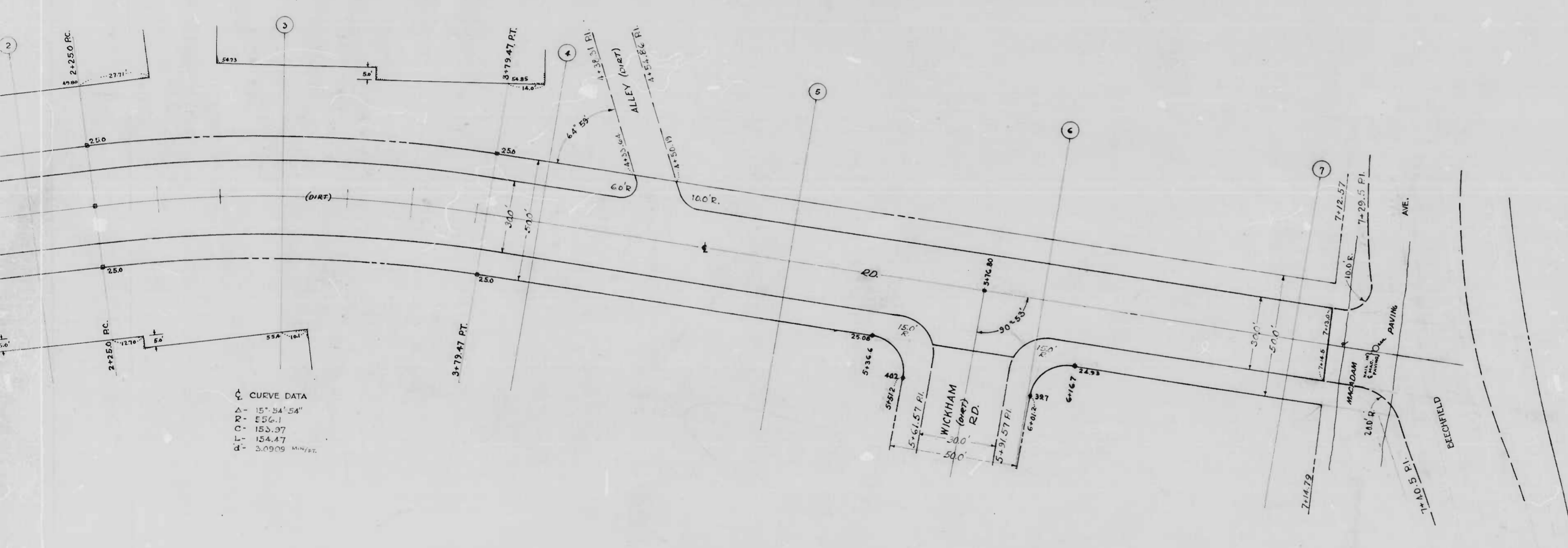

DRAWN BY: R.E. JONES
 CHECKED BY: *[Signature]*
 DATE: *[Date]*



Δ CURVE DATA

Δ	15° 54' 54"
R	152.61
C	152.97
L	154.47
d	0.0909 MIN/FT.

Note:
 THE ISSUANCE OF THIS PLAN DOES NOT COMMIT THE CITY TO THE ACCEPTANCE AND/OR IMPROVEMENT OF ANY THROUGHFARE SHOWN HEREON.
 SOIL STABILIZATION MATERIALS AND/OR UNDERDRAINS ARE NOT REQUIRED.
 TO BE CEM. CONC. PAVING SEVEN (7") INCHES IN DEPTH.

CITY OF BALTIMORE
 DEPARTMENT OF PUBLIC WORKS
 BUREAU OF HIGHWAYS
 PLAN
 STAFFORD RD - LONG ISLAND AVE - BEECHFIELD AVE.
 SCALE 1"=200' BOOK 1243
 DATE JUNE 15, 1948 CONT. 892

APPROVED - *Henry Weisberg* ASSOCIATE ENGINEER
 APPROVED - *James H. Jones* HIGHWAYS ENGINEER
 APPROVED - *Edward M. ...* ENGR. OF SURVEYS
 APPROVED - *P. P. Hollander* DIRECTOR OF PUBLIC WORKS

892

RATIO - 24

11

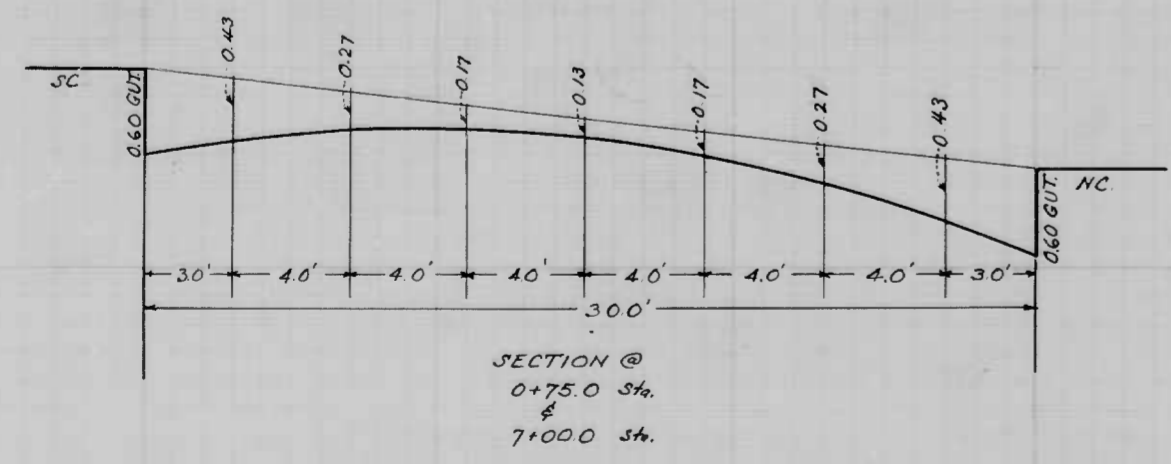
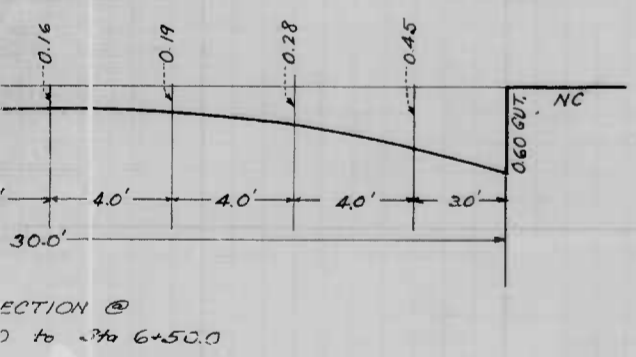
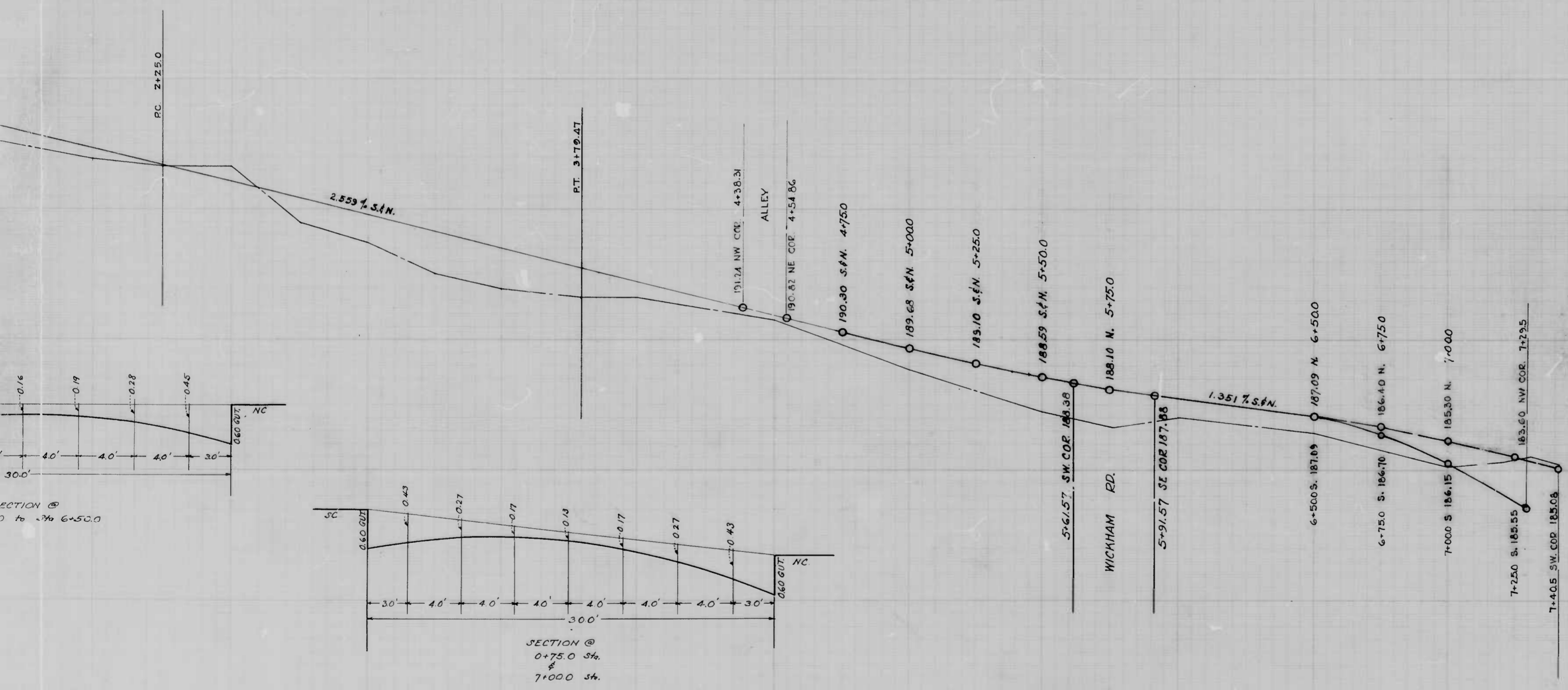

THE ISSUANCE OF THIS PROFILE DOES NOT COMMIT THE CITY TO THE ACCEPTANCE AND/OR IMPROVEMENT OF ANY THOROUGHFARE SHOWN HEREON.

CITY OF BALTIMORE
DEPARTMENT OF PUBLIC WORKS
BUREAU OF HIGHWAYS
PROFILE
STAFFORD RD. - LONG ISLAND AVE. - BEECHFIELD AVE.
HOR 1"=20' BOOK X-234
VER 1"=20' CONT No. 892 DATE JUNE 15, 1948

APPROVED -
Henry Weislog
ASSOCIATE ENGINEER

APPROVED -
Edward J. Hecker
ENGR OF SURVEYS

APPROVED -
Wm. C. ...
HIGHWAYS ENGINEER

APPROVED -
P. L. Holland
DIRECTOR OF PUBLIC WORKS

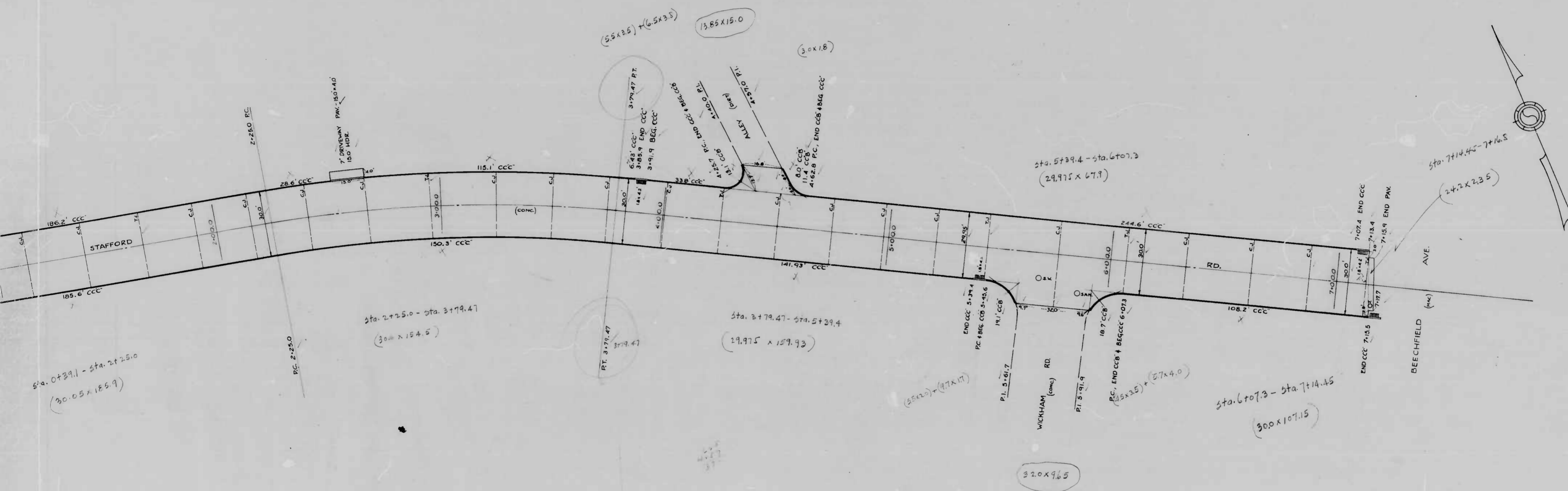

CITY OF BALTIMORE
 DEPARTMENT OF PUBLIC WORKS
 BUREAU OF HIGHWAYS
 CONT. # 892

STAFFORD RD.
 LONG ISLAND AVE. - BEECHFIELD AVE.
 CEM. CONC. PAV. - SEVEN (7) IN. THICK

P. REDDINGTON & SONS
 STARTED 3-30-49
 SCALE 1"=20.0'

CONTRACTOR
 COMPLETED 5-6-49
 DATE 6-29-49

892

RATIO - 24

13

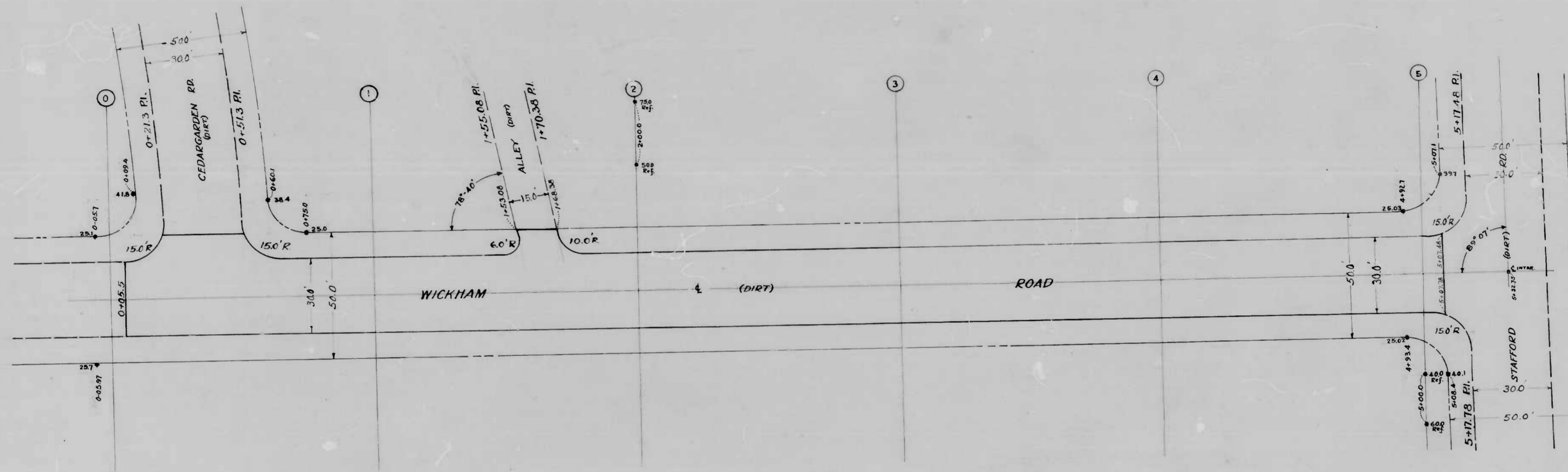

Drawn by *Robert M. Smith*
Engineer
In Charge of Drafting

892

RATIO - 24

14

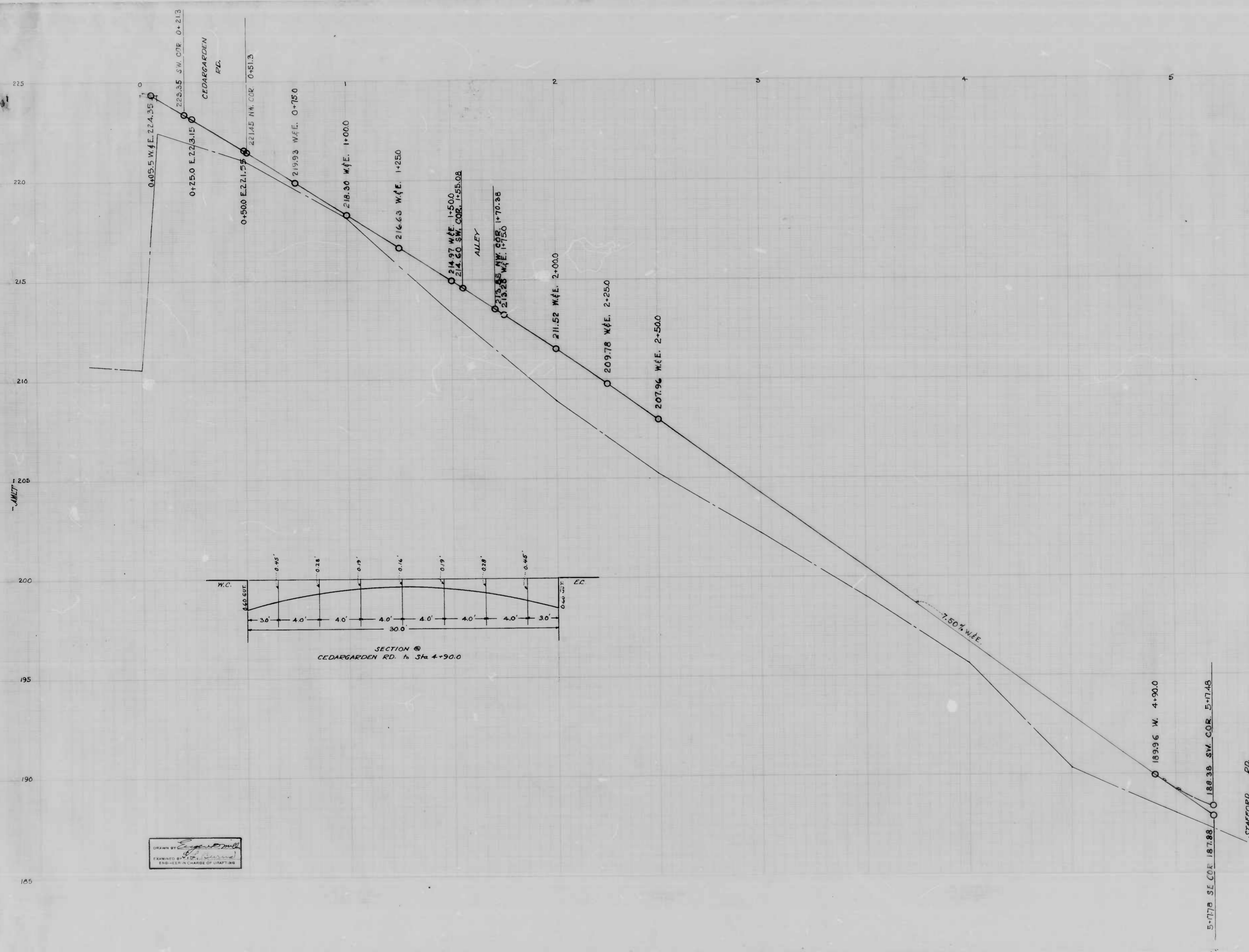

THE ISSUANCE OF THIS PROFILE DOES NOT COMMIT THE CITY TO THE ACCEPTANCE AND OR IMPROVEMENT OF ANY THOROUGHFARE SHOWN HEREON.

CITY OF BALTIMORE
DEPARTMENT OF PUBLIC WORKS
BUREAU OF HIGHWAYS
Profile
WICKHAM RD - CEDARGARDEN RD - STAFFORD RD
HOR 1" = 200' BOOK X-243
VER 1" = 2.0' CONT'N 892 DATE JUNE 14, 1948

APPROVED - APPROVED -
Henry Mackay *James H. ...*
ASSOCIATE ENGINEER HIGHWAYS ENGINEER
APPROVED - APPROVED -
Charles H. ... *D. H. ...*
ENGINEER OF SURVEYS DIRECTOR OF PUBLIC WORKS

DRAWN BY *[Signature]*
EXAMINED BY *[Signature]*
ENGINEER IN CHARGE OF DRAFTING

892

RATIO - 24

15

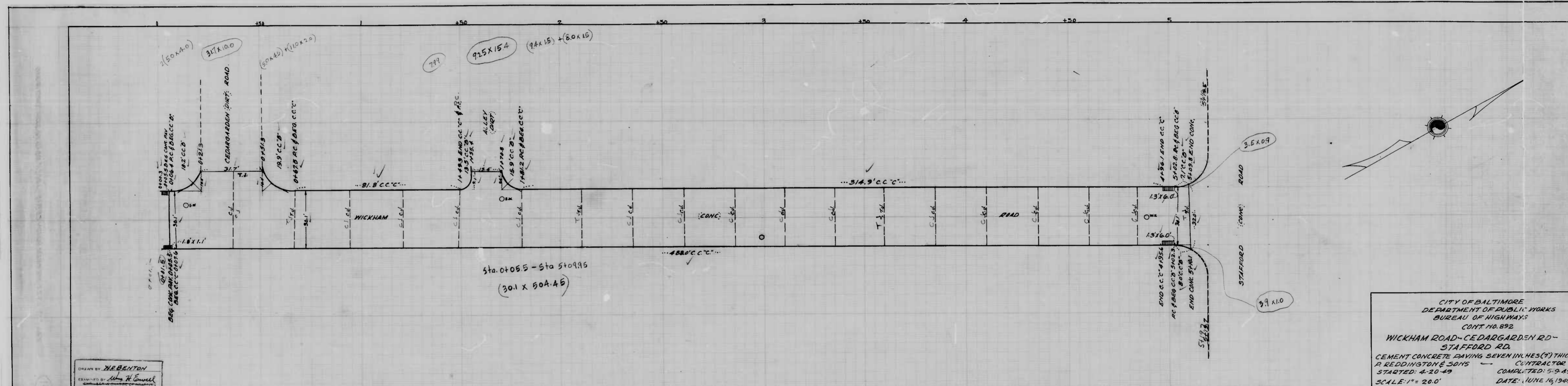

DRAWN BY: H. BENTON
 EXAMINED BY: H. Council

CITY OF BALTIMORE
 DEPARTMENT OF PUBLIC WORKS
 BUREAU OF HIGHWAYS
 CONT NO. 892
 WICKHAM ROAD - CEDARGARDEN RD -
 STAFFORD RD.
 CEMENT CONCRETE PAVING SEVEN INCHES (7) THICK
 R. REDDINGTON & SONS CONTRACTOR
 STARTED: 4-20-49 COMPLETED: 5-9-49
 SCALE: 1" = 20.0' DATE: JUNE 16, 1949

892

RATIO - 24

1 3

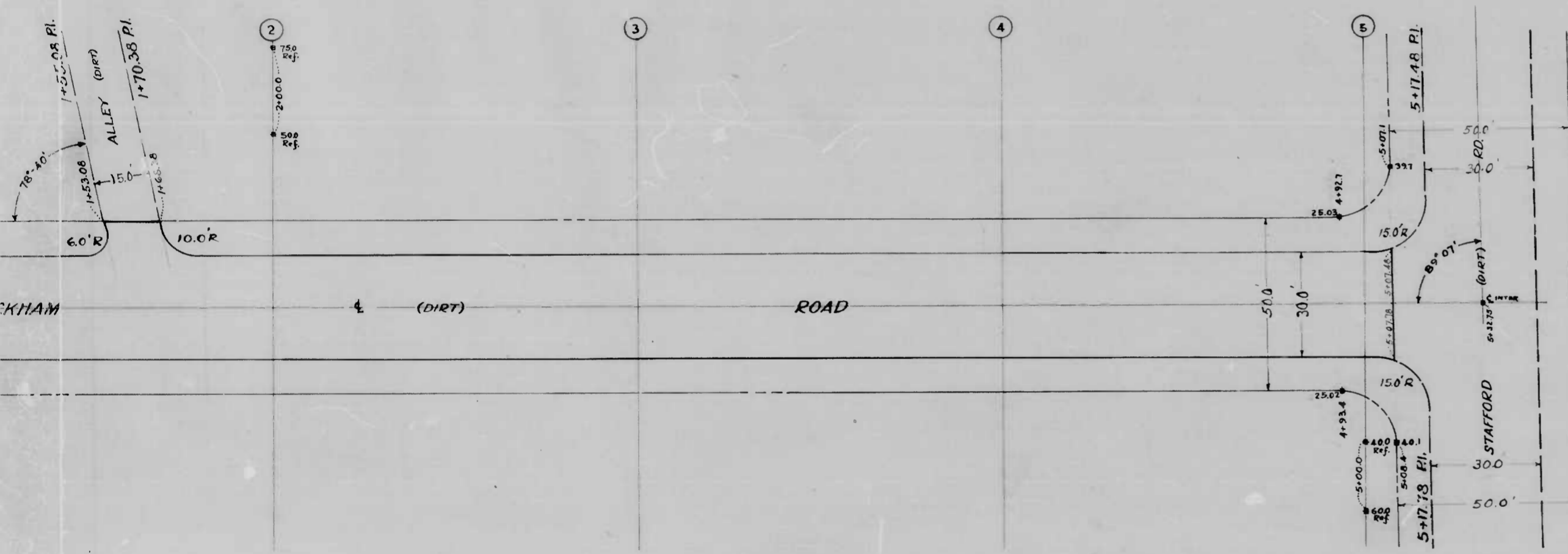

THE ISSUANCE OF THIS PLAN DOES NOT COMMIT THE CITY TO THE ACCEPTANCE AND OR IMPROVEMENT OF ANY THOROUGHFARE SHOWN HEREON.

SOIL STABILIZATION MATERIALS AND OR UNDERDRAINS ARE NOT REQUIRED.

TO BE CEMENT CONCRETE PAVING SEVEN (7") INCHES IN DEPTH.

CITY OF BALTIMORE
DEPARTMENT OF PUBLIC WORKS
BUREAU OF HIGHWAYS

PLAN OF
WICKHAM RD. "CEDARGARDEN RD." STAFFORD RD.
SCALE 1"=200' BOOK 1243
DATE JUNE 14, 1948 CONT #892

APPROVED -

Henry Weisberg
ASSOCIATE ENGINEER

APPROVED -

Edward J. Hecker
ENGINEER OF SURVEYS

APPROVED -

James M. [unclear]
HIGHWAYS ENGINEER

APPROVED -

P. L. Hollands
DIRECTOR OF PUBLIC WORKS

1 shot

2 shot

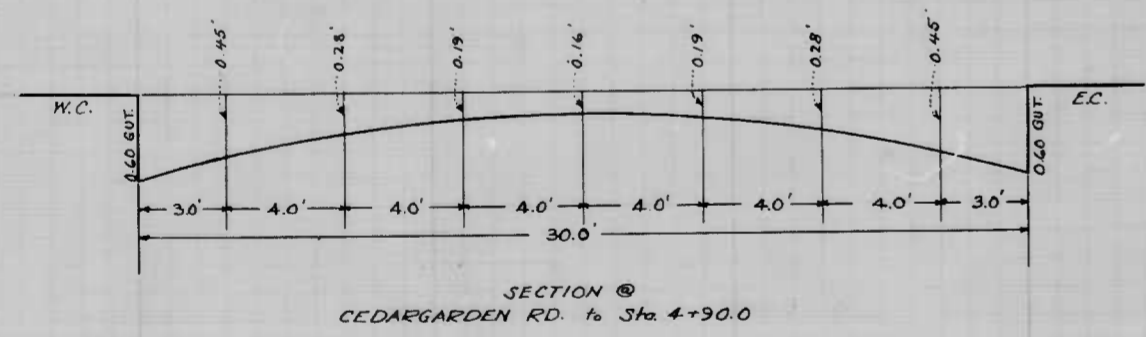
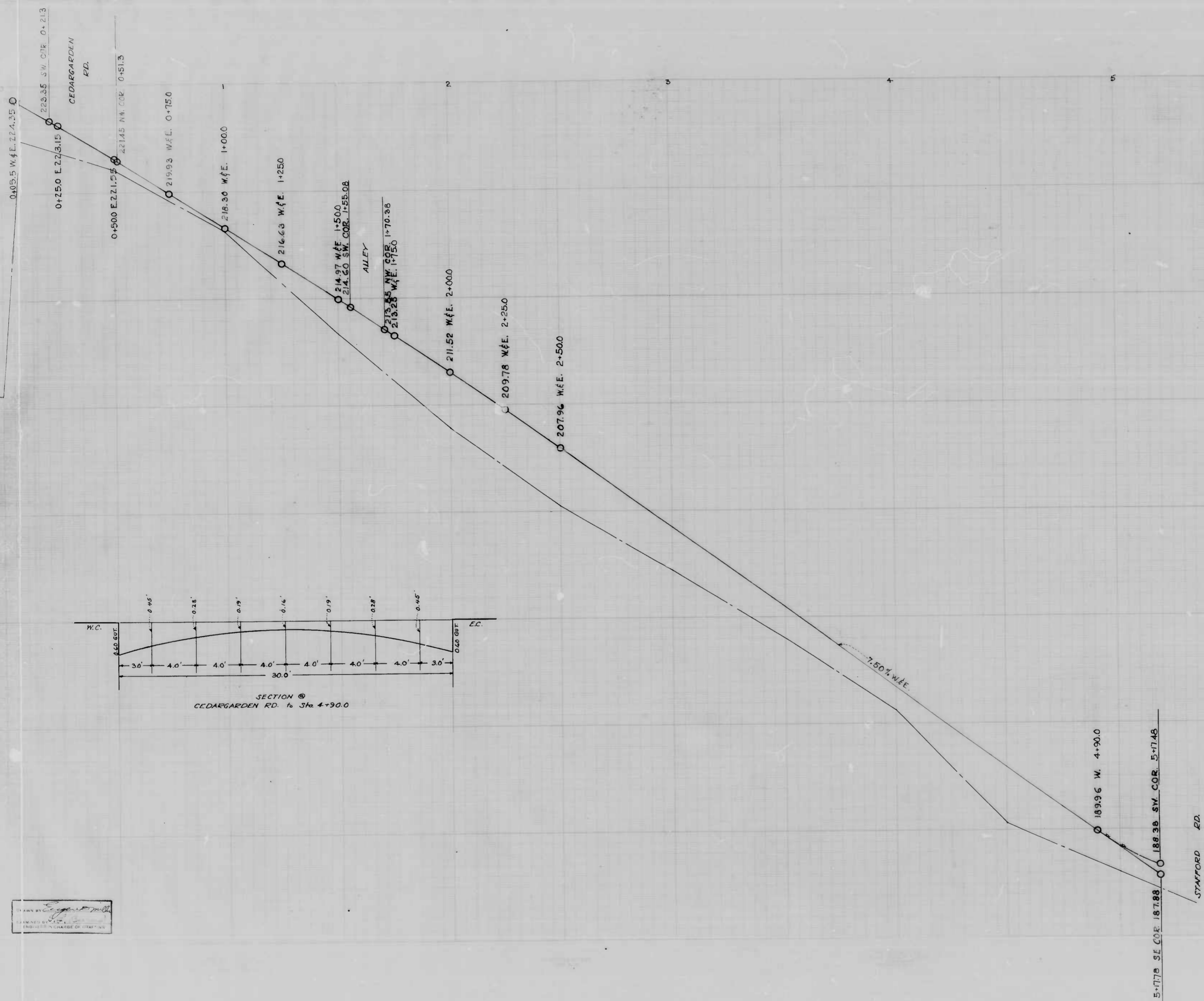

THE ISSUANCE OF THIS PROFILE DOES NOT COMMIT THE CITY TO THE ACCEPTANCE AND OR IMPROVEMENT OF ANY THOROUGHFARE SHOWN HEREON.

CITY OF BALTIMORE
 DEPARTMENT OF PUBLIC WORKS
 BUREAU OF HIGHWAYS
 PROFILE
 WICKHAM RD. - CEDARGARDEN RD. - STAFFORD RD.
 HOR 1" = 200' BOOK X-243
 VERT 1" = 2.0' CONT'N 892 DATE JUNE 14, 1948

APPROVED - *Henry Weisberg* ASSOCIATE ENGINEER
 APPROVED - *James G. Kelly* HIGHWAYS ENGINEER
 APPROVED - *Shirley M. Hollander* ENGINEER OF SURVEYS
 APPROVED - *P. L. Holland* DIRECTOR OF PUBLIC WORKS

DRAWN BY *[Signature]*
 CHECKED BY *[Signature]*
 ENGINEER IN CHARGE OF DISTRICT

892

RATIO - 24

15

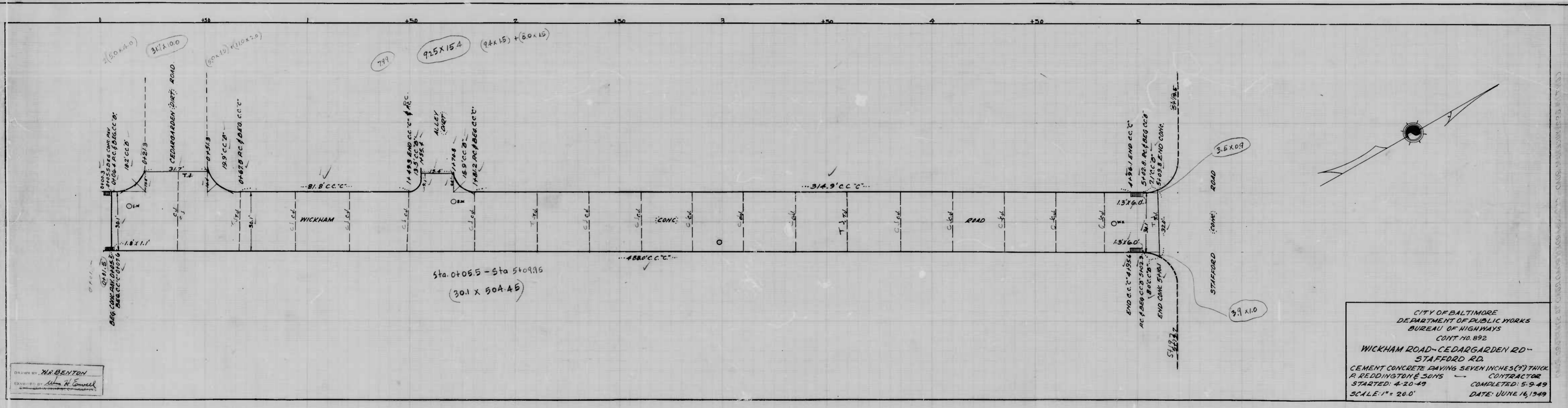

DRAWN BY: W. BENTON
 EXAM. BY: John H. Connel

CITY OF BALTIMORE
 DEPARTMENT OF PUBLIC WORKS
 BUREAU OF HIGHWAYS
 CONT. NO. 892
 WICKHAM ROAD - CEDARGARDEN RD -
 STAFFORD RD.
 CEMENT CONCRETE PAVING SEVEN INCHES (7") THICK
 R. REDDINGTON & SONS CONTRACTOR
 STARTED: 4-20-49 COMPLETED: 5-9-49
 SCALE: 1" = 20.0' DATE: JUNE 16, 1949

1560

2 5107