

871

RATIO - 24

1

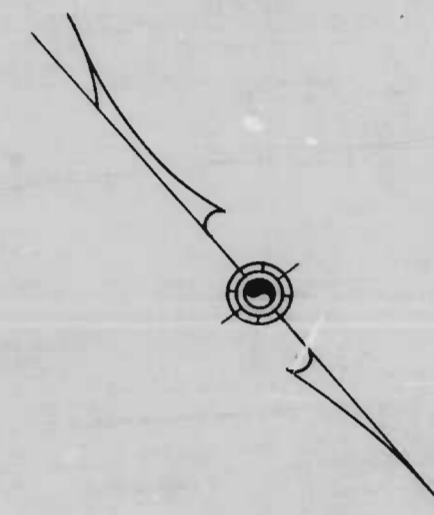
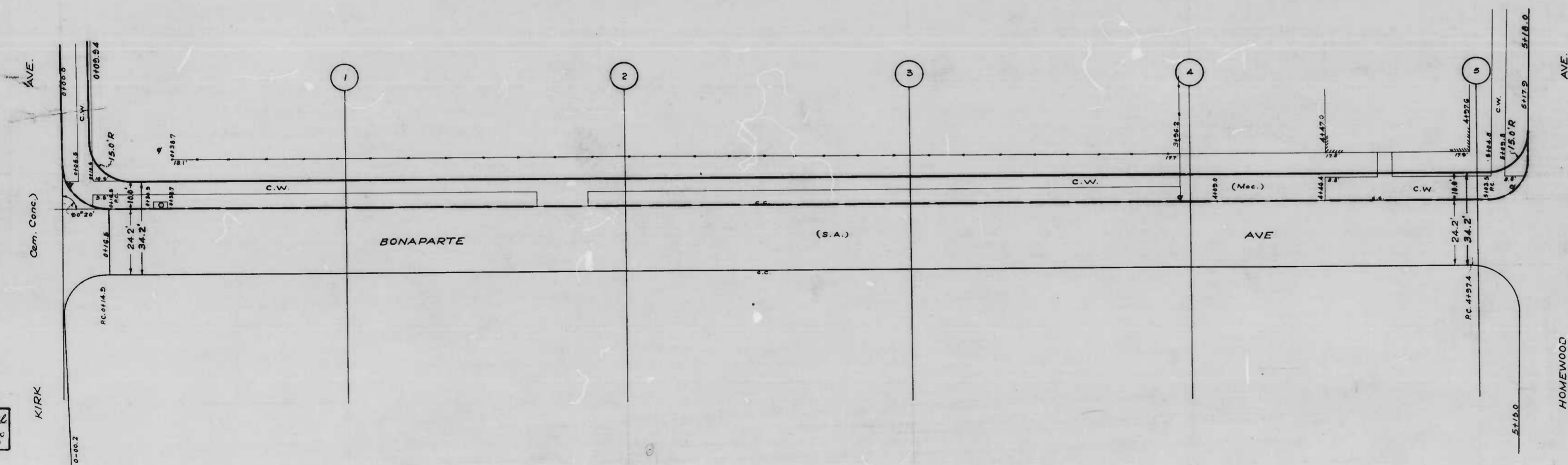

CITY OF BALTIMORE  
 DEPARTMENT OF PUBLIC WORKS  
 BUREAU OF HIGHWAYS  
 PLAN OF  
 BONAPARTE AVE. - KIRK AVE. - HOMEWOOD AVE.  
 Scale - 1" = 20.0' Book No 225 Date - Oct. 22, 1947.  
 Cont. No 871

APPROVED  
*Henry Weisberg*  
 ASSOCIATE ENGINEER

APPROVED  
*James H. McKay*  
 HIGHWAYS ENGINEER

APPROVED  
*Edward Whelan*  
 ENGR. OF SURVEYS

APPROVED  
*Robert R. Smith*  
 DIRECTOR OF PUBLIC WORKS

DRAWN BY: *Wm. A. Ewell*  
 EXAMINED BY: *S. L. Burns*  
 ENGINEER IN CHARGE OF DRAFTING

266

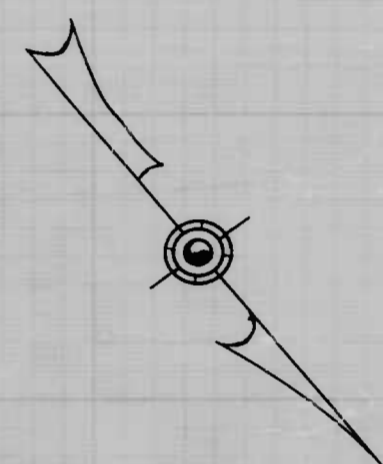
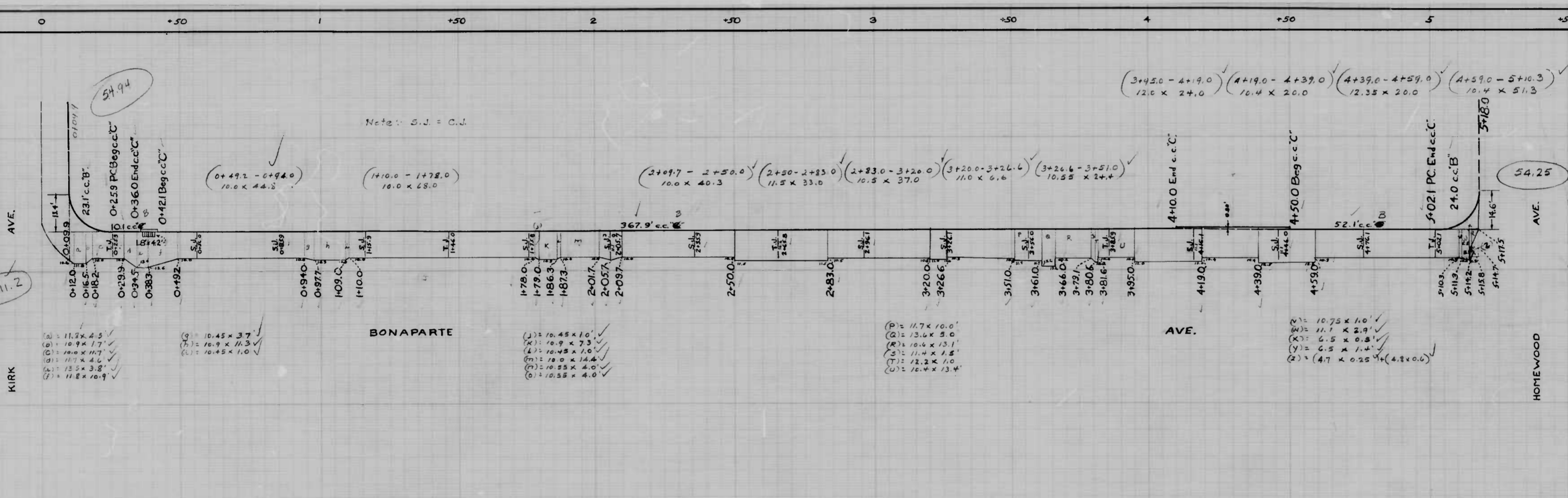

CITY OF BALTIMORE  
 DEPARTMENT OF PUBLIC WORKS  
 BUREAU OF HIGHWAYS  
 CONT. NO. 871  
 BONAPARTE AVE-KIRK AVE-HOMEWOOD AVE.  
 CEMENT CONCRETE PAVING SEVEN INCHES THICK  
 TRINITY BUILDING & CONST. CO. INC.-CONTRACTORS  
 STARTED-4-26-48 COMPLETED-5-12-48  
 SCALE 1"=20.0' Date 7-16-48

DRAWN BY *John J. Caprio*  
 CHECKED BY *Wm. H. Cowell*

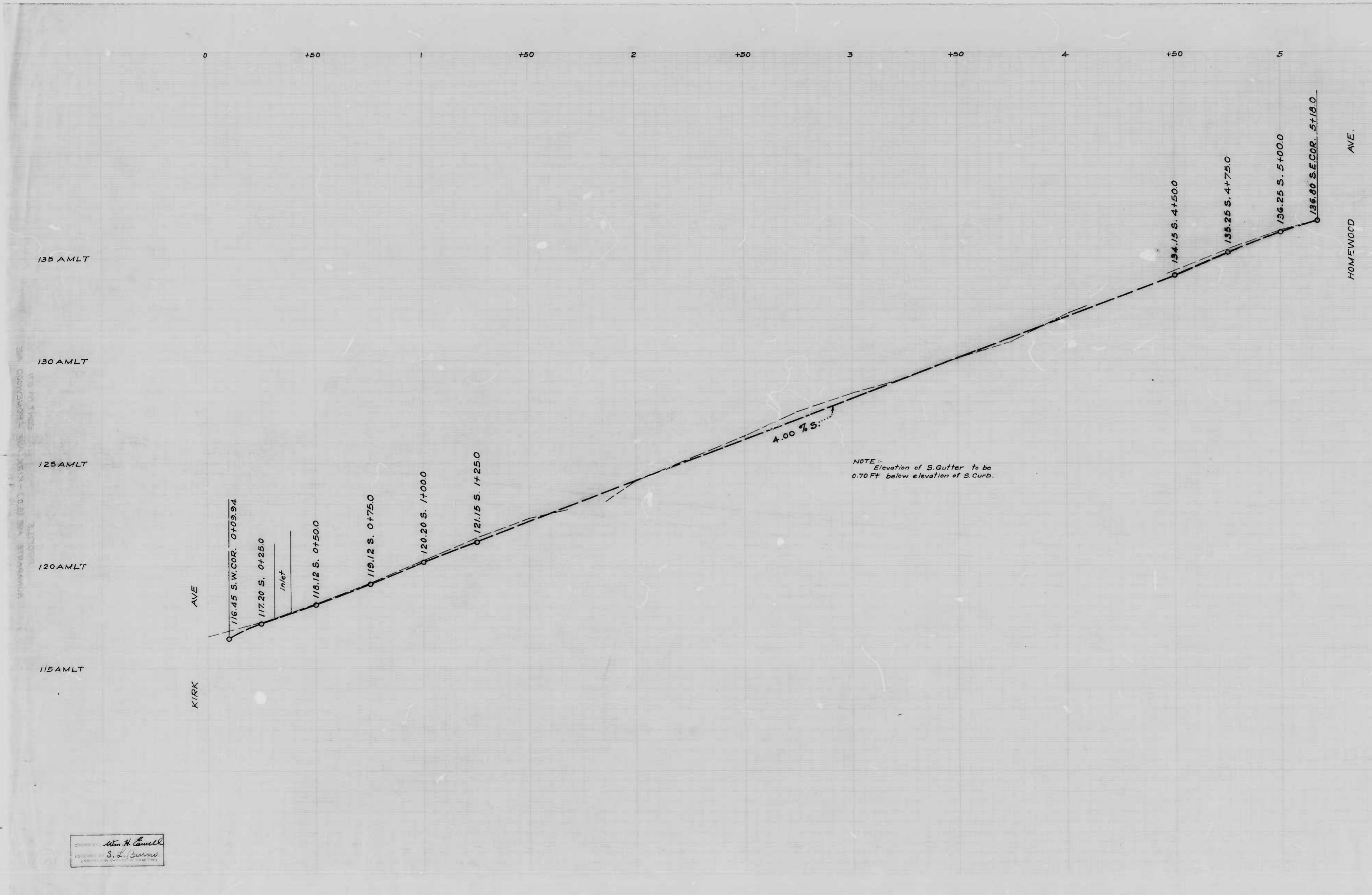

NOTE: Elevation of S. Gutter to be 0.70 Ft below elevation of S. Curb.

CITY OF BALTIMORE  
 DEPARTMENT OF PUBLIC WORKS  
 BUREAU OF HIGHWAYS  
 PROFILE OF  
 BONAPARTE AVE. (S.W.) - KIRK AVE - HOMEWOOD AVE.  
 Scale: Hor. 1" = 20', Ver. 1" = 20', Date: Oct. 23, 1923, Cont. No. 871

APPROVED: *Henry Weisberg*  
 ASSOCIATE ENGINEER

APPROVED: *James S. Jones*  
 HIGHWAYS ENGINEER

APPROVED: *Edward Freeman*  
 ENGINEER OF SURVEYS

APPROVED: *Walter R. Smith*  
 DIRECTOR OF PUBLIC WORKS

Drawn by *Wm. H. Cowell*  
 Checked by *S. L. Curran*

871

RATIO - 24

3

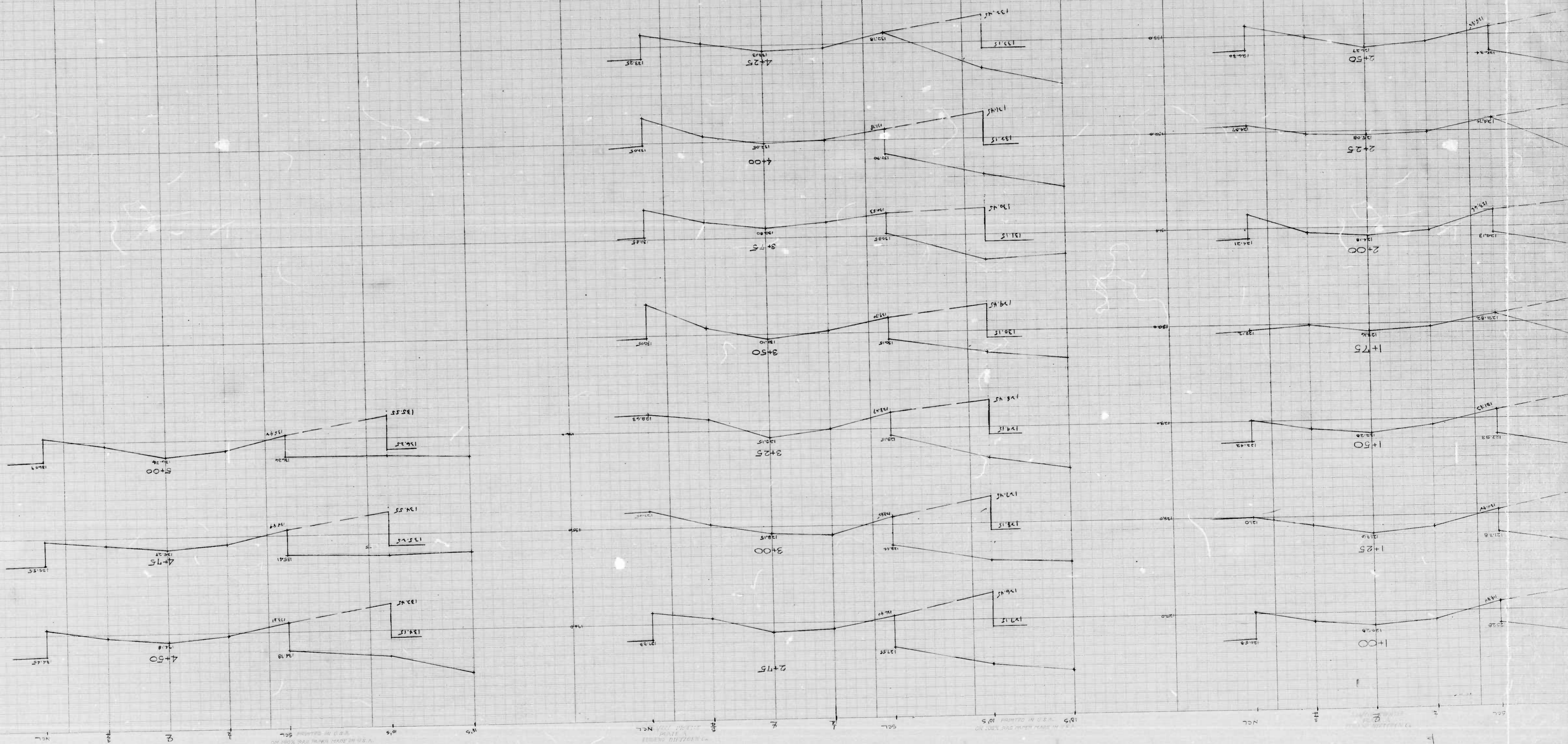

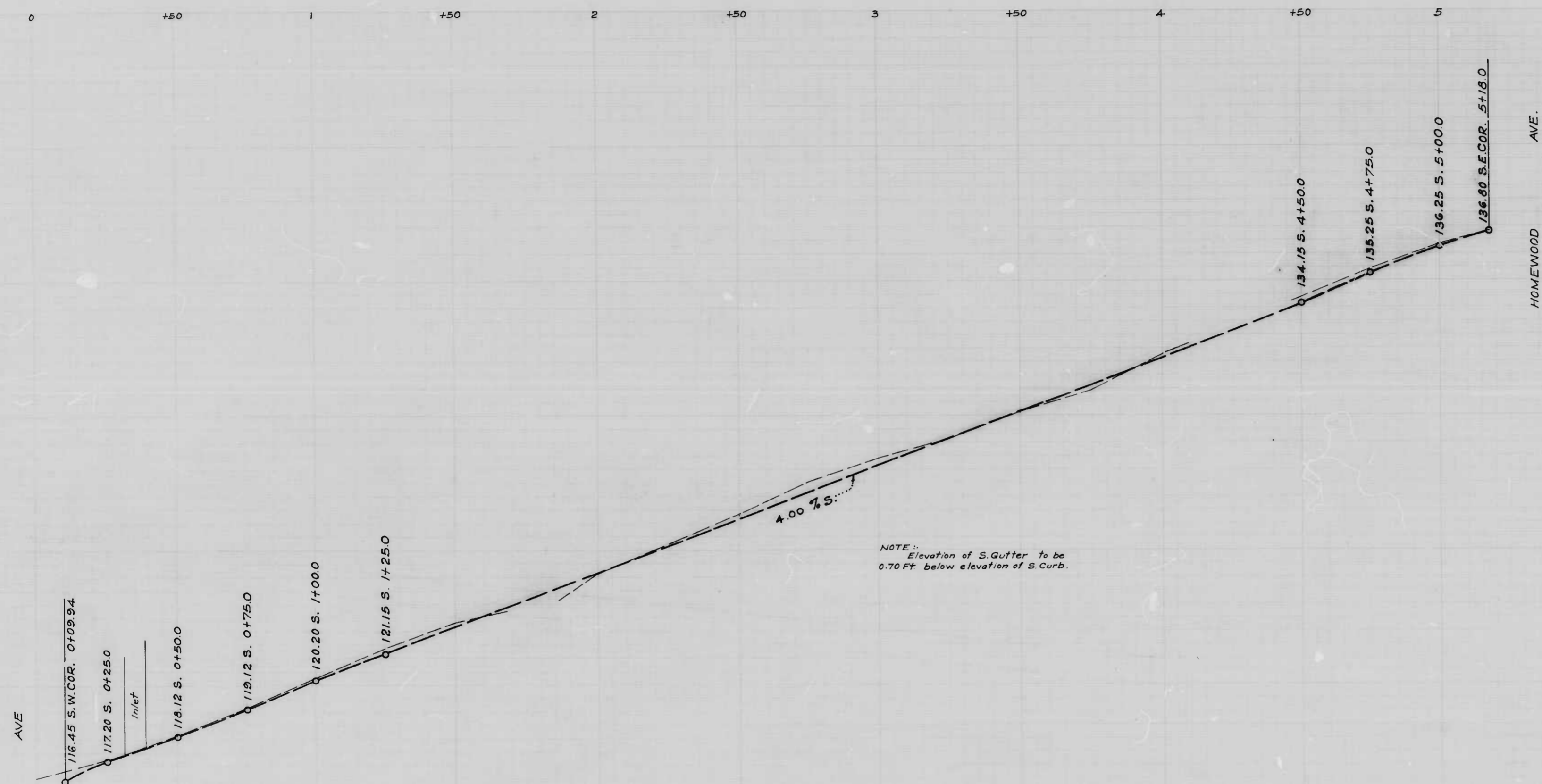

NOTE: Elevation of S. Gutter to be 0.70 Ft. below elevation of S. Curb.

CITY OF BALTIMORE  
 DEPARTMENT OF PUBLIC WORKS  
 BUREAU OF HIGHWAYS  
 PROFILE OF  
 BONAPARTE AVE. (S.S.) - KIRK AVE. - HOMEWOOD AVE.  
 Hor. : 1" = 20'  
 Scale : Ver. : 1" = 20' Date : Oct. 23, 1947.  
 Cont. No 871

APPROVED  
*Henry Weisberg*  
 ASSOCIATE ENGINEER  
 APPROVED

APPROVED  
*James H. Deegan*  
 HIGHWAYS ENGINEER  
 APPROVED

*Edward Freeman*  
 ENGINEER OF SURVEYS

*Nath R. Smith*  
 DIRECTOR OF PUBLIC WORKS

*H. Carroll*  
*L. Curran*

871

RATIO - 24

3

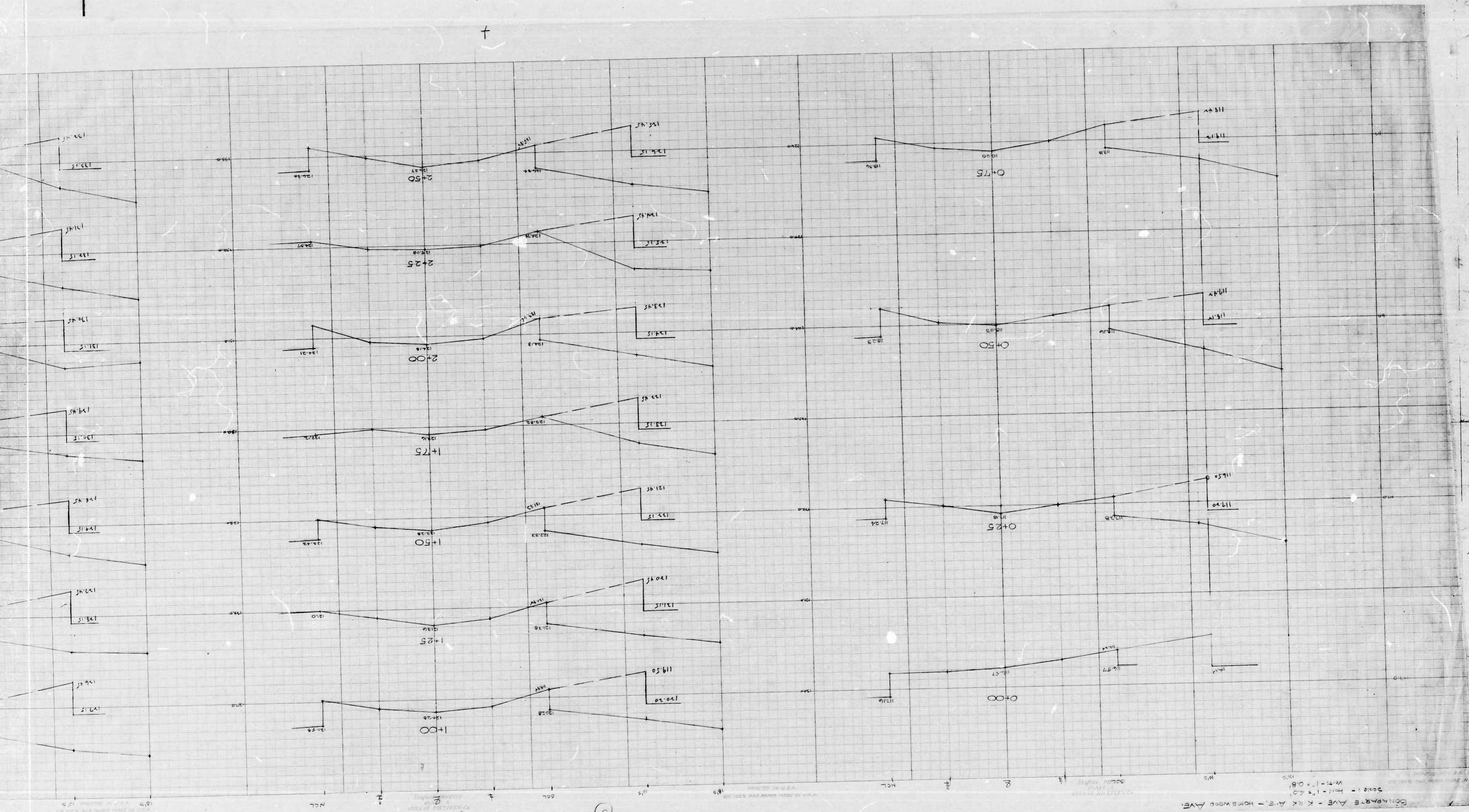

871

RATIO - 24

8

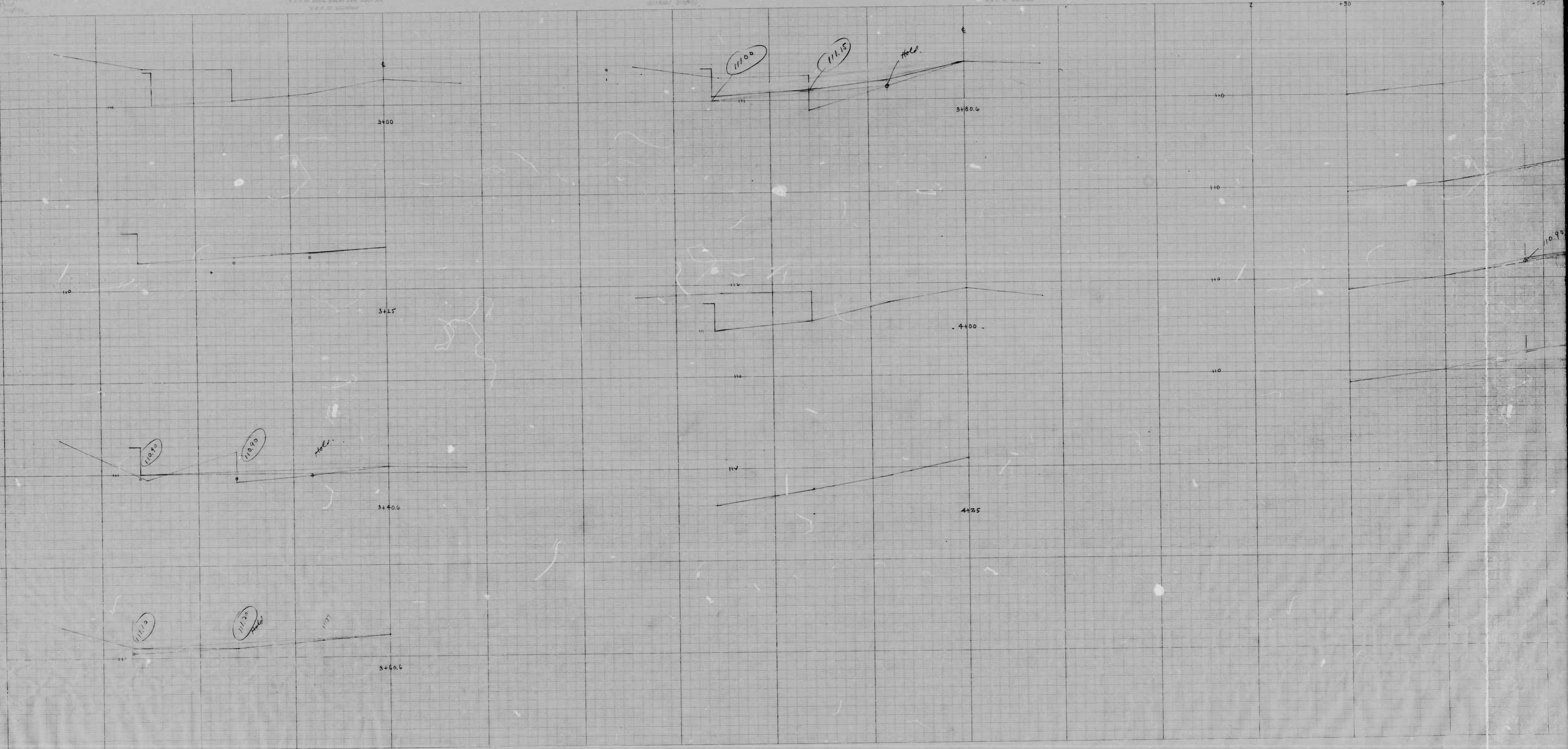

871

RATIO - 24

8

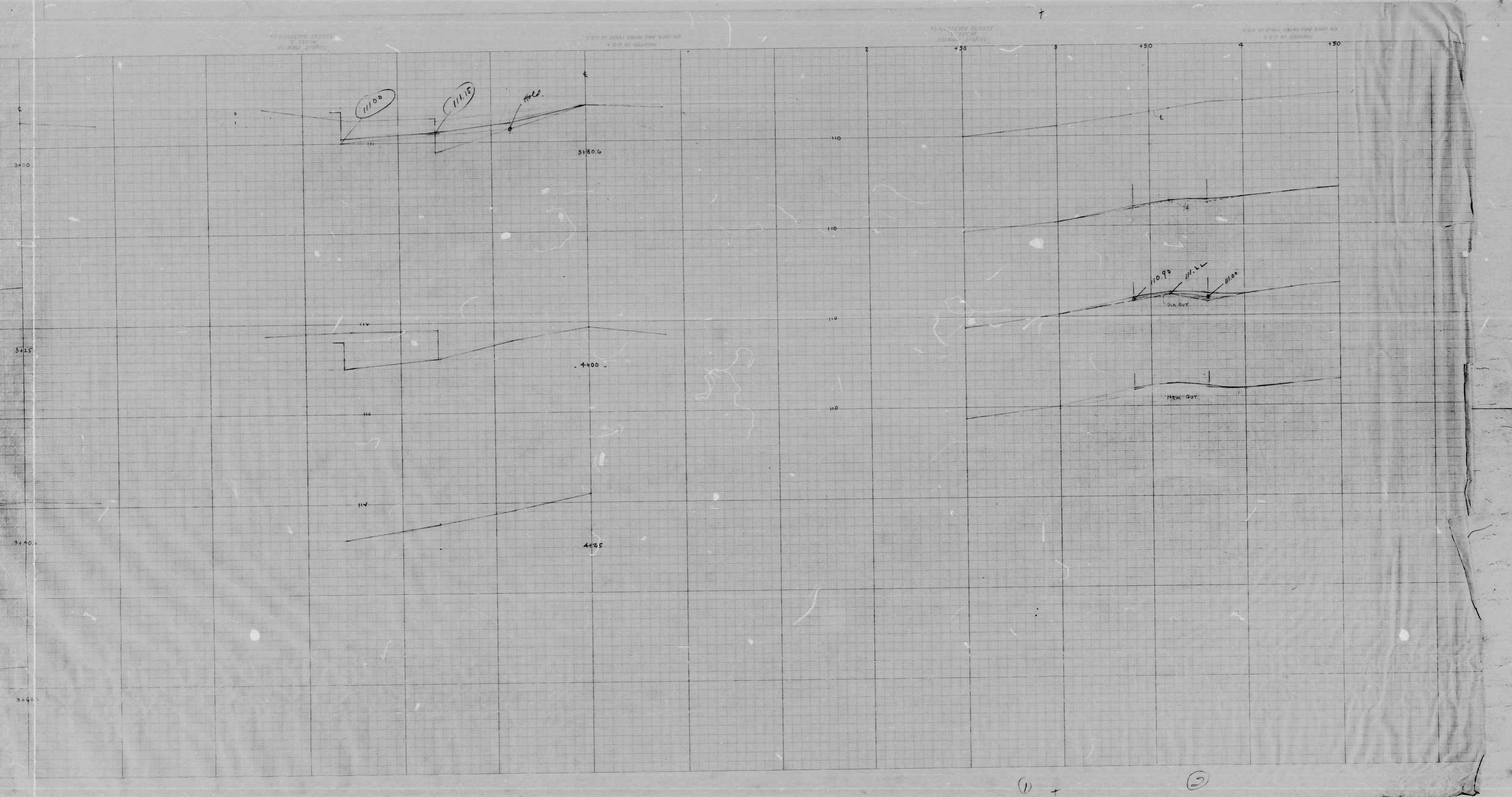



871

RATIO - 24

5

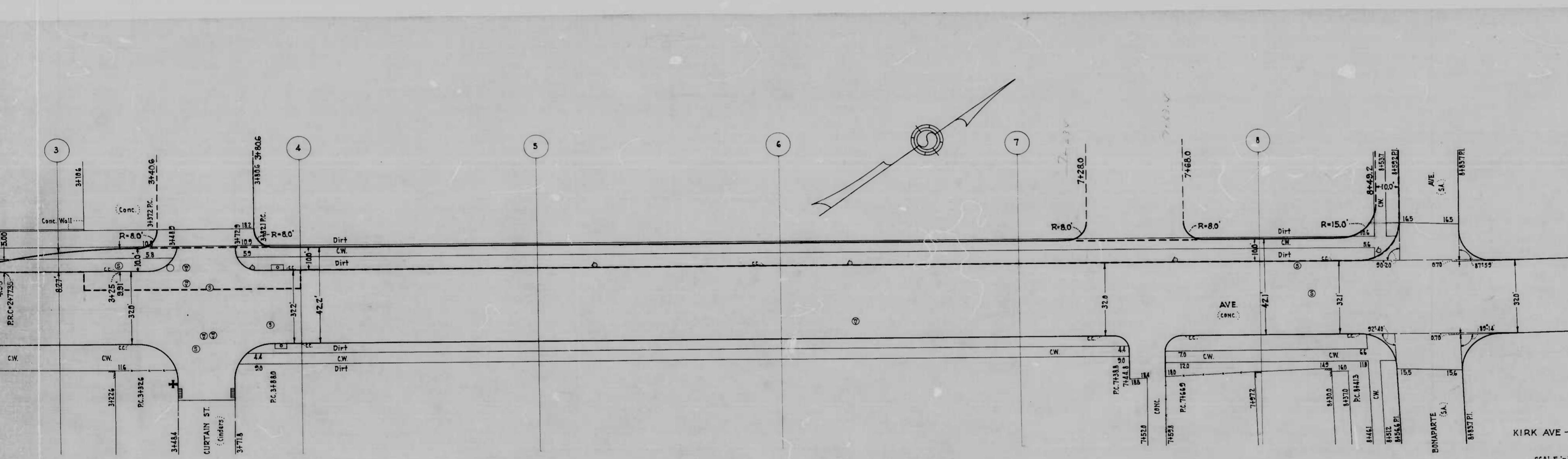

CITY OF BALTIMORE  
 DEPARTMENT OF PUBLIC WORKS  
 BUREAU OF HIGHWAYS  
 PLAN OF  
 KIRK AVE - 210'± NORTH OF BARTLETT AVE - BONAPARTE AVE.  
 CONT. NO. 871

SCALE: 1" = 20.0'  
 BOOK NO. X-227  
 DATE: OCT. 28, 1947

APPROVED: *Henry Weisberg* ASSOCIATE ENGINEER.  
 APPROVED: *James H. ...* HIGHWAYS ENGINEER.

APPROVED: *Edward ...* ENGINEER OF SURVEYS.  
 APPROVED: *William ...* DIRECTOR OF PUBLIC WORKS.



871

RATIO - 24

7

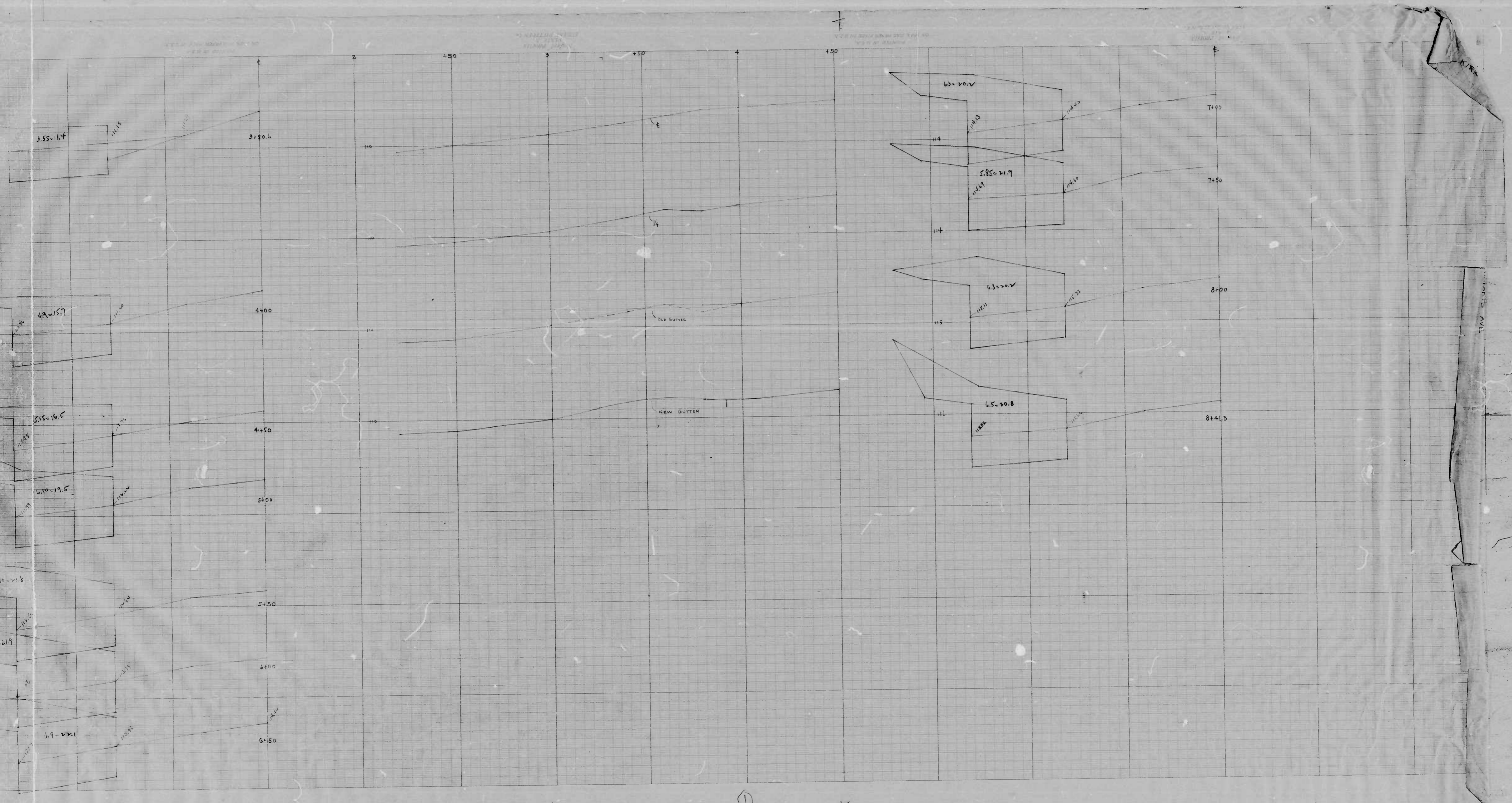

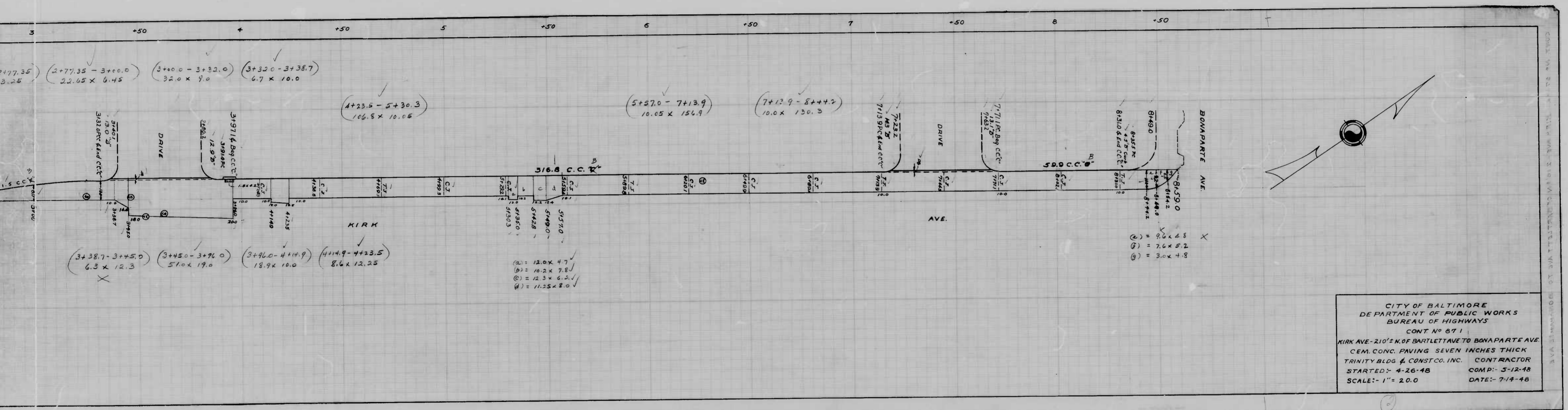

871

RATIO - 24

5

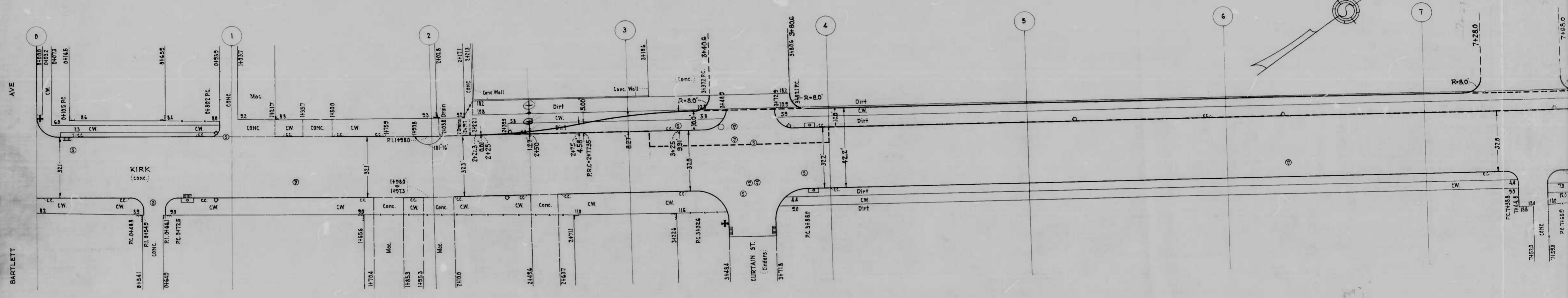

DESIGNED BY JESSE D. CARTER  
DRAWN BY S. L. CARTER

871

RATIO - 24

6

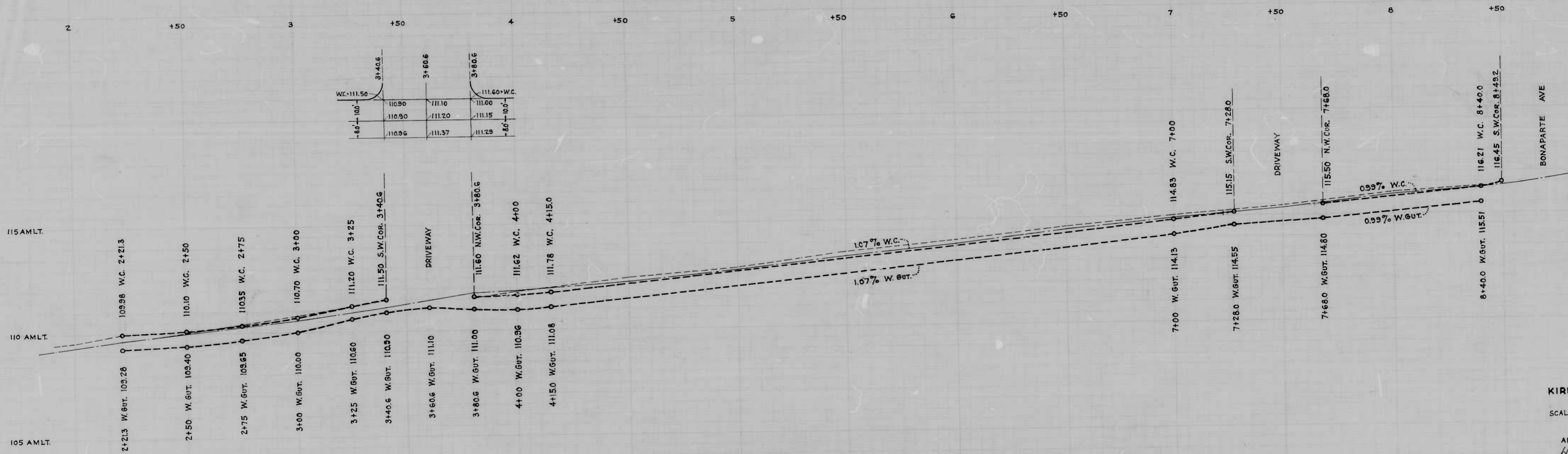

CITY OF BALTIMORE  
 DEPARTMENT OF PUBLIC  
 WORKS  
 BUREAU OF HIGHWAYS  
**PROFILE OF**  
**KIRK AVE - 210± NORTH OF BARTLET**  
 CONT. N° 871

SCALE: HOR - 1" = 20.0'  
 VER - 1" = 2.0'

APPROVED  
*Henry Weisberg*  
 ASSOCIATE ENGINEER

APPROVED  
*Edward J. Healy*  
 ENGINEER OF SURVEYS

ESSE D. CARTER  
*S. J. Burns*  
 ENGINEER OF SURVEYS

871

RATIO - 24

7

