

STA. 0+250 TO STA. 3+250
 @ STA. 3+500 & @ STA. 5+000 REVERSED
 STA. 5+500 TO STA. 6+250

NOTES:
 THE ISSUANCE OF THIS PLAN & PROFILE DOES NOT COMMIT THE CITY TO THE ACCEPTANCE AND/OR IMPROVEMENT OF ANY THROUGHFARES SHOWN HEREON. TO BE SHEET ASPHALT PAVING - 1 1/2" WEAR SURF 1 1/2" BINDER ON AN 8" CONC. BASE, SIX (6) INCHES OF 50% STABILIZATION MATERIAL WILL BE REQUIRED. UNDERDRAINS WILL NOT BE REQUIRED.

195-AML.T.
 200-AML.T.
 205-AML.T.
 210-AML.T.

DESIGNED BY: J. J. HAYDEN
 CHECKED BY: W. H. CANNON

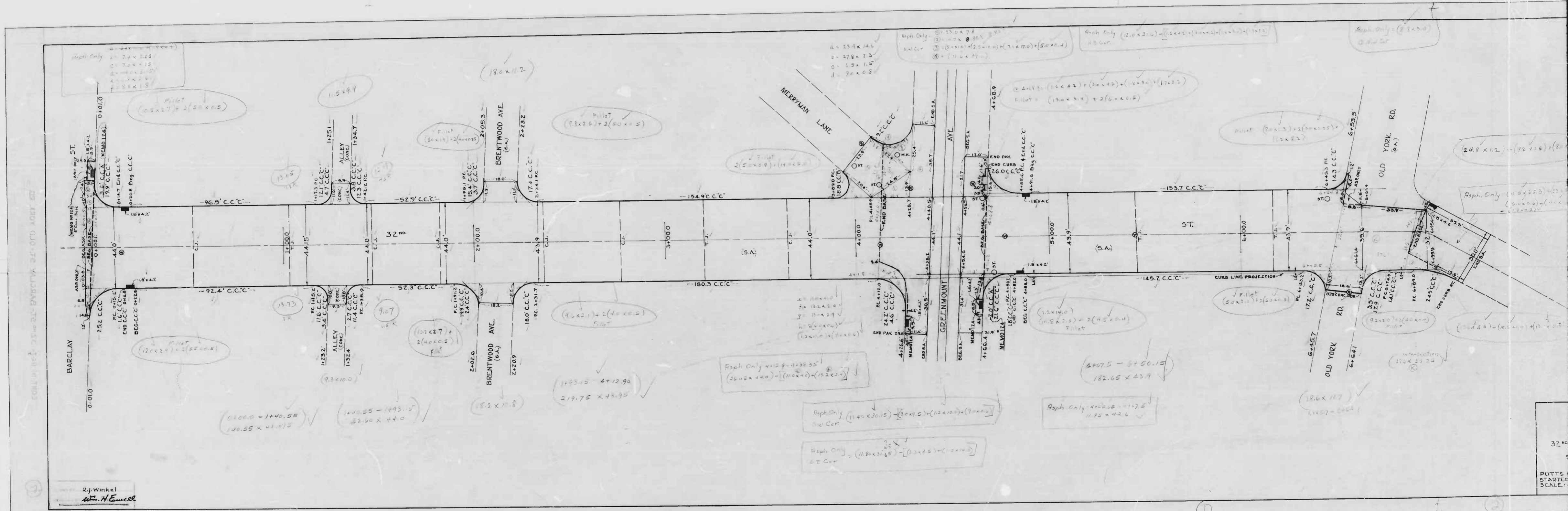

32' =
 PUTTS STARTED
 SCALE

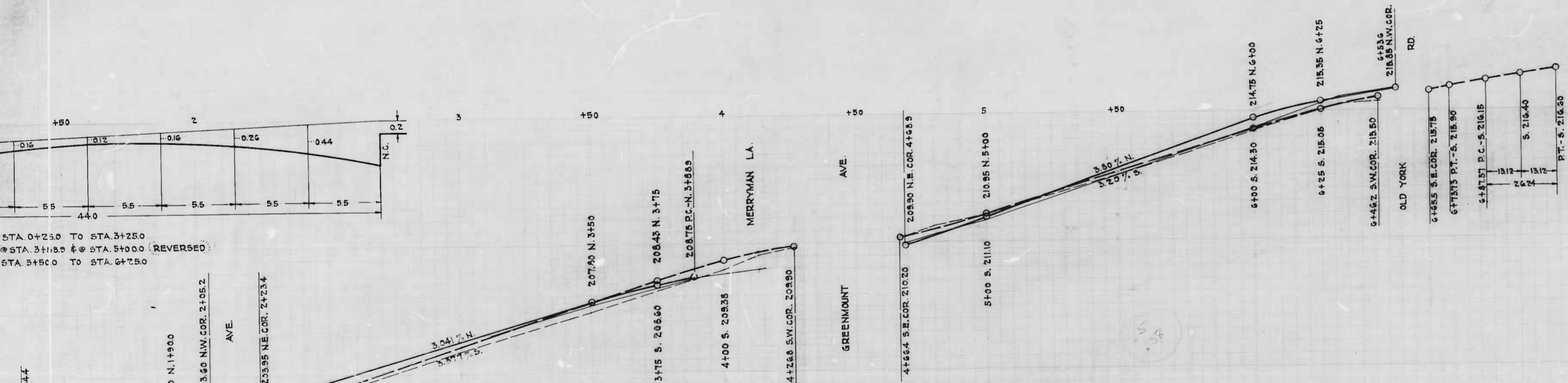
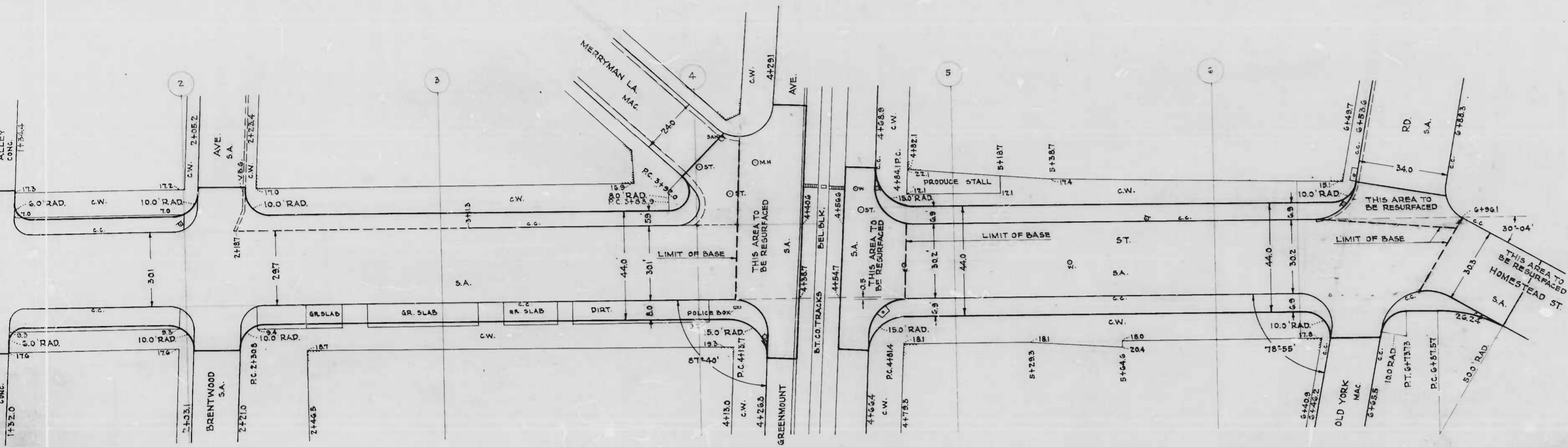

STA 0+25.0 TO STA 3+25.0
 @ STA 3+11.85 & @ STA 5+00.0 REVERSED
 STA 5+50.0 TO STA 6+25.0

NOTES
 THE ISSUANCE OF THIS PLAN & PROFILE DOES NOT COMMIT THE CITY TO THE ACCEPTANCE AND/OR IMPROVEMENT OF ANY THOROUGHFARE SHOWN HEREON. TO BE SHEET ASPHALT PAVING - 1 1/2" WEAR SURF 1 1/2" BINDER ON AN 8" CONC. BASE. SIX (6) INCHES OF SOIL STABILIZATION MATERIAL WILL BE REQUIRED. UNDERDRAINS WILL NOT BE REQUIRED.

CITY OF BALTIMORE
 DEPARTMENT OF PUBLIC WORKS
 BUREAU OF HIGHWAYS
 PLAN & PROFILE
 32ND ST. - BARCLAY ST. TO OLD YORK RD.
 CONT. NO. 567
 SCALES: PLAN - 1" = 20.0'
 PROFILE - VER. - 1" = 2.0'
 HORIZ. - 1" = 20.0'
 AUGUST 28, 1947
 APPROVED: *Henry W. ...* ASSOCIATE ENGINEER
 APPROVED: *James H. ...* HIGHWAYS ENGINEER
 APPROVED: *Edward ...* ENGINEER OF SURVEYS
 APPROVED: *...* DIRECTOR OF PUBLIC WORKS

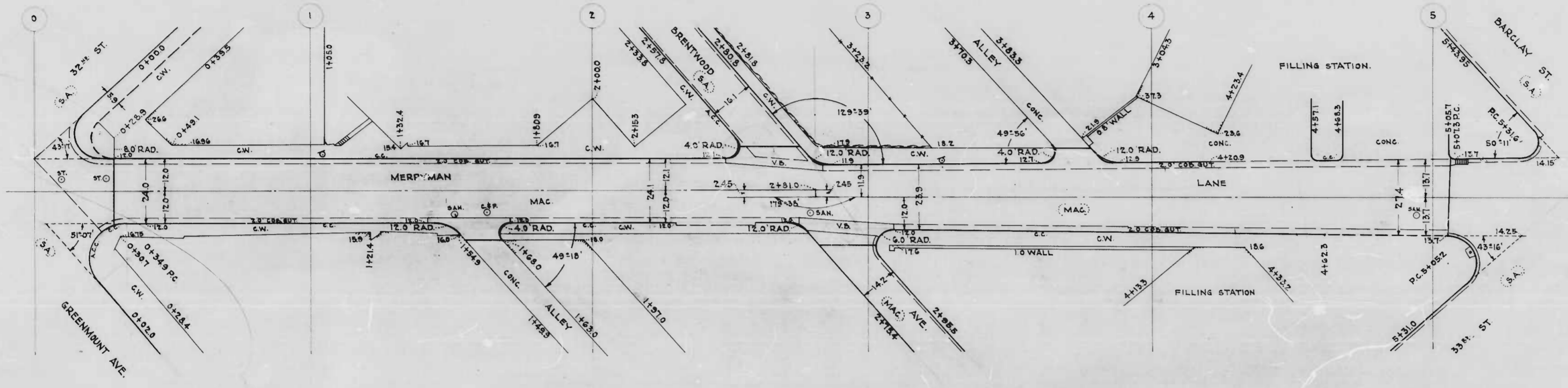

NOTES
 THE ISSUANCE OF THIS PLAN & PROFILE DOES NOT COMMIT THE CITY TO THE ACCEPTANCE AND/OR IMPROVEMENT OF ANY THOROUGHFARES SHOWN HEREIN. TO BE SHEET ASPHALT PAVING - 1 1/2" WEAR SURF 1 1/2" BINDER ON AN 8" CONC. BASE. SIX (6) INCHES OF SOIL STABILIZATION MATERIAL WILL BE REQUIRED. UNDERDRAINS WILL NOT BE REQUIRED.

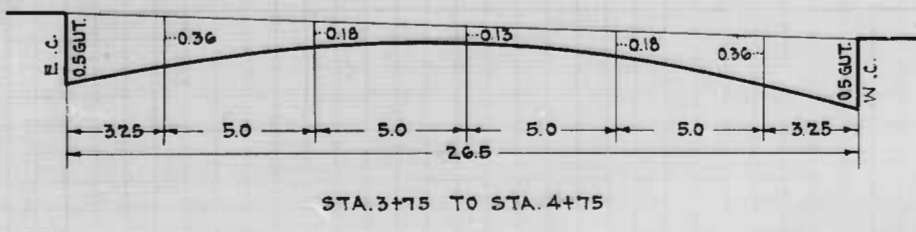
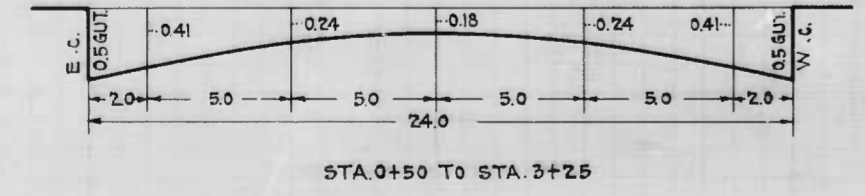
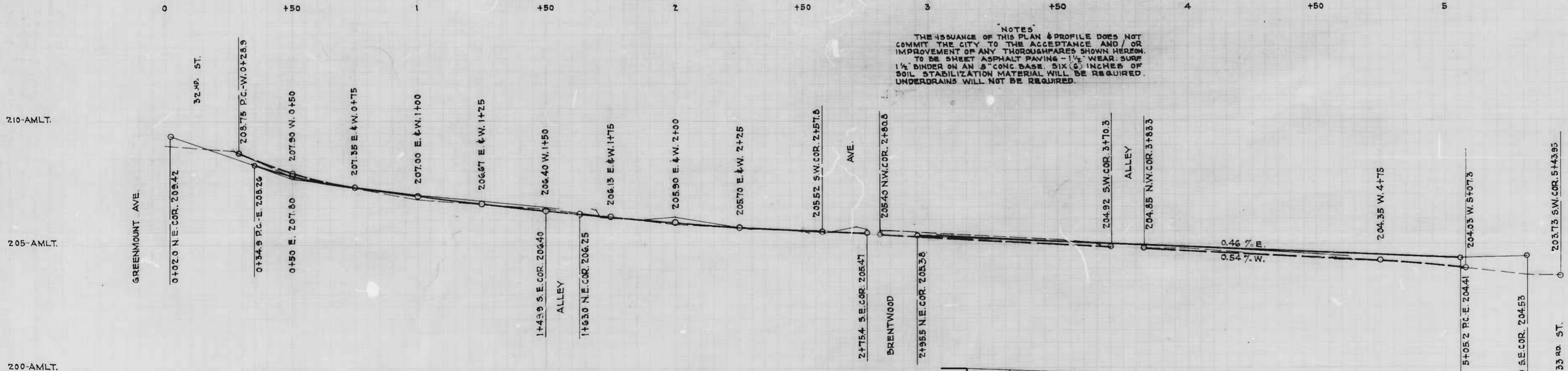

DESIGNED BY J.J. HAYDEN
 W. H. BULL

CITY OF BALTIMORE
 DEPARTMENT OF PUBLIC WORKS
 BUREAU OF HIGHWAYS
 PLAN & PROFILE
 MERRYMAN LA. - GREENMOUNT AVE. TO 33RD ST.
 CONT. NO. 867
 PLAN - 1" = 200'
 PROFILE - 1" = 20'
 BOOK NO. X-234
 SEPT. 5, 1947
 APPROVED: [Signature] HIGHWAYS ENGINEER
 APPROVED: [Signature] ENGINEER OF SURVEYS
 APPROVED: [Signature] DIRECTOR OF PUBLIC WORKS

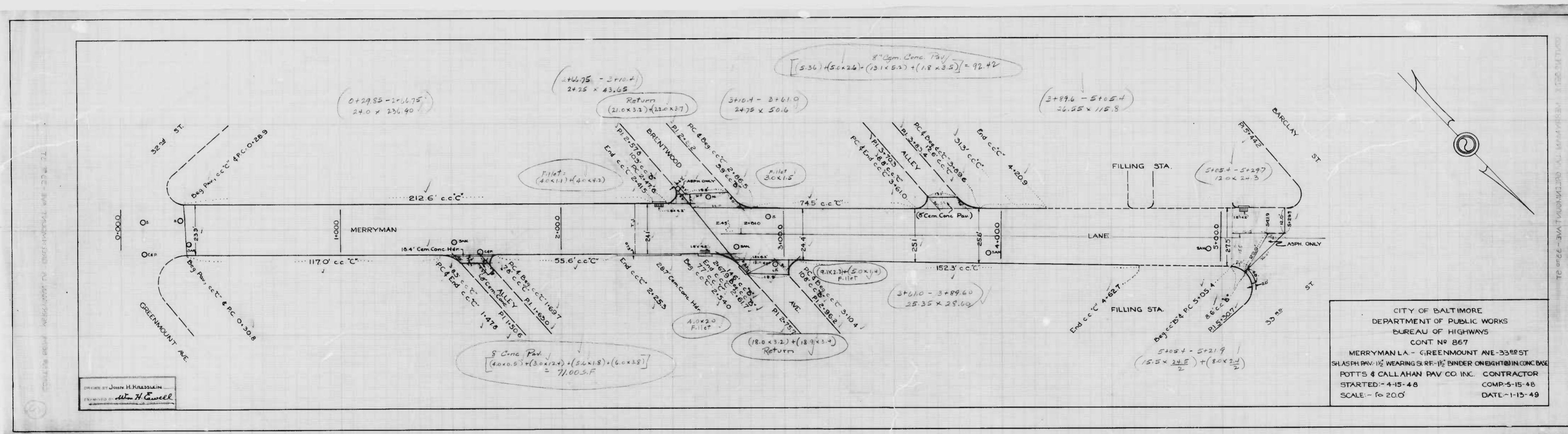

CITY OF BALTIMORE
 DEPARTMENT OF PUBLIC WORKS
 BUREAU OF HIGHWAYS
 CONT NO 867
 MERRYMAN LA - GREENMOUNT AVE-33RD ST
 SLASH PAV. 1/2 WEARING SURF-1/2 BINDER ONE EIGHT IN CONC BASE
 POTT'S & CALLAHAN PAV CO INC. CONTRACTOR
 STARTED - 4-15-48 COMP-5-15-48
 SCALE - 1" = 20' DATE - 1-15-49

DESIGNED BY JOHN H. KURSSALIN
 DRAWN BY W. H. COWELL