

NOTE:-  
 TO BE CEMENT CONCRETE PAVING EIGHT INCHES THICK.  
 SIX INCH SOIL STABILIZATION MATERIALS ARE  
 REQUIRED THROUGHOUT.  
 UNDERDRAINS IF AND WHERE NECESSARY AS  
 DETERMINED BY ENGINEER IN FIELD.

УЩЕ ПИЛОБОГА ЛЕЗБУКЕ І ДОПИСАНО: ОМАНІСЬ ВАГІТЬ БУВА - ВПІЛЕРІОМІ 30  
СОМІ ІВ. Р. С. І. К.

СВІТЯНІС ФАЛЛС РІВІ

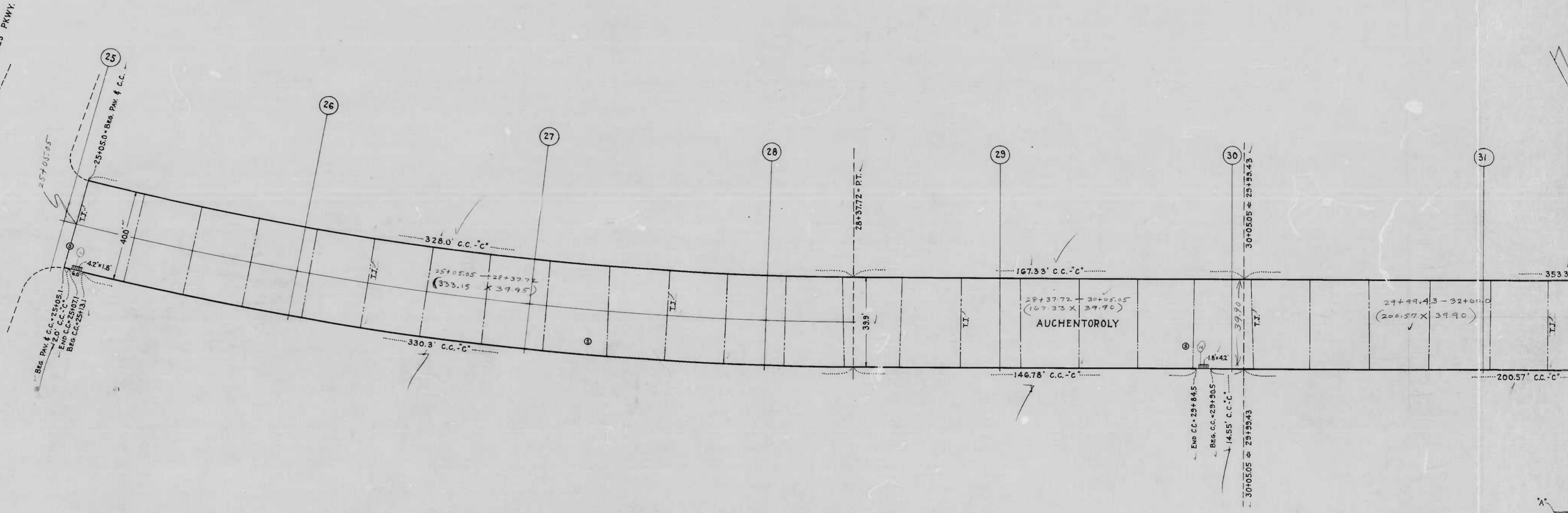

DRAWN BY JESSE D. CARTER  
EXAMINED BY *W. H. Lowell*



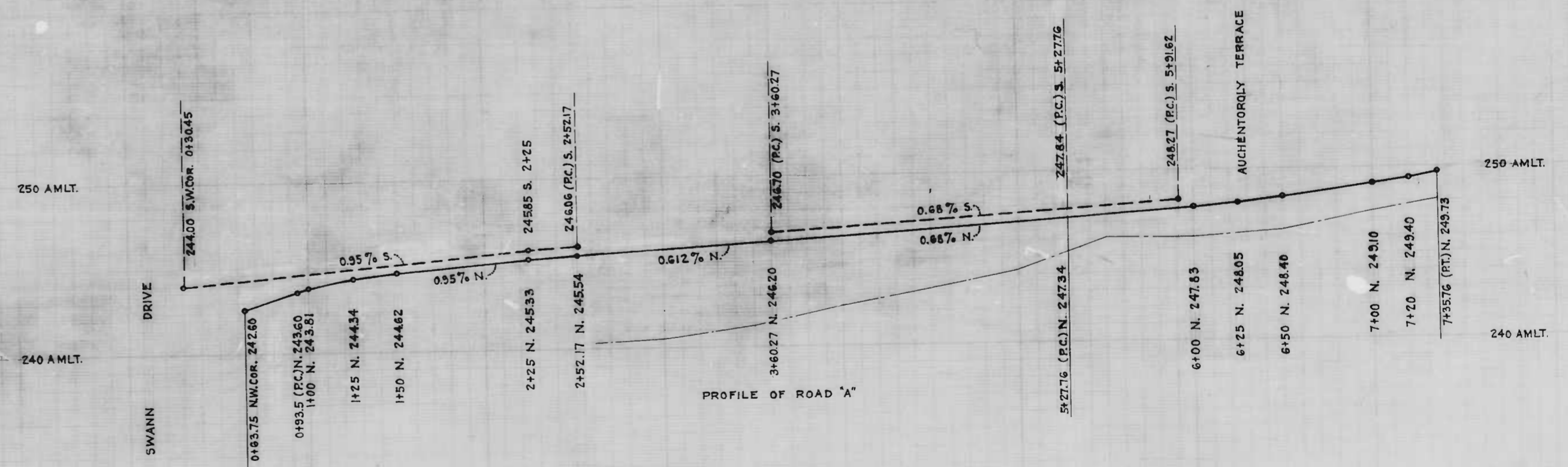
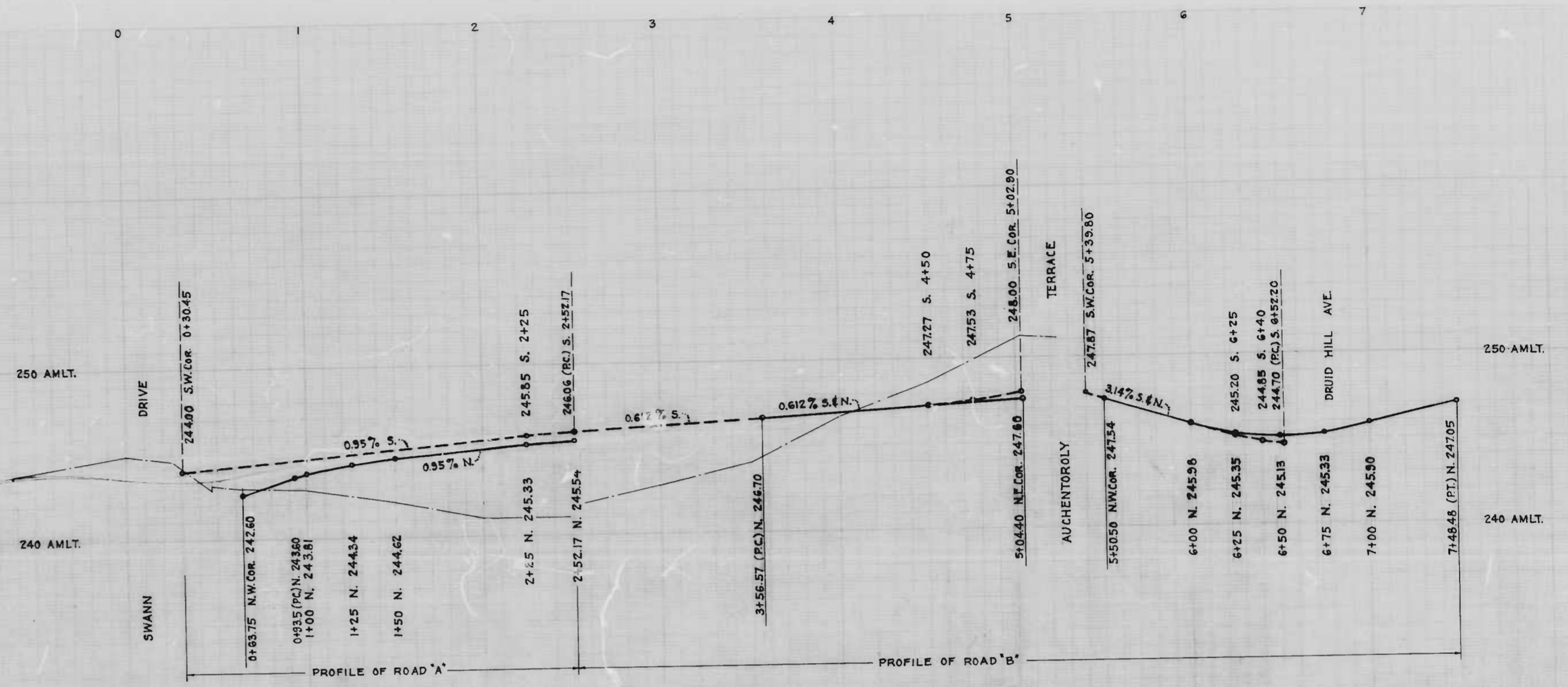
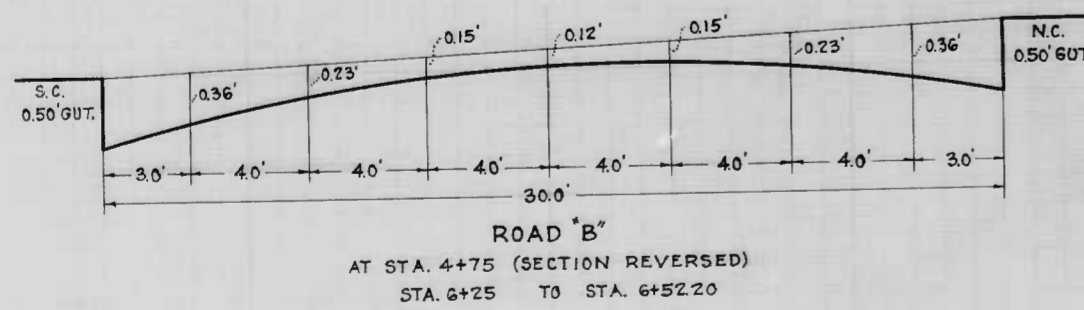
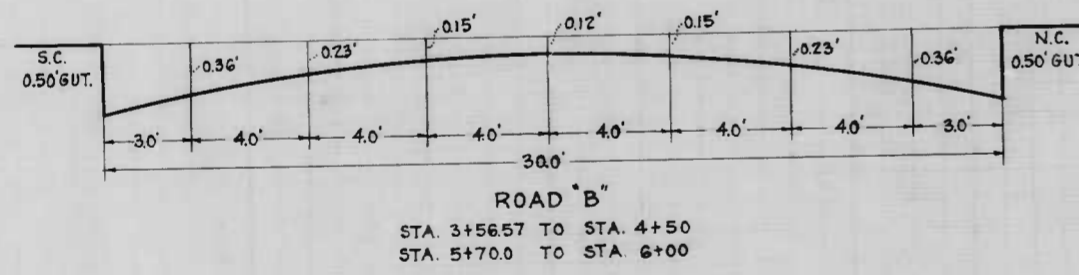
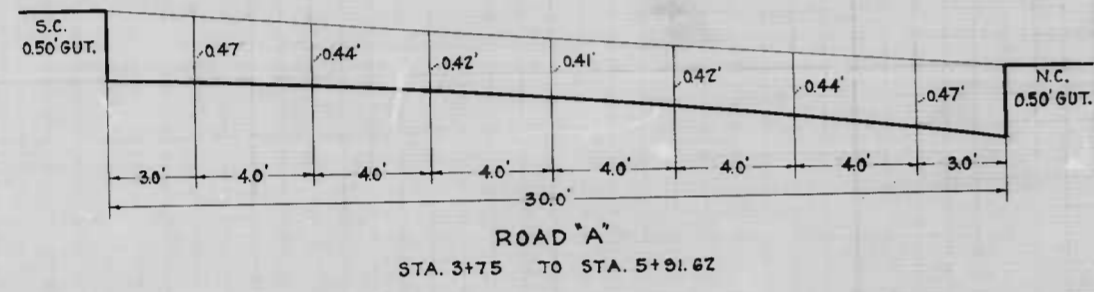
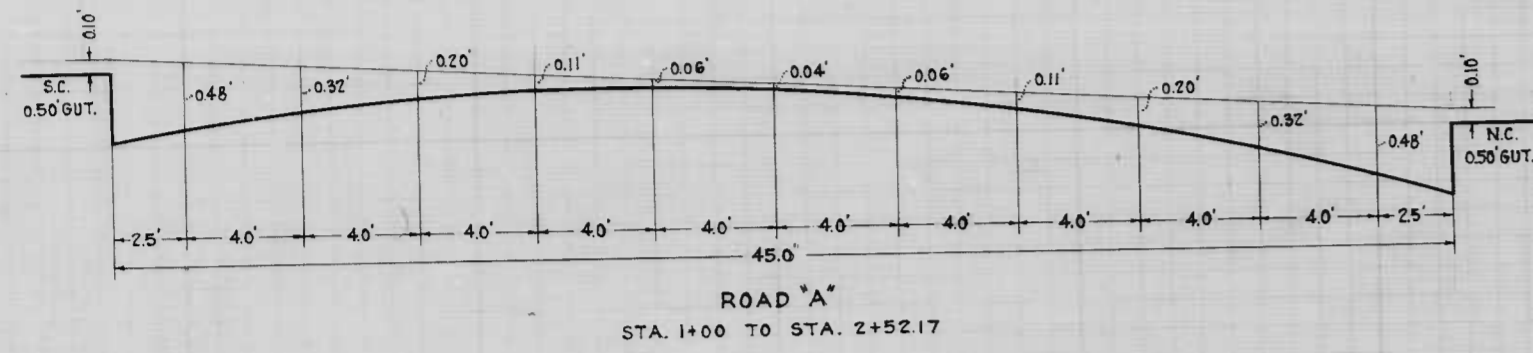



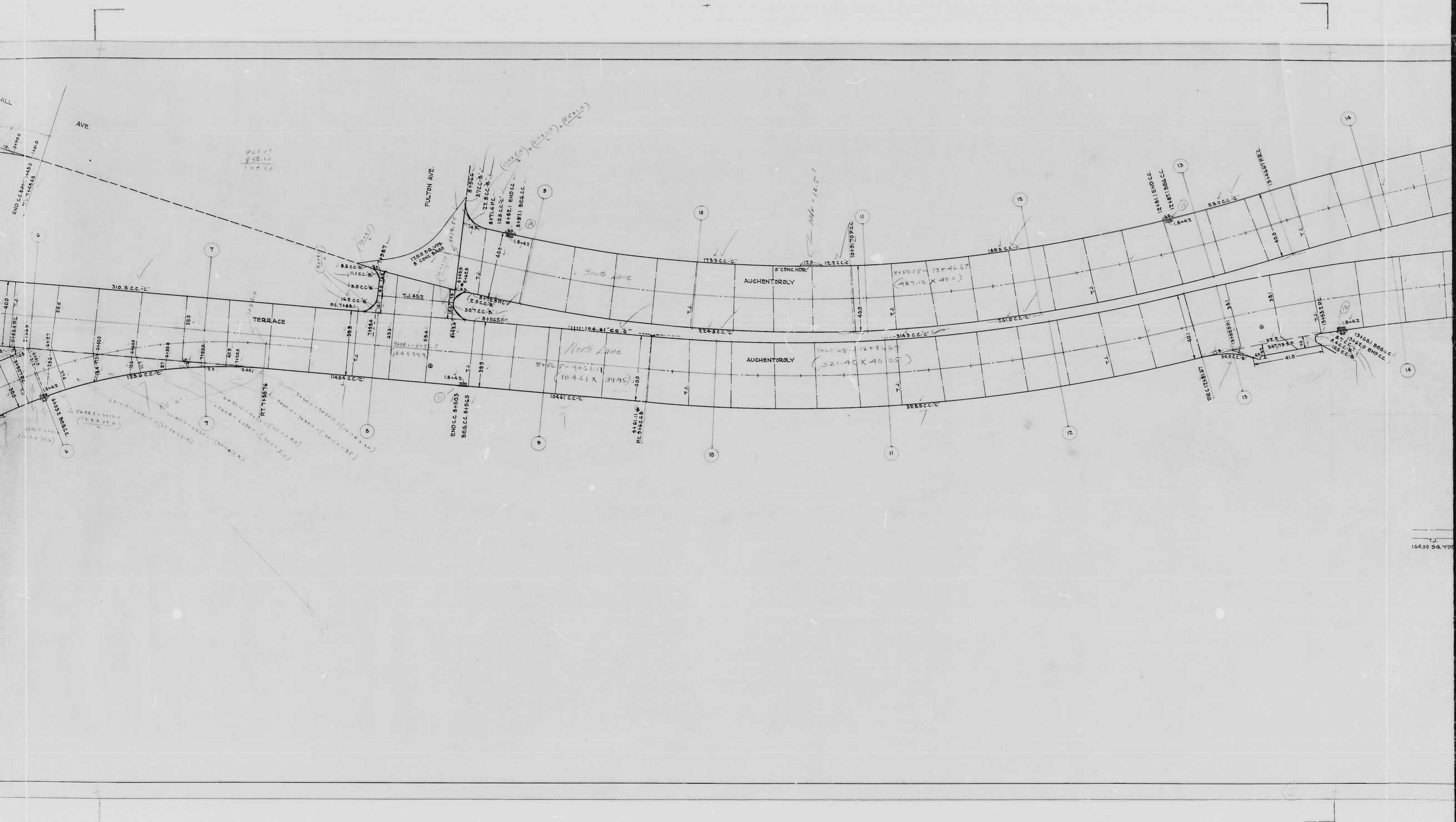



CITY OF BALTIMORE  
 DEPARTMENT OF PUBLIC WORKS  
 BUREAU OF HIGHWAYS  
 PLAN OF  
**AUCHENTOROLY TERRACE AND CONNECTIONS**  
**CLOVERDALE RD. - GWYNNS FALLS PKWY.**  
 CONT. N° 860 BOOKS - X223, X223A, X223B, X223C  
 SCALE - 1" = 40.0' DATE - JULY 8, 1947

APPROVED  
*Henry Wasker*  
 ASSOCIATE ENGINEER

APPROVED  
*James L. McRoy*  
 HIGHWAYS ENGINEER

APPROVED  
*Edward J. Wacker*  
 ENGR OF SURVEYS

APPROVED  
*Edwin S. Smith*  
 DIRECTOR OF PUBLIC WORKS



CC Paving (Lane B) =  $(\frac{10 \times 2.5}{2}) + (10 \times 1.5) + (6 \times 1.5) + (50.0 \times 2.0)$   
 (Lane E) =  $(26.92) + (2 \times 38) + (10.3 \times 24.0)$

SEE END OF SHEET FOR CONTINUATION OF PLAN FROM STA. 7+00 TO REISTERSTOWN RD.

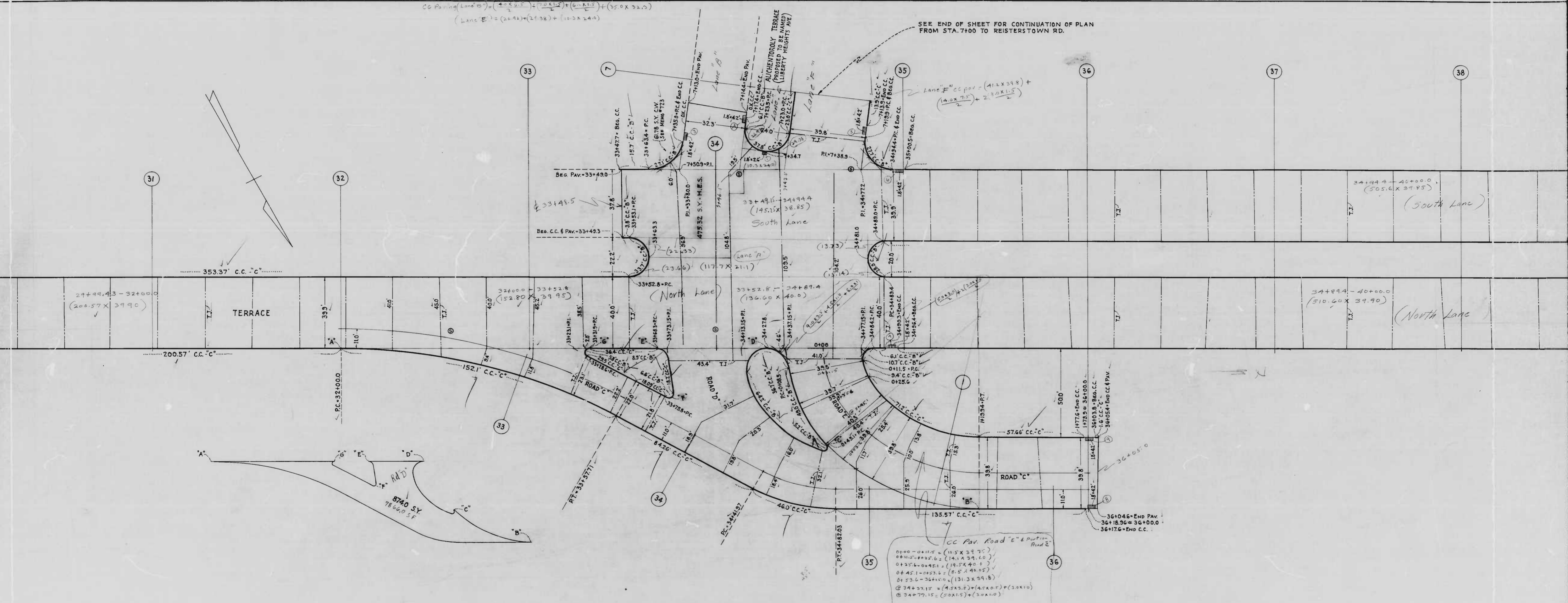

CC Pav. Road "E" & Portion Road "B"

$0+00 - 0+11.5 = (11.5 \times 39.75)$   
 $0+11.5 - 0+25.62 = (14.1 \times 39.60)$   
 $0+25.62 - 0+45.1 = (19.5 \times 40.0)$   
 $0+45.1 - 0+53.6 = (8.5 \times 40.0)$   
 $0+53.6 - 36+00.0 = (131.3 \times 39.8)$   
 $36+00.0 - 34+37.15 = (4.5 \times 39.8) + (4.5 \times 40.0) + (30 \times 40.0)$   
 $34+37.15 - 34+77.15 = (20 \times 41.5) + (30 \times 41.0)$

34+944 - 40+00.0  
(505.6 X 39.85)  
(South Lane)

34+894 - 40+00.0  
(510.60 X 39.90)  
(North Lane)



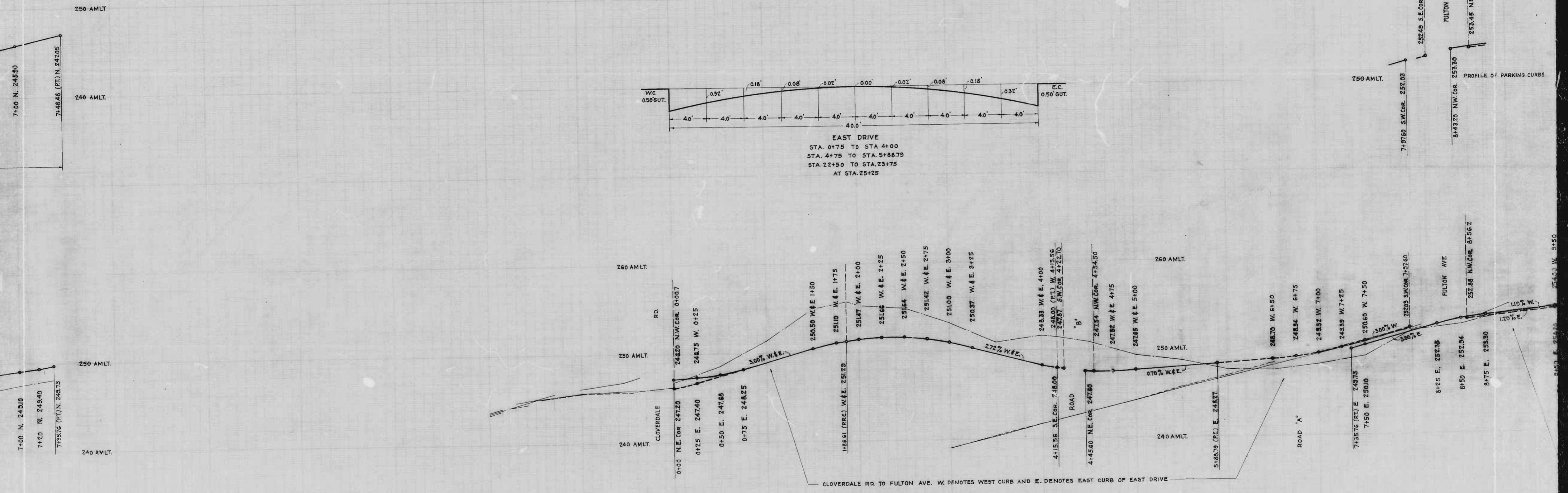
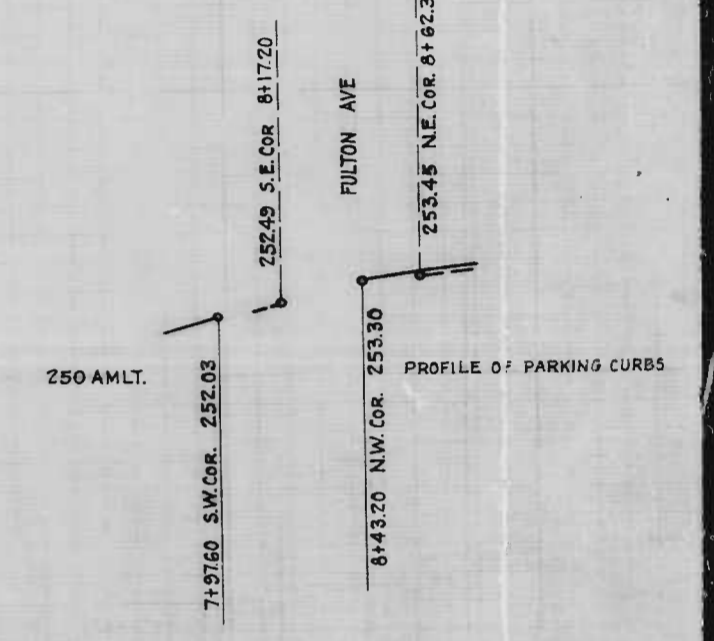
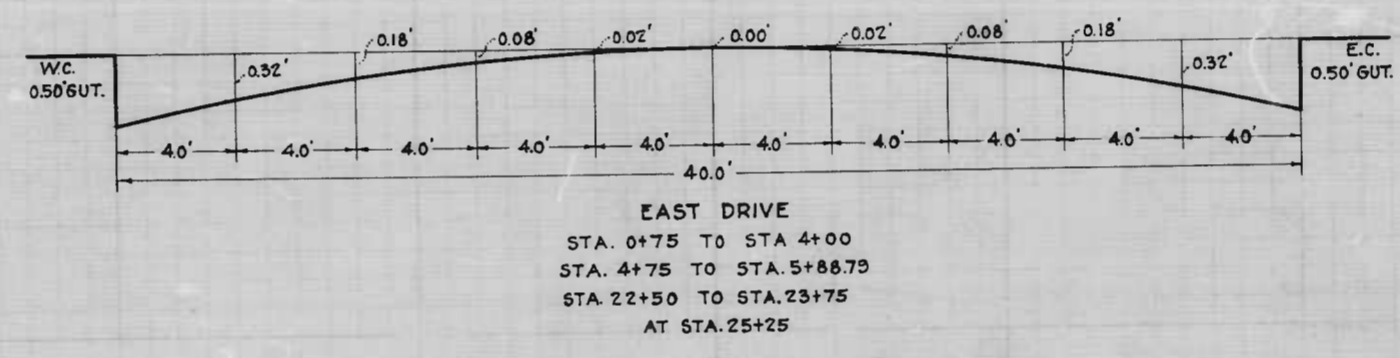
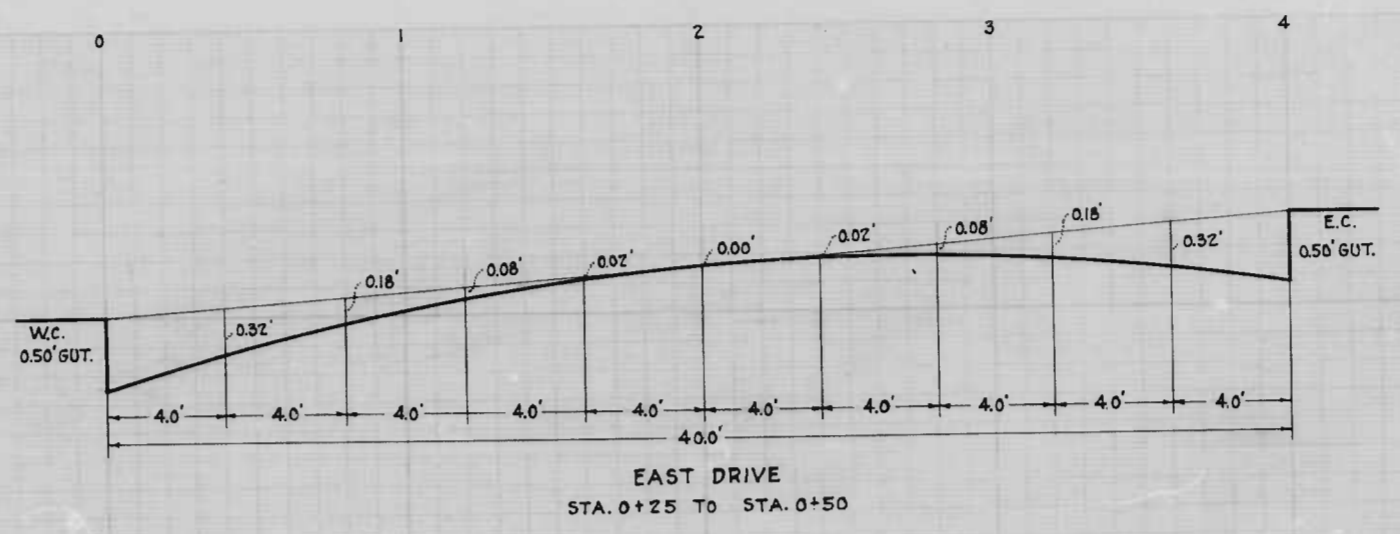







E CURVE DATA  
30'  
MIN. PER FT.

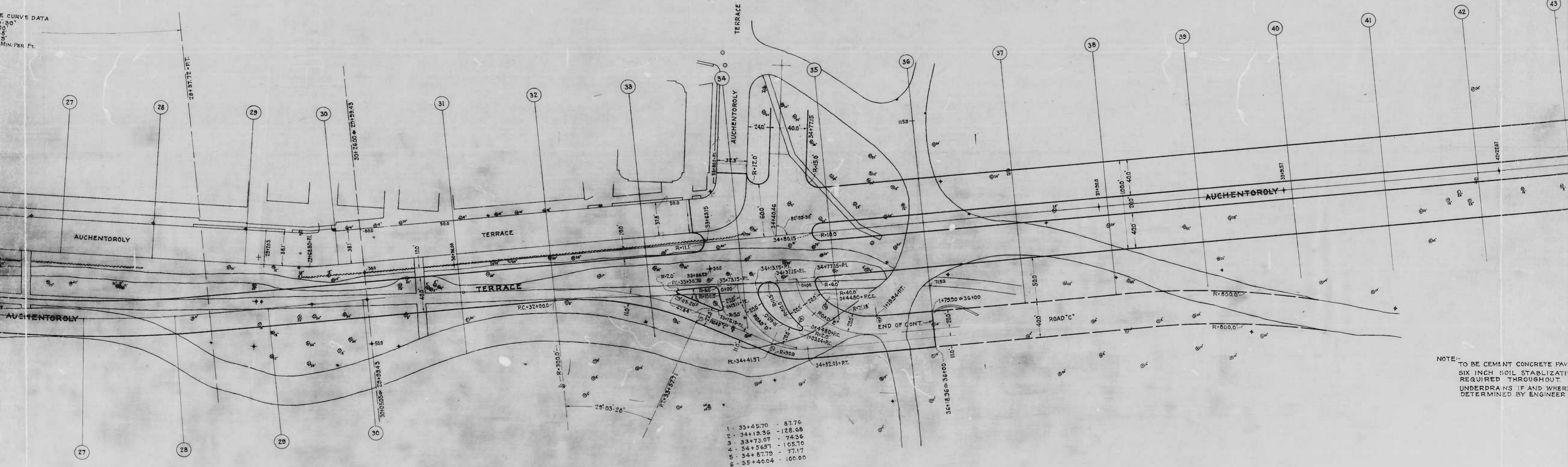

NOTE:-  
TO BE CEMENT CONCRETE PAVI  
SIX INCH SOIL STABILIZATI  
REQUIRED THROUGHOUT.  
UNDERDRAINS IF AND WHERE  
DETERMINED BY ENGINEER



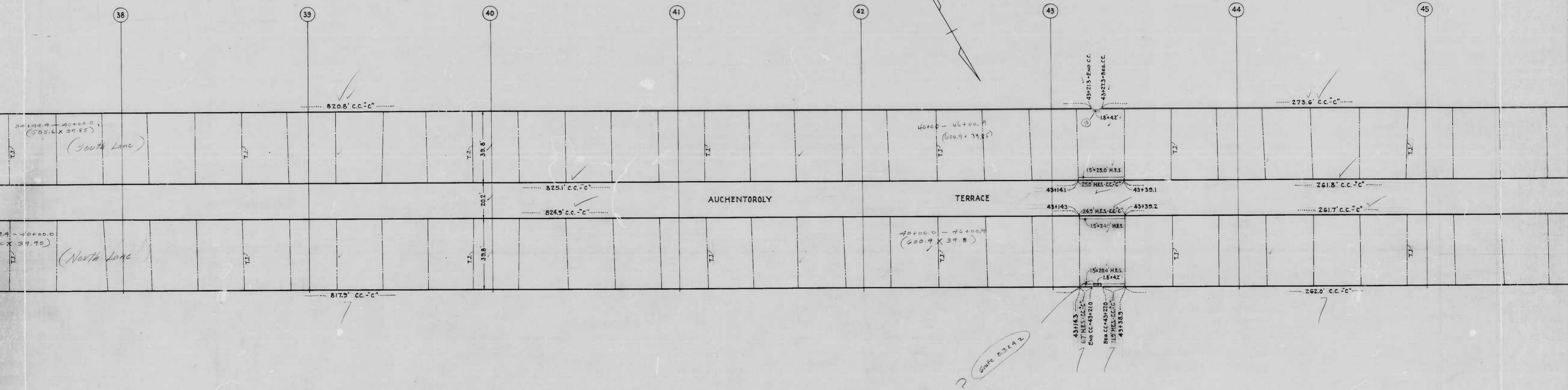







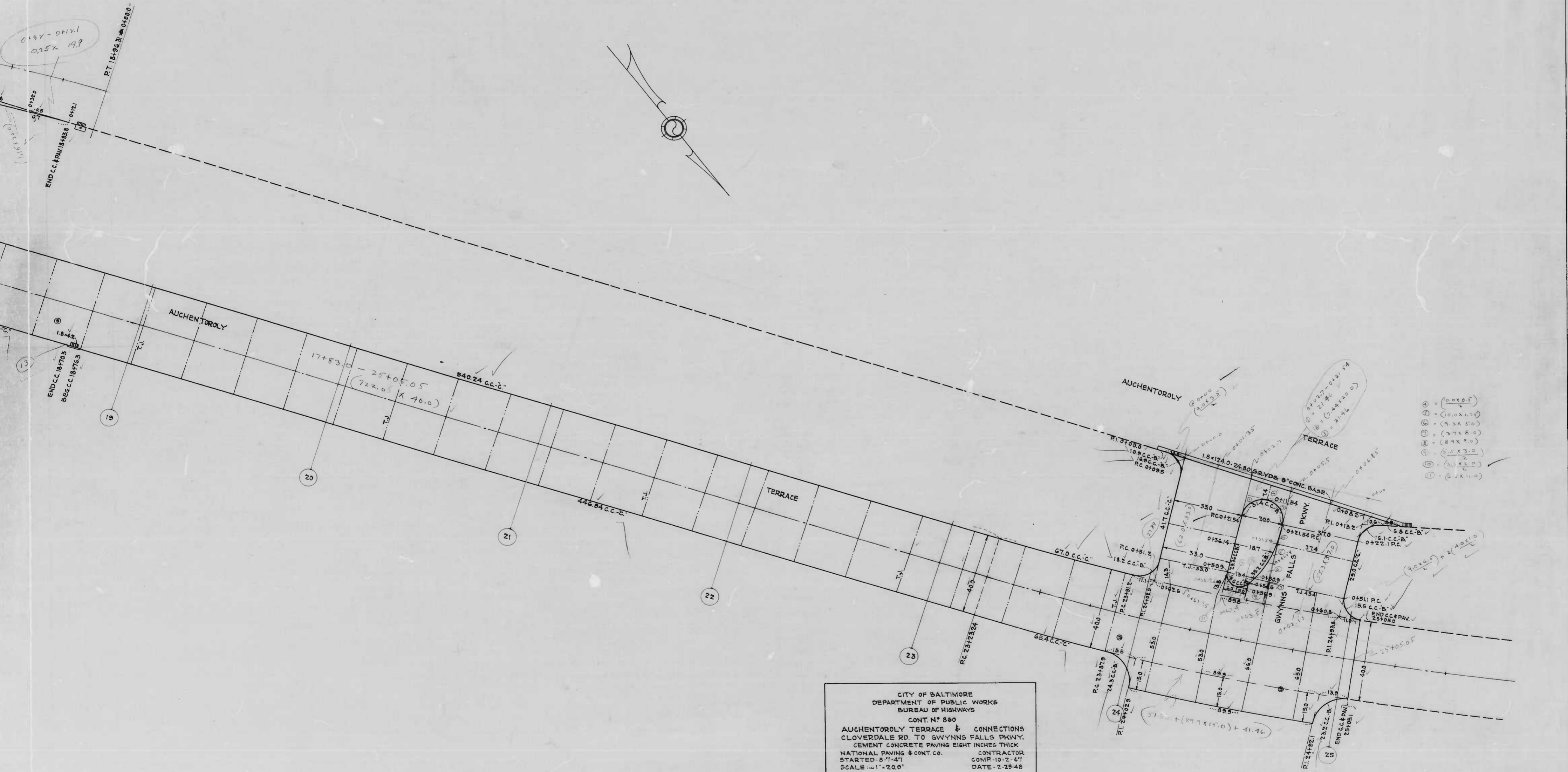

CITY OF BALTIMORE  
 DEPARTMENT OF PUBLIC WORKS  
 BUREAU OF HIGHWAYS  
 CONT. N° 880  
 AUCHENTOROLY TERRACE & CONNECTIONS  
 CLOVERDALE RD. TO GWYNN'S FALLS PKWY.  
 CEMENT CONCRETE PAVING EIGHT INCHES THICK  
 NATIONAL PAVING & CONT. CO. CONTRACTOR  
 STARTED - 8-7-47 COMP. - 10-2-47  
 SCALE - 1" = 20.0' DATE - 2-28-48

APPROVED FOR THE CITY ENGINEER  
 APPROVED FOR THE STATE ENGINEER  
 APPROVED FOR THE FEDERAL ENGINEER



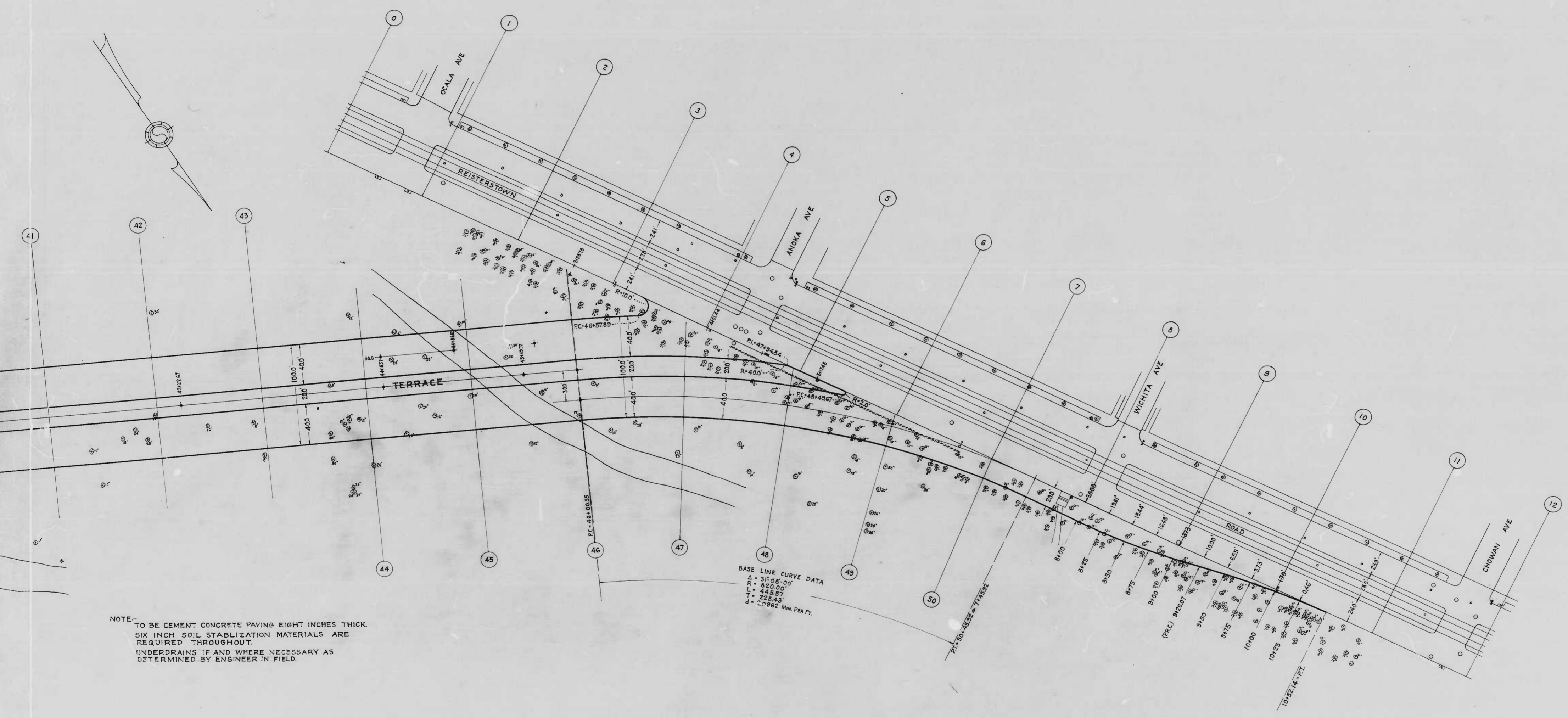

NOTE:-  
TO BE CEMENT CONCRETE PAVING EIGHT INCHES THICK.  
SIX INCH SOIL STABILIZATION MATERIALS ARE  
REQUIRED THROUGHOUT.  
UNDERDRAINS IF AND WHERE NECESSARY AS  
DETERMINED BY ENGINEER IN FIELD.

BASE LINE CURVE DATA  
Δ = 31° 06' 00"  
R = 820.00'  
L = 443.57'  
T = 228.43'  
d = 0.962 MIN. PER FT.







BALTIMORE  
PUBLIC WORKS  
DIVISION  
OFFICE OF  
DESIGN AND CONNECTIONS  
GWYNNS FALLS PKWY.  
No 860  
BOOKS: X223, X223A, X223B, X223C  
DATE: JULY 8, 1947  
APPROVED  
*James M. King*  
HIGHWAYS ENGINEER  
APPROVED  
*William L. Smith*  
DIRECTOR OF PUBLIC WORKS

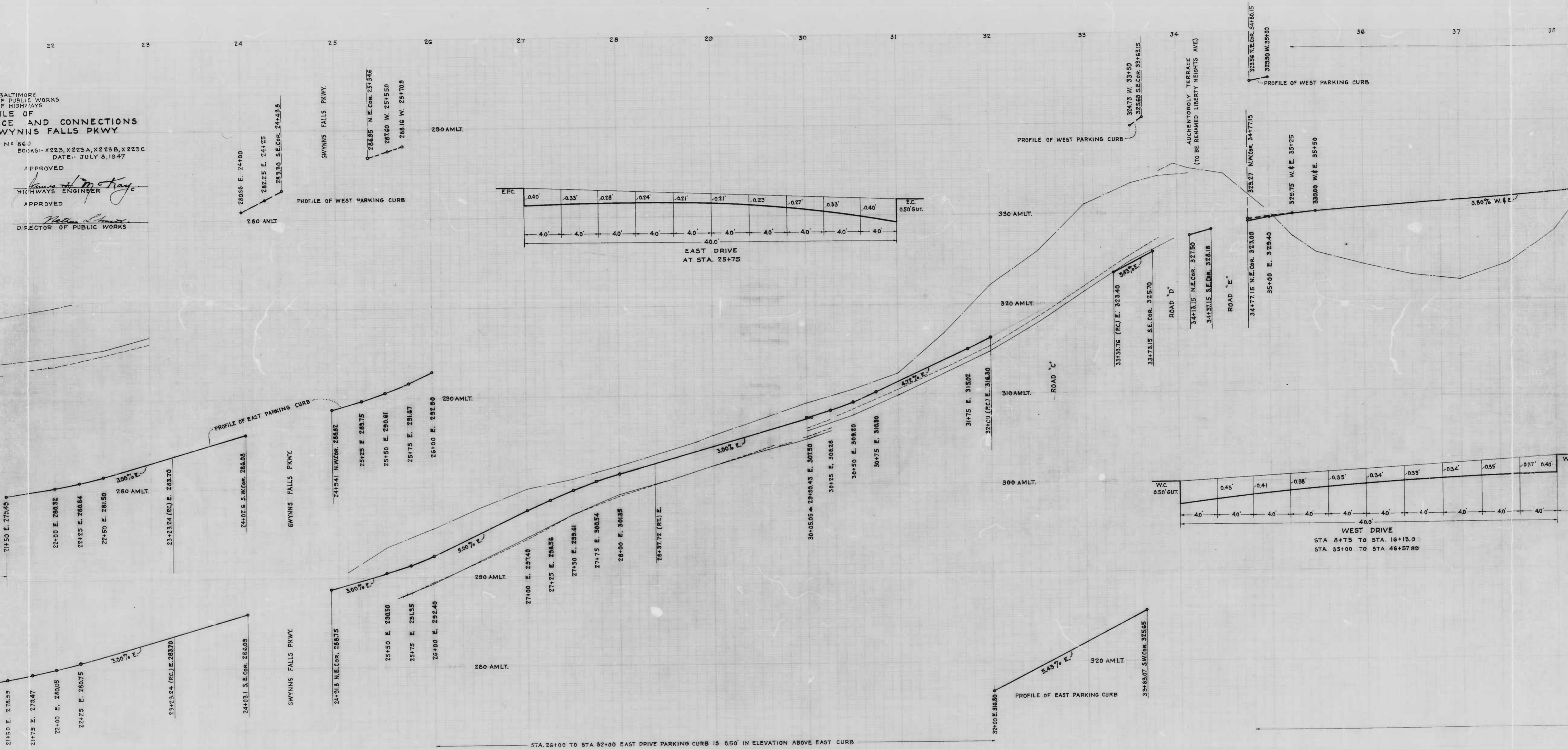

STA. 26+00 TO STA 32+00 EAST DRIVE PARKING CURB IS 0.50' IN ELEVATION ABOVE EAST CURB

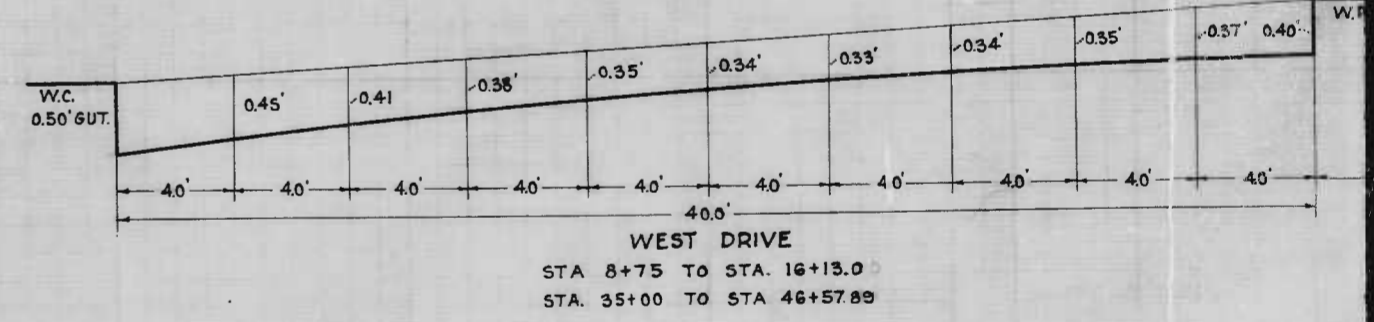



860/861

RATIO - 24

1

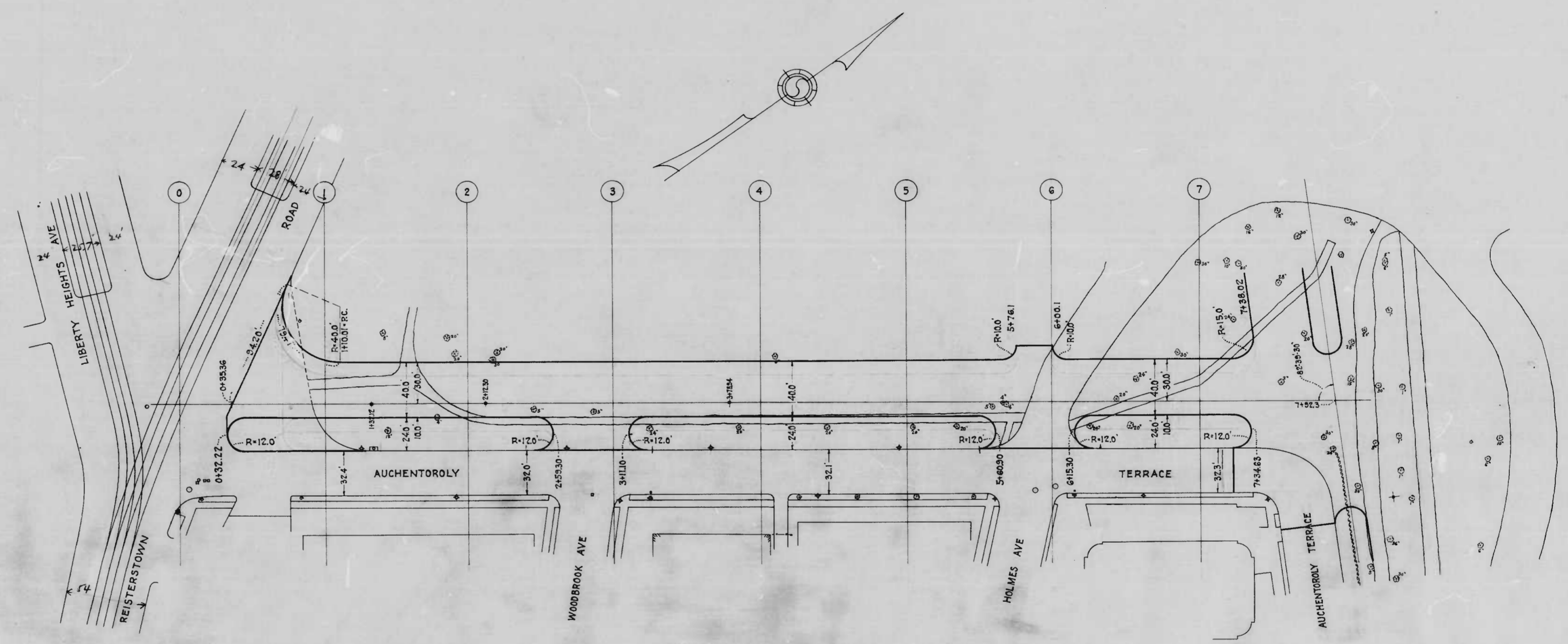

NOTE:-  
 TO BE CEMENT CONCRETE PAVING EIGHT INCHES THICK.  
 SIX INCH SOIL STABILIZATION MATERIALS ARE  
 REQUIRED THROUGHOUT.  
 UNDERDRAINS IF AND WHERE NECESSARY AS  
 DETERMINED BY ENGINEER IN FIELD.

AUCHENTOROLY  
 GWYNNE  
 CONT. NO. 861  
 SCALE - 1" = 40.0'  
 APPROVED  
*Henry*  
 ASSOCIATE ENGINEER  
 APPROVED  
 ENGR. OF SURVEYING











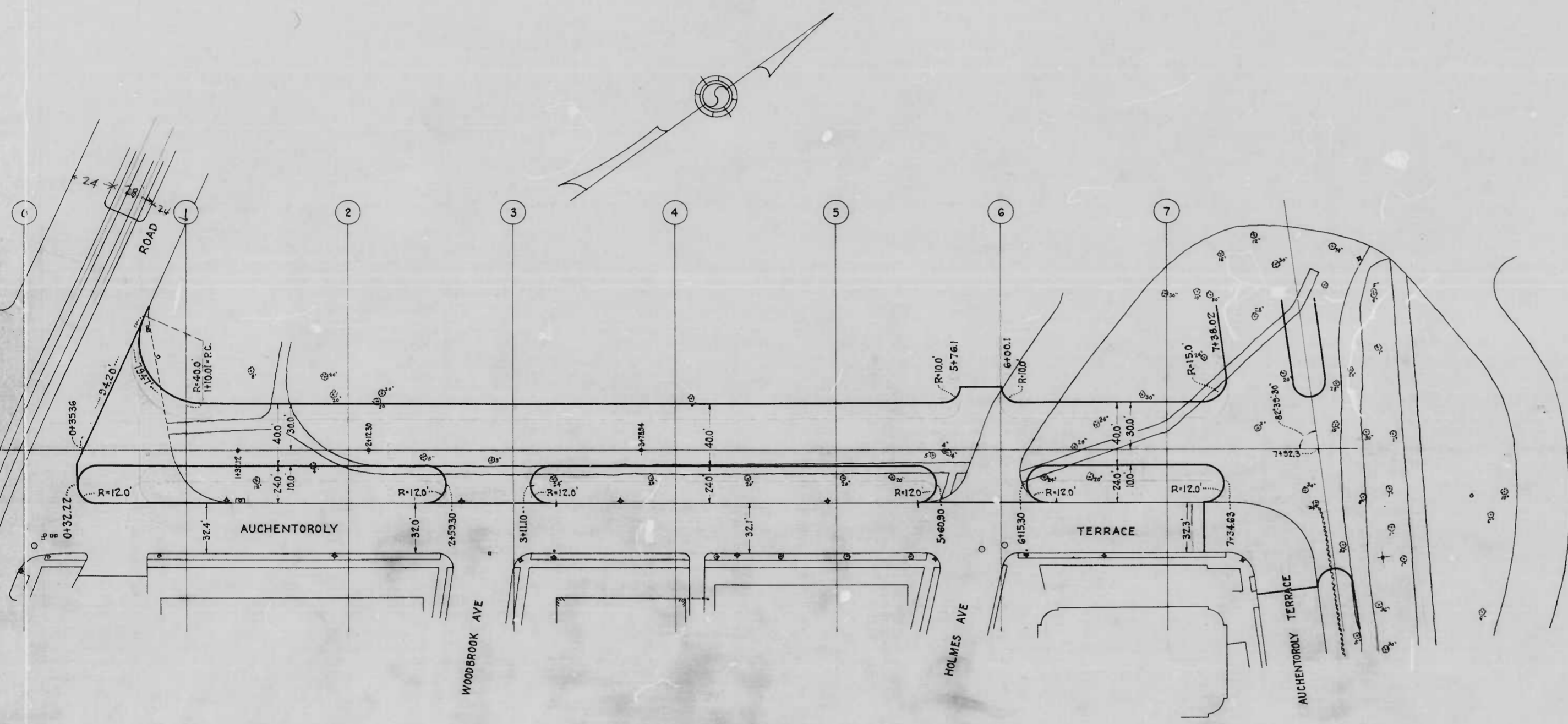

NOTE:-  
 TO BE CEMENT CONCRETE PAVING EIGHT INCHES THICK.  
 SIX INCH SOIL STABILIZATION MATERIALS ARE  
 REQUIRED THROUGHOUT.  
 UNDERDRAINS IF AND WHERE NECESSARY AS  
 DETERMINED BY ENGINEER IN FIELD.

CITY OF BALTIMORE  
 DEPARTMENT OF PUBLIC WORKS  
 BUREAU OF HIGHWAYS  
 PLAN OF  
**AUCHENTOROLY TERRACE AND CONNECTIONS**  
 GWYNNS FALLS PKWY - REISERSTOWN RD.

CONT NO 861  
 SCALE - 1" = 40.0'  
 BOOKS - X225, X228A, X228B, X228C  
 DATE - JULY 8, 1947

APPROVED  
*Henry Weiskopf*  
 ASSOCIATE ENGINEER

APPROVED  
*James M. Mc Coy*  
 HIGHWAYS ENGINEER

APPROVED  
*Edward J. He...*  
 ENGR. OF SURVEYS

APPROVED  
*Walter L. Smith*  
 DIRECTOR OF PUBLIC WORKS



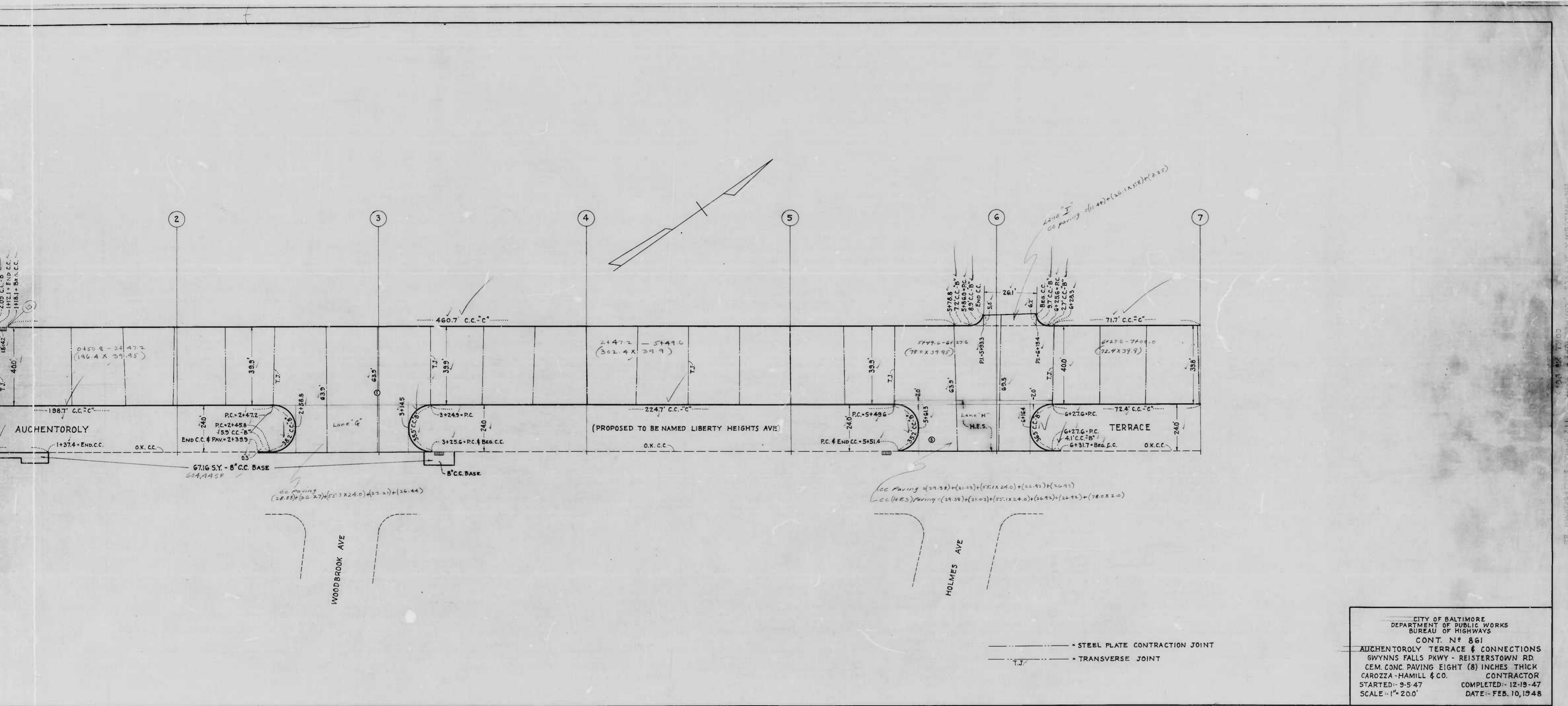

CITY OF BALTIMORE  
 DEPARTMENT OF PUBLIC WORKS  
 BUREAU OF HIGHWAYS  
 CONT. N# 861  
 AUCHENTOROLY TERRACE & CONNECTIONS  
 GWYNNS FALLS PKWY - REISTERSTOWN RD.  
 CEM. CONC PAVING EIGHT (8) INCHES THICK  
 CAROZZA-HAMILL & CO. CONTRACTOR  
 STARTED- 9-5-47 COMPLETED- 12-19-47  
 SCALE- 1" = 20.0' DATE- FEB. 10, 1948







860/861

RATIO - 24

2

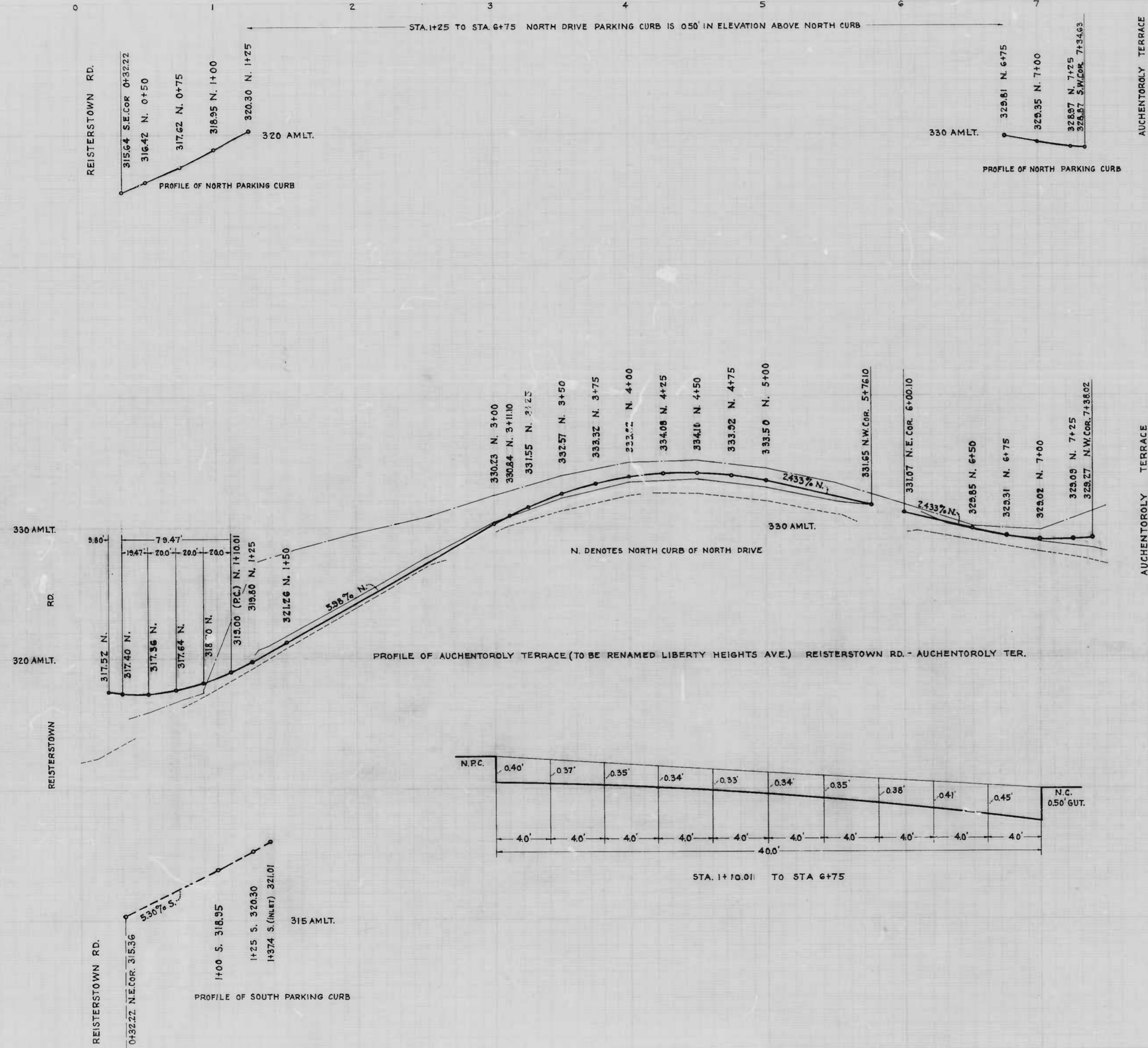

CROSSROADS AT REISTERSTOWN RD.  
AUCHENTOROLY TERRACE AND CONNECTIONS  
PROFILE OF CURB NO. 860 & 861

CITY OF BALTIMORE  
DEPARTMENT OF PUBLIC WORKS  
BUREAU OF HIGHWAYS

PROFILE OF  
AUCHENTOROLY TERRACE AND CONNECTIONS  
GWYNNS FALLS PKWY. - REISTERSTOWN RD.

CONT. N# 861  
BOOKS: X 223, X 223A, X 223 B, X 223 C  
DATE: JULY 8, 1947

SCALES: HOR. 1" = 40.0'  
VER. 1" = 4.0'

APPROVED *Henry Weisberg*  
ASSOCIATE ENGINEER

APPROVED *James A. McKeefe*  
HIGHWAYS ENGINEER

APPROVED *Edwin J. Heald*  
ENGR. OF SURVEYS

APPROVED *Patton Smith*  
DIRECTOR OF PUBLIC WORKS