

CITY OF BALTIMORE
 DEPARTMENT OF PUBLIC WORKS
 BUREAU OF HIGHWAYS
 PLAN OF
 BONNIE VIEW DR. & GERMAND RD.-END CULVERT AT WESTERN RUN TO 1495+N.E.
 FORMERLY CARROLL DR. CONT. N.F. 858

SCALE - 1" = 40'
 APPROVED: *Henry Weisberg*
 ASSOCIATE ENGINEER
 APPROVED: *Edward H. Hecker*
 ENGINEER OF SURVEYS

BOOK N.F. 858
 OCT. 28, 1947
 APPROVED: *Nathan L. Smith*
 DIRECTOR OF PUBLIC WORKS

DRAWN BY J.J. HAYDEN
 EXAMINED BY S.L. Curran
 1947

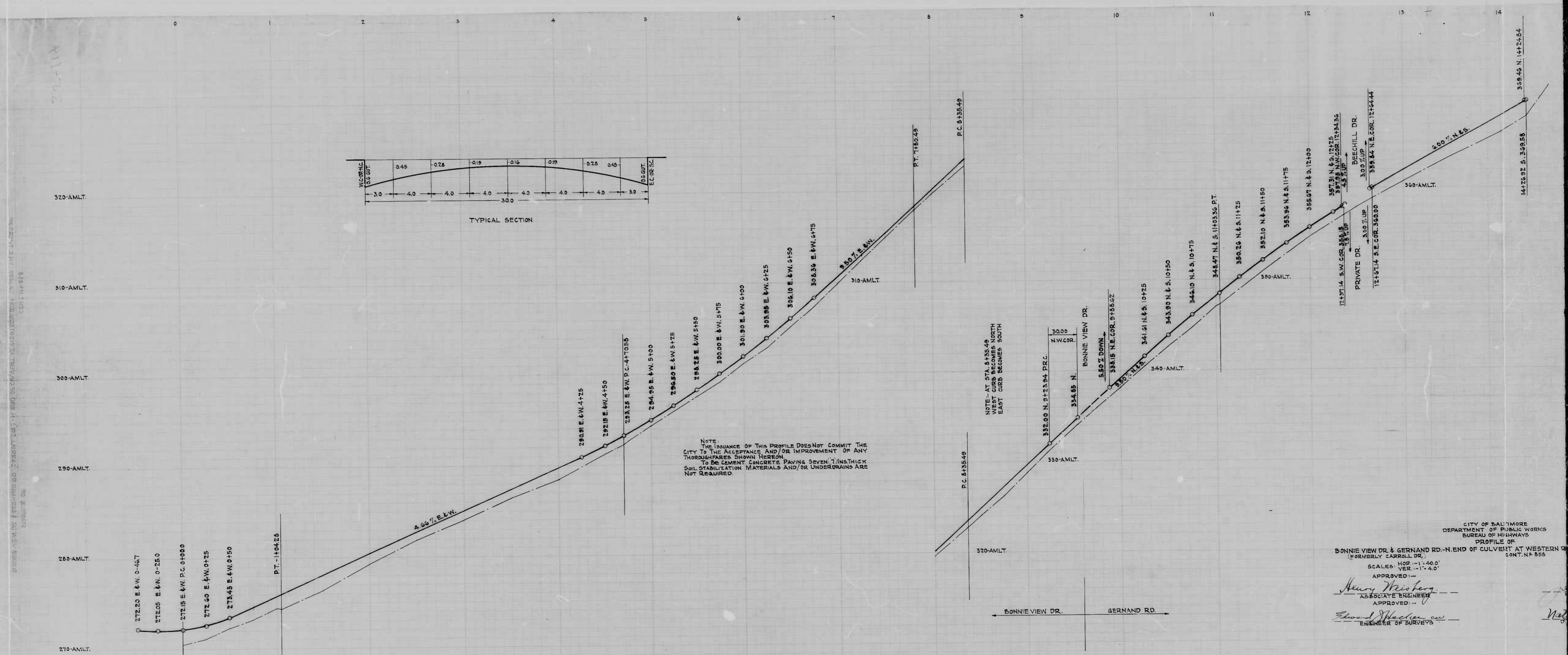

BONNIE VIEW DR. & GERNAND RD. (FORMERLY CARROLL DR.) - N. END OF CULVERT AT WESTERN RD. CONT. N. 858

NOTE - AT STA. 3135.49 WEST CURB BECOMES NORTH EAST CURB BECOMES SOUTH

CITY OF BALTIMORE
DEPARTMENT OF PUBLIC WORKS
BUREAU OF HIGHWAYS
PROFILE OF
BONNIE VIEW DR. & GERNAND RD. - N. END OF CULVERT AT WESTERN RD.
(FORMERLY CARROLL DR.)
CONT. N. 858

SCALES: HOR. - 1" = 40.0'
VER. - 1" = 4.0'
APPROVED: *Henry Weisberg*
ASSOCIATE ENGINEER
APPROVED: *Edward J. Hecker*
ENGINEER OF SURVEYS

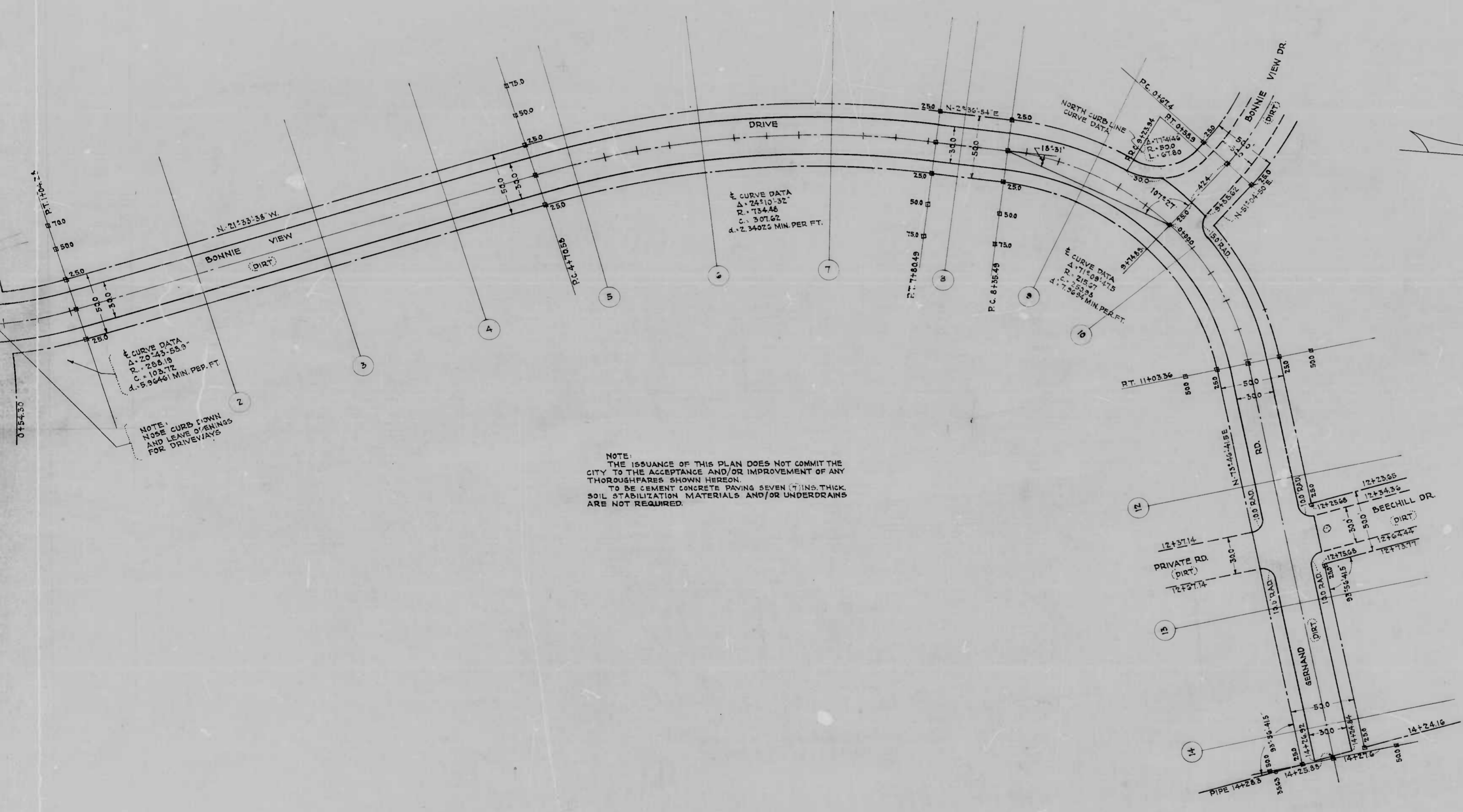

NOTE:
THE ISSUANCE OF THIS PLAN DOES NOT COMMIT THE CITY TO THE ACCEPTANCE AND/OR IMPROVEMENT OF ANY THOROUGHFARES SHOWN HEREON.
TO BE CEMENT CONCRETE PAVING SEVEN (7) INCH THICK.
SOIL STABILIZATION MATERIALS AND/OR UNDERDRAINS ARE NOT REQUIRED.

CITY OF BALTIMORE
DEPARTMENT OF PUBLIC WORKS
BUREAU OF HIGHWAYS
PLAN OF
BONNIE VIEW DR. & GERNAND RD.-N. END CULVERT AT WESTERN RUN TO 1495N.E.THEREOF
(FORMERLY CARROLL DR.)

SCALE - 1"=400'
APPROVED: *Henry Weiskopf*
ASSOCIATE ENGINEER
APPROVED: *Edward H. Wecker*
ENGINEER OF SURVEYS

BOOK # 858
OCT. 28, 1947
APPROVED: *James A. McVay*
HIGHWAYS ENGINEER
APPROVED: *Nathan Smith*
DIRECTOR OF PUBLIC WORKS

REPRODUCED FROM THE ORIGINAL DRAWING BY THE CITY OF BALTIMORE, DEPARTMENT OF PUBLIC WORKS, BUREAU OF HIGHWAYS, 1947.

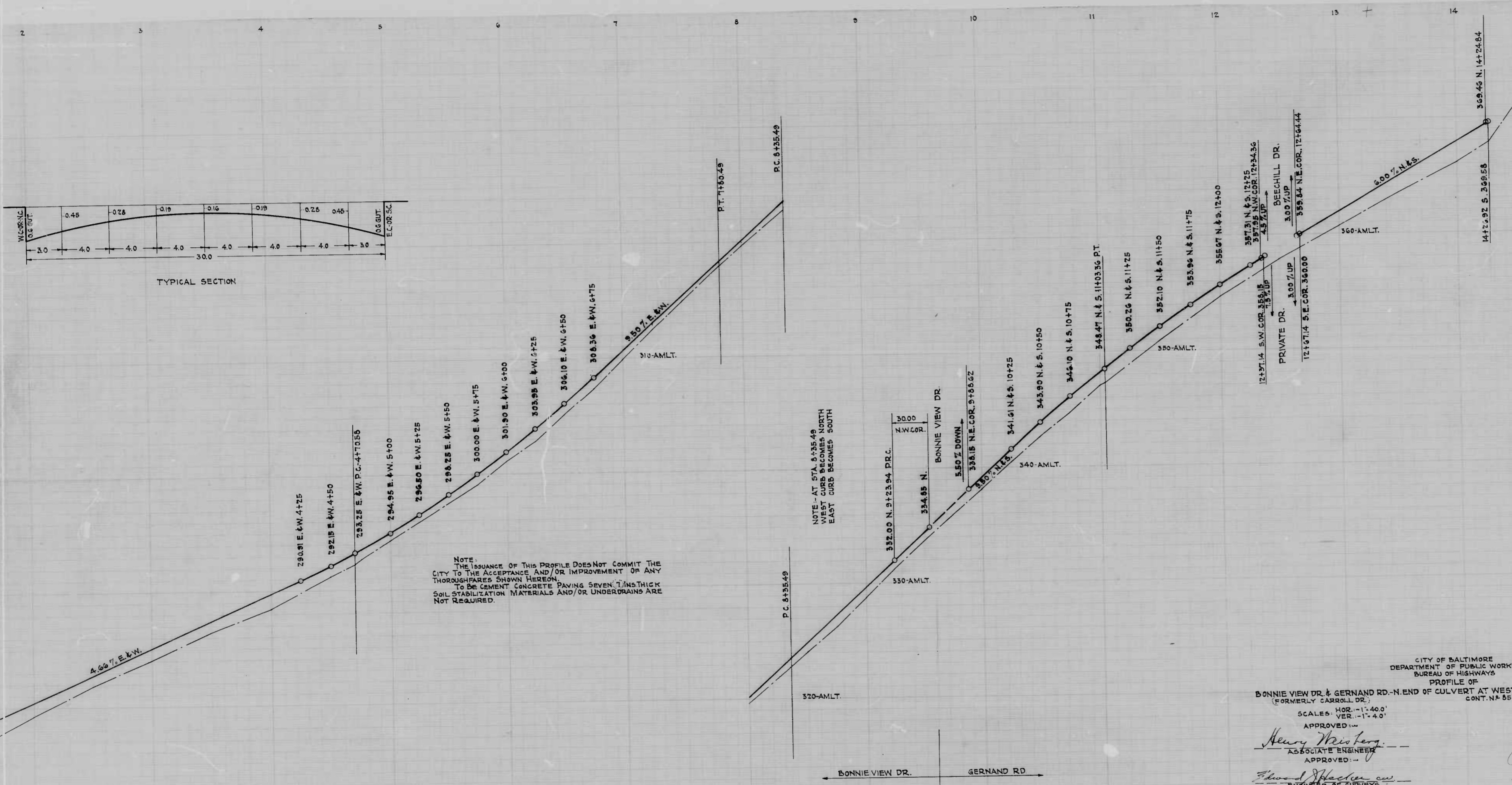
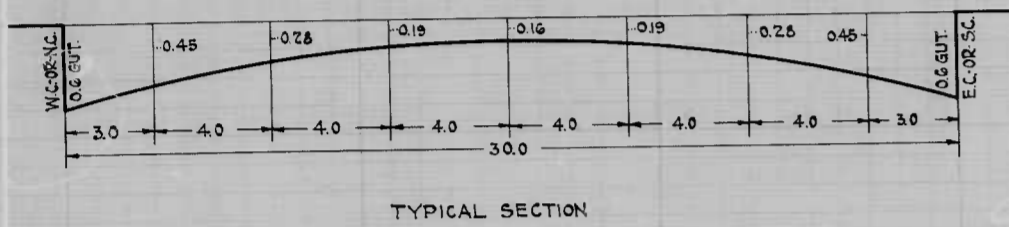

CITY OF BALTIMORE
 DEPARTMENT OF PUBLIC WORKS
 BUREAU OF HIGHWAYS

PROFILE OF
 BONNIE VIEW DR. & GERNAND RD. - N. END OF CULVERT AT WESTERN RUN TO 1495'± N.E. THEREOF
 (FORMERLY CARROLL DR.)
 CONT. N# 855

SCALE: HOR. - 1" = 40.0'
 VER. - 1" = 4.0'

APPROVED: *Henry Weisberg*
 ASSOCIATE ENGINEER

APPROVED: *James W. McGay*
 HIGHWAYS ENGINEER

APPROVED: *Nathan L. Smith*
 DIRECTOR OF PUBLIC WORKS

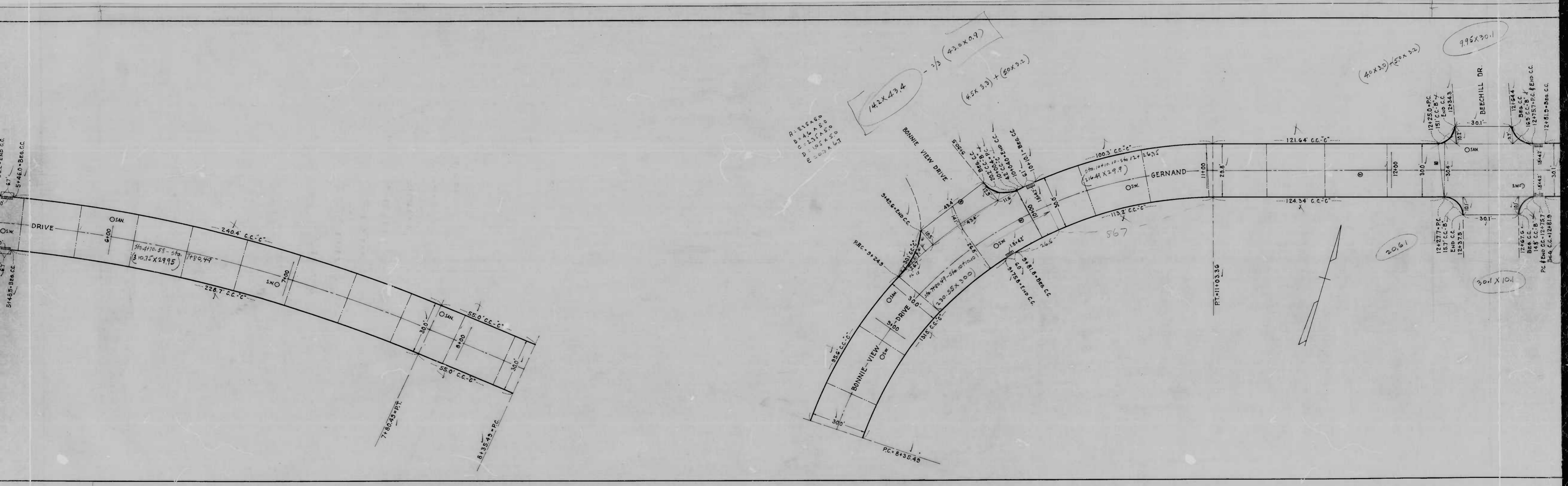

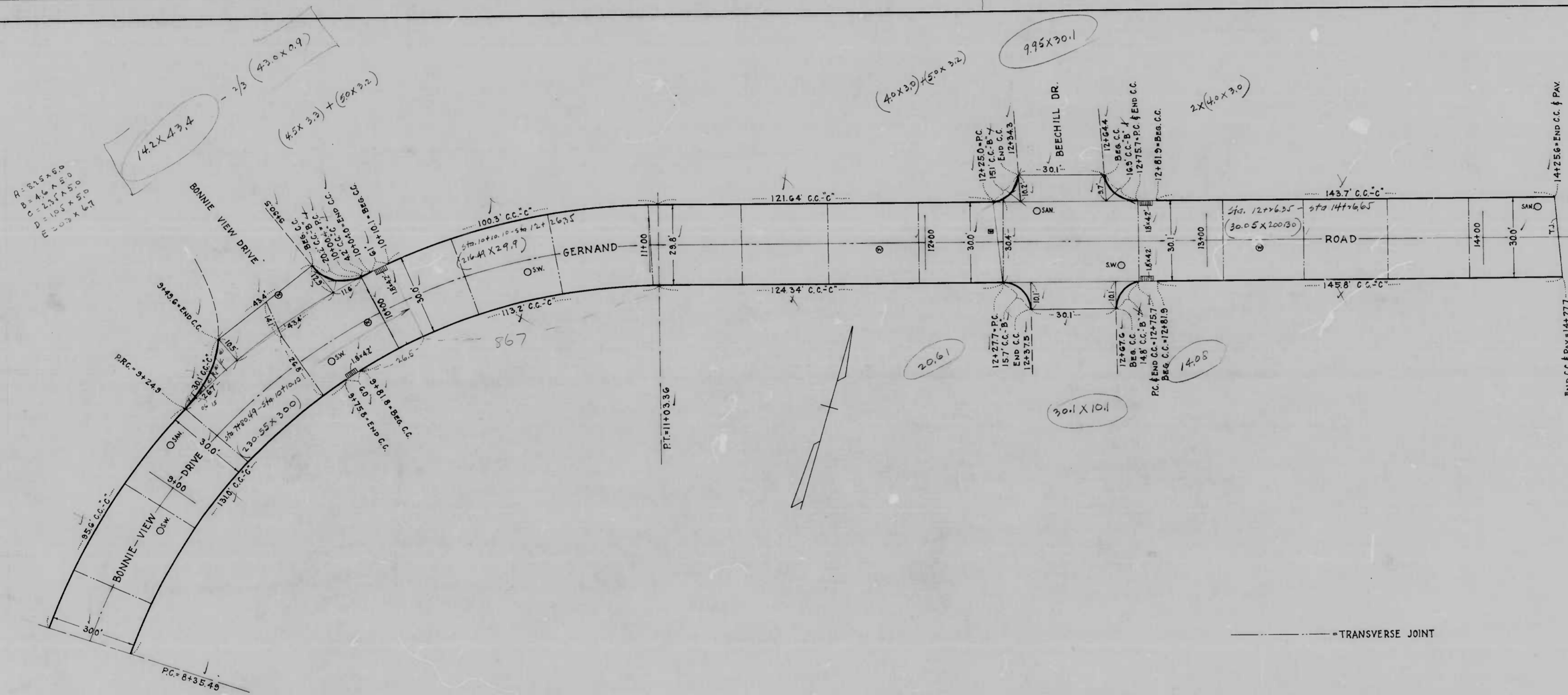

CITY OF BALTIMORE
 DEPARTMENT OF PUBLIC WORKS
 BUREAU OF HIGHWAYS
 CONT. No. 858
 BONNIE VIEW DRIVE & GERNAND RD
 (FORMERLY CARROLL DRIVE)
 N. END OF CULVERT AT WESTERN RUN - 1495 ± N.E.
 CEM. CONC. PAVING SEVEN (7) INCHES THICK
 PARAMOUNT CONSTRUCTION CO. - CONTRACTOR
 STARTED - 8-26-48 COMPLETED - 9-14-48
 SCALE - 1"=20' DATE - FEB. 1, 1949

BONNIE VIEW DRIVE & GERNAND RD (FORMERLY CARROLL DRIVE) - N. END OF CULVERT AT WESTERN RUN - 1495 ± N.E.
 CONT. No. 858

858

RATIO - 24 **4**

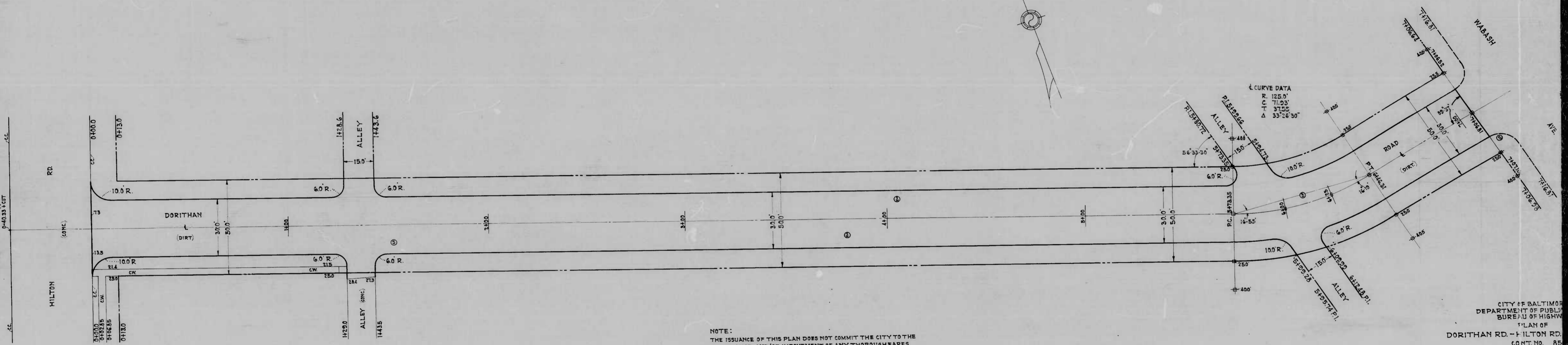

NOTE:
 THE ISSUANCE OF THIS PLAN DOES NOT COMMIT THE CITY TO THE
 ACCEPTANCE AND/OR IMPROVEMENT OF ANY THOROUGHFARES
 SHOWN THEREON.

NOTE:
 TO BE CEMENT CONCRETE PAVING, SEVEN (7) INCHES THICK.
 SOIL STABILIZATION MATERIALS AND/OR UNDERDRAINS
 ARE NOT REQUIRED.

CITY OF BALTIMORE
 DEPARTMENT OF PUBLIC
 BUREAU OF HIGHWAYS
 PLAN OF
 DORITHAN RD. - HILTON RD.
 CONT. NO. 85

SCALE: 1" = 20.0'

APPROVED:

Gene W. Mistry
 ASSOCIATE ENGINEER

APPROVED:

Edward M. Meston
 ENGINEER OF SURVEYS

D. Marley
[Signature]

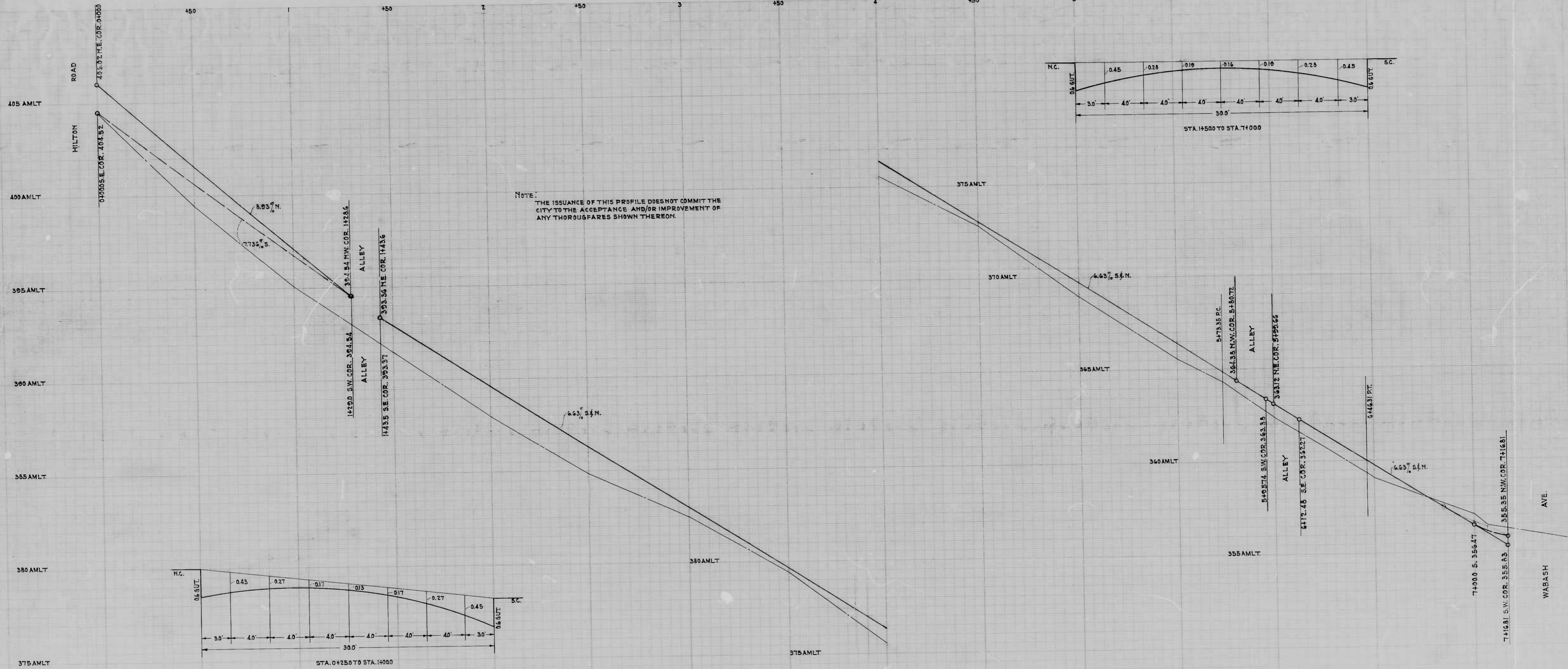

NOTE:
 THE ISSUANCE OF THIS PROFILE DOES NOT COMMIT THE CITY TO THE ACCEPTANCE AND/OR IMPROVEMENT OF ANY THOROUGHFARES SHOWN THEREON.

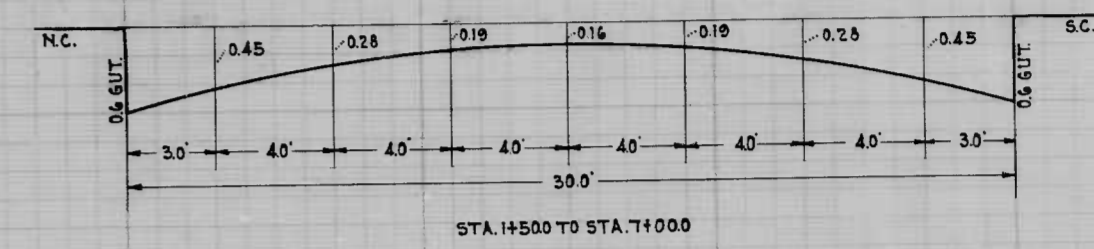
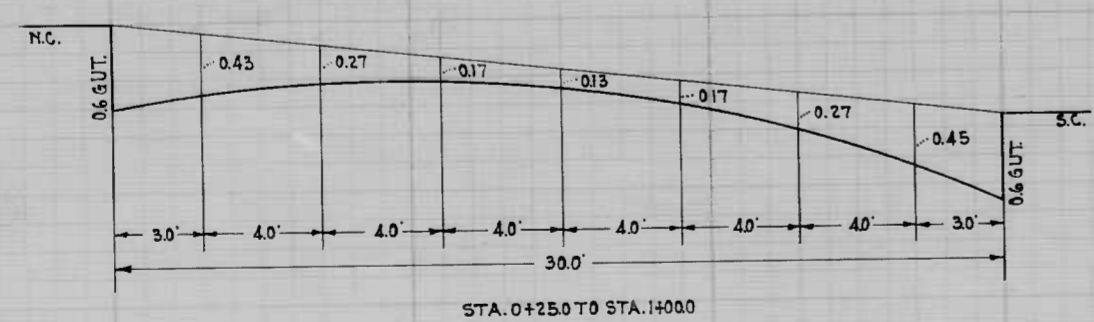

D. Marley
[Signature]

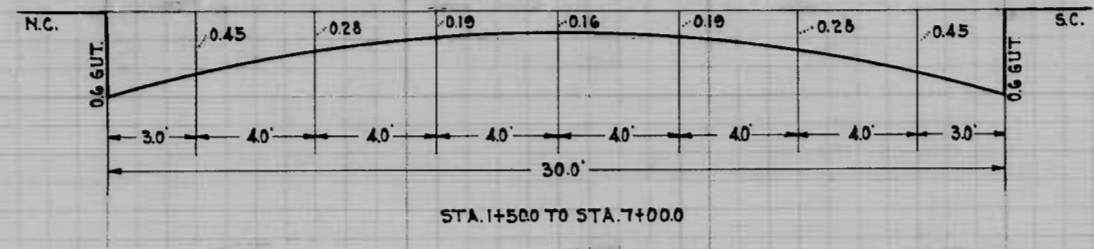

NOTE: THE ISSUANCE OF THIS PROFILE DOES NOT COMMIT THE CITY TO THE ACCEPTANCE AND/OR IMPROVEMENT OF ANY THOROUGHFARES SHOWN THEREON.

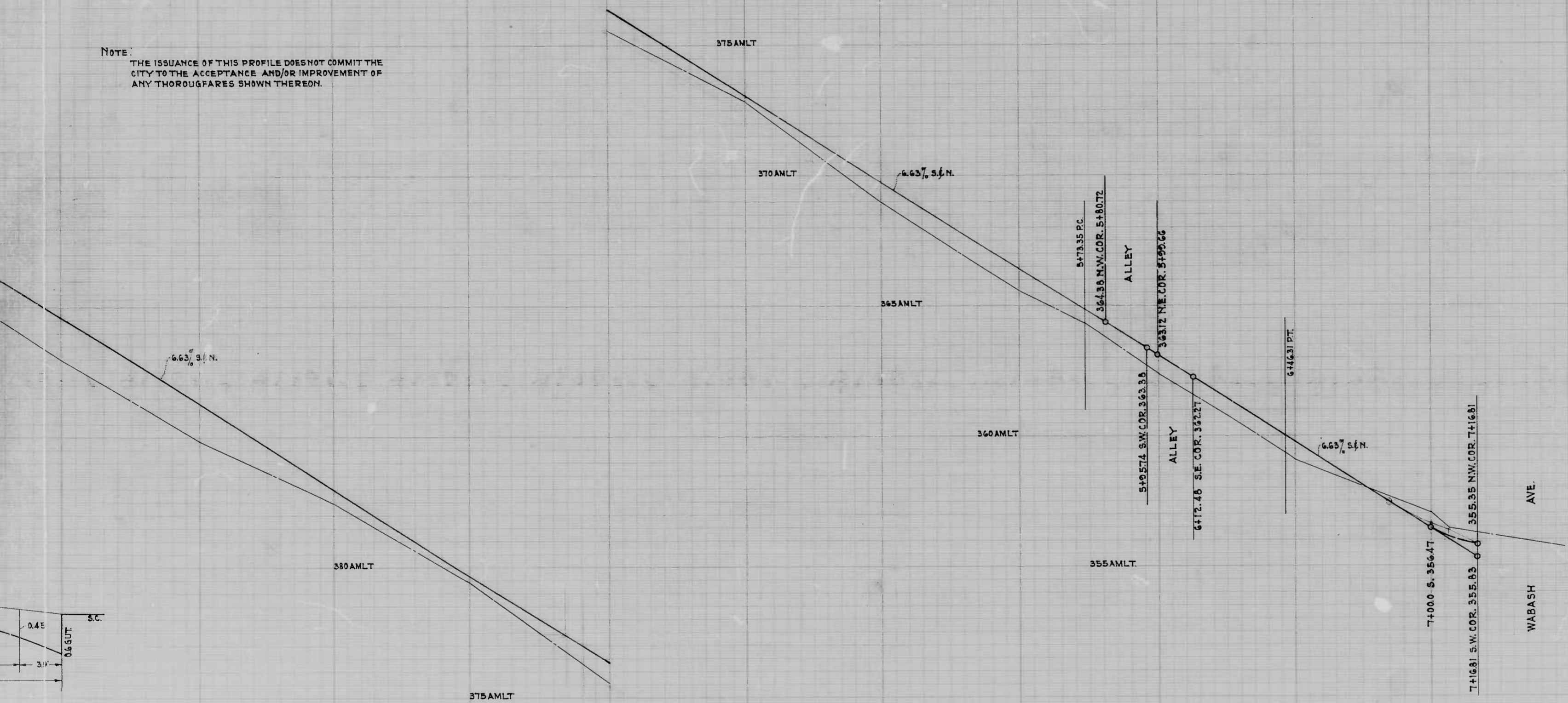

CITY OF BALTIMORE
 DEPARTMENT OF PUBLIC WORKS
 BUREAU OF HIGHWAYS
 PROFILE OF
 DORITHAN RD. - HILTON RD. TO WABASH AVE.
 HOR: 1"=20.0' BOOK NO. X-214
 SCALE: VER: 1"=2.0' CONT. NO. 555
 DATE: AUG. 4, 1947

APPROVED: *Henry Wacker* ASSOCIATE ENGINEER
 APPROVED: *James H. McKay* HIGHWAYS ENGINEER
 APPROVED: *Edward Wacker* ENGINEER OF SURVEYS
 APPROVED: *Orville R. Smith* DIRECTOR OF PUBLIC WORKS

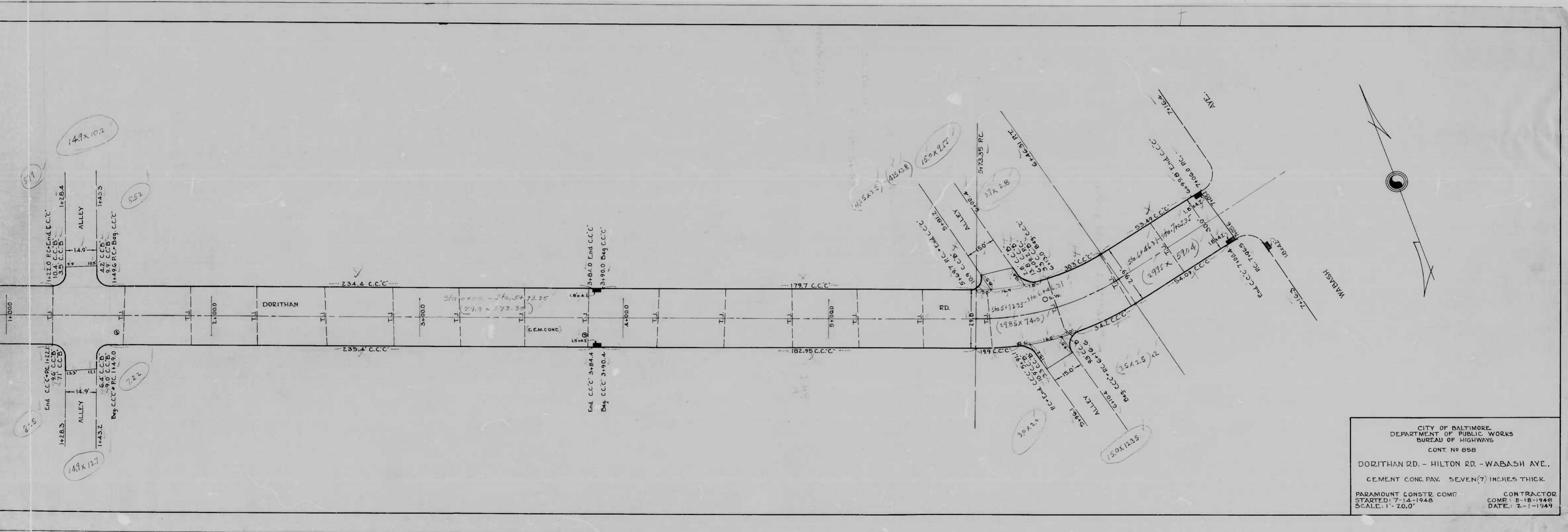

CITY OF BALTIMORE
 DEPARTMENT OF PUBLIC WORKS
 BUREAU OF HIGHWAYS
 CONT. No 858
 DORITHAN RD. - HILTON RD. - WABASH AVE.
 CEMENT CONC. PAY. SEVEN (7) INCHES THICK
 PARAMOUNT CONSTR. COMP. CONTRACTOR
 STARTED: 7-14-1948 COMP. 8-18-1948
 SCALE: 1" = 20.0' DATE: 2-1-1949