

NOTE:
 TO BE SHEET ASPHALT PAVING, 1 1/2" WEARING SURFACE, 1 1/2" BINDER
 ON AN EIGHT (8) INCH CONCRETE BASE.
 SOIL STABILIZATION MATERIALS AND/OR UNDERDRAINS ARE
 NOT REQUIRED.

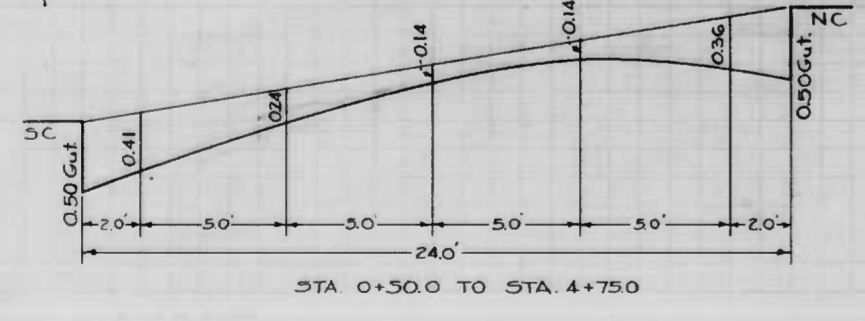
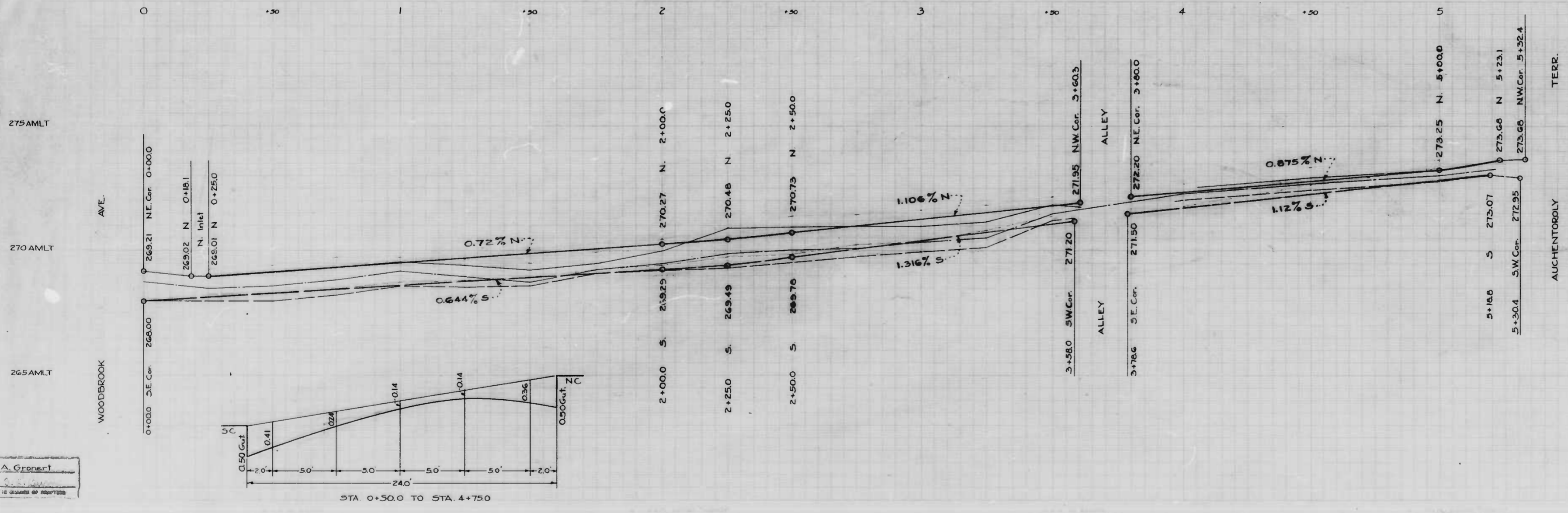
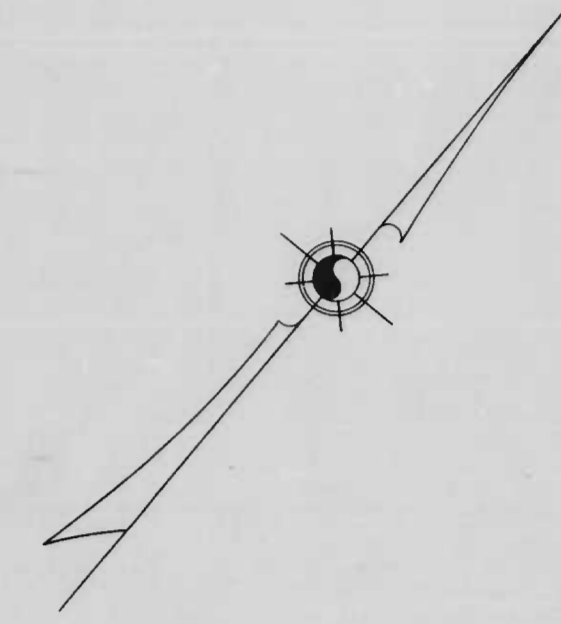

CITY OF BALTIMORE WORKS
 DEPARTMENT OF PUBLIC WORKS
 BUREAU OF HIGHWAYS
 PLAN & PROFILE
 BRYANT AVE - WOODBROOK AVE - AUCHENTOROLY TERR.
 SCALE: PLAN 1" = 20.0'
 PROF. 1" = 20.0'
 VER. 1" = 20'
 DATE: JUN. 27, 1947.
 APPROVED
 Edward Hecker
 ENGINEER OF SURVEYS
 APPROVED
 James H. Taylor
 HIGHWAYS ENGINEER
 APPROVED
 Mark R. Smith
 DIRECTOR OF PUBLIC WORKS

DESIGNED BY A. Gronert
 CHECKED BY S. S. S. S.
 IN ACCORDANCE WITH THE SPECIFICATIONS

CLEVELAND ST. - BAYARD ST. TO CAREY ST.

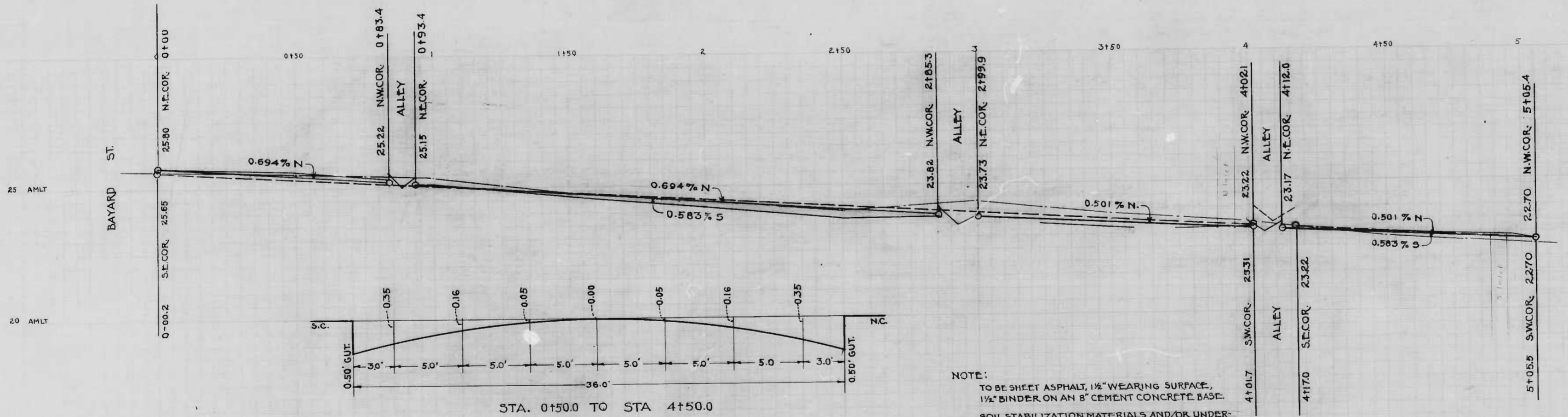
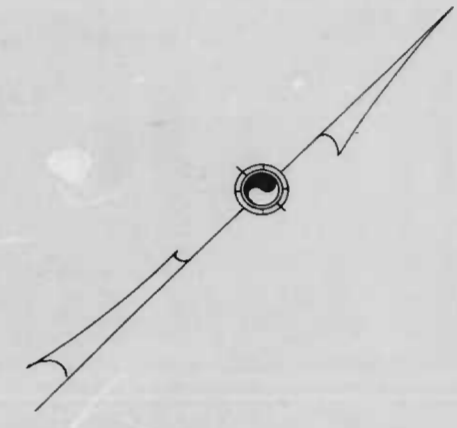
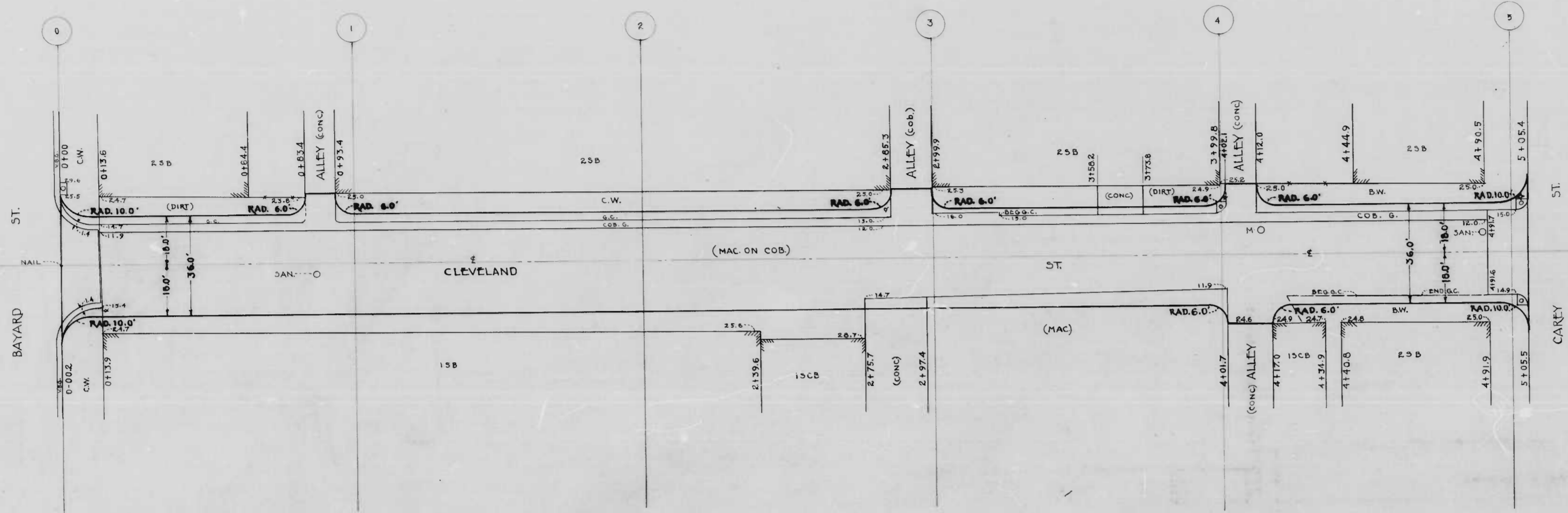

NOTE:
 TO BE SHEET ASPHALT, 1 1/2" WEARING SURFACE,
 1 1/2" BINDER ON AN 8" CEMENT CONCRETE BASE.
 SOIL STABILIZATION MATERIALS AND/OR UNDER
 DRAIN PIPE ARE NOT REQUIRED.

CITY OF BALTIMORE
 DEPARTMENT OF PUBLIC WORKS
 BUREAU OF HIGHWAYS
 PLAN & PROFILE OF
 CLEVELAND ST. - BAYARD ST. TO CAREY ST.
 CONT. NO. 854

SCALES: PLAN: 1" = 20.0'
 PROFILE: HOR.: 1" = 20.0'
 VER.: 1" = 02.0'

BOOK NO. X210
 DATE 7-25-47

APPROVED
Henry Weisberg
 ASSOCIATE ENGINEER

APPROVED
James M. Smith
 HIGHWAYS ENGINEER

APPROVED
Edward Shepley
 ENGINEER OF SURVEYS

APPROVED
Arthur R. Smith
 DIRECTOR OF PUBLIC WORKS

D. J. Dowling
 ENGINEER

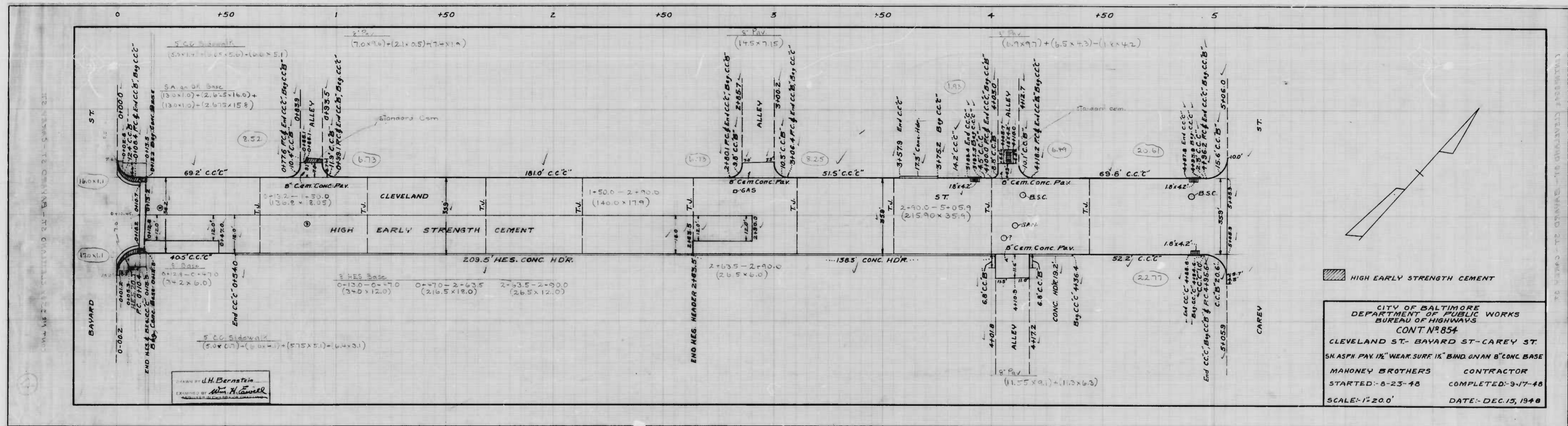

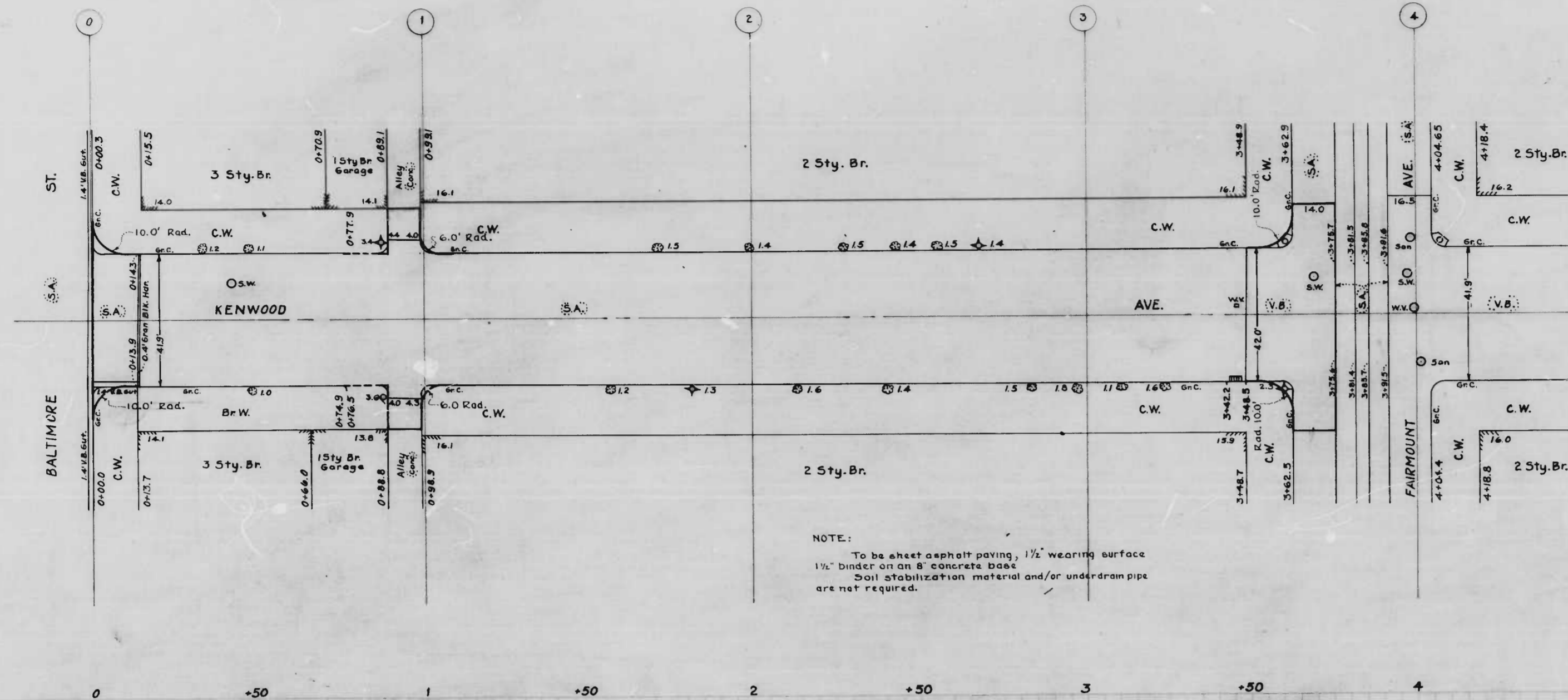

NOTE:
 To be sheet asphalt paving, 1 1/2" wearing surface
 1 1/2" binder on an 8" concrete base
 Soil stabilization material and/or underdrain pipe
 are not required.

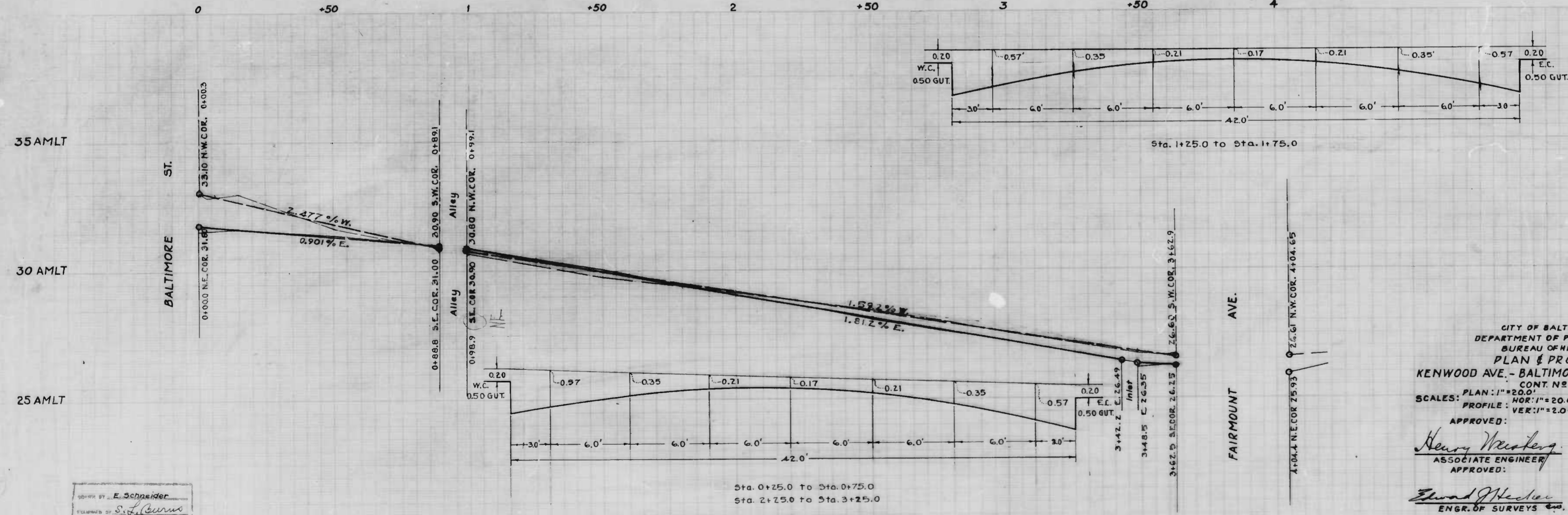

CITY OF BALTIMORE
 DEPARTMENT OF PUBLIC WORKS
 BUREAU OF HIGHWAYS
PLAN & PROFILE
KENWOOD AVE. - BALTIMORE ST. - FAIRMOUNT AVE.
 CONT. NO. 854
 PLAN: 1" = 20.0'
 PROFILE: 1" = 20.0'
 DATE: AUG. 4, 1947
 BOOK NO. X-227

APPROVED: *Henry Weisberg*
 ASSOCIATE ENGINEER

APPROVED: *James H. McKay*
 HIGHWAYS ENGINEER

APPROVED: *Edward J. Hecker*
 ENGR. OF SURVEYS

APPROVED: *Charles R. Smith*
 DIRECTOR OF PUBLIC WORKS

Drawn by: *E. Schneider*
 Checked by: *S. J. Curran*

