

NOTE: THE ISSUANCE OF THIS PLAN & PROFILE DOES NOT COMMIT THE CITY TO THE ACCEPTANCE AND/OR IMPROVEMENT OF ANY THROUGHFARES SHOWN THEREON TO BE CEMENT CONCRETE PAVING SEVEN INCHES THICK. SOIL STABILIZATION MATERIALS AND/OR UNDERDRAINS ARE NOT REQUIRED.

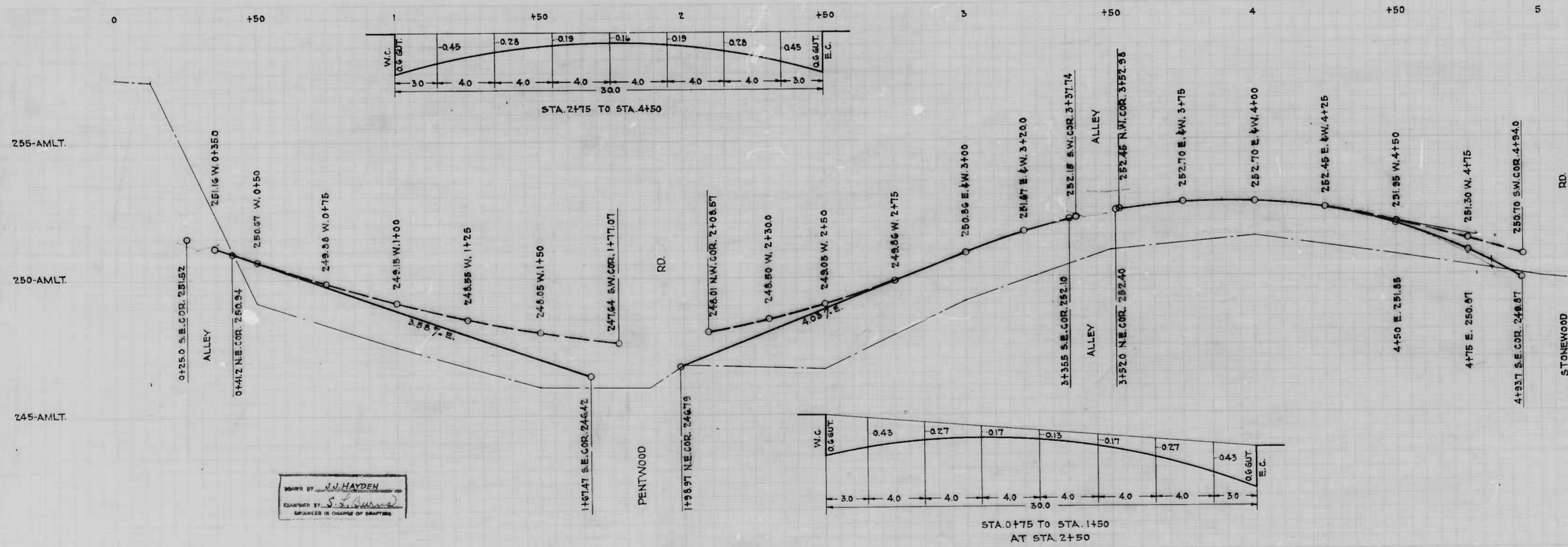

DRAWN BY: J. J. HAYDEN
 REVISION BY: J. J. HAYDEN
 ENGINEER IN CHARGE OF DRAWING

CITY OF BALTIMORE
 DEPARTMENT OF PUBLIC WORKS
 BUREAU OF HIGHWAYS
 PLAN & PROFILE
 FENWICK AVE. - AL. S. - PENTWOOD RD. TO STONEWOOD RD.
 CONT. N° 852
 BOOK N° X 234
 SCALES: PLAN - 1" = 20' HOR. - 1" = 20' VER. - 1" = 20'
 JUNE 14, 1947
 APPROVED: Henry Wierberg, ASSOCIATE ENGINEER
 APPROVED: [Signature], HIGHWAYS ENGINEER
 APPROVED: [Signature], ENGINEER OF SURVEYS
 APPROVED: [Signature], DIRECTOR OF PUBLIC WORKS

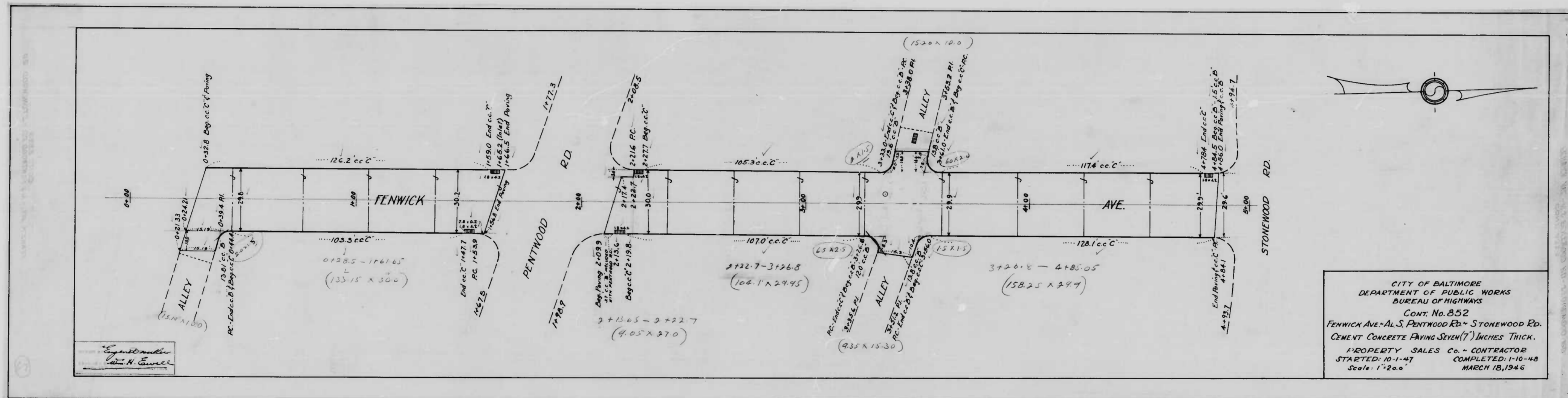

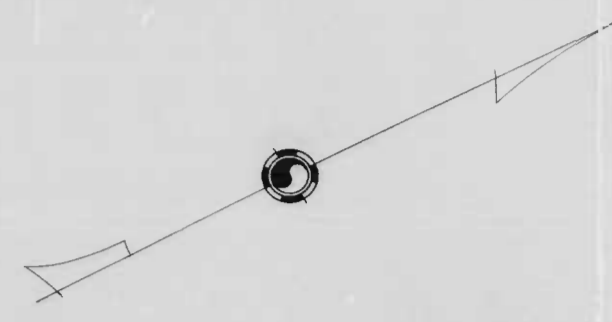
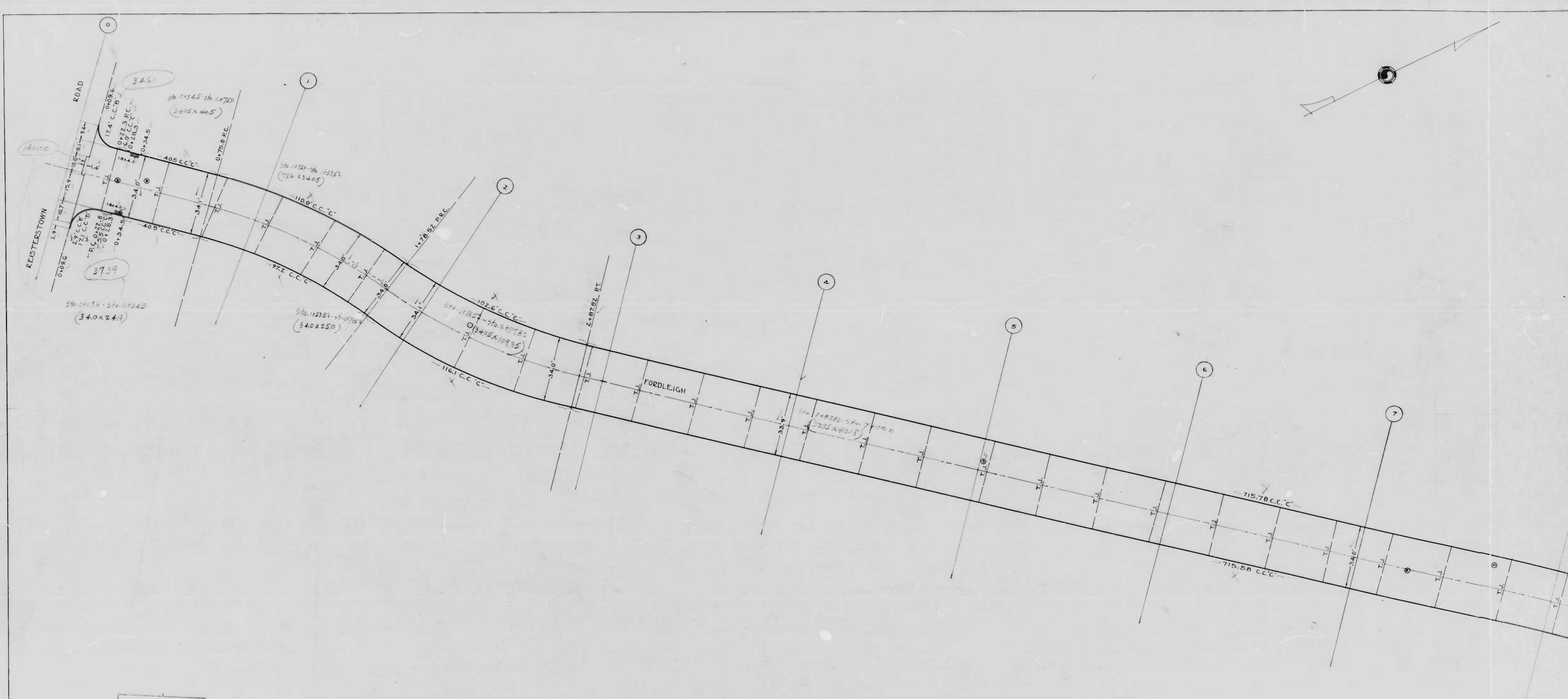

Drawn by: R.J. Winkel
Checked by: W.H. Ewell

LAND/ENR-35 ANTWERP/PA 07 10002 PV 01
C07 04 92-1

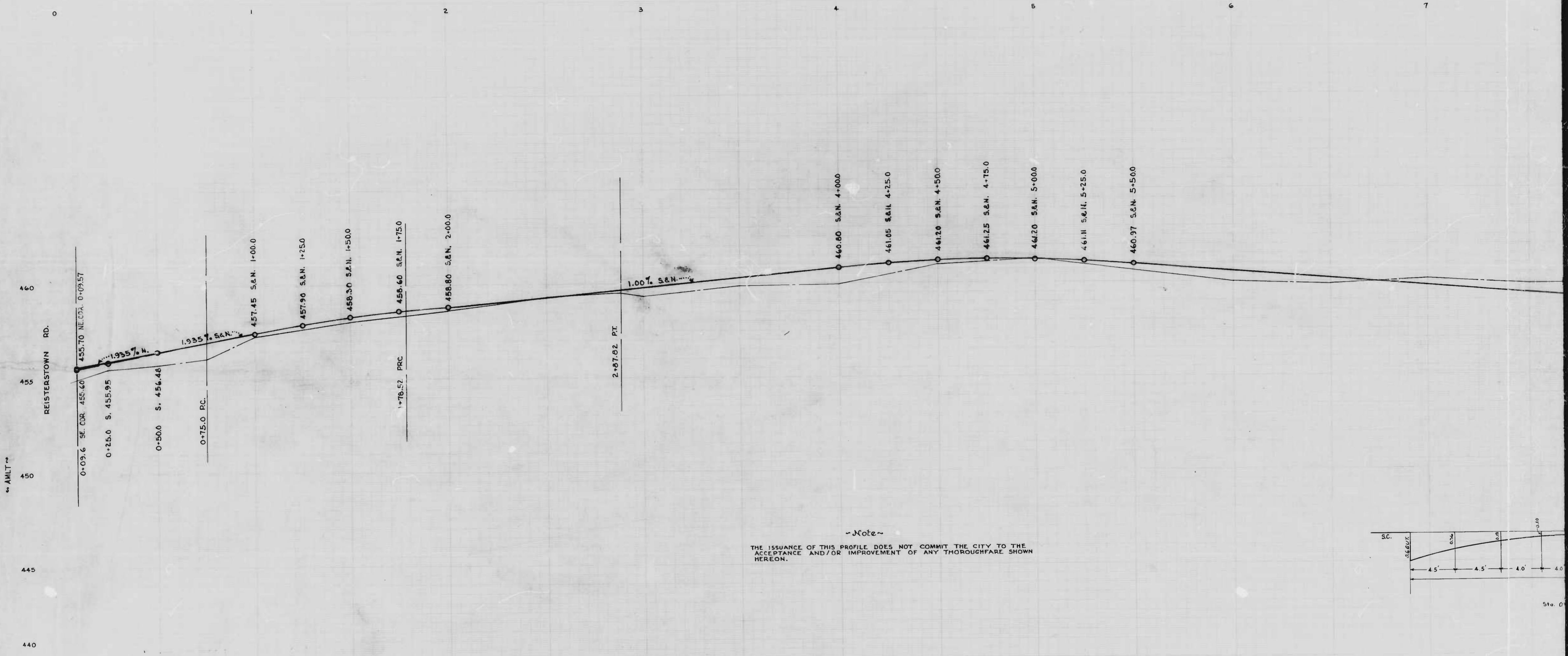

~Note~
 THE ISSUANCE OF THIS PROFILE DOES NOT COMMIT THE CITY TO THE
 ACCEPTANCE AND/OR IMPROVEMENT OF ANY THOROUGHFARE SHOWN
 HEREON.

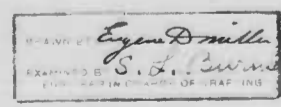
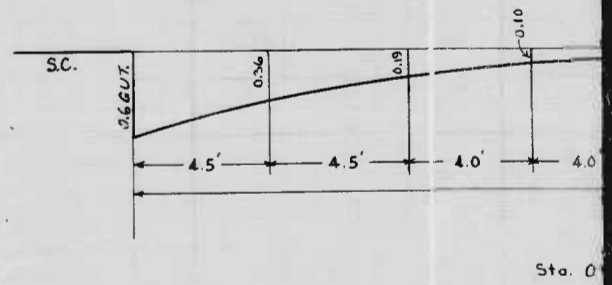

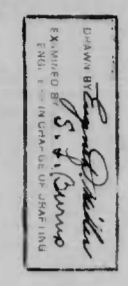

FOR THE CITY OF BALTIMORE
COM. No. 985

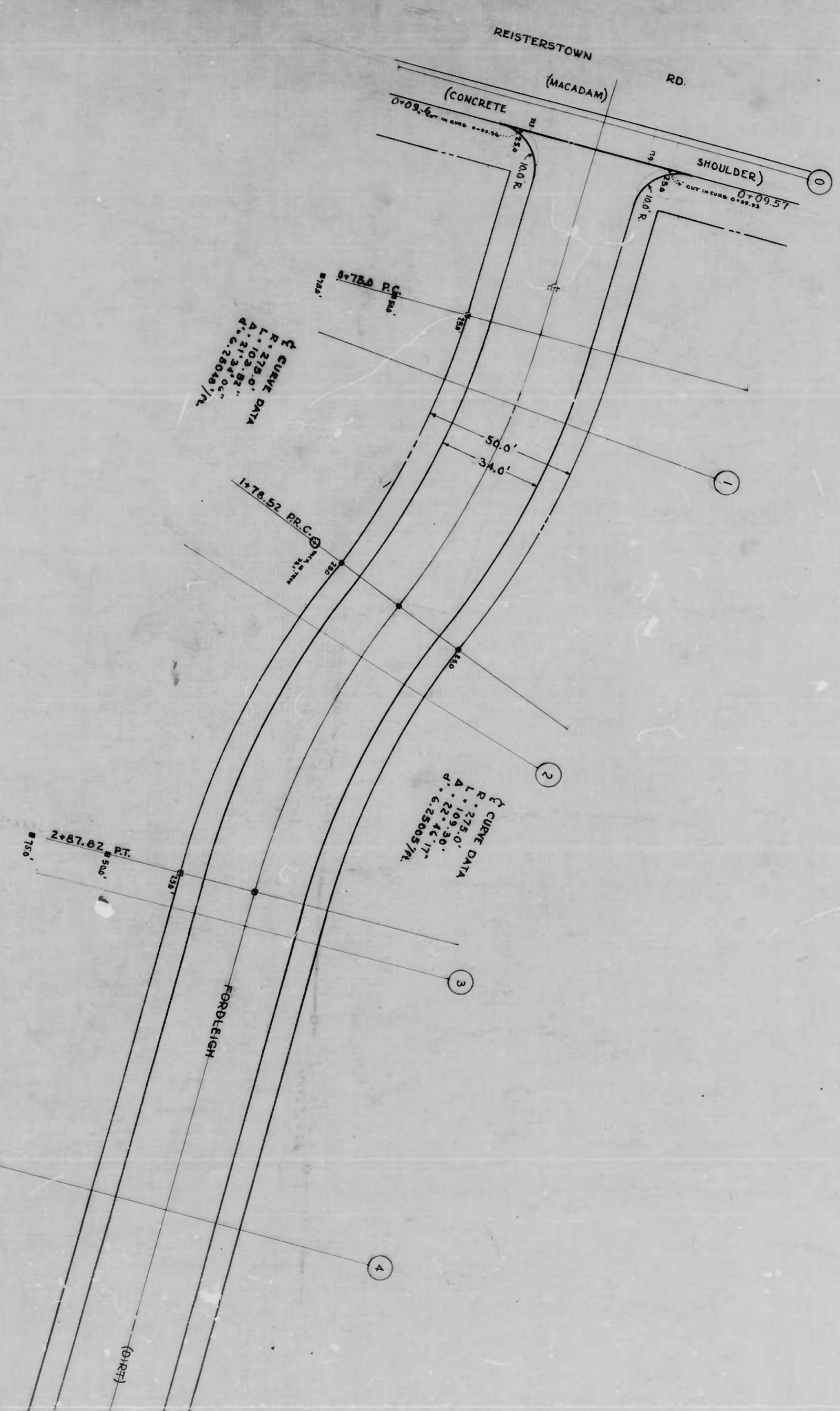

NOTE
 THE ISSUANCE OF THIS PLAN DOES NOT COMMIT THE CITY TO THE ACCEPTANCE AND/OR IMPROVEMENT OF ANY THOROUGHFARE SHOWN HEREON. TO BE CEMENT CONCRETE PAVING 7" THICK. SOIL STABILIZATION MATERIALS AND/OR UNDERDRAINS ARE NOT REQUIRED.

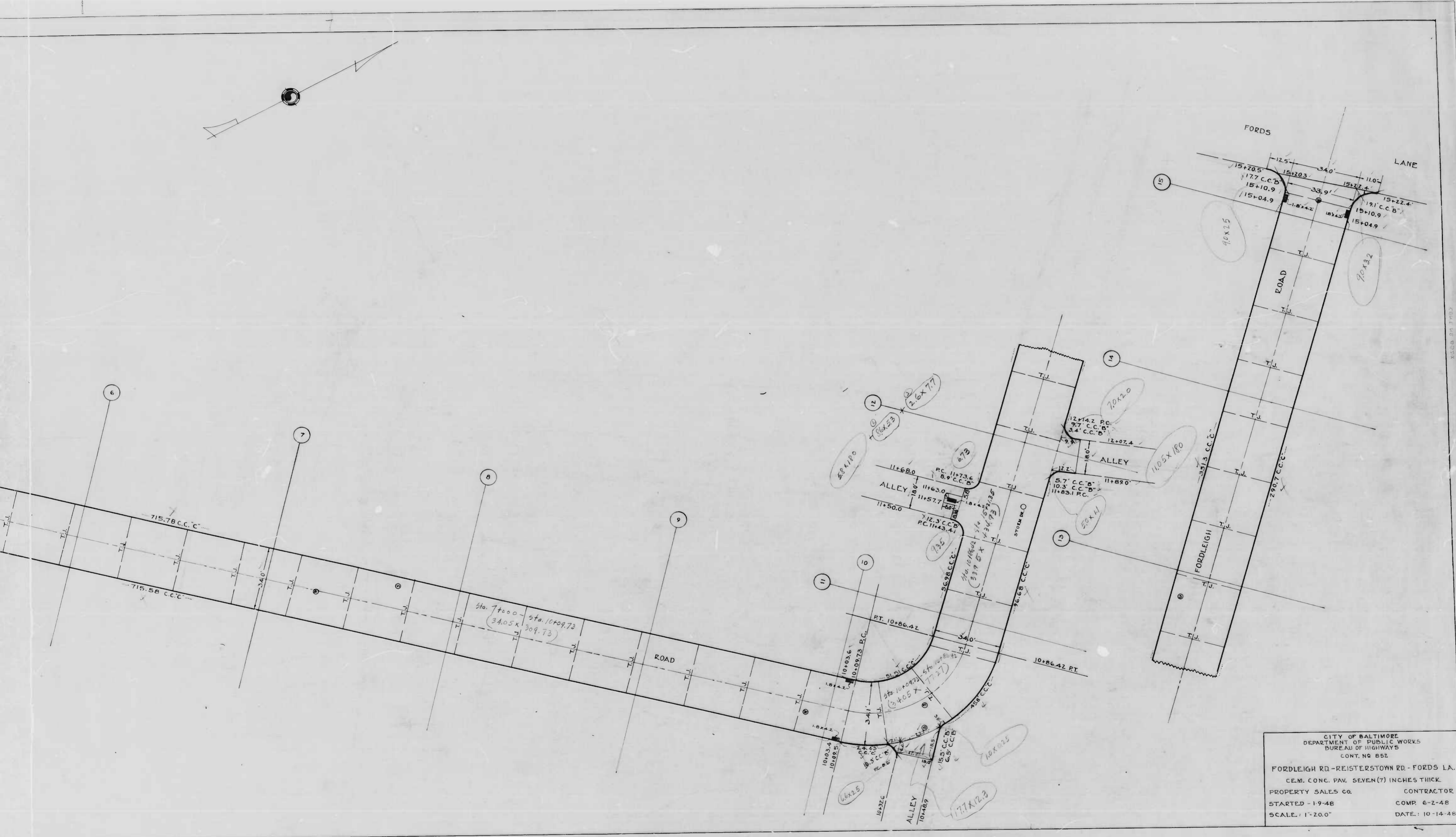
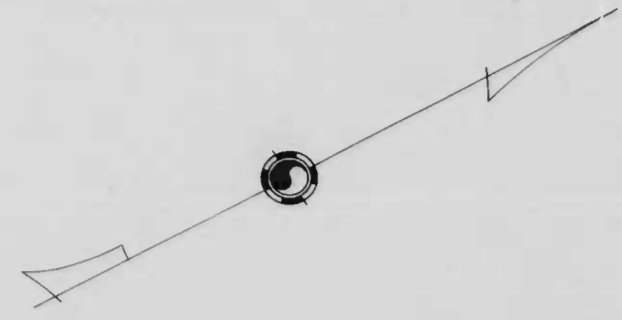

CITY OF BALTIMORE
 DEPARTMENT OF PUBLIC WORKS
 BUREAU OF HIGHWAYS
 CONT. NO. 852

FORDLEIGH RD - REISTERSTOWN RD - FORDS L.A.
 C.E.M. CONC. PAV. SEVEN (7) INCHES THICK.
 PROPERTY SALES CO. CONTRACTOR
 STARTED - 1-9-48 COMP. 6-2-48
 SCALE: 1"=20.0' DATE: 10-14-48

FORDLEIGH RD - REISTERSTOWN RD - FORDS L.A. 10002 (V)

852

3



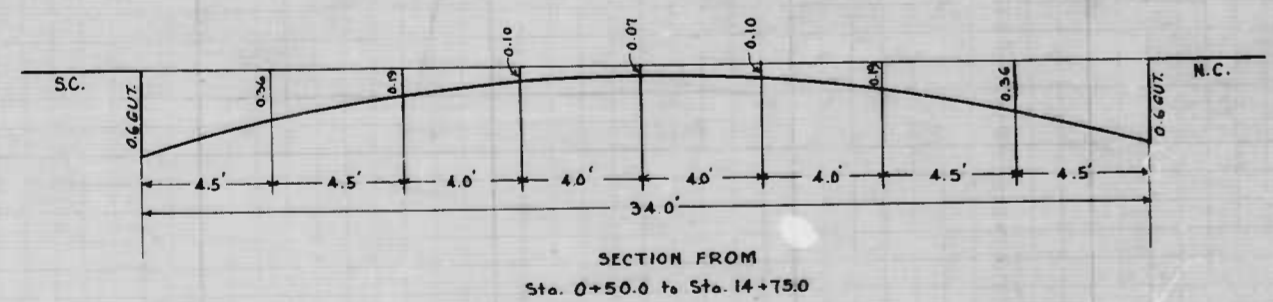
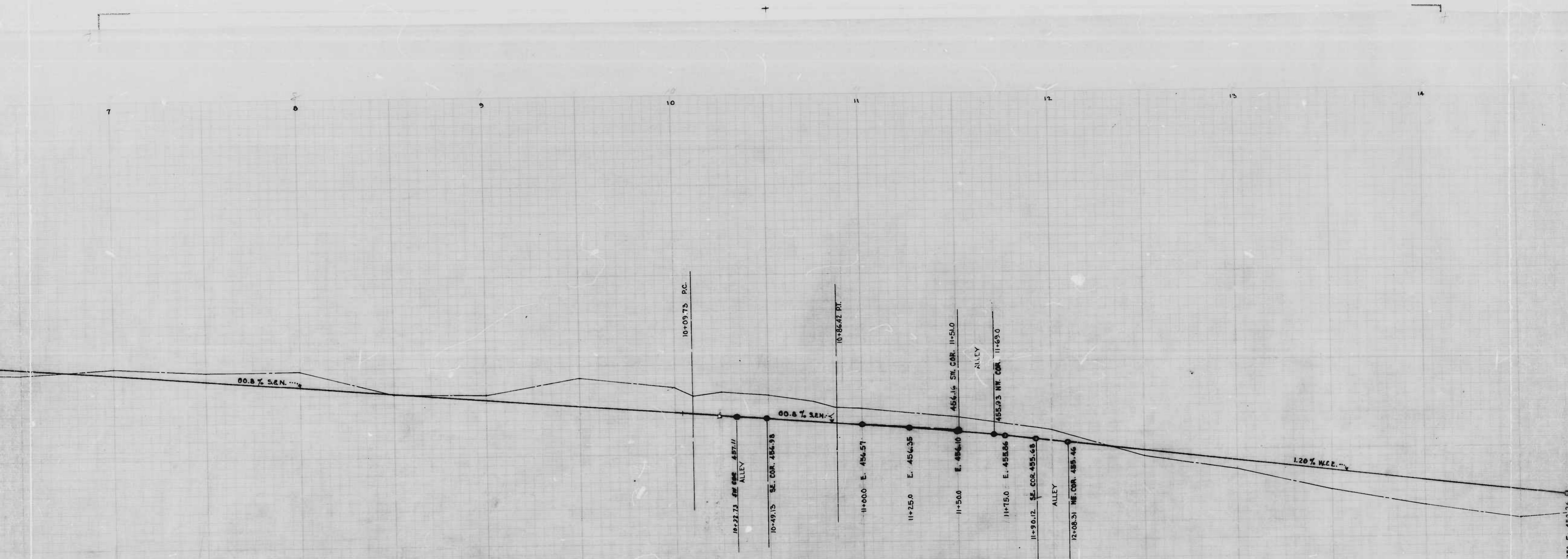

NOTE ~
 ● STATION 10+86.42 P.I.
 N. CURB BECOMES W. CURB
 S. CURB BECOMES E. CURB

CITY OF BALTIMORE
 DEPARTMENT OF PUBLIC WORKS
 BUREAU OF HIGHWAYS
 PROFILE OF
 FORDLEIGH RD.- REISTERSTOWN RD.- FORDS LANE
 CONT. NO. 852
 BOOK X-222
 August 27, 1947

APPROVED:
Henry Winkler
 ASSOCIATE ENGINEER

APPROVED:
James H. DeLong
 HIGHWAYS ENGINEER

APPROVED:
James H. DeLong
 ENGINEER OF SURVEYS

APPROVED:
Frank R. Smith
 DIRECTOR OF PUBLIC WORKS

Established grade used

852

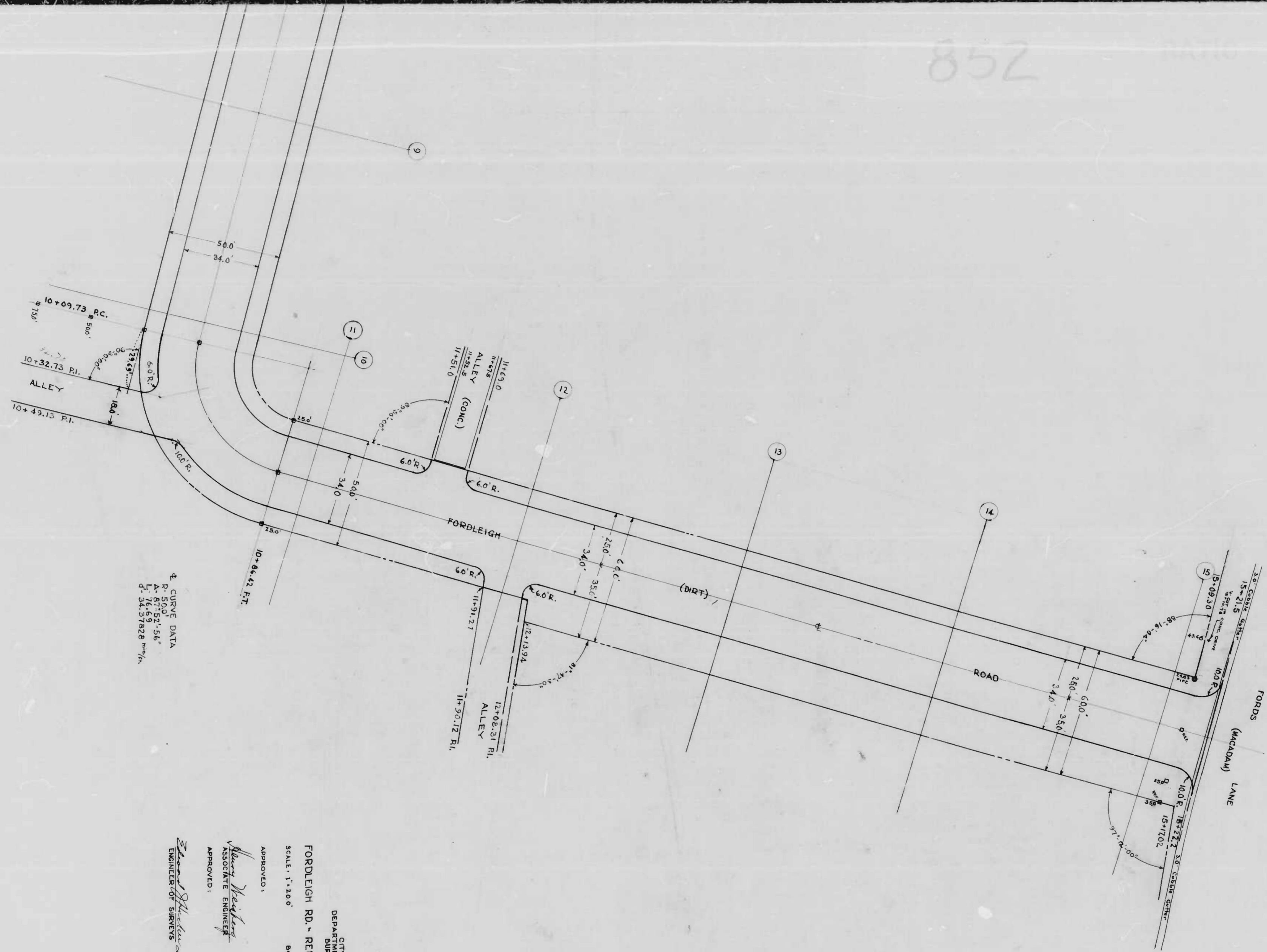

4. CURVE DATA
 P- 50.0'
 A- 57°52'56"
 L- 16.69
 D- 34.57828 m/m

CITY OF BALTIMORE
 DEPARTMENT OF PUBLIC WORKS
 BUREAU OF HIGHWAYS
 PLAN OF
FORDLEIGH RD. - REISTERSTOWN RD. - FORDS LANE
 SCALE: 1" = 20.0'
 BOOK NO. X212
 JULY 10, 1981

APPROVED: *[Signature]*
 ASSOCIATE ENGINEER

APPROVED: *[Signature]*
 HIGHWAYS ENGINEER

APPROVED: *[Signature]*
 ENGINEER OF SURVEYS

APPROVED: *[Signature]*
 DIRECTOR OF PUBLIC WORKS

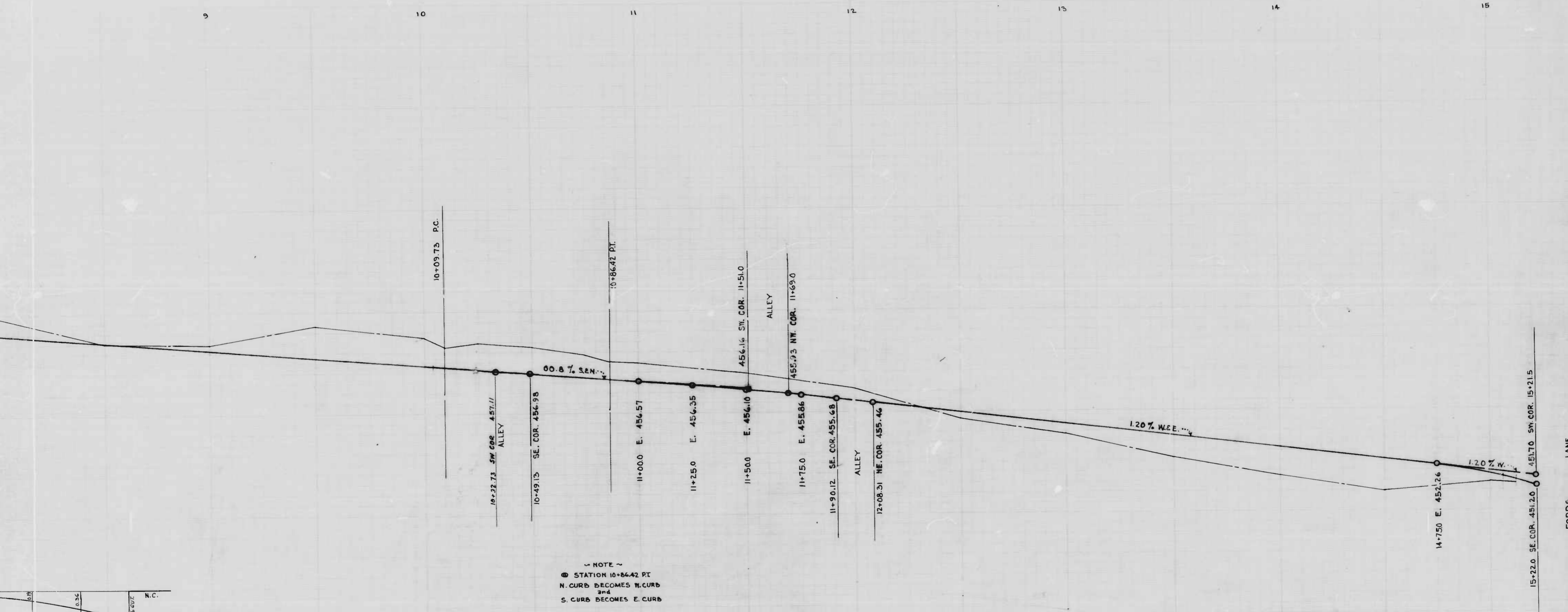

NOTE
 @ STATION 10+86.42 PT
 N. CURB BECOMES W. CURB
 and
 S. CURB BECOMES E. CURB

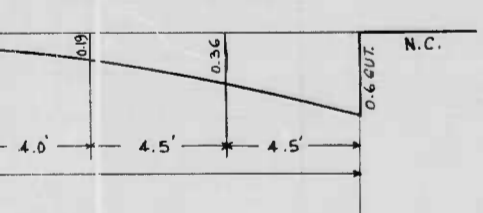

CITY OF BALTIMORE
 DEPARTMENT OF PUBLIC WORKS
 BUREAU OF HIGHWAYS
 PROFILE OF
 FORDLEIGH RD.- REISTERSTOWN RD.- FORDS LANE

Scale -
 HOR. 1" = 20'
 VER. 1" = 20.0'

CONT. NO. 852
 BOOK X-222
 August 27, 1947

APPROVED:
Henry Weisberg
 ASSOCIATE ENGINEER

APPROVED:
James A. [Signature]
 HIGHWAYS ENGINEER

APPROVED:
[Signature]
 ENGINEER OF SURVEYS

APPROVED:
[Signature]
 DIRECTOR OF PUBLIC WORKS

Established grade used

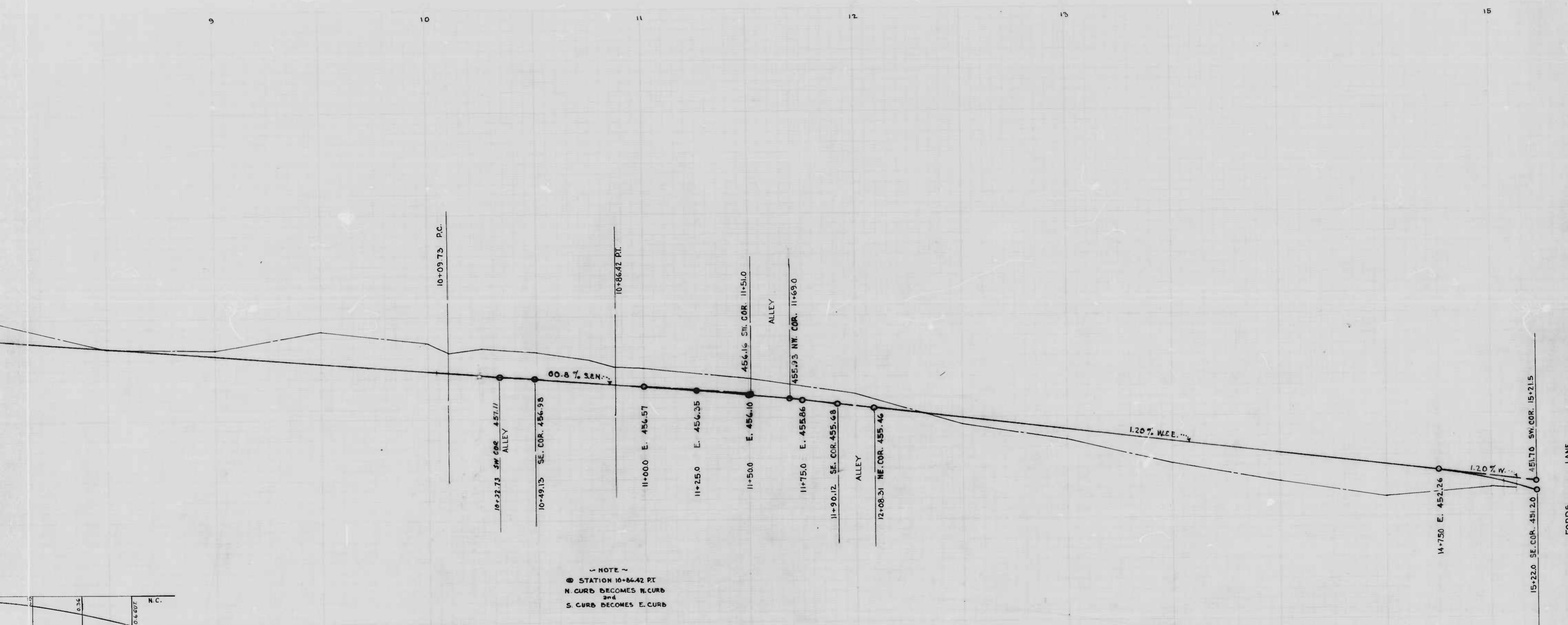

NOTE ~
 @ STATION 10+86.42 PT
 N. CURB BECOMES N. CURB
 and
 S. CURB BECOMES E. CURB

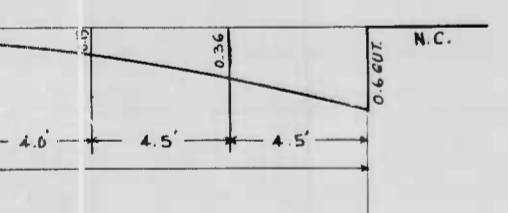

CITY OF BALTIMORE
 DEPARTMENT OF PUBLIC WORKS
 BUREAU OF HIGHWAYS
 PROFILE OF
 FORDLEIGH RD. - REISTERSTOWN RD. - FORDS LANE
 - Scales -
 HOR - 2.0"
 VER - 20.0"
 CONT. NO. 852
 BOOK X-222
 August 27, 1947

APPROVED: *Henry Weisberg*
 ASSOCIATE ENGINEER

APPROVED: *James H. [Signature]*
 HIGHWAYS ENGINEER

APPROVED: *[Signature]*
 ENGINEER OF SURVEYS

APPROVED: *[Signature]*
 DIRECTOR OF PUBLIC WORKS

Established grade used

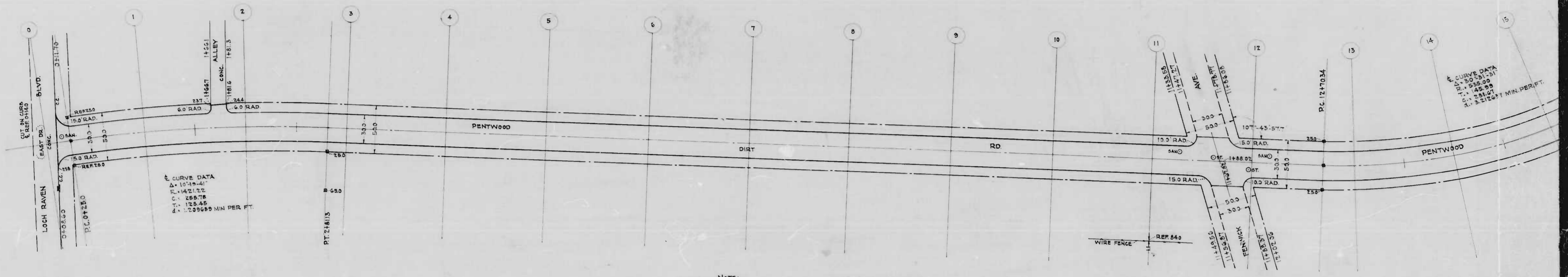

NOTE:
 THE ISSUANCE OF THIS PLAN & PROFILE DOES NOT COMMIT THE CITY TO THE ACCEPTANCE AND/OR IMPROVEMENT OF ANY THOROUGHFARES SHOWN THEREON.
 TO BE CEMENT CONCRETE PAVING SEVEN INCHES THICK SOIL STABILIZATION MATERIAL AND/OR UNDERDRAINS ARE NOT REQUIRED.

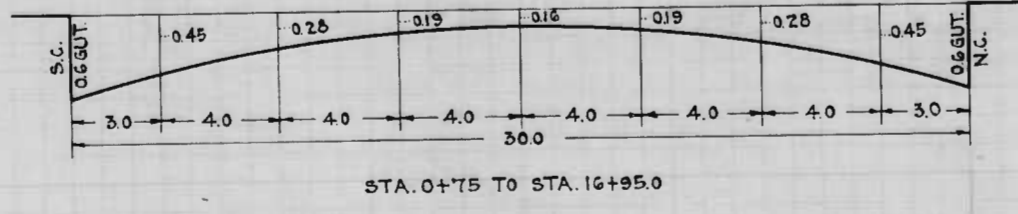
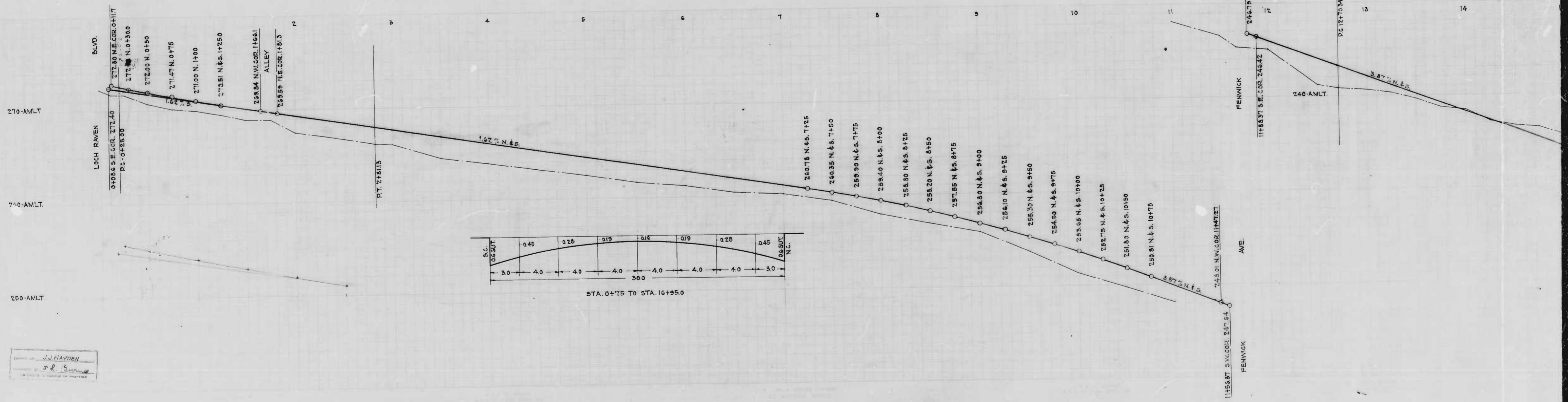

J. HAYDEN
 S. R. BUNN

2004 10 15 PENTWOOD SEC. FOUR DVAH DTAD. UNTER ED.

$(10.4 \times 2.4) = 49.58$

$(14.90 \times 30.1) = 448.30$

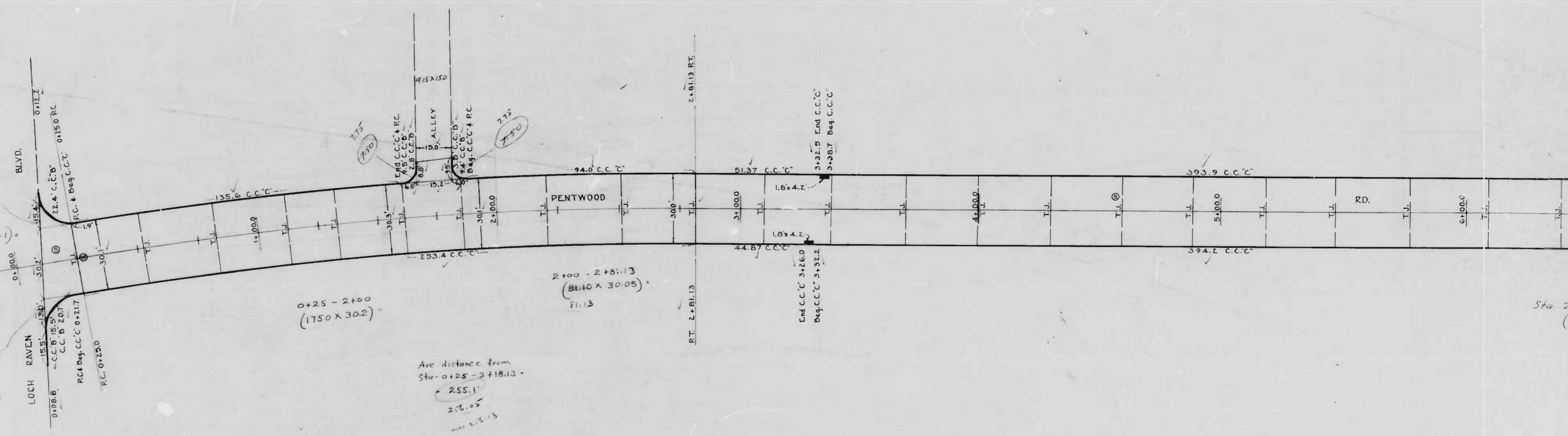

R.J. Winkel
Wm. H. Conwell

Sta. 2+ (8)

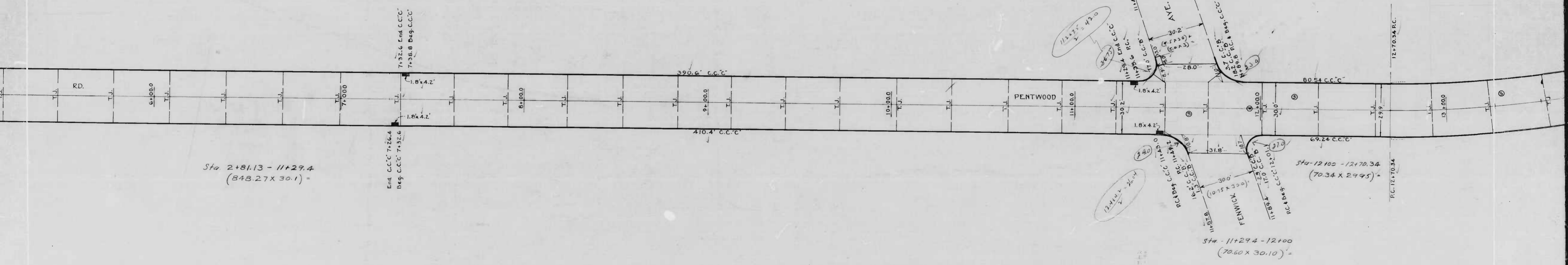

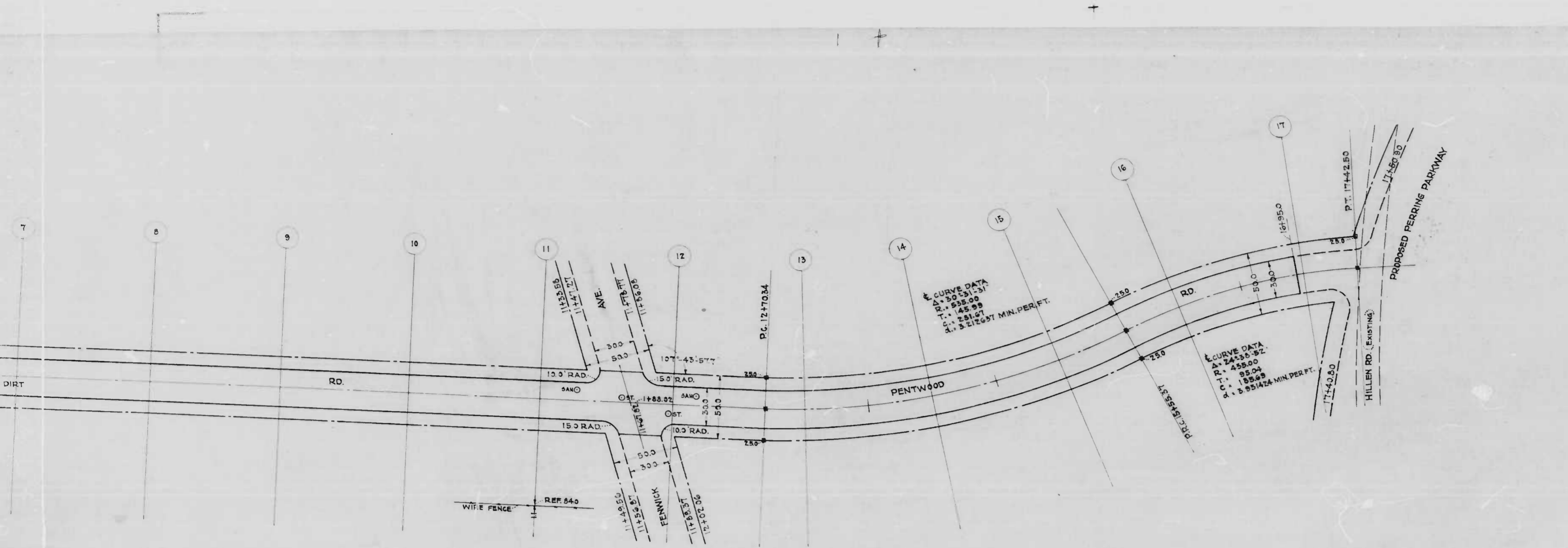

THE ISSUANCE OF THIS PLAN & PROFILE DOES NOT COMMIT THE CITY TO THE ACCEPTANCE AND/OR IMPROVEMENT OF ANY THOSE SIGNATURES SHOWN THEREON. TO BE CEMENT CONCRETE PAVING SEVEN INCHES THICK WITH STABILIZATION MATERIAL AND/OR UNDERDRAINS NOT REQUIRED.

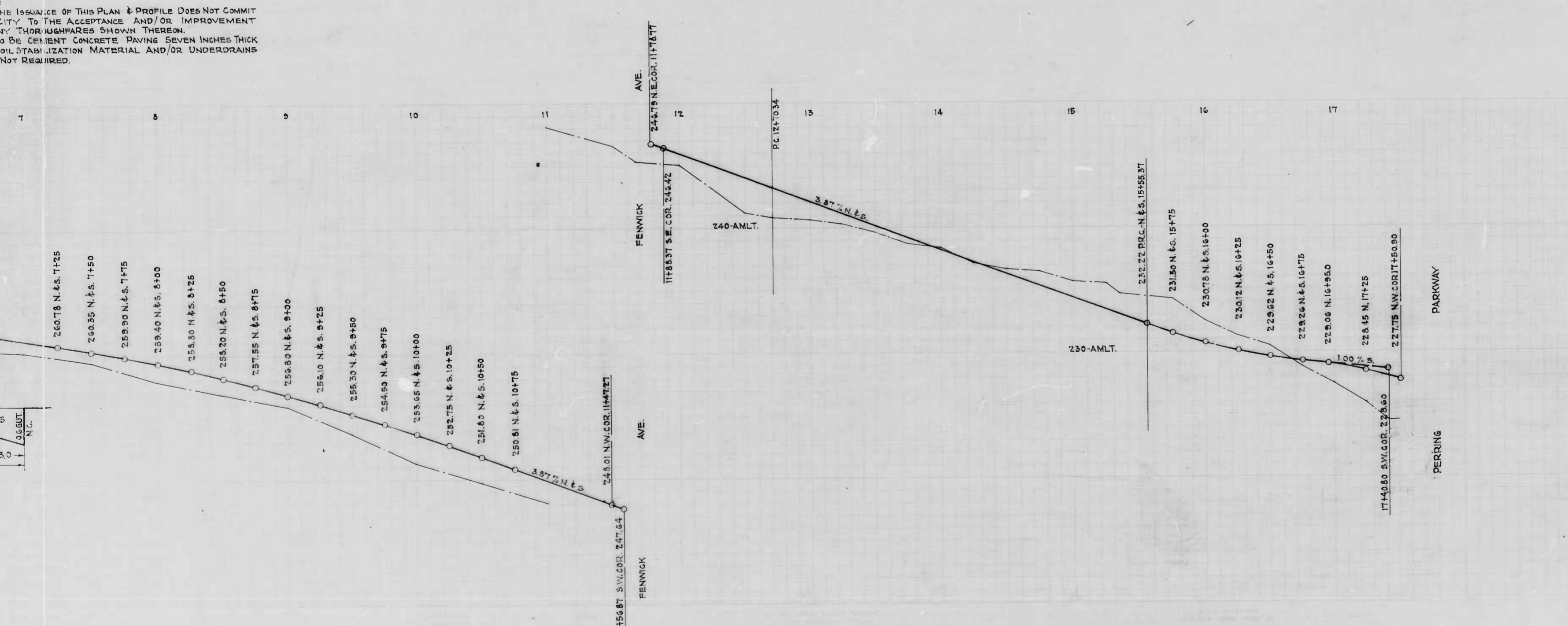

CITY OF BALTIMORE
 DEPARTMENT OF PUBLIC WORKS
 BUREAU OF HIGHWAYS
 PLAN & PROFILE
 PENTWOOD RD. - LOCH RAVEN BLVD. TO HILLEN RD.
 SHEET NO. 852
 SCALE: PLAN - 1"=40'
 PROFILE - HOR. - 1"=40'
 VER. - 1"=40'
 BOOK NO. 852
 JULY 1, 1947
 APPROVED: *Edward J. McHenry* ASSOCIATE ENGINEER
 APPROVED: *James A. McHenry* HIGHWAYS ENGINEER
 APPROVED: *Edward J. McHenry* ENGINEER OF SURVEYS
 APPROVED: *Paul C. Fisher* DIRECTOR OF PUBLIC WORKS

THIS PLAN AND PROFILE ARE THE PROPERTY OF THE CITY OF BALTIMORE AND ARE NOT TO BE REPRODUCED OR COPIED WITHOUT THE WRITTEN PERMISSION OF THE CITY ENGINEER.

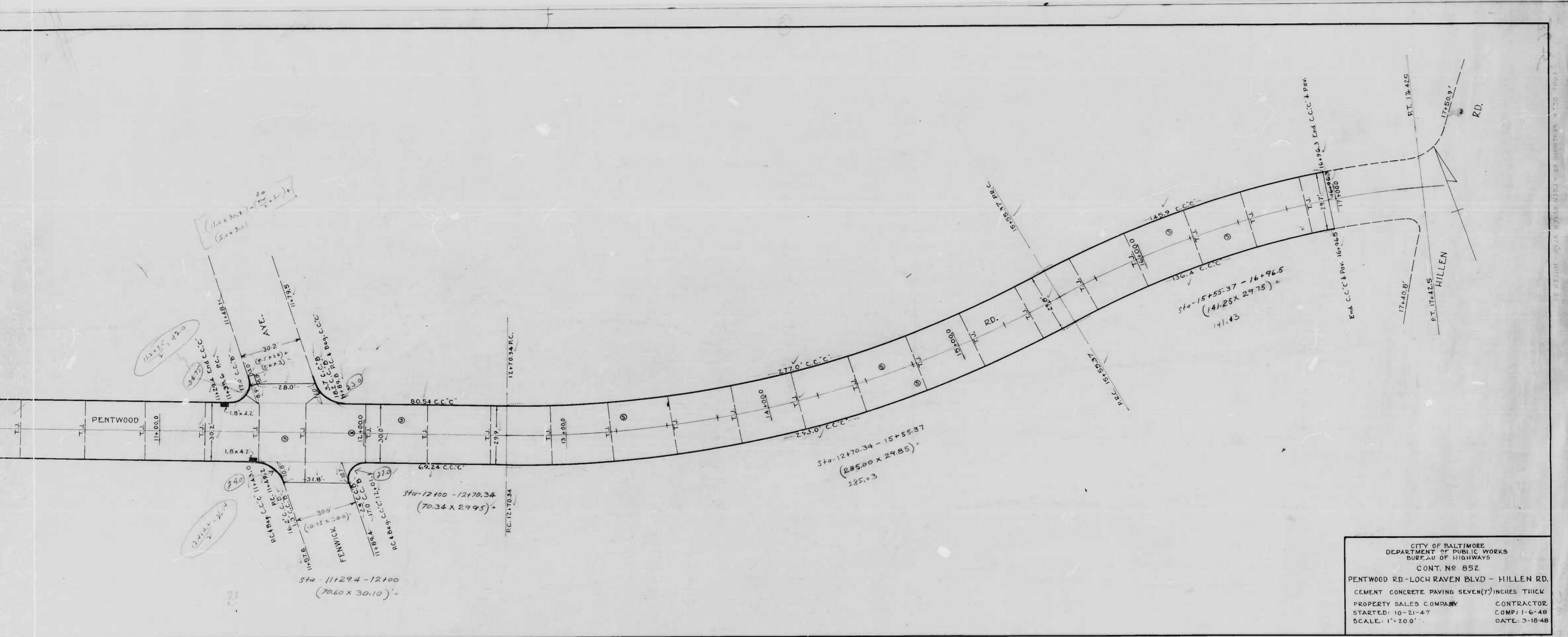

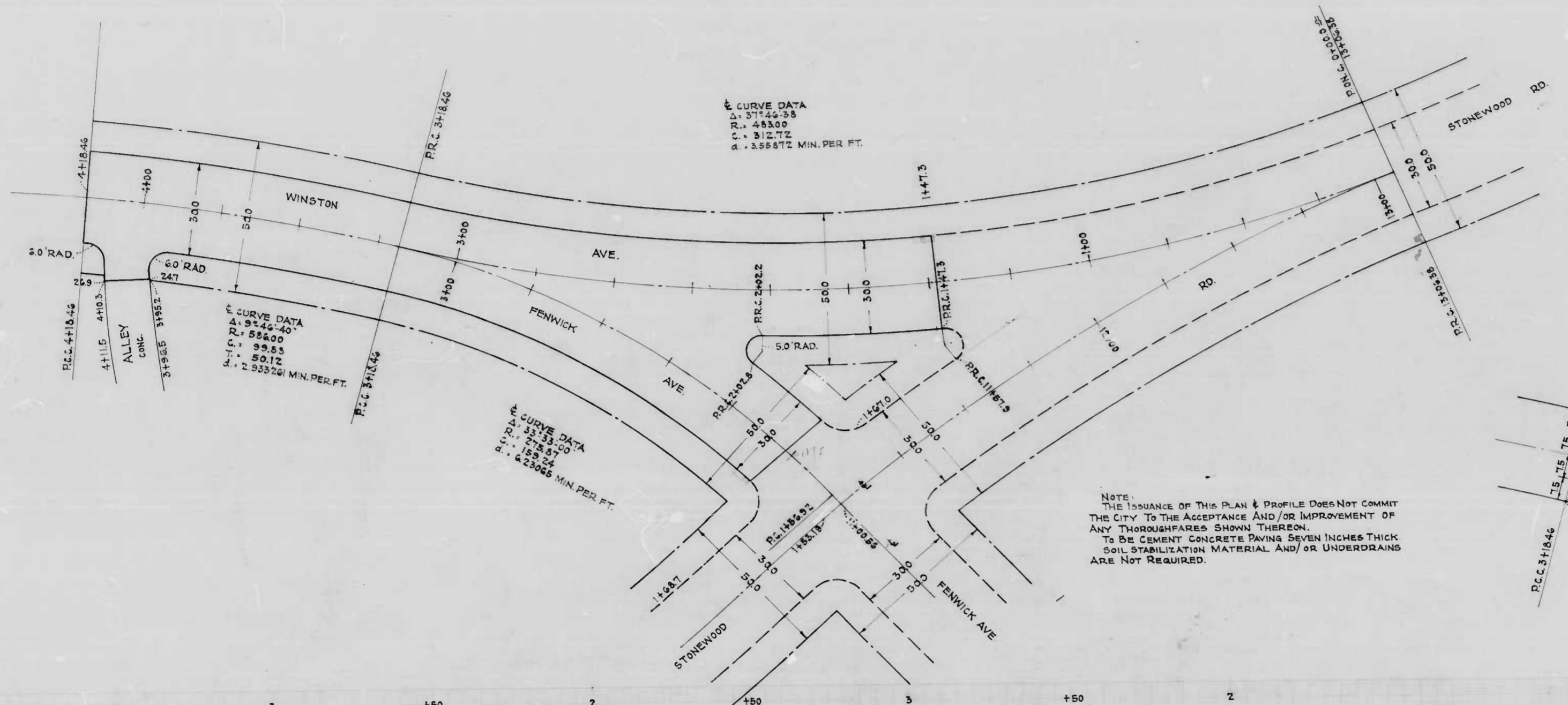

NOTE:
 THE ISSUANCE OF THIS PLAN & PROFILE DOES NOT COMMIT THE CITY TO THE ACCEPTANCE AND/OR IMPROVEMENT OF ANY THOROUGHFARES SHOWN THEREON. TO BE CEMENT CONCRETE PAVING SEVEN INCHES THICK SOIL STABILIZATION MATERIAL AND/OR UNDERDRAINS ARE NOT REQUIRED.

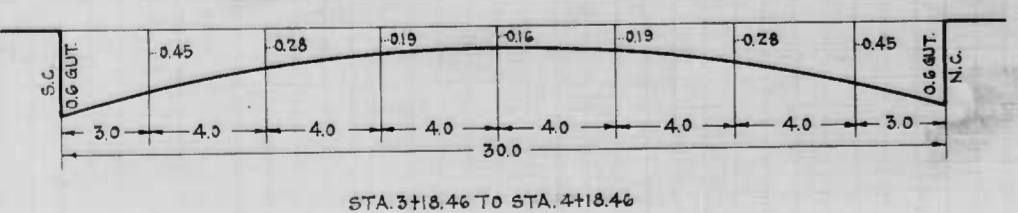
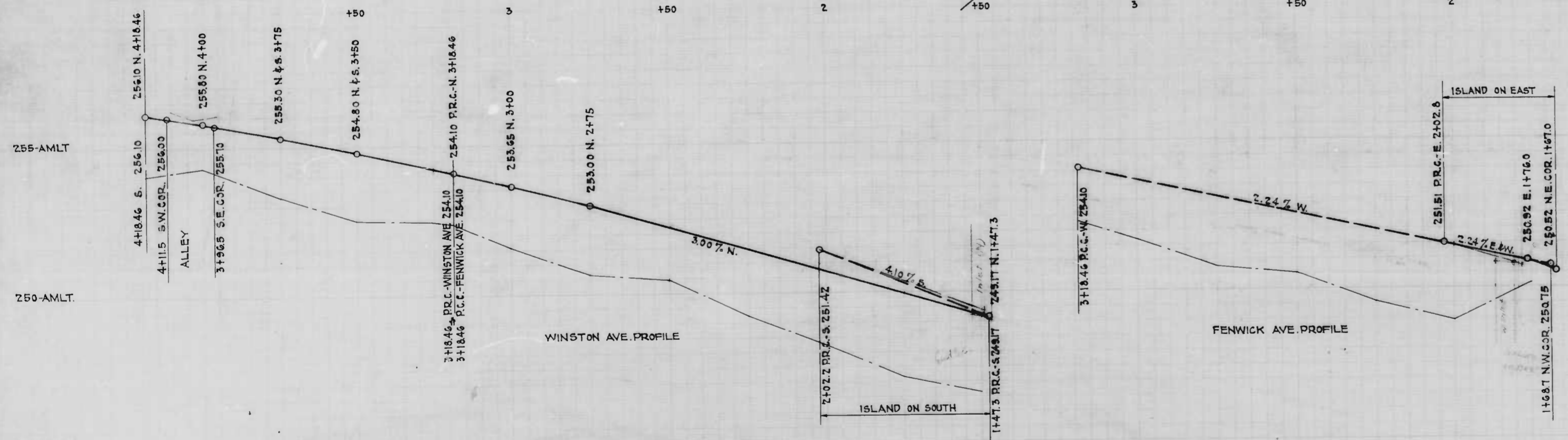
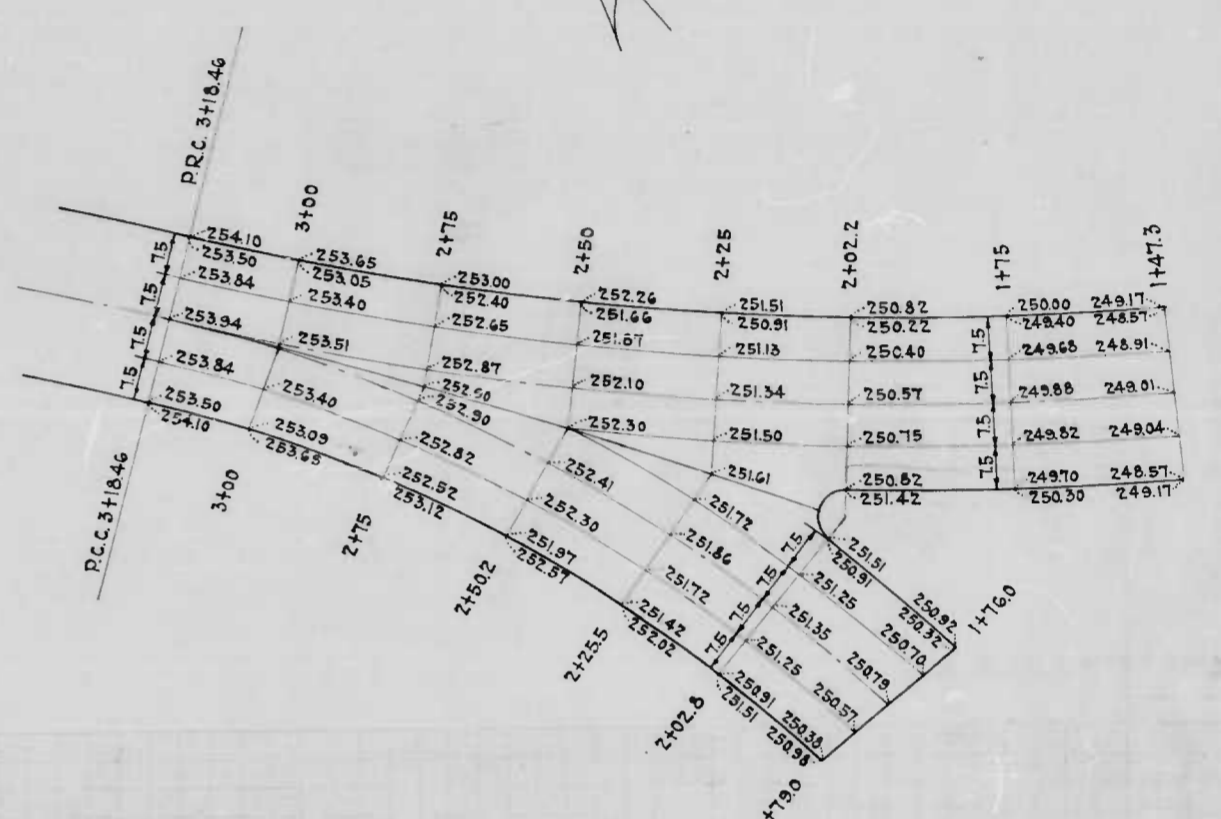

CITY OF BALTIMORE
 DEPARTMENT OF PUBLIC WORKS
 BUREAU OF HIGHWAYS
 PLAN & PROFILE
 WINSTON AVE. - AL. 200' NW. STONEWOOD RD. TO STONEWOOD RD.
 CONT. NO. 552
 SCALE: PLAN - 1" = 20.0' BOOK NO. X-234
 PROFILE - HOR. - 1" = 20.0' JUNE 24, 1947
 VER. - 1" = 2.0'
 APPROVED: *Henry Weisberg* ASSOCIATE ENGINEER
 APPROVED: *Edward J. ...* ENGINEER OF SURVEYS
 APPROVED: *James A. ...* HIGHWAYS ENGINEER
 APPROVED: *...* DIRECTOR OF PUBLIC WORKS

DESIGNED BY: J.J. HAYDEN
 CHECKED BY: S.L. ...