

E CURVE DATA
 Δ = 36° 22' 30"
 T = 356.12
 R = 1021.34
 S = 672.54
 D = 50.50
 R = 1072.54

NOTE:
 TO BE CEMENT CONCRETE PAV. 6" THICK.
 SIX INS. SOIL STABILIZATION MATERIALS
 AND UNDERDRAINS WILL BE REQUIRED.

CITY OF BALTIMORE
 DEPARTMENT OF PUBLIC WORKS
 BUREAU OF HIGHWAYS
 PLAN OF
 HILTON RD. - DORRITHAN RD. TO W. END PROPOSED BRIDGE OVER WMRR
 CONT. N. 849

SCALE - 1" = 20.0'

BOOK N° X-224
 MAY 27, 1941

APPROVED: *Henry Briskman* ASSOCIATE ENGINEER
 APPROVED: *Walter Fisher* HIGHWAYS ENGINEER
 APPROVED: *Edward H. ...* ENGINEER OF SURVEYS
 APPROVED: *...* DIRECTOR OF PUBLIC WORKS

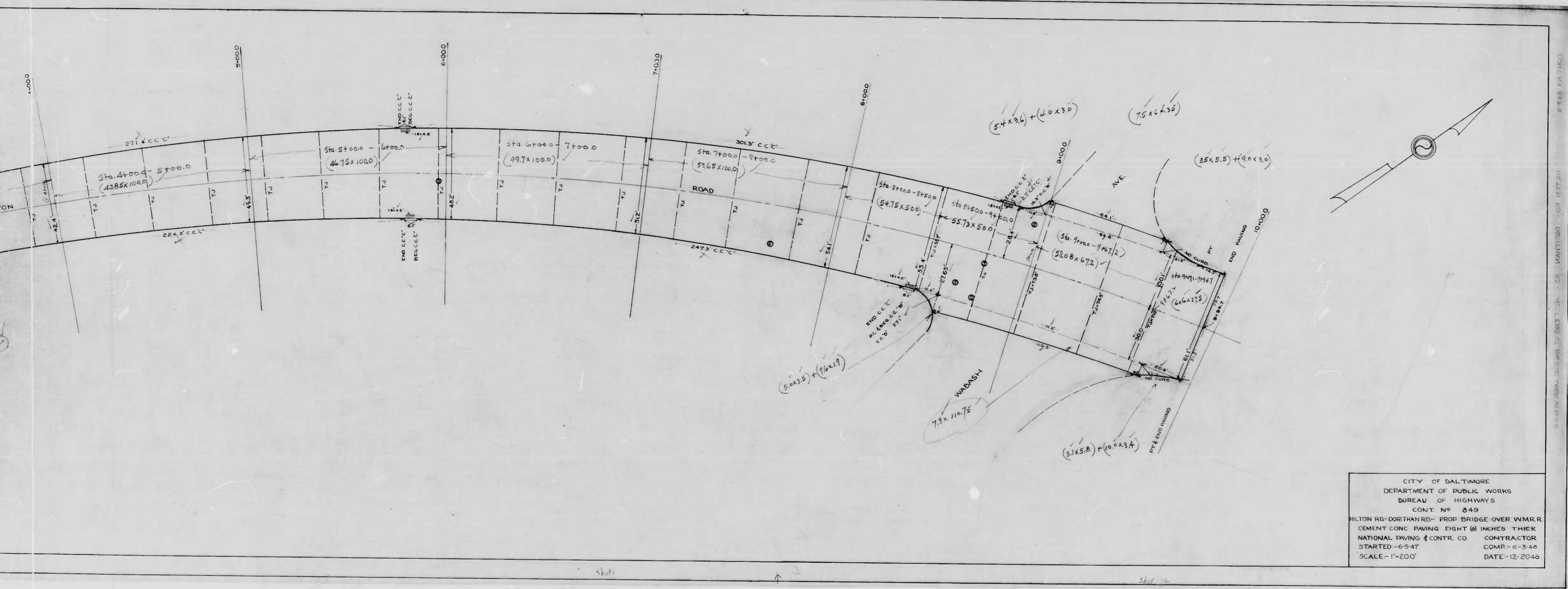

CITY OF BALTIMORE
 DEPARTMENT OF PUBLIC WORKS
 BUREAU OF HIGHWAYS
 CONT. NO. 849
 MILTON RD-DORITMAN RD- PROP BRIDGE OVER WM.R.R.
 CEMENT CONC PAVING EIGHT (8) INCHES THICK
 NATIONAL PAVING & CONTR. CO. CONTRACTOR
 STARTED-6-5-47 COMP.-6-5-48
 SCALE-1"=200' DATE-12-20-46

CONT. NO. 849-A
 MILTON RD-DORITMAN RD- W.M.R.R. BRIDGE OVER WM.R.R.

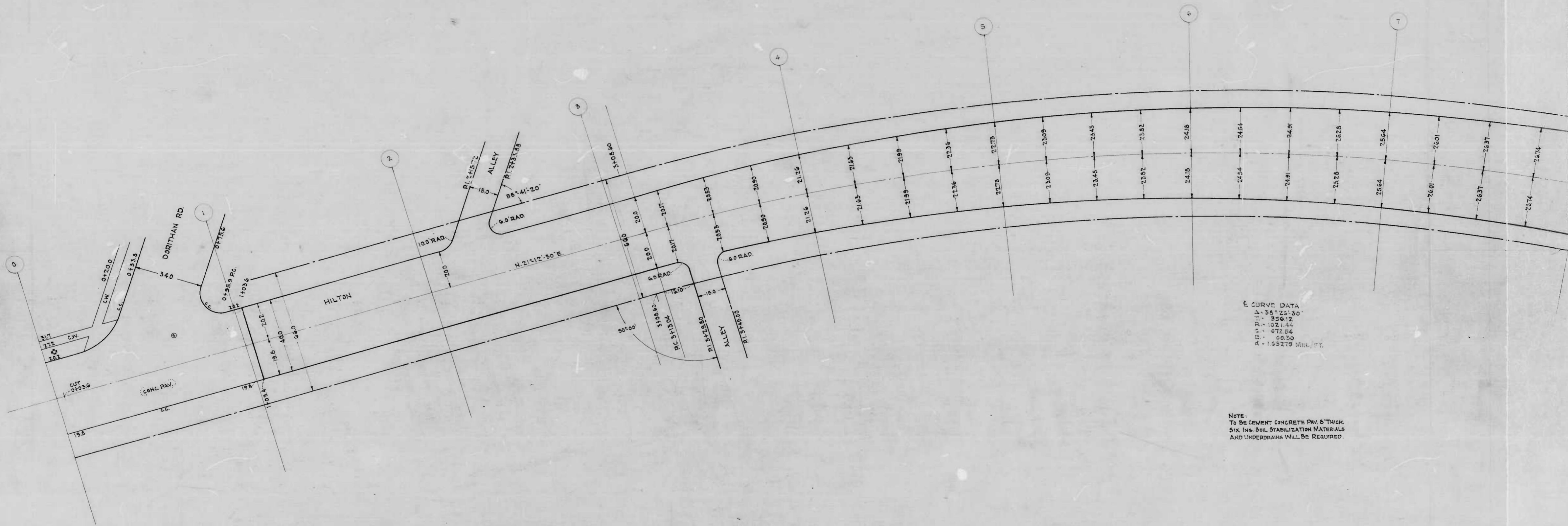

E CURVE DATA
 Δ = 36° 23' 30"
 P.T. = 356.12
 P.C. = 1021.44
 P.T. = 672.54
 R = 50.50
 d = 1.63279 MIN./FT.

NOTE:
 TO BE CEMENT CONCRETE PAV. 6" THICK.
 SIX IN. SOIL STABILIZATION MATERIALS
 AND UNDERDRAINS WILL BE REQUIRED.

J.J. HAYDEN
 S. J. Hayden
 REGISTERED PROFESSIONAL ENGINEER

Sheet

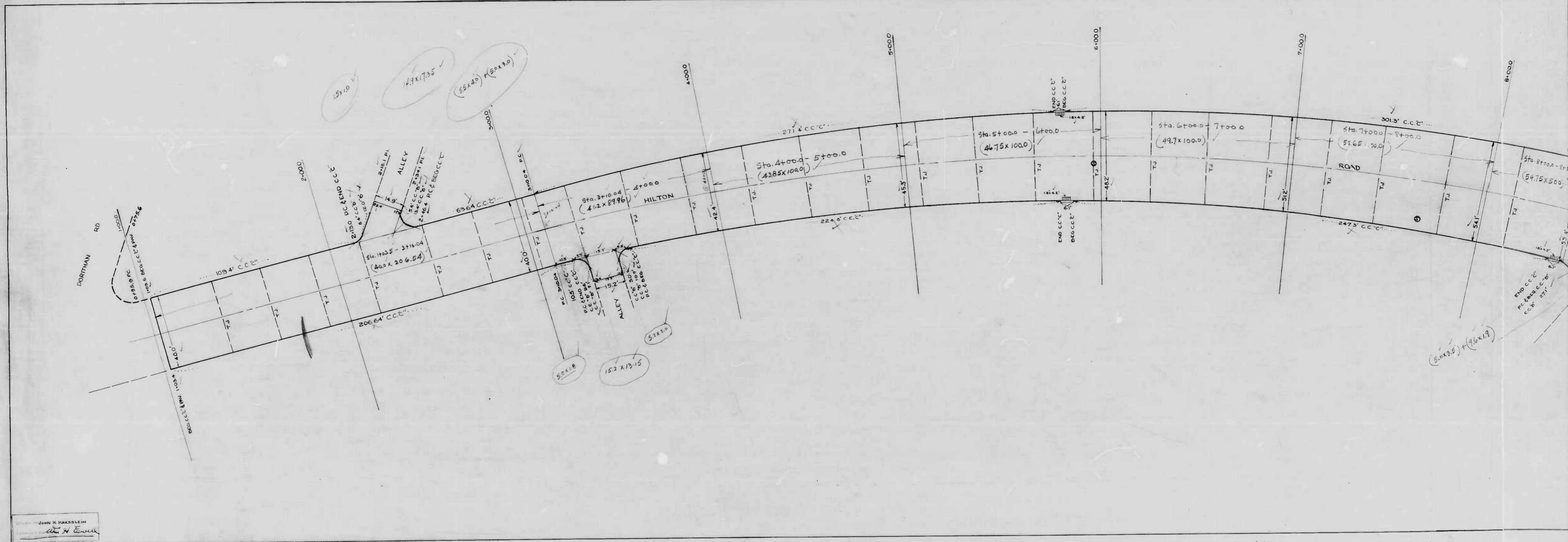

JOHN H. KRESLEIN
Civil Engineer
No. 11

Sheet

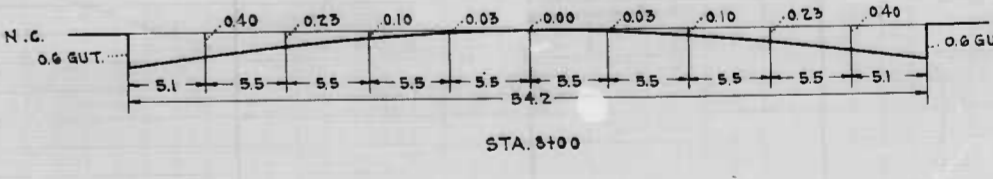
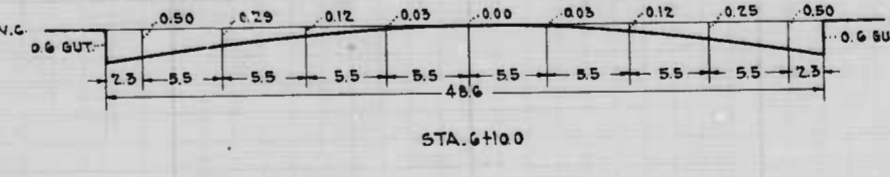
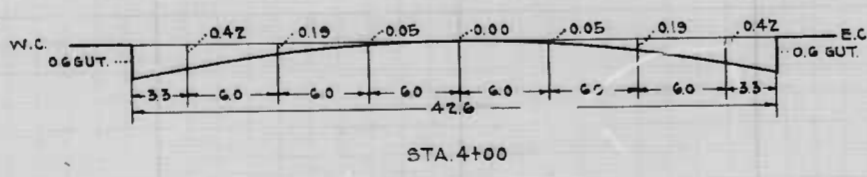
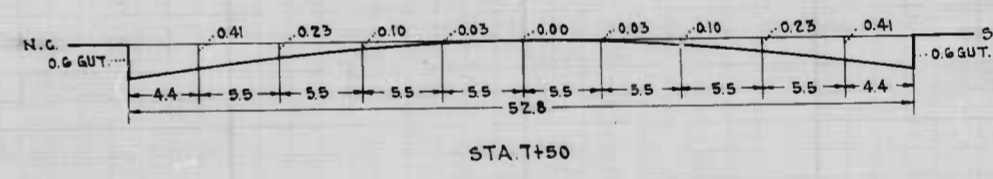
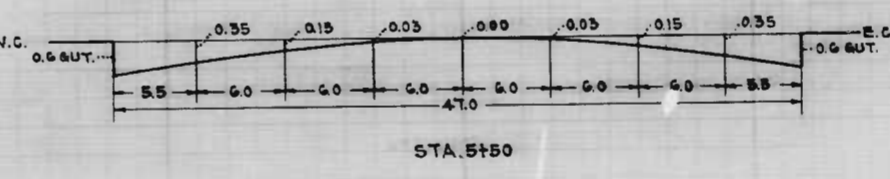
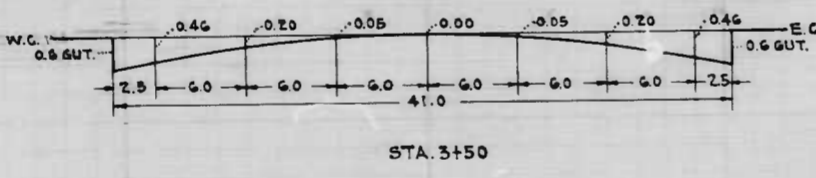
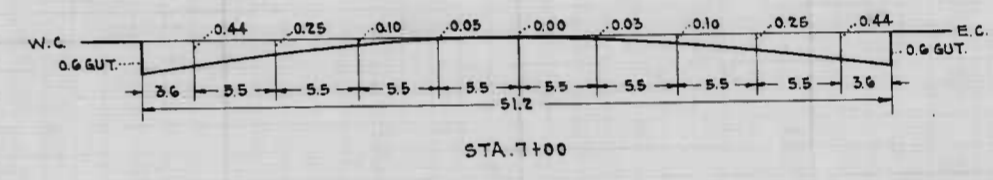
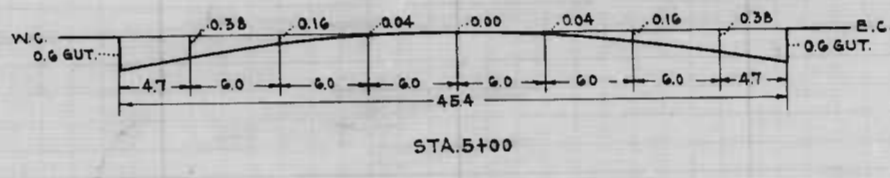
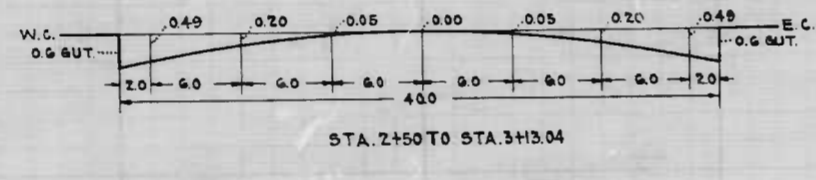
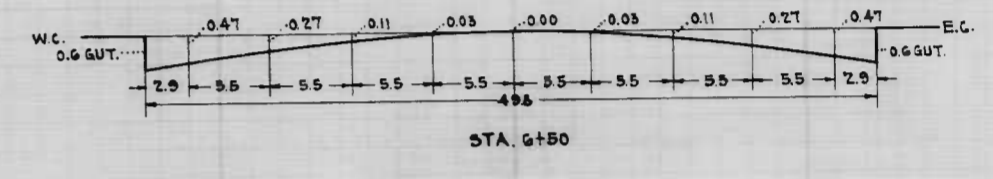
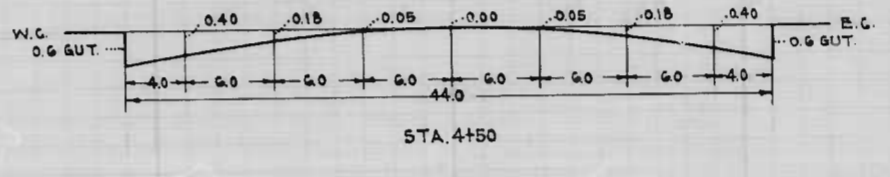
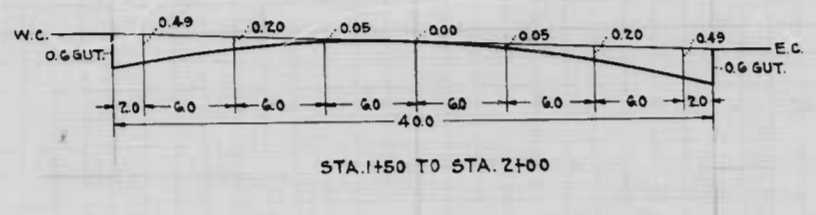
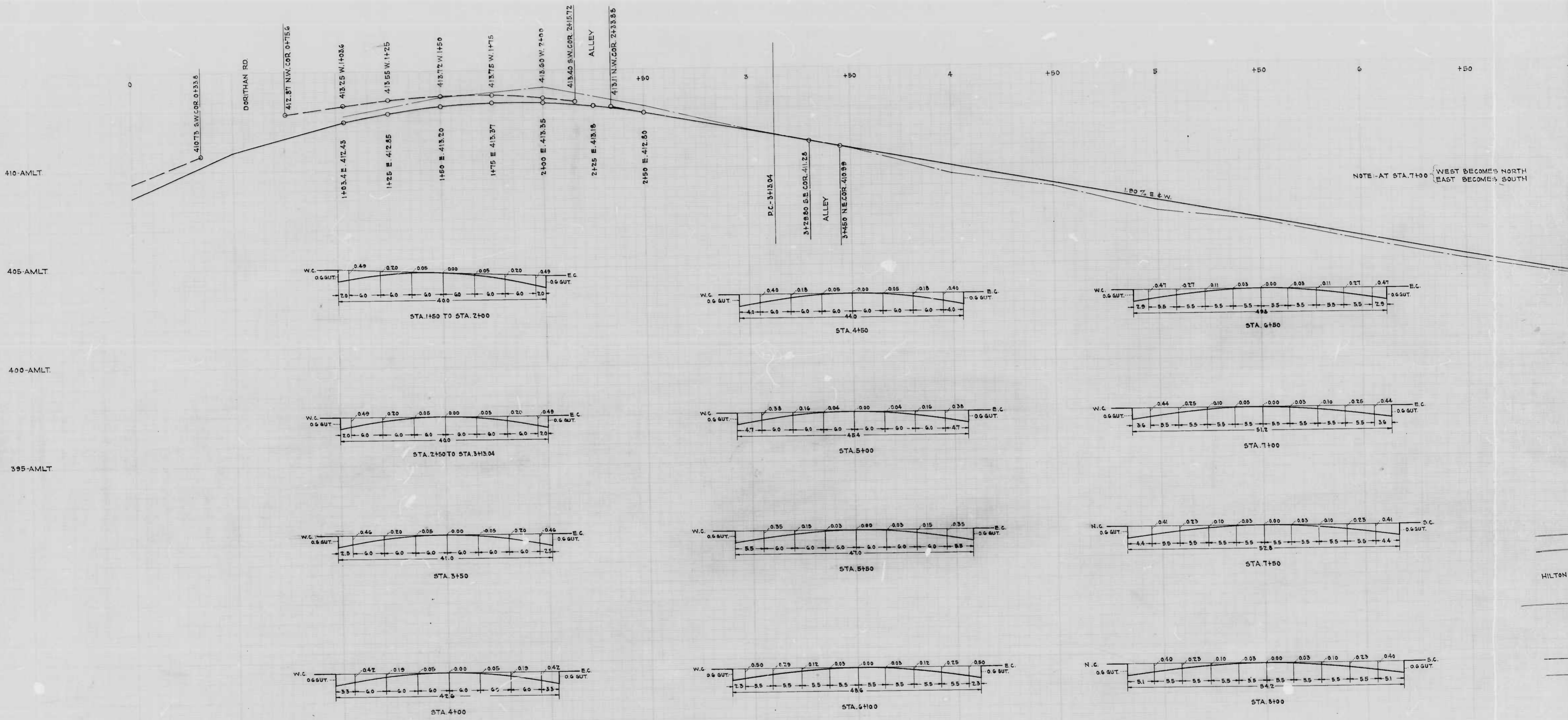

DESIGNED BY J. J. HAYDEN
 CHECKED BY S. L. BURNS
 REVISIONS IN COURSE OF DRAWING

HILTON