

CITY OF BALTIMORE
 DEPARTMENT OF PUBLIC WORKS
 BUREAU OF HIGHWAYS
 CONT. N-847
 NORTH AVE. - BENTALOU ST. TO PAYSON ST.
 5% ASP. PAV. - 1 1/2" WEARING SURFACE - 1 1/2" BINDER ON AN
 EIGHT INCH CONC. BASE - VERT. FIBRE VIT. BR. SUT. LINING
 NATIONAL PAV. & CONT. CO. CONTRACTOR
 STARTED - 6-12-47 CONTRACTOR
 COMP - 10-20-47
 SCALE - 1" = 200' DATE - 3-16-48

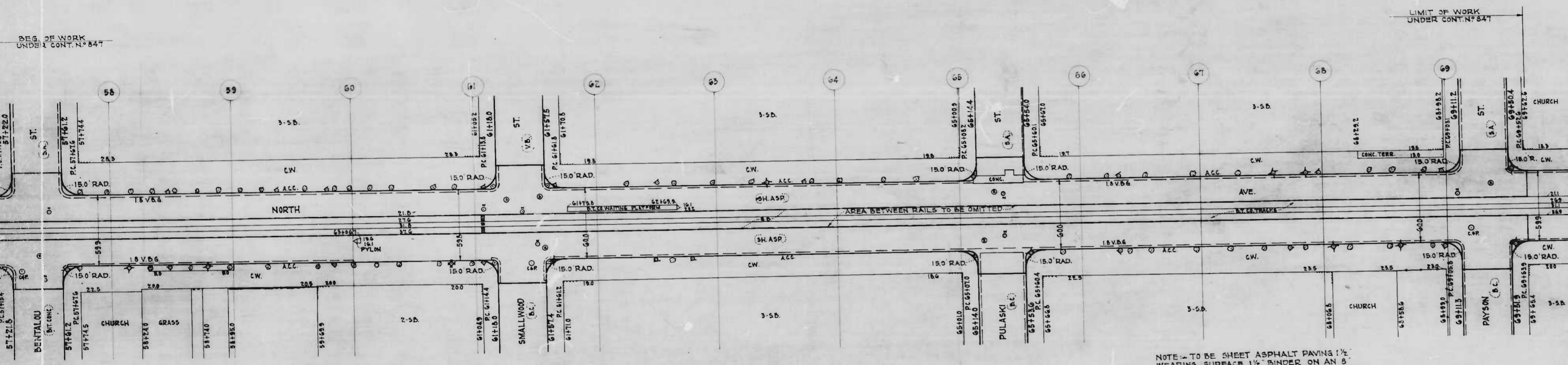

REG. OF WORK UNDER CONT. N. 847

LIMIT OF WORK UNDER CONT. N. 847

NOTE - TO BE SHEET ASPHALT PAVING 1 1/2" WEARING SURFACE 1/4" BINDER ON AN 8" CEMENT CONCRETE BASE. SOIL STABILIZATION MATERIALS AND/OR UNDERDRAINS ARE NOT REQUIRED.



CITY OF BALTIMORE
DEPARTMENT OF PUBLIC WORKS
BUREAU OF HIGHWAYS
PLAN OF
NORTH AVE. - BENTALOU ST. TO PAYSON ST.
CONT. NO. 847

SCALE - 1" = 40.0' BOOK NO. X-180
MAY 2, 1941

APPROVED: *Henry Weisberg* ASSOCIATE ENGINEER
APPROVED: *Edward J. Heston* ENGR. - PLANS & SURVEYS
APPROVED: *W. J. Fisher* HIGHWAYS ENGINEER
APPROVED: *Walter R. Smith* CHIEF ENGINEER

DRAWN BY J. J. HAYDEN
CHECKED BY *Wm. H. [unclear]*

shot 5

58 +50 59 +50 60 +50 61 +50 62 +50 63 +50 64 +50 65 +50

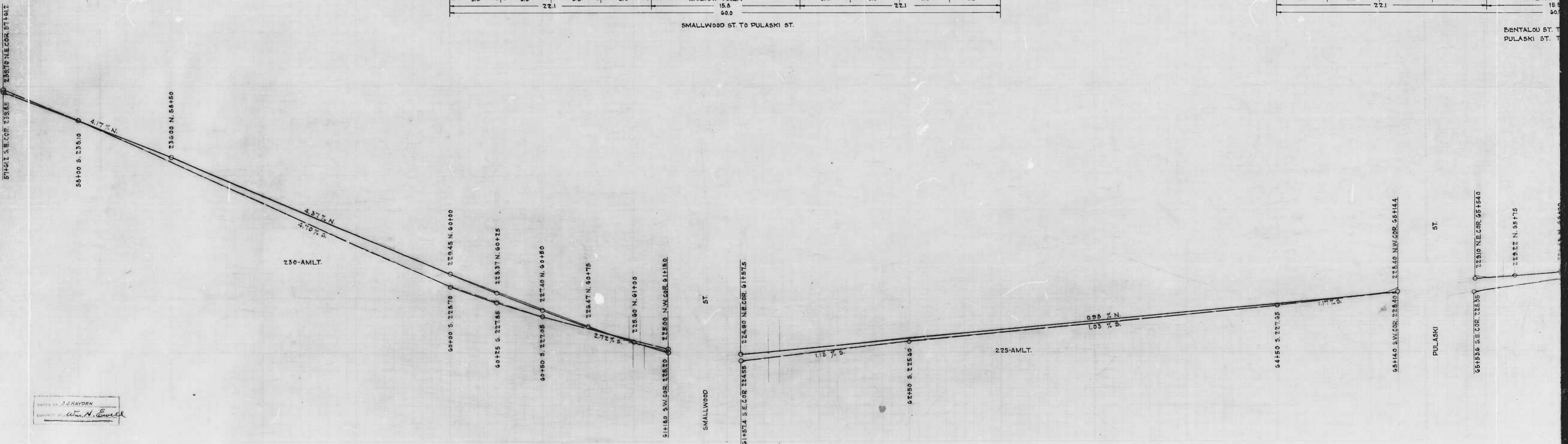
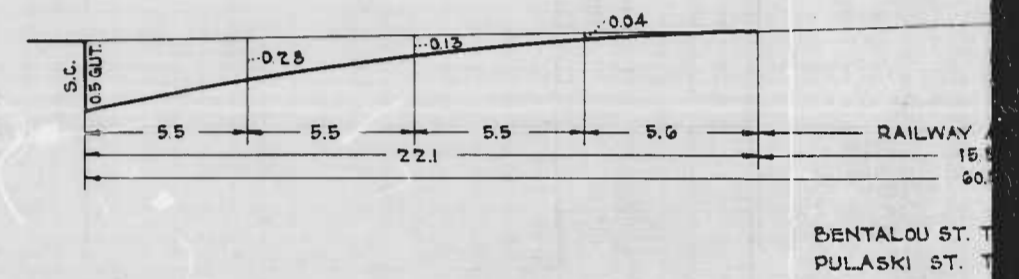
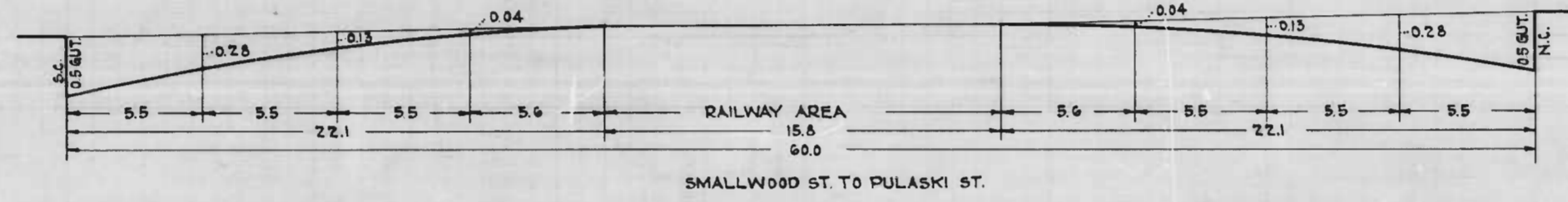

DESIGNED BY J. J. HAYDEN
 DRAWN BY Wm. A. Gull

Sheet 7

64 +50 65 +50 66 +50 67 +50 68 +50 69

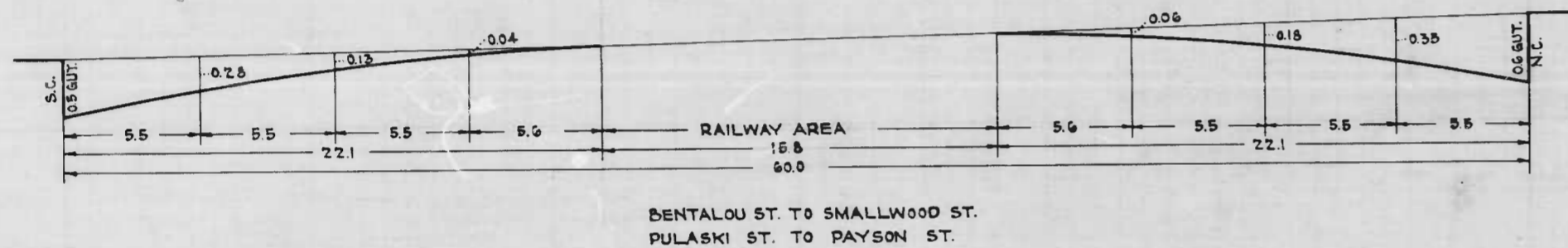

BENTALOU ST. TO SMALLWOOD ST.
PULASKI ST. TO PAYSON ST.

LIMIT OF WORK
UNDER CONT. NO. 847

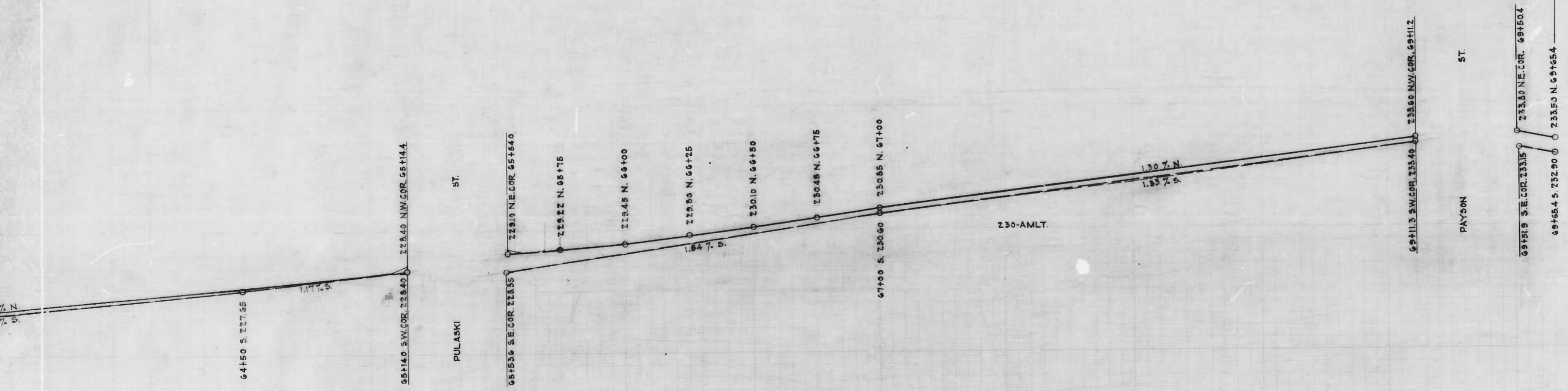

CITY OF BALTIMORE
DEPARTMENT OF PUBLIC WORKS
BUREAU OF HIGHWAYS
ESTABLISHED GRADE OF
NORTH AVE. - BENTALOU ST. TO PAYSON ST.

SCALES - HOR. - 1" = 20.0'
VER. - 1" = 2.0'

APPROVED - *Henry Weisberg*
ASSOCIATE ENGINEER

APPROVED - *W. J. Fisher*
HIGHWAYS ENGINEER

APPROVED - *Edward J. Haderew*
ENGR. - PLANS & SURVEYS

APPROVED - *Walter R. Smith*
CHIEF ENGINEER

BOOK NO. X-150
CONT. NO. 847
MAY 2, 1947

sk. 110

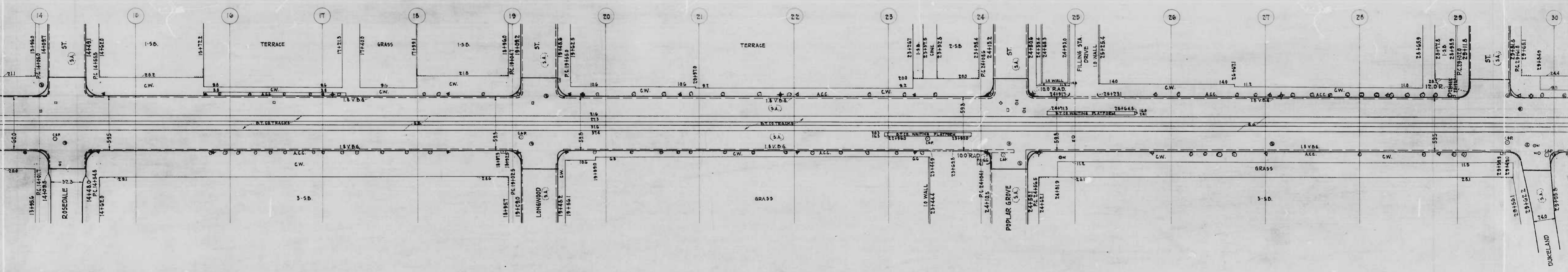

Sheet

847/848

RATIO - 24

2

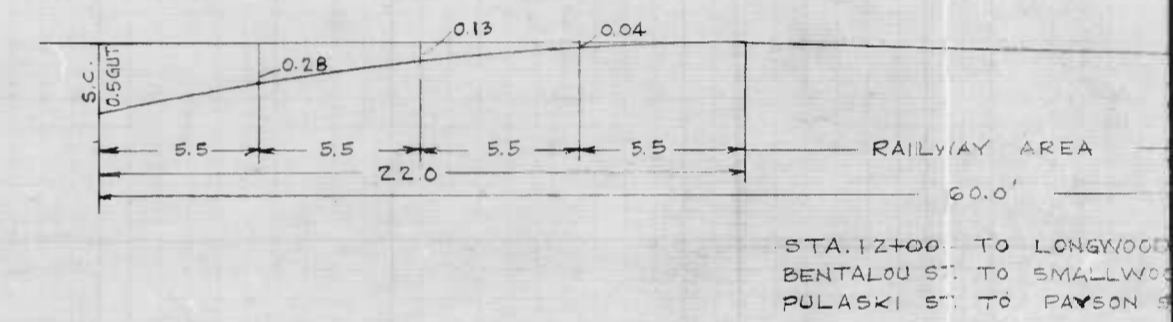
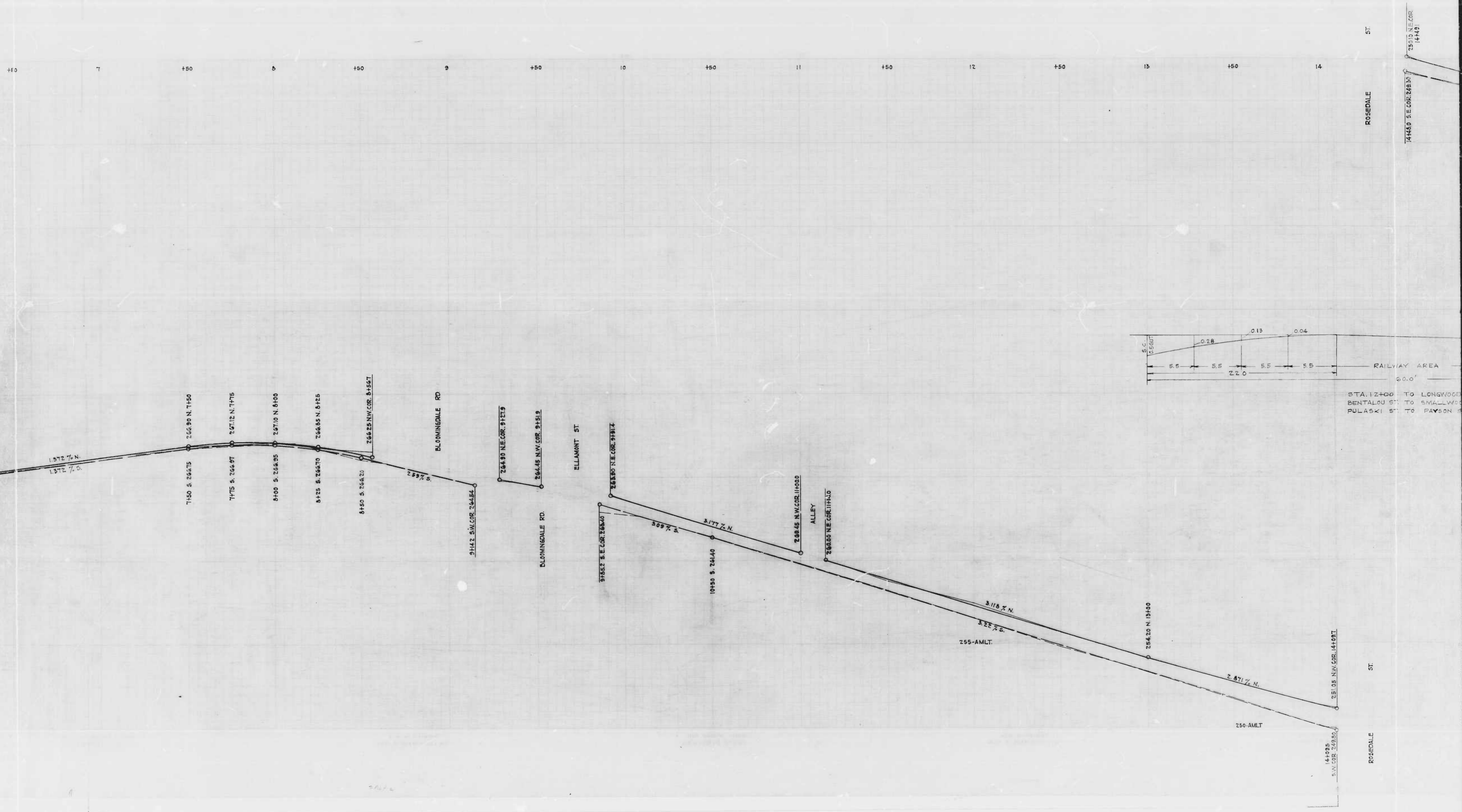

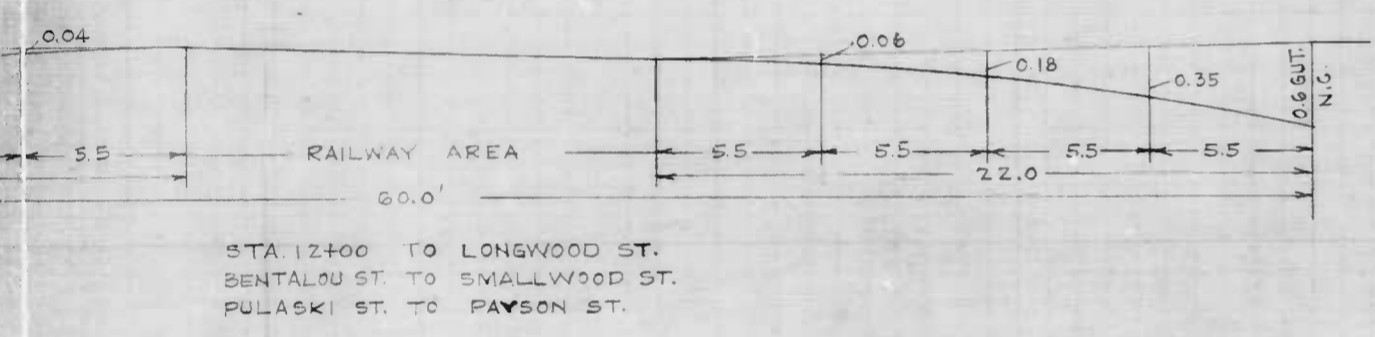
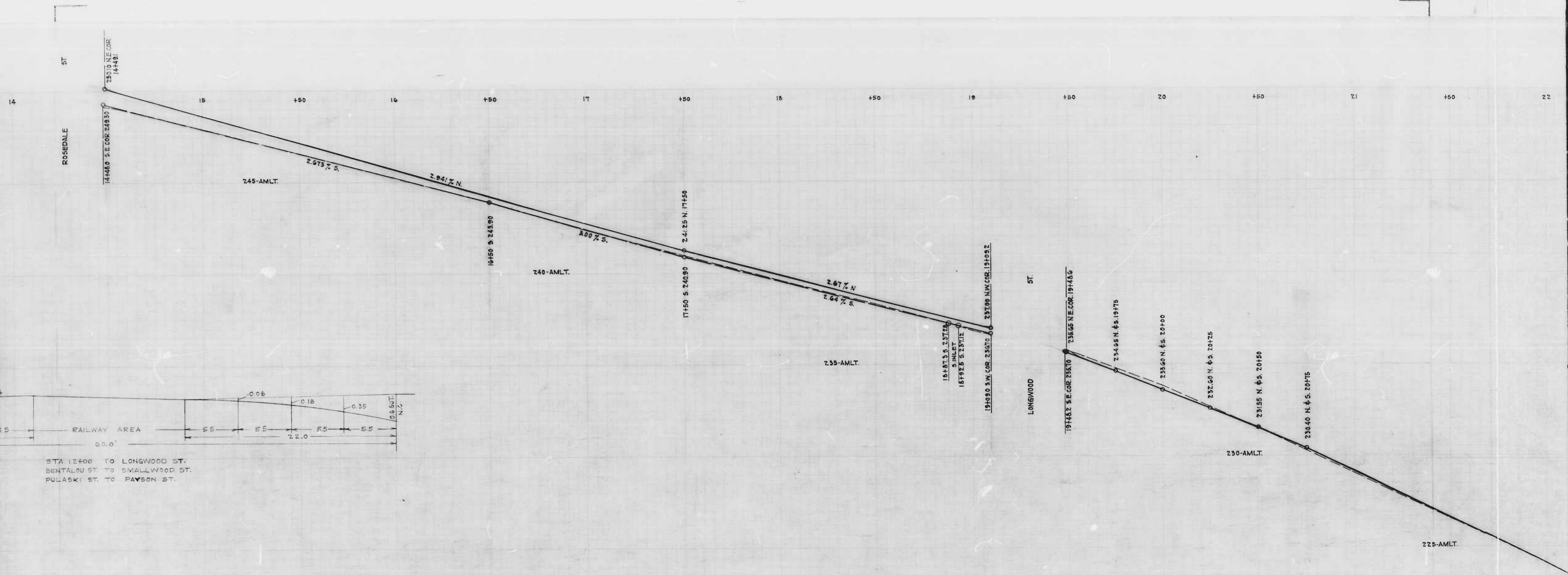

STA 12+00 TO LONGWOOD ST.
 BENTALOU ST TO SMALLWOOD ST.
 PULASKI ST TO PAVSON ST.

14+035
 S.W. COR 24930
 ROSEDA
 ST.

24013

+50 22 +50 23 +50 24 +50 25 +50 26 +50 27 +50 28 +50 29

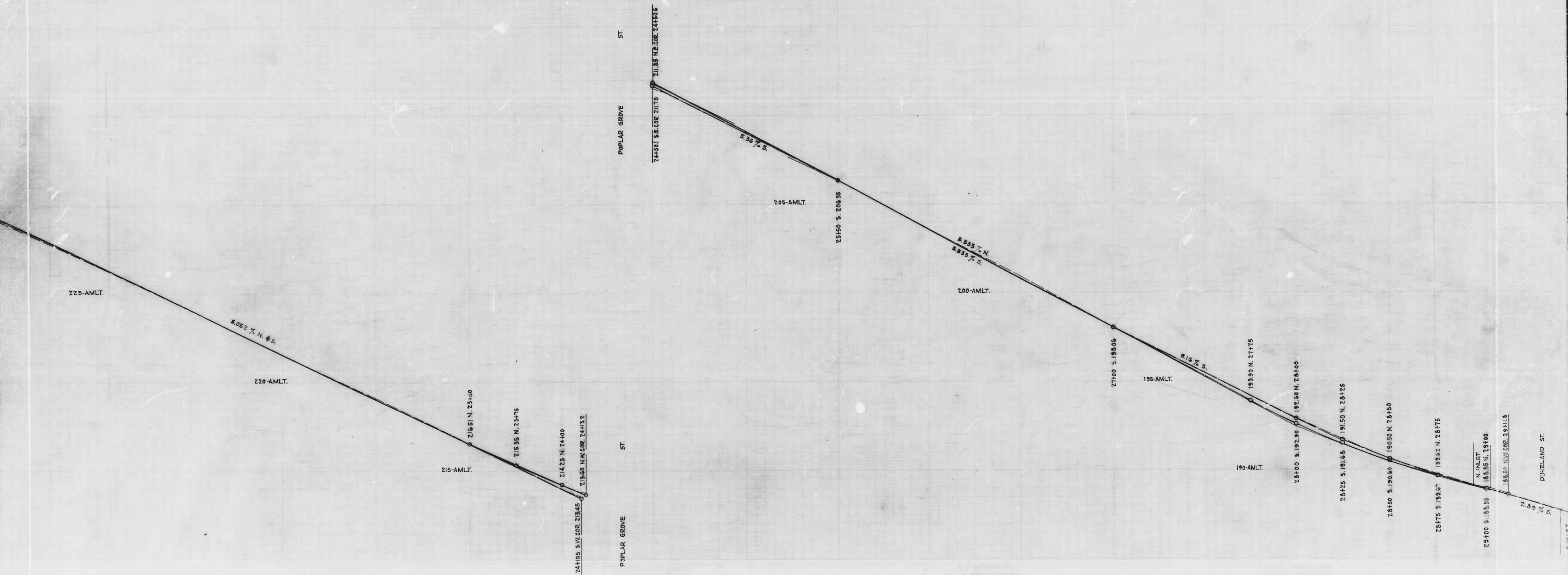

+50 29 +50 30 +50 31 +50 32 +50 33 +50 34 +50 35 +50 36 +50

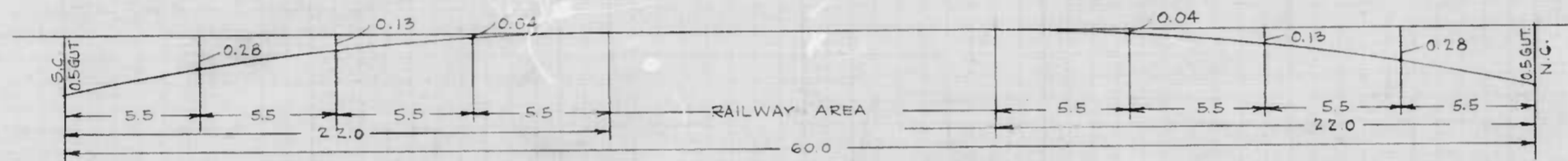

DENISON ST. TO BLOOMINGDALE RD.
 LONGWOOD ST. TO ASHBURTON ST.
 WARWICK AVE. TO BENTALOU ST.

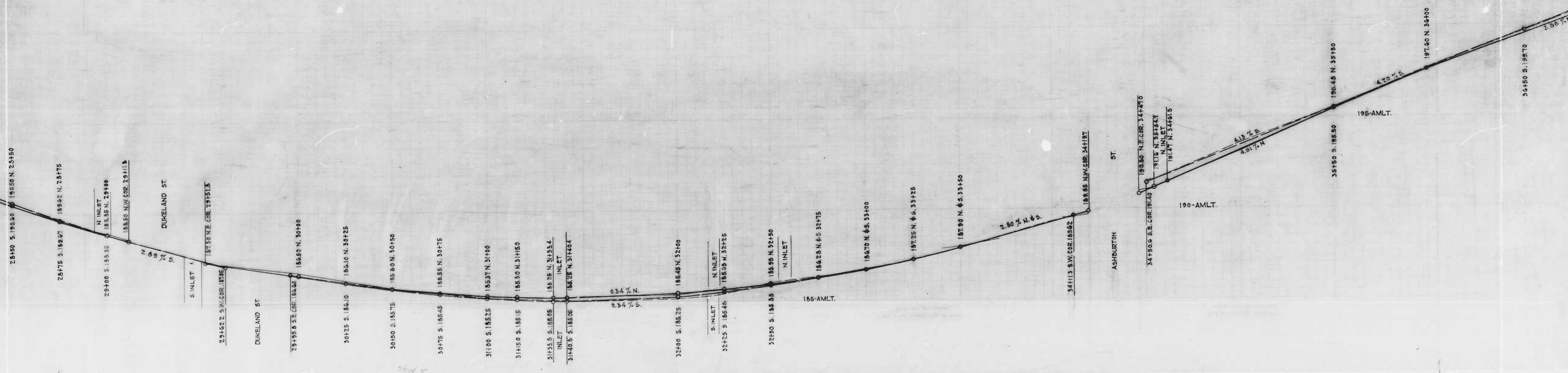
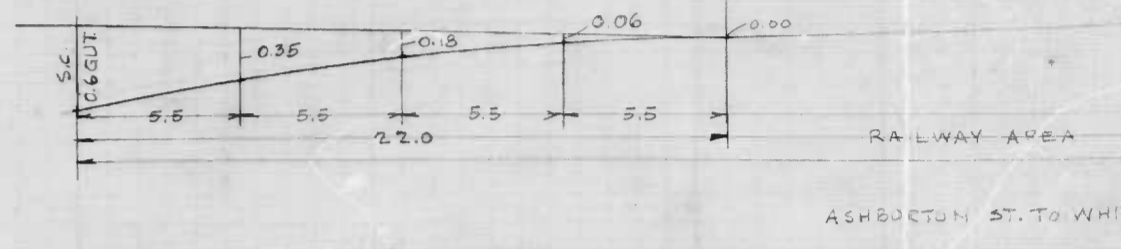

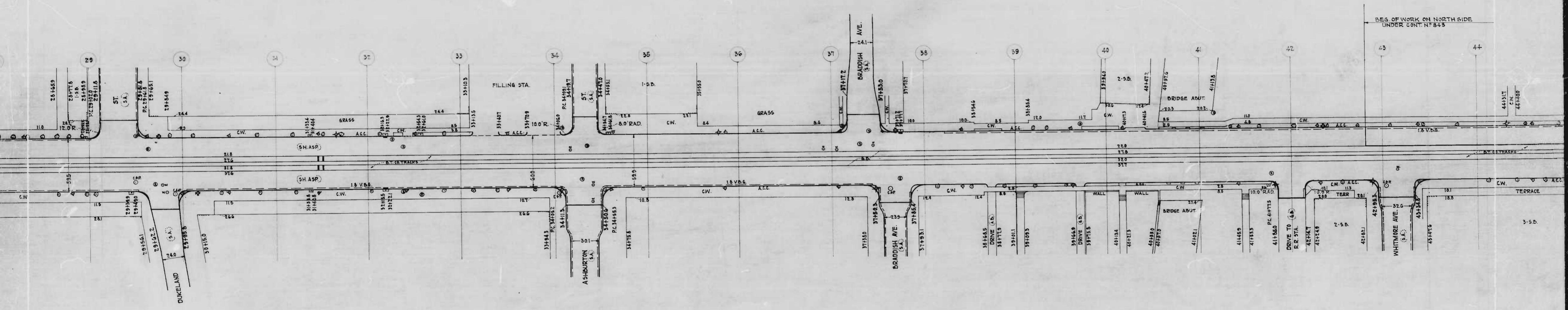

shots

J. J. HAYDEN
 CIVIL ENGINEER

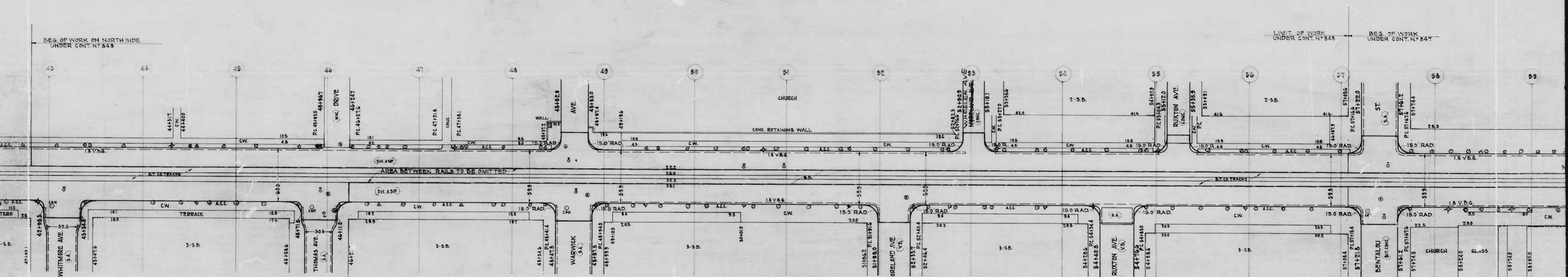

CITY OF BALTIMORE
 DEPARTMENT OF PUBLIC WORKS
 BUREAU OF HIGHWAYS
 PLAN OF
 NORTH AVE - NORTH SIDE - W.B.L. - WHITMORE AVE. TO W.B.L. - BENTALOU ST.
 NORTH AVE - SOUTH SIDE - E.B.L. - THOMAS AVE. TO W.B.L. - BENTALOU ST.
 CONT. N° 848

SCALE: 1" = 400'
 APPROVED: *Henry H. ...* ASSOCIATE ENGINEER
 APPROVED: *Edward S. ...* ENGR. - PL. & SURVEYS

BOOK N° X-180
 MAY 2, 1947
 APPROVED: *Arthur P. ...* HIGHWAYS ENGINEER
 APPROVED: *Arthur P. ...* CHIEF ENGINEER

J. J. HAYDEN
John H. ...

J. J. HAYDEN
John H. ...

shot 4

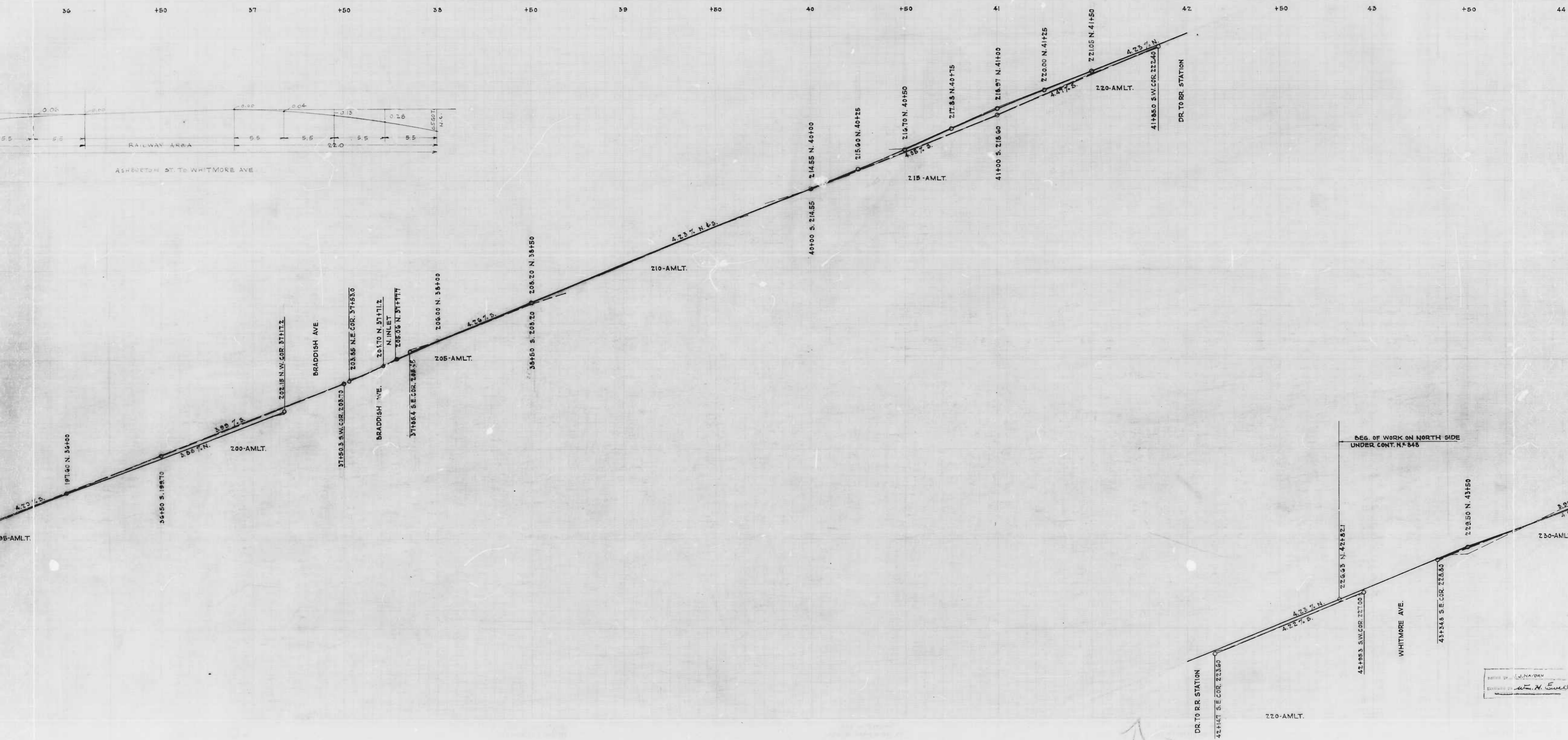

DESIGNED BY J. H. HANCOCK
 DRAWN BY W. H. SWEET

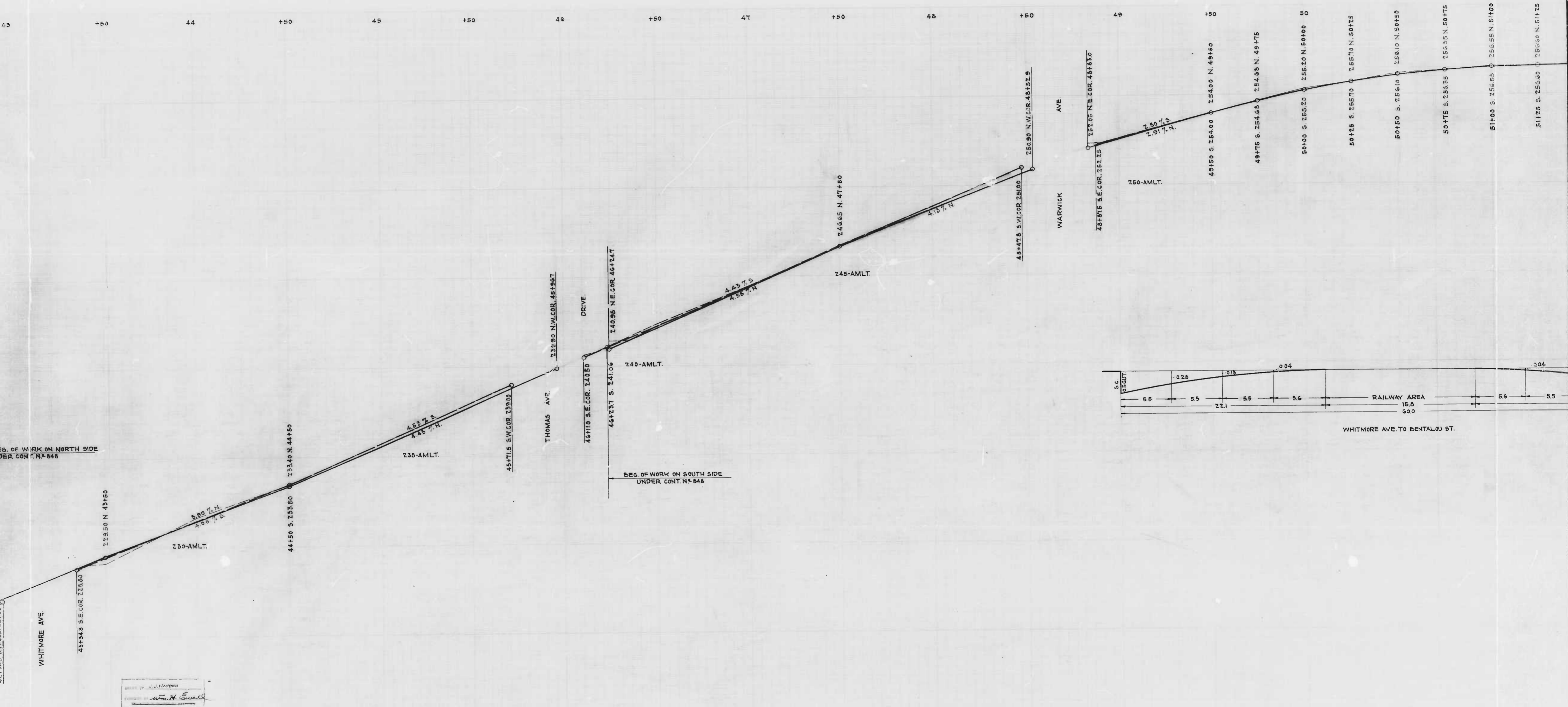

1/2 IN. OF WORK ON NORTH SIDE UNDER CONT. N° 848

DESIGNED BY J. J. HAYDEN
DRAWN BY W. H. SWELL

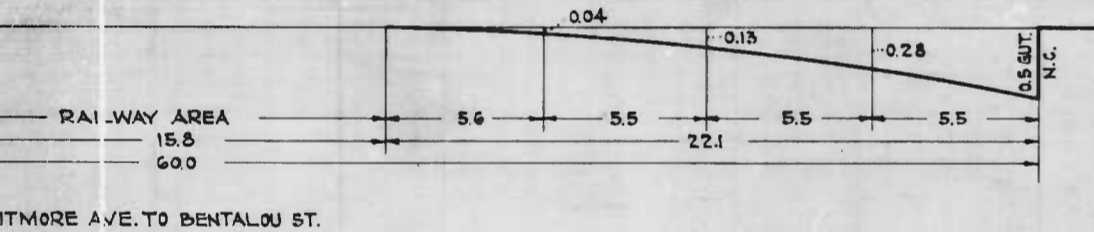
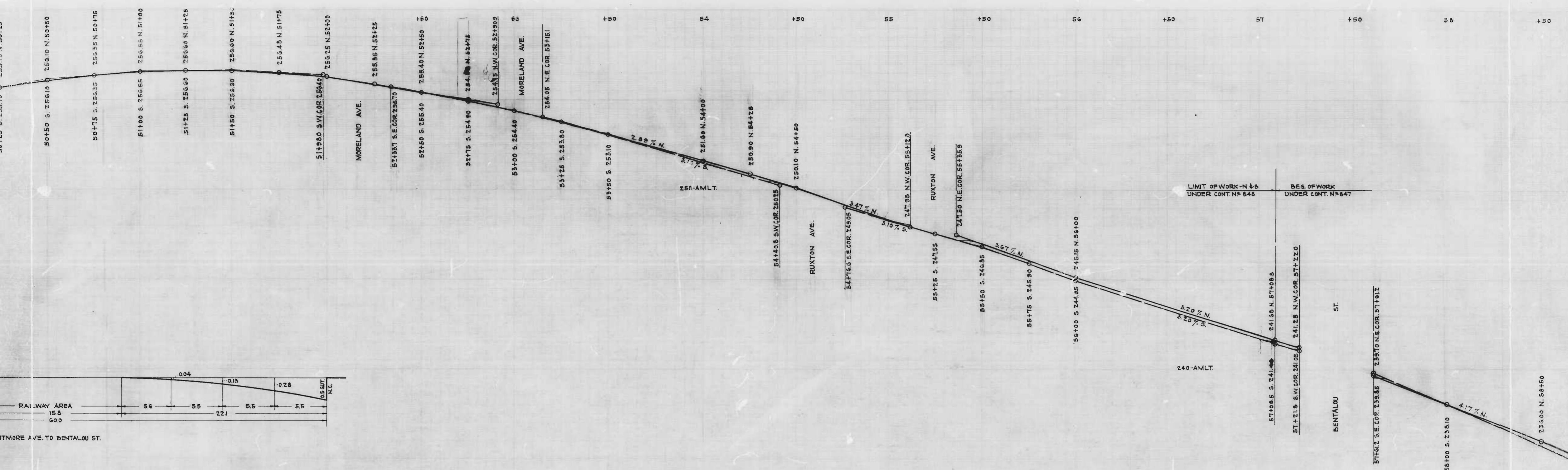

CITY OF BALTIMORE
 DEPARTMENT OF PUBLIC WORKS
 BUREAU OF HIGHWAYS
 PROFILE OF
 NORTH AVE. - NORTH SIDE - W.B.L. - WHITMORE AVE. TO W.B.L. - BENTALOU ST.
 NORTH AVE. - SOUTH SIDE - E.B.L. - THOMAS AVE. TO W.B.L. - BENTALOU ST.
 CONT. N^o 848
 SCALE - HOR. - 1" = 200'
 VER. - 1" = 20'
 APPROVED - *Henry Weisberg* ASSOCIATE ENGINEER
 APPROVED - *Edward H. ...* ENGR. - PLANS & SURVEYS
 APPROVED - *W. H. ...* HIGHWAYS ENGINEER
 APPROVED - *John R. ...* CHIEF ENGINEER
 BOOK N^o X-150
 MAY 2, 1947

DESIGNED BY J. J. HAYDEN
 CHECKED BY *Wm. H. ...*

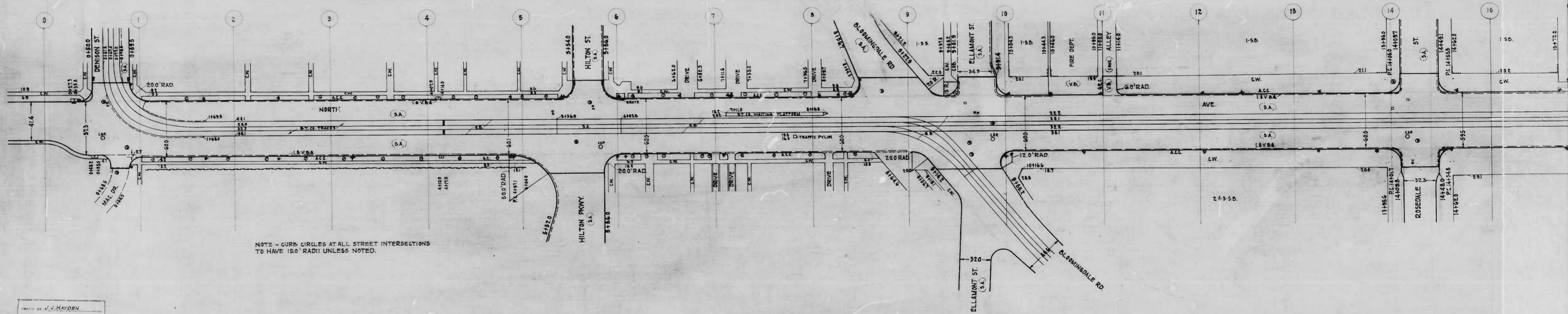

NOTE - CURB CIRCLES AT ALL STREET INTERSECTIONS TO HAVE 150' RADII UNLESS NOTED.

DESIGNED BY J.J. HAYDEN
DRAWN BY Wm. H. ...

5101

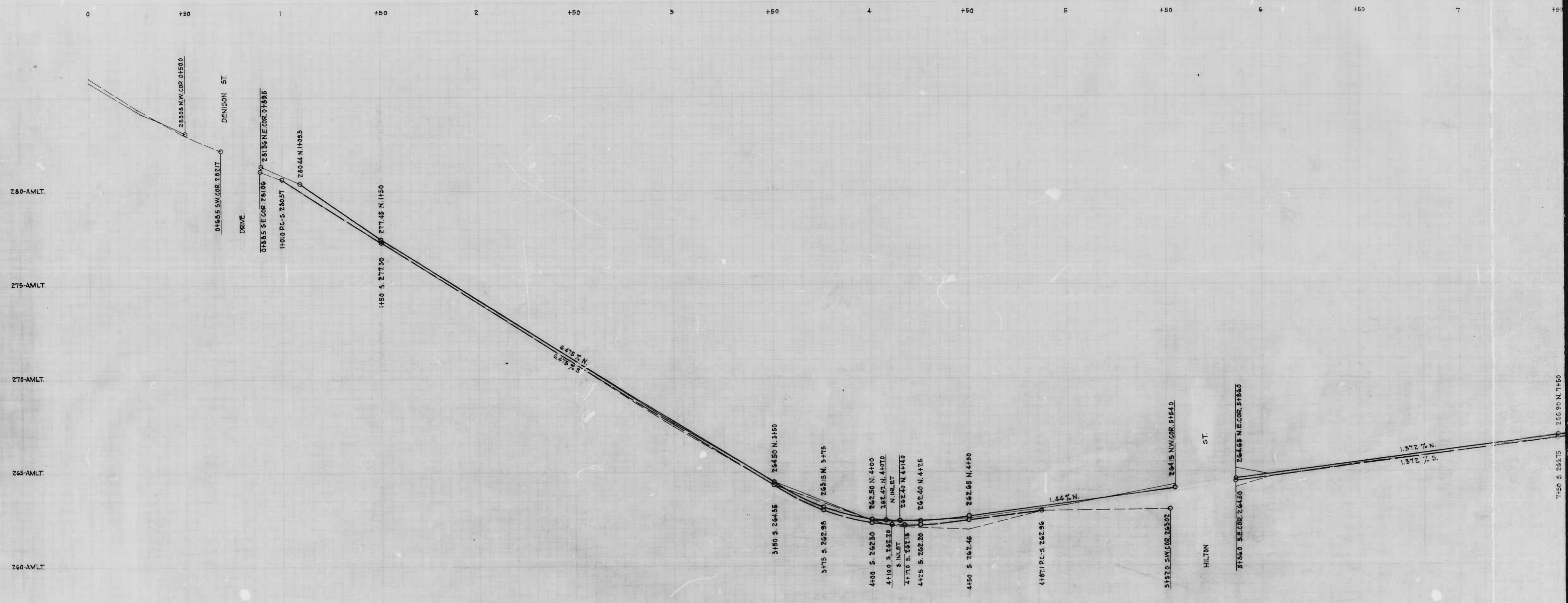

DESIGNED BY J. J. HAYDEN
 DRAWN BY *H. E. SWELL*

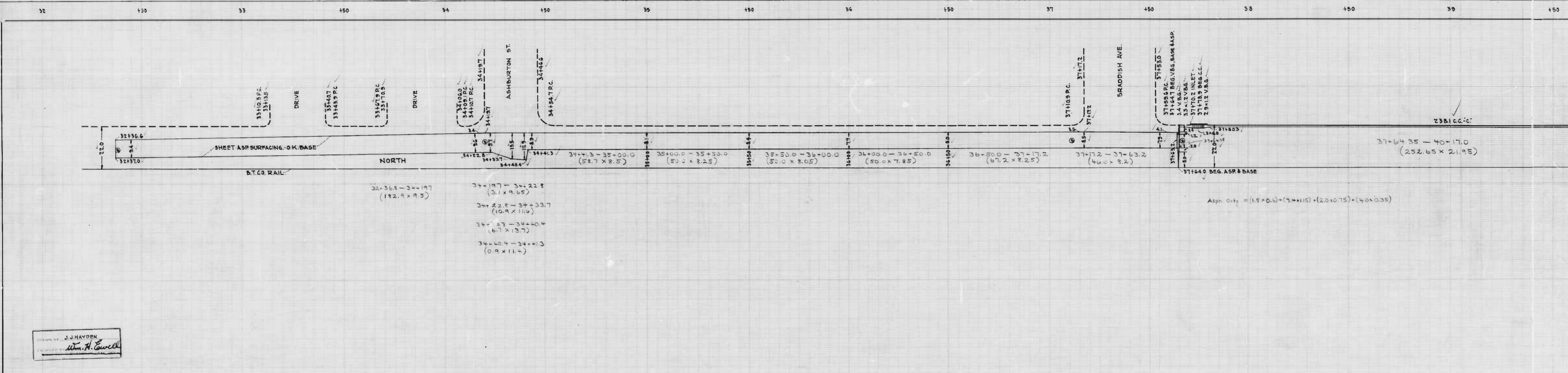

DRAWN BY J. J. HAYDEN
 CHECKED Wm. H. Lowell

Asph Only = (1.5 x 0.6) + (7 x 115) + (2.0 x 0.75) + (4 x 0.35)

2581 cc. cc.
 37+64.35 - 40+17.0
 (252.65 x 21.95)

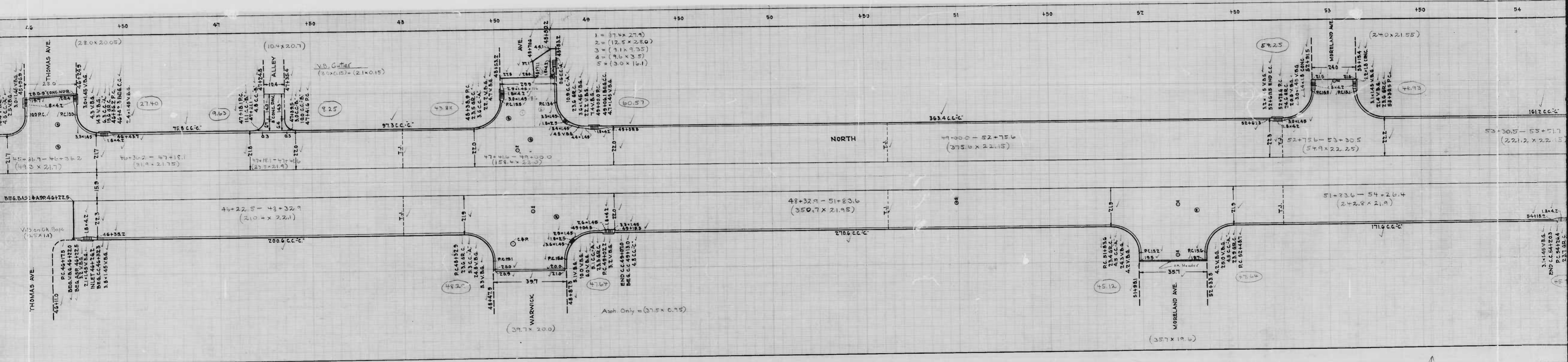

Shot 3

WARWICK
(39.7 x 20.0)

Asph. Only = (27.5 x 0.95)

MORELAND AVE.
(35.7 x 19.6)

NORTH

47+00.0 - 52+75.6
(375.6 x 22.15)

51+23.6 - 54+26.4
(2+2.8 x 21.9)

52+75.6 - 53+30.5
(54.9 x 22.25)

53+30.5 - 55+51.7
(221.2 x 22.15)

THOMAS AVE
(28.0 x 20.05)

ALLEY
(10.4 x 20.7)

V.B. Gutter
(2.0x0.15) + (2.1x0.15)

1	37.7 x 27.4
2	12.5 x 28.0
3	3.1 x 3.5
4	3.6 x 3.5
5	3.0 x 16.1

MORELAND AVE
(24.0 x 21.55)

1612 C.C.C.

THOMAS AVE
48+11.0

46+22.5 - 48+32.9
(21.0 x 22.1)

48+32.9 - 51+80.6
(350.7 x 21.95)

200.0 C.C.C.

270.0 C.C.C.

171.0 C.C.C.

1.8 x 4.2
54118.7

31.1 x 15.0 V.B.G.
END C.C. 54120.3
P.C. 54124.4
23.1 C.C.

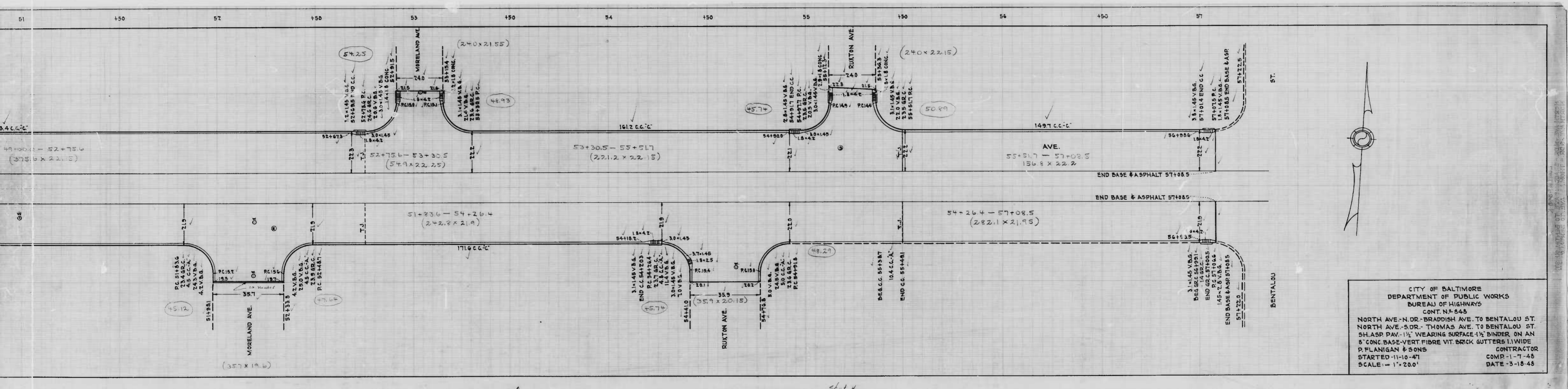

CITY OF BALTIMORE
 DEPARTMENT OF PUBLIC WORKS
 BUREAU OF HIGHWAYS
 CONT. N° 848
 NORTH AVE - N. OR - BRADISH AVE. TO BENTALOU ST.
 NORTH AVE - S. OR - THOMAS AVE. TO BENTALOU ST.
 5H.ASP.PAV.-1 1/2 WEARING SURFACE 1 1/2 BINDER ON AN
 8" CONG.BASE-VERT.FIBRE VIT.BRICK GUTTERS 1 1/2 WIDE
 P.FLANIGAN & SONS CONTRACTOR
 STARTED - 11-10-47 COMP - 1-7-48
 SCALE - 1" = 20.0' DATE - 3-10-48