

E CURVE DATA  
 R = 947.33'    C = 284.59'  
 L = 235.63'    Δ = 17°16'36"  
 d = 108.8675" per ft.

NOTE :-  
 To be Cement Concrete Paving eight (8) thick.  
 Six inch Soil Stabilization Material and Underdrains  
 are required.

DRAWN BY: NHE-SRW  
 CHECKED BY: J.R. G...  
 APPROVED BY: ...

ECHODALE AVE. - 400± E.  
 APPROVED &  
*Harold ...*  
 ASSOCIATE ENGINEER  
 APPROVED &  
*Ernest ...*  
 ENGR. PLANS & SURVEYS

Sheet

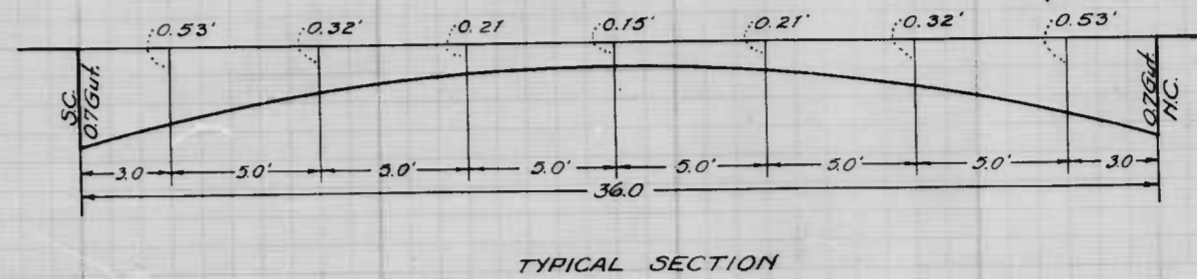
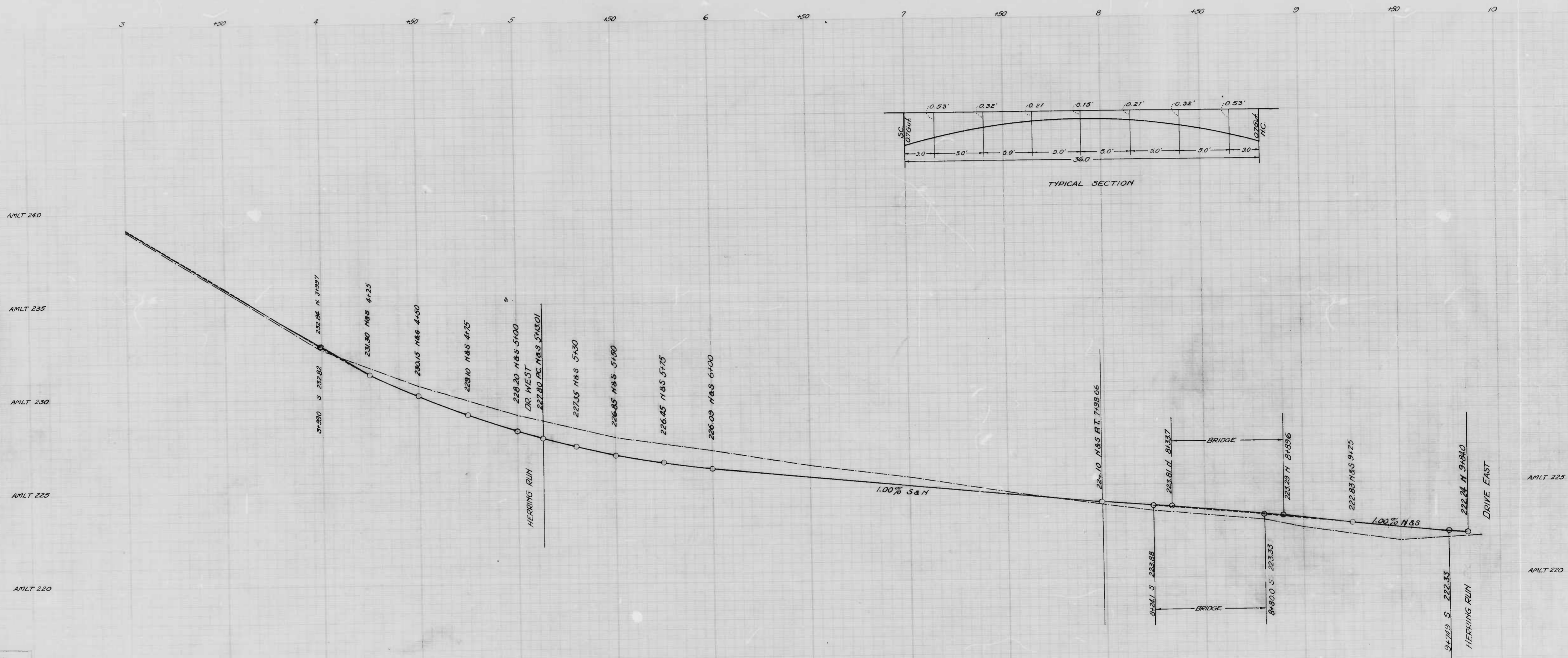

DESIGNED BY S.M. HOLLAND  
 DRAWN BY S.L. BROWN



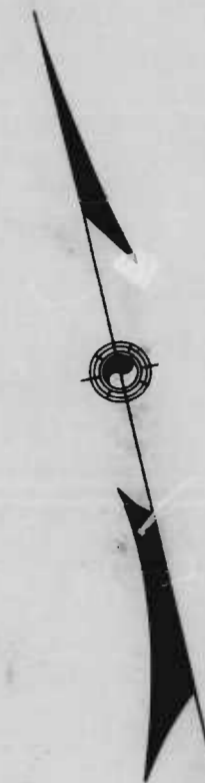
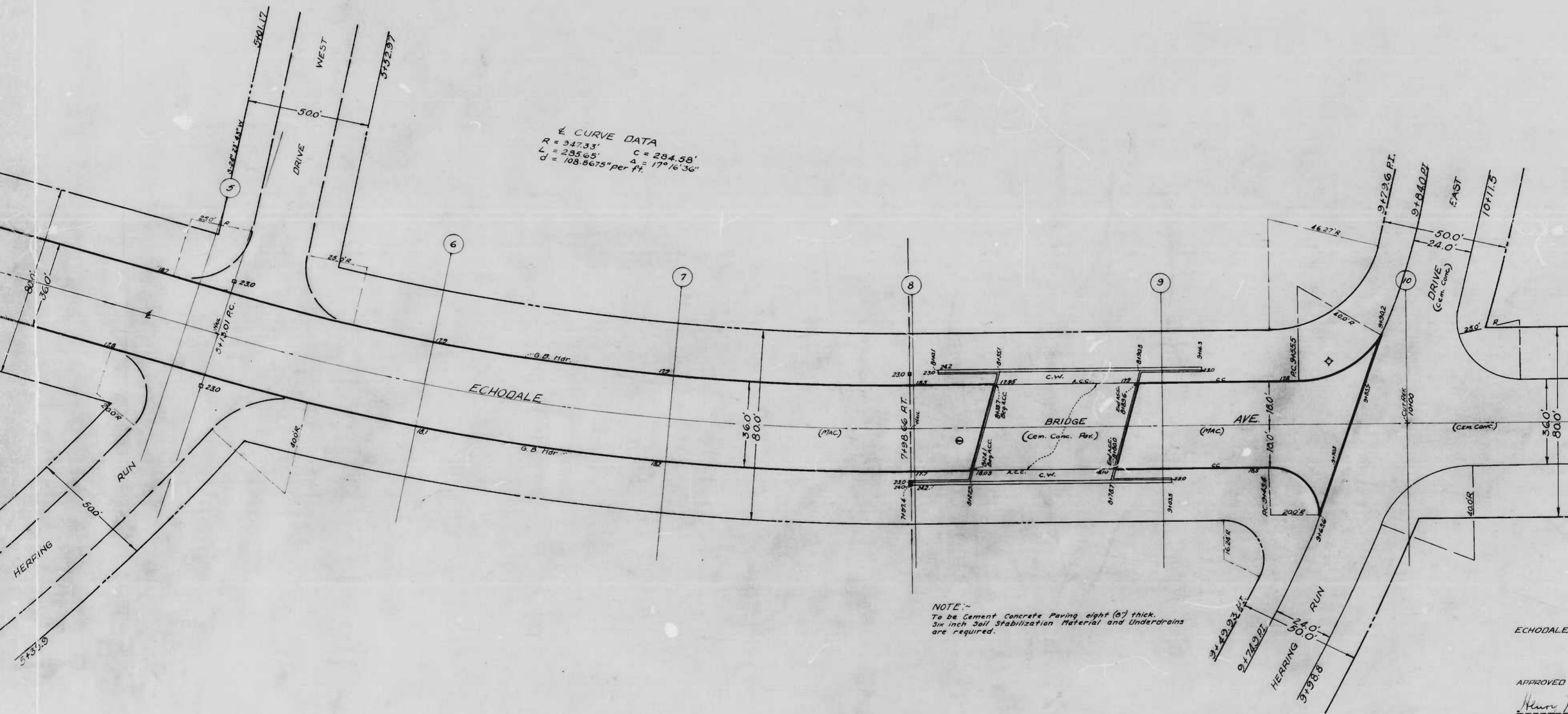

CITY OF BALTIMORE  
 DEPARTMENT OF PUBLIC WORKS  
 BUREAU OF HIGHWAYS  
 PLAN OF  
 ECHODALE AVE. - 400'± E. OF WOODBOURNE AVE. TO HERRING RUN DRIVE EAST  
 SCALE: 1" = 200'  
 BOOK NO. X-102A, CONT. NO. C.C. 846  
 DATE 2-17-47

APPROVED +  
*Harold H. Fisher*  
 ASSOCIATE ENGINEER

APPROVED +  
*Wm. T. Fisher*  
 HIGHWAYS ENGINEER

APPROVED +  
*Edward J. Mackey*  
 ENGR. PLANS & SURVEYS

APPROVED +  
*Wm. L. Smith*  
 CHIEF ENGINEER

sheet

sheet

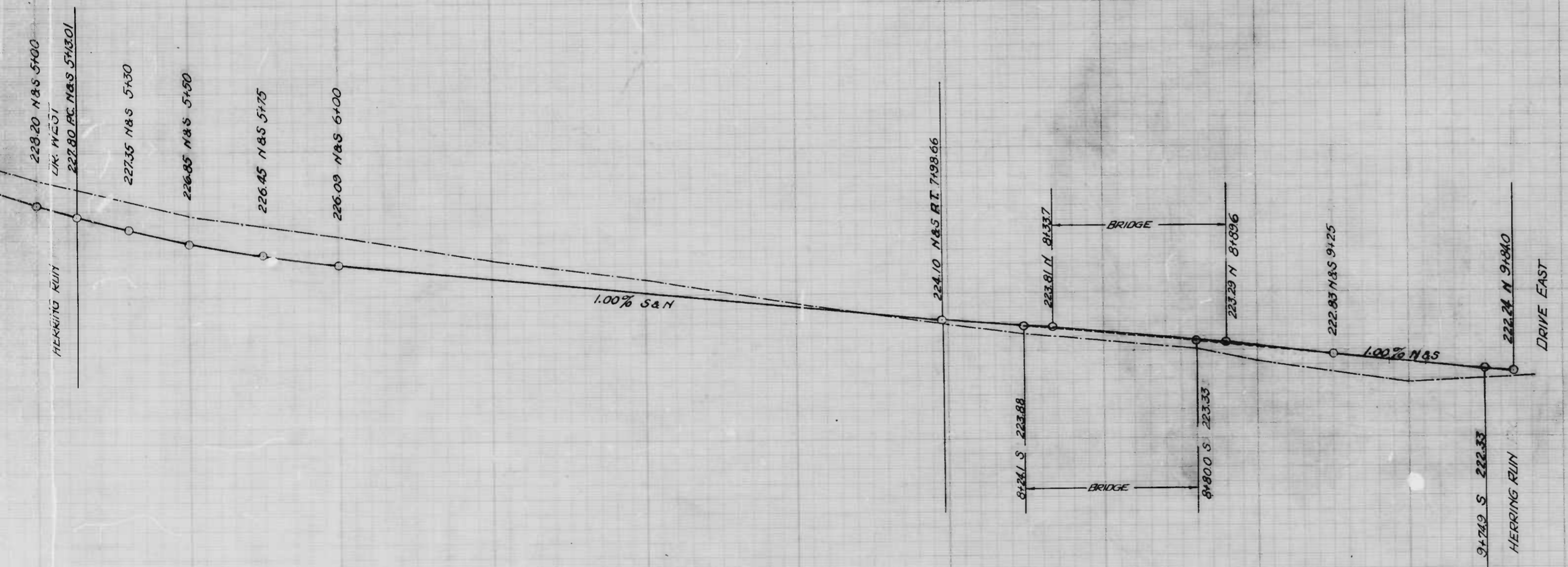
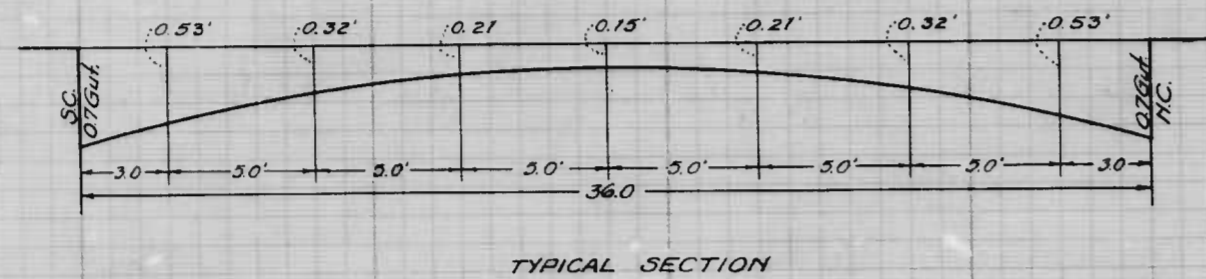

CITY OF BALTIMORE  
 DEPARTMENT OF PUBLIC WORKS  
 BUREAU OF HIGHWAYS  
 PROFILE OF  
 ECHODALE AVE - 400' E OF WOODBOURNE AVE. TO HERRING RUN DRIVE EAST  
 SCALES: VER. 1" = 20'  
 HOR. 1" = 200'  
 BOOK NO. X-182-A CONT. NO. C.C. 846  
 DATE: 2-20-47

APPROVED \*  
*Henry Weisberg*  
 ASSOCIATE ENGINEER

APPROVED \*  
*W. T. Fisher*  
 HIGHWAYS ENGINEER

APPROVED \*  
*Edward J. Heaton*  
 ENGR. PLANS & SURVEYS

APPROVED \*  
*Dorothy L. Smith*  
 CHIEF ENGINEER



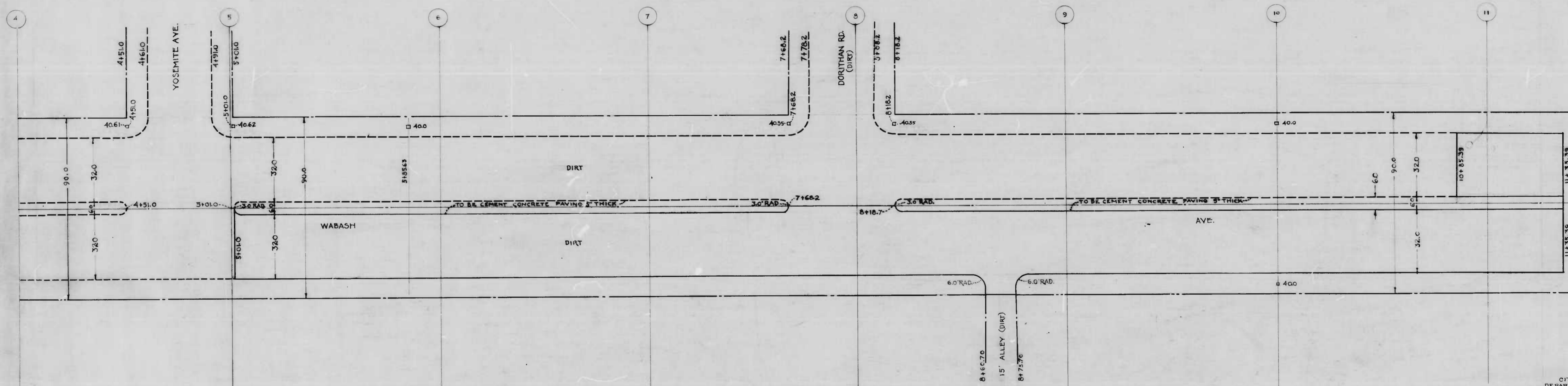

NOTE:  
 TO BE CEMENT CONCRETE PAVING 8" THICK  
 FROM STA. 5+01.0 TO STA. 10+00. 2 INCHES OF STONE  
 DUST SCREENING WILL BE REQUIRED  
 FROM STA. 10+00 TO STA. 11+35.39 - 6 INCHES OF SOIL  
 STABILIZATION WILL BE REQUIRED  
 UNDERDRAIN PIPE WILL BE REQUIRED THROUGHOUT

DRAWN BY L.L. DOWLING  
 ENGINEER IN CHARGE OF DRAFTING

CITY OF BALTIMORE  
 DEPARTMENT OF PUBLIC WORKS  
 BUREAU OF HIGHWAYS  
 PLAN OF  
 WABASH AVE. (DRIVE) YOSEMITE AVE. 316' N. OF DORATHAN RD.  
 CONT. NO. 846  
 SCALE - 1" = 20' 0"  
 BOOK NO. X214  
 APRIL 30, 1947  
 APPROVED  
 Associate Engineer  
 APPROVED  
 Chief Engineer

shot





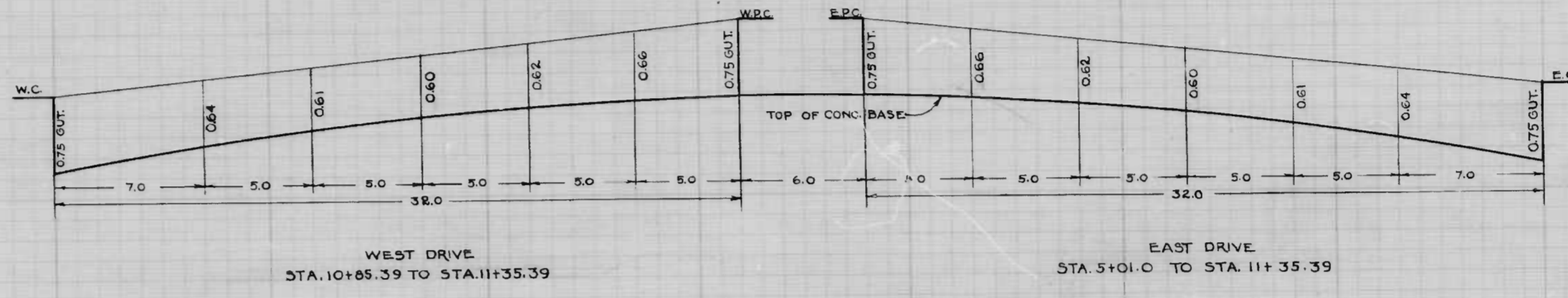

NOTE: FROM STA. 5+01.0 TO STA. 11+35.39, ELEVATION OF PARKING CURBS TO BE 7' FT ABOVE ELEVATIONS OF E & W CURBS.

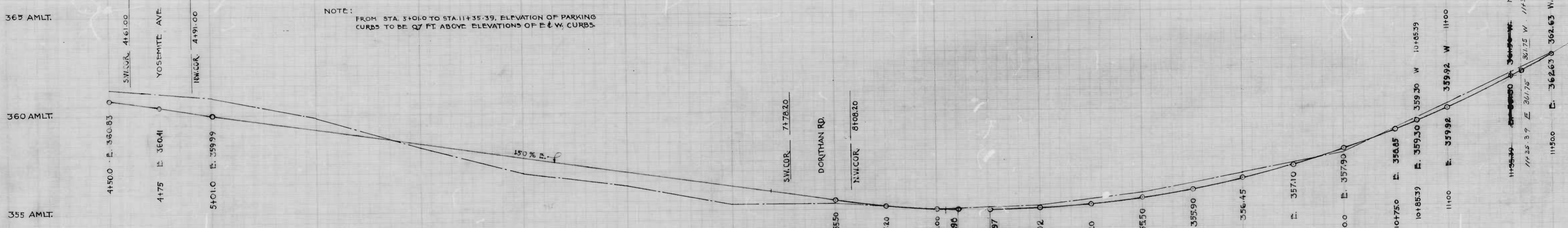

DRAWN BY J.L. DOWLING  
ENGINEER BY S.L. [Signature]  
SUPERVISOR IN CHARGE OF SURVEYS

CITY OF BALTIMORE  
DEPARTMENT OF PUBLIC WORKS  
BUREAU OF HIGHWAYS  
PROFILE OF  
WABASH AVE (E-DRIVE) - YOSEMITE AVE - 318' N OF DORRITHAN  
CONTIN# 846

BOOK NO. APRIL 30  
APPROVED [Signature]  
HIGHWAYS ENGINEER

APPROVED [Signature]  
ENGR. PLANS & SURVEYS

APPROVED [Signature]  
CHIEF ENGINEER

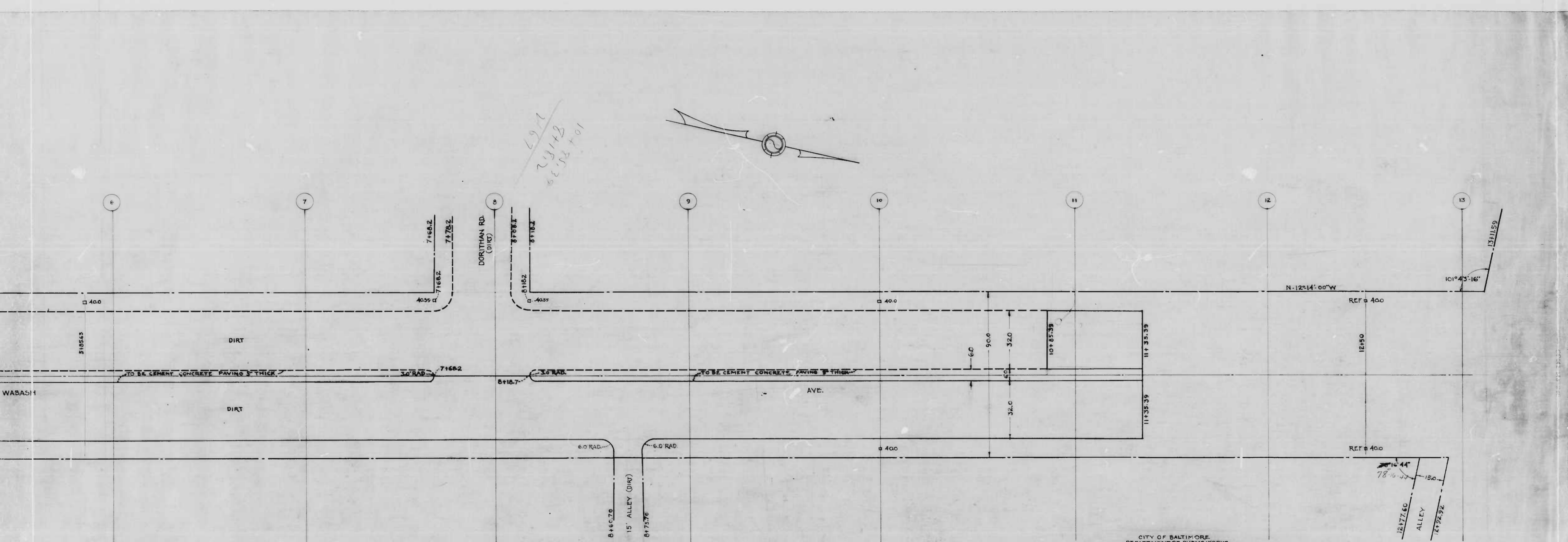

NOTE:  
 TO BE CEMENT CONCRETE PAVING 8" THICK  
 FROM STA. 5+01.0 TO STA. 10+00.2 INCHES OF STONE  
 DUST SCREENINGS WILL BE REQUIRED  
 FROM STA. 10+00 TO STA. 11+35.39 - 6 INCHES OF SOIL  
 STABILIZATION WILL BE REQUIRED  
 UNDERDRAIN PIPE WILL BE REQUIRED THROUGHOUT

CITY OF BALTIMORE  
 DEPARTMENT OF PUBLIC WORKS  
 BUREAU OF HIGHWAYS  
 PLAN OF  
 WABASH AVE. (DRIVE); YOSEMITE AVE. - 316' N. OF DORITHAN RD.  
 CONT. NO. 846  
 SCALE - 1" = 20' 0"  
 BOOK NO. X214  
 APRIL 30, 1947  
 APPROVED *Henry Mueberg* ASSOCIATE ENGINEER  
 APPROVED *W. J. V. Zacher* HIGHWAYS ENGINEER  
 APPROVED *Edmond J. Mackinnon* ENGR. PLANS & SURVEYS  
 APPROVED *Paul R. Smith* CHIEF ENGINEER

shot 1

shot 2

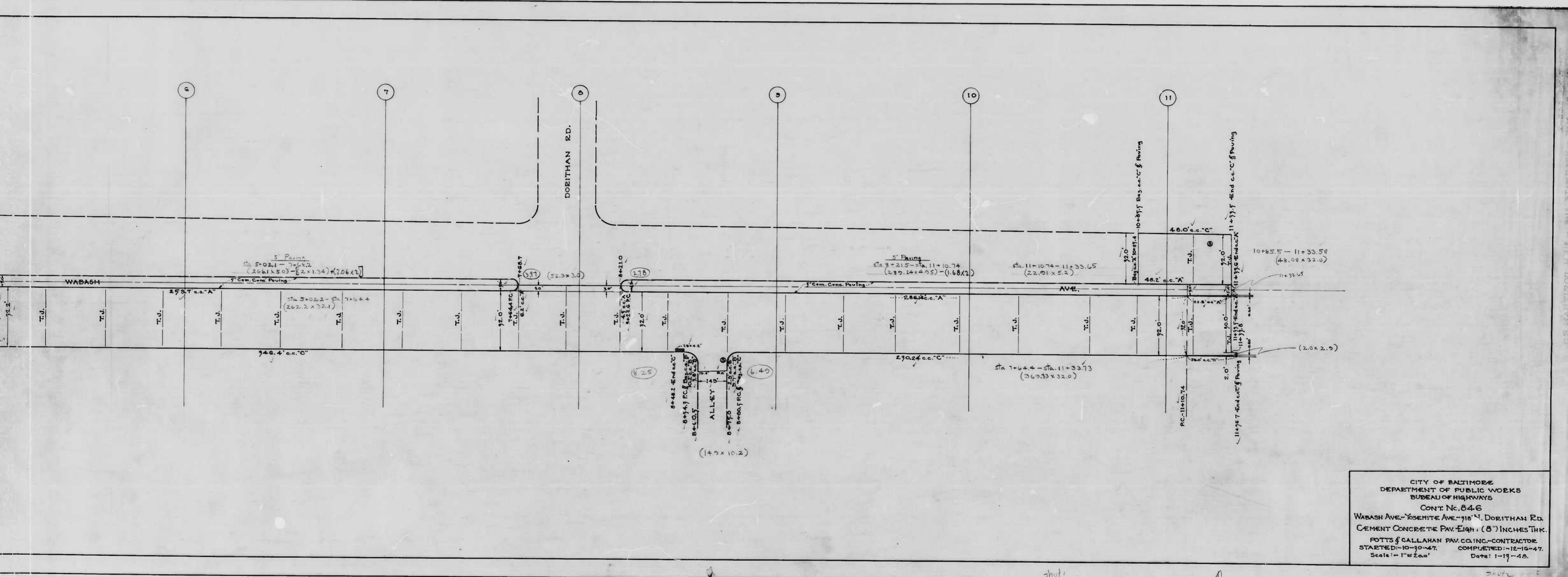

CITY OF BALTIMORE  
 DEPARTMENT OF PUBLIC WORKS  
 BUREAU OF HIGHWAYS  
 CONT. No. 846  
 WABASH AVE.-Yosemite Ave.-718' N. DORITHAN RD.  
 CEMENT CONCRETE PAVEMENT (8") THICK.  
 POTTS & CALLAHAN PAV. CO. INC.-CONTRACTOR  
 STARTED: 10-30-47. COMPLETED: 12-16-47.  
 Scale: 1" = 200' Date: 1-17-48.

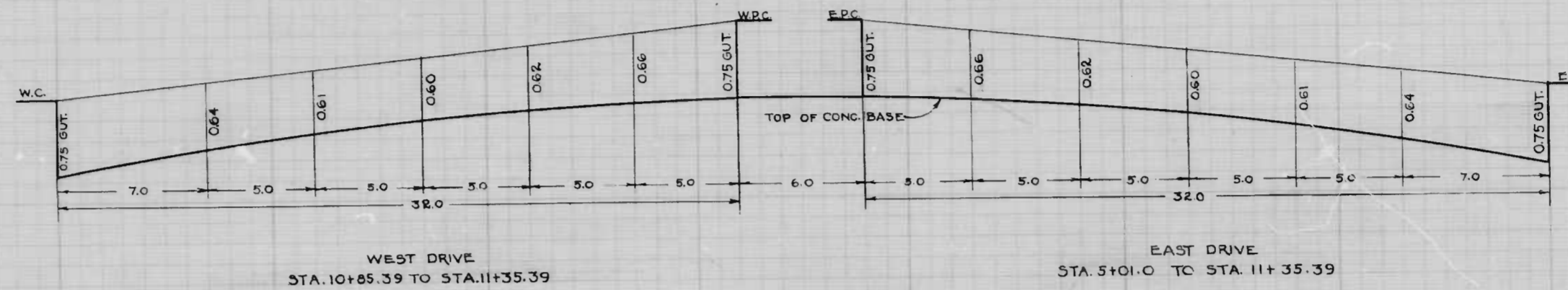

WEST DRIVE  
STA. 10+65.39 TO STA. 11+35.39

EAST DRIVE  
STA. 5+01.0 TO STA. 11+35.39

NOTE:  
FROM STA. 5+01.0 TO STA. 11+35.39, ELEVATION OF PARKING CURBS TO BE 0' FT. ABOVE ELEVATIONS OF E & W CURBS.



365 AML.  
360 AML.  
355 AML.

DESIGNED BY *A.L. DOMING*  
EXAMINED BY *S.D. [Signature]*  
SUPERVISOR IN CHARGE OF DRAWING

CITY OF BALTIMORE  
DEPARTMENT OF PUBLIC WORKS  
BUREAU OF HIGHWAYS  
PROFILE OF  
WABASH AVE (E-DRIVE) - YOSEMITE AVE - 318' N OF DOROTHAN  
CONT'N 846

SCALES - HOR: 1" = 20.0'  
VER: 1" = 2.0'

APPROVED *[Signature]*  
ASSOCIATE ENGINEER

APPROVED *[Signature]*  
ENGR. PLANS & SURVEYS

APPROVED *[Signature]*  
CHIEF ENGINEER

BOOK NO. 1  
APRIL 30, 1951

Sheet

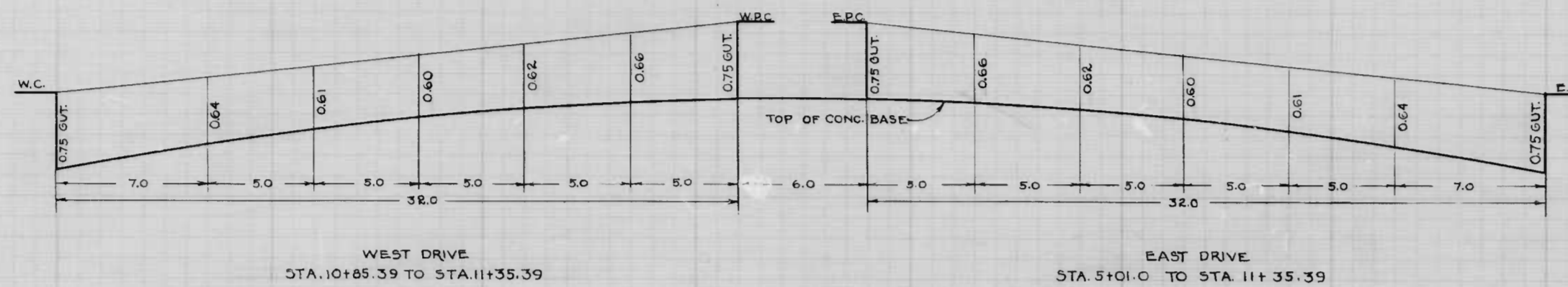

NOTE:  
FROM STA. 5+01.0 TO STA. 11+35.39, ELEVATION OF PARKING CURBS TO BE 07 FT. ABOVE ELEVATIONS OF E & W CURBS.

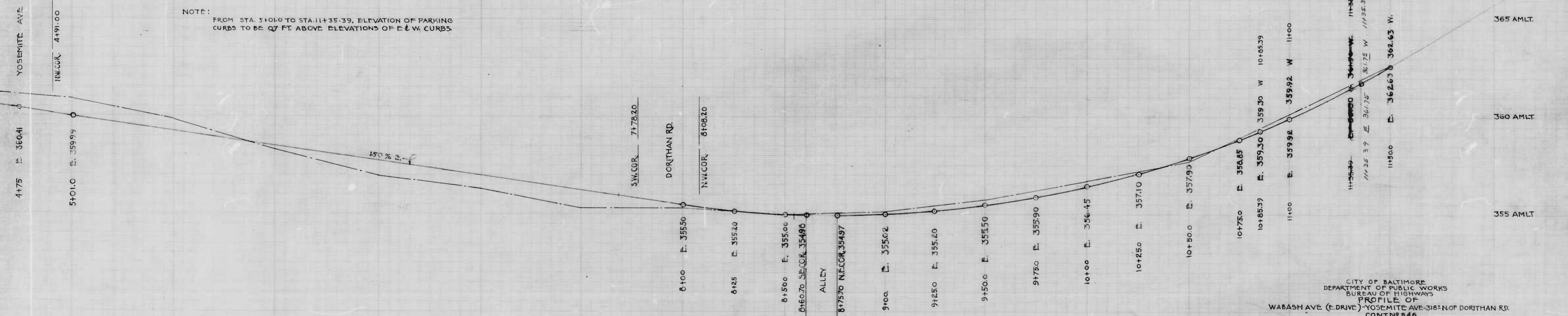

CITY OF BALTIMORE  
DEPARTMENT OF PUBLIC WORKS  
BUREAU OF HIGHWAYS  
PROFILE OF  
WABASH AVE (E.DRIVE)-YOSEMITE AVE-315' N OF DORATHAN RD.  
CONTN# 846

SCALES: HOR: 1" = 200'  
VER: 1" = 20'

APPROVED: *Henry H. ...*  
ASSOCIATE ENGINEER

APPROVED: *W. J. ...*  
HIGHWAYS ENGINEER

APPROVED: *Edmond J. ...*  
ENGR. PLANS & SURVEYS

APPROVED: *Opfer ...*  
CHIEF ENGINEER

BOOK NO. 214  
APRIL 30, 1947