

NOTE:
 TO BE CEMENT CONCRETE PAVING SEVEN (7) INCHES IN DEPTH
 SOIL STABILIZATION MATERIAL AND/OR UNDERDRAINS ARE NOT REQUIRED

(No) PLAT NUMBER
 (No) HOUSE OR DEV. LOT NUMBER
 (No) APPEAL TAX COURT LOT NUMBER

WARD 8
 SECTION 16
 BLOCK 1488

FILED May 1 - 1947
 HIGHWAYS ENGINEER
 PER [Signature]

CITY OF BALTIMORE
 DEPARTMENT OF PUBLIC WORKS
 BUREAU OF HIGHWAYS
 ASSESSMENT PLAT NO 503-A
 KENHILL AVE. - OLIVER ST. - FEDERAL ST.
 CONT. NO 845
 BOOK NO X 230
 APRIL 21, 1947

APPROVED

APPROVED

[Signature]
 ASSOCIATE ENGINEER

[Signature]
 ENGR PLANS & SURVEYS

APPROVED

APPROVED

[Signature]
 HIGHWAYS ENGINEER

[Signature]
 CHIEF ENGINEER

347 J.G.F.
 S.P. Burns

246-11 T-101100
 A-100-11 T-101100-100
 TO JAMES H. TAYLOR, CIVIL ENGINEER

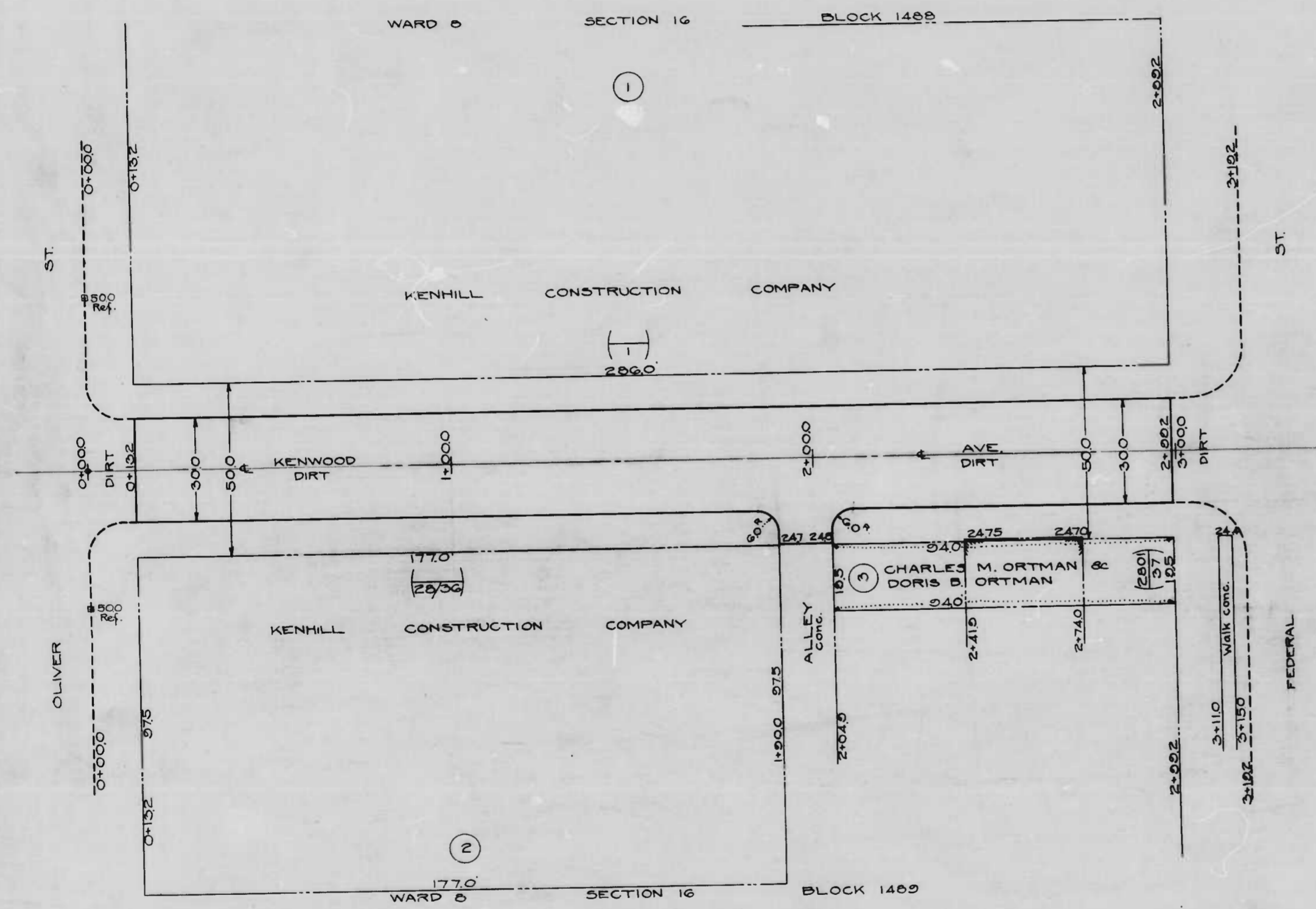

NOTE:-
 TO BE CEMENT CONCRETE PAVING SEVEN (7) INCHES IN DEPTH
 SOIL STABILIZATION MATERIAL AND/OR UNDERDRAINS ARE NOT REQUIRED

(N^o) PLAT NUMBER
 (H^o) HOUSE OR DEV. LOT NUMBER
 (T^o) APPEAL TAX COURT LOT NUMBER
 WARD 8
 SECTION 16
 BLOCK 1485-1489

FILED May 1 - 1947
 HIGHWAYS ENGINEER
 PER [Signature]

CITY OF BALTIMORE
 DEPARTMENT OF PUBLIC WORKS
 BUREAU OF HIGHWAYS
 ASSESSMENT PLAT N^o 584A
 KENWOOD AVE - OLIVER ST - FEDERAL ST.
 CONTRACT N^o 845
 BOOK N^o X 230
 SCALE - 1" = 2000' APRIL 24, 1947

APPROVED [Signature] ASSOCIATE ENGINEER
 APPROVED [Signature] ENGR. PLANS & SURVEYS
 APPROVED [Signature] HIGHWAYS ENGINEER
 APPROVED [Signature] CHIEF ENGINEER

DRAWN BY: J.G.F.
 CHECKED BY: S.J. [Signature]
 ENGINEER IN CHARGE OF DRAWING

KENWOOD AVE - OLIVER ST - FEDERAL ST.
 ASSESSMENT PLAT N^o 584A
 CONTRACT N^o 845
 BOOK N^o X 230

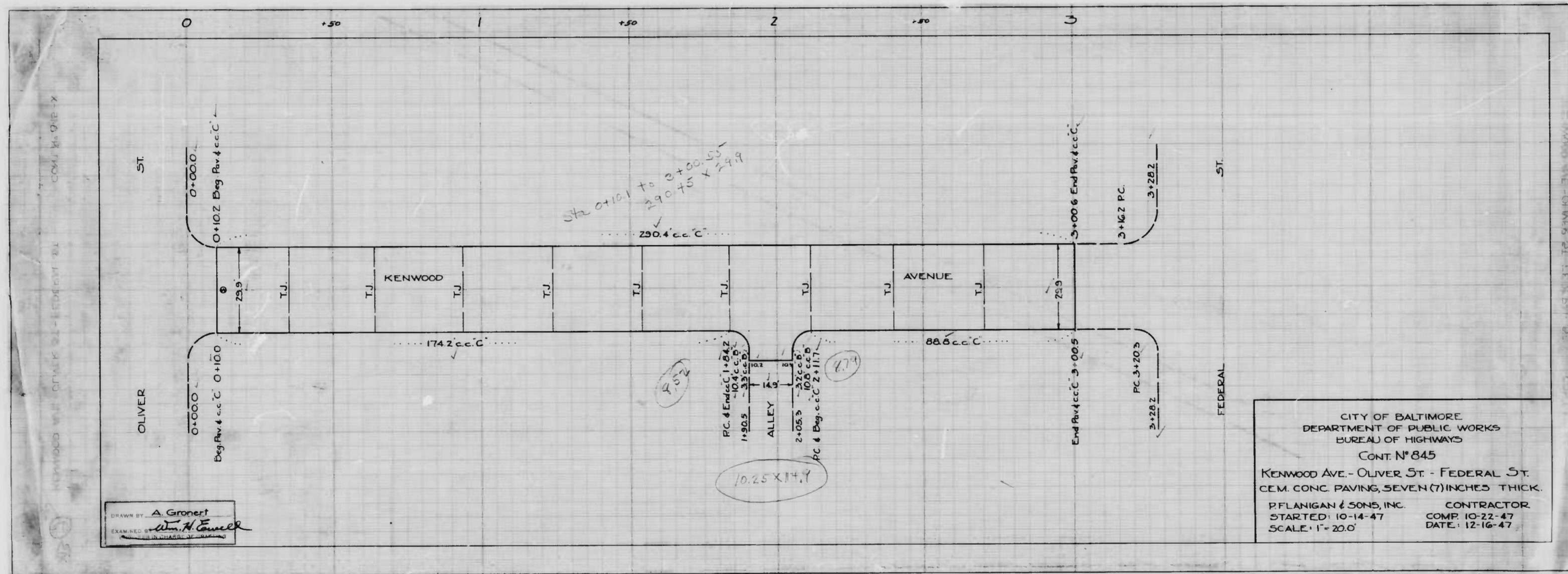

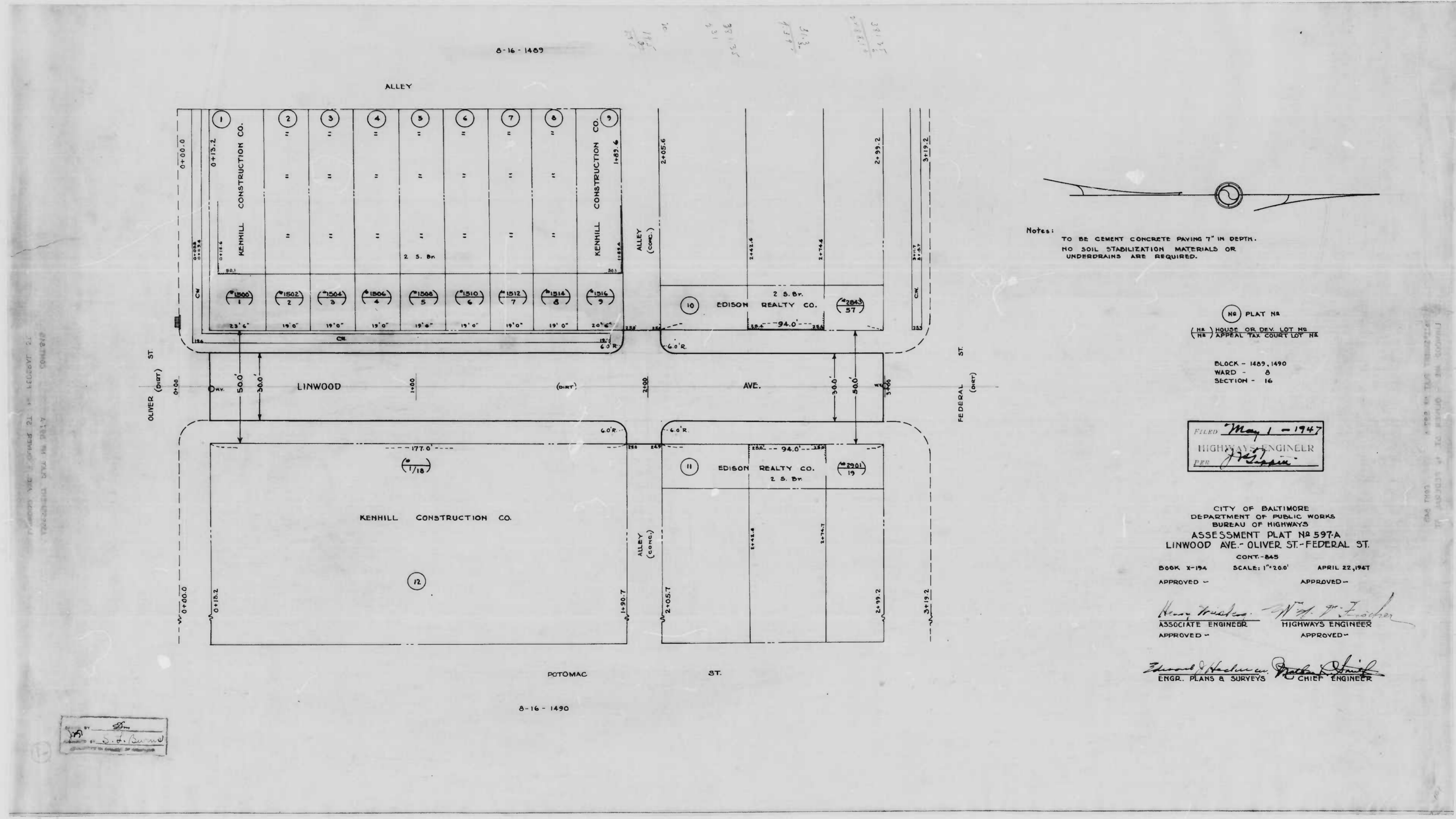

Notes:
 TO BE CEMENT CONCRETE PAVING 7" IN DEPTH.
 NO SOIL STABILIZATION MATERIALS OR
 UNDERDRAINS ARE REQUIRED.

NO PLAT NO
 (NA) HOUSE OR DEV. LOT NO
 (NR) APPEAL TAX COURT LOT NO

BLOCK - 1489, 1490
 WARD - 8
 SECTION - 16

FILED May 1 - 1947
 HIGHWAYS ENGINEER
 PER [Signature]

CITY OF BALTIMORE
 DEPARTMENT OF PUBLIC WORKS
 BUREAU OF HIGHWAYS
 ASSESSMENT PLAT NO 597A
 LINWOOD AVE.- OLIVER ST.- FEDERAL ST.
 CONT.- 845
 BOOK X-194 SCALE: 1"=200' APRIL 22, 1947

APPROVED - [Signature] ASSOCIATE ENGINEER
 APPROVED - [Signature] HIGHWAYS ENGINEER

[Signature] ENGR. PLANS & SURVEYS
 [Signature] CHIEF ENGINEER

15
 [Signature]

8-16-1490

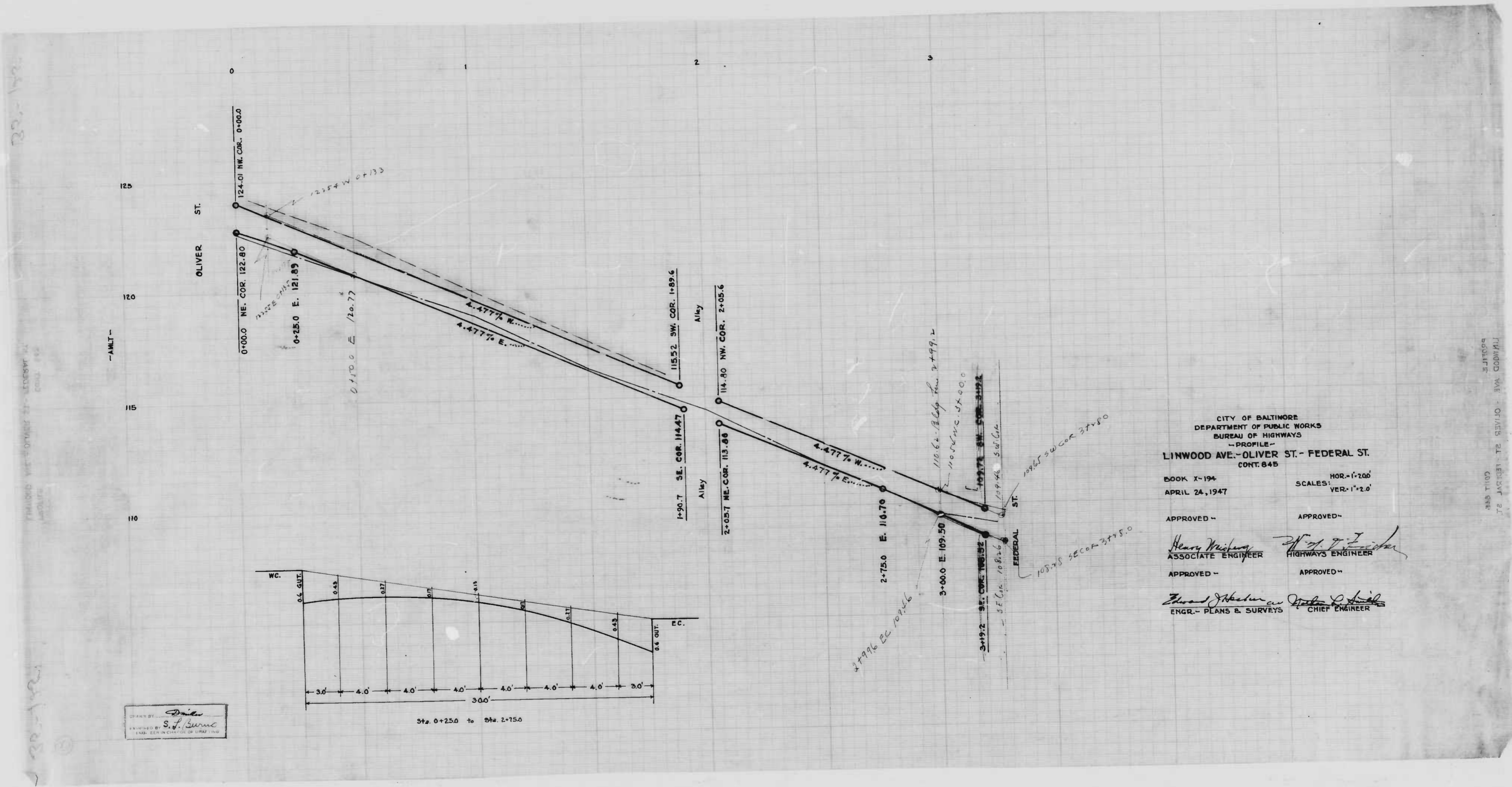

DESIGNED BY *S. F. Burns*
 DRAWN BY *S. F. Burns*
 CHECKED BY *[Signature]*
 ENGR. EXP. IN CHARGE OF DRAWING

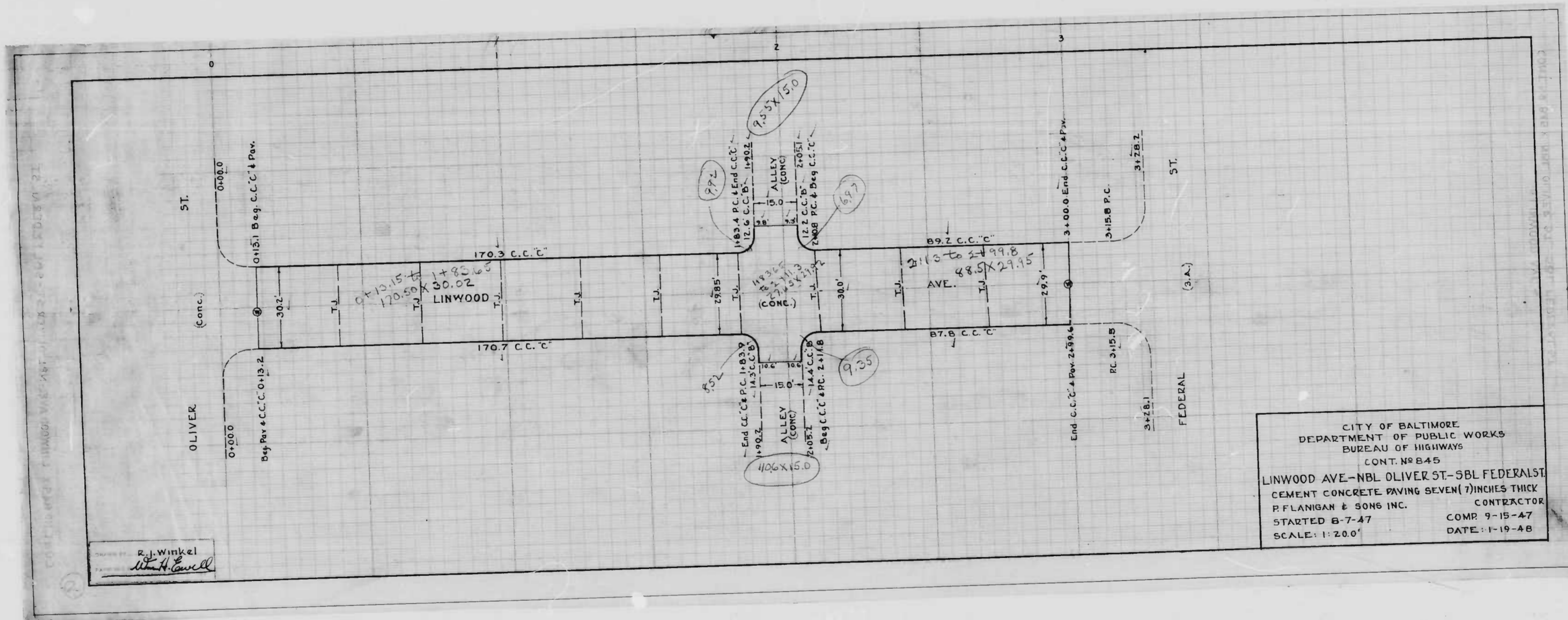

CITY OF BALTIMORE
 DEPARTMENT OF PUBLIC WORKS
 BUREAU OF HIGHWAYS
 CONT. NO. 845
 LINWOOD AVE - NBL OLIVER ST - SBL FEDERAL ST
 CEMENT CONCRETE PAVING SEVEN (7) INCHES THICK
 R. FLANGAN & SONS INC. CONTRACTOR
 STARTED 8-7-47 COMP. 9-15-47
 SCALE: 1" = 20.0'

R. J. Winkel
 W. H. Cavell

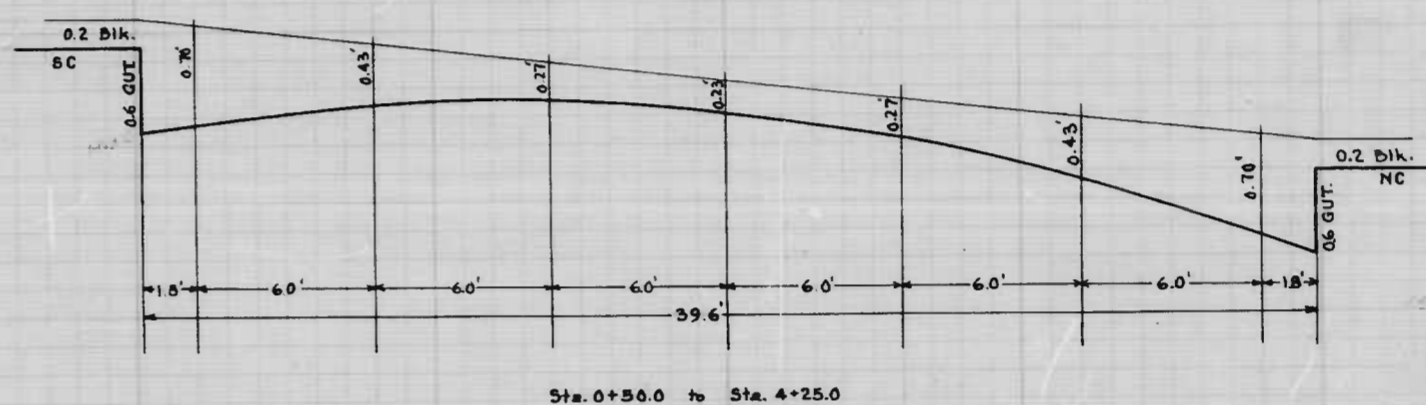
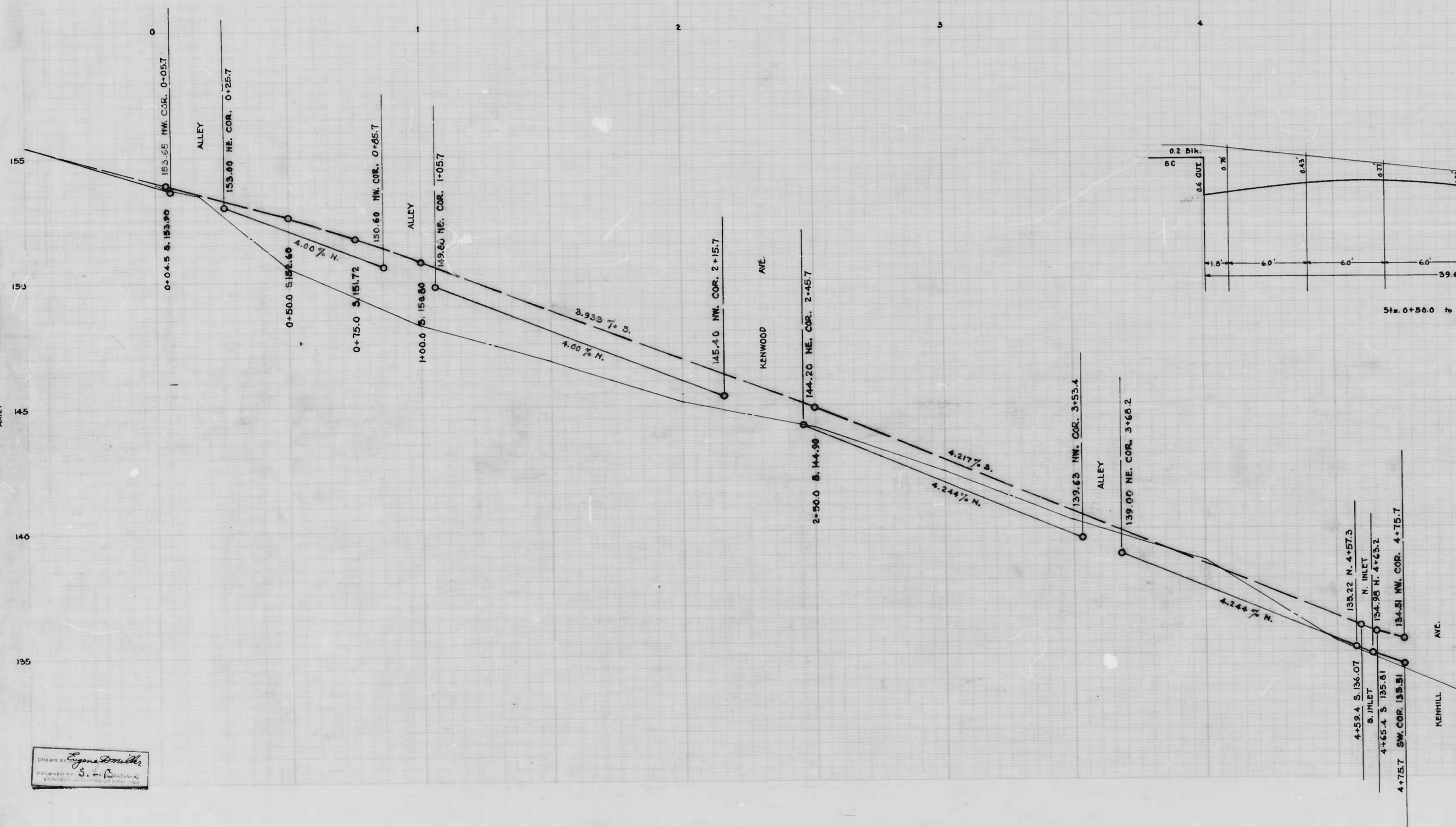

CITY OF BALTIMORE
 DEPARTMENT OF PUBLIC WORKS
 BUREAU OF HIGHWAYS
OLIVER ST. - KENHILL AVE. - AL. E. LAKEWOOD AVE.
 CONT. 845
 BOOK X-194
 APRIL 23, 1947
 APPROVED - *Henry Wisberg* ASSOCIATE ENGINEER
 APPROVED - *W. H. Fisher* HIGHWAYS ENGINEER
 APPROVED - *Edward J. Maden* ENGR. - PLANS & SURVEYS
 APPROVED - *Nathan D. Smith* CHIEF ENGINEER

DRAWN BY *Egon Smulke*
 CHECKED BY *S. M. ...*

OFFICE: 317 KENHILL AVE. - AT E. LAKEWOOD AVE.

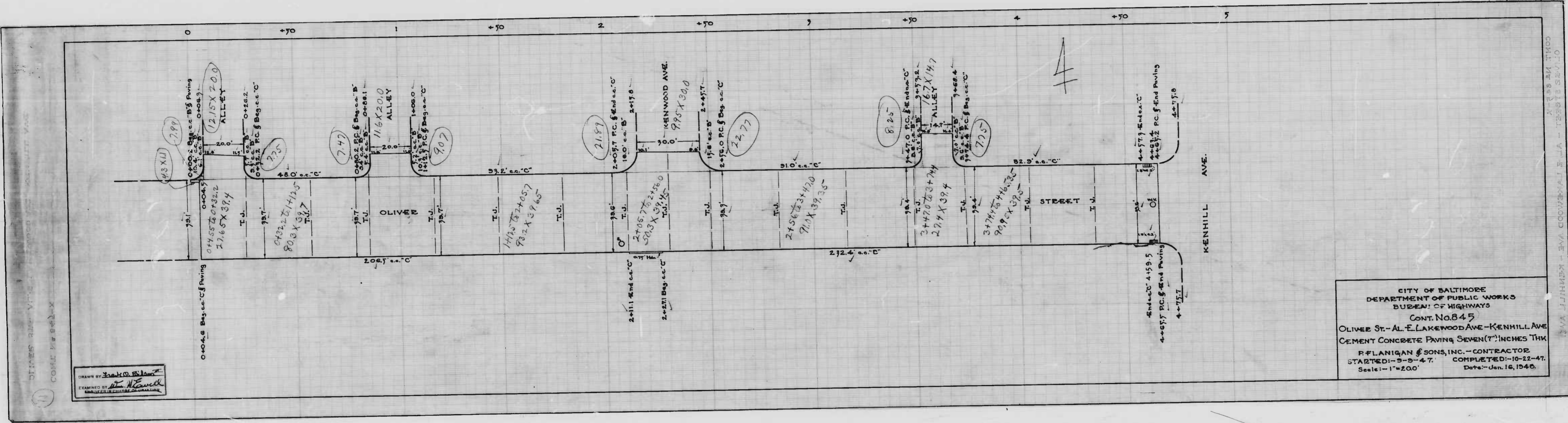

CITY OF BALTIMORE
 DEPARTMENT OF PUBLIC WORKS
 BUREAU OF HIGHWAYS
 CONT. No. 845
 OLIVER ST. - AL. E. LAKEWOOD AVE. - KENNILL AVE.
 CEMENT CONCRETE PAVING SEVEN (7) INCHES THK
 P. FLANIGAN & SONS, INC. - CONTRACTOR
 STARTED: 3-3-47. COMPLETED: 10-22-47.
 Scale: 1"=200' Date: Jan. 16, 1948.

DRAWN BY *Frank O. Wilson*
 CHECKED BY *Wm. H. Smith*
 ENGINEER

STAGES AND VIEWS TO BE SHOWN AS INDICATED
 COME HERE TO X

CONT. NO. 845
 OLIVER ST. - AL. E. LAKEWOOD AVE. - KENNILL AVE.
 CEMENT CONCRETE PAVING SEVEN (7) INCHES THK

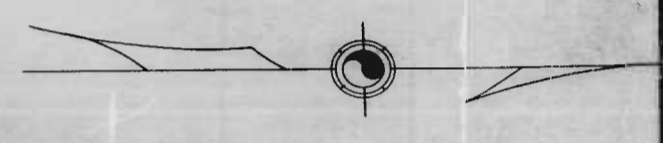
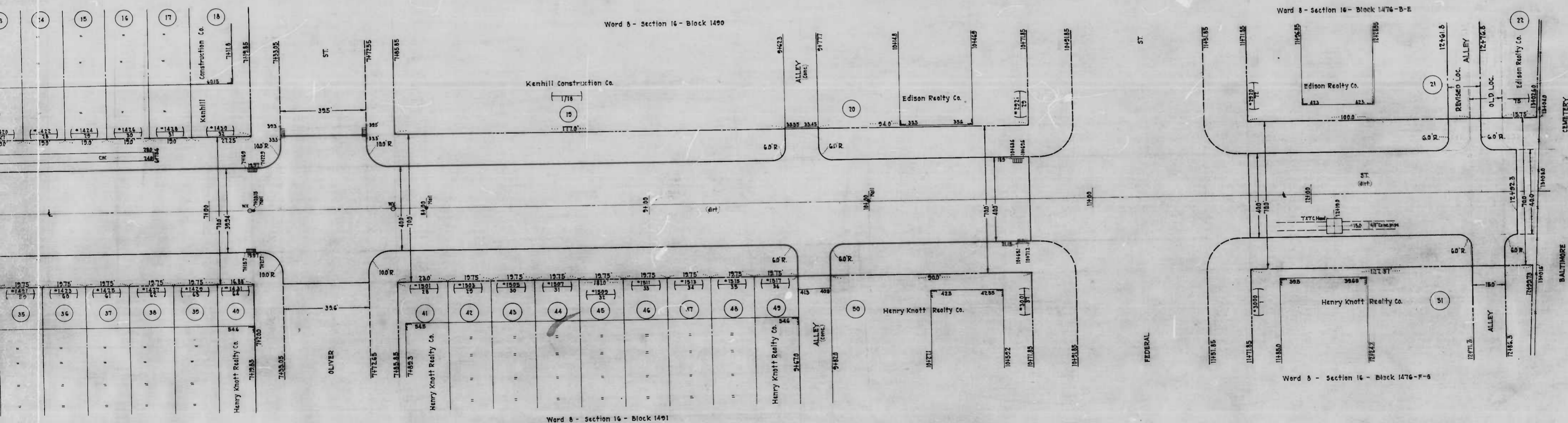

NOTE:
TO BE CEMENT CONCRETE PAVING 7" THICK.
SOIL STABILIZATION MATERIALS AND/OR
UNDERDRAINS ARE NOT REQUIRED.

NO. PLAT NO.
HOUSE OR REV LOT NO.
APPEAL TAX COURT LOT NO.

WARD - 8
SECTION - 16, 23
BLOCK - 1476-B-E, 1476-F-6, 1490, 1491
11-09, 1510, 1529, 1526-27

FILED May 1 - 1947
HIGHWAY ENGINEER

CITY OF BALTIMORE
DEPARTMENT OF PUBLIC WORKS
BUREAU OF HIGHWAYS
ASSESSMENT PLAT No. 596-A
POTOMAC ST. - PRESTON ST. TO BALTIMORE CEMETERY
CONT. NO. 145

SCALE - 1" = 200'
APPROVED: *Henry Weisberg*
ASSOCIATE ENGINEER

BOOK NO. -
APR. 16, 1947
APPROVED: *Edward J. ...*
CHIEF ENGINEER

ENGR. PLANS & SURVEYS. CHIEF ENGINEER
REVISED 11-14-47

Shot 2

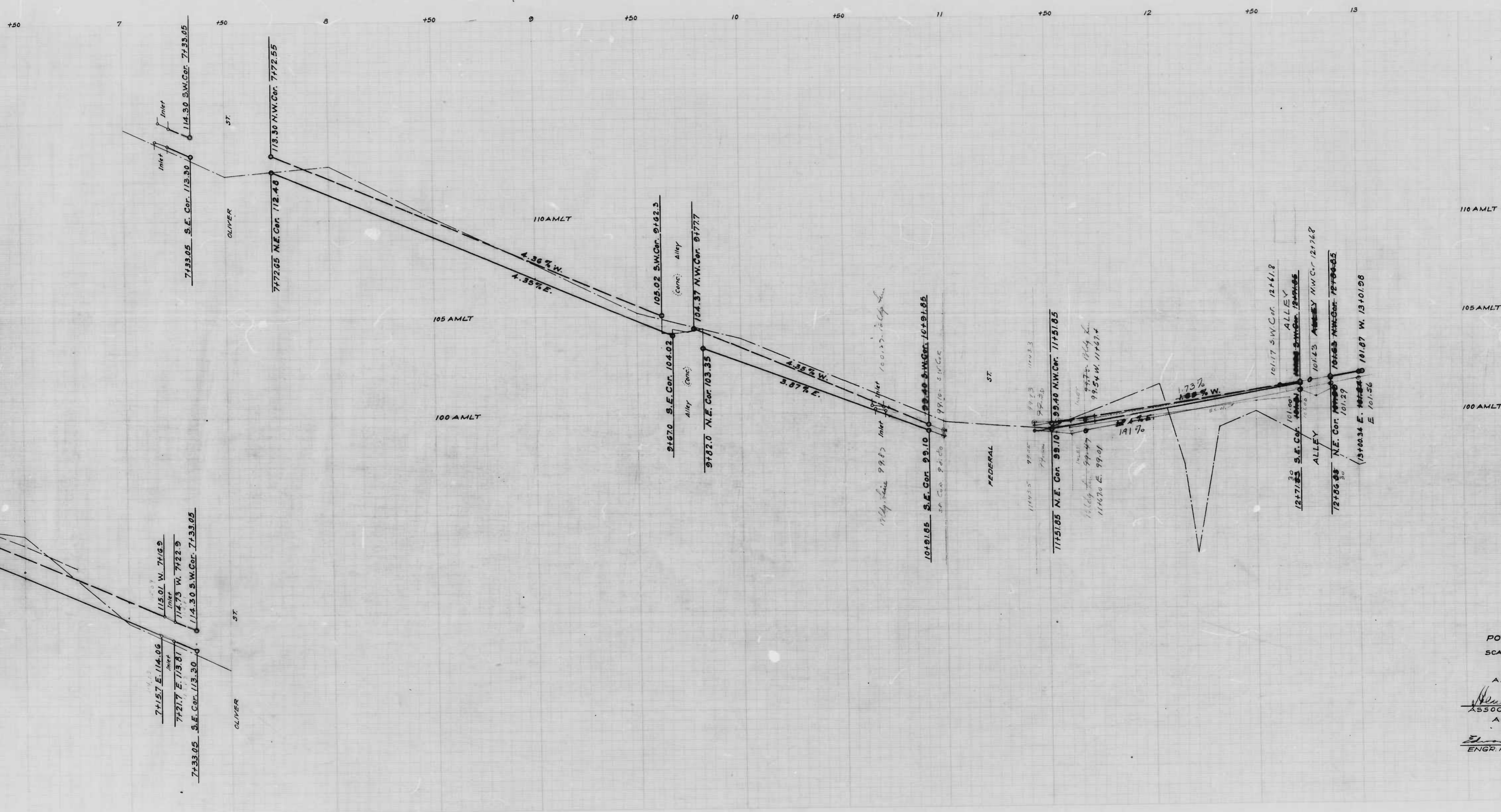

CITY OF BALTIMORE
 DEPARTMENT OF PUBLIC WORKS
 BUREAU OF HIGHWAYS

PROFILE OF
 POTOMAC ST.-PRESTON ST.-BALTIMORE

SCALE: HOR. 1" = 20.0'
 VER. 1" = 20'

CONT. NO. 845

APPROVED
Henry W. ...
 ASSOCIATE ENGINEER

APPROVED
Edward J. ...
 ENGR. PLANS & SURVEYS

APPROVED
...
 CHIEF

Sheet 2

Word 8 - Section 16 - Block 1490

Kenhill Construction Co.

Edison Realty Co.

Word 8 - Section 16 - Block 1491

1718	1719	1720	1721	1722	1723	1724	1725	1726	1727	1728	1729	1730
41	42	43	44	45	46	47	48	49				

Henry Knott Realty Co.

Word 8 - Section 16 - Block 1476-B-E

Edison Realty Co.

Henry Knott Realty Co.

Word 8 - Section 16 - Block 1476-F-G

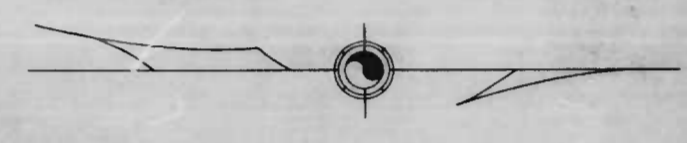

NOTE: TO BE CEMENT CONCRETE PAVING 7" THICK. SOIL STABILIZATION MATERIALS AND/OR UNDERDRAINS ARE NOT REQUIRED.

No. PLAT No.
 No. HOUSE OR DEV. LOT No.
 No. APPEAL TAX COURT LOT No.

WARD - 8
 SECTION - 16, 23
 BLOCK - 1476 B-E, 1476 F-G, 1490, 1491,
 1499, 1510, 1515, 1526-27

May 1 - 1947
 HENRY KNOTT ENGINEER
 PER [Signature]

CITY OF BALTIMORE
 DEPARTMENT OF PUBLIC WORKS
 BUREAU OF HIGHWAYS
 ASSESSMENT PLAT No. 556-A
 POTOMAC ST. - PRESTON ST. TO BALTIMORE CEMETERY
 CONT. NO. 848

SCALE - 1" = 20.0'
 APPROVED: [Signature] ASSOCIATE ENGINEER
 APPROVED: [Signature] HIGHWAYS ENGINEER
 APPROVED: [Signature] ENGR. PLANS & SURVEYS
 APPROVED: [Signature] CHIEF ENGINEER

BOOK NO. X-229
 APR. 16, 1947

REVISED 11-14-47

Shot 2

Shot 3

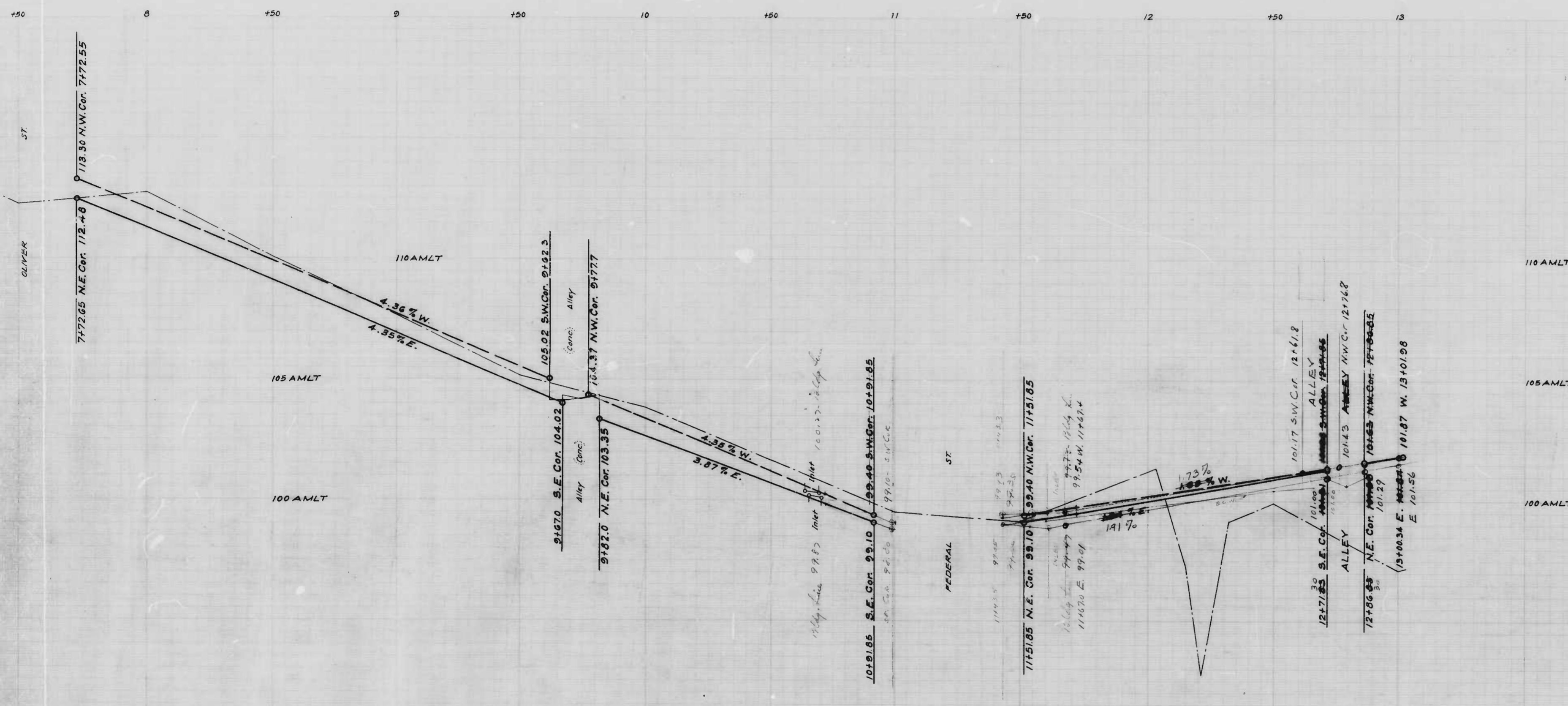

CITY OF BALTIMORE
 DEPARTMENT OF PUBLIC WORKS
 BUREAU OF HIGHWAYS
 PROFILE OF
 POTOMAC ST. - PRESTON ST. - BALTIMORE CEMETERY
 HOR. 1" = 20.0' BOOK NO. X-229
 SCALE: VER. 1" = 20' DATE: APRIL 10, 1947
 CONT. NO. 845

APPROVED
Henry Weckert
 ASSOCIATE ENGINEER
 APPROVED

APPROVED
Wm. F. Fisher
 HIGHWAYS ENGINEER
 APPROVED

Edmund Wheeler
 ENGR. PLANS & SURVEYS

Carl E. Lind
 CHIEF ENGINEER

30-81

30-81

5107 2

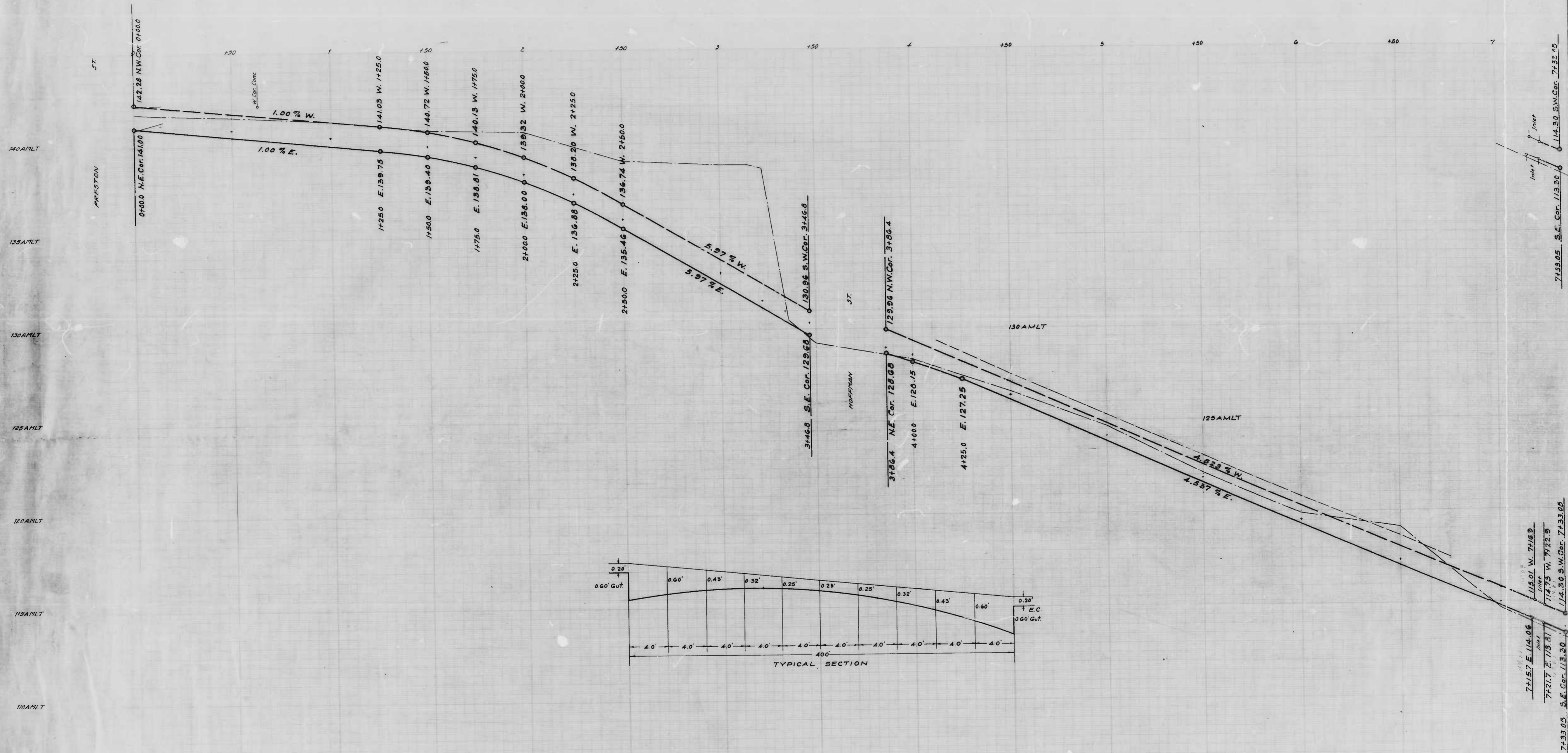

DESIGNED BY *Wm. H. Powell*
 ENGINEER
 1000 1/2 S. 1st St. (1910-1912)
 ST. LOUIS, MO.

shot