

CITY OF BALTIMORE  
DEPARTMENT OF PUBLIC WORKS  
BUREAU OF HIGHWAYS  
MASONRY RETAINING WALL  
FRANKFORD AVE AND BELAIR ROAD  
SCHOOL No 211.

Scale - As Shown

APRIL 7, 1948.

APPROVED: [Signature] PRINCIPAL ASSEC. ENGINEER

APPROVED: [Signature] HIGHWAYS ENGINEER

APPROVED: [Signature] ASSIST. Supt. - SCHOOL BOARD

APPROVED: [Signature] DIRECTOR OF PUBLIC WORKS







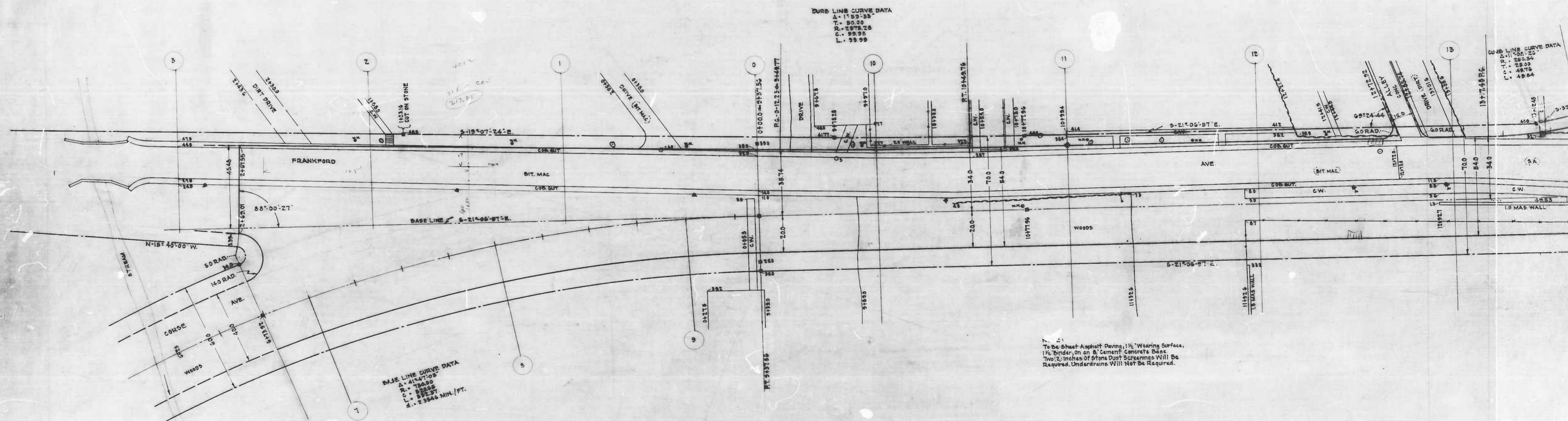

To Be Shovel Asphalt Paving, 1 1/2" Wearing Surface,  
 1 1/2" Binder on an 8" Cement Concrete Base.  
 Two 2" Inches of Stone Dust Screens Will Be  
 Required. Underdrains Will Not Be Required.

DRAWN BY: J. HANSEN  
 CHECKED BY: S. L. [Signature]  
 DATE: 1954

Sheet



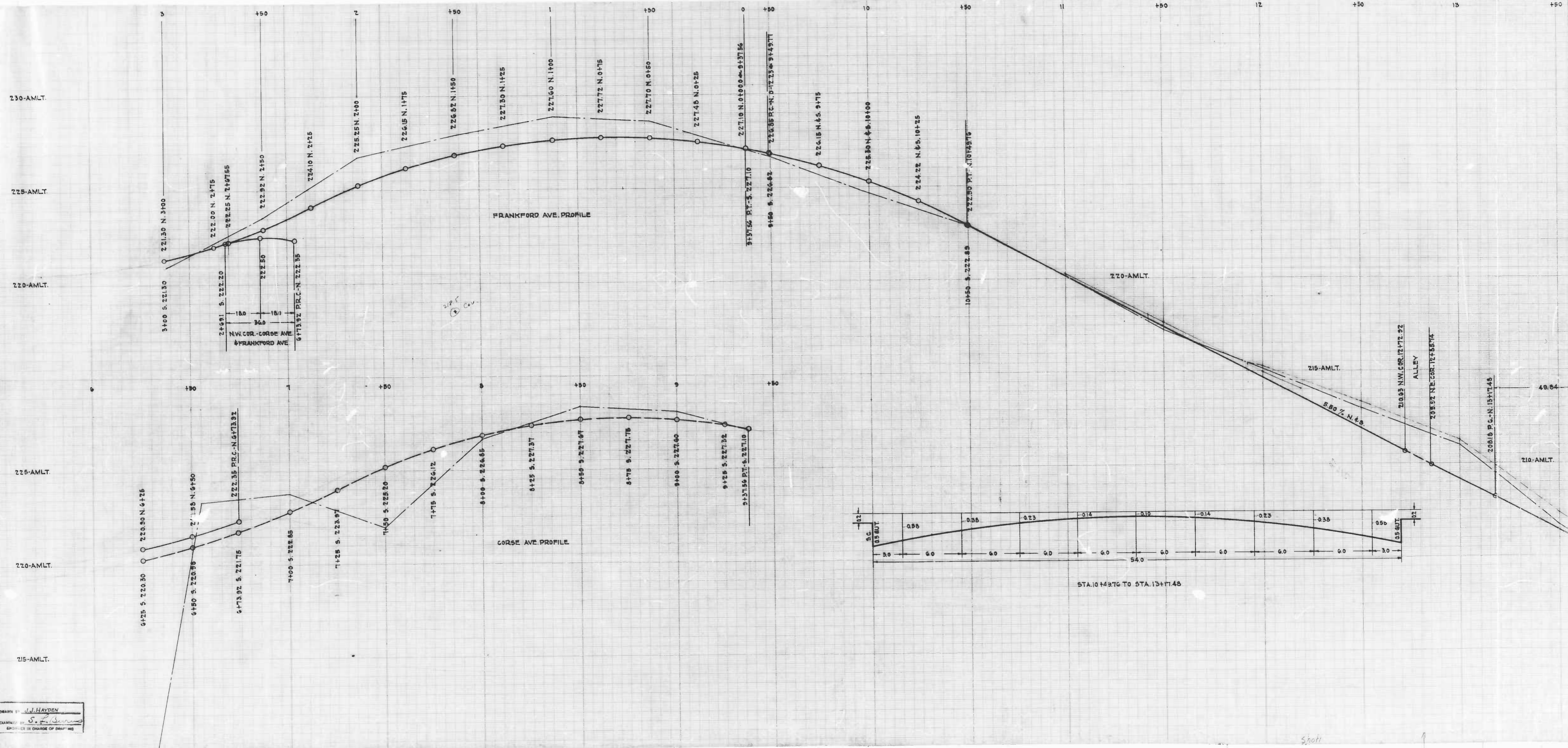

DRAWN BY: J.J. HAYDEN  
 EXAMINED BY: S. J. [Signature]  
 ENGINEER IN CHARGE OF DRAWING

Sheet



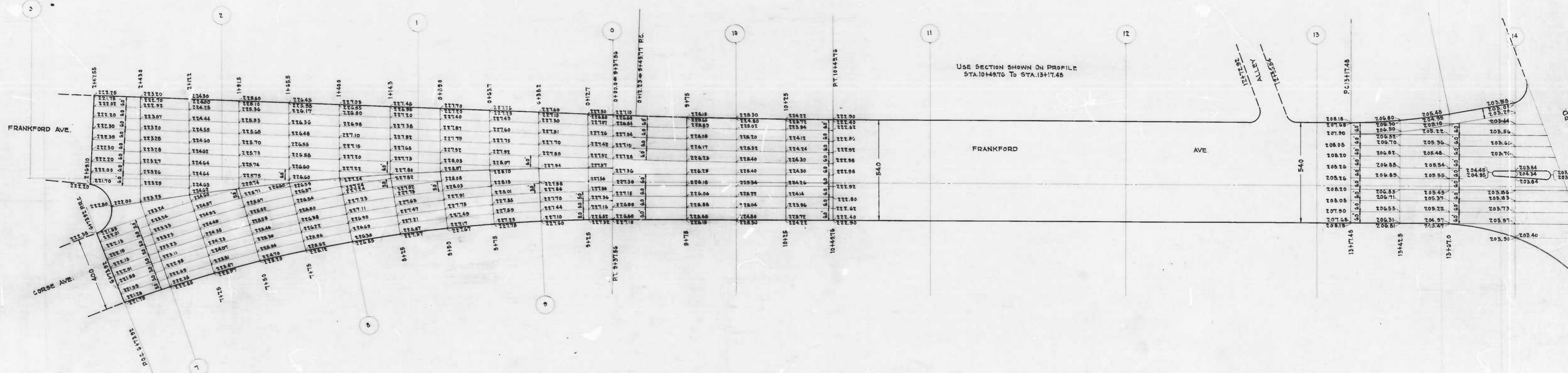

DRAWN BY J. HAYDEN  
 EXAMINED BY S. J. [Signature]  
 ENGINEER IN CHARGE OF PROJECT

Sheet





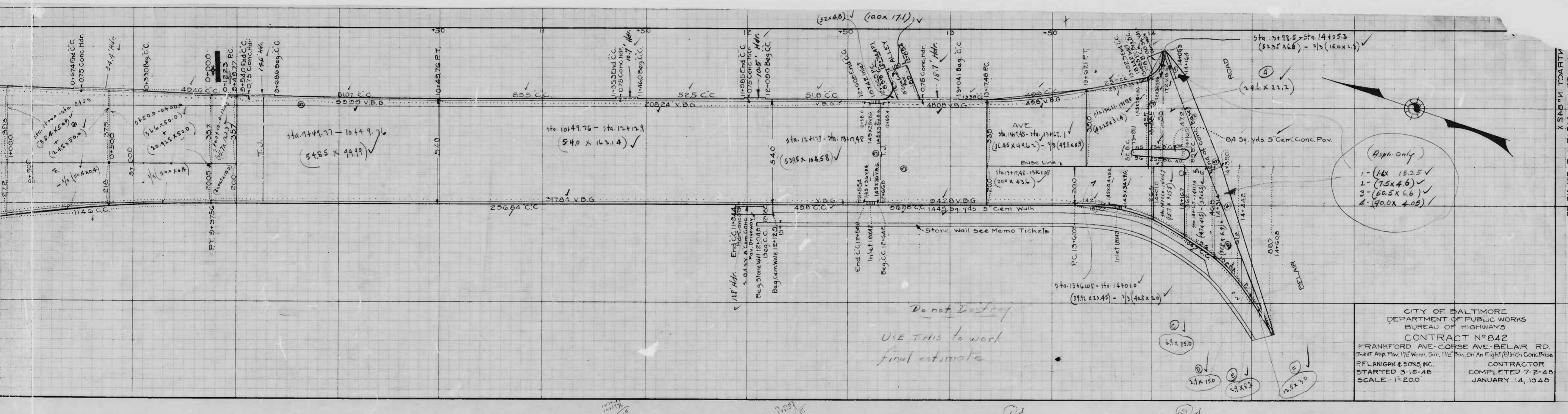

Do not Destroy  
 Use this to work  
 final estimate

CITY OF BALTIMORE  
 DEPARTMENT OF PUBLIC WORKS  
 BUREAU OF HIGHWAYS  
 CONTRACT NO 842  
 FRANKFORD AVE. CORSE AVE. BELAIR RD.  
 SHEET 159 PAV. 11/2" WALK, 5/8" S.W. 11/2" S.W. ON AN EIGHT (8) INCH CONC. BASE  
 RELANIGAN & SONS INC. CONTRACTOR  
 STARTED 3-15-48 COMPLETED 7-2-48  
 SCALE: 1"=200' JANUARY 14, 1948

FRANKFORD AVE. CORSE AVE. BELAIR RD.  
 SHEET 159 PAV. X



CURB LINE CURVE DATA  
 Δ: 115.50  
 T: 50.00  
 R: 2870.28  
 C: 35.95  
 L: 33.99

CURB LINE CURVE DATA  
 Δ: 115.50  
 T: 50.00  
 R: 2870.28  
 C: 35.95  
 L: 33.99

CURB LINE CURVE DATA  
 Δ: 69.22  
 T: 12.39  
 R: 105.14  
 C: 115.32  
 L: 127.61

NOTE:  
 To Be Sheet Asphalt Paving, 1 1/2" Wearing Surface,  
 1 1/2" Binder, on an 8" Cement Concrete Base.  
 Two 2" Inches of Stone Dust Screenings Will Be  
 Required. Underdrains Will Not Be Required.

CITY OF BALTIMORE  
 DEPARTMENT OF PUBLIC WORKS  
 BUREAU OF HIGHWAYS  
 PLAN OF  
 FRANKFORD AVE. - SE AVE. TO BELAIR RD.  
 CON. NO. 842  
 SCALE - 1" = 200'  
 BOOK NO. X-225  
 APRIL 11, 1947

APPROVED: *Henry Weisberg*  
 ASSOCIATE ENGINEER

APPROVED: *James A. ...*  
 HIGHWAYS ENGINEER

APPROVED: *Edward ...*  
 ENGR.-PLANS & SURVEYS

APPROVED: *Walter ...*  
 CHIEF ENGINEER

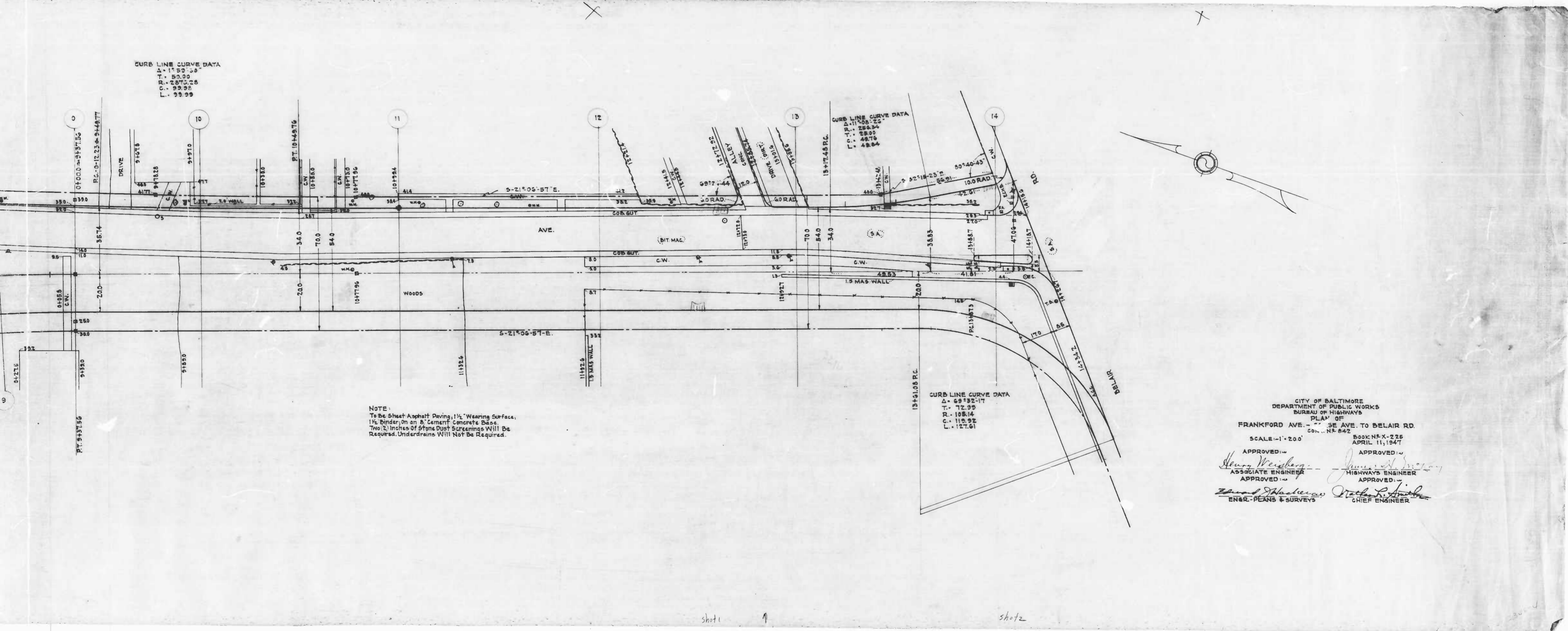

Sheet 1

Sheet 2



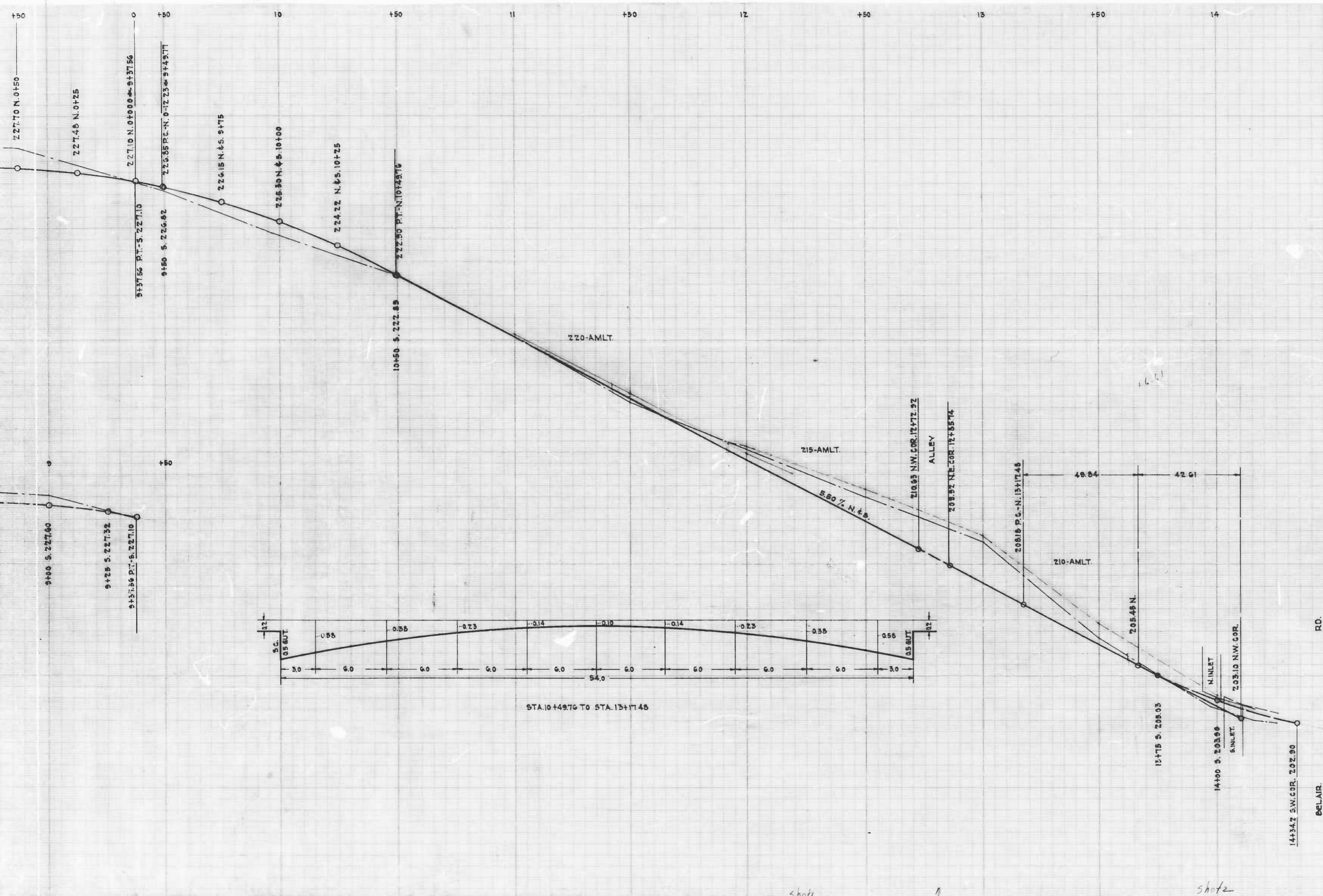

CITY OF BALTIMORE  
 DEPARTMENT OF PUBLIC WORKS  
 BUREAU OF HIGHWAYS  
 PROFILE OF  
 FRANKFORD AVE. - CORSE AVE. TO BELAIR RD.  
 CONT. N.F. 842

SCALE: HOR. 1" = 200'      BOOK N.A.-225  
 VER. 1" = 20'                APRIL 16, 1947

APPROVED: *Henry Weisberg*      APPROVED: *James A. de Gay*  
 ASSOCIATE ENGINEER      HIGHWAYS ENGINEER

APPROVED: *Edward S. Macdonald*      APPROVED: *Arthur R. Smith*  
 ENGINEER IN CHARGE      CHIEF ENGINEER

*City Surveyors grade and*

*shot*

*shot*



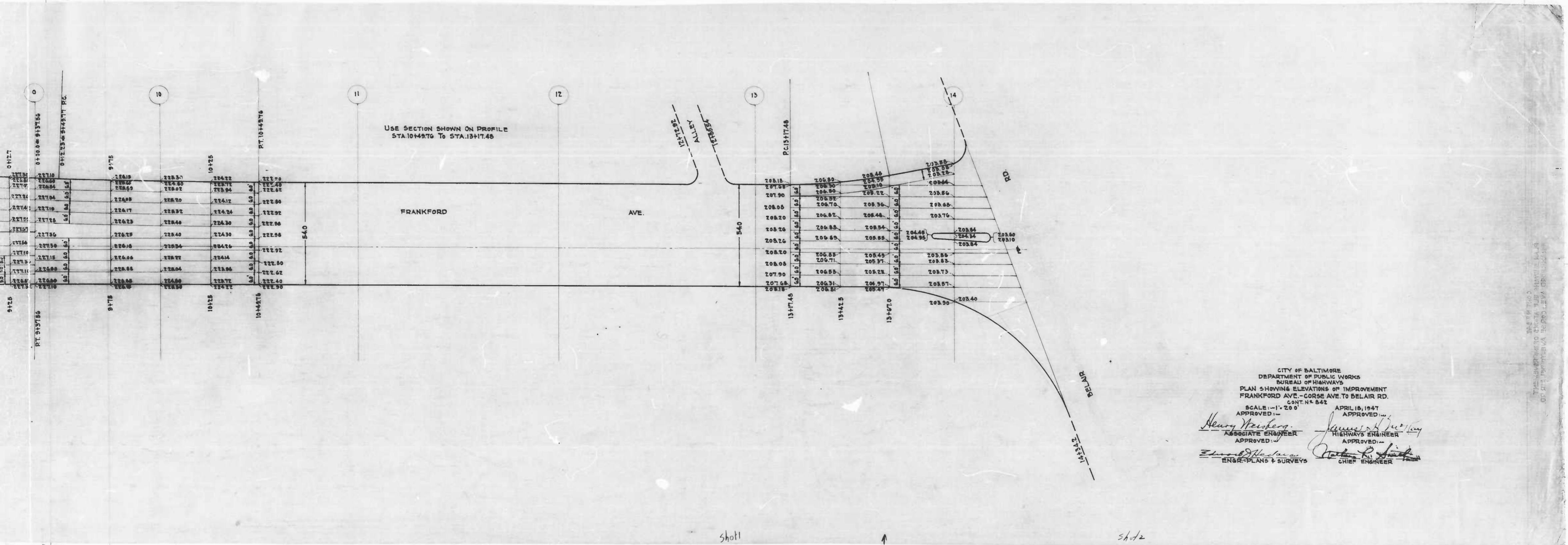

CITY OF BALTIMORE  
DEPARTMENT OF PUBLIC WORKS  
BUREAU OF HIGHWAYS  
PLAN SHOWING ELEVATIONS OF IMPROVEMENT  
FRANKFORD AVE. - CORSE AVE. TO BELAIR RD.  
CONT. N. 842  
SCALE: 1" = 20' APRIL 18, 1947

Henry Weisberg  
ASSOCIATE ENGINEER  
APPROVED

James H. Sullivan  
HIGHWAYS ENGINEER  
APPROVED

Edmond J. McManus  
ENGR. PLANS & SURVEYS

Robert R. Smith  
CHIEF ENGINEER

shot 1

shot 2



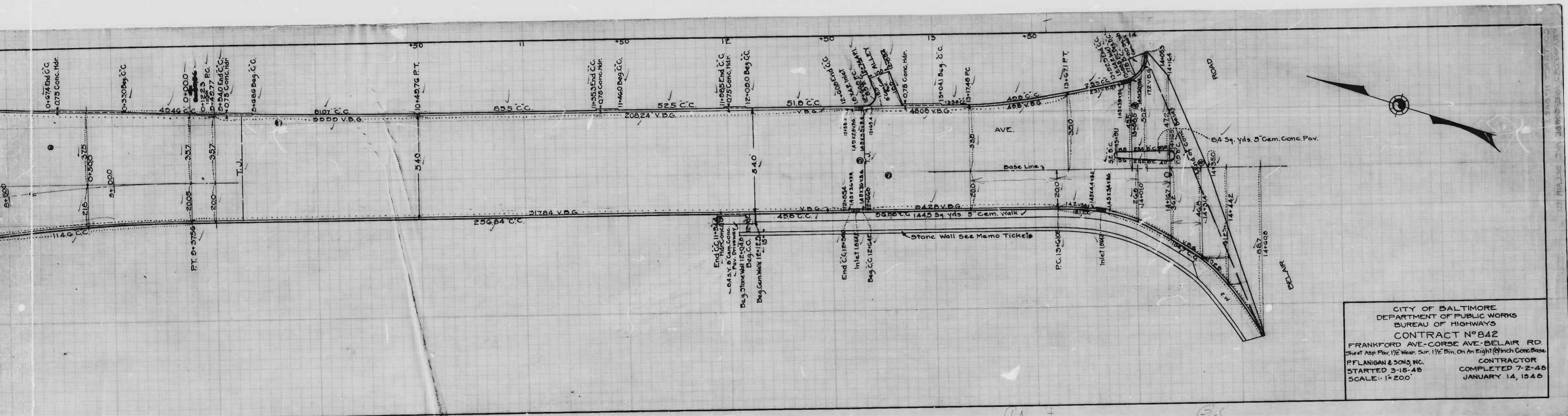

CITY OF BALTIMORE  
 DEPARTMENT OF PUBLIC WORKS  
 BUREAU OF HIGHWAYS  
 CONTRACT NO. 842  
 FRANKFORD AVE.-CORSE AVE.-BELAIR RD.  
 Sheet Asp Pav, 1/2" Wear Sur, 1 1/2" Bm, On An Eight (8) Inch Conc. Base  
 PFLANIGAN & SONS, INC. CONTRACTOR  
 STARTED 3-15-45 COMPLETED 7-2-45  
 SCALE: 1"=200' JANUARY 14, 1946