

NOTE - THE ISSUANCE OF THIS PLAN DOES NOT COMMIT THE CITY TO THE ACCEPTANCE AND/OR IMPROVEMENT OF ANY THOROUGHFARE SHOWN THEREON.

NOTE - TO BE CEMENT CONCRETE PAVING SEVEN (7) INCHES THICK. NO SOIL STABILIZATION MATERIALS OR UNDERDRAIN ARE REQUIRED.

D. Miller
 S. E. Burnett
 ENGINEER - PLANS

DEPART
 LYNVIEW AVE
 NEWBERN AVE
 FAIRLAWN AVE

BOOK - C-658

APPROVED -
Henry Miller
 ASSOCIATE ENGINEER

APPROVED -
Edward J. Hill
 ENGINEER - PLANS

shot

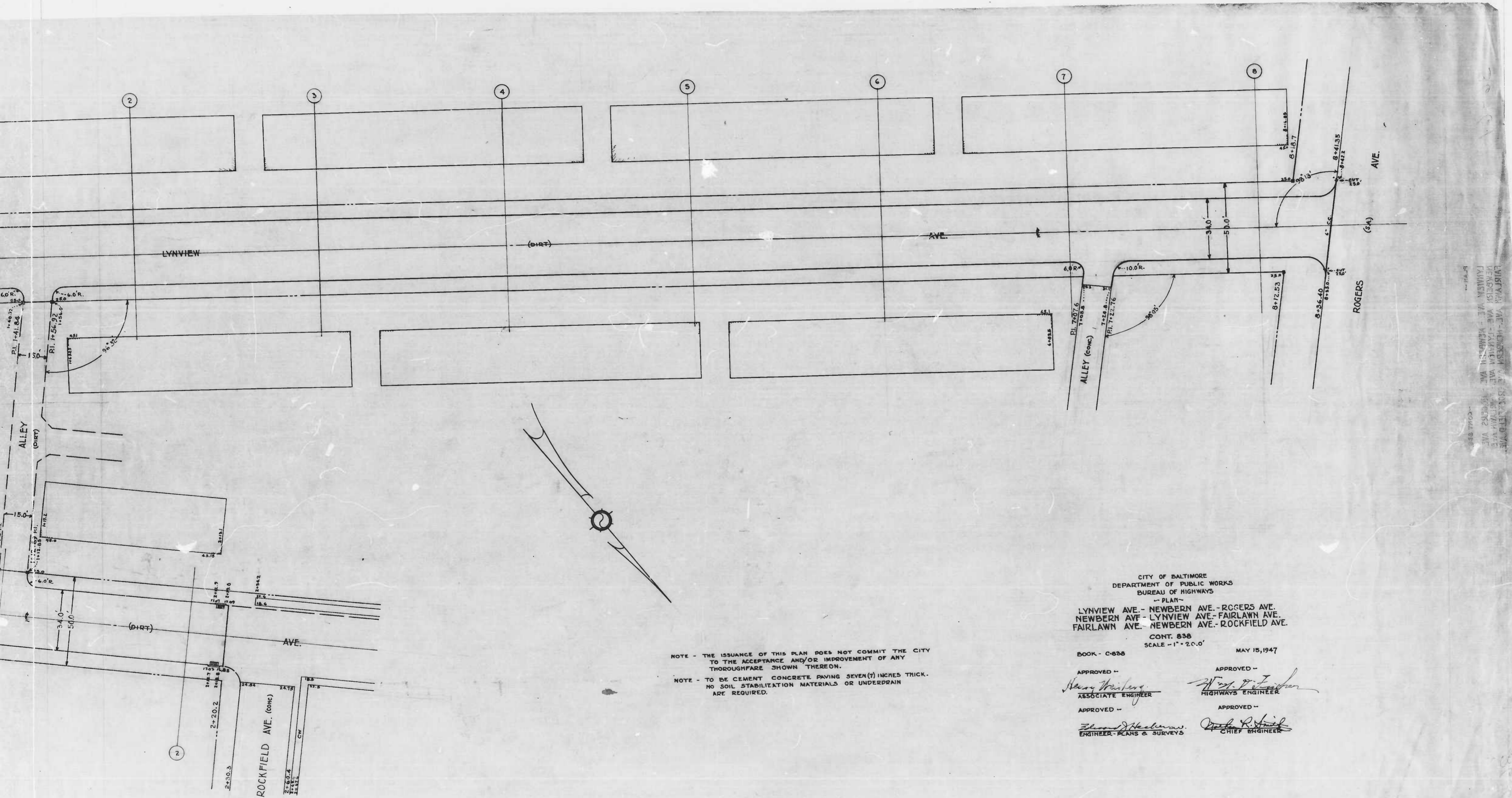

NOTE - THE ISSUANCE OF THIS PLAN DOES NOT COMMIT THE CITY TO THE ACCEPTANCE AND/OR IMPROVEMENT OF ANY THOROUGHFARE SHOWN THEREON.

NOTE - TO BE CEMENT CONCRETE PAVING SEVEN (7) INCHES THICK. NO SOIL STABILIZATION MATERIALS OR UNDERDRAIN ARE REQUIRED.

CITY OF BALTIMORE
 DEPARTMENT OF PUBLIC WORKS
 BUREAU OF HIGHWAYS
 -- PLAN --
 LYNVIEW AVE. - NEWBERN AVE. - ROGERS AVE.
 NEWBERN AVE. - LYNVIEW AVE. - FAIRLAWN AVE.
 FAIRLAWN AVE. - NEWBERN AVE. - ROCKFIELD AVE.
 CONT. 838
 SCALE - 1" = 20.0'

BOOK - C-636
 MAY 15, 1947

APPROVED - *Henry Weisberg*
 ASSOCIATE ENGINEER

APPROVED - *Wm. J. Fisher*
 HIGHWAYS ENGINEER

APPROVED - *Edward J. Heston*
 ENGINEER - PLANS & SURVEYS

APPROVED - *Charles R. Smith*
 CHIEF ENGINEER

1 shot

2 shot

LYNVIEW AVE. - NEWBERN AVE. - ROGERS AVE.
 NEWBERN AVE. - LYNVIEW AVE. - FAIRLAWN AVE.
 FAIRLAWN AVE. - NEWBERN AVE. - ROCKFIELD AVE.
 CONT. 838

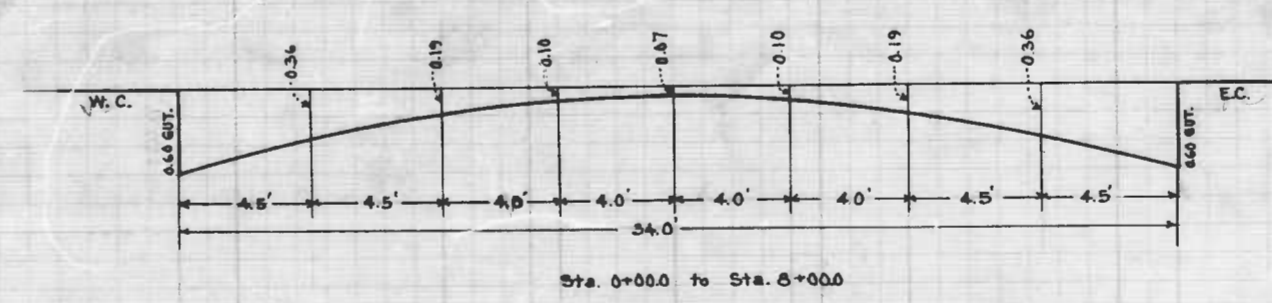
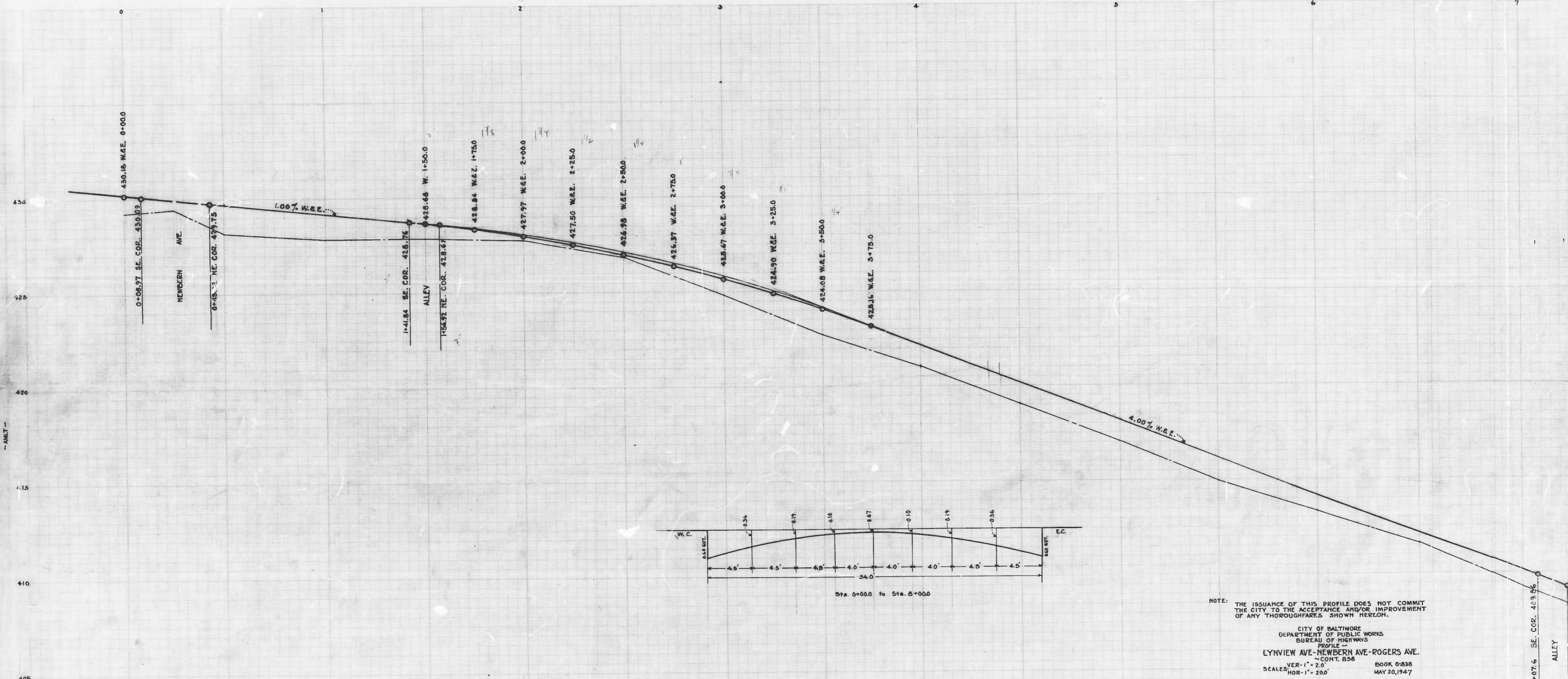

NOTE: THE ISSUANCE OF THIS PROFILE DOES NOT COMMIT THE CITY TO THE ACCEPTANCE AND/OR IMPROVEMENT OF ANY THOROUGHFARES SHOWN HEREON.

CITY OF BALTIMORE
DEPARTMENT OF PUBLIC WORKS
BUREAU OF HIGHWAYS
PROFILE
LYNVIEW AVE-NEWBERN AVE-ROGERS AVE.
~CONT. 838
SCALE: VER-1"=2.0' HOR-1"=200'

BOOK 0-838
MAY 20, 1947

APPROVED: *W. A. P. Fisher*
ASSOCIATE ENGINEER HIGHWAYS ENGINEER

APPROVED: *Edmond H. ...*
ENGR.-PLANS & SURVEYS CHIEF ENGINEER

Drawn by *Smith*
S. F. Burns
EXAMINED BY
ENGR. IN CHARGE OF DRAWING

7+07.6 SE. COR. 409.96
ALLEY
7+22.76 NE. COR. 409.75

Shot

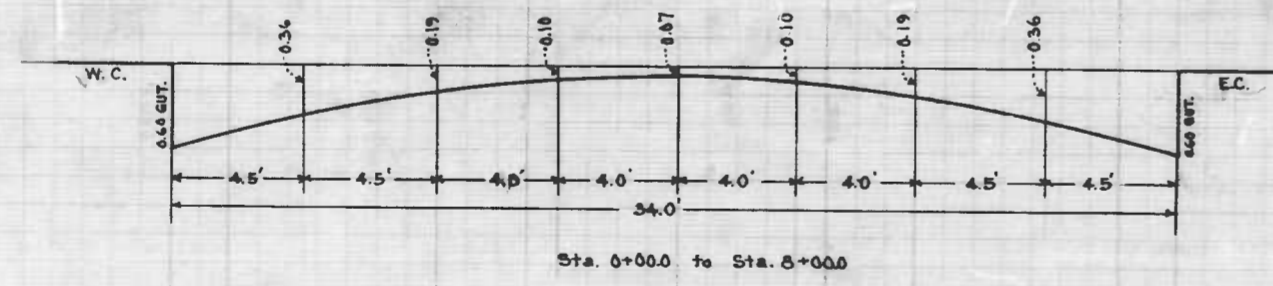
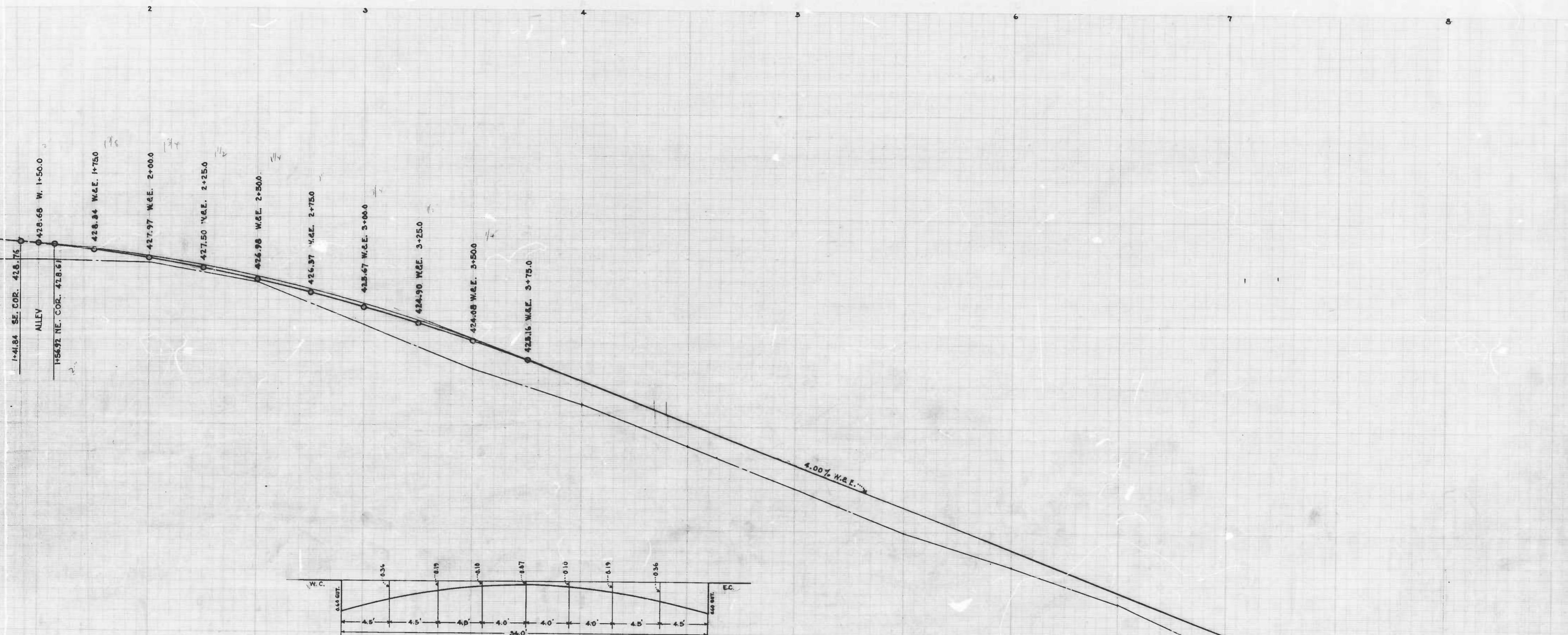

NOTE: THE ISSUANCE OF THIS PROFILE DOES NOT COMMIT THE CITY TO THE ACCEPTANCE AND/OR IMPROVEMENT OF ANY THOROUGHFARES SHOWN HEREON.

CITY OF BALTIMORE
 DEPARTMENT OF PUBLIC WORKS
 BUREAU OF HIGHWAYS
 PROFILE
 LYNVIEW AVE-NEWBERN AVE-ROGERS AVE.
 CONT. 838
 VER. 1" = 2.0' BOOK 0-838
 HOR. 1" = 200' MAY 20, 1947

APPROVED: *Henry Weisberg* ASSOCIATE ENGINEER
 APPROVED: *W. J. P. Fisher* HIGHWAYS ENGINEER
 APPROVED: *Edward J. [Signature]* ENGR.-PLANS & SURVEYS
 APPROVED: *[Signature]* CHIEF ENGINEER

Shot 1

Shot 2

322105
 R. H. [Signature]
 CIVIL ENGINEER

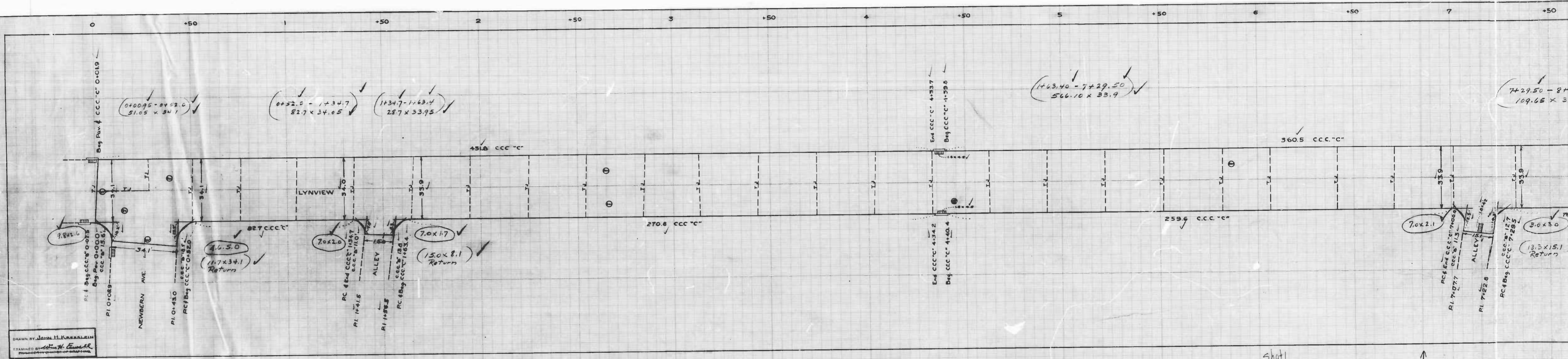

DRAWN BY JOHN H. KARALEIN
 EXAMINED BY [Signature]

Shot1

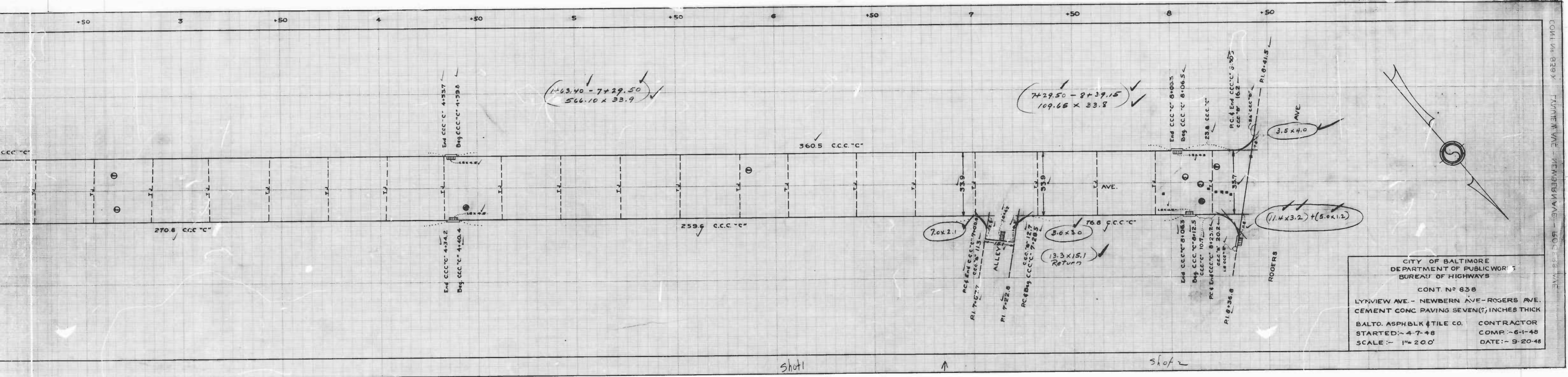

CITY OF BALTIMORE
 DEPARTMENT OF PUBLIC WORKS
 BUREAU OF HIGHWAYS

CONT. NO. 838

LYNVIEW AVE. - NEWBERN AVE - ROGERS AVE.
 CEMENT CONC PAVING SEVEN (7) INCHES THICK

BALTO. ASPHBLK & TILE CO. CONTRACTOR
 STARTED: - 4-7-48 COMP: - 6-1-48
 SCALE: - 1" = 20.0' DATE: - 9-20-48

CONT. NO. 838 X LYNVIEW AVE - NEWBERN AVE - ROGERS AVE

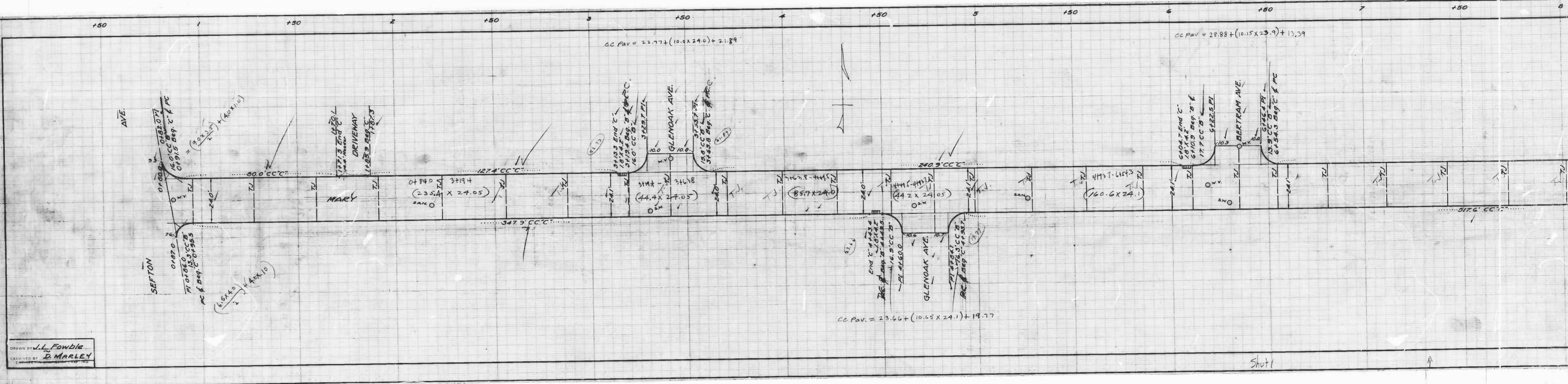

DRAWN BY J.L. Fowble
EXAMINED BY D. MARLEY

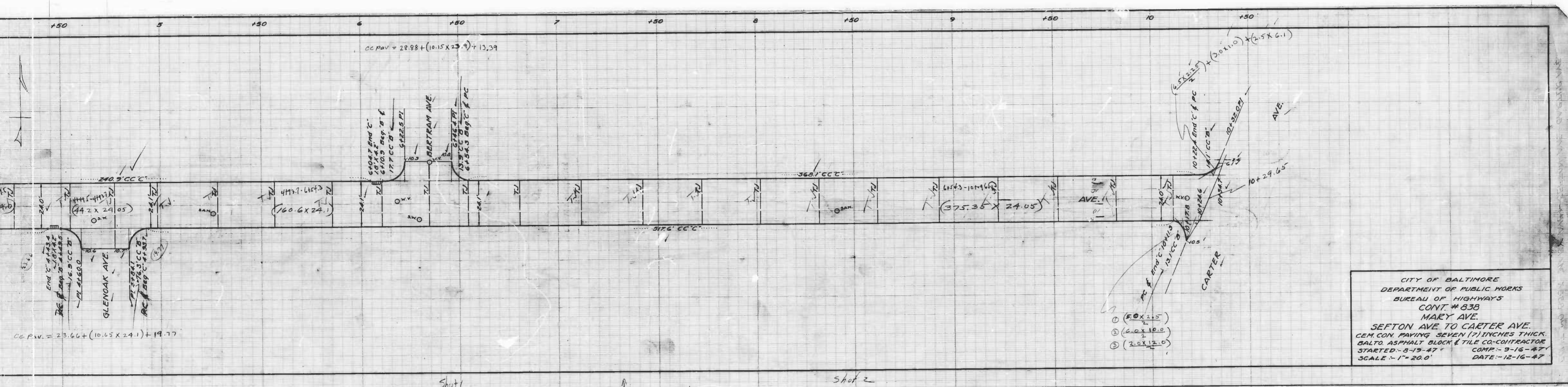

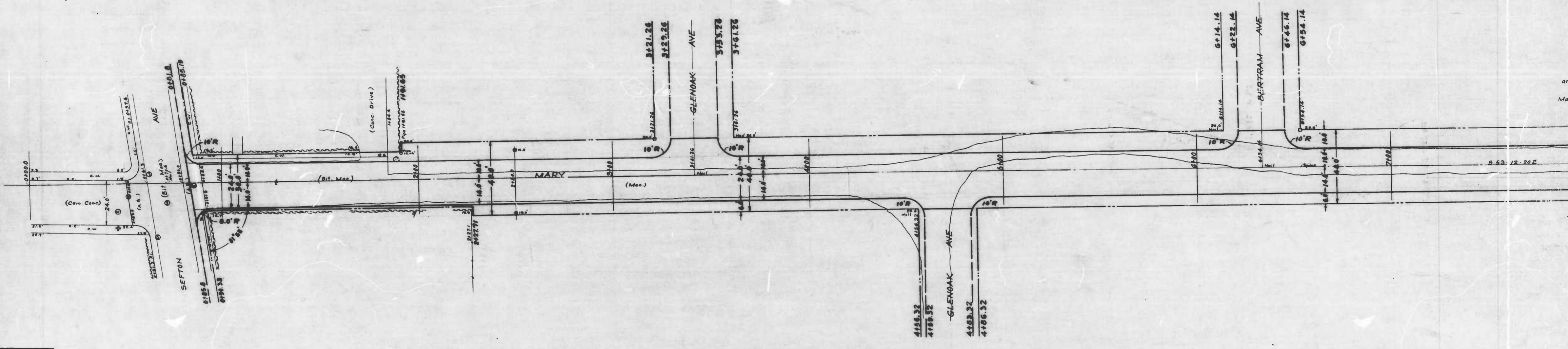

DRAWN BY *Wm. H. Gower*
 EXAMINED BY *[Signature]*
 ENGINEER IN CHARGE OF DISTRICT

Shot

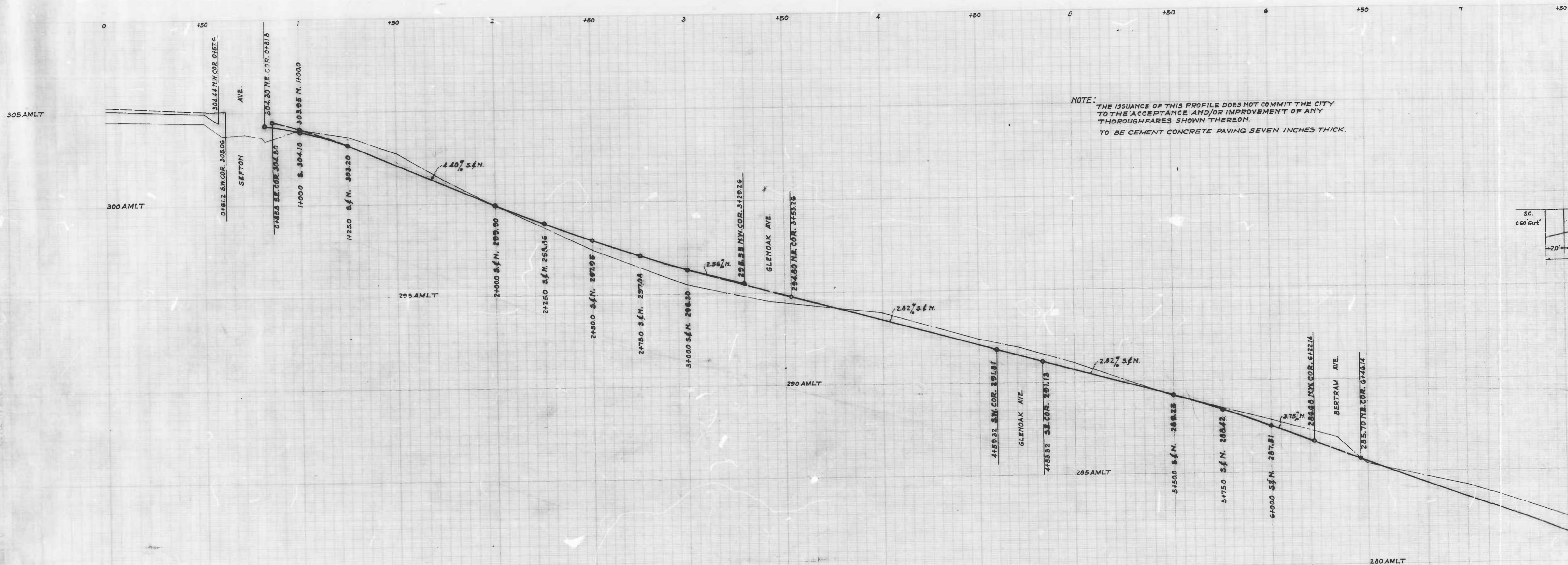

NOTE:
 THE ISSUANCE OF THIS PROFILE DOES NOT COMMIT THE CITY
 TO THE ACCEPTANCE AND/OR IMPROVEMENT OF ANY
 THOROUGHFARES SHOWN THEREON.
 TO BE CEMENT CONCRETE PAVING SEVEN INCHES THICK.

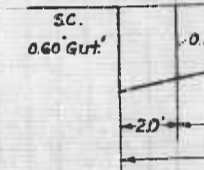

D. Marley
 S. J. Burns

Sheet

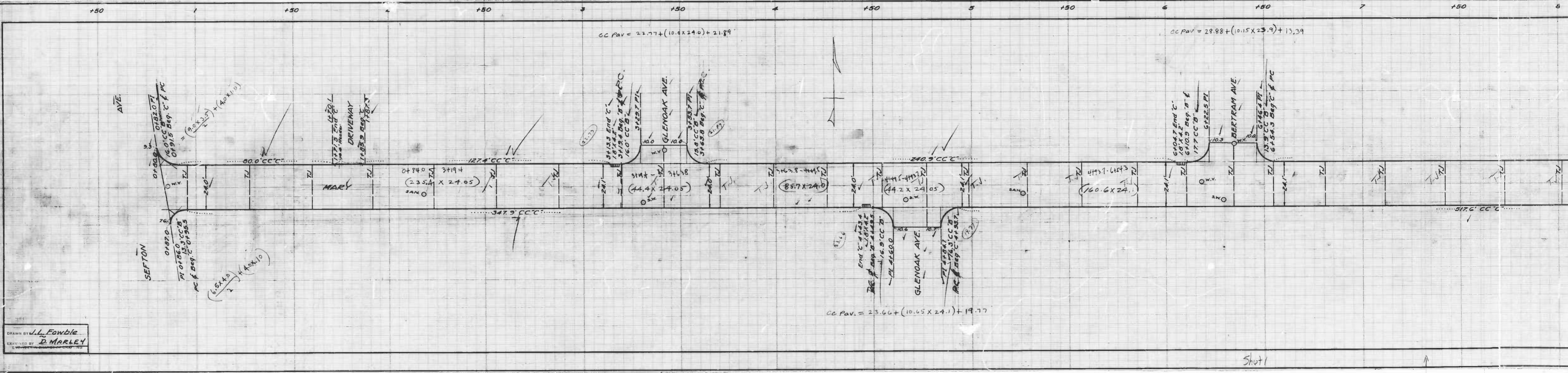

Drawn by J.L. Fowble
 Checked by D. Marley

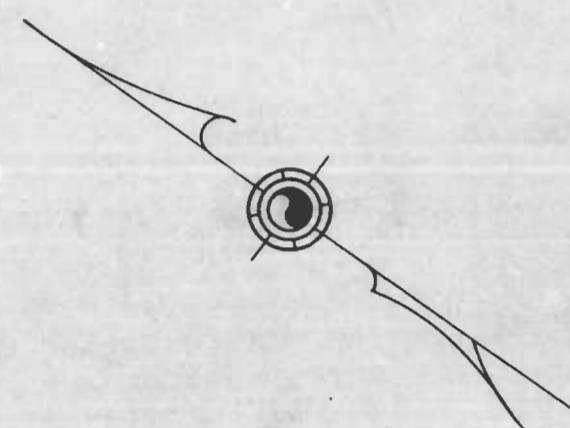
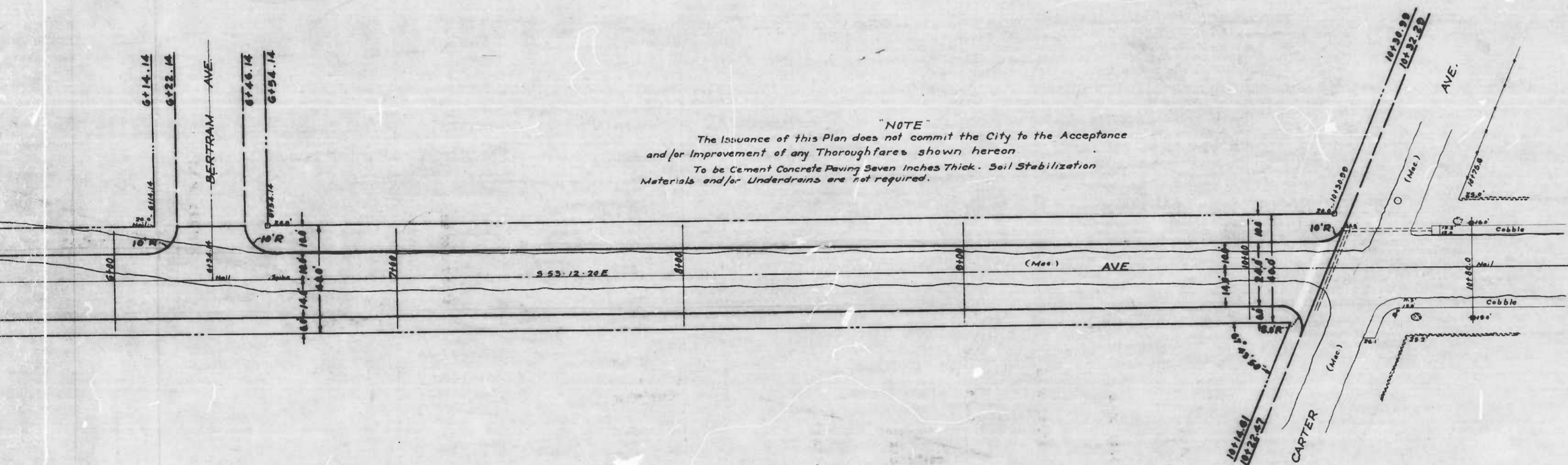

CITY OF BALTIMORE
 DEPARTMENT OF PUBLIC WORKS
 BUREAU OF HIGHWAYS
 PLAN OF
 MARY AVE - SEFTON AVE - CARTER AVE.
 SCALE: 1" = 20.0' BOOK NO. X-191
 CONT. NO. 838 DATE: APR. 14, 1947

APPROVED APPROVED
Henry Weisberg *R. D. Fisher*
 ASSOCIATE ENGINEER HIGHWAYS ENGINEER
 APPROVED APPROVED
Edward J. Smith *Nathan R. Smith*
 ENGR. PLANS & SURVEYS CHIEF ENGINEER

Shot 1

Shot 2

+50 6 +50 7 +50 8 +50 9 +50 10

NOTE: THE ISSUANCE OF THIS PROFILE DOES NOT COMMIT THE CITY TO THE ACCEPTANCE AND/OR IMPROVEMENT OF ANY THOROUGHFARES SHOWN THEREON. TO BE CEMENT CONCRETE PAVING SEVEN INCHES THICK.

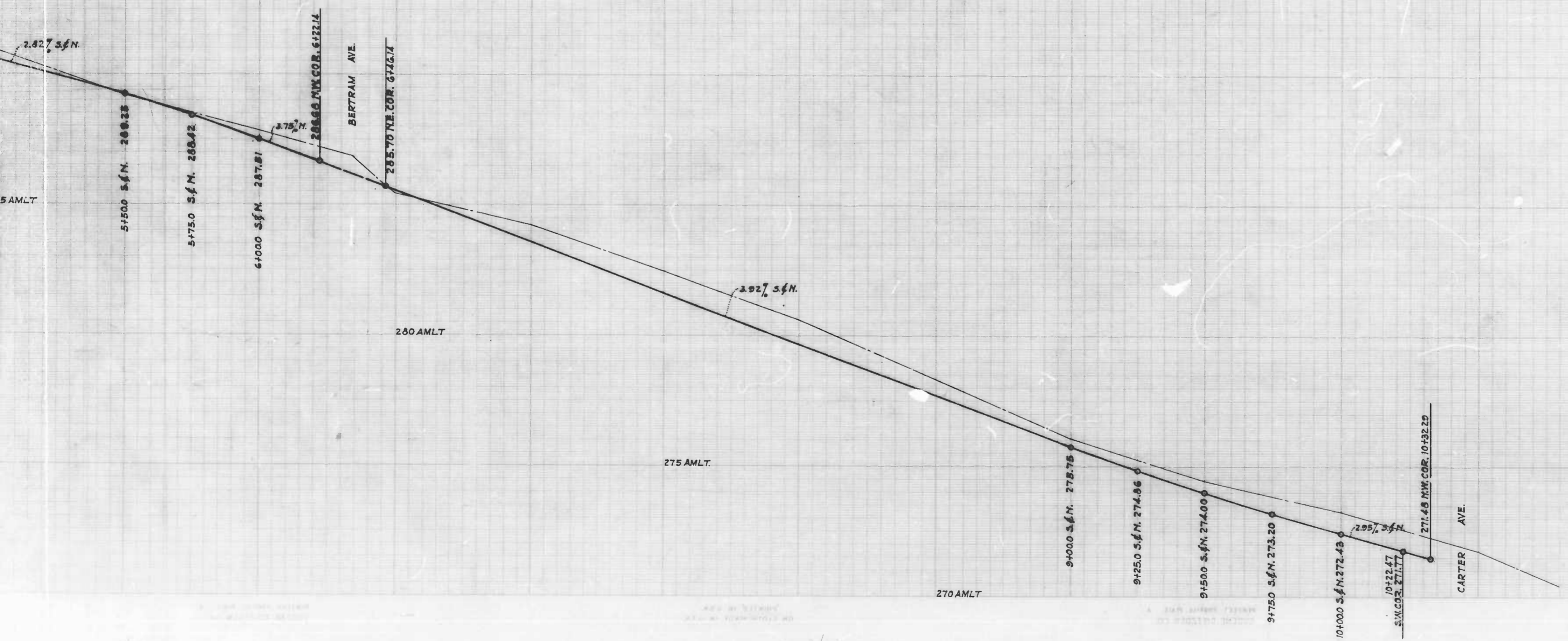
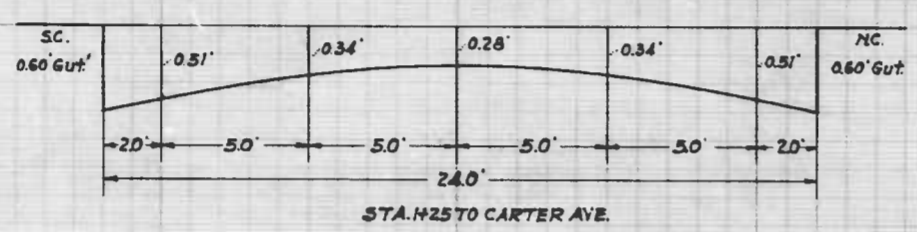

CITY OF BALTIMORE
 DEPARTMENT OF PUBLIC WORKS
 BUREAU OF HIGHWAYS
 PROFILE OF
 MARY AVE. - SEFTON AVE. TO CARTER AVE.
 HOR. SCALE: 1" = 200'
 VER. SCALE: 1" = 2.0'
 BOOK NO. X-191
 DATE: APR. 21, 1947

APPROVED: *Henry Weisberg*
 ASSOCIATE ENGINEER.

APPROVED: *W. H. Fisher*
 HIGHWAYS ENGINEER

APPROVED: *Walter R. Smith*
 ENGR. PLANS & SURVEYS

APPROVED: *Walter R. Smith*
 CHIEF ENGINEER.

shot

shot 2

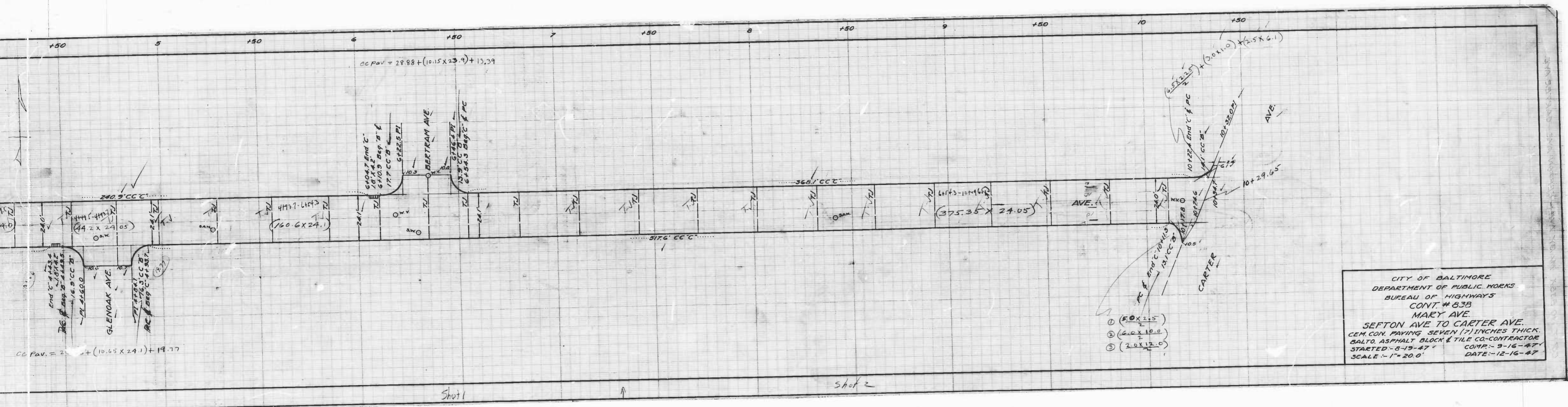

- ① (5.0 X 2.15)
- ② (6.0 X 10.0)
- ③ (2.0 X 12.0)

CITY OF BALTIMORE
 DEPARTMENT OF PUBLIC WORKS
 BUREAU OF HIGHWAYS
 CONT. # 838
 MARY AVE.
 SEFTON AVE TO CARTER AVE.
 CEM. CON. PAVING SEVEN (7) INCHES THICK.
 BALTO. ASPHALT BLOCK & TILE CO.-CONTRACTOR
 STARTED - 8-19-47 COMP. - 9-16-47
 SCALE - 1" = 20.0' DATE - 12-16-47

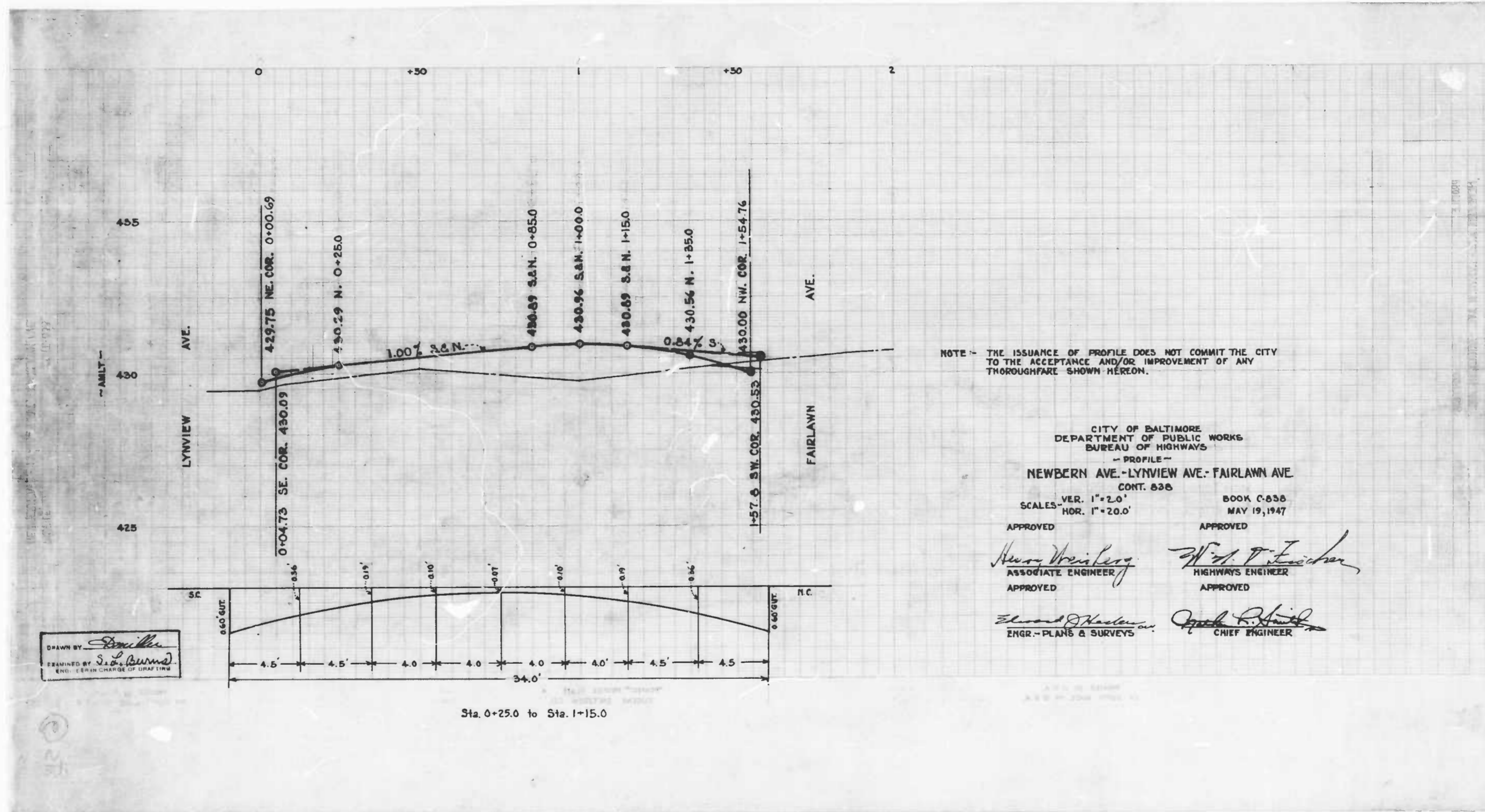

DRAWN BY *[Signature]*
 CHECKED BY *[Signature]*
 ENGR. - CIVIL - BUREAU OF SURVEYS

NOTE - THE ISSUANCE OF PROFILE DOES NOT COMMIT THE CITY TO THE ACCEPTANCE AND/OR IMPROVEMENT OF ANY THOROUGHFARE SHOWN HEREON.

CITY OF BALTIMORE
 DEPARTMENT OF PUBLIC WORKS
 BUREAU OF HIGHWAYS
 PROFILE
 NEWBERN AVE. - LYVIEW AVE. - FAIRLAWN AVE.
 CONT. 838
 SCALES VER. 1"=20.0' HOR. 1"=20.0'
 BOOK C.838
 MAY 19, 1947

APPROVED *[Signature]* ASSOCIATE ENGINEER
 APPROVED *[Signature]* HIGHWAYS ENGINEER
 APPROVED *[Signature]* ENGR. - PLANS & SURVEYS
 APPROVED *[Signature]* CHIEF ENGINEER

Sta. 0+25.0 to Sta. 1+15.0

