

834/835
836/837

3

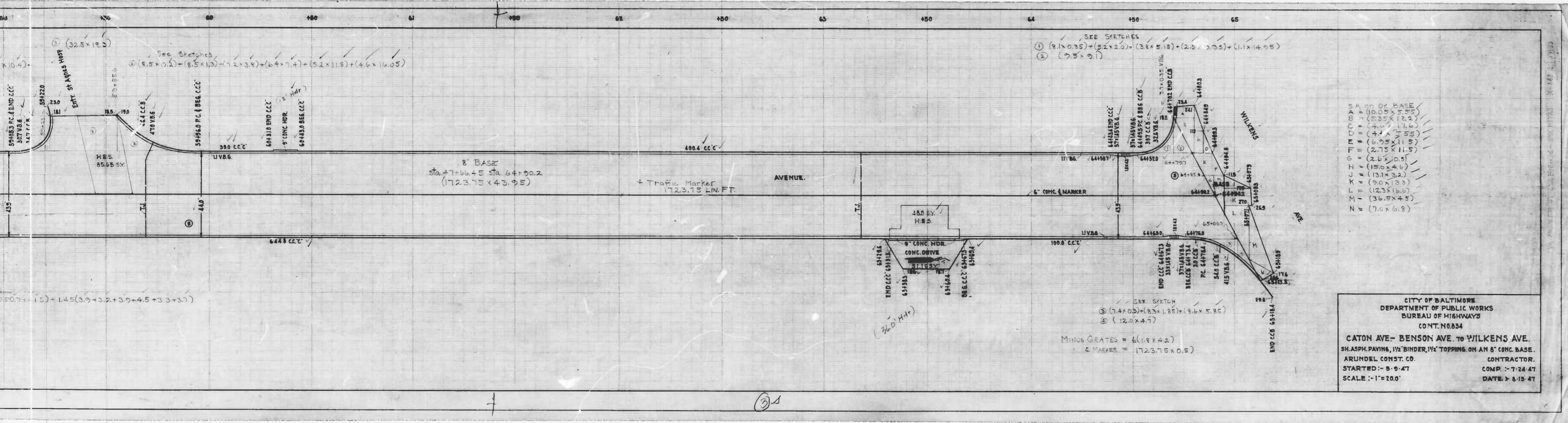

CITY OF BALTIMORE
DEPARTMENT OF PUBLIC WORKS
BUREAU OF HIGHWAYS
CONT. NO. 834

CATON AVE- BENSON AVE. TO WILKENS AVE.
SH. ASPH. PAVING, 1/2\"/>

ARUNDEL CONST. CO. CONTRACTOR
STARTED - 8-9-47
SCALE - 1\"/>

DATE - 8-15-47

834/835
836/837

3

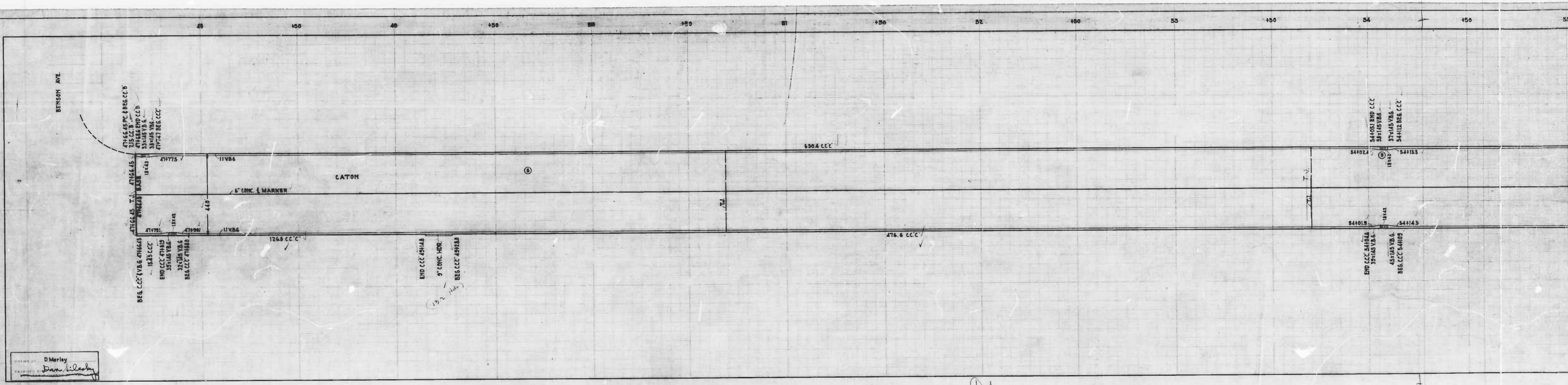

834/835
836/837

5

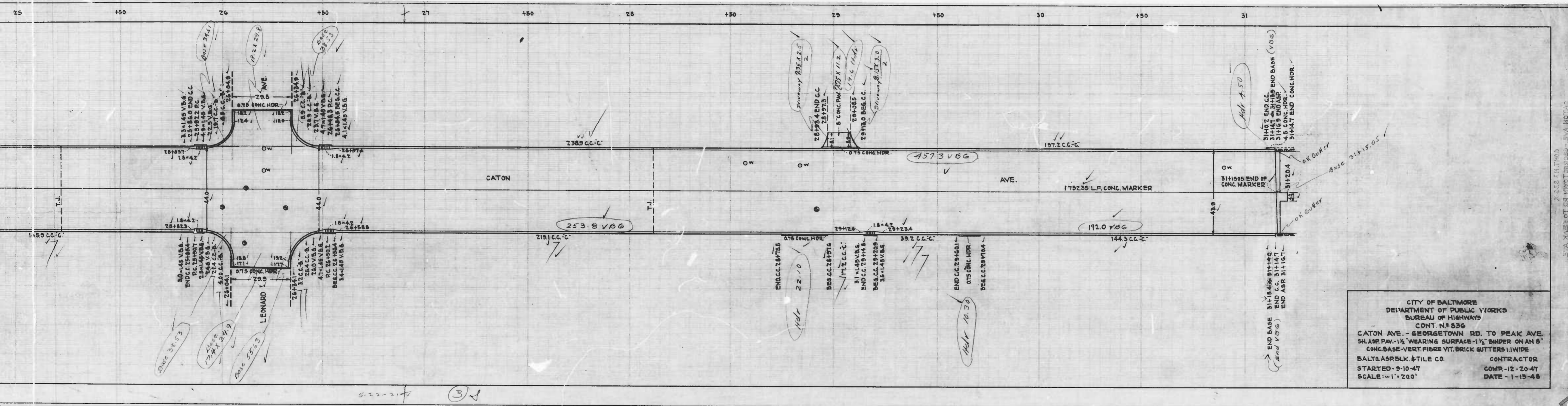

CITY OF BALTIMORE
DEPARTMENT OF PUBLIC WORKS
BUREAU OF HIGHWAYS
CONT. N^o 836
CATON AVE. - GEORGETOWN RD. TO PEAK AVE.
SHARP PAV. - 1 1/2" WEARING SURFACE - 1 1/2" SAND ON AN 8"
CONC. BASE - VERT. PIERRE VIT. BRICK GUTTERS 14" WIDE
BALTA ASP. BLK. & TILE CO. CONTRACTOR
STARTED - 9-10-47 COMP. - 12-20-47
SCALE: 1" = 200' DATE - 1-15-48

2-558 P.H. 7903
SVA. X. UNIT OF CON. MOUNTING - SVA. 807A

834/835
836/837

4

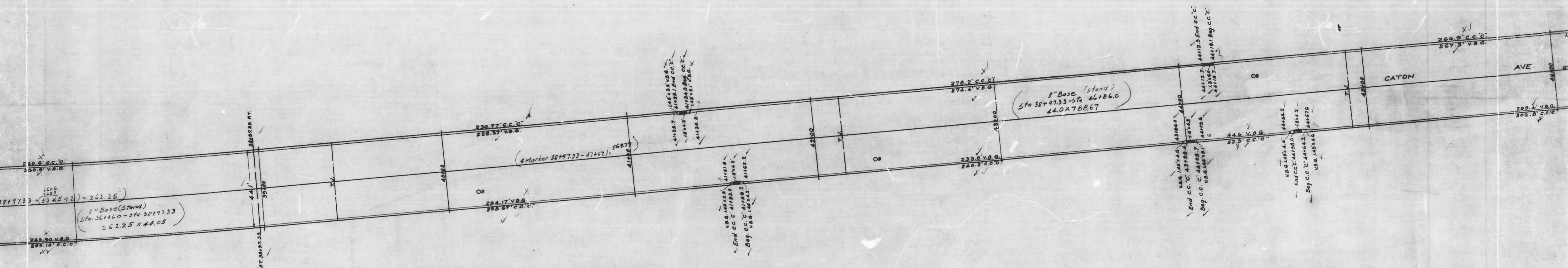

834/835
836/837

1

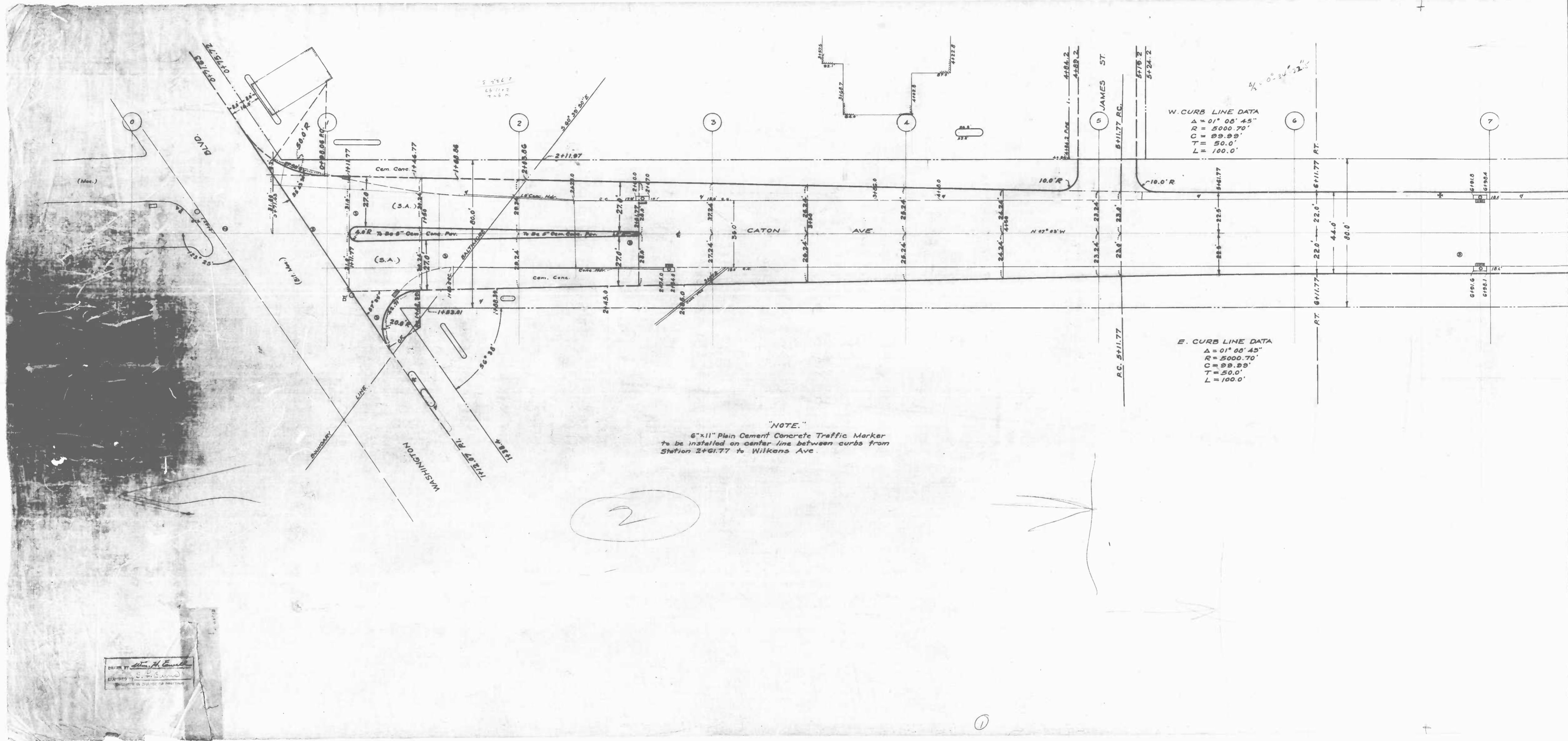

834/835
836/837

2

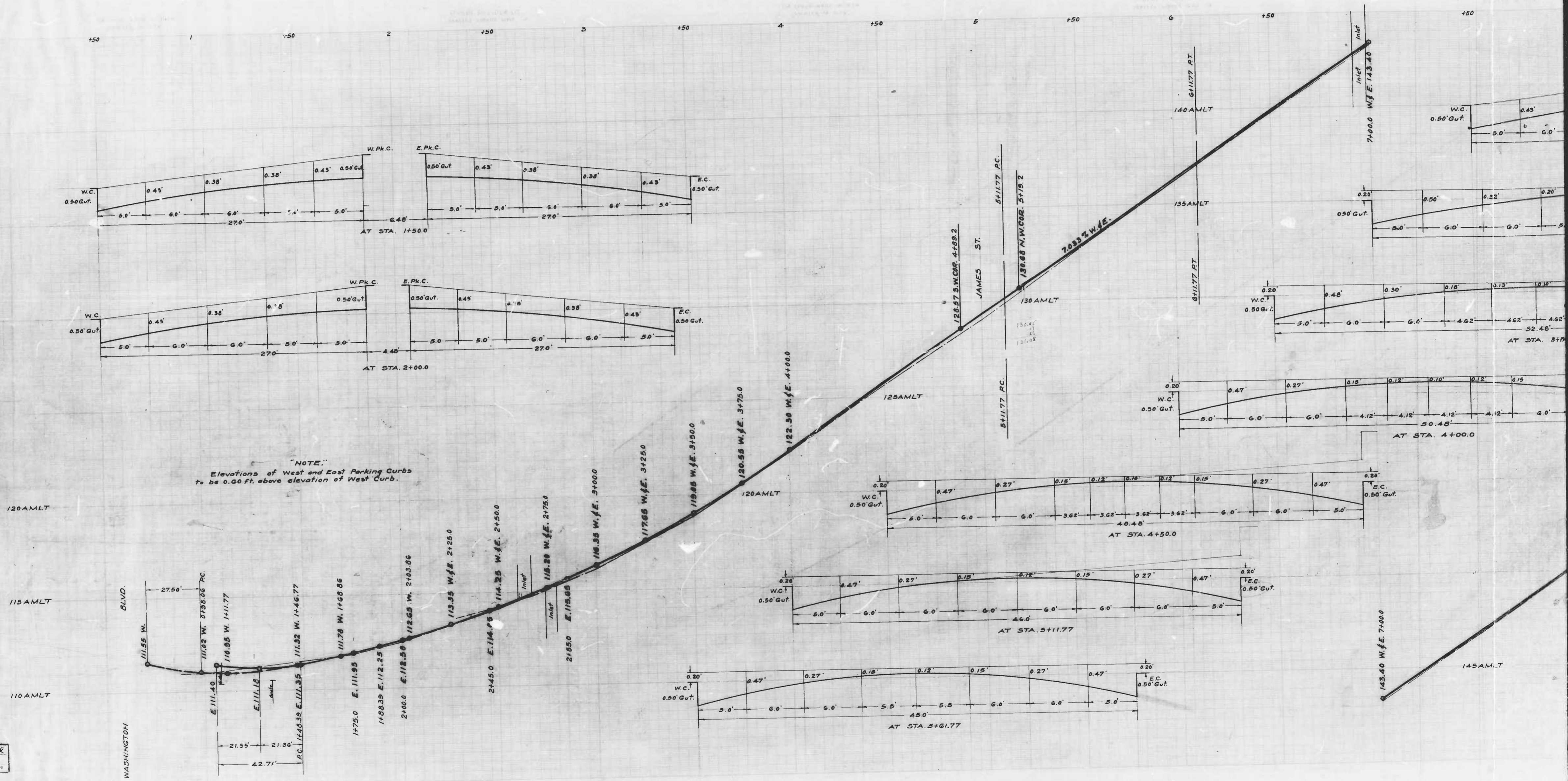

01

Wm. H. Conwell
S. E. Conroy

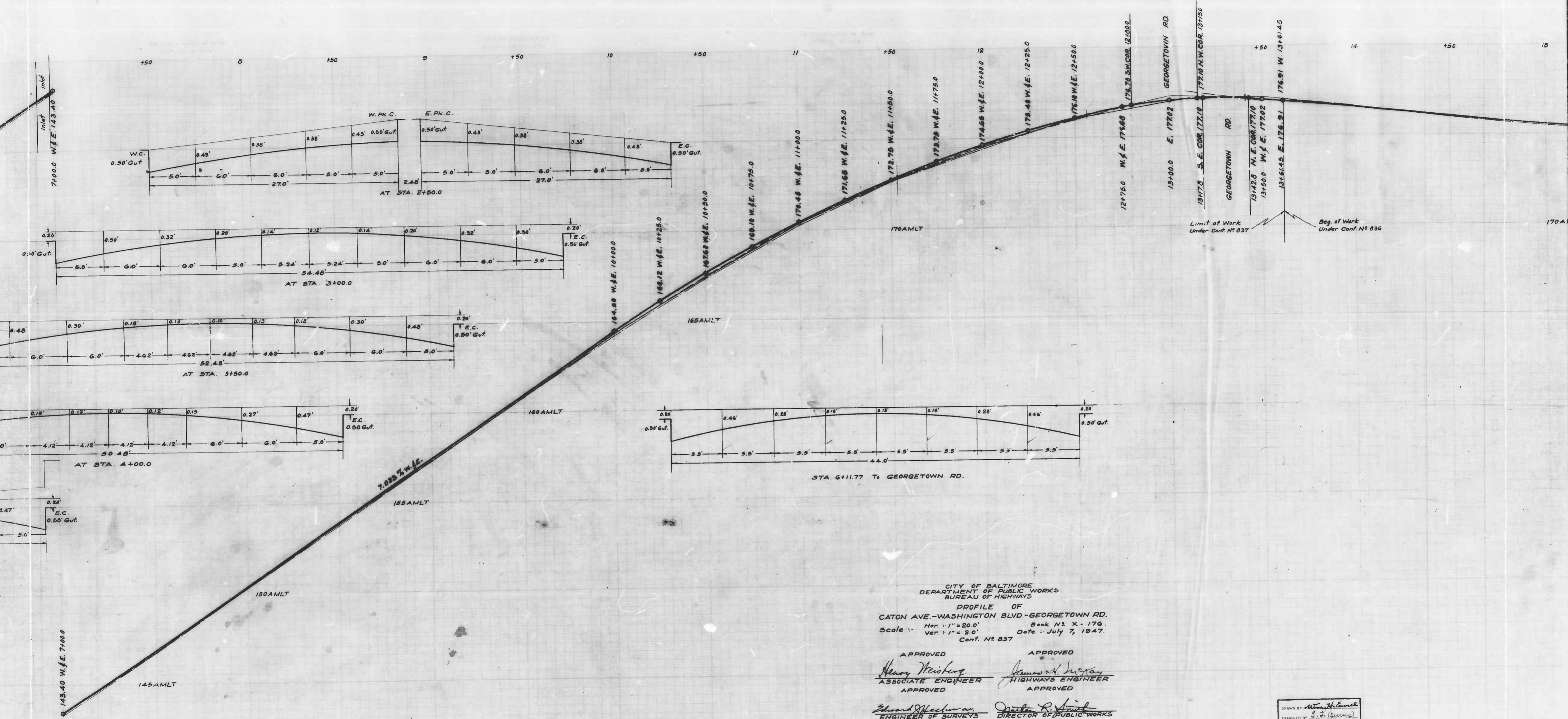

CITY OF BALTIMORE
DEPARTMENT OF PUBLIC WORKS
BUREAU OF HIGHWAYS
PROFILE OF
CATON AVE.-WASHINGTON BLVD.-GEORGETOWN RD.
Hor. 1" = 20.0' Book No. X-170.
Scale: Ver. 1" = 2.0' Date: July 7, 1947.
Cont. No. 837

APPROVED
Henry Weiskopf
ASSOCIATE ENGINEER

APPROVED
James H. Meyer
HIGHWAYS ENGINEER

APPROVED
Edward Sheehan
ENGINEER OF SURVEYS

APPROVED
William R. Smith
DIRECTOR OF PUBLIC WORKS

DRAWN BY *William H. Connel*
EXAMINED BY *S. F. [Signature]*
ENGINEER IN CHARGE OF DRAFTING

(2)

(2)

834/835
836/837

2

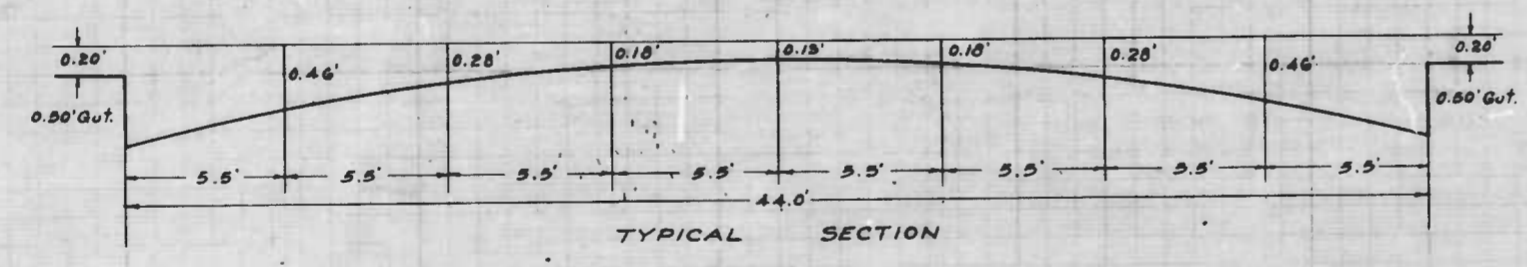
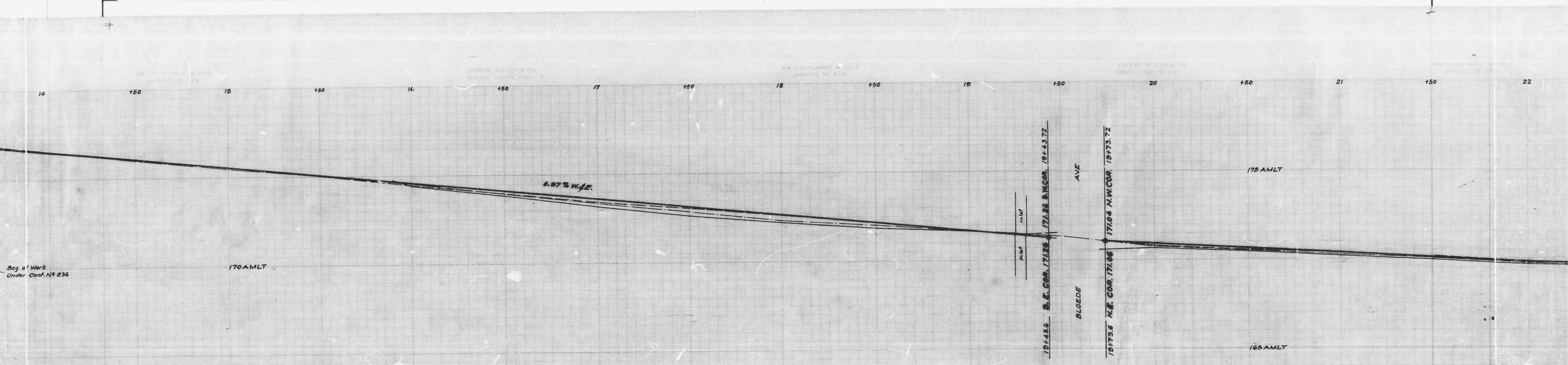

1/2" x 1/2" Jolt

31

834/835
836/837

1

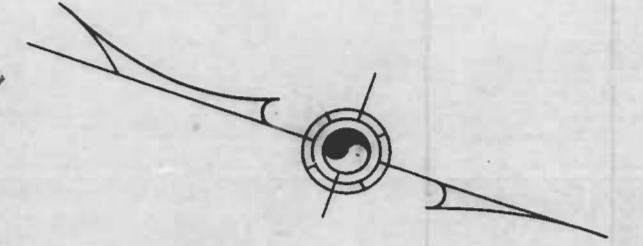

NOTE
To Be Sheet Asphalt Paving - 1 1/2" Wearing Surface, 1 1/2" Binder,
on an 8" Con. Conc. Base
Six Inches of Soil Stabilization Materials and Underdrains
are required.

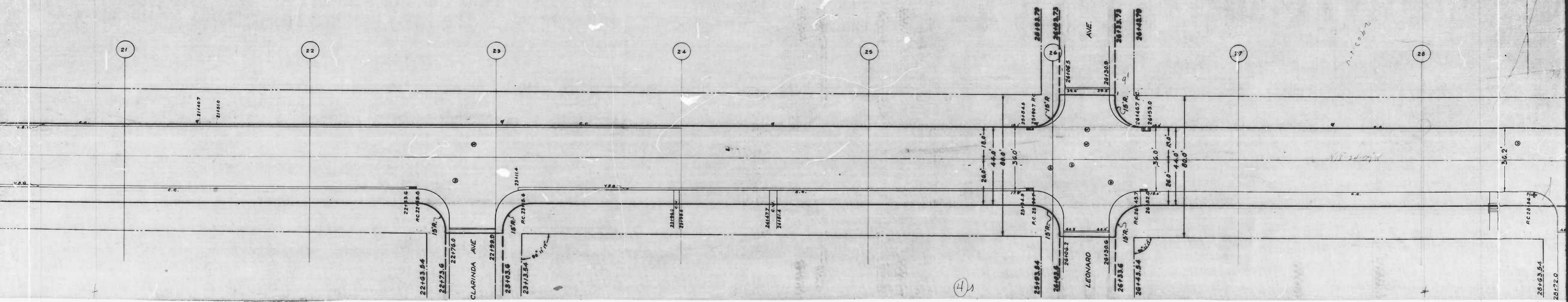

834/835
836/837

2

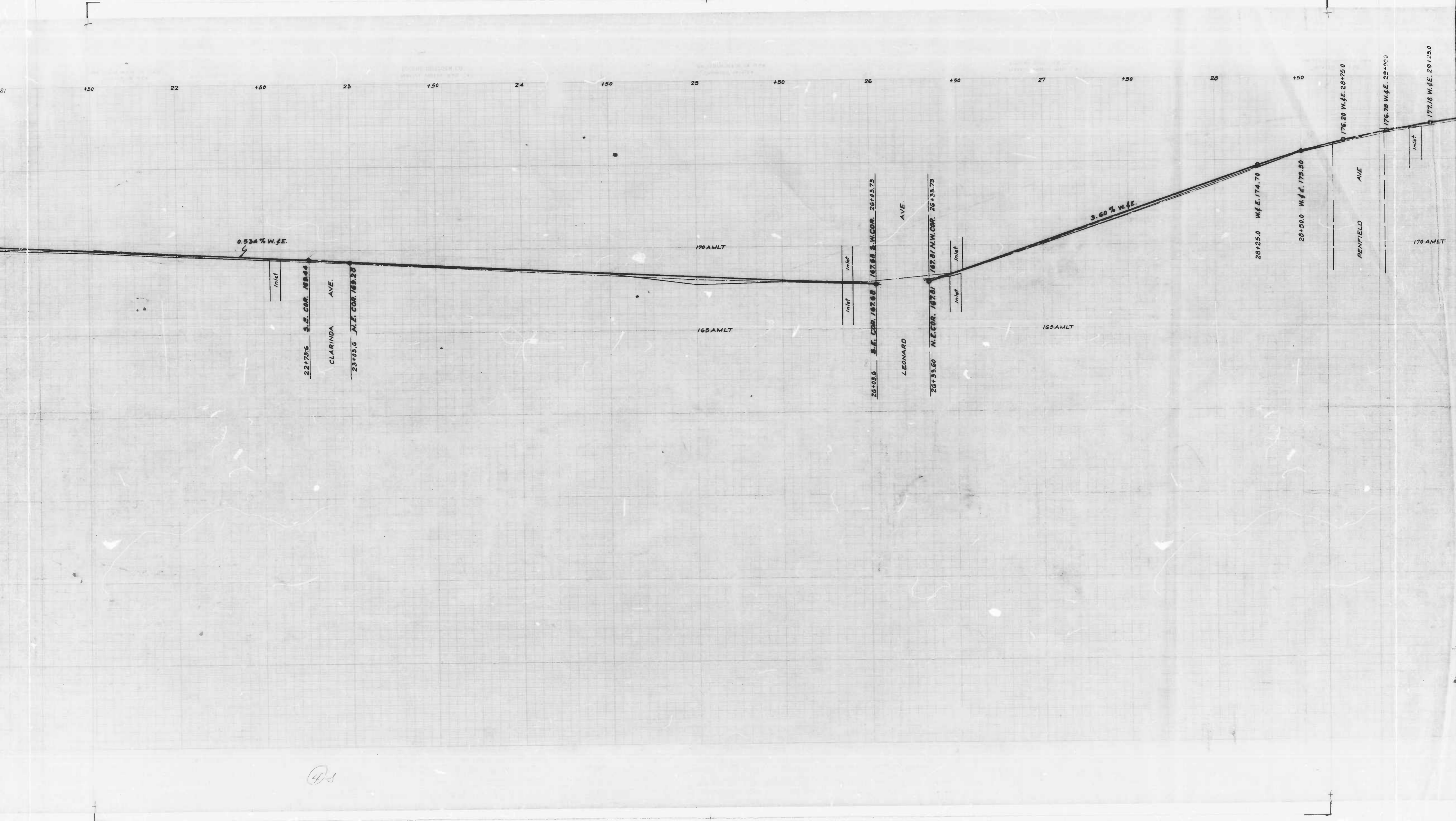

834/835
836/837

1

CITY OF BALTIMORE
DEPARTMENT OF PUBLIC WORKS
BUREAU OF HIGHWAYS
PLAN OF
CATON AVE. - GEORGETOWN RD. - PEAK AVE.
SCALE: 1" = 20.0' BOOK N° X-176 DATE: 7-2-47.
CONT. N° 336

LIMIT OF WORK UNDER CONT. N° 836
BEG. OF WORK UNDER CONT. N° 835

APPROVED
Henry Weisberg
ASSOCIATE ENGINEER

APPROVED
Samuel S. Gray
HIGHWAYS ENGINEER

APPROVED
Edward J. Healdman
ENGINEER OF SURVEYS

APPROVED
Jack P. Smith
DIRECTOR OF PUBLIC WORKS

"NOTE"
aving - 1 1/2" Wearing Surface, 1 1/2" Binder,
stabilization Materials and Underdrains

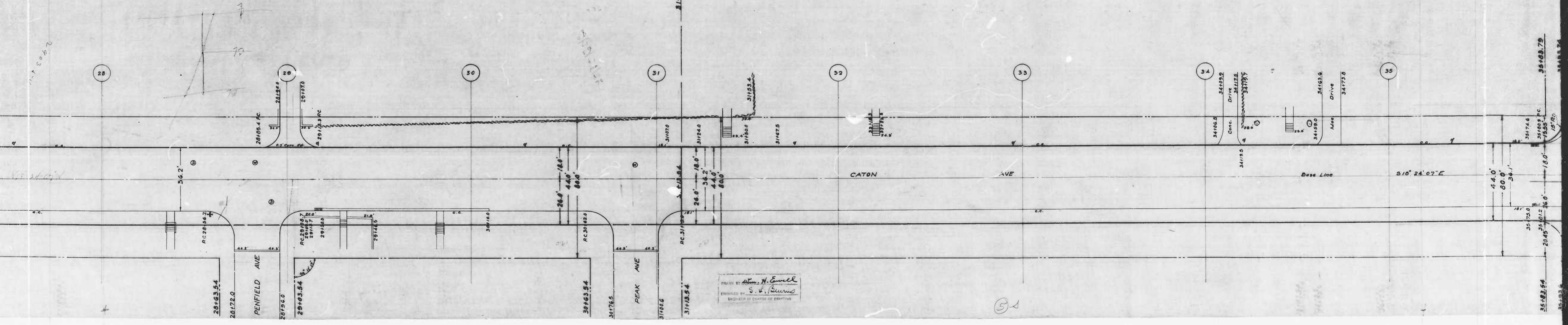

Prepared by *Wm. H. Howell*
S. J. Burns
ENGINEER IN CHARGE OF DRAWING

54

834/835
836/837

2

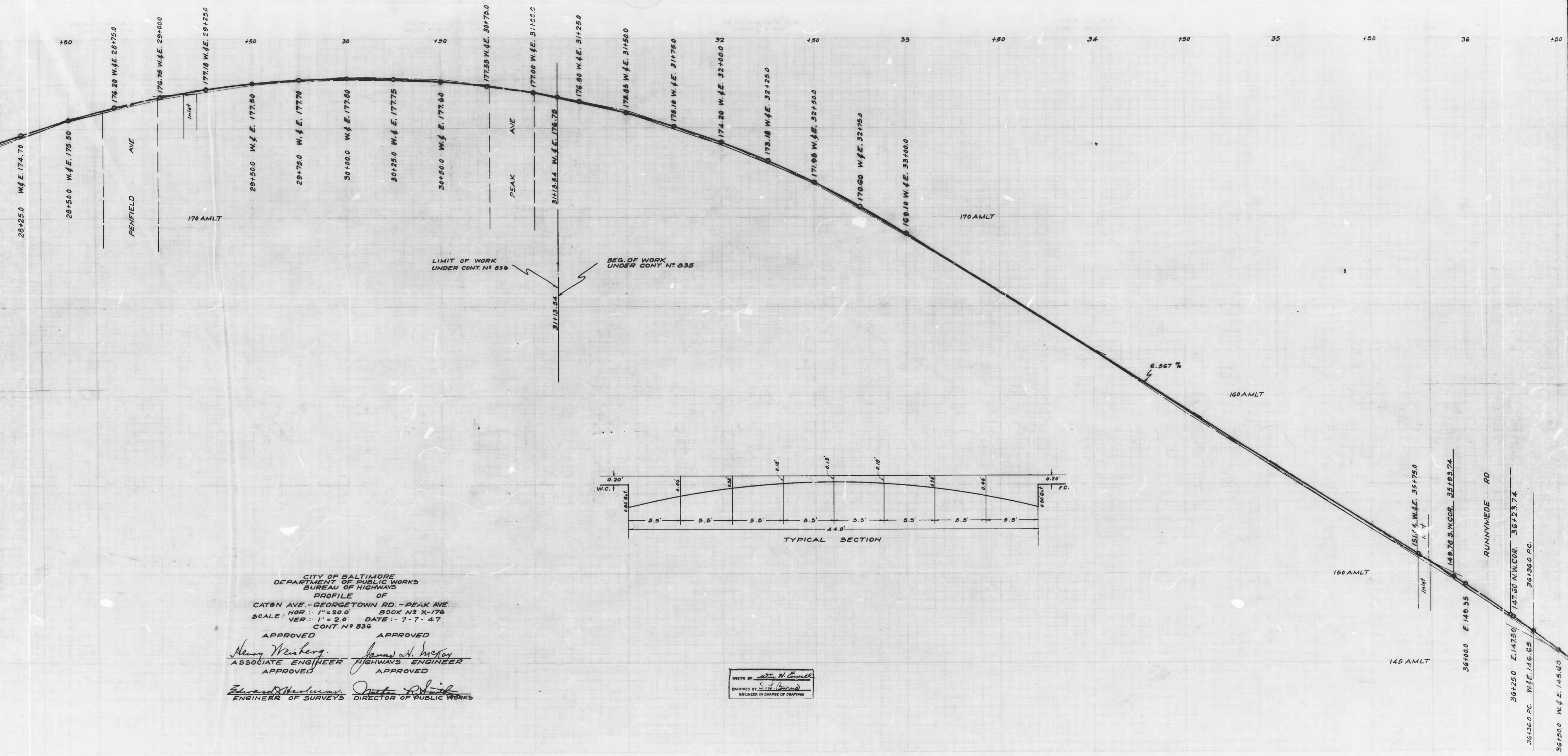

CITY OF BALTIMORE
DEPARTMENT OF PUBLIC WORKS
BUREAU OF HIGHWAYS
PROFILE OF
CATON AVE - GEORGETOWN RD. - PEAK AVE.
HOR.: 1" = 20.0' BOOK N° X-176
SCALE: VER.: 1" = 2.0' DATE: 7-7-47
CONT. N° 836

APPROVED *Henry Weinberg*
ASSOCIATE ENGINEER

APPROVED *James H. McKen*
HIGHWAYS ENGINEER

APPROVED *Edward Maslunas*
ENGINEER OF SURVEYS

APPROVED *Orator Adair*
DIRECTOR OF PUBLIC WORKS

DRAWN BY *John H. Connel*
ENGINEER IN CHARGE OF DRAFTING

5

834/835
836/837

2

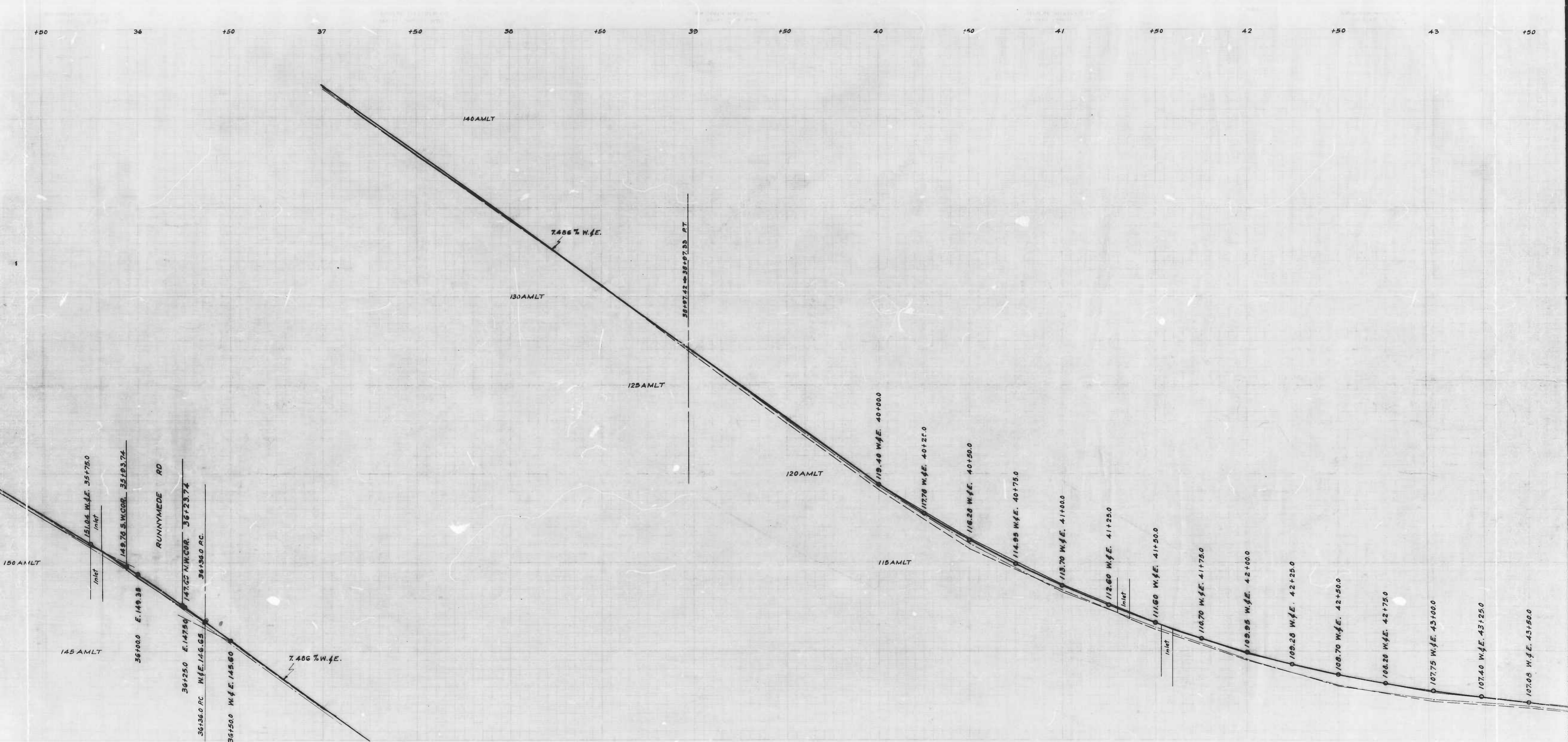

6

834/835
836/837

1

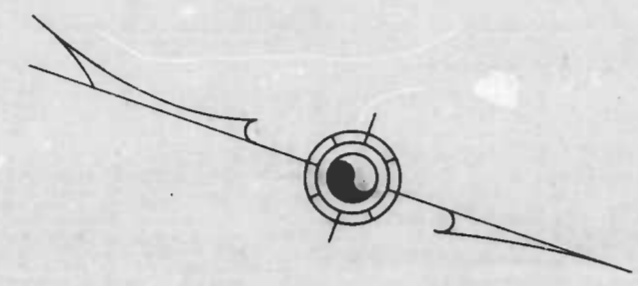

"NOTE"
TO BE SHEET ASPHALT PAVING, 1 1/2" WEARING SURFACE, 1 1/2" BINDER
ON AN EIGHT INCH CEMENT CONCRETE BASE.
FROM PEAK AVE TO S.B.L. RUNNYMEDE AVE. AND FROM S.B.L. BENSON AVE.
TO N.B.L. BENSON AVE; SIX INCHES OF SOIL STABILIZATION MATERIALS ARE REQUIRED
FROM S.B.L. RUNNYMEDE AVE. TO S.B.L. BENSON AVE; SOIL STABILIZATION AND
UNDERDRAINS ARE NOT REQUIRED.

LIMIT OF WORK
UNDER CONT. NO. 835

BEG. OF WORK
UNDER CONT. NO. 834

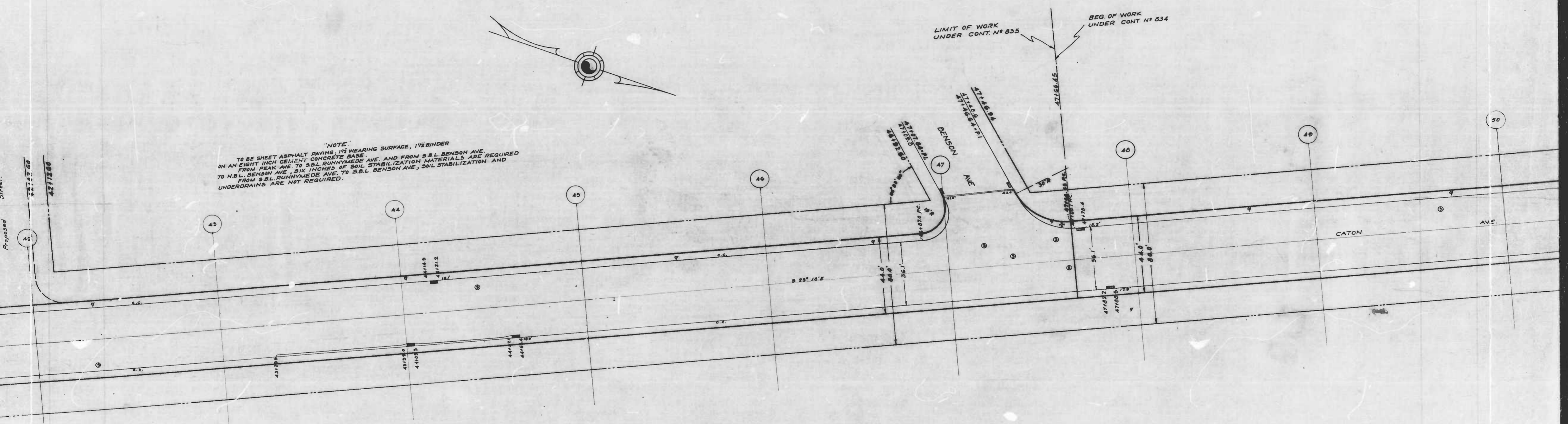

CITY OF BALTIMORE
DEPARTMENT OF PUBLIC WORKS
BUREAU OF HIGHWAYS
PLAN OF
CATON AVE. - PEAK AVE. - BENSON AVE
SCALE: 1" = 20.0' BOOK NO. X-176 DATE: 3-12-47
CONT. NO. 835

APPROVED *Henry Wislizenus* ASSOCIATE ENGINEER
APPROVED *W. J. Fisher* HIGHWAYS ENGINEER
APPROVED *Edward Whelan* ENGR. PLANS & SURVEYS
APPROVED *Robert R. Smith* CHIEF ENGINEER

DRAWN BY *Arthur H. Ewell*
EXAMINED BY *S. S. Burns*
ENGINEER IN CHARGE OF DRAWING

7

834/835
836/837

2

+50 43 +50 44 +50 45 +50 46 +50 47 +50 48 +50 49 +50 50 +50

CITY OF BALTIMORE
DEPARTMENT OF PUBLIC WORKS
BUREAU OF HIGHWAYS
PROFILE OF
CATON AVE. - PEAK AVE. - BENSON AVE.
HOR: 1" = 20.0' BOOK N^o X-176
SCALE: VER: 1" = 2.0' DATE: 3-13-47
CONT. N^o 835

APPROVED APPROVED
Henry Wisler *W. J. D. Fisher*
ASSOCIATE ENGINEER HIGHWAYS ENGINEER
APPROVED APPROVED
Edward J. Anderson *Robert R. Smith*
ENGR. PLANS & SURVEYS CHIEF ENGINEER

LIMIT OF WORK UNDER CONT. N^o 835
BEG. OF WORK UNDER CONT. N^o 834

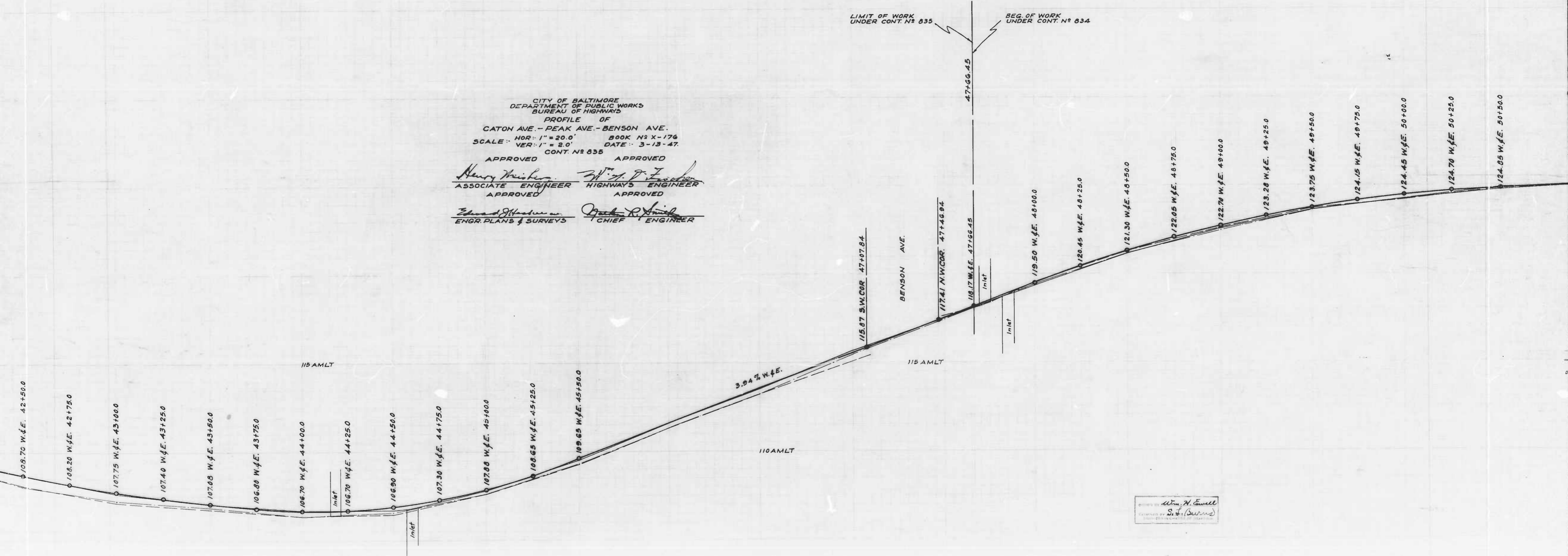

Checked by *Wm. H. Sewell*
Supt. of Surveys

61

834/835
836/837

1

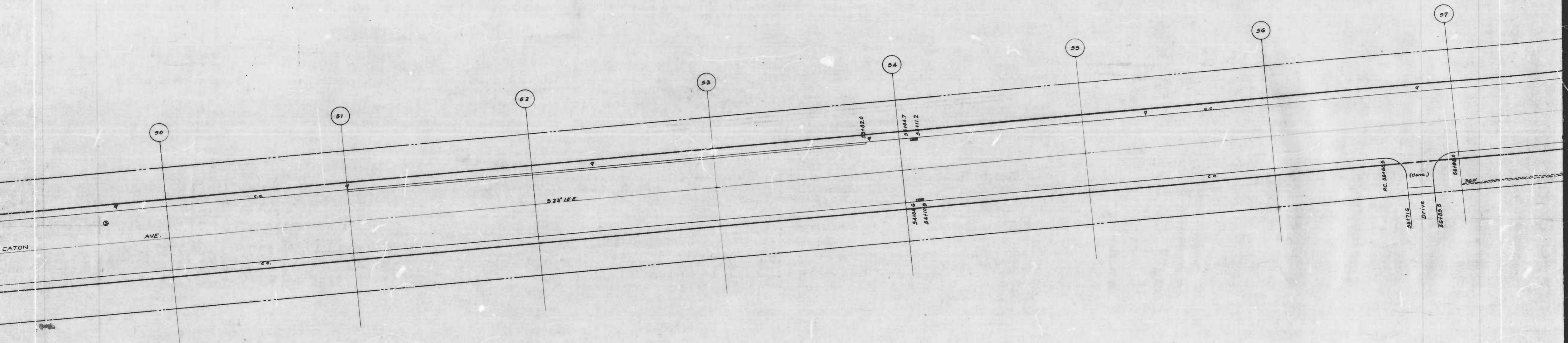

834/835
836/837

2

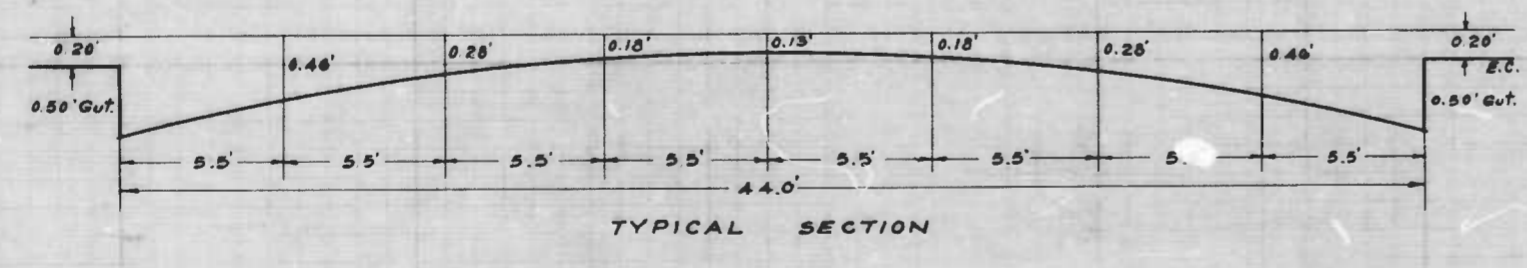
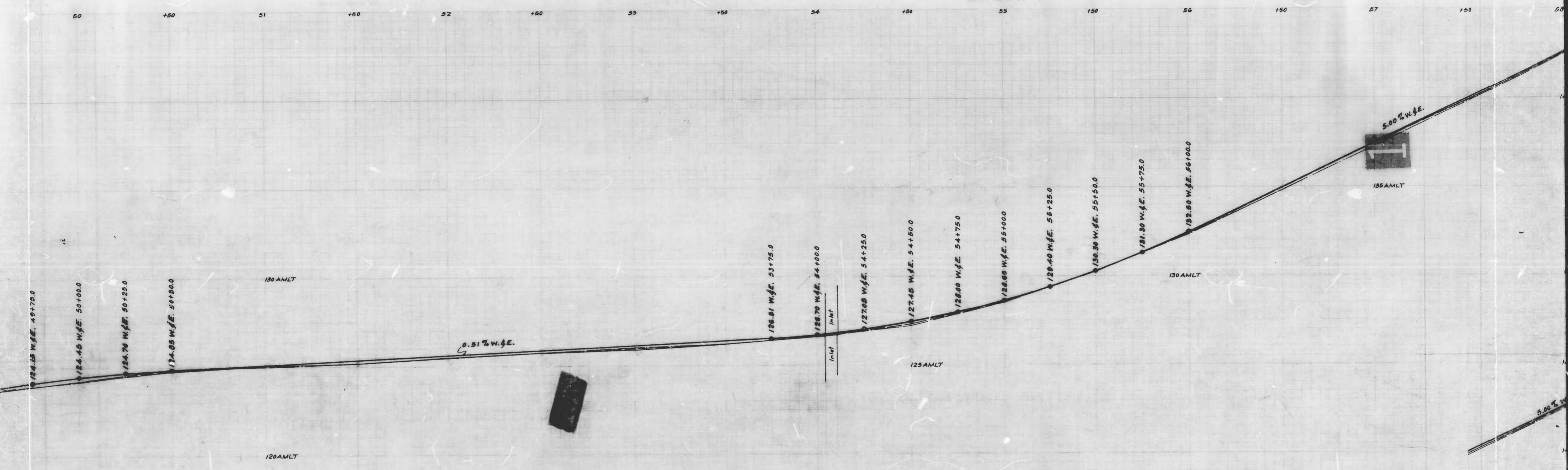

834/835
836/837

1

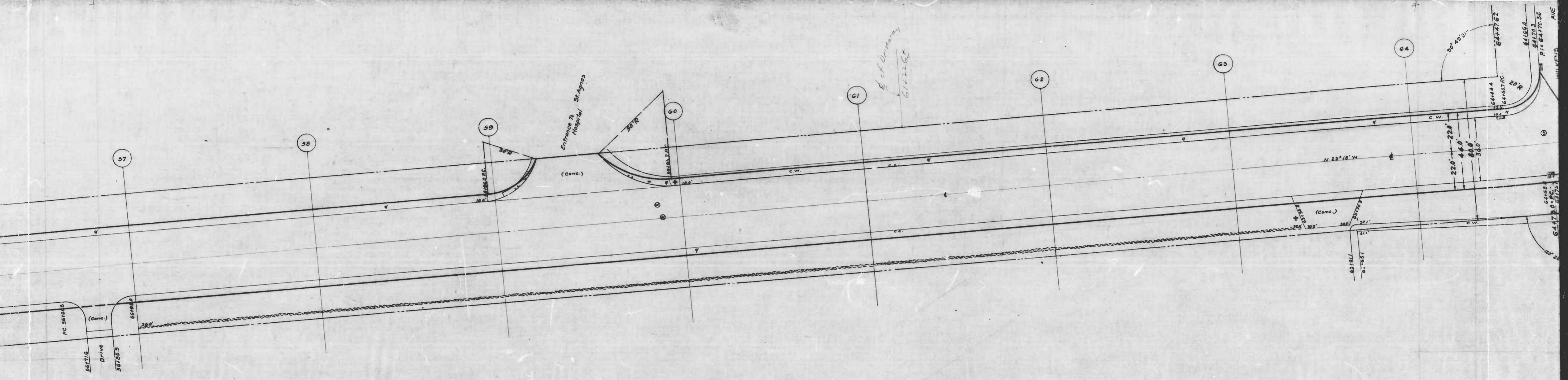

NOTE: FROM N.E.L. BENSON AVE. TO S.E.L. WILKENS AVE.
TO BE SHEET ASPHALT PAVING, 1/2" WEARING SURFACE, 1/2" BINDER
ON AN EIGHT INCH CEMENT CONCRETE BASE, SIX INCH SOIL STABILIZATION MATERIAL
AND UNDERDRAINS ARE REQUIRED.

Q1

834/835
836/837

2

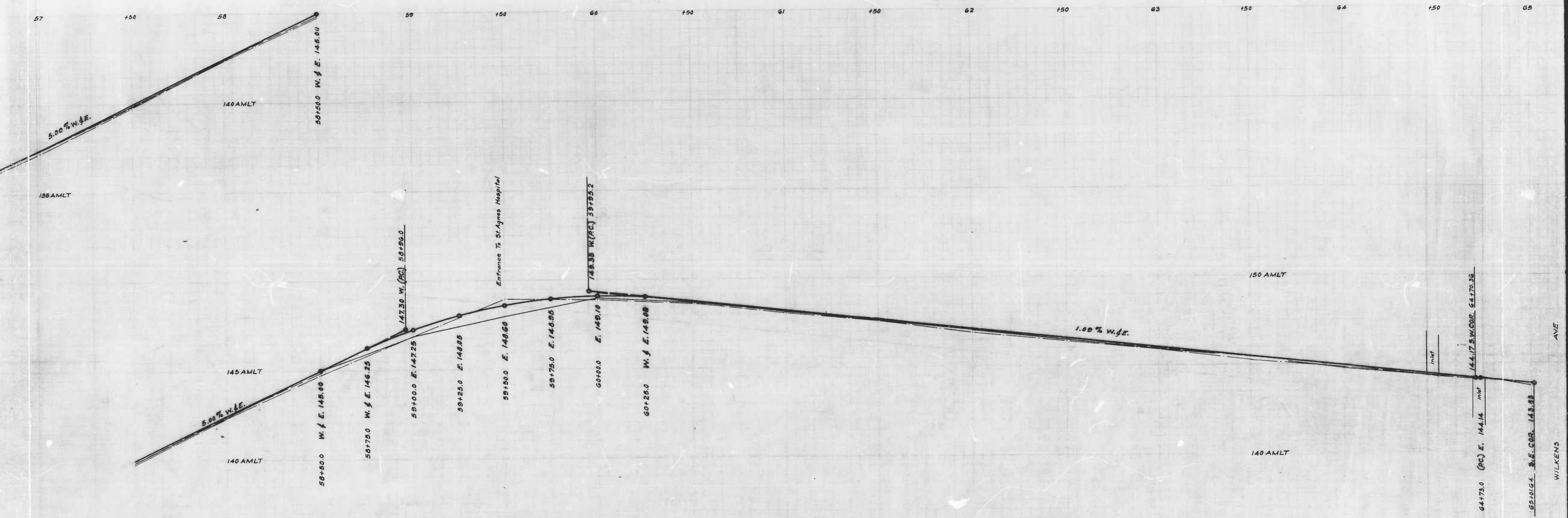

(a)

834/835
836/837

1

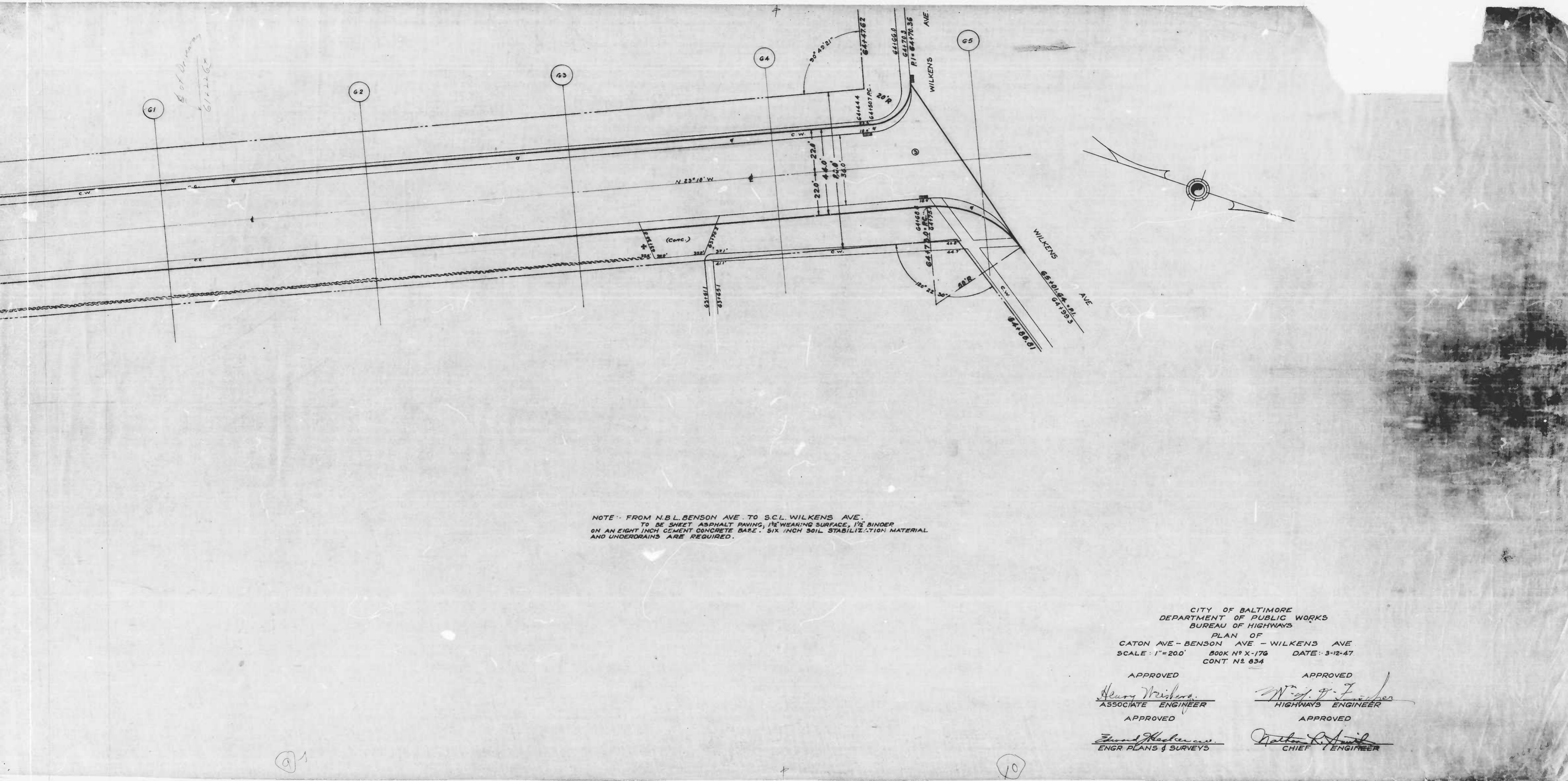

834/835
836/837

2

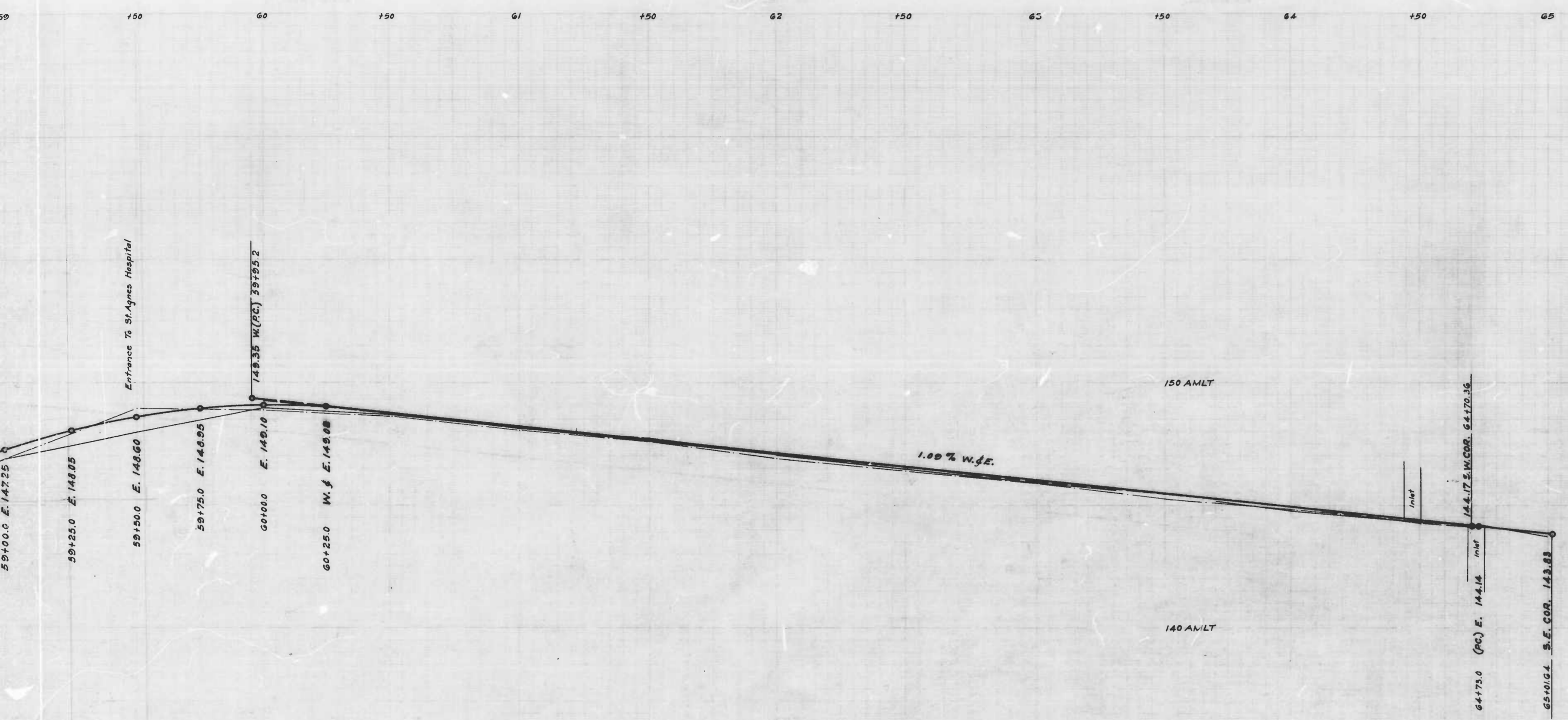

CITY OF BALTIMORE
DEPARTMENT OF PUBLIC WORKS
BUREAU OF HIGHWAYS
PROFILE OF
CATON AVE. - BENSON AVE. - WILKENS AVE
HOR. 1" = 20.0' BOOK NO. X-176
SCALE: VER. 1" = 2.0' DATE: 3-13-47
CONT. NO. 834

APPROVED *Henry M. ...* ASSOCIATE ENGINEER
APPROVED *Wm. J. ...* HIGHWAYS ENGINEER

APPROVED *Edward ...* ENGR. PLANS & SURVEYS
APPROVED *Paul ...* CHIEF ENGINEER

9

10

834/835
836/837

6

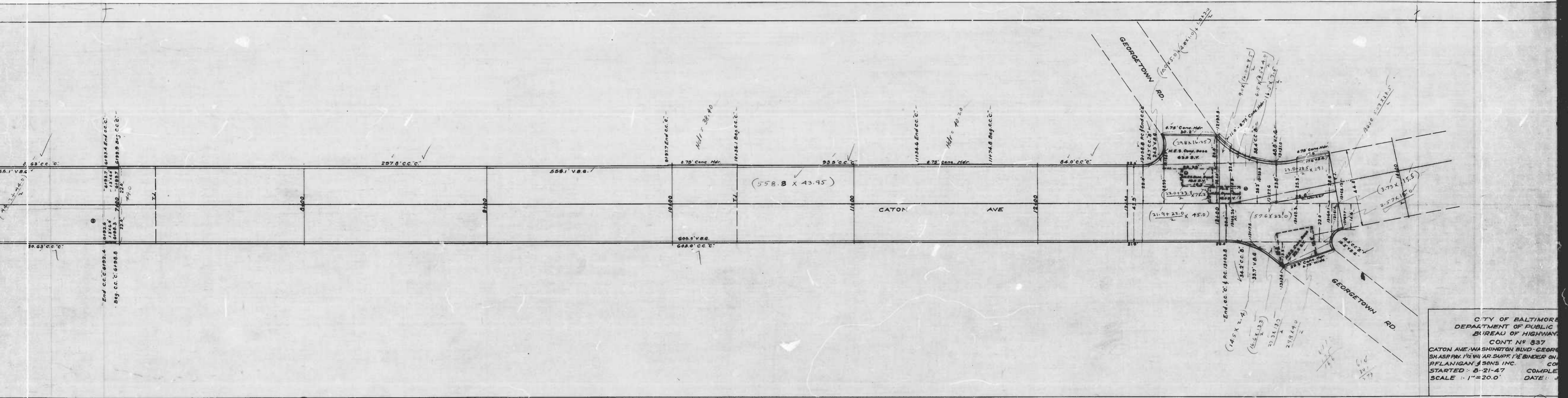

CITY OF BALTIMORE
DEPARTMENT OF PUBLIC
WORKS
BUREAU OF HIGHWAYS
CONTRACT NO. 837
CATON AVE. WASHINGTON BLVD. GEORGETOWN RD.
SHARPN. 1/2" W. AR. SURF. 1/2" BINDER ON
PFLANIGAN & SONS INC. CON
STARTED: 8-21-47 COMPLE
SCALE: 1"=20.0' DATE: J

(2)

(3)

834/835
836/837

6

CATON AVE. - WASHINGTON BLVD. - GEORGETOWN RD. - COMLYN ST.

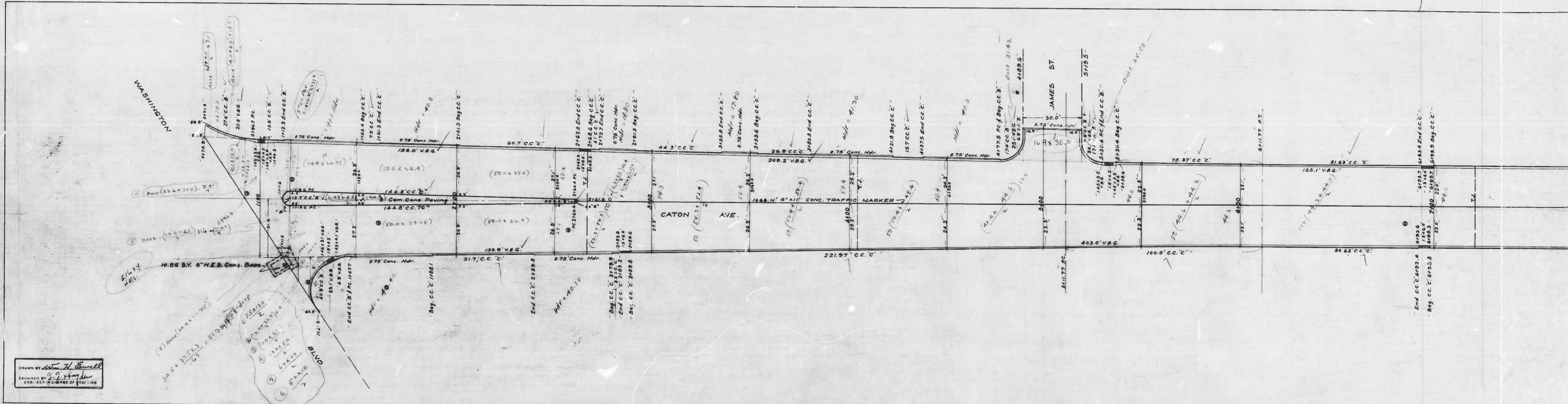

DRAWN BY *[Signature]*
EXAMINED BY *[Signature]*
ENGR. REG. NO. 118118

105