

Note - To Be Shovel Asphalt Paving 1 1/2" Binder On Any Cement Concrete 2 Inches Stone Dust screenings Underneath

DESIGNED BY J.J. HAYDEN  
 DRAWN BY S. L. CURRAN  
 ENGINEER IN CHARGE OF DRAWING

Sheet 1

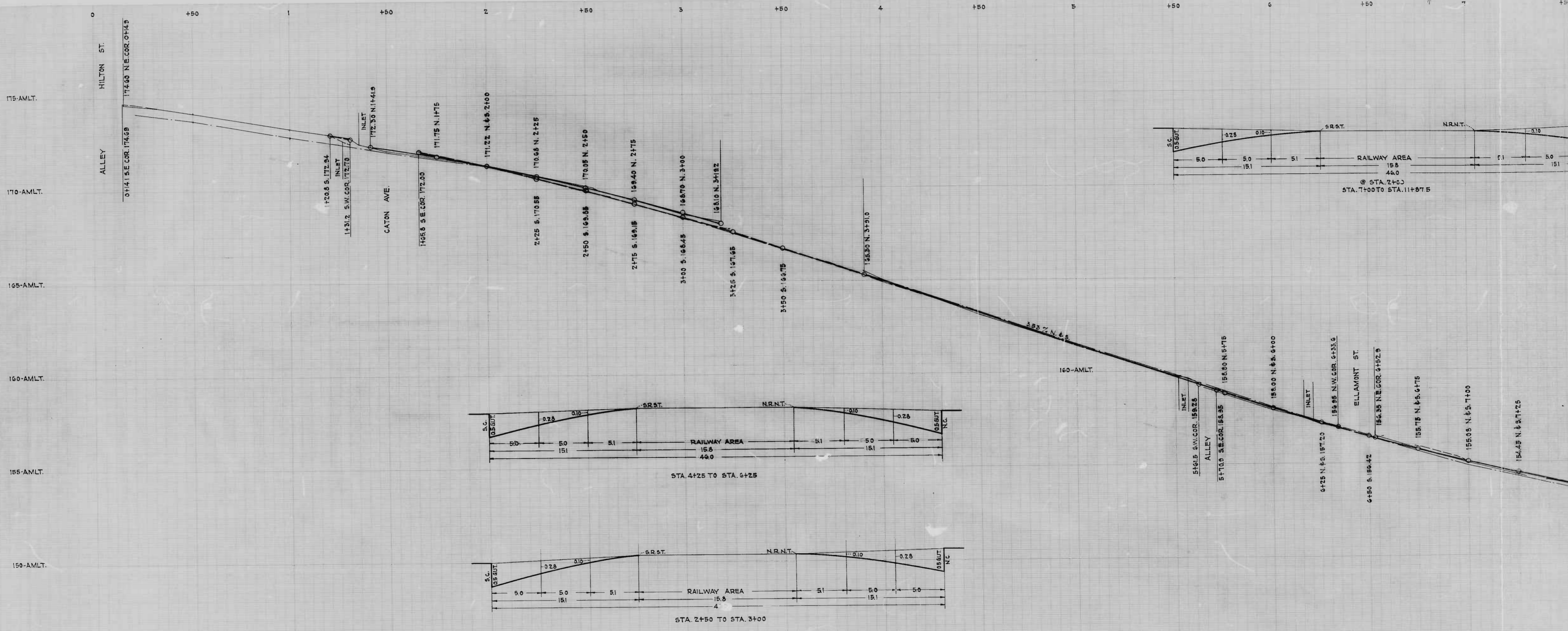

DRAWN BY J.J. HAYDEN  
 EXAMINED BY S. J. BURMAN  
 ENGINEER IN CHARGE OF DRAFTING

Sheet

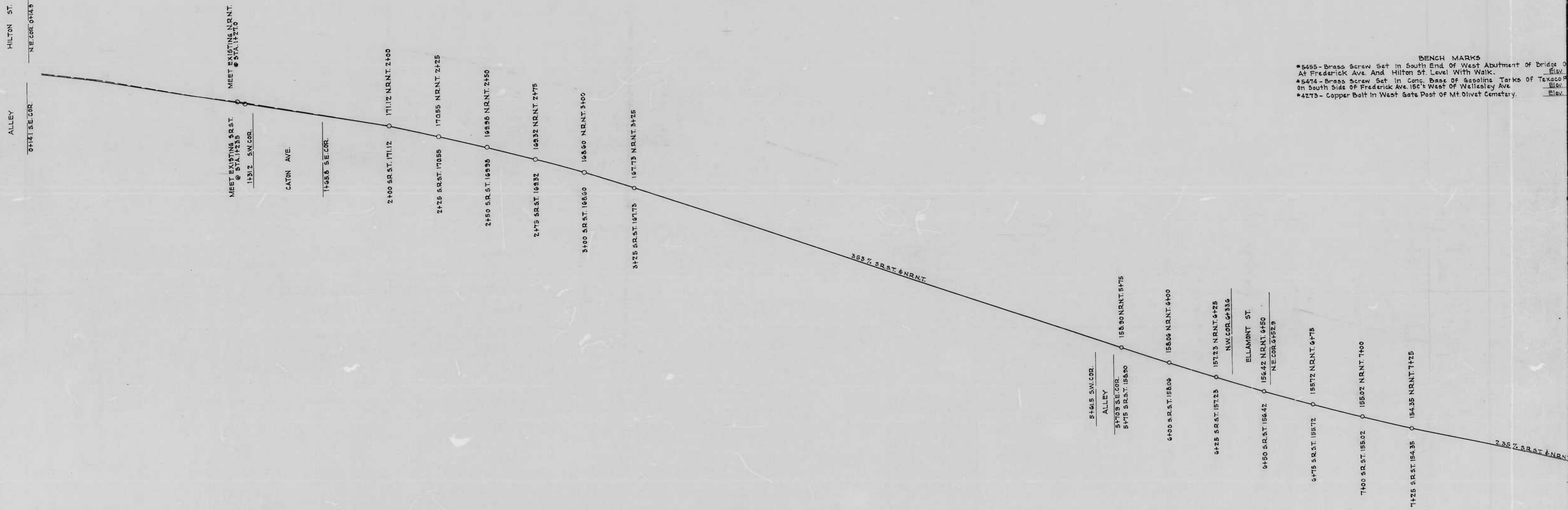

BENCH MARKS

- \*5455 - Brass Screw Set in South End of West Abutment of Bridge at Frederick Ave. and Hilton St. Level With Walk. Elev.
- \*5474 - Brass Screw Set in Conc. Base of Gasoline Tanks of Texaco on South Side of Frederick Ave. 150' West of Wellesley Ave. Elev.
- \*4273 - Copper Bolt in West Gate Post of Mt. Olivet Cemetery. Elev.

DESIGNED BY N.J. HAYDEN  
 CHECKED BY S. L. JAMES  
 APPROVED BY [Signature]

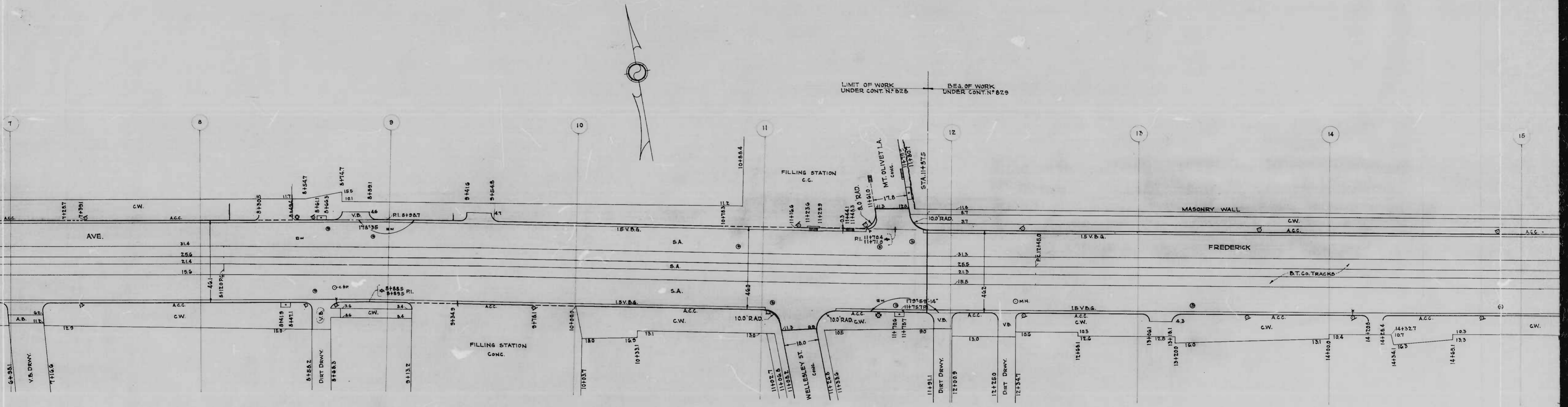

Note: - To Be Sheet Asphalt Paving, 1 1/2" Wearing Surface,  
 1 1/2" Binder On An 8" Cement Concrete Base and Two (2)  
 Inches Stone Dust Scrappings Underdrains Are Not Required.

CITY OF BALTIMORE  
 DEPARTMENT OF PUBLIC WORKS  
 BUREAU OF HIGHWAYS  
 PLAN OF  
 FREDERICK AVE.-CATON AVE TO MT. OLIVET L.A.  
 CONT. N° 828

SCALE - 1" = 20.0'

BOOK N° X-212  
 MARCH 14, 1947

APPROVED: *Edward J. Hadden*  
 ASSOCIATE ENGINEER

APPROVED: *Wm. D. Fisher*  
 HIGHWAYS ENGINEER

APPROVED: *Edward J. Hadden*  
 ENGR. PLANS & SURVEYS

APPROVED: *Arthur R. Smith*  
 CHIEF ENGINEER

DRAWN BY J.J. HAYDEN  
 EXAMINED BY S. L. ...  
 ENGINEER IN CHARGE OF CRAFTING

Sheet 2

828/829

RATIO - 24

2

+50 7 +50 8 +50 9 +50 10 +50 11 +50 12 +50 13 +50 14 +50 100

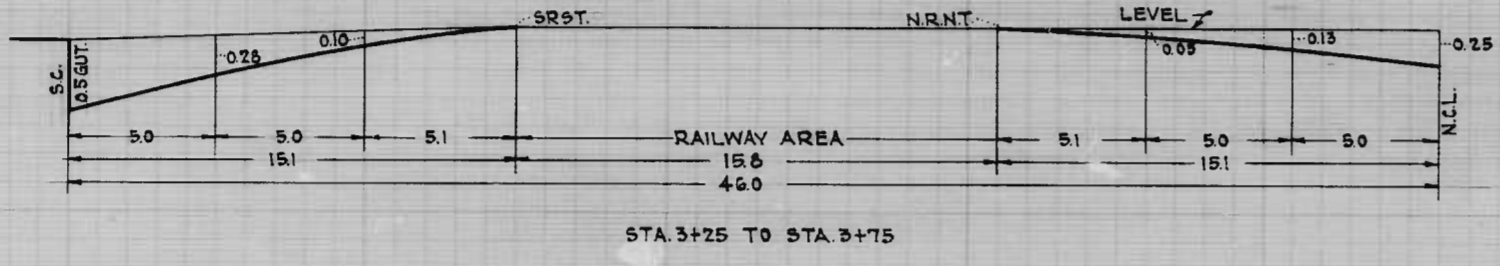
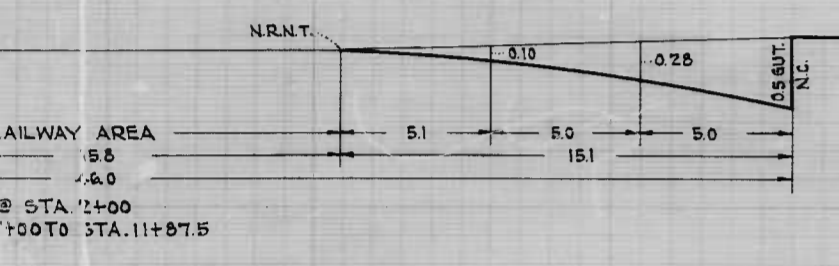

STA 3+25 TO STA 3+75

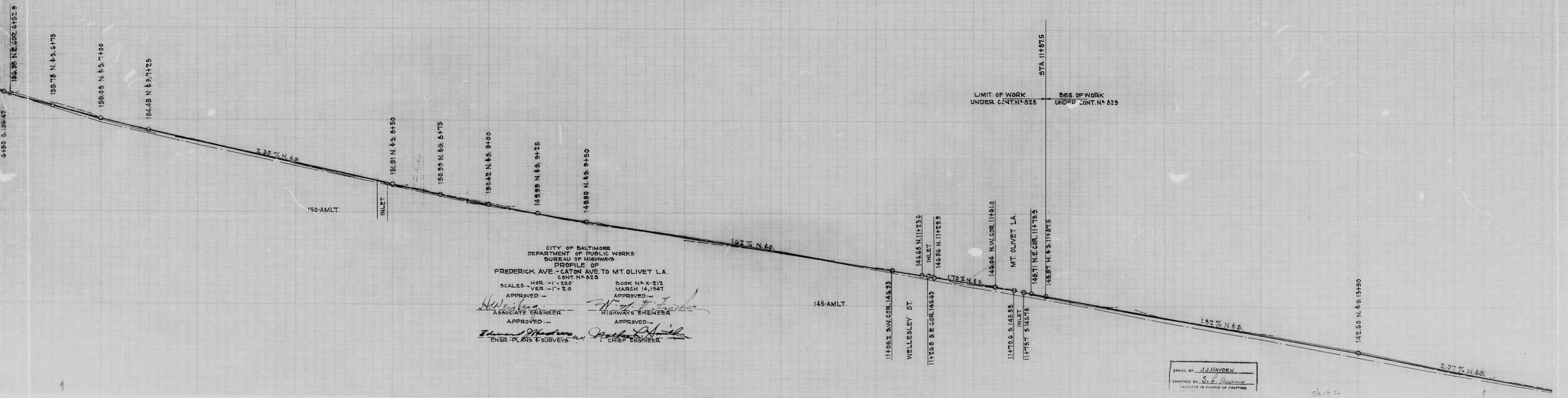

CITY OF BALTIMORE  
DEPARTMENT OF PUBLIC WORKS  
BUREAU OF HIGHWAYS  
PROFILE OF  
FREDERICK AVE. - GATON AVE. TO MT. OLIVET L.A.  
CONT. N. 828  
SCALES - HOR. - 1" = 200'  
VER. - 1" = 2.0'  
APPROVED *[Signature]*  
ASSOCIATE ENGINEER  
APPROVED *[Signature]*  
ENGR. - PLANS & SURVEYS  
APPROVED *[Signature]*  
HIGHWAYS ENGINEER  
APPROVED *[Signature]*  
CHIEF ENGINEER

DRAWN BY J.J. HAYDEN  
EXAMINED BY S.E. CUNNINGHAM  
ENGINEER IN CHARGE OF DRAFTING

Shot 2

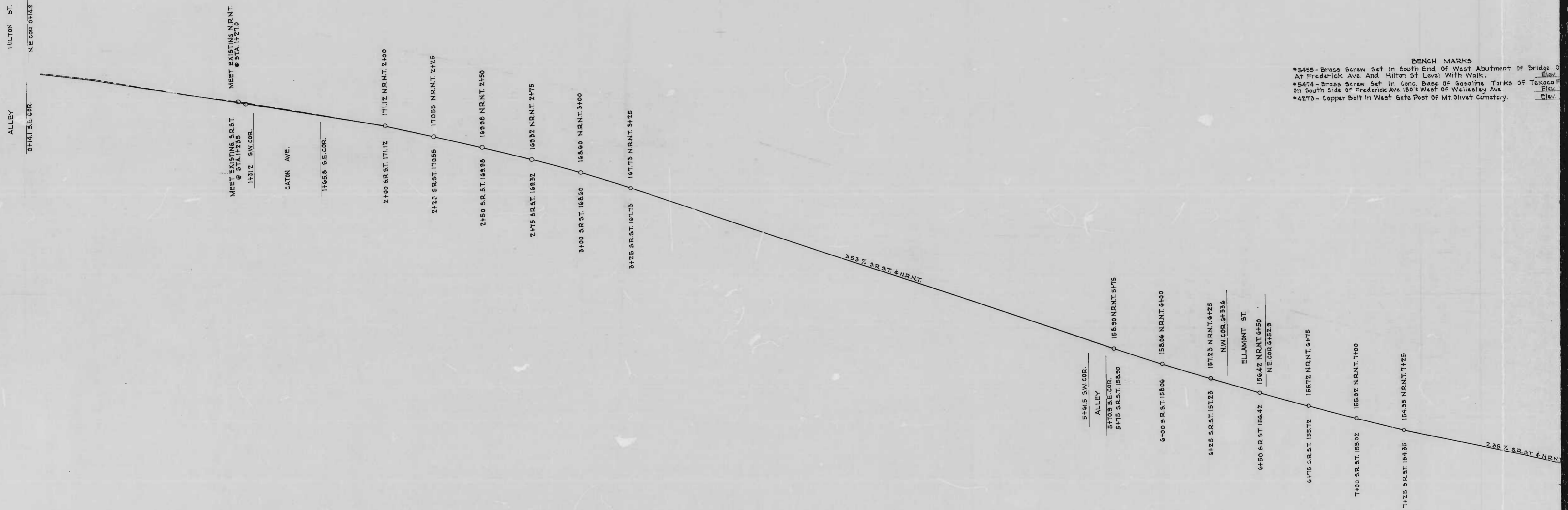

BENCH MARKS

- \*5455 - Brass screw set in South End of West Abutment of Bridge O At Frederick Ave. And Hilton St. Level With Walk. Elev.
- \*5474 - Brass screw set in Conc. Base of Gasoline Tanks of Texaco P On South Side of Frederick Ave. 150' West of Wellesley Ave. Elev.
- \*4273 - Copper Bolt in West Gate Post of Mt Olivet Cemetery. Elev.

Drawn by J. HANSEN  
 Checked by J. Hansen  
 Engineer of Public Works

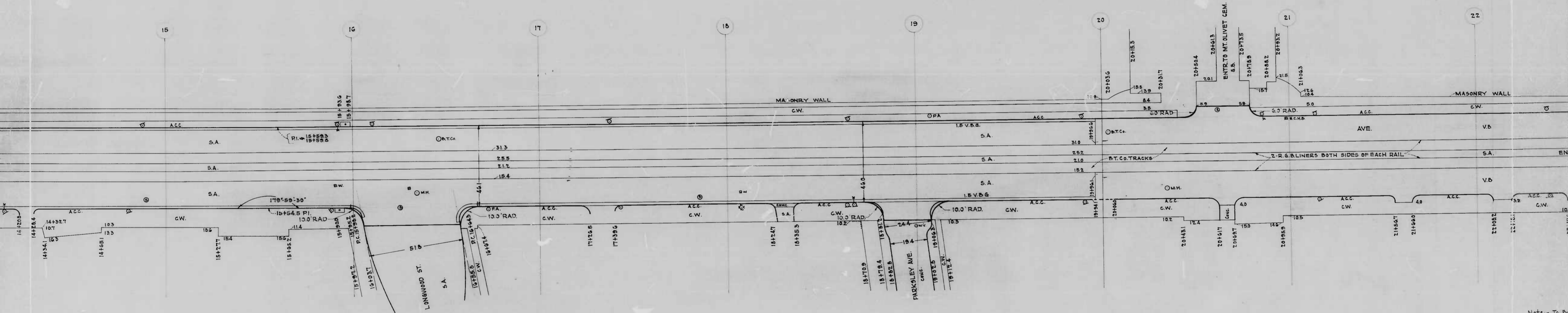

Notes - To Be  
 1 1/2" Binder, On  
 Stone Dust Sol

Shot 3

828/829

RATIO - 24

2

14 +50 15 +50 16 +50 17 +50 18 +50 19 +50 20 +50 21 +50 22

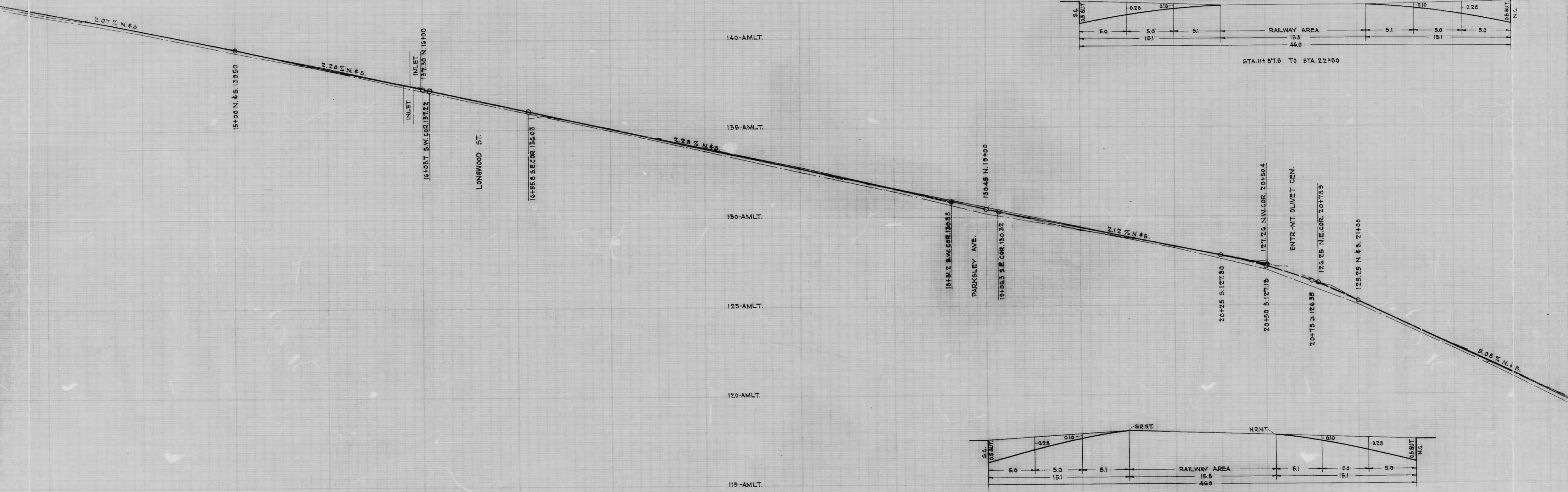

2.07% N. 45

shot 3



**BENCH MARKS**  
 Screw set in South End of West Abutment of Bridge Over PRR  
 Ave. and Hilton St. Level With Walk. Elev. 174.84  
 Screw set in Conc. Base of Gasoline Tanks of Texaco Filling Sta.  
 of Frederick Ave. 150' West of Wellesley Ave. Elev. 150.61  
 Bolt in West Gate Post of Mt. Olivet Cemetery. Elev. 129.26

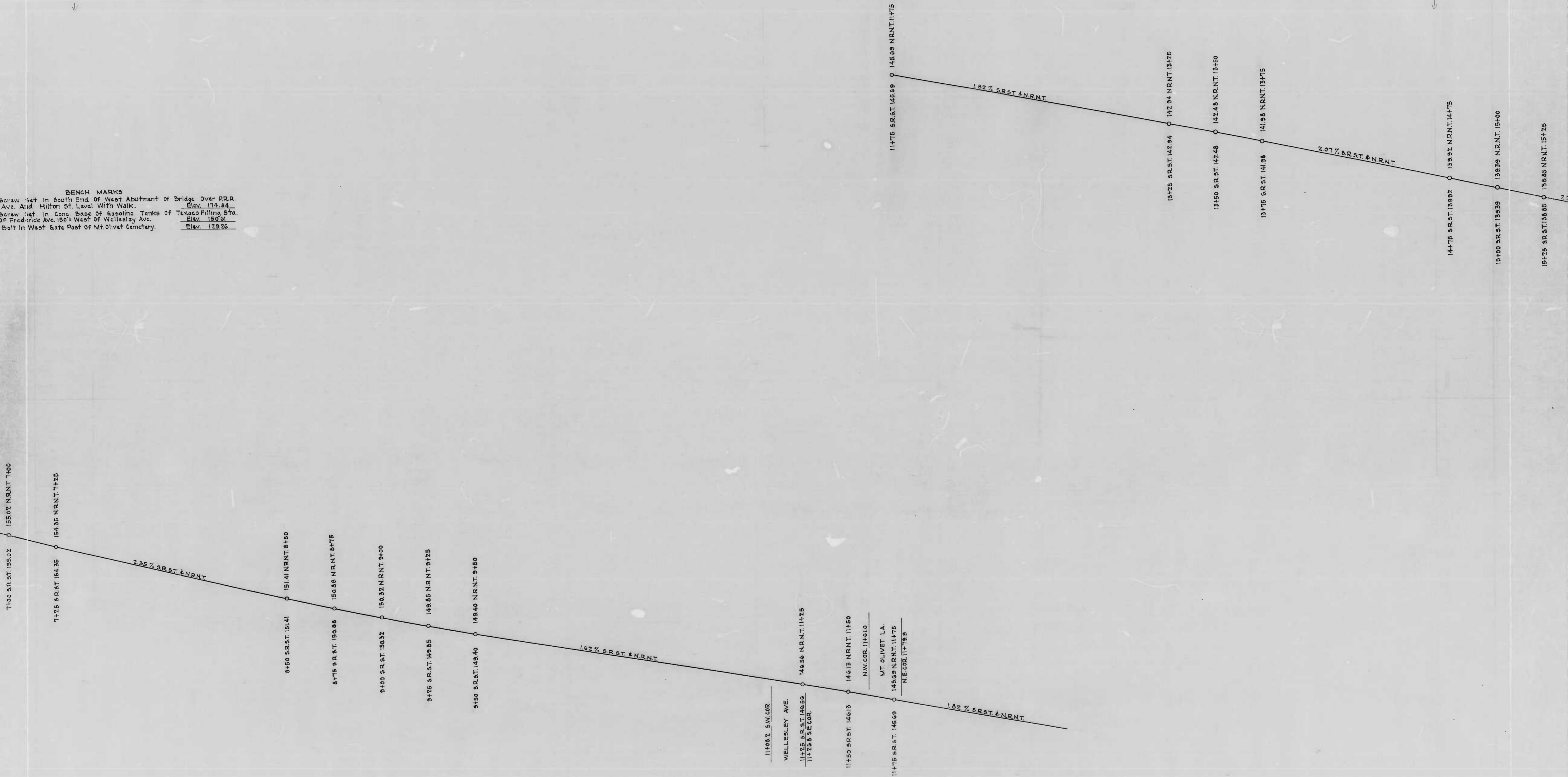

Sheet 2

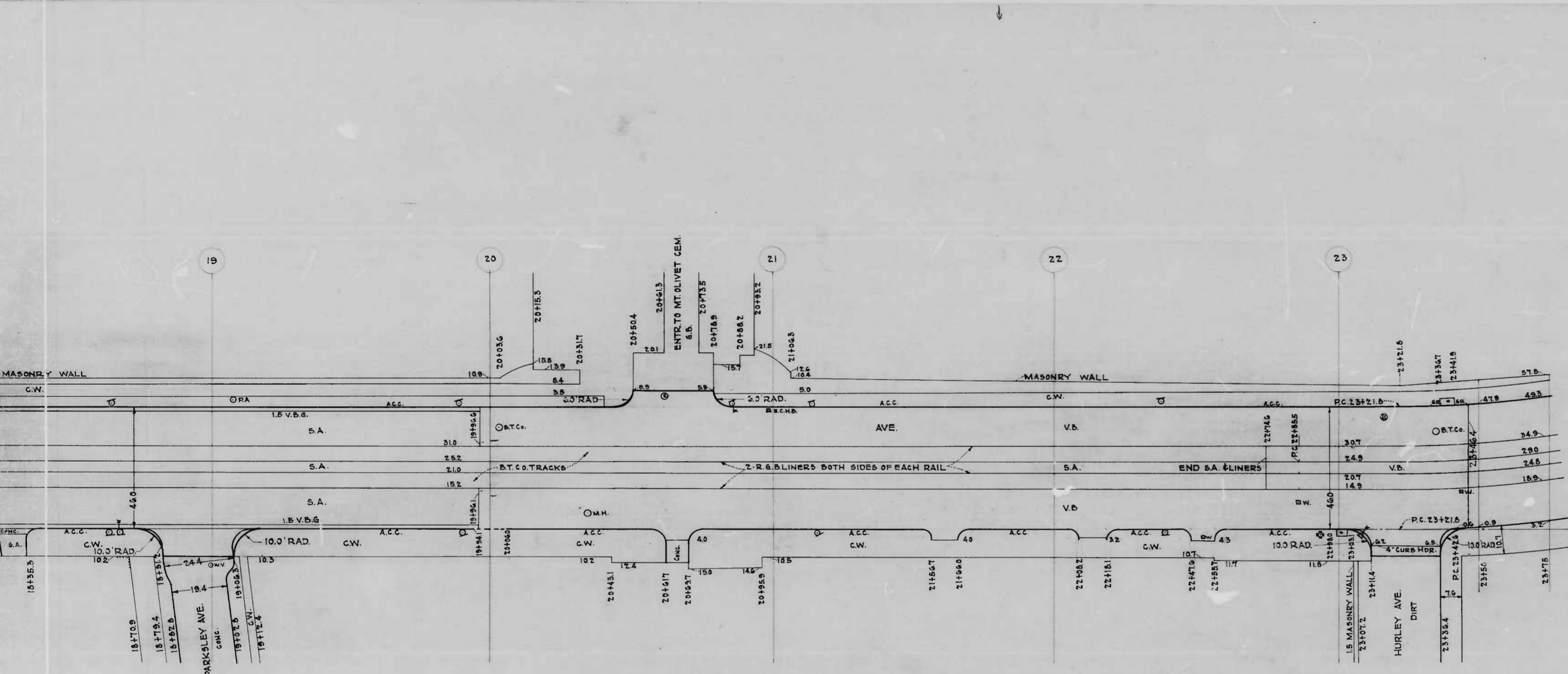

Note - To Be Sheet Asphalt Paving; 1 1/2" Wearing Surface, 1 1/2" Binder, On An 8" Cement Concrete Base And Two (2) Inches Stone Dust Screenings. Underdrains Are Not Required.

CITY OF BALTIMORE  
 DEPARTMENT OF PUBLIC WORKS  
 BUREAU OF HIGHWAYS  
 PLAN OF  
 FREDERICK AVE. - MT. OLIVET LA. TO HURLEY AVE.  
 CONT. N° 829

SCALE - 1" = 20.0'  
 APPROVED - *W. J. ...*  
 ASSOCIATE ENGINEER

BOOK N° X-212  
 MARCH 14, 1947  
 APPROVED - *W. J. ...*  
 HIGHWAYS ENGINEER

APPROVED - *Edmund ...*  
 ENGR. - PLANS & SURVEYS

APPROVED - *Charles ...*  
 CHIEF ENGINEER

Shot 3

Shot 4

+50 15 +50 20 +50 21 +50 22 +50 23 +50

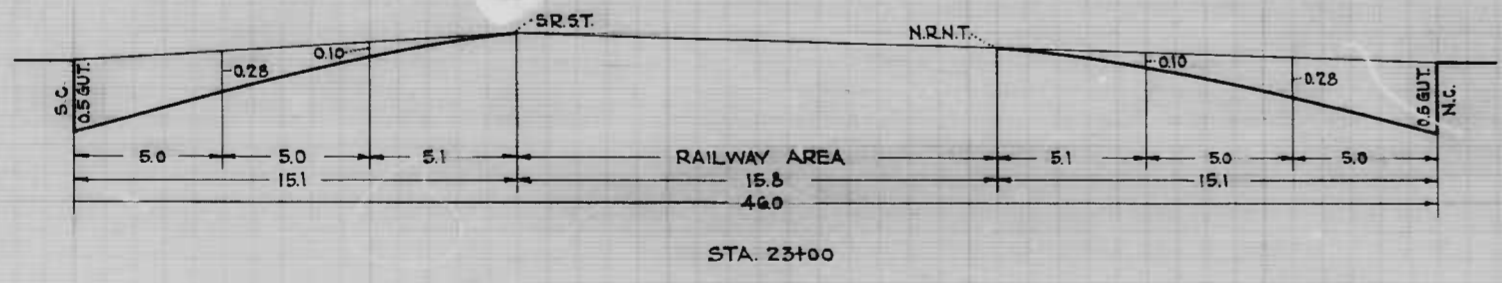
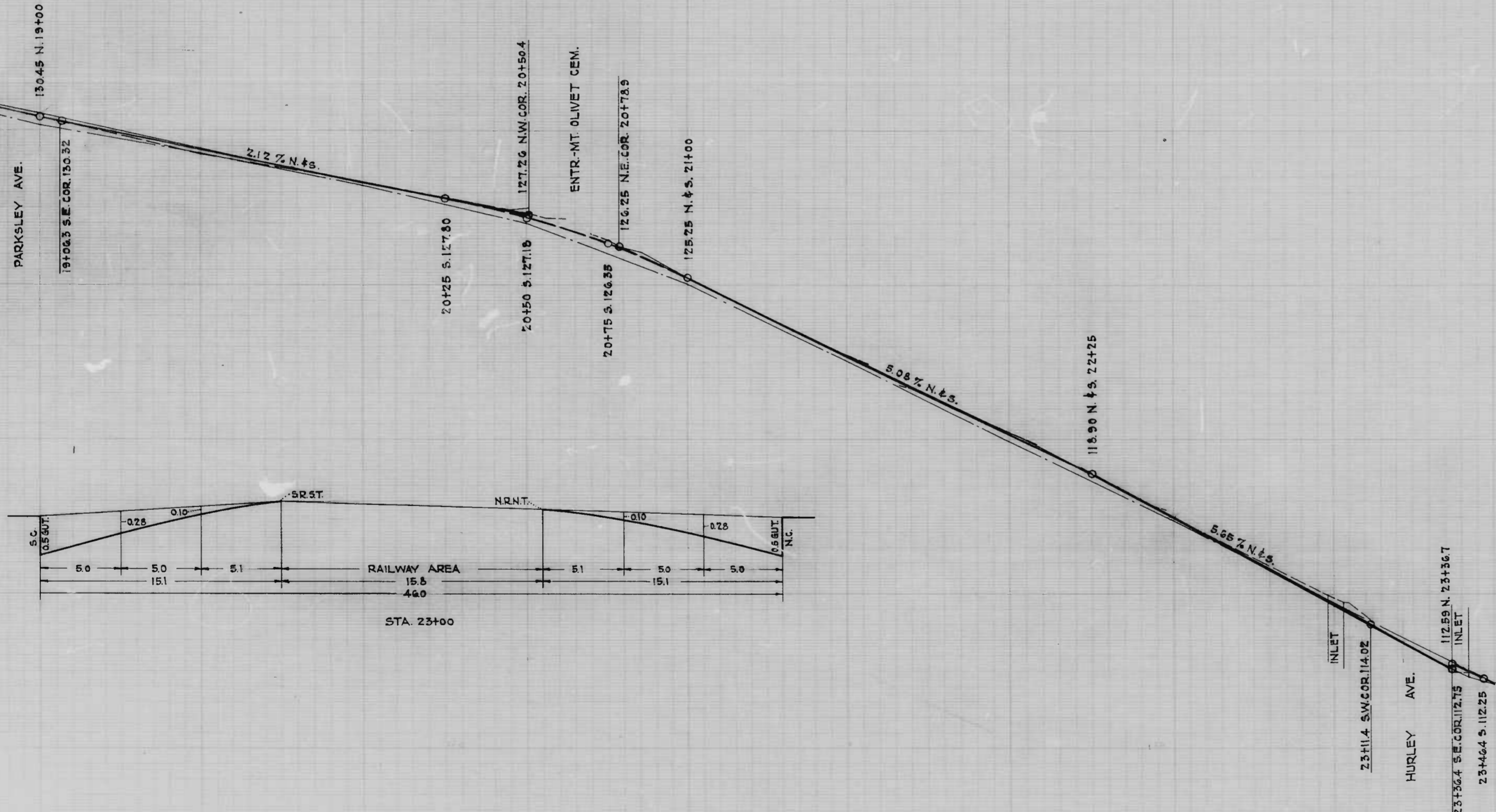
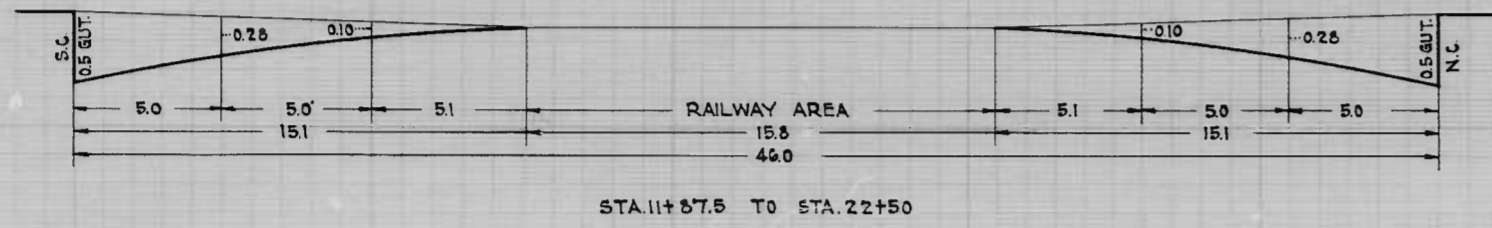

CITY OF BALTIMORE  
 DEPARTMENT OF PUBLIC WORKS  
 BUREAU OF HIGHWAYS  
 PROFILE OF  
 FREDERICK AVE. - MT. OLIVET LA. TO HURLEY AVE.  
 CONT. N° 829  
 BOOK N° X 212  
 MARCH 14, 1947  
 SCALES - HOR. 1" = 50.0' APPROVED: [Signature]  
 VER. 1" = 2.0' APPROVED: [Signature]  
 ASSOCIATE ENGINEER - [Signature] HIGHWAYS ENGINEER  
 APPROVED: [Signature] APPROVED: [Signature]  
 ENGR. - PLANS & SURVEYS CHIEF ENGINEER

Shot 3

Shot 4

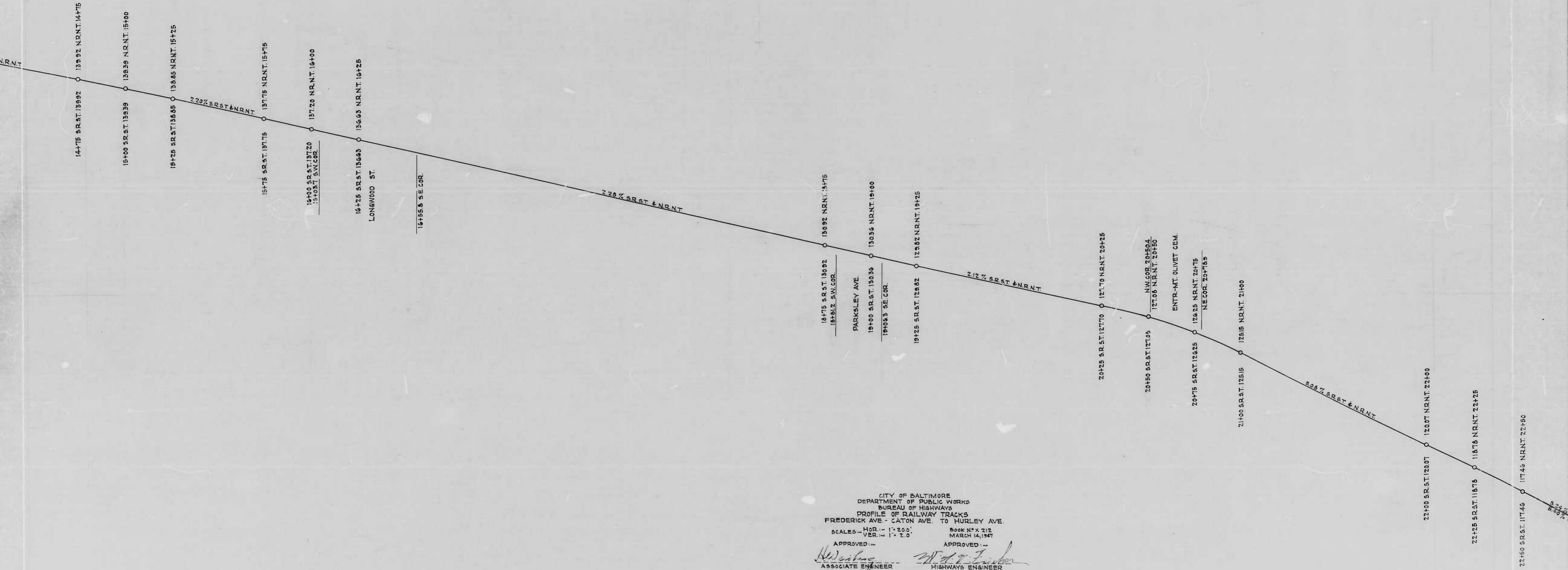

CITY OF BALTIMORE  
 DEPARTMENT OF PUBLIC WORKS  
 BUREAU OF HIGHWAYS  
 PROFILE OF RAILWAY TRACKS  
 FREDERICK AVE. - CATON AVE. TO HURLEY AVE.  
 SCALES - HOR. - 1" = 200'.      Book No. X 212  
 VER. - 1" = 2.0'.                      MARCH 14, 1947  
 APPROVED: *H. Weisberg*                      APPROVED: *W. J. Fisher*  
 ASSOCIATE ENGINEER                      HIGHWAYS ENGINEER

LONGWOOD ST.

16+55.8 SE. COR.

2.28% S.R.ST. & N.R.N.T.

18+75 S.R.ST. 130.92  
18+81.2 S.W. COR.

190.92 N.R.N.T. 18+75

PARKSLEY AVE.

19+00 S.R.ST. 130.36  
19+05.3 SE. COR.

130.36 N.R.N.T. 19+00

19+25 S.R.ST. 129.82  
129.82 N.R.N.T. 19+25

2.12% S.R.ST. & N.R.N.T.

20+25 S.R.ST. 127.70  
127.70 N.R.N.T. 20+25

20+50 S.R.ST. 127.05  
N.W. COR. 20+50.4  
127.05 N.R.N.T. 20+50

ENTR. - MT. OLIVET CEM.

20+75 S.R.ST. 126.25  
126.25 N.R.N.T. 20+75  
N.E. COR. 20+75.5

21+00 S.R.ST. 125.15  
125.15 N.R.N.T. 21+00

5.08% S.R.ST. & N.R.N.T.

22+00 S.R.ST. 120.07  
120.07 N.R.N.T. 22+00

22+25 S.R.ST. 118.76  
118.76 N.R.N.T. 22+25

22+50 S.R.ST. 117.46  
117.46 N.R.N.T. 22+50

5.24% S.R.ST. & N.R.N.T.

23+00 S.R.ST. 114.84  
114.84 N.R.N.T. 23+00

23+11.4 S.W. COR.

HURLEY AVE.

23+36.4 SE. COR.

MEET EXISTING N.R.N.T. @ STA. 23+36.4

CITY OF BALTIMORE  
 DEPARTMENT OF PUBLIC WORKS  
 BUREAU OF HIGHWAYS  
 PROFILE OF RAILWAY TRACKS  
 FREDERICK AVE. - CATON AVE. TO HURLEY AVE.

SCALES - HOR. 1" = 20.0'  
 VER. 1" = 2.0'

APPROVED: *W. J. Fisher* HIGHWAYS ENGINEER  
 APPROVED: *H. DeLoach* ASSOCIATE ENGINEER

Book N° X 212  
 MARCH 14, 1947

DATE: 3/14/47

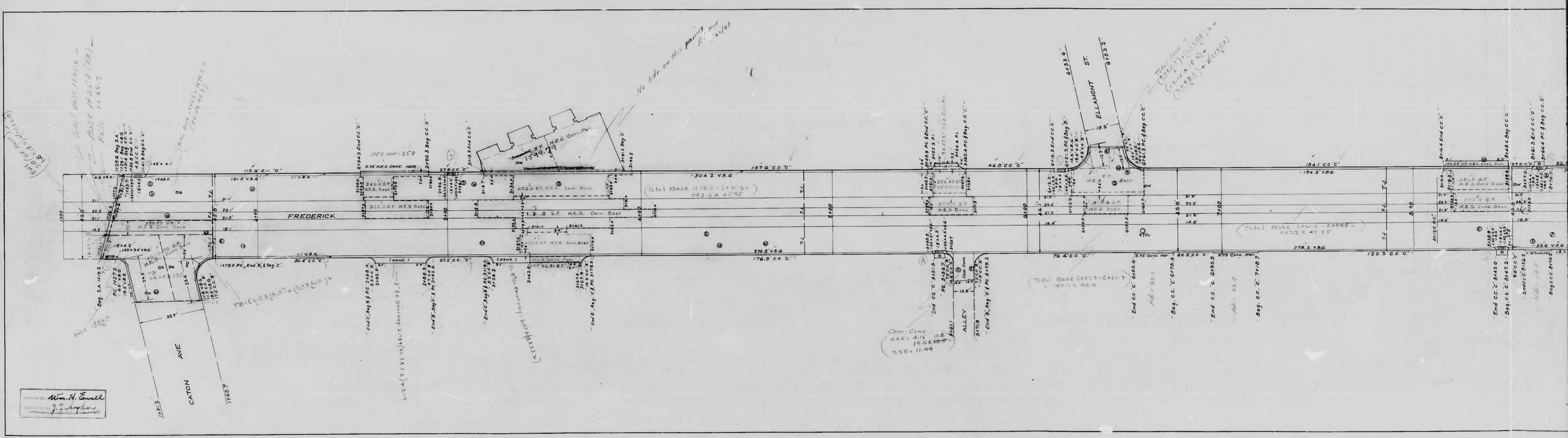

Shot:

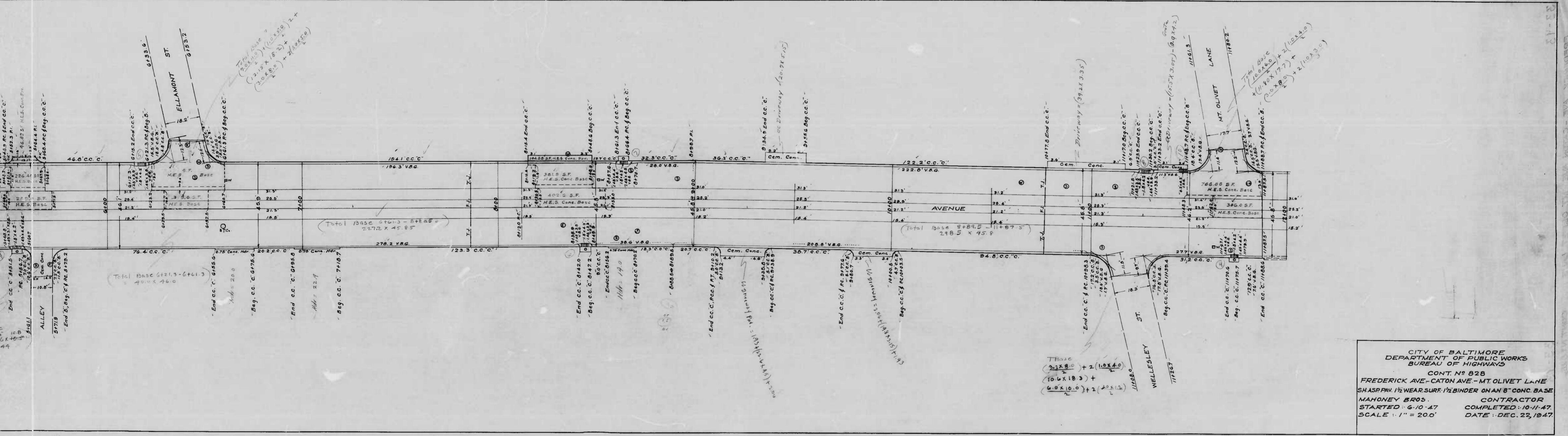

CITY OF BALTIMORE  
 DEPARTMENT OF PUBLIC WORKS  
 BUREAU OF HIGHWAYS  
 CONT. NO. 828  
 FREDERICK AVE.-CATON AVE.-MT OLIVET LANE  
 SHASRPW. 1/2 WEAR SURF. 1/2 BINDER ON AN 8" CONC. BASE  
 MAHONEY BROS. CONTRACTOR  
 STARTED: 6-10-47 COMPLETED: 10-11-47  
 SCALE: 1" = 20' DATE: DEC. 23, 1947

Shot 1

Shot 2

FREDERICK AVE - CATON AVE - MT OLIVET LANE

FREDERICK ST. - 117852 - 117852 X

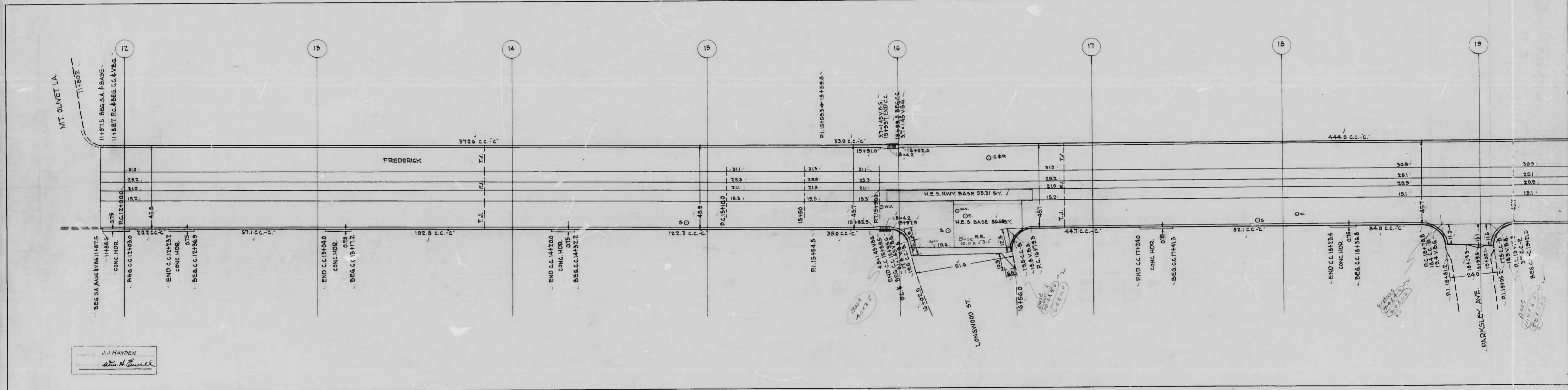

Shot 1



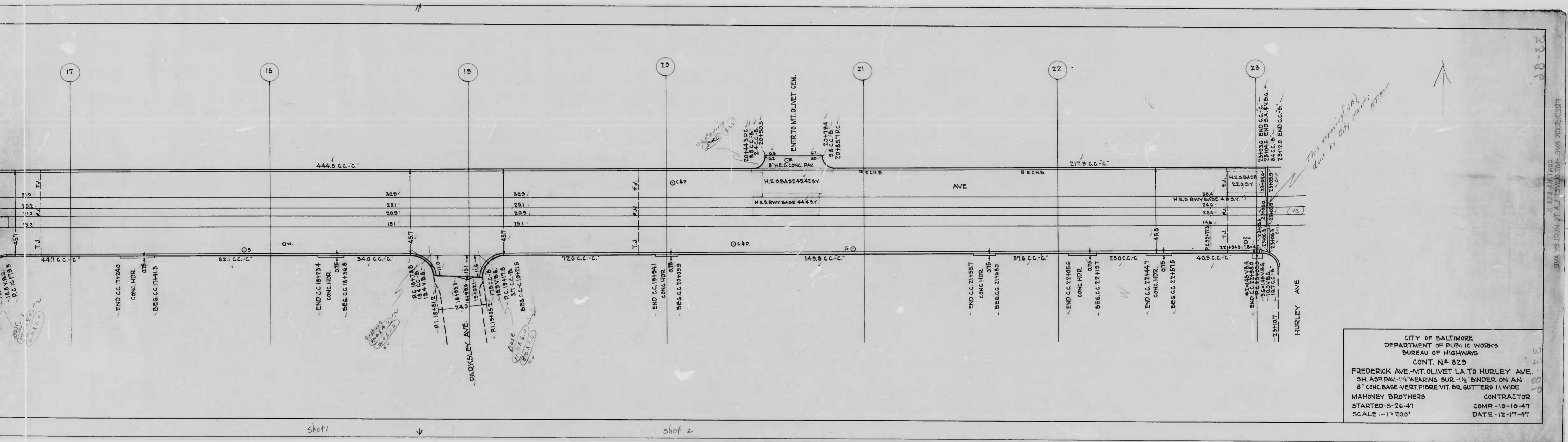

CITY OF BALTIMORE  
 DEPARTMENT OF PUBLIC WORKS  
 BUREAU OF HIGHWAYS  
 CONT. N# 829  
 FREDERICK AVE.-MT. OLIVET LA. TO HURLEY AVE.  
 8 1/2" ASP. PAV.-1/2" WEARING SUR.-1/2" BINDER ON AN  
 8" CONG. BASE-VERT. FIBRE VIT. DR. SUTTERS 11" WIDE  
 MAHONEY BROTHERS CONTRACTOR  
 STARTED 5-26-47 COMP. 10-10-47  
 SCALE = 1" = 200' DATE = 12-17-47

FREDERICK AVE - MT. OLIVET LA. TO HURLEY AVE