

NOTE:
THE ISSUANCE OF THIS PLAN & PROFILE DOES NOT COMMIT THE CITY TO THE ACCEPTANCE AND/OR IMPROVEMENT OF ANY THOROUGHFARES SHOWN THEREON.

NOTE:
TO BE CEMENT CONCRETE PAVING "IN DEPTH". SOIL STABILIZATION MATERIAL OR UNDERDRAINS ARE NOT REQUIRED.

CITY OF BALTIMORE
DEPARTMENT OF PUBLIC WORKS
BUREAU OF HIGHWAYS
PLAN & PROFILE

ANNELLEN RD. - DOLFIELD AVE. TO DORITHAN RD.
PLAN - 1" = 20'
SCALES: PROF. - 1" = 20'
BOOK NO. X-228
CONT. NO. 827
DATE - APRIL 7, 1947

APPROVED: *Henry Weisberg*
ASSOCIATE ENGINEER
HIGHWAYS ENGINEER

APPROVED: *Nathan R. Smith*
CHIEF ENGINEER

DESIGNED BY: D. Marley
CHECKED BY: S. J. Burns

1 Shot

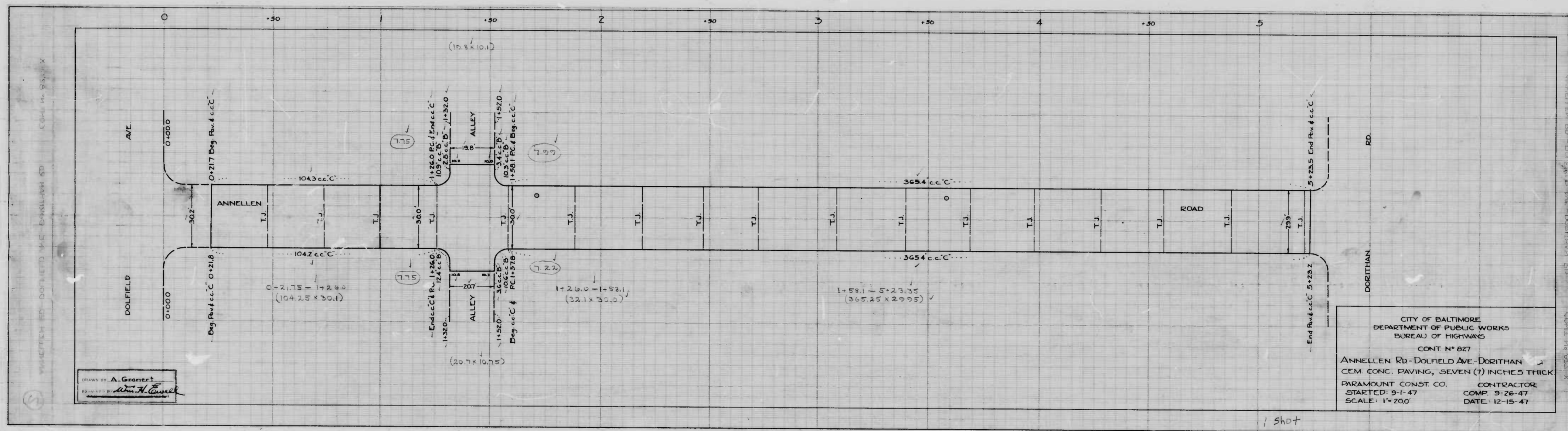

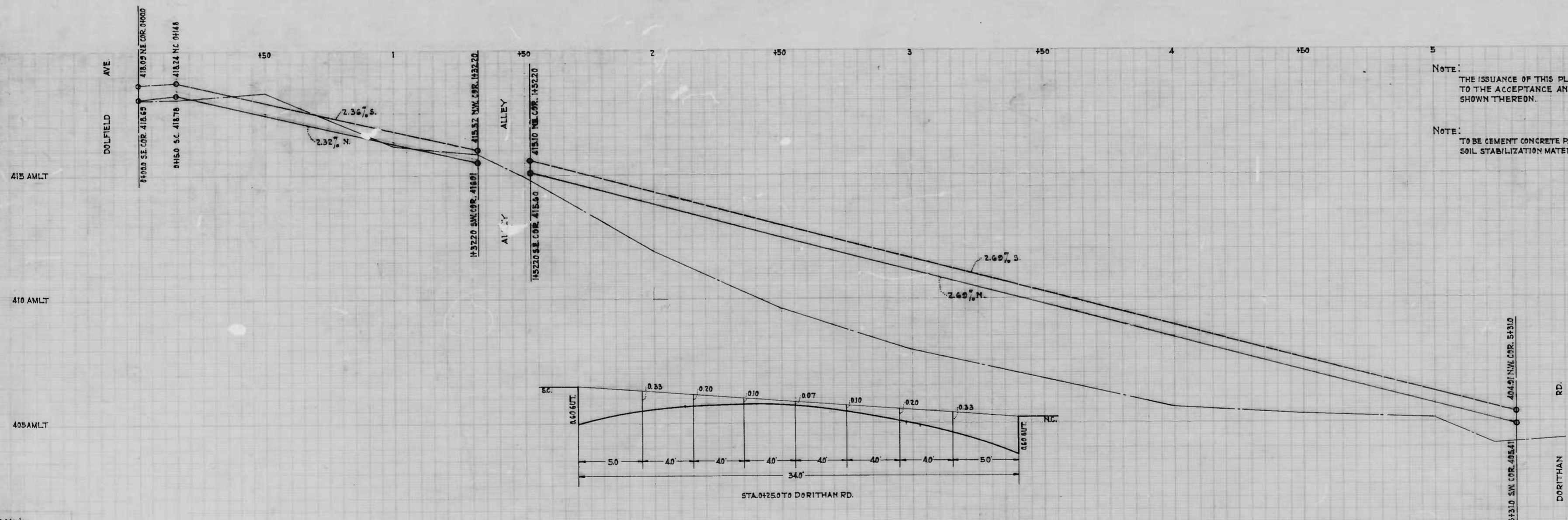
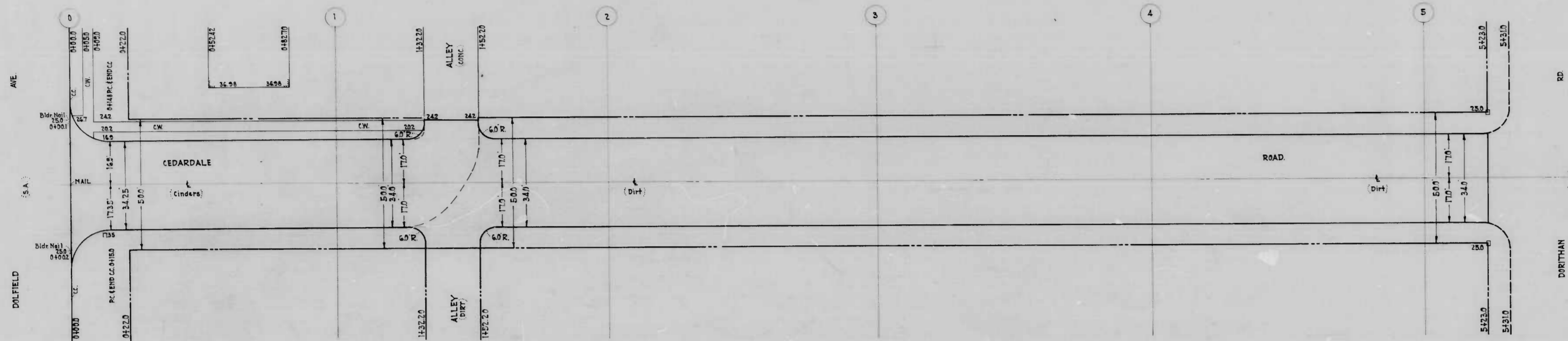

NOTE:
THE ISSUANCE OF THIS PLAN & PROFILE DOES NOT COMMIT THE CITY TO THE ACCEPTANCE AND/OR IMPROVEMENT OF ANY THOROUGHFARES SHOWN THEREON.

NOTE:
TO BE CEMENT CONCRETE PAVING 7" IN DEPTH
SOIL STABILIZATION MATERIAL OR UNDERDRAINS ARE NOT REQUIRED.

CITY OF BALTIMORE
DEPARTMENT OF PUBLIC WORKS
BUREAU OF HIGHWAYS
PLAN, PROFILE

CEDARDALE RD- DOLFIELD AVE- DORITHAN RD.

PLAN - 1" = 20.0'
SCALES - HOR - 1" = 20.0'
PROF - VER - 1" = 20'

BOOK NO. X-225
CONT. NO. 827
DATE - APRIL 3, 1947

APPROVED: Henry Weisberg, ASSOCIATE ENGINEER
APPROVED: [Signature], HIGHWAYS ENGINEER
APPROVED: Edward J. Hudson, ENGR PLANS & SURVEYS
APPROVED: [Signature], CHIEF ENGINEER

D. Morley
S. J. [Signature]

1 shot

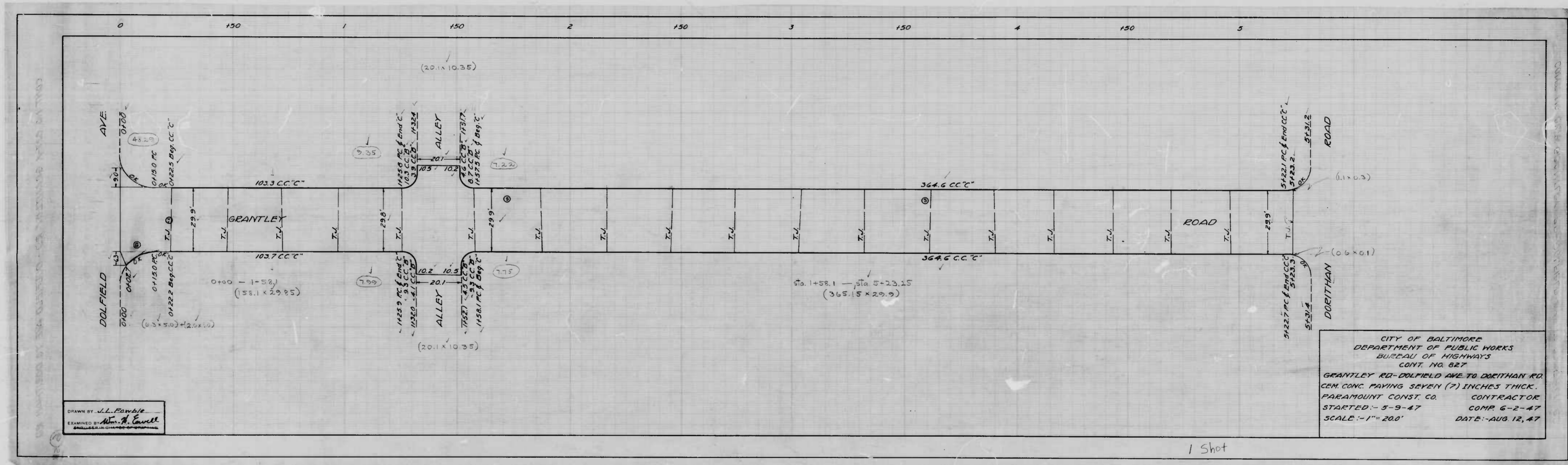

DRAWN BY J.L. FOWLER
 EXAMINED BY Wm. H. Cavell

CITY OF BALTIMORE
 DEPARTMENT OF PUBLIC WORKS
 BUREAU OF HIGHWAYS
 CONT. NO. 827
 GRANTLEY RD-DOLFIELD AVE TO DORRITHAN RD.
 CEM. CONC. PAVING SEVEN (7) INCHES THICK.
 PARAMOUNT CONST. CO. CONTRACTOR
 STARTED - 5-9-47 COMP. 6-2-47
 SCALE - 1" = 20.0' DATE - AUG 12, 47

1 Shot

30-100

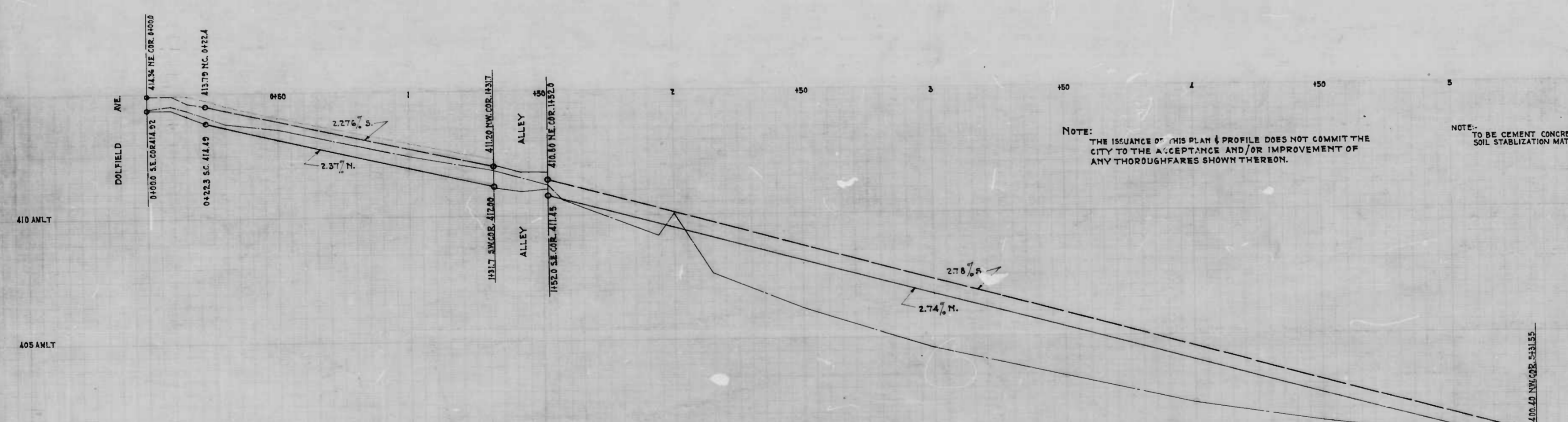
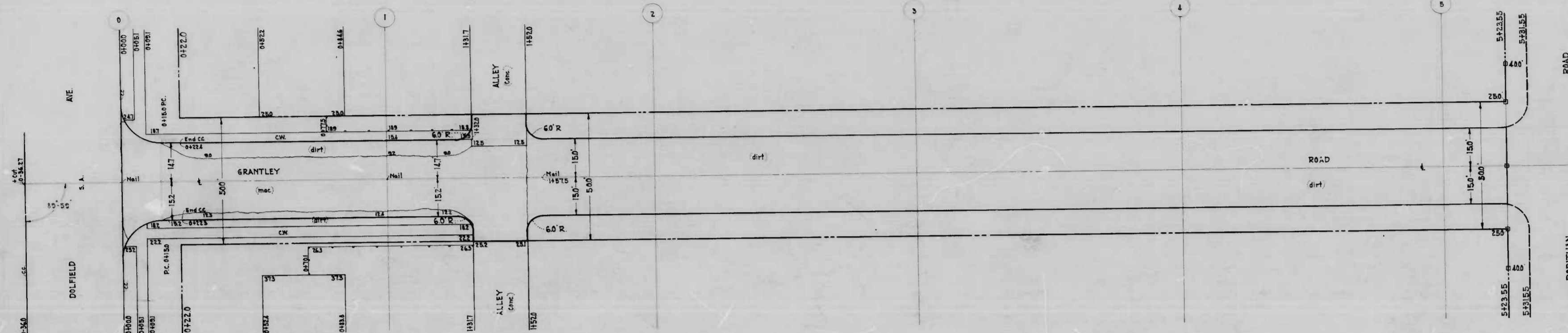

NOTE:
 THE ISSUANCE OF THIS PLAN & PROFILE DOES NOT COMMIT THE CITY TO THE ACCEPTANCE AND/OR IMPROVEMENT OF ANY THOROUGHFARES SHOWN THEREON.

NOTE:
 TO BE CEMENT CONCRETE PAVING 7" IN DEPTH. SOIL STABILIZATION MATERIAL OR UNDERDRAINS ARE NOT REQUIRED.

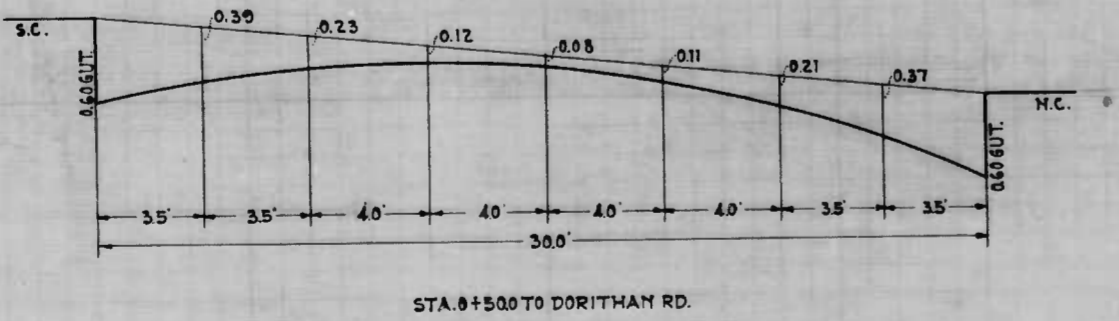

STA. 0+50.00 TO DORITHAN RD.

CITY OF BALTIMORE
 DEPARTMENT OF PUBLIC WORKS
 BUREAU OF HIGHWAYS
 PLAN & PROFILE
 GRANTLEY RD.- DOLFIELD AVE. TO DORITHAN RD.
 PLAN: 1"=200' BOOK NO. X-171
 SCALES: HOR.: 1"=200' VER.: 1"=20'
 DATE: MAR. 10, 1947
 CONT. NO. 827

APPROVED: *Henry Maskey* ASSOCIATE ENGINEER
 APPROVED: *Wm. J. Fisher* HIGHWAYS ENGINEER
 APPROVED: *Edward J. Heston* ENGR. PLANS & SURVEYS.
 APPROVED: *John R. Hill* CHIEF ENGINEER.

D. Maskey
 S. A. Bunn

1 Shot

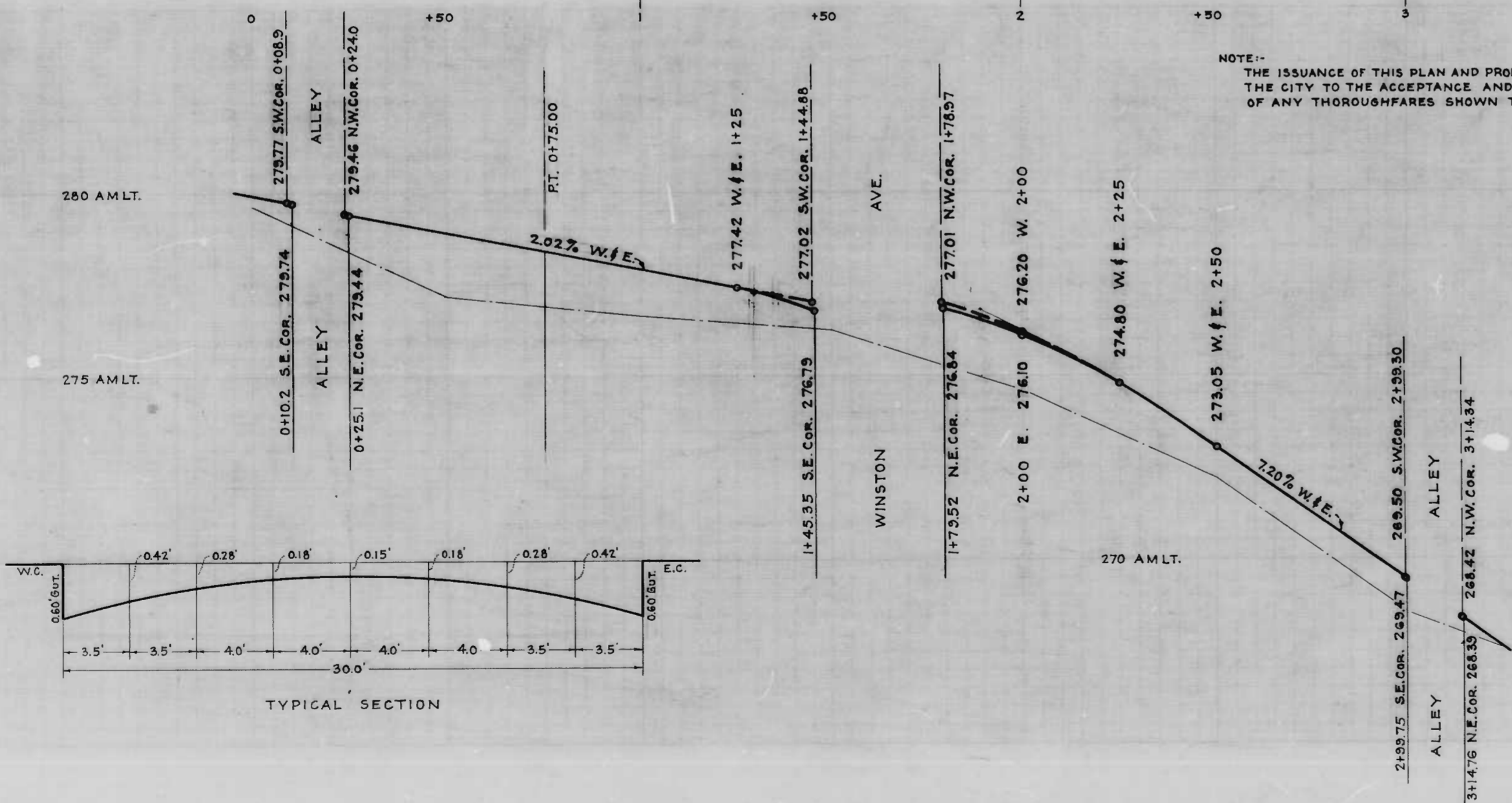
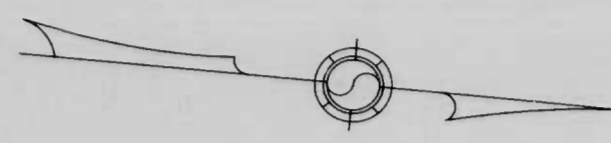
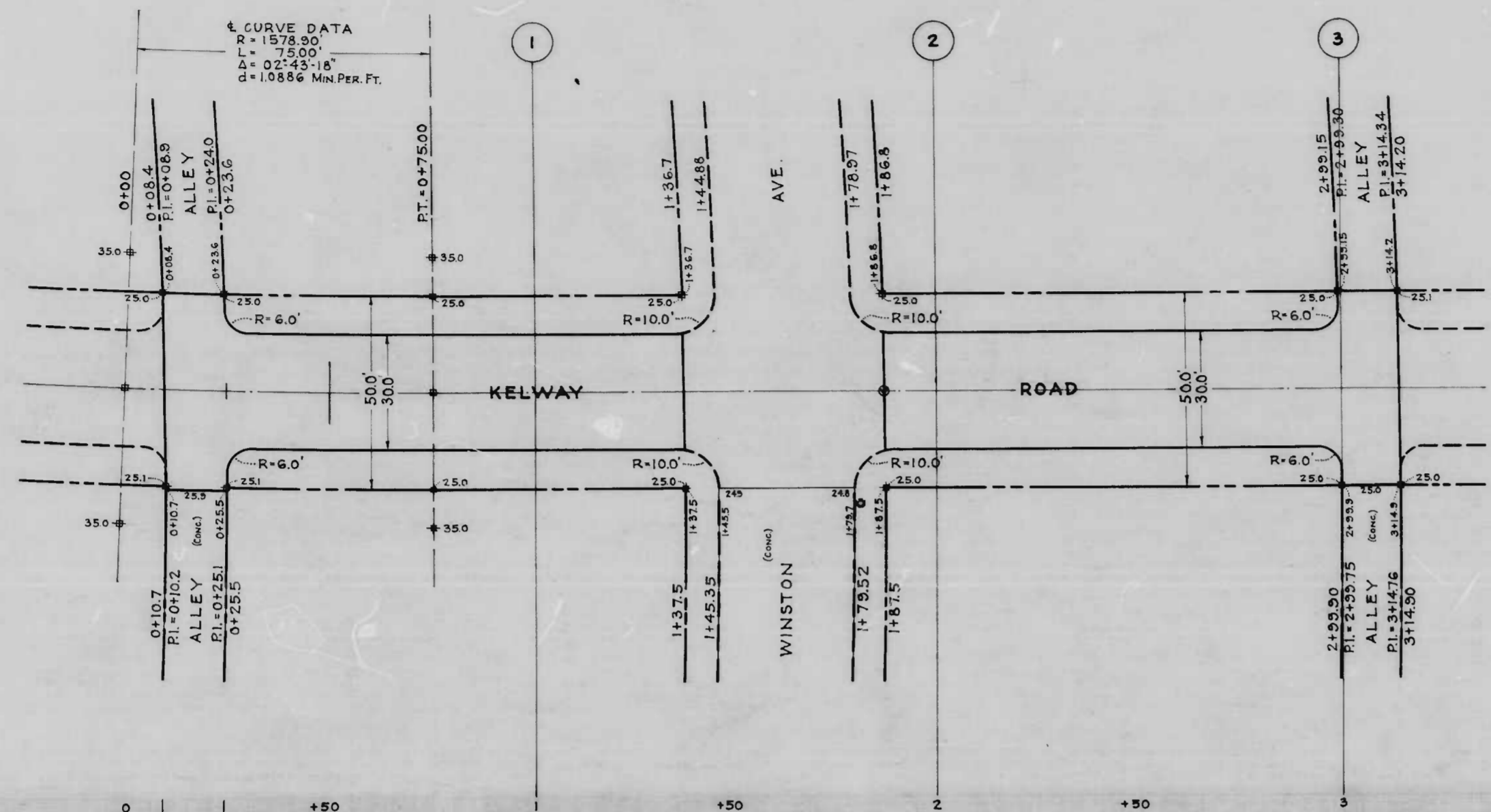

NOTE:- THE ISSUANCE OF THIS PLAN AND PROFILE DOES NOT COMMIT THE CITY TO THE ACCEPTANCE AND/OR IMPROVEMENT OF ANY THROUGHFARES SHOWN THEREON.

NOTE:- TO BE CEMENT CONCRETE PAVING 7" IN DEPTH. SOIL STABILIZATION MATERIAL OR UNDERDRAINS ARE NOT REQUIRED.

CITY OF BALTIMORE
 DEPARTMENT OF PUBLIC WORKS
 BUREAU OF HIGHWAYS
**PLAN AND PROFILE OF
 KELWAY ROAD**
 AL. S. OF WINSTON AVE - AL. N. OF WINSTON AVE.
 COMT. NO. 827

PLAN 1" = 20'
 SCALE: PROFILE - HOR. 1" = 20'
 VER. 1" = 2'

BOOK - X-213
 DATE - MARCH 18, 1947

APPROVED
Harvey Newberry
 ASSOCIATE ENGINEER

APPROVED
W. J. T. Fisher
 HIGHWAYS ENGINEER

APPROVED
Edmond H. Anderson
 ENGR. OF PLANS & SURVEYS

APPROVED
Walter R. Smith
 CHIEF ENGINEER

Jesse D. Carter

13-103

20-103

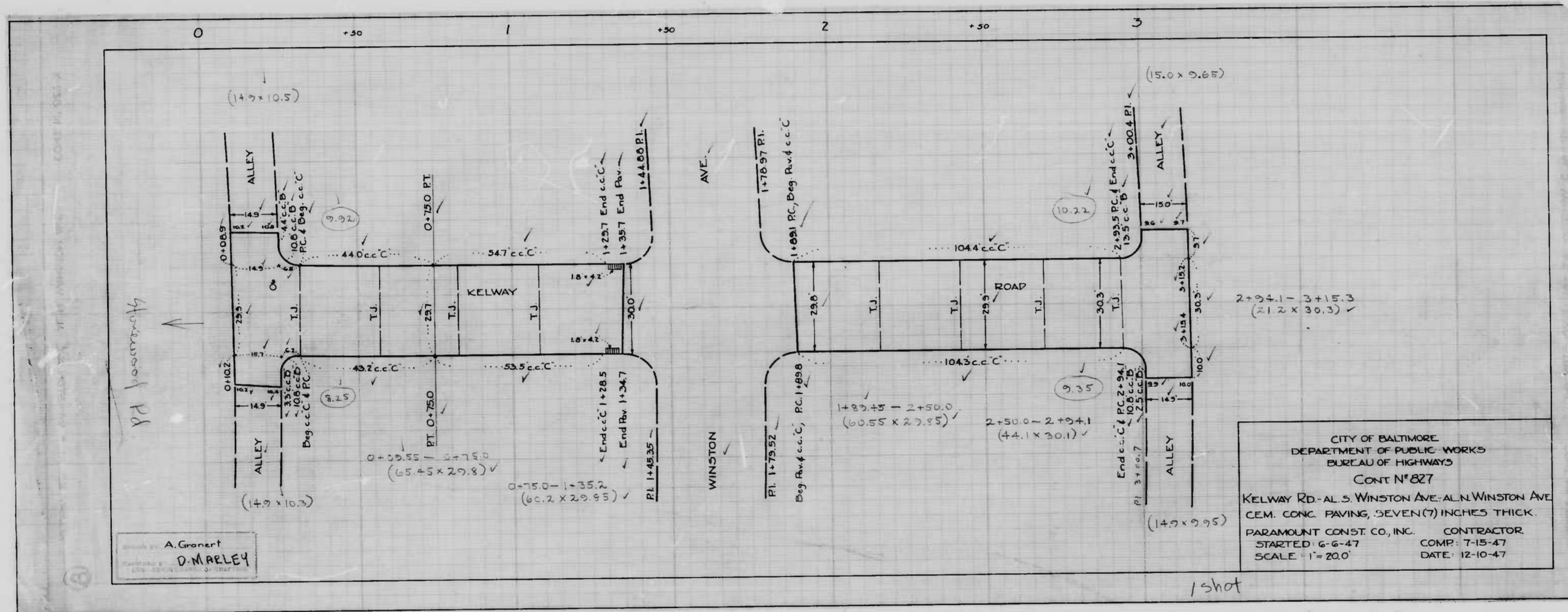

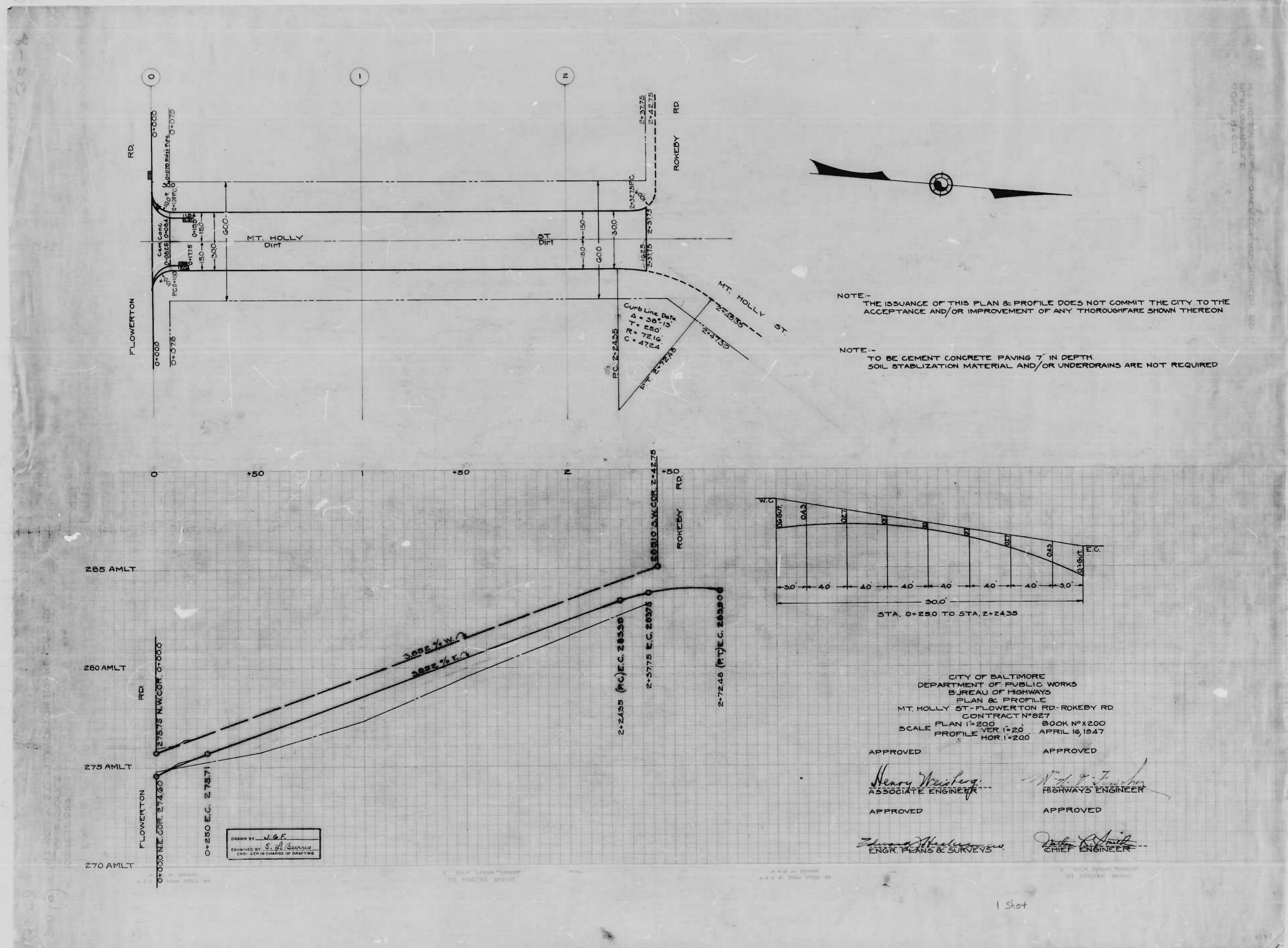

NOTE:-
THE ISSUANCE OF THIS PLAN & PROFILE DOES NOT COMMIT THE CITY TO THE ACCEPTANCE AND/OR IMPROVEMENT OF ANY THOROUGHFARE SHOWN THEREON

NOTE:-
TO BE CEMENT CONCRETE PAVING 7" IN DEPTH.
SOIL STABILIZATION MATERIAL AND/OR UNDERDRAINS ARE NOT REQUIRED

CITY OF BALTIMORE
DEPARTMENT OF PUBLIC WORKS
BUREAU OF HIGHWAYS
PLAN & PROFILE
MT. HOLLY ST-FLOWERTON RD-ROKEBY RD
CONTRACT NO. 827
SCALE PLAN 1"=200' BOOK NO. X200
PROFILE HOR. 1"=20' VER. 1"=20' APRIL 16, 1947

APPROVED *Henry Weisberg*
ASSOCIATE ENGINEER

APPROVED *W. J. Fisher*
HIGHWAYS ENGINEER

APPROVED *Edward Shepley*
ENGR. PLANS & SURVEYS

APPROVED *Arthur Smith*
CHIEF ENGINEER

DRAWN BY *V.G.F.*
EXAMINED BY *S. J. Dennis*
ENGR. IN CHARGE OF DRAFTING

1 Shot

827

RATIO - 24

10

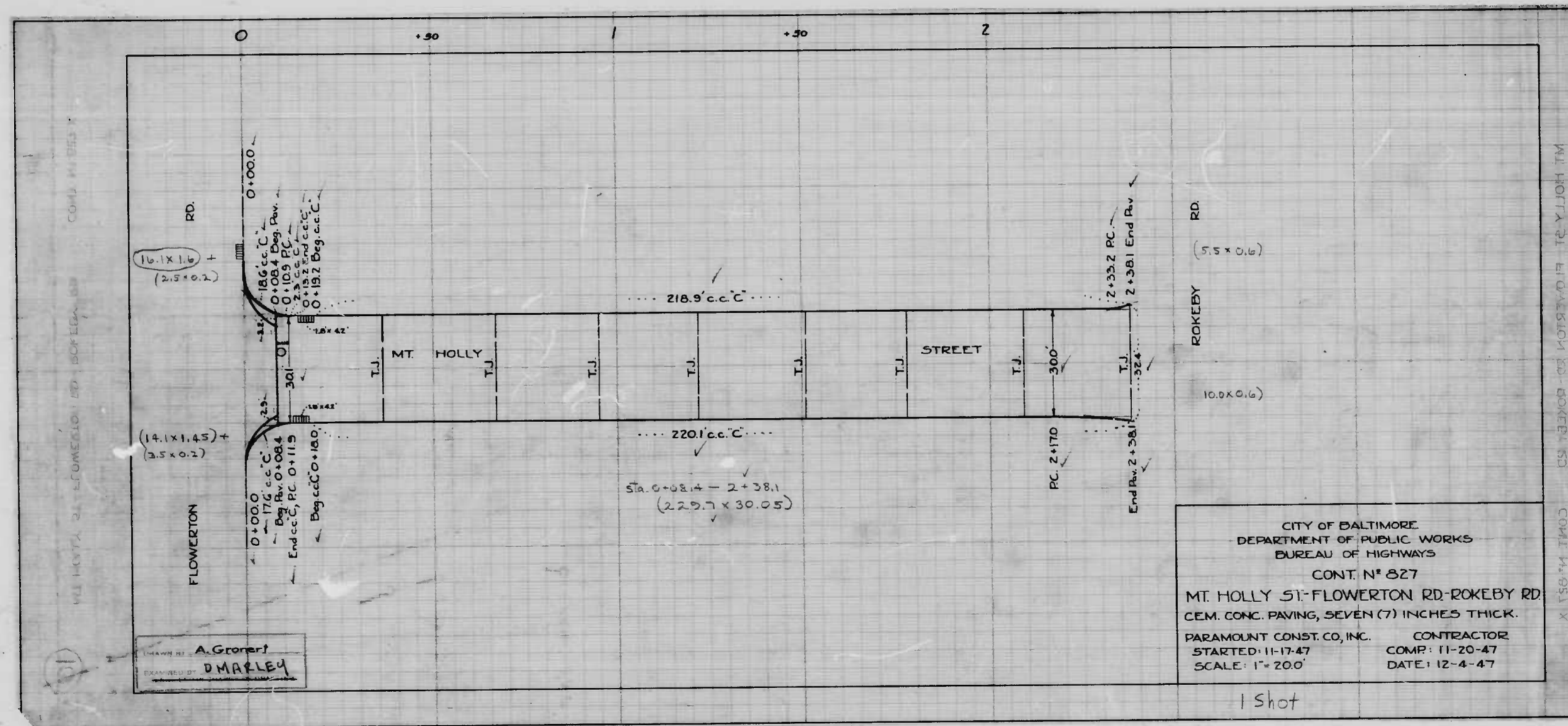

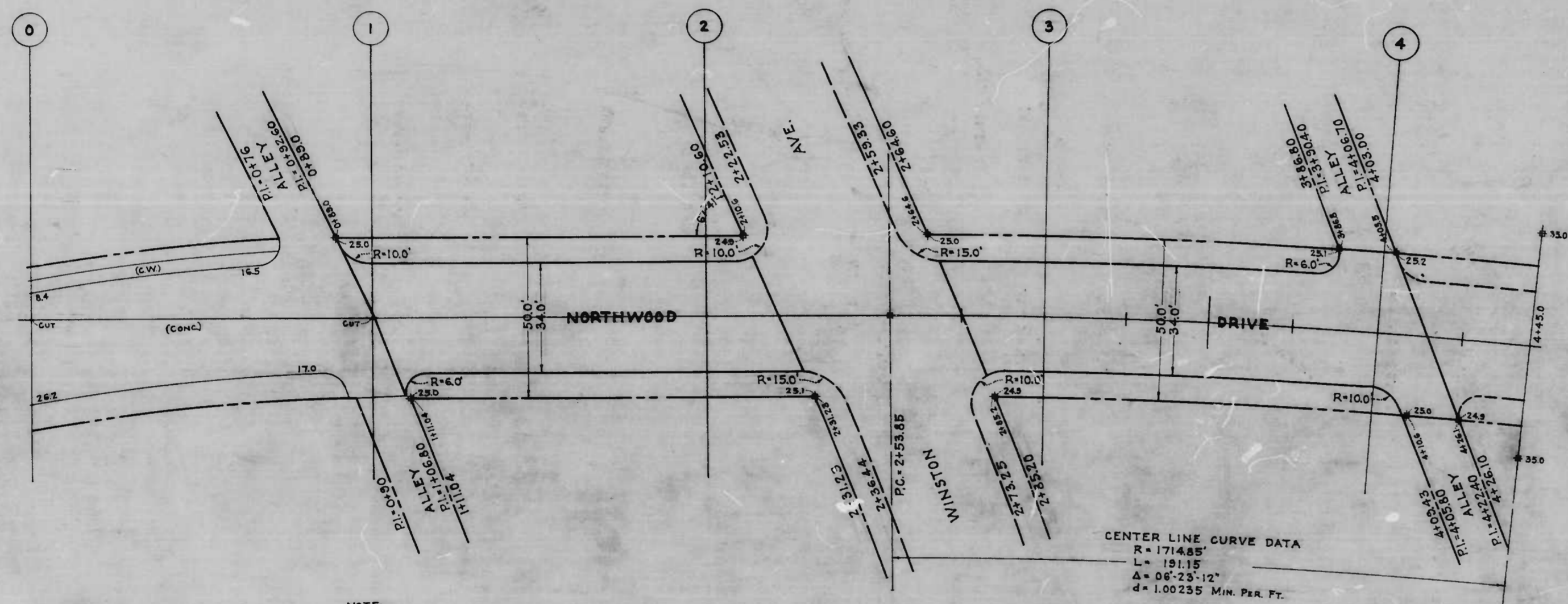

NOTE:-
 TO BE ELEMENT CONCRETE PAVING 7" IN DEPTH.
 SOIL STABILIZATION MATERIAL OR UNDERDRAINS ARE NOT REQUIRED.

CITY OF BALTIMORE
 DEPARTMENT OF PUBLIC WORKS
 BUREAU OF HIGHWAYS
**PLAN OF
 NORTHWOOD DRIVE**
 AL. S. OF WINSTON AVE - AL. N. OF WINSTON AVE.
 CONT. NO. 827

SCALE: 1"=20'

BOOK: X-213
 DATE: MARCH 13, 1947

APPROVED
Henry Weisberg
 ASSOCIATE ENGINEER

APPROVED
W. J. Fisher
 HIGHWAYS ENGINEER

APPROVED
Edward H. Hecker
 ENGR. OF PLANS & SURVEYS

APPROVED
Walter R. Smith
 CHIEF ENGINEER

CENTER LINE CURVE DATA
 R = 1714.85'
 L = 191.15'
 Δ = 08°-25'-12"
 d = 1.00235 MIN. PER FT.

NOTE:-
 THE ISSUANCE OF THIS PLAN DOES NOT COMMIT
 THE CITY TO THE ACCEPTANCE AND/OR IMPROVEMENT
 OF ANY THOROUGHFARES SHOWN THEREON.

1shot

WESLEY D. CARTER
W. D. Carter

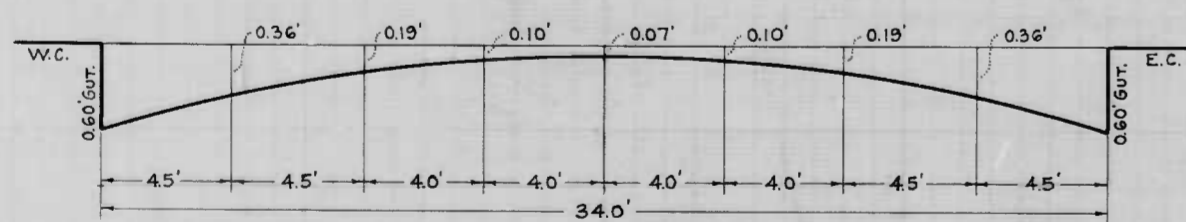
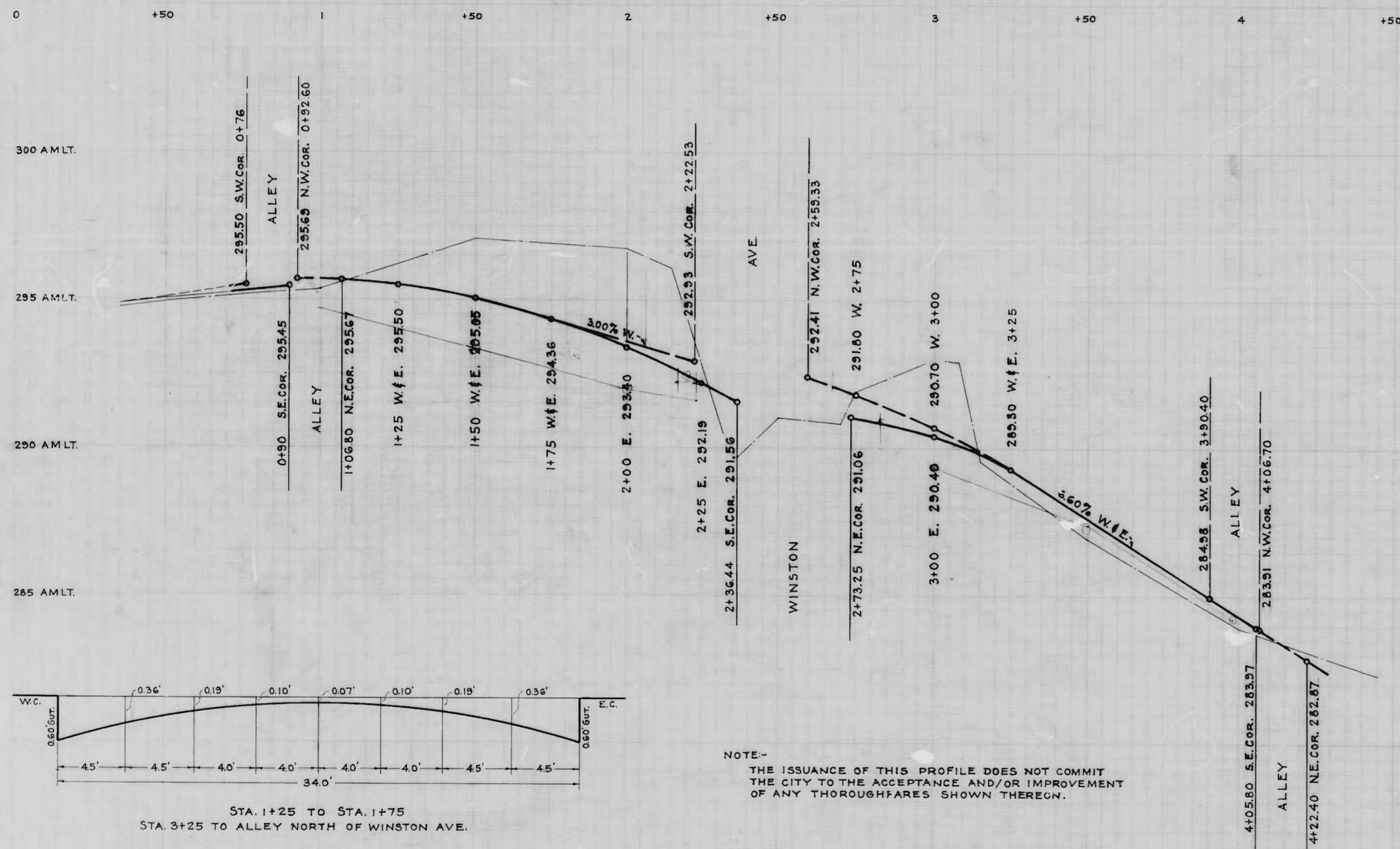

STA. 1+25 TO STA. 1+75
 STA. 3+25 TO ALLEY NORTH OF WINSTON AVE.

NOTE -
 THE ISSUANCE OF THIS PROFILE DOES NOT COMMIT
 THE CITY TO THE ACCEPTANCE AND/OR IMPROVEMENT
 OF ANY THOROUGHFARES SHOWN THEREON.

CITY OF BALTIMORE
 DEPARTMENT OF PUBLIC WORKS
 BUREAU OF HIGHWAYS
 PROFILE OF
 NORTHWOOD DRIVE
 AL. S. OF WINSTON AVE - AL. N. OF WINSTON AVE
 CONT. NO. 827 BOOK-X-213
 DATE-MARCH 13, 1947

APPROVED
Henry Weisler
 ASSOCIATE ENGINEER

APPROVED
W. J. Fisher
 HIGHWAYS ENGINEER

APPROVED
Edward Wheeler, Jr.
 ENGR. OF PLANS & SURVEYS

APPROVED
Walter R. Smith
 CHIEF ENGINEER

1 shot

JESSE D. CARTER
 S. L. CURTIS

