

WARD 25 - SECTION 5 - BLOCK 7419

CONSOLIDATED GAS ELECTRIC LIGHT & POWER Co.

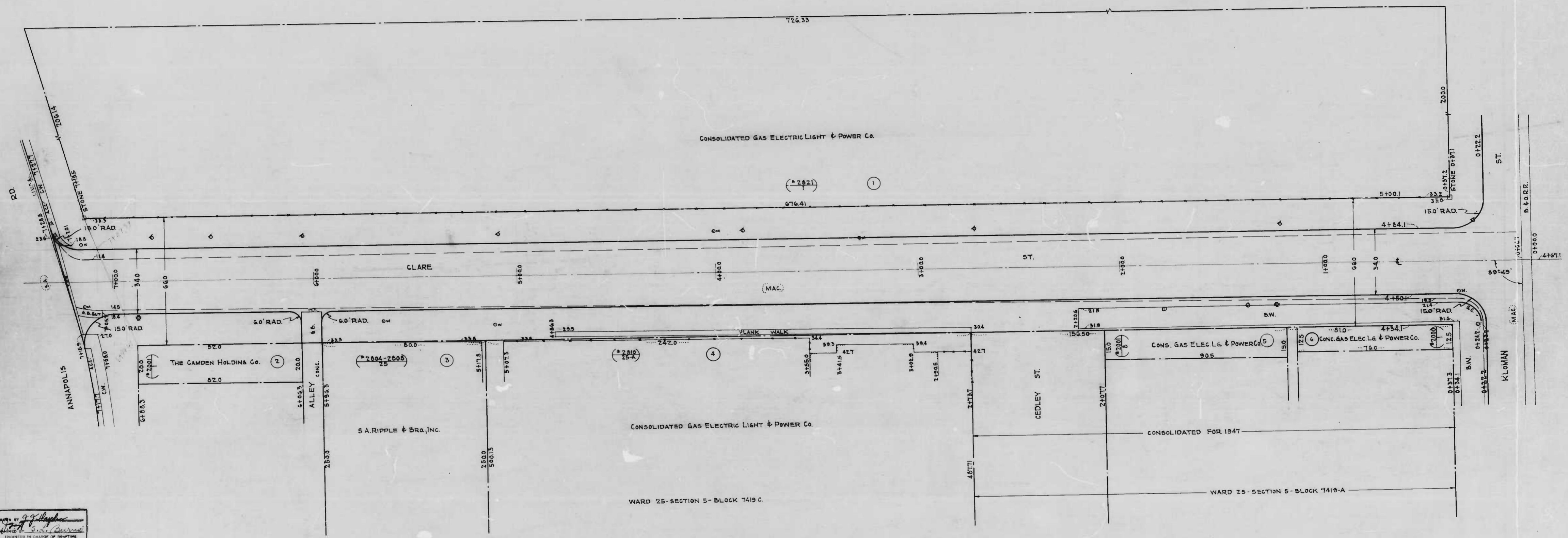

DRAWN BY *J. J. Hughes*
 CHECKED BY *W. C. ...*
 ENGINEER IN CHARGE OF DRAFTING

02

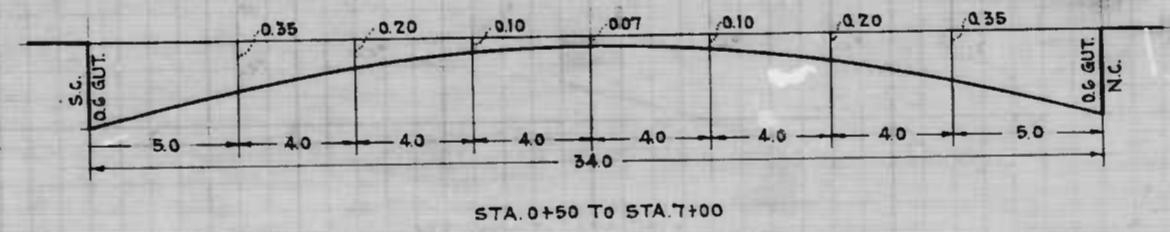
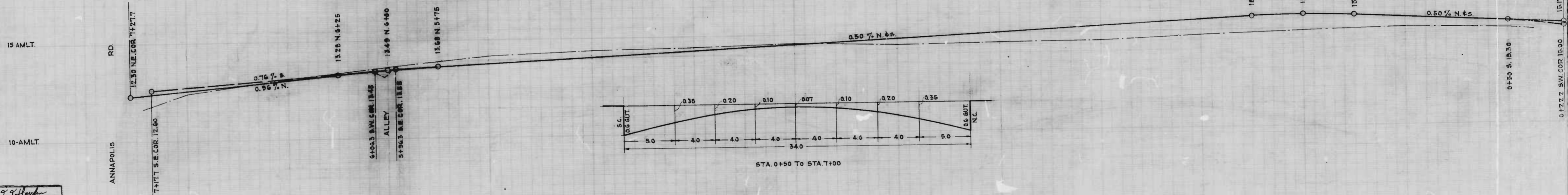

DRAWN BY *J. J. [Signature]*
 CHECKED BY *[Signature]*
 ENGINEER IN CHARGE *[Signature]*

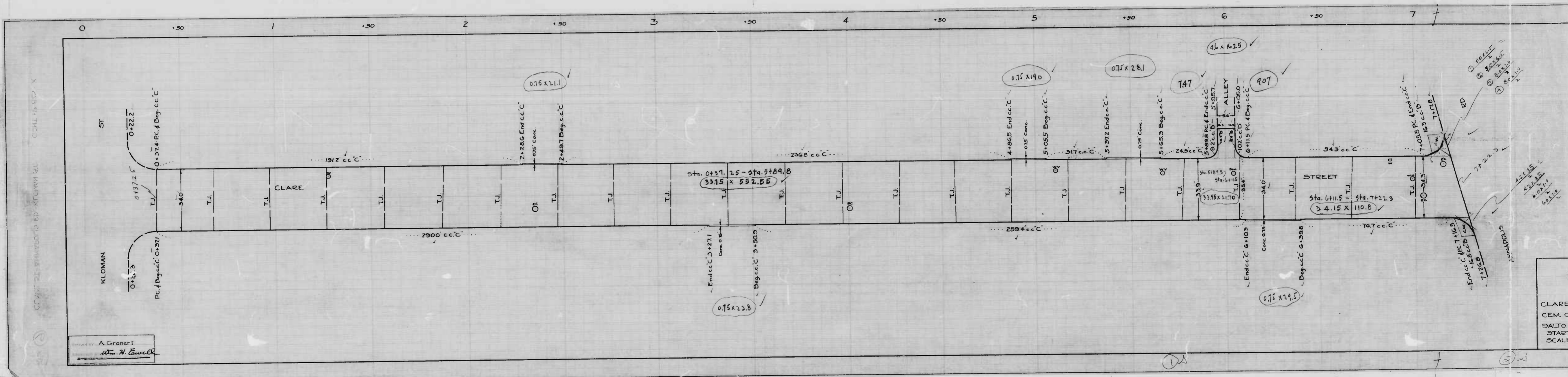

CLARE
 CEM. C.
 BALTO.
 STREET
 SCALE

WARD 25 - SECTION 5 - BLOCK 7419

CONSOLIDATED GAS ELECTRIC LIGHT & POWER Co.

CONSOLIDATED GAS ELECTRIC LIGHT & POWER Co.

WARD 25 - SECTION 5 - BLOCK 7419 C.

CONSOLIDATED FOR 1947

WARD 25 - SECTION 5 - BLOCK 7419-A

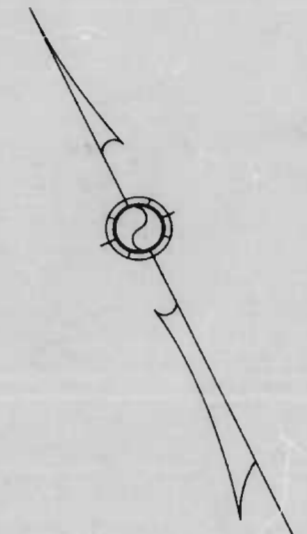

(NO) PLAT NO.
 (NO) HOUSE OR DEV. LOT NO.
 (NO) APPEAL TAX COURT LOT NO.
 BLOCK - 7419-7419A & 7419C
 WARD - 25
 SECTION - 5

FILED Aug 8-1946
 BUREAU OF HIGHWAYS
 PER [Signature]

CITY OF BALTIMORE
 DEPARTMENT OF PUBLIC WORKS
 BUREAU OF HIGHWAYS
 ASSESSMENT PLAT N° 876-A
 CLARE ST. - ANNAPOLIS RD. TO KLOMAN ST.
 CONT. N° 823

SCALE - 1" = 200' Book N° X-181
 APPROVED - JULY 19, 1946
 APPROVED - APPROVED -
 Henry Waisberg Edward J. [Signature]
 ASSOCIATE ENGINEER ENGR. - PLANS & SURVEYS
 APPROVED - APPROVED -
 [Signature] [Signature]
 HIGHWAYS ENGINEER CHIEF ENGINEER

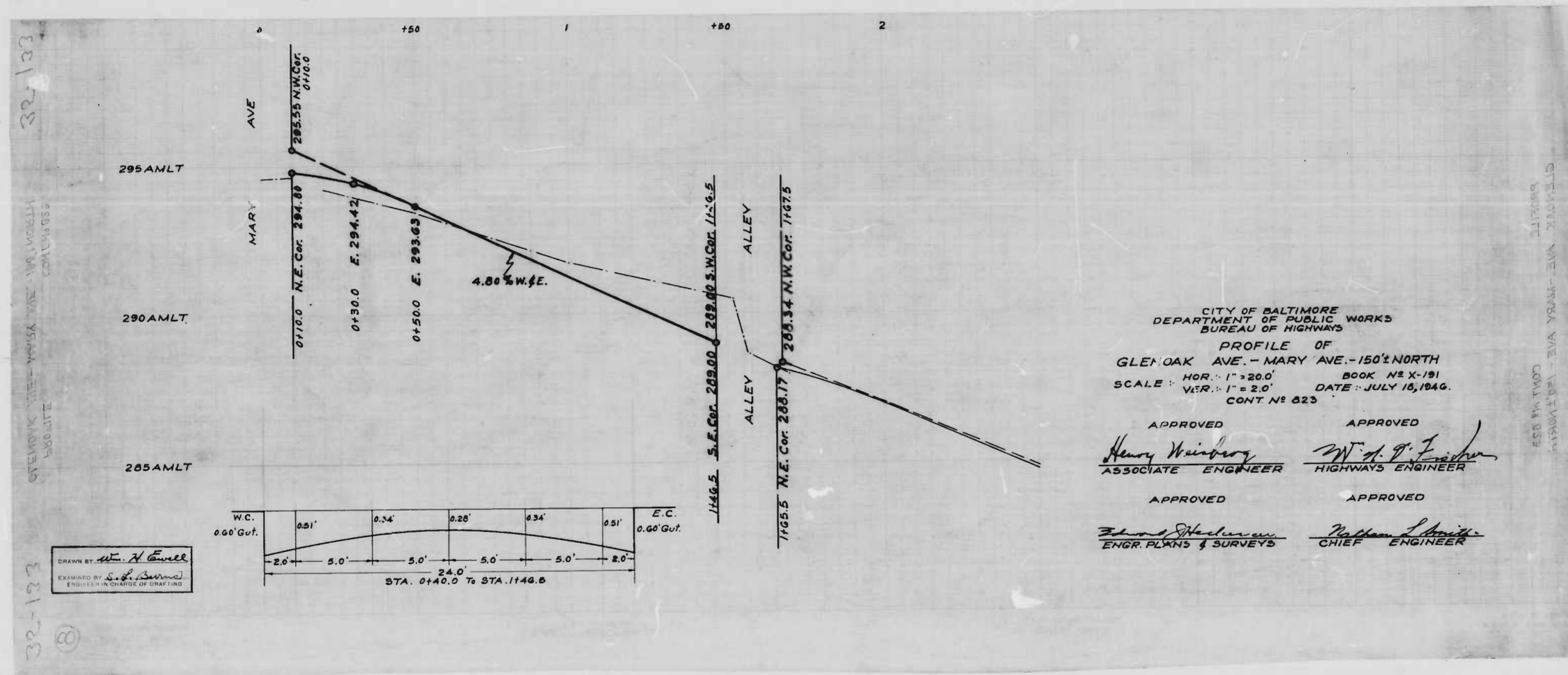

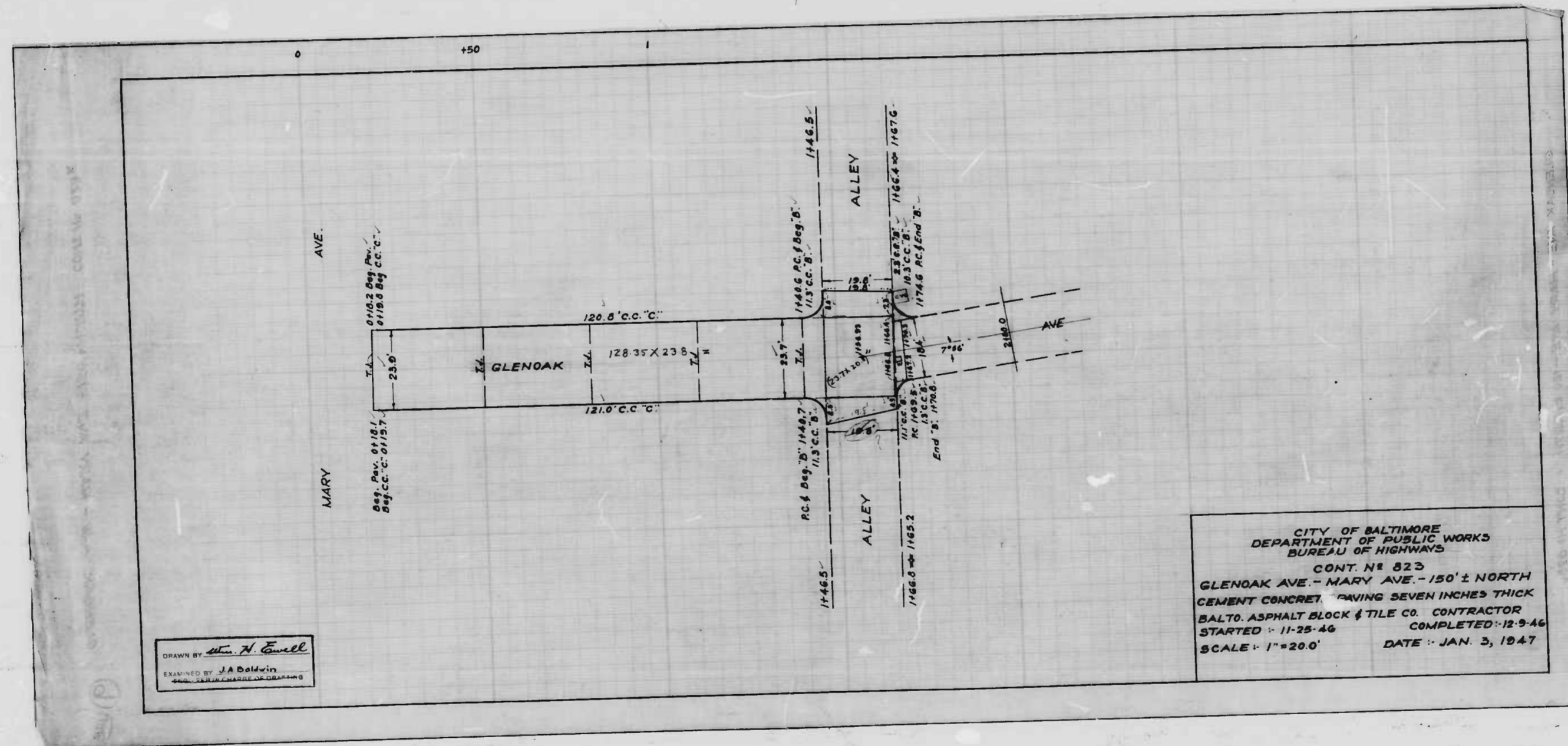

BENCH MARKS
 N^o5592 - \square CUT IN W. END OF BOTTOM GRAN. STEP MAIN
 ENTRANCE TO WESTPORT POWER HOUSE — ELEV. 15.35
 N^o5595 - Brass SCREW SET IN N. END OF CONC. DOOR SILL
 OF LOADING PLATFORM ENTRANCE FOR 2 ST. BRICK ON W.
 SIDE OF CLARE ST. 100' S. OF ANNAPOLIS RD. — ELEV. 14.21

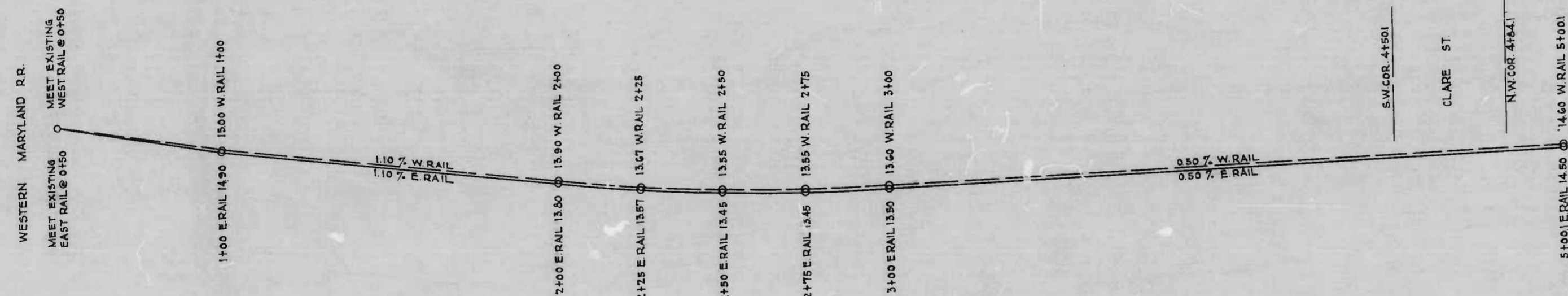

DRAWN BY J.J. HAYDEN
 EXAMINED BY J.C. [Signature]
 ENG. DIVISION, BUREAU OF HIGHWAYS

CITY OF BALTIMORE
 DEPARTMENT OF PUBLIC WORKS
 BUREAU OF HIGHWAYS
 PROFILE OF RAILWAY TRACKS
 KLOMAN ST. - WESTERN MARYLAND R.R. TO CLARE ST.
 CONT. N^o 823
 SCALES - HOR. 1" = 200'
 VER. 1" = 20'
 APPROVED: [Signature] ASSOCIATE ENGINEER
 APPROVED: [Signature] HIGHWAYS ENGINEER
 BOOK NEX-181
 JULY 15, 1944

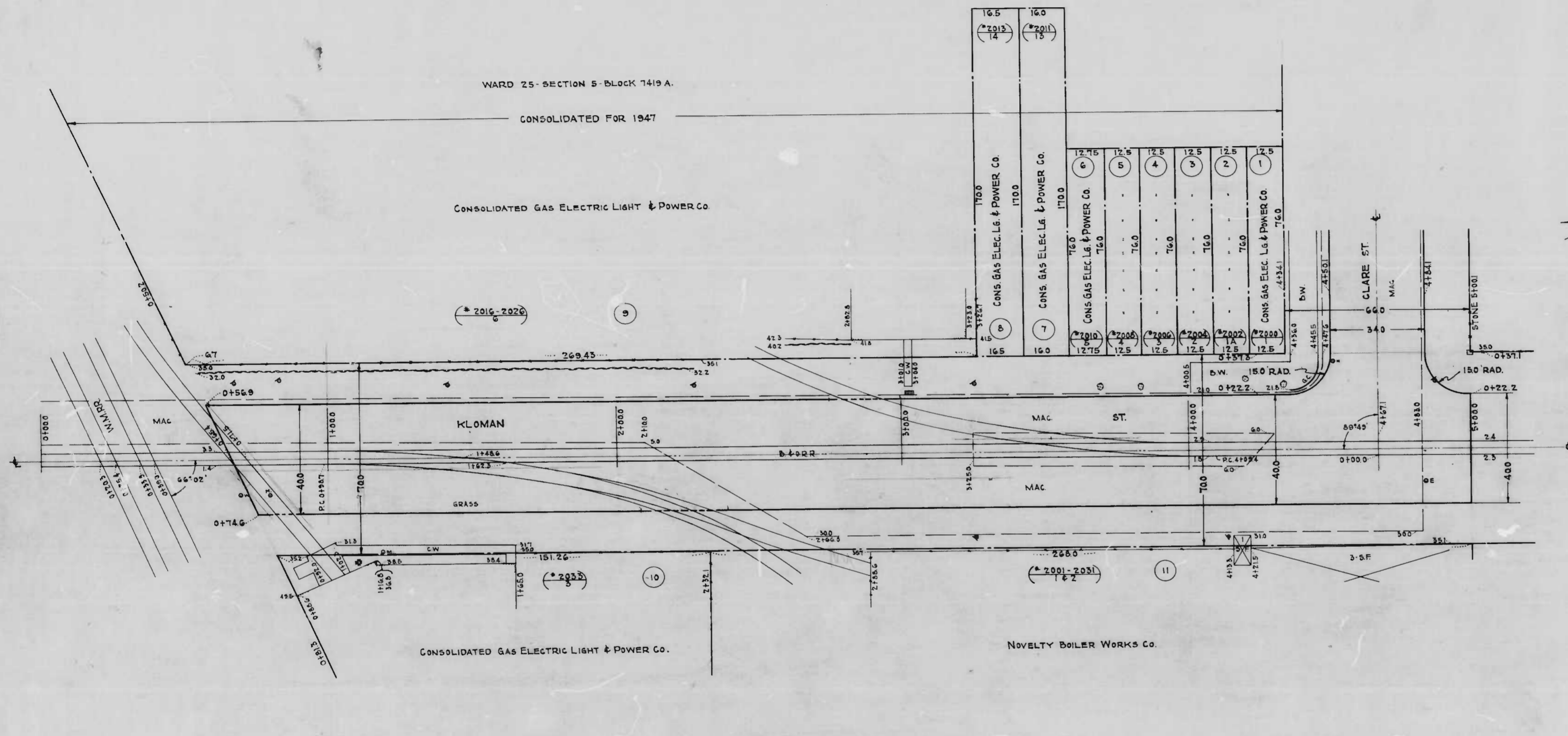

NO PLAT NO.
 NO HOUSE OR DEV. LOT NO.
 NO APPEAL TAX COURT LOT NO.
 BLOCK - 7419 A & 7612
 WARD - 25
 SECTION - 5

FILED *Aug 8 - 1946*
 BUREAU OF HIGHWAYS
 PER *[Signature]*

CITY OF BALTIMORE
 DEPARTMENT OF PUBLIC WORKS
 BUREAU OF HIGHWAYS
 ASSESSMENT PLAT NO. 577-A
 KLOMAN ST. - W.M.R.R. TO CLARE ST.
 CONT. NO. 823
 SCALE: 1" = 200'
 APPROVED: _____
 BOOK NO. X-181
 JULY 19, 1946
 APPROVED: _____

Henry W. Fisher
 ASSOCIATE ENGINEER

Edward J. Anderson
 ENGR.-PLANS & SURVEYS

W. H. Fisher
 HIGHWAYS ENGINEER

Walter D. Smith
 CHIEF ENGINEER

DRAWN BY *[Signature]*
 8-15-46
 ENGINEER IN CHARGE OF DRAWING

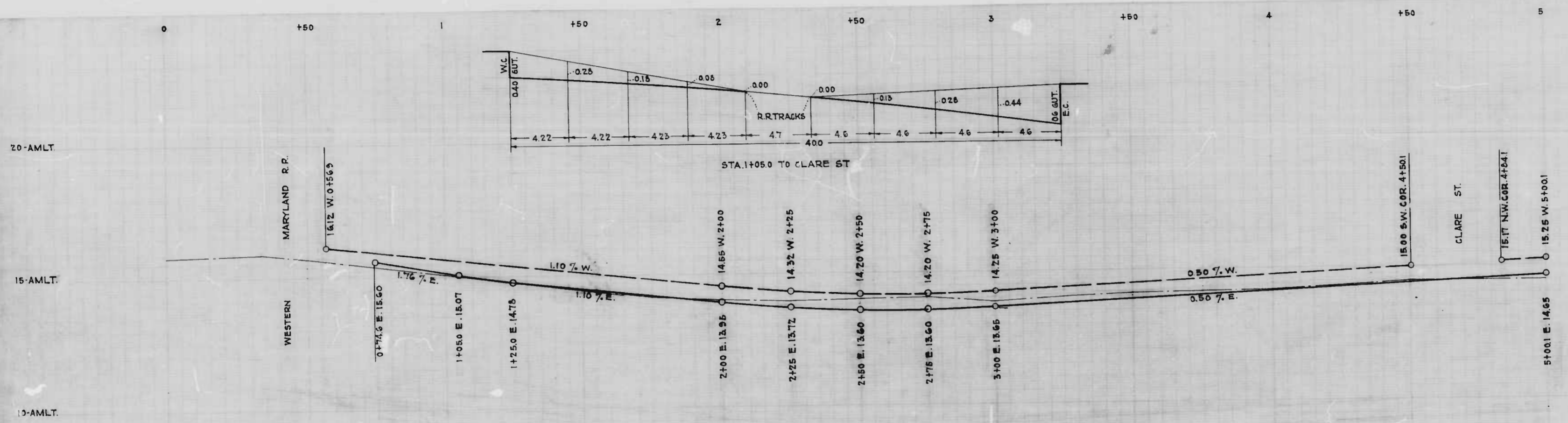

CITY OF BALTIMORE
 DEPARTMENT OF PUBLIC WORKS
 BUREAU OF HIGHWAYS
 PROFILE OF
 KLOMAN ST. - W.M.R.R. TO CLARE ST.
 CONT. NO. 823
 HOR. - 1" = 200'
 VER. - 1" = 20'
 BOOK N-X-181
 JULY 19, 1946

APPROVED - *Henry Wiskey* ASSOCIATE ENGINEER
 APPROVED - *Edward J. ...* ENGR. - PLANS & SURVEYS
 APPROVED - *Wm. J. ...* HIGHWAYS ENGINEER
 APPROVED - *Paul ...* CHIEF ENGINEER

DRAWN BY *J. J. ...*
 CHECKED BY *W. J. ...*
 ENGINEER IN CHARGE OF DRAWING

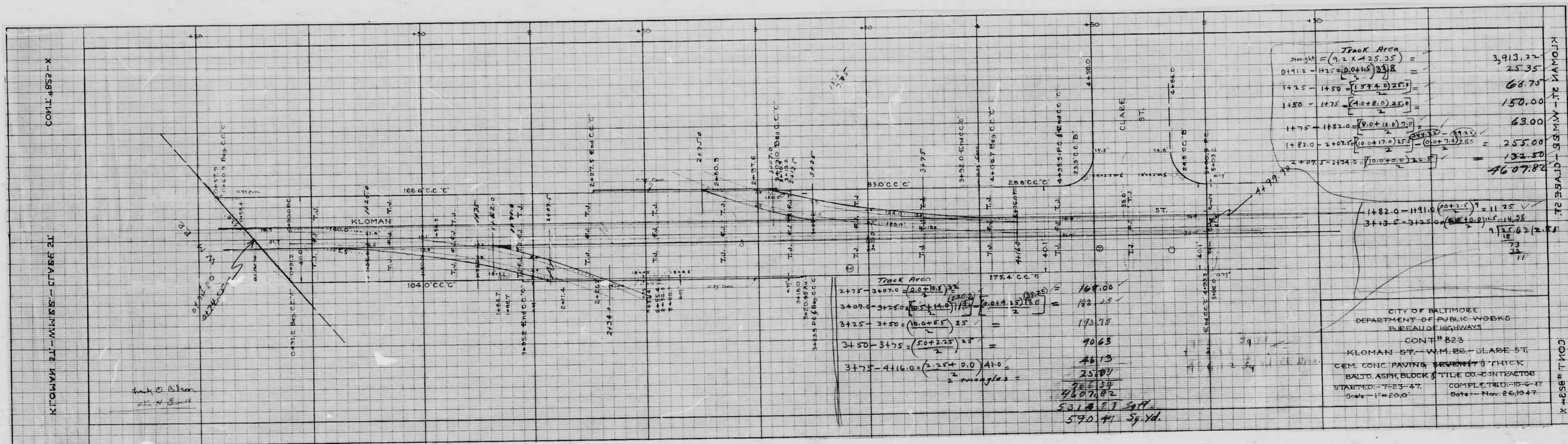

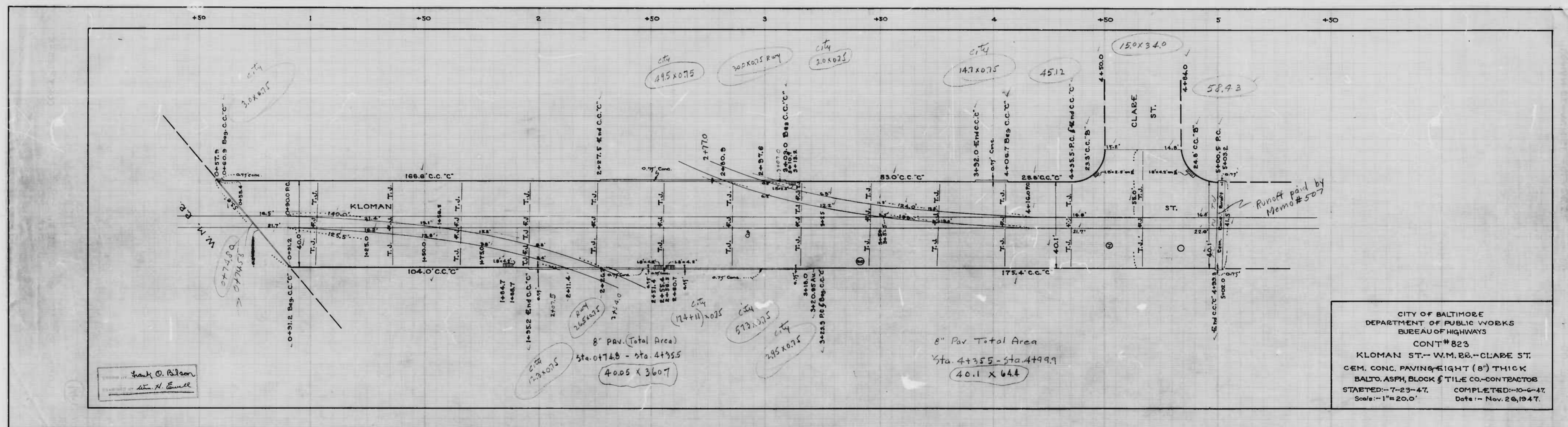

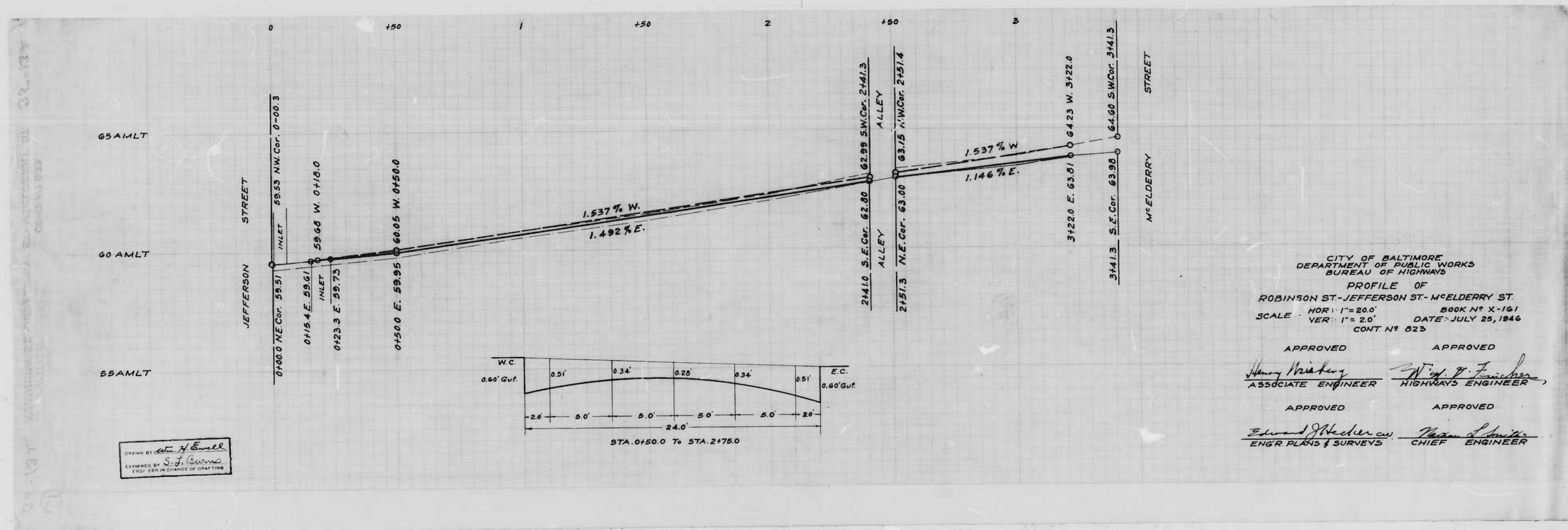

DRAWN BY *H. E. Hume*
 EXAMINED BY *S. J. Curran*
 ENGR. IN CHARGE OF DRAFTING

CITY OF BALTIMORE
 DEPARTMENT OF PUBLIC WORKS
 BUREAU OF HIGHWAYS
 PROFILE OF
 ROBINSON ST-JEFFERSON ST-M'ELDERRY ST.
 HOR. 1" = 20.0' BOOK N° X-161
 VER. 1" = 2.0' DATE: JULY 25, 1946
 CONT N° 025

APPROVED *Henry Weicker* ASSOCIATE ENGINEER
 APPROVED *W. J. Fisher* HIGHWAYS ENGINEER
 APPROVED *Edward J. Weicker* ENGR. PLANS & SURVEYS
 APPROVED *Nathan L. Smith* CHIEF ENGINEER

