

NOTE: THE ISSUANCE OF THIS PLAN & PROFILE DOES NOT COMMIT THE CITY TO THE ACCEPTANCE AND/OR IMPROVEMENT OF ANY THOROUGHFARES SHOWN THEREON.

3  
 440.26  
 Check limit of Pav.  
 Paved Stop  
 5.75

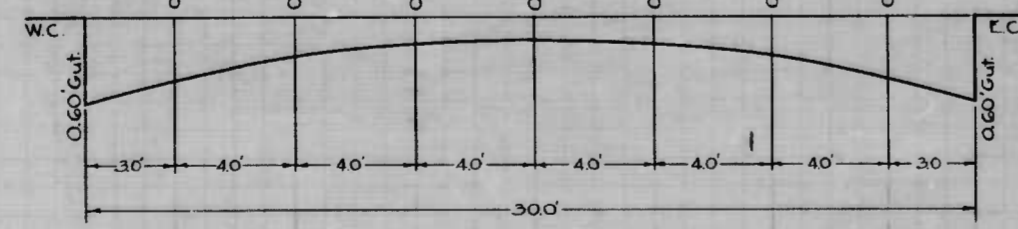

DRAWN BY A. Groner  
 S. P. J. J. J. J.  
 ENGINEER

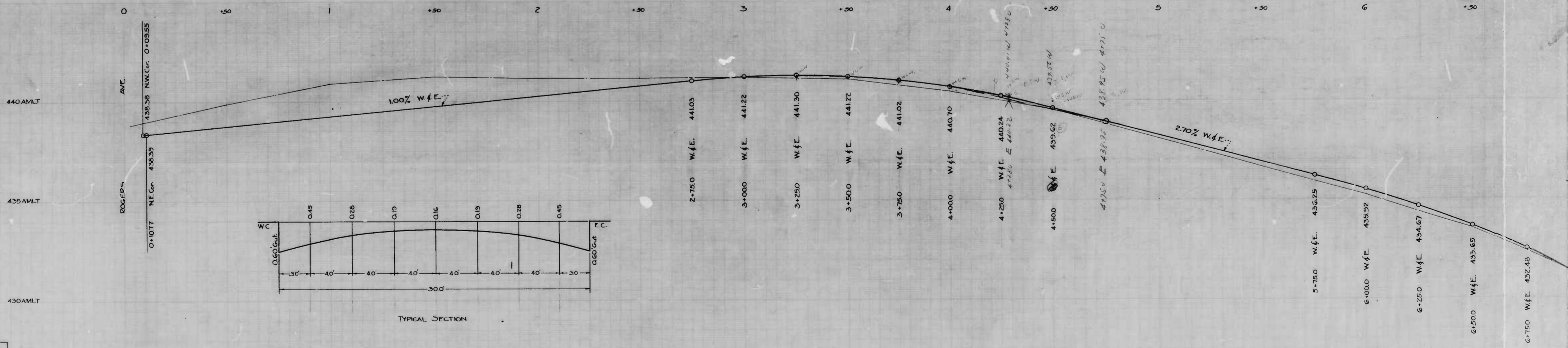

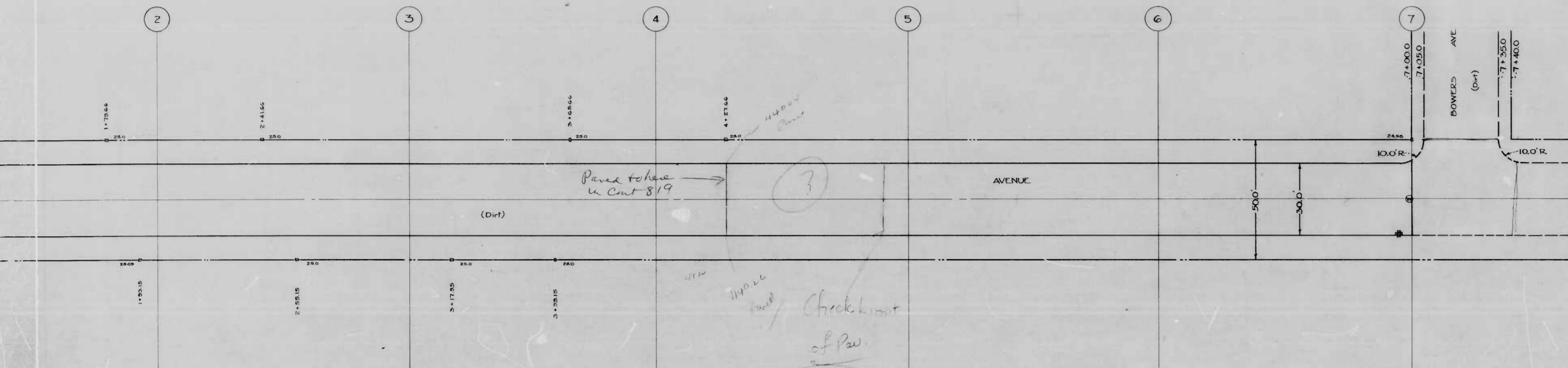

NOTE: THE ISSUANCE OF THIS PLAN & PROFILE DOES NOT COMMIT THE CITY TO THE ACCEPTANCE AND/OR IMPROVEMENT OF ANY THOROUGHFARES SHOWN THEREON.

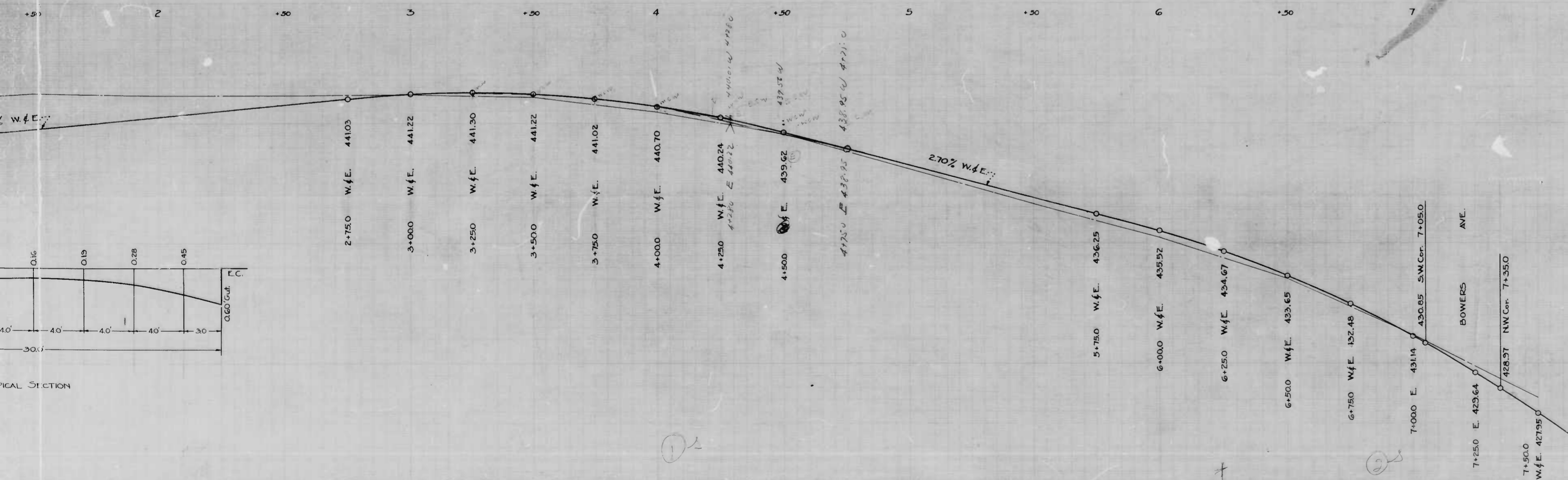

CITY OF BALTIMORE  
 DEPARTMENT OF PUBLIC WORKS  
 BUREAU OF HIGHWAYS  
 PLAN & PROFILE  
 BELLE AVE. - ROGERS AVE. - BOWERS AVE.  
 CONT. NO. 819 BOOK NO. X-207  
 SCALES: PLAN - 1"=20' PROFILE - 1"=20'  
 FOR: JUNE 6, 1946  
 APPROVED: *Henry Weisberg* ASSOCIATE ENGINEER  
 APPROVED: *W. J. ...* HIGHWAYS ENGINEER  
 APPROVED: *Edmund ...* ENGR. PLANS & SURVEYS  
 APPROVED: *Walter ...* CHIEF ENGINEER

BELLE AVE. - ROGERS AVE. - BOWERS AVE. CONT. NO. 819



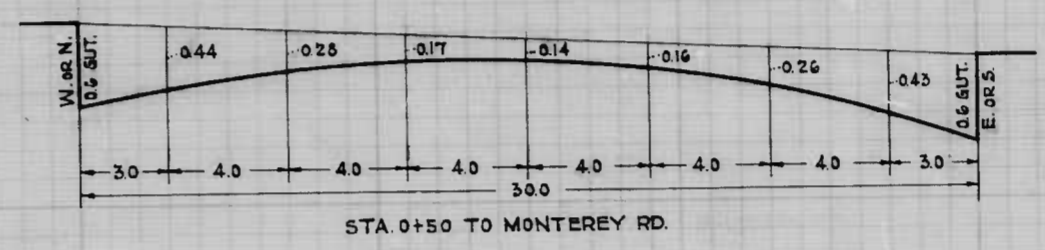

Note: - The Issuance of This Profile Does Not Commit The City To The Acceptance And /or Improvement of Any Thoroughfares Shown Thereon.

Note: - At Sta. 2+00 - W. Becomes N.  
E. Becomes S.

CITY OF BALTIMORE  
DEPARTMENT OF PUBLIC WORKS  
BUREAU OF HIGHWAYS  
PROFILE OF  
DELVERNE RD. - CHESTNUT HILL AVE. TO MONTEREY RD.  
CONT. NA 518

SCALES: - HOR. 1" = 200'  
VER. 1" = 20'

BOOK N° X 294  
JUNE 11, 1945

APPROVED - *Henry Weiskopf*  
ASSOCIATE ENGINEER

APPROVED - *W. J. [Signature]*  
HIGHWAYS ENGINEER

APPROVED - *Edmond [Signature]*  
ENGR. PLANS & SURVEYS

APPROVED - *Walter [Signature]*  
CHIEF ENGINEER

DRAWN BY: J. J. HAYDEN  
EXAMINED BY: S. J. [Signature]  
EXTENDING ENGINEER OF DRAWING



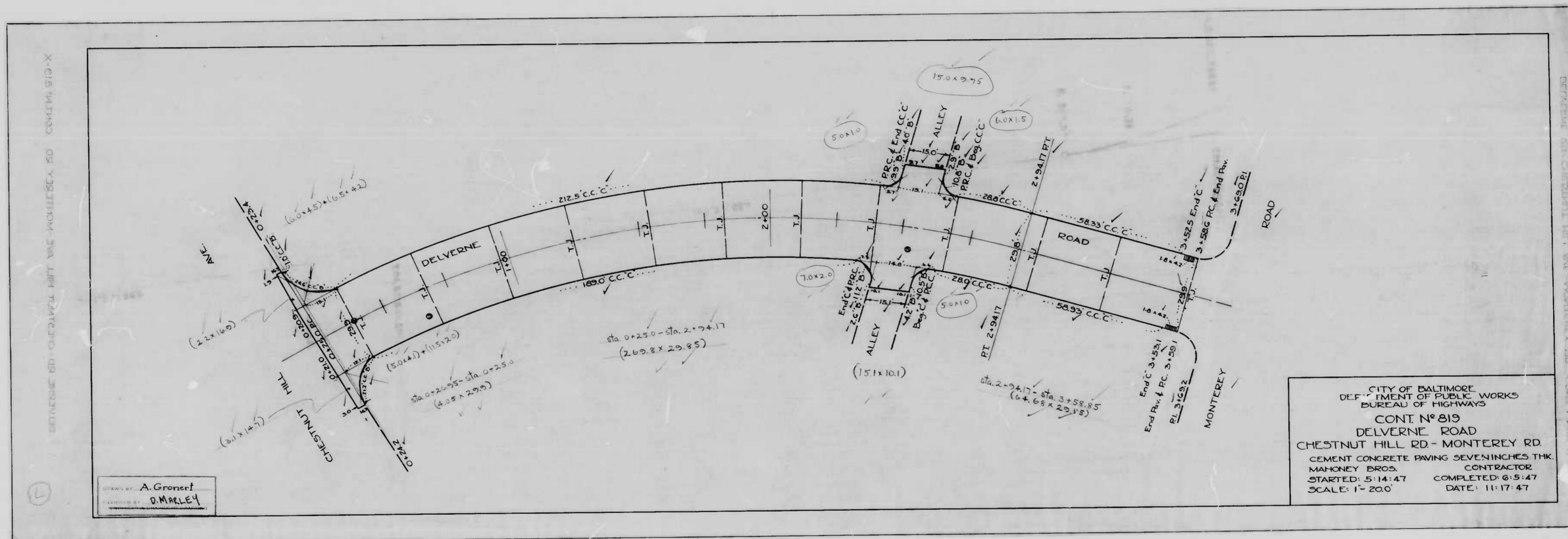

DESIGNED BY: A. Gronert  
 DRAWN BY: D. MARLEY

CITY OF BALTIMORE  
 DEPARTMENT OF PUBLIC WORKS  
 BUREAU OF HIGHWAYS  
 CONT. NO. 819  
 DELVERNE ROAD  
 CHESTNUT HILL RD. - MONTEREY RD.  
 CEMENT CONCRETE PAVING SEVEN INCHES THK.  
 MAHONEY BROS. CONTRACTOR  
 STARTED: 5-14-47 COMPLETED: 6-5-47  
 SCALE: 1" = 20' DATE: 11-17-47

DEFINITION FOR CHESTNUT HILL AND MONTEREY RD. CONTINUED FROM SHEET 818

DEFINITION FOR CHESTNUT HILL AND MONTEREY RD. CONTINUED FROM SHEET 818

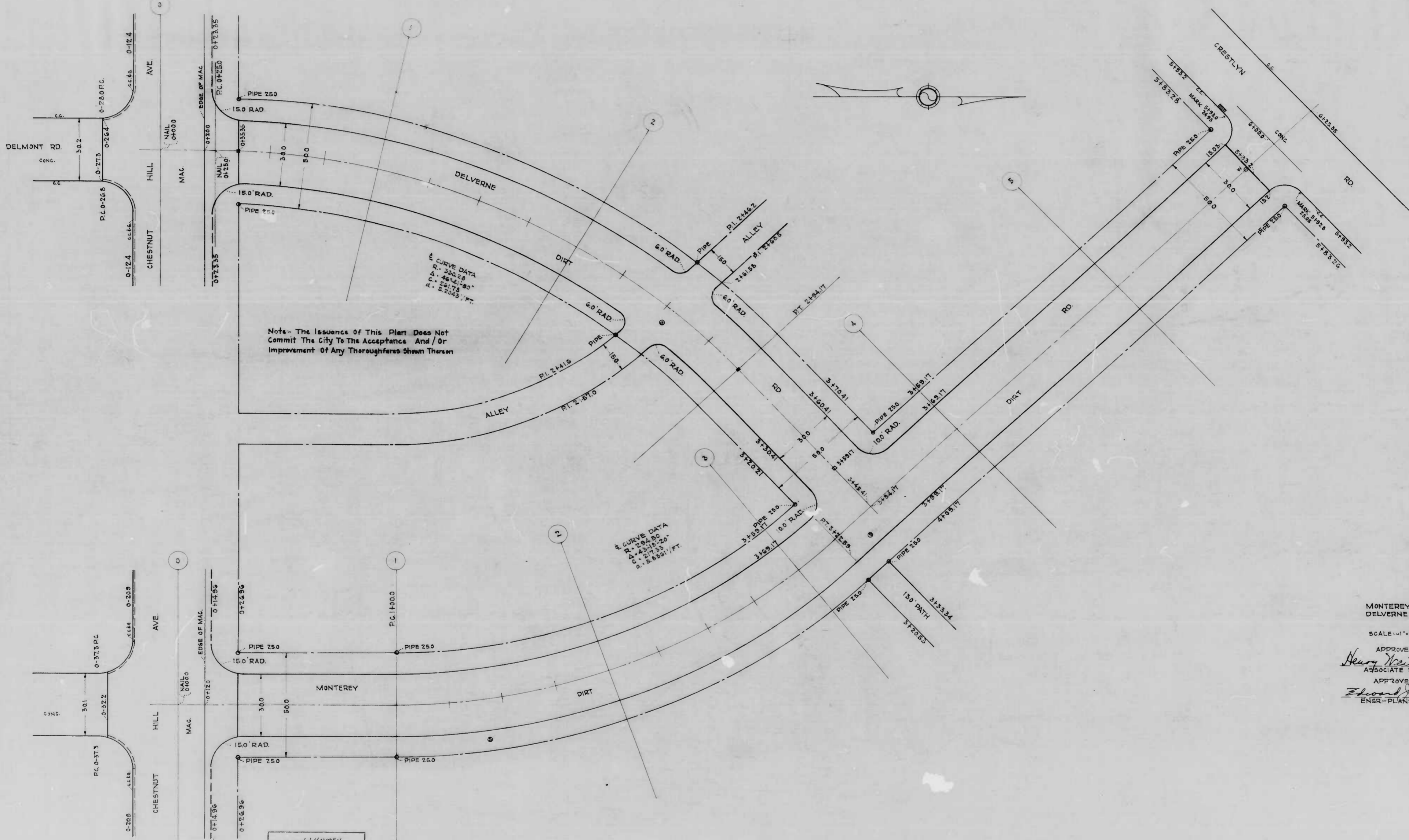

Note - The issuance of this plan does not commit the City to the acceptance and/or improvement of any thoroughfares shown thereon.

CURVE DATA  
 R. 240.00  
 Δ. 45.00  
 C. 201.78  
 d. 8.5301 / FT.

DESIGNED BY J.J. HAYDEN  
 ENGINEER S.B. CORNELL  
 ENGINEER

CITY OF BALTIMORE  
 DEPARTMENT OF PUBLIC WORKS  
 BUREAU OF HIGHWAYS  
 PLAN OF  
 MONTEREY RD. - CHESTNUT HILL AVE. TO CRESTLYN RD.  
 DELVERNE RD. - CHESTNUT HILL AVE. TO MONTEREY RD.  
 CONT. No. 519

SCALE: 1" = 200'

BOOK No. X-204  
 JUNE 7, 1946

APPROVED: *Henry Weisberg* ASSOCIATE ENGINEER  
 APPROVED: *Edward H. Hadler* ENGR. - PLANS & SURVEYS  
 APPROVED: *Wm. H. Fisher* HIGHWAYS ENGINEER  
 APPROVED: *Arthur R. Smith* CHIEF ENGINEER

02



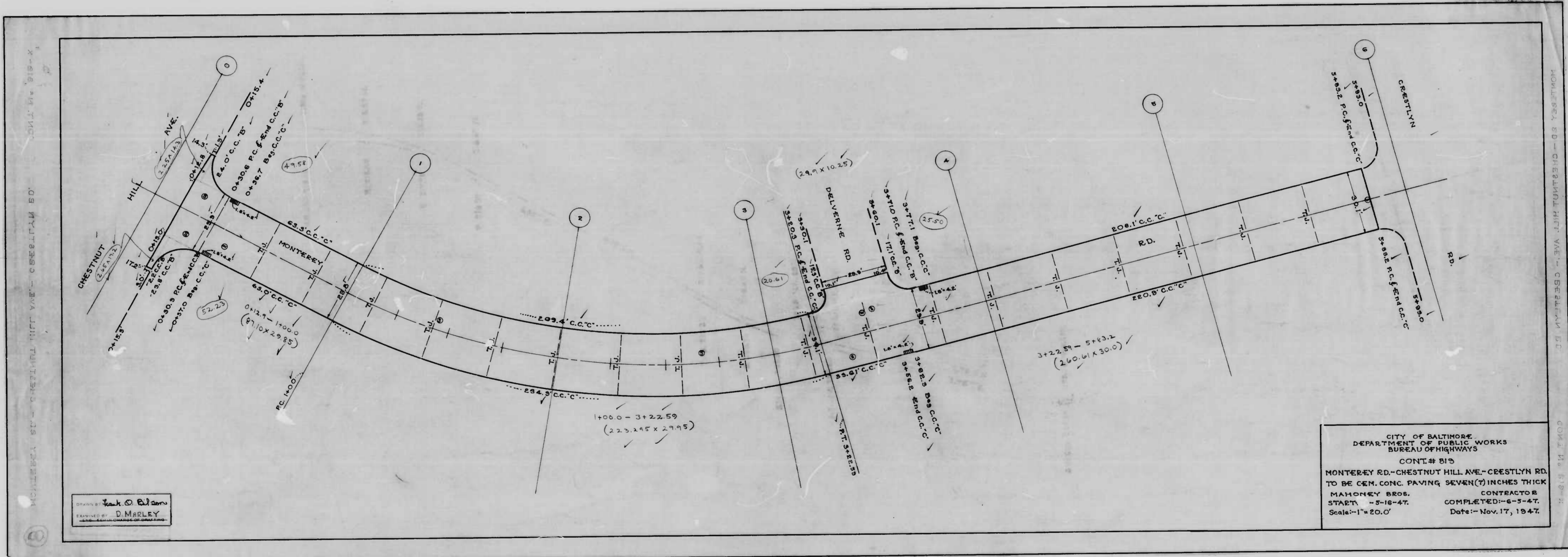



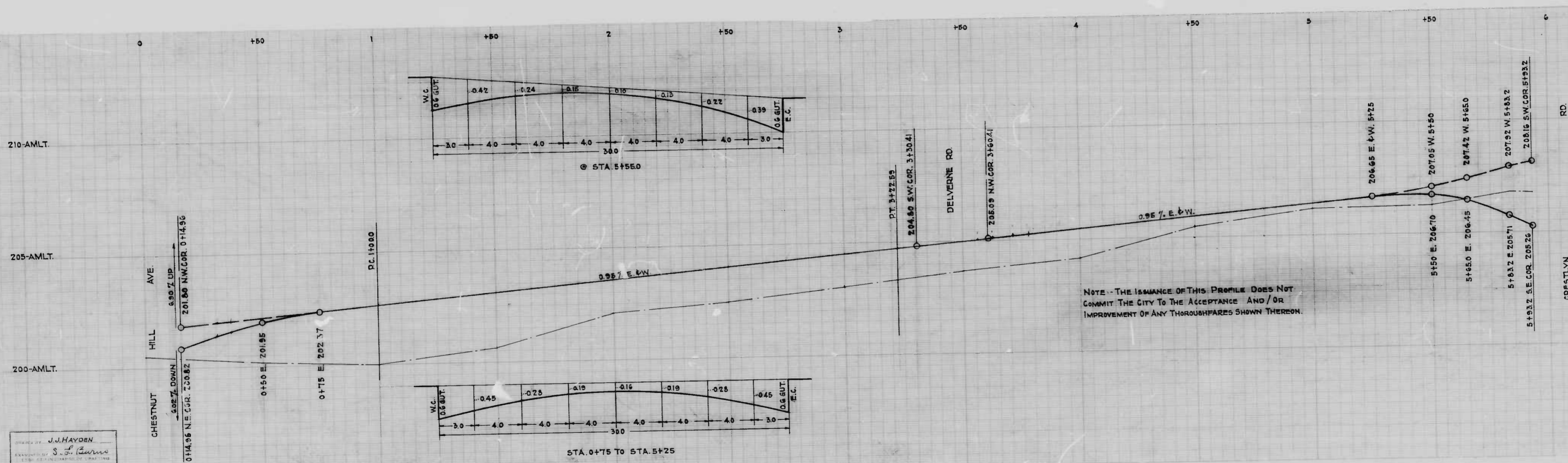

NOTE - THE ISSUANCE OF THIS PROFILE DOES NOT COMMIT THE CITY TO THE ACCEPTANCE AND/OR IMPROVEMENT OF ANY THOROUGHFARES SHOWN THEREON.

DRAWN BY J. HAYDEN  
 CHECKED BY S. J. Burns  
 ENGINEER

CITY OF BALTIMORE  
 DEPARTMENT OF PUBLIC WORKS  
 BUREAU OF HIGHWAYS  
 PROFILE OF  
 MONTEREY RD - CHESTNUT HILL AVE  
 CONT. NO. 819  
 SCALE - HOR. - 1" = 200'  
 VER. - 1" = 20'  
 APPROVED: *Henry Weiskopf* ASSOCIATE ENGINEER  
 APPROVED: *Edward J. [Signature]* ENGR. PLANS & SURVEYS



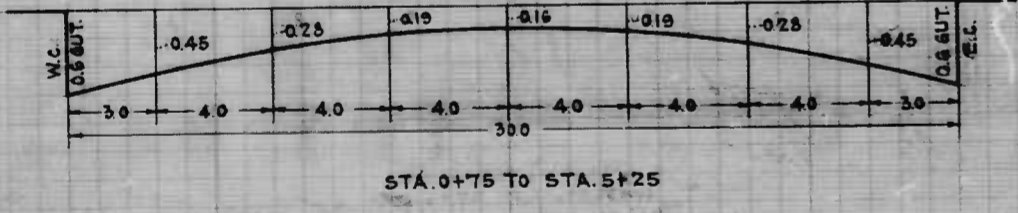
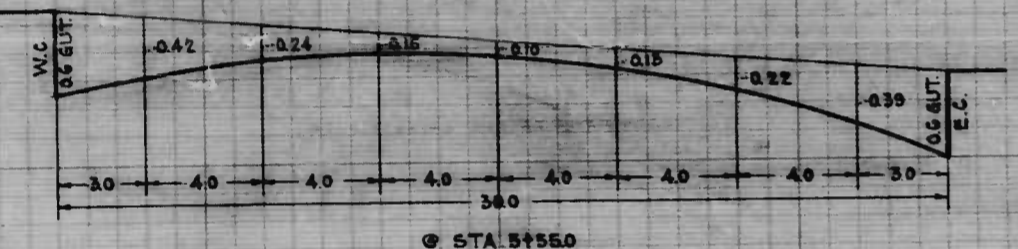
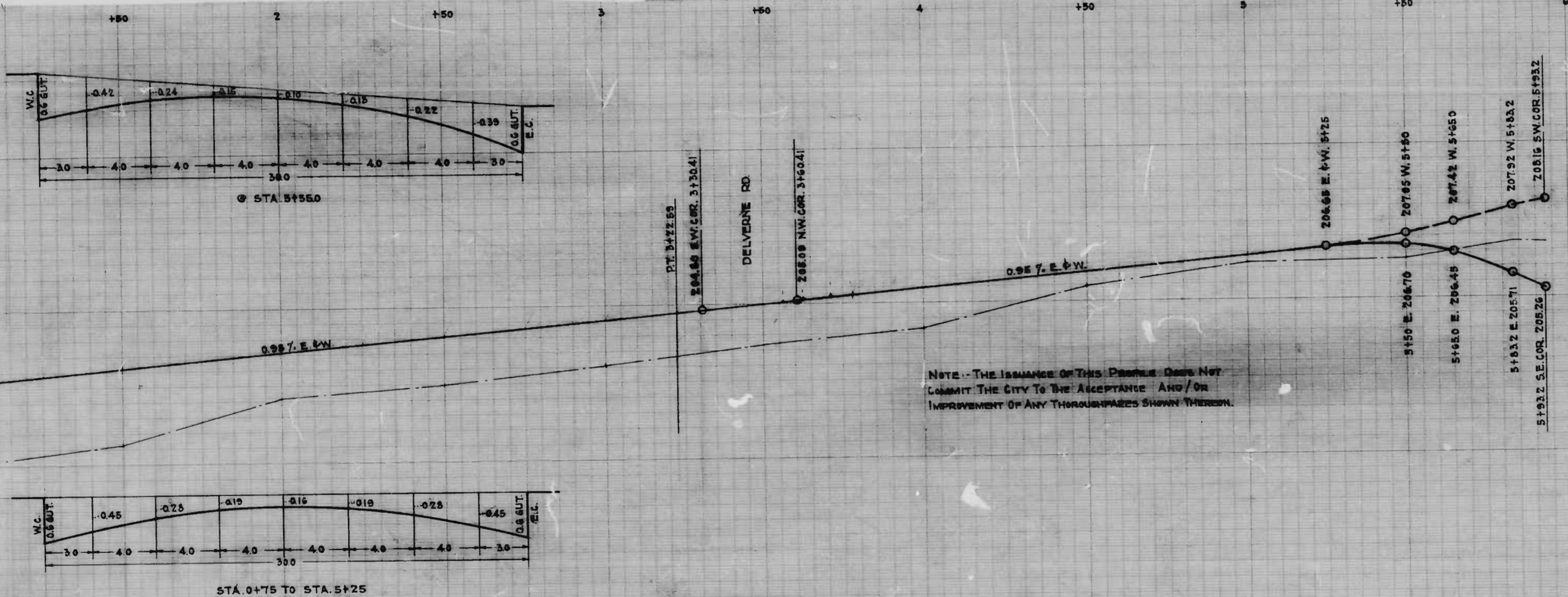

NOTE - THE ISSUANCE OF THIS PROFILE DOES NOT COMMIT THE CITY TO THE ACCEPTANCE AND/OR IMPROVEMENT OF ANY THROUGHPADES SHOWN THEREON.

CITY OF BALTIMORE  
 DEPARTMENT OF PUBLIC WORKS  
 BUREAU OF HIGHWAYS  
 PROFILE OF  
 MONTEREY RD - CHESTNUT HILL AVE TO CRESTLYN RD  
 CONT. N.A. 819  
 HOR. - 1" = 200'      BOOK N.A. X-204  
 VER. - 1" = 2.0'      JUNE 12, 1946

APPROVED - *Henry Weisberg*  
 ASSOCIATE ENGINEER

APPROVED - *W. J. Fisher*  
 HIGHWAYS ENGINEER

APPROVED - *Edward Maclean*  
 ENGR. - EXAM. & SURVEYOR

APPROVED - *John P. Smith*  
 CHIEF ENGINEER

CITY OF BALTIMORE, DEPARTMENT OF PUBLIC WORKS, BUREAU OF HIGHWAYS



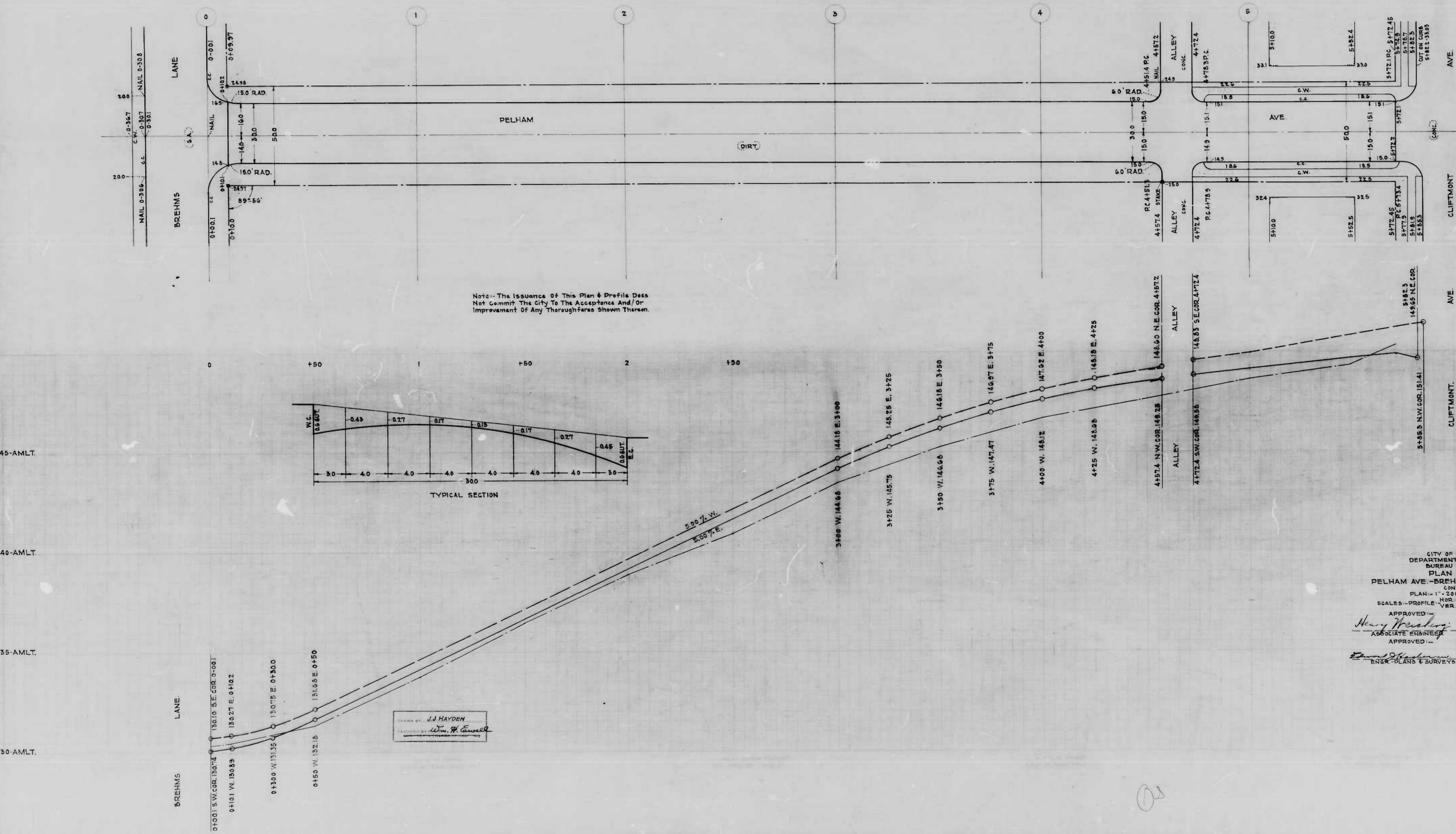

CITY OF BALTIMORE  
 DEPARTMENT OF PUBLIC WORKS  
 BUREAU OF HIGHWAYS  
 PLAN & PROFILE  
 PELHAM AVE - BREHMS L.A. TO CLIFTMONT AVE.  
 CONT. N-519  
 PLAN - 1" = 200'  
 HOR. - 1" = 200'  
 VEB. - 1" = 20'  
 BOOK N-5-210  
 AUG. 7, 1942

APPROVED: *Henry Weathers* ASSOCIATE ENGINEER  
 APPROVED: *W. J. Fisher* HIGHWAYS ENGINEER  
 APPROVED: *Edmund J. ...* ENGR. PLANS & SURVEYS  
 APPROVED: *Wm. R. ...* CHIEF ENGINEER

DESIGNED BY: J.J. HAYDEN  
 DRAWN BY: Wm. R. ...



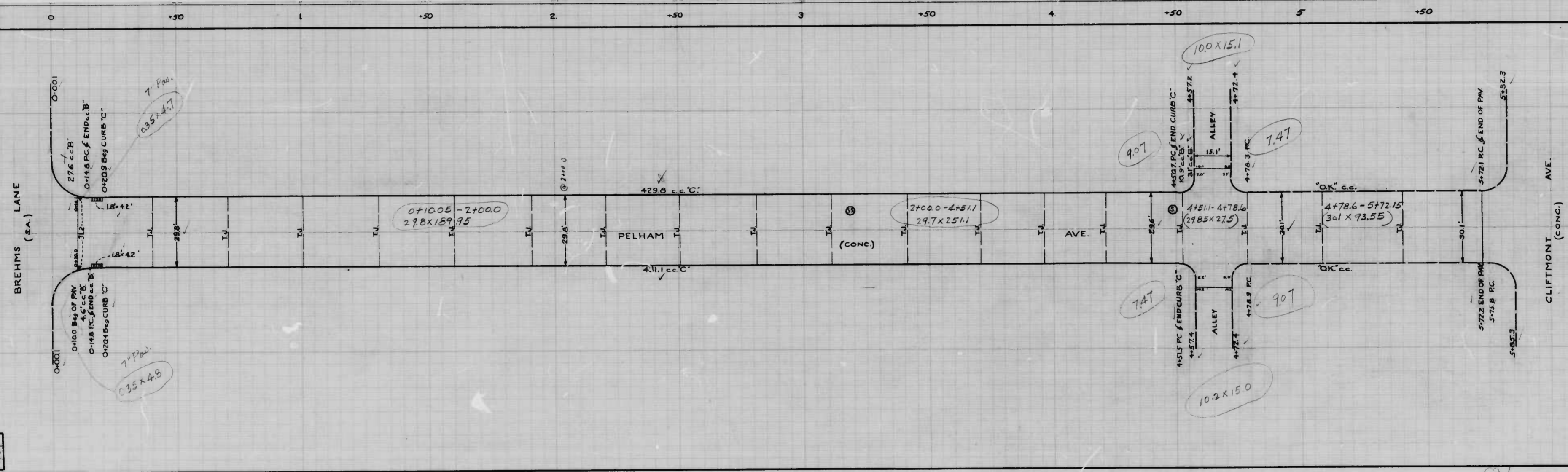

DRAWN BY: *John J. Caputo*  
 CHECKED BY: *William H. Caputo*  
 DATE: 7-1-44

DEPART  
 BU  
 PELHAM AVE-F  
 CEMENT CONC  
 MAHONEY BRO  
 STARTED 7-1-4  
 SCALE: 1"=20'



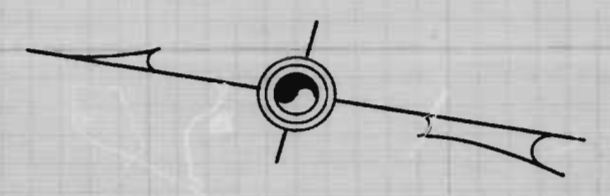
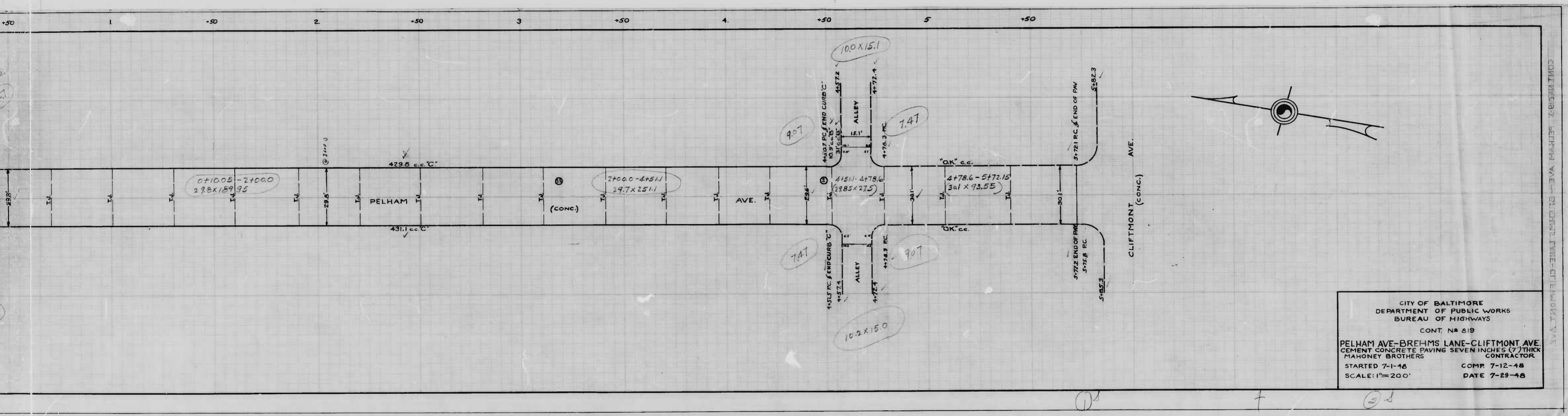

CITY OF BALTIMORE  
 DEPARTMENT OF PUBLIC WORKS  
 BUREAU OF HIGHWAYS  
 CONT. NO. 819  
 PELHAM AVE-BREHMS LANE-CLIFTMONT AVE.  
 CEMENT CONCRETE PAVING SEVEN INCHES (7") THICK  
 MAHONEY BROTHERS CONTRACTOR  
 STARTED 7-1-48 COMP. 7-12-48  
 SCALE: 1"=200' DATE 7-29-48

CONT. NO. 819 PELHAM AVE-BREHMS LANE-CLIFTMONT AVE







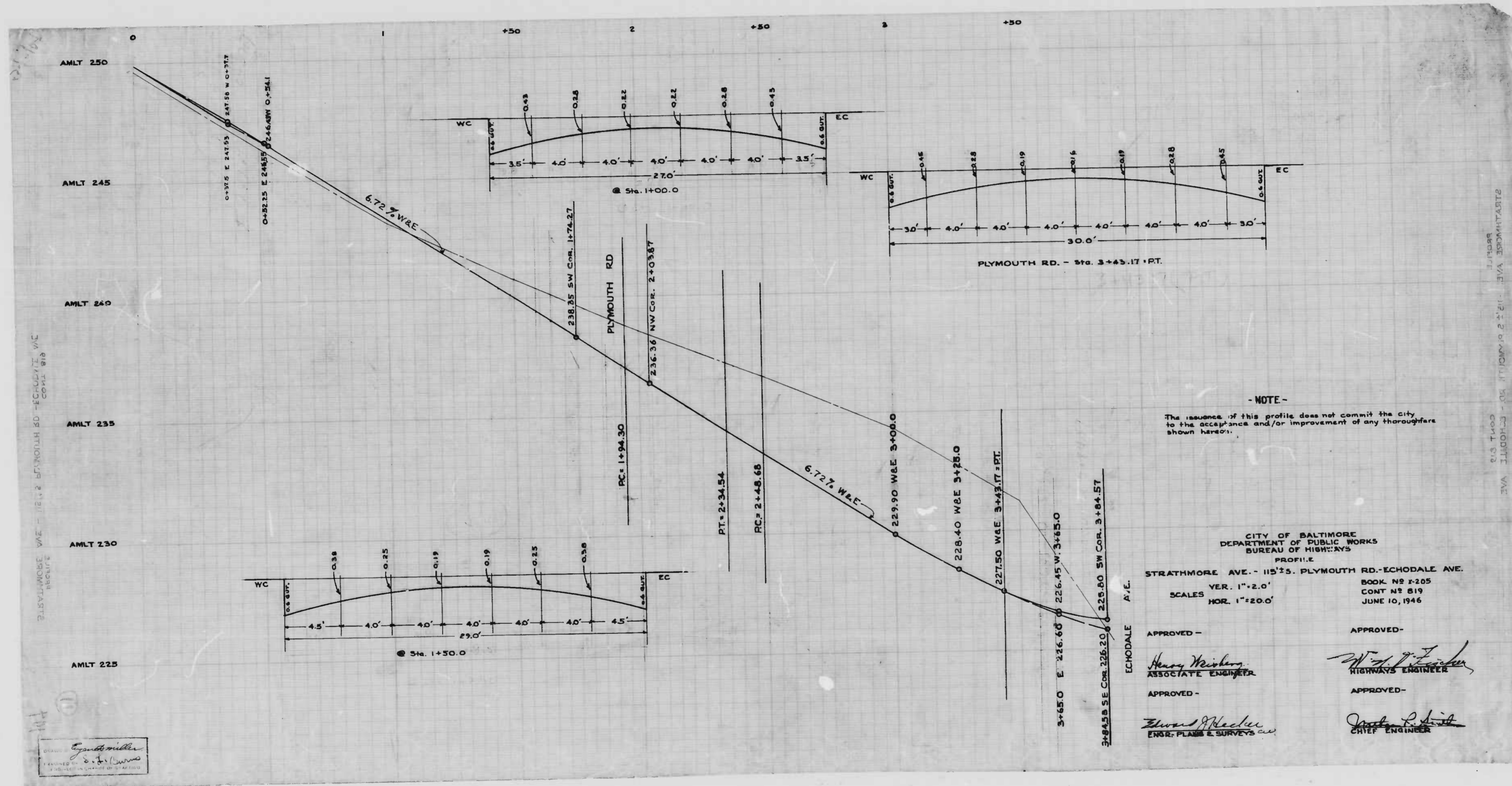

**- NOTE -**  
 The issuance of this profile does not commit the city to the acceptance and/or improvement of any thoroughfare shown hereon.

CITY OF BALTIMORE  
 DEPARTMENT OF PUBLIC WORKS  
 BUREAU OF HIGHWAYS  
 PROFILE  
 STRATHMORE AVE. - 11525. PLYMOUTH RD. - ECHODALE AVE.  
 VER. 1" = 2.0'  
 HOR. 1" = 20.0'  
 BOOK NO 2205  
 CONT NO 819  
 JUNE 10, 1946

APPROVED -  
*Henry Weisberg*  
 ASSOCIATE ENGINEER  
 APPROVED -  
*Edward M. Hecker*  
 ENGR. PLANS & SURVEYS

APPROVED -  
*W. J. Fisher*  
 HIGHWAYS ENGINEER  
 APPROVED -  
*James P. Smith*  
 CHIEF ENGINEER

*Engelhardt*  
 ENGINEER



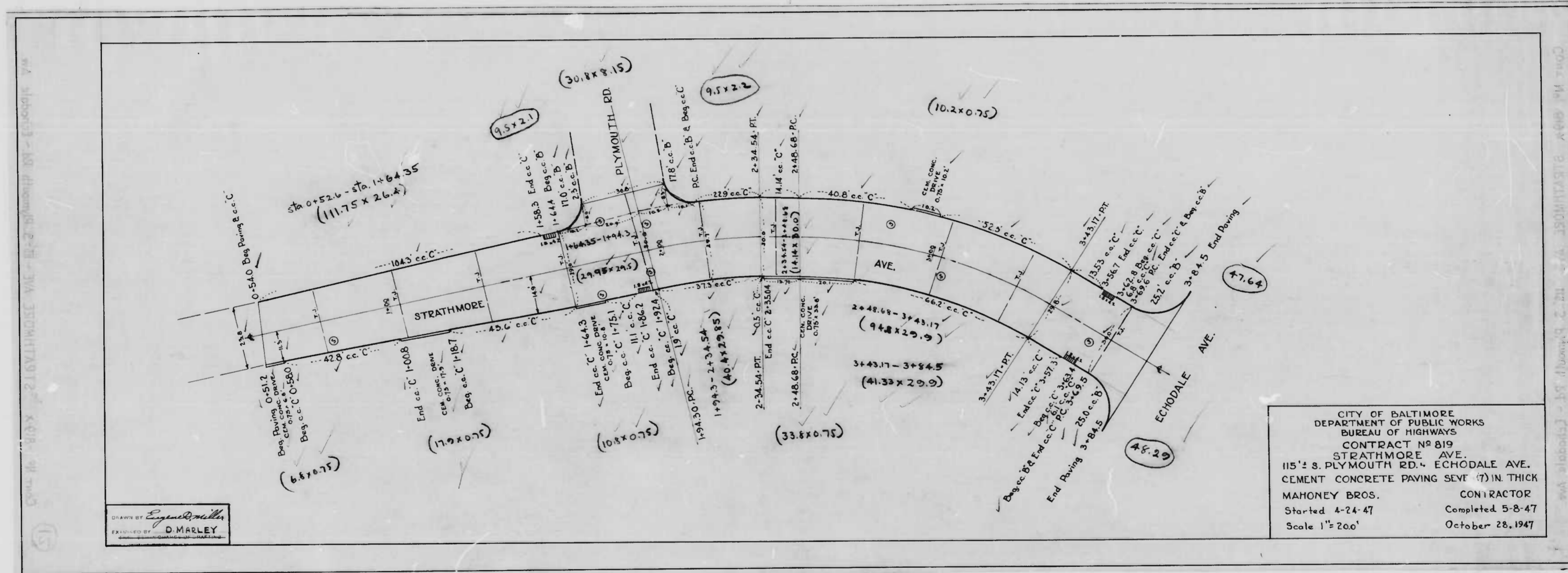



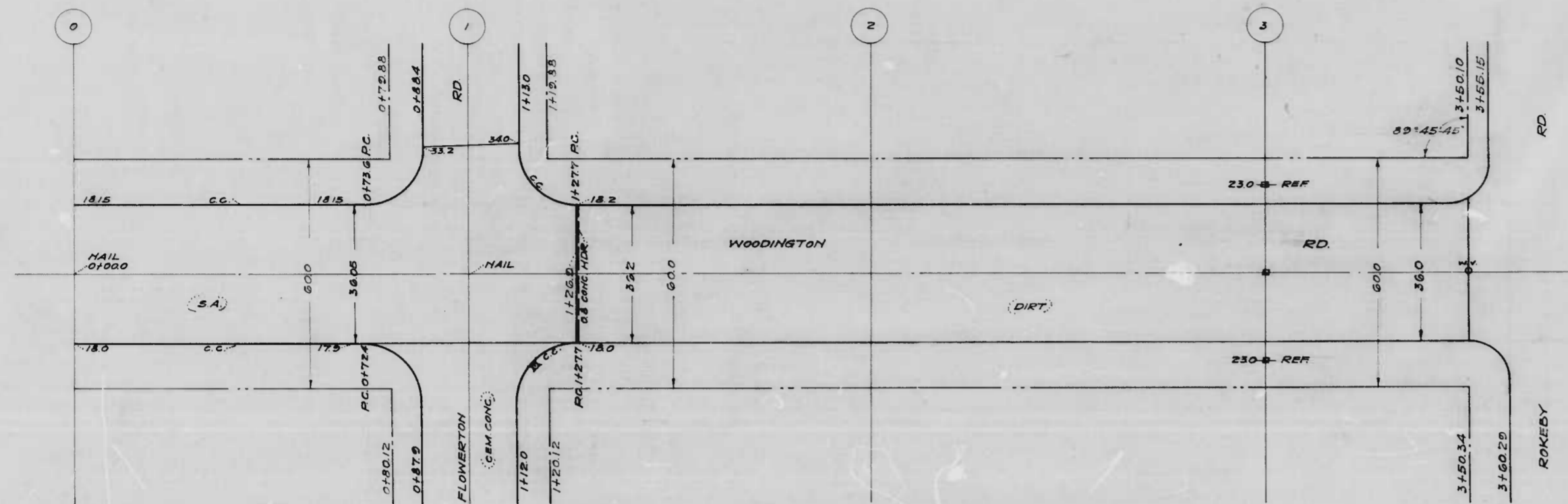

NOTE - THE ISSUANCE OF THIS PLAN & PROFILE DOES NOT COMMIT THE CITY TO THE ASSISTANCE AND/OR IMPROVEMENT OF ANY THOROUGHFARES SHOWN THEREON.

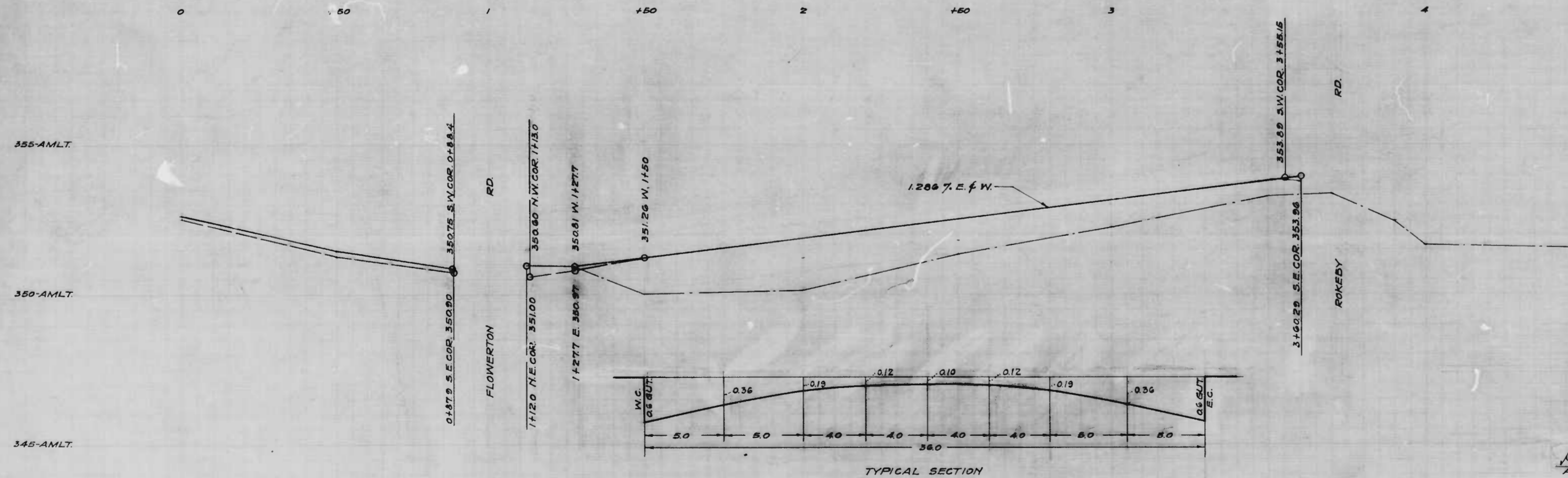

CITY OF BALTIMORE  
 DEPARTMENT OF PUBLIC WORKS  
 BUREAU OF HIGHWAYS  
 PLAN & PROFILE  
 WOODINGTON RD - FLOWERTON RD TO ROKEBY RD  
 CONT. NO. 818  
 PLAN - 1" = 200'  
 PROFILE - HOR. - 1" = 200'  
 VER. - 1" = 20'  
 BOOK-X-149  
 JUNE 5, 1946

APPROVED: *Henry Wasberg*  
 ASSOCIATE ENGINEER

APPROVED: *Edward J. Hasfens c.w.*  
 ENGR. (PLANS & SURVEYS)

APPROVED: *W. J. ...*  
 HIGHWAYS ENGINEER

APPROVED: *...*  
 CHIEF ENGINEER

DRAWN BY *J. J. ...*  
 EXAMINED BY *...*  
 ENGINEER IN CHARGE OF DRAWINGS



