

DRAWN BY J.J. HAYDEN
ENGINEER S. S. HAYDEN
ENGINEERING COMPANY

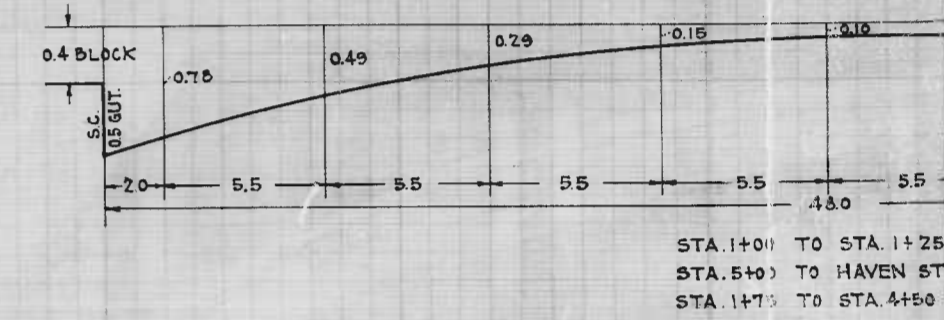

J. J. HAYDEN
 S. L. Burns
 ENGINEERS

03

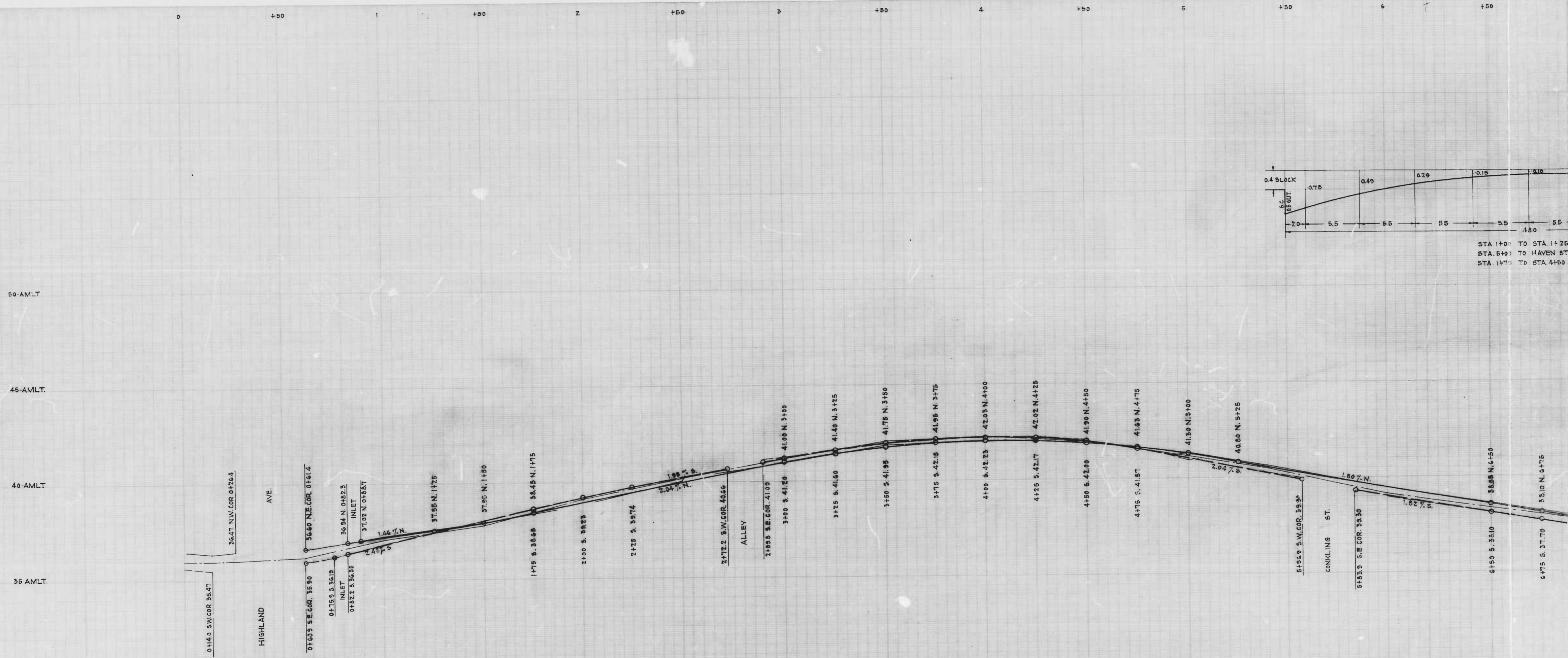
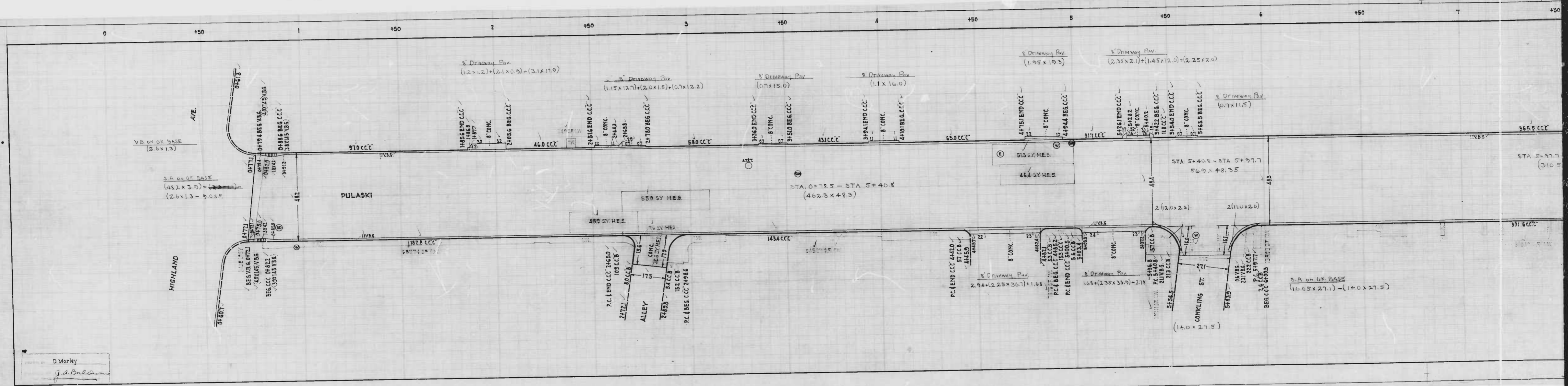

812

RATIO - 24 1

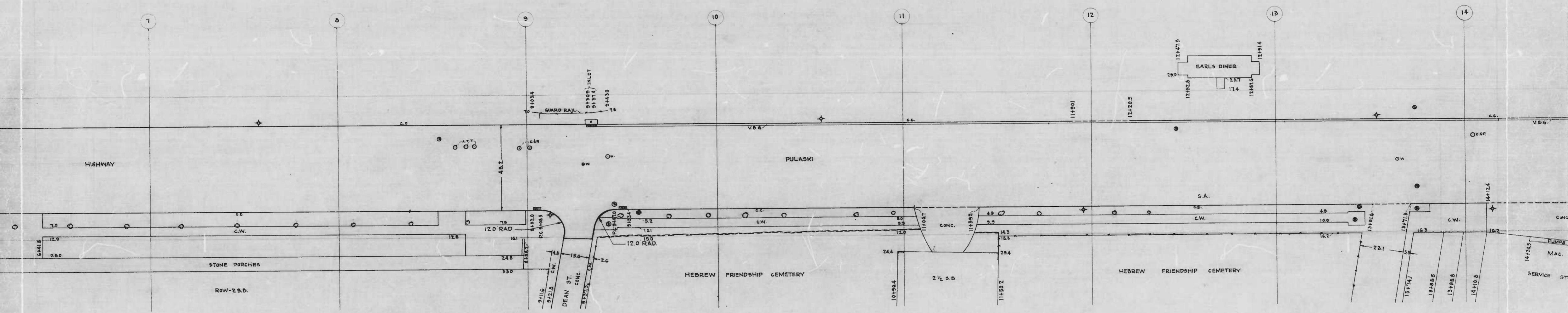

812

RATIO - 24

2

6 +50 7 +50 8 +50 9 +50 10 +50 11 +50 12 +50 13 +50 14

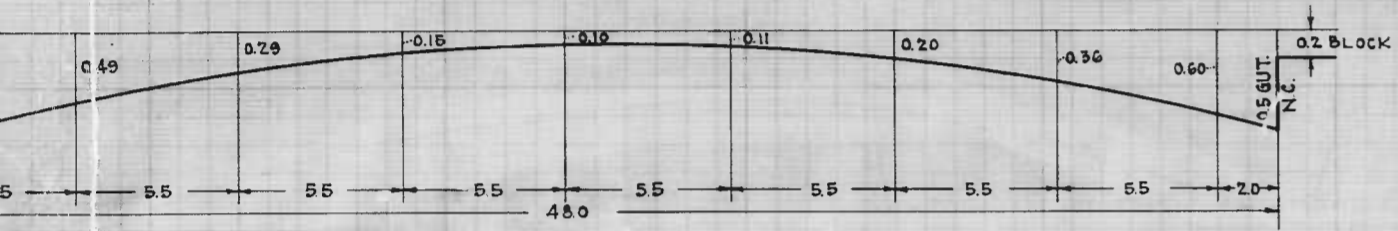

STA. 1+00 TO STA. 1+25
 STA. 5+00 TO HAVEN ST.
 STA. 1+75 TO STA. 4+50 (REVERSED)

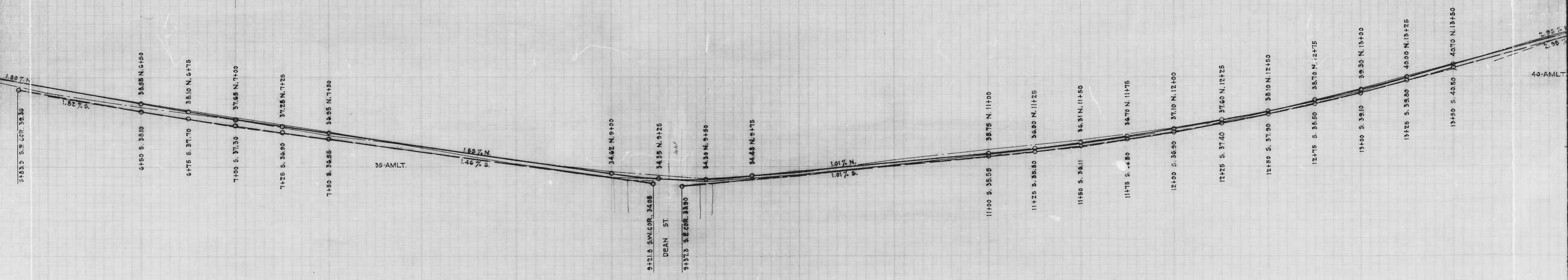

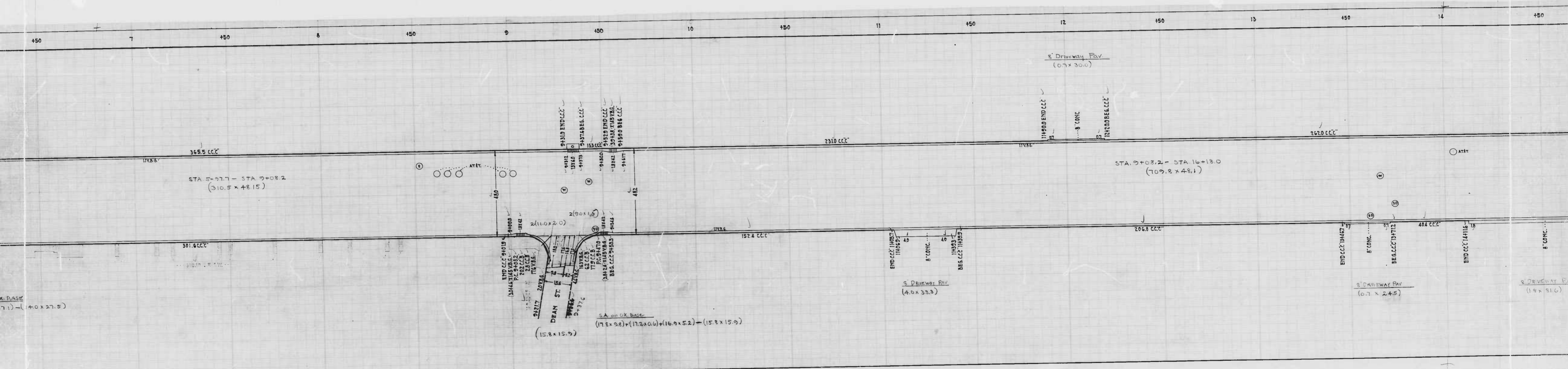

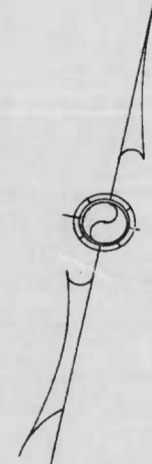
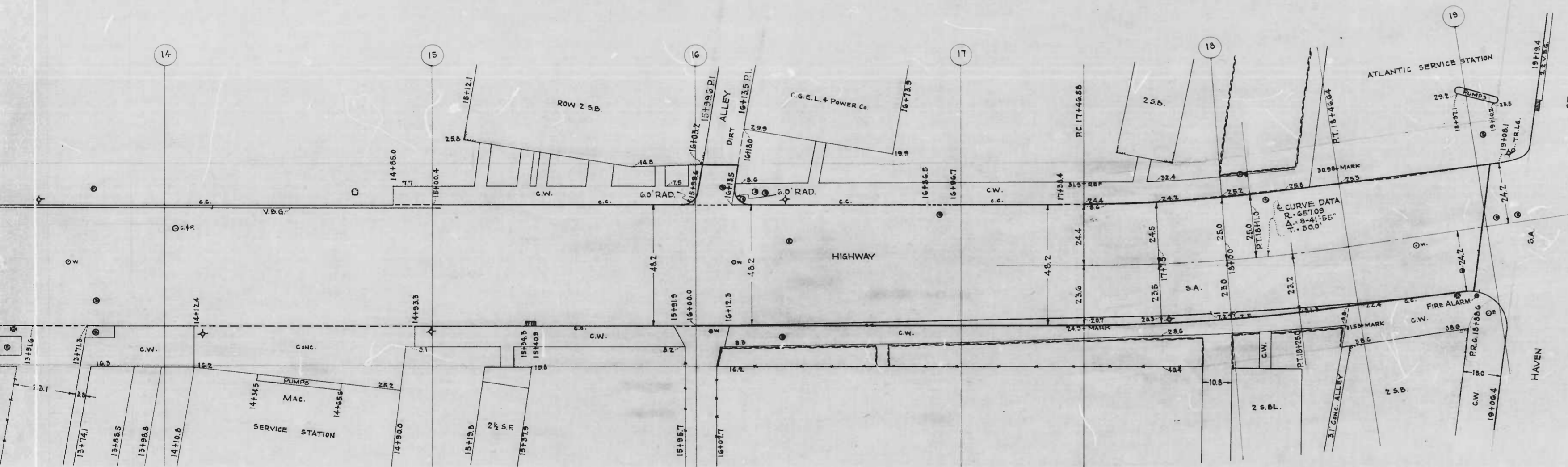

CITY OF BALTIMORE
 DEPARTMENT OF PUBLIC WORKS
 BUREAU OF HIGHWAYS
 PLAN OF
 PULASKI HIGHWAY - HIGHLAND AVE. TO HAVEN ST.
 CONT. N° 512

SCALE: 1" = 200' BOOK N° X-132
 MARCH 29, 1946

APPROVED: *Henry Weidberg* *W. J. Z. Fisher*
 ASSOCIATE ENGINEER HIGHWAYS ENGINEER

APPROVED: *Edwin J. ...* *Charles ...*
 ENGR. PLANS & SURVEYS CHIEF ENGINEER

32

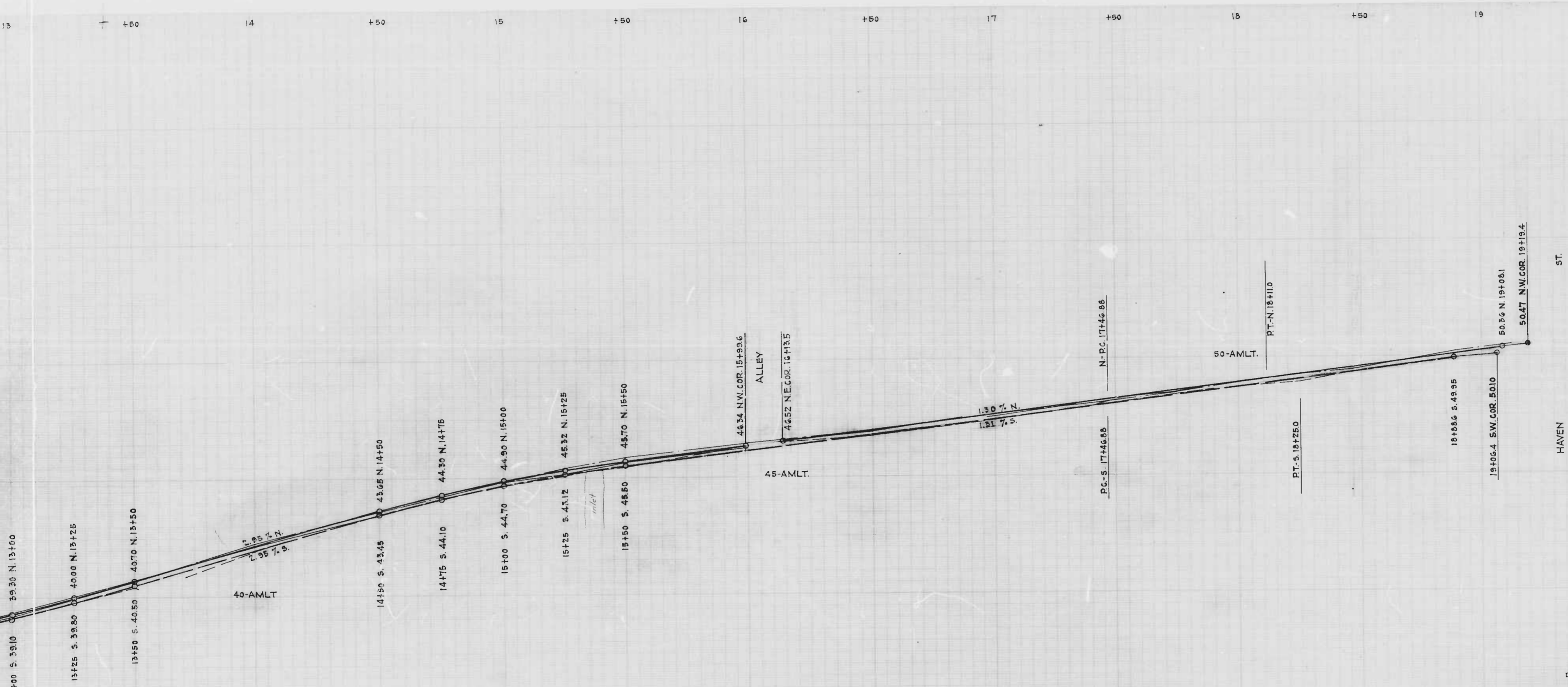

CITY OF BALTIMORE
 DEPARTMENT OF PUBLIC WORKS
 BUREAU OF HIGHWAYS
 PROFILE OF
 PULASKI HIGHWAY - HIGHLAND AVE. TO HAVEN ST.
 CONT. N^o 512

SCALES - HOR. - 1" = 200' BOOK N^o X-192
 VER. - 1" = 20' MARCH 30, 1946

APPROVED - *Henry Weisberg* APPROVED - *W. J. Fisher*
 ASSOCIATE ENGINEER HIGHWAYS ENGINEER

APPROVED - *Edward W. Hedden* APPROVED - *Walter R. Smith*
 ENGR. - PLANS & SURVEYS CHIEF ENGINEER

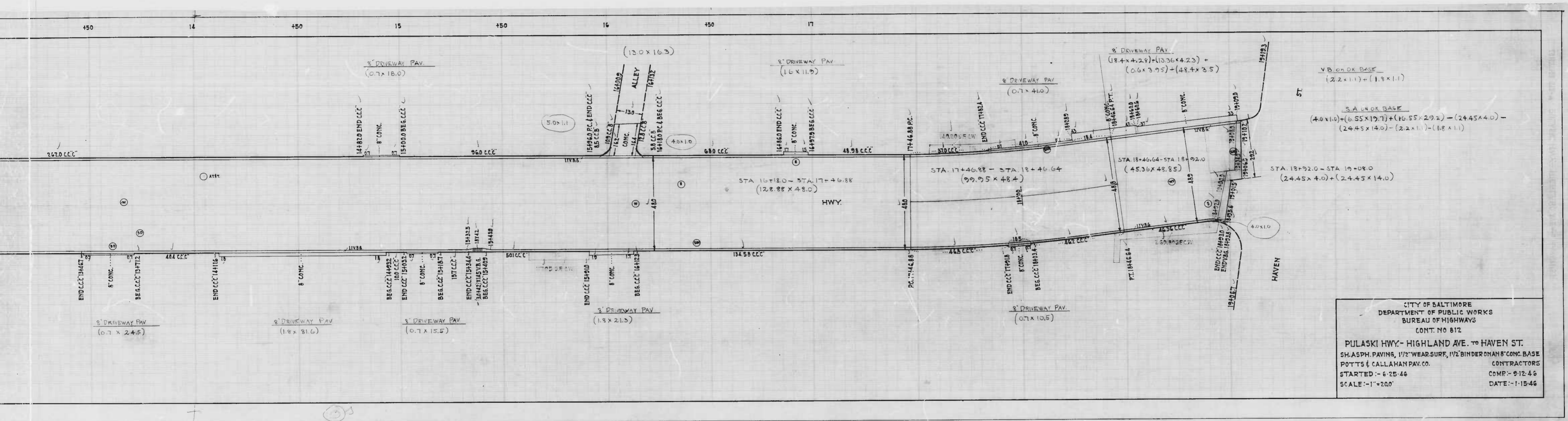

CITY OF BALTIMORE
 DEPARTMENT OF PUBLIC WORKS
 BUREAU OF HIGHWAYS
 CONT. NO 812
 PULASKI HWY - HIGHLAND AVE. TO HAVEN ST.
 SH. ASPH. PAVING, 1/2" WEAR SURF, 1/2" BINDER ON 8" CONC. BASE
 POTTS & CALLAHAN PAV. CO. CONTRACTORS
 STARTED - 6-25-46 COMP - 9-12-46
 SCALE - 1" = 20' DATE - 1-15-46