

J. J. HAYDEN
 DRAWN BY
 CHECKED BY *H. A. C...*

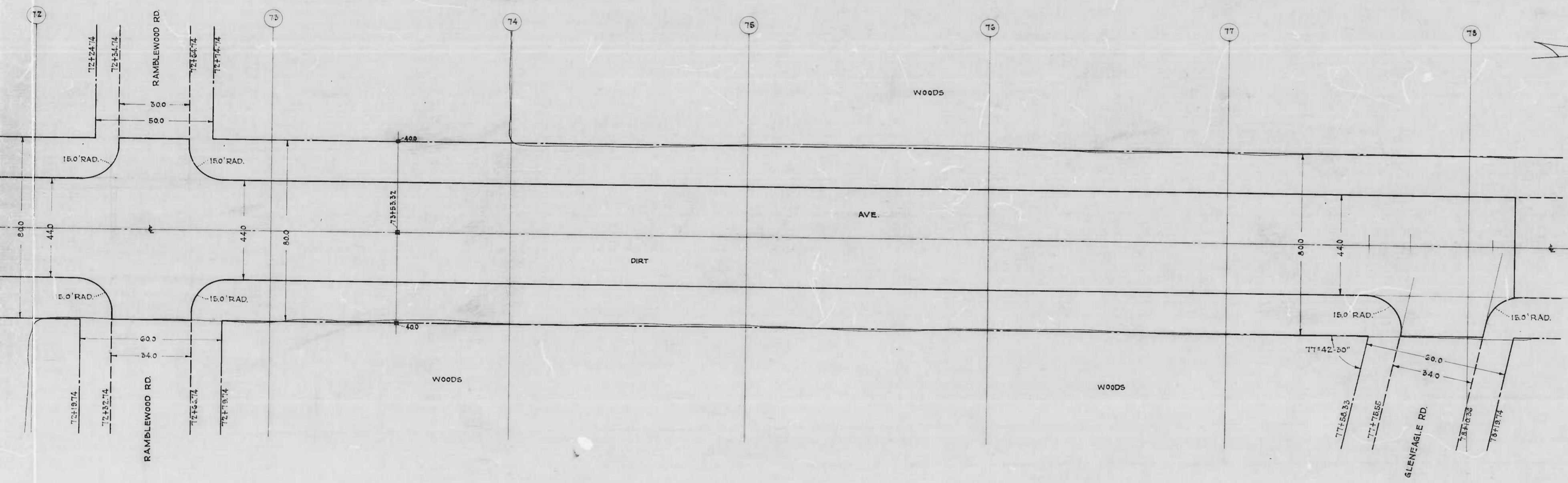

CITY OF BALTIMORE
 DEPARTMENT OF PUBLIC WORKS
 BUREAU OF HIGHWAYS
 PLAN OF
 BEAUREGARD AVE. - BELVEDERE AVE. TO GLENLEAGLE RD.
 CONT. N° 811

SCALE - 1" = 20.0' Book N° X 206
 MARCH 21, 1946

APPROVED - *Henry Newberg*
 ASSOCIATE ENGINEER

APPROVED - *Walter R. Smith*
 CHIEF ENGINEER

APPROVED - *Edward J. Hecker*
 ENGR. PLANS & SURVEYS

24

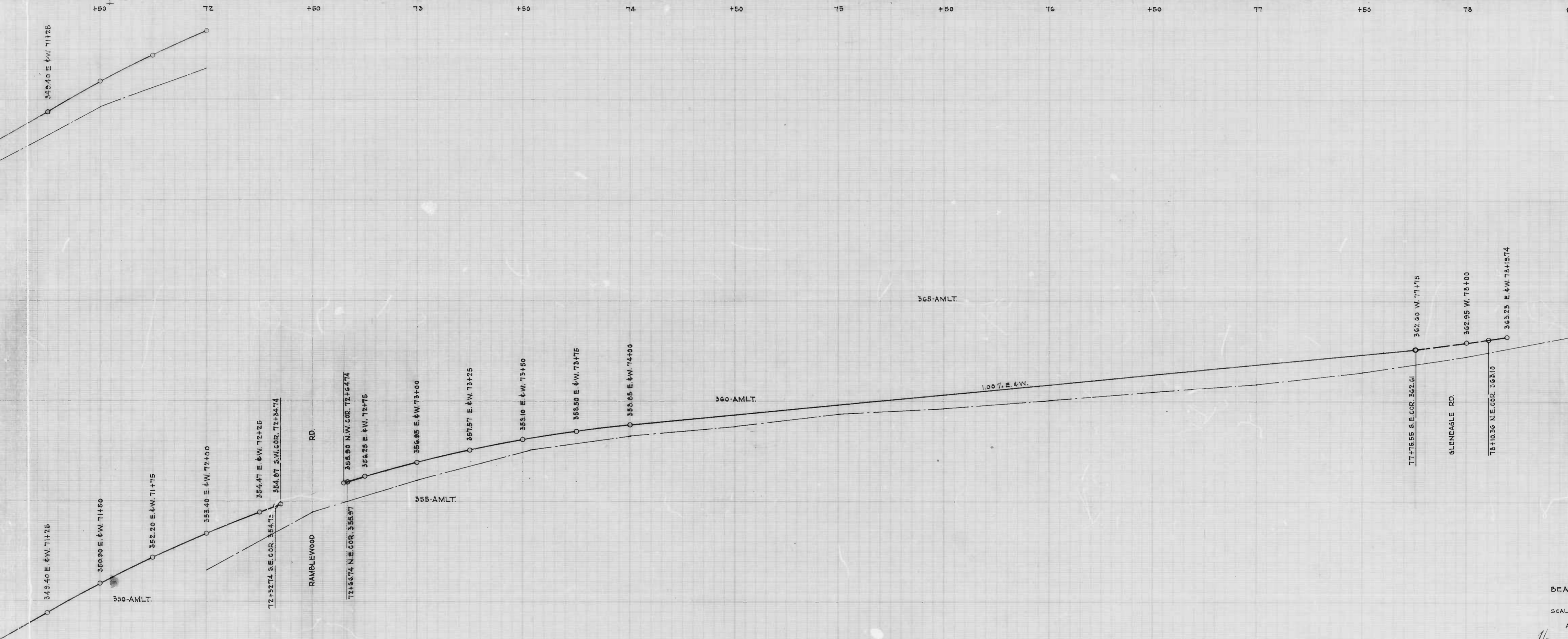

CITY OF BALTIMORE
 DEPARTMENT OF PUBLIC WORKS
 BUREAU OF HIGHWAYS
 PROFILE OF
 BEAUREGARD AVE. - BELVEDERE AVE. TO GLENEAGLE
 CONT. N^o 811

SCALES - HOR. - 1" = 200'
 VER. - 1" = 20'

APPROVED BY: *Henry Waisberg* ASSOCIATE ENGINEER
 APPROVED BY: *[Signature]* CHIEF ENGINEER
 APPROVED BY: *[Signature]* ENGR. PLANS & SURVEYS
 APPROVED BY: *[Signature]* CHIEF ENGINEER

29

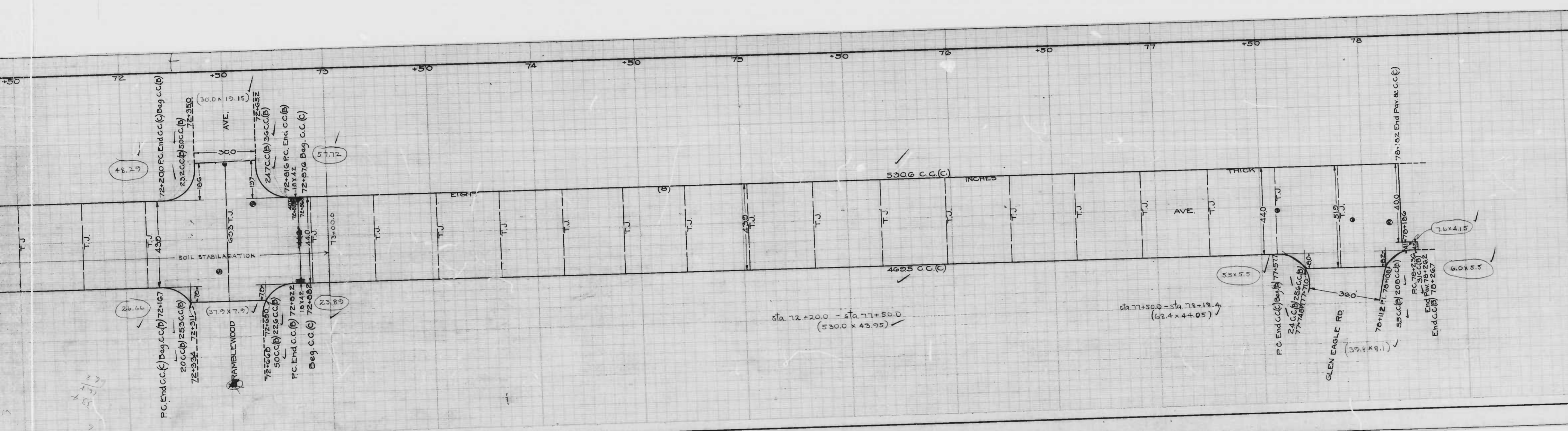

CITY OF BALTIMORE
 DEPARTMENT OF PUBLIC
 BUREAU OF HIGHWAY
 CONTRACT NO 811
 BEAUREGARD AVE-BELVEDERE AVE-G
 Cement Concrete Paving Eight (8) In
 MAHONEY BROTHERS CONT
 Started 6-13-46 Complete
 SCALE 1"=200 NOVEM

73 +50 74 +50 75 +50 76 +50 77 +50 78 +50

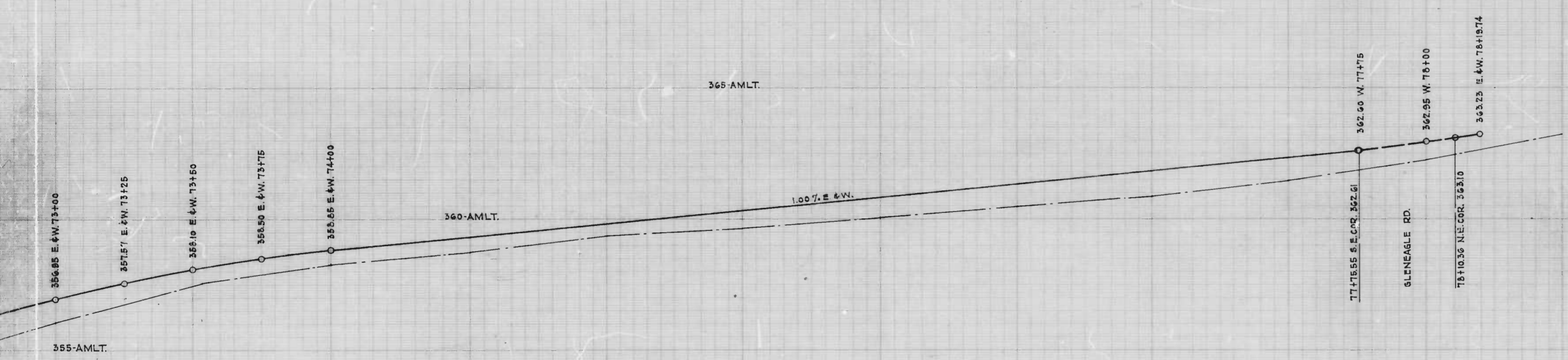

CITY OF BALTIMORE
 DEPARTMENT OF PUBLIC WORKS
 BUREAU OF HIGHWAYS
 PROFILE OF
 BEAUGARD AVE. - BELVEDERE AVE. TO GLENEAGLE RD.
 CONT. NO. 811

SCALES -- HOR. 1" = 200'
 VER. 1" = 20'

Book No. X - 206
 MARCH 21, 1946

APPROVED --
Henry Weisberg
 ASSOCIATE ENGINEER

APPROVED --
W. J. Fisher
 HIGHWAYS ENGINEER

APPROVED --
Edward Hecker
 ENGR. PLANS & SURVEYS

APPROVED --
Walter Smith
 CHIEF ENGINEER

2

3

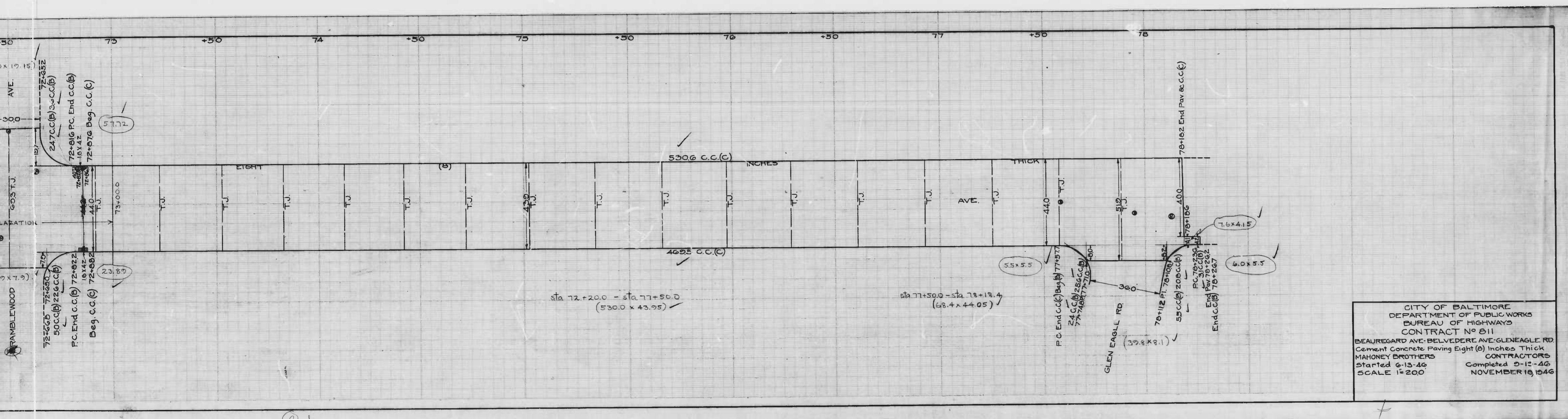

CITY OF BALTIMORE
 DEPARTMENT OF PUBLIC WORKS
 BUREAU OF HIGHWAYS
 CONTRACT NO 811
 BEAUREGARD AVE. BELVEDERE AVE. GLENEAGLE RD
 Cement Concrete Paving Eight (8) Inches Thick
 MAHONEY BROTHERS CONTRACTORS
 Started 6-13-46 Completed 9-12-46
 SCALE 1"=200 NOVEMBER 19, 1946

2.3