

* CURVE DATA
 PC = 5120.89
 PT = 5120.89
 PI = 5120.89
 R = 160
 L = 257.41

574.23
 614.23

①

810

RATIO - 24

2

0 +50 1 +50 2 +50 3 +50 4 +50 5 +50 6 +50

365 AMLT.
360 AMLT.
355 AMLT.
350 AMLT.
345 AMLT.
340 AMLT.

LIBERTY HEIGHTS AVE.

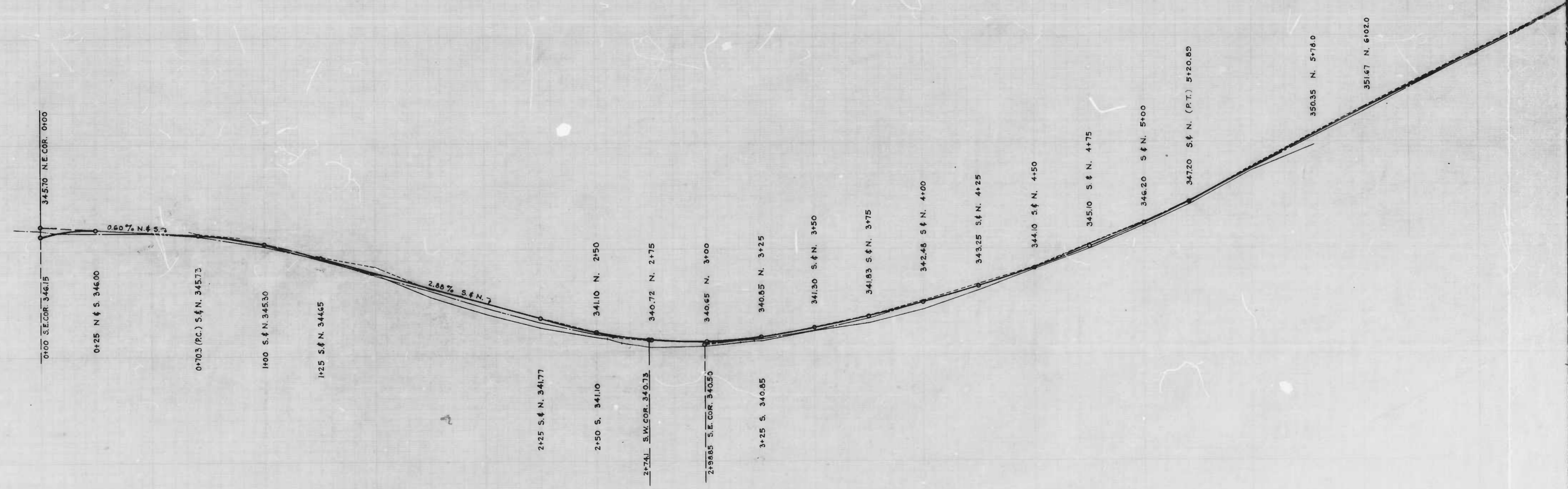

810

RATIO - 24

3

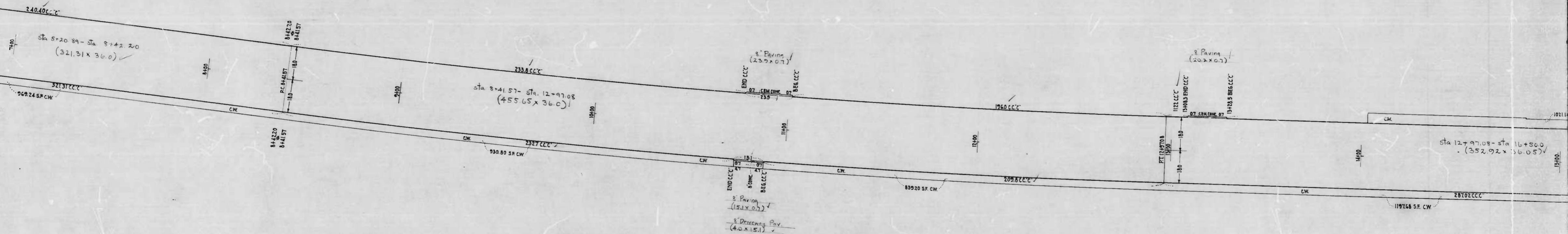

(C)

← CURVE DATA
Δ = 09°52'07"
R = 4447.30'
C = 455.32'
L = 455.31'
T = 227.36'

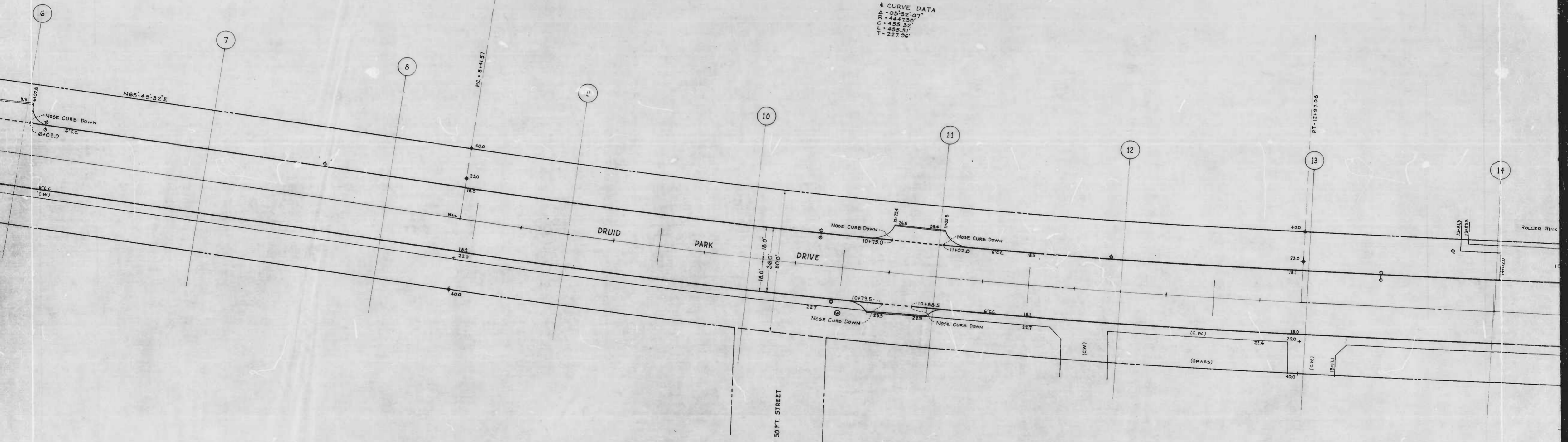

- 6
- 7
- 8
- 9
- 10
- 11
- 12
- 13
- 14

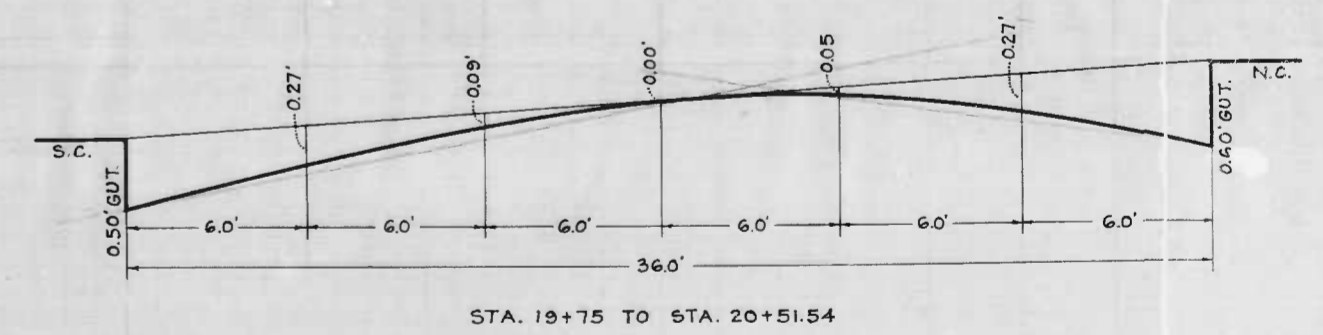
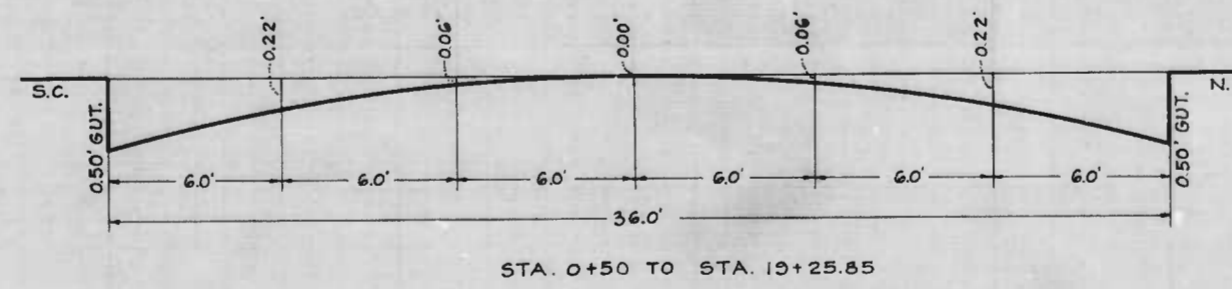
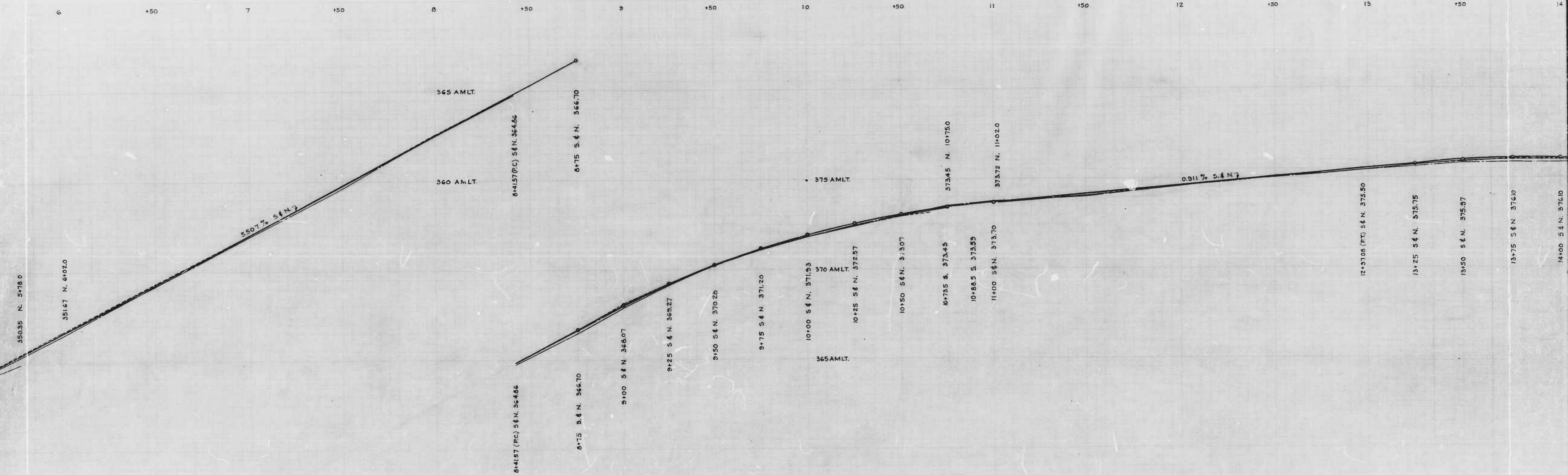

0/3

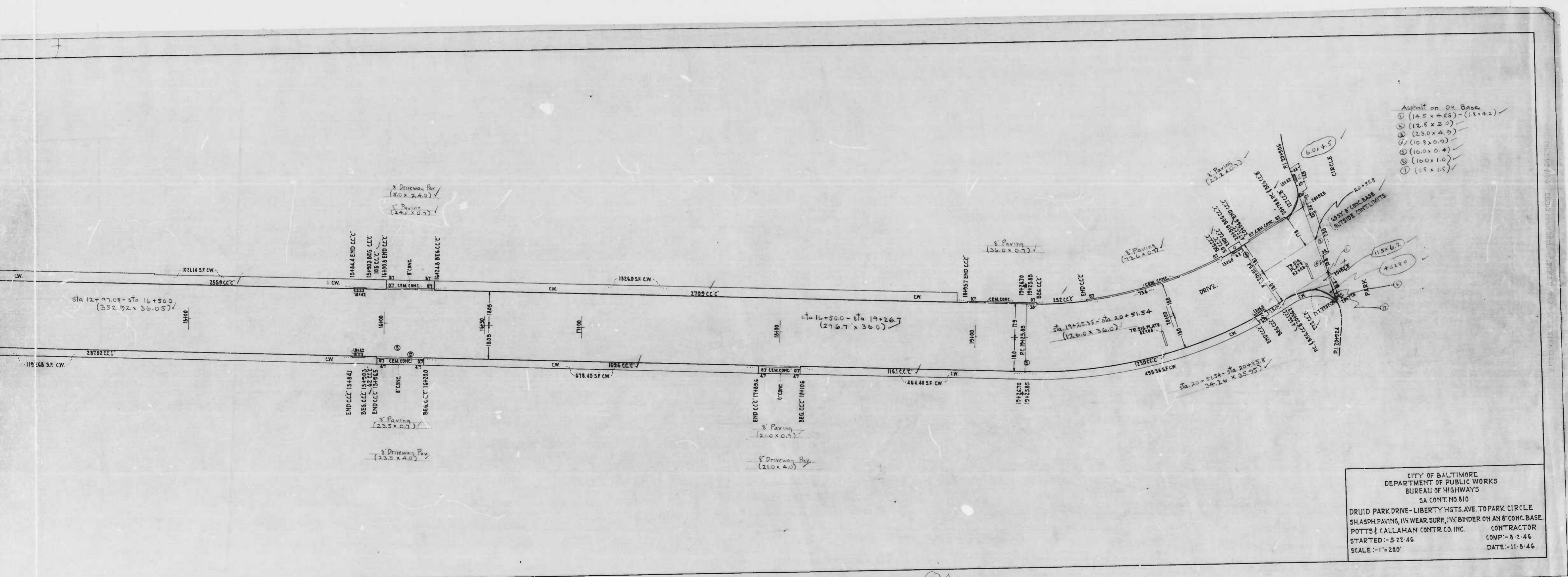

- Asphalt on O.K. Base
- ① (14.5 x 4.85) - (1.8 x 4.2)
 - ② (12.5 x 2.0)
 - ③ (23.0 x 4.5)
 - ④ (10.8 x 0.7)
 - ⑤ (16.0 x 0.4)
 - ⑥ (16.0 x 1.0)
 - ⑦ (1.5 x 1.5)

CITY OF BALTIMORE
 DEPARTMENT OF PUBLIC WORKS
 BUREAU OF HIGHWAYS
 SA CONT. NO. 810
 DRUID PARK DRIVE - LIBERTY HIGTS. AVE. TO PARK CIRCLE
 SH. ASPH. PAVING, 1 1/2\"/>

30

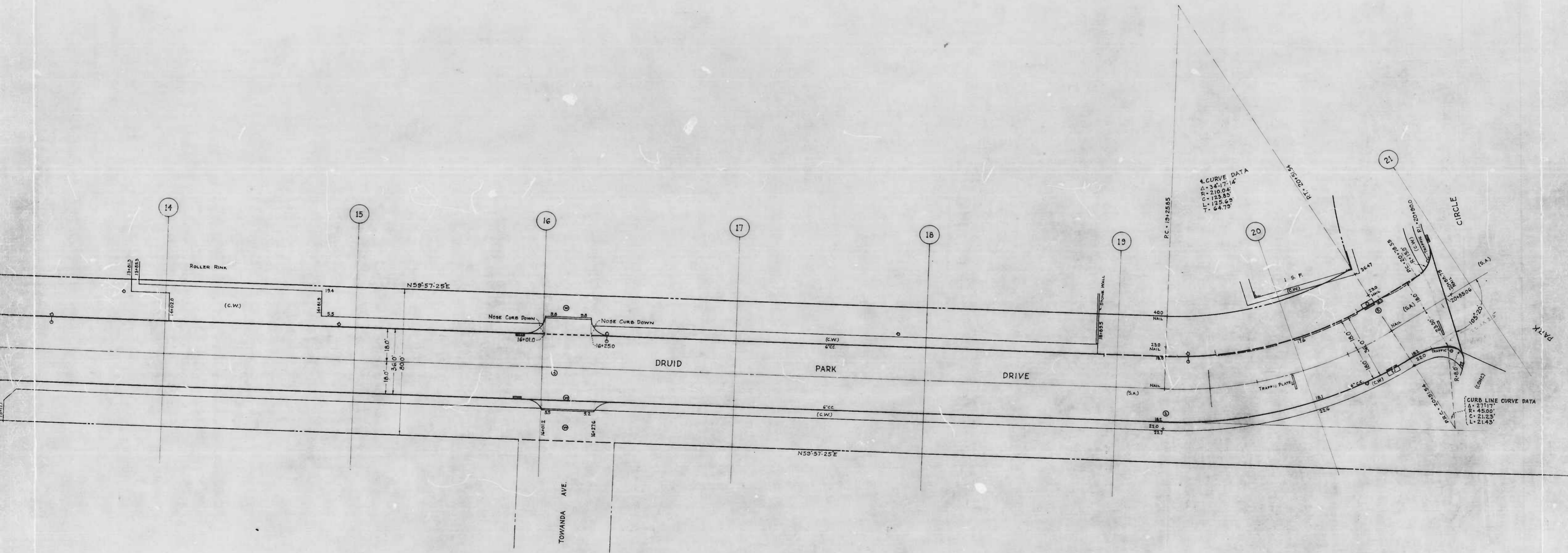

4. CURVE DATA
 $\Delta = 34^{\circ}17'14''$
 $R = 210.04'$
 $C = 123.85'$
 $L = 125.69'$
 $T = 64.75'$

CURB LINE CURVE DATA
 $\Delta = 27^{\circ}51'17''$
 $R = 45.00'$
 $C = 21.25'$
 $L = 21.43'$

810

RATIO - 24

2

3 +50 14 +50 15 +50 16 +50 17 +50 18 +50 19 +50 20 +50 21

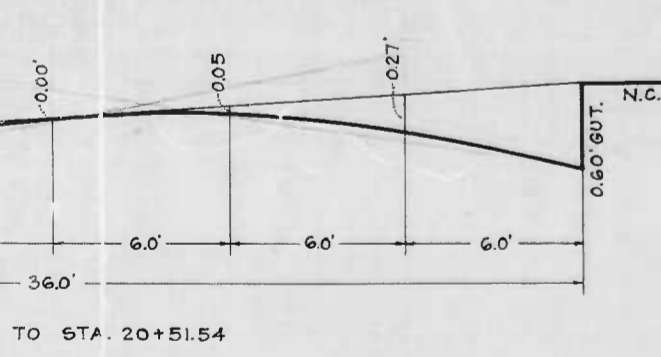
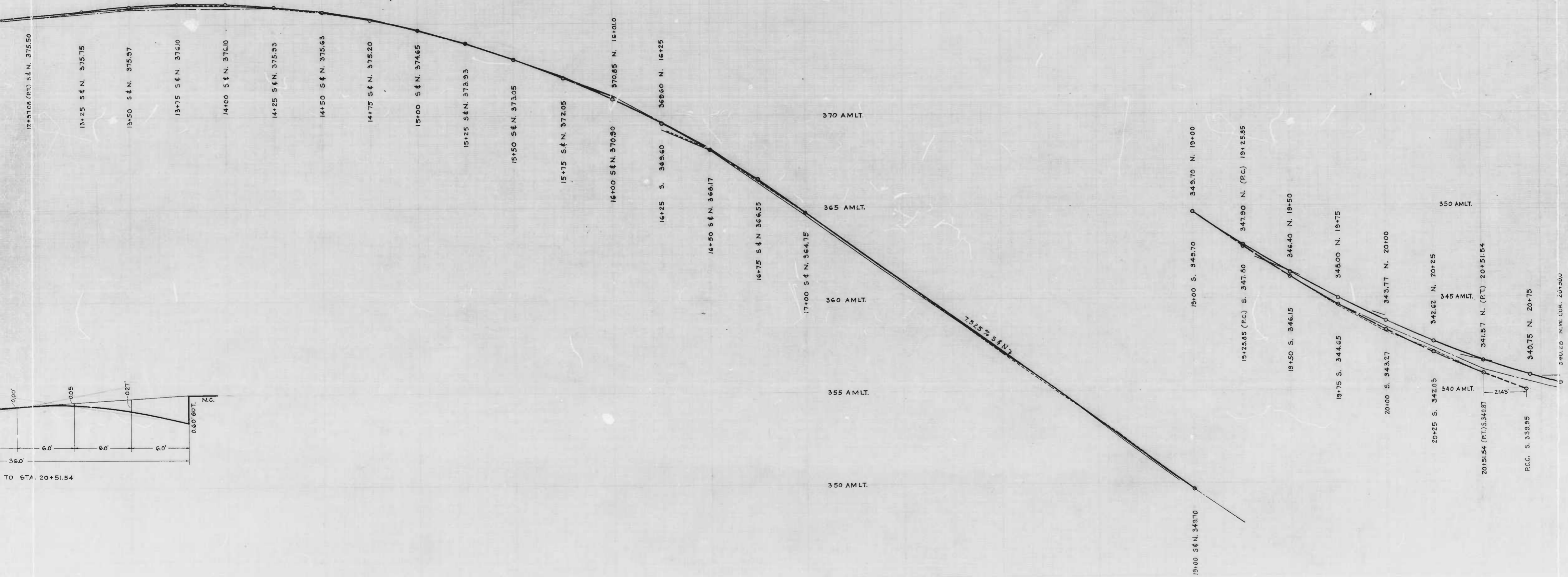

3

PARK CIRCLE

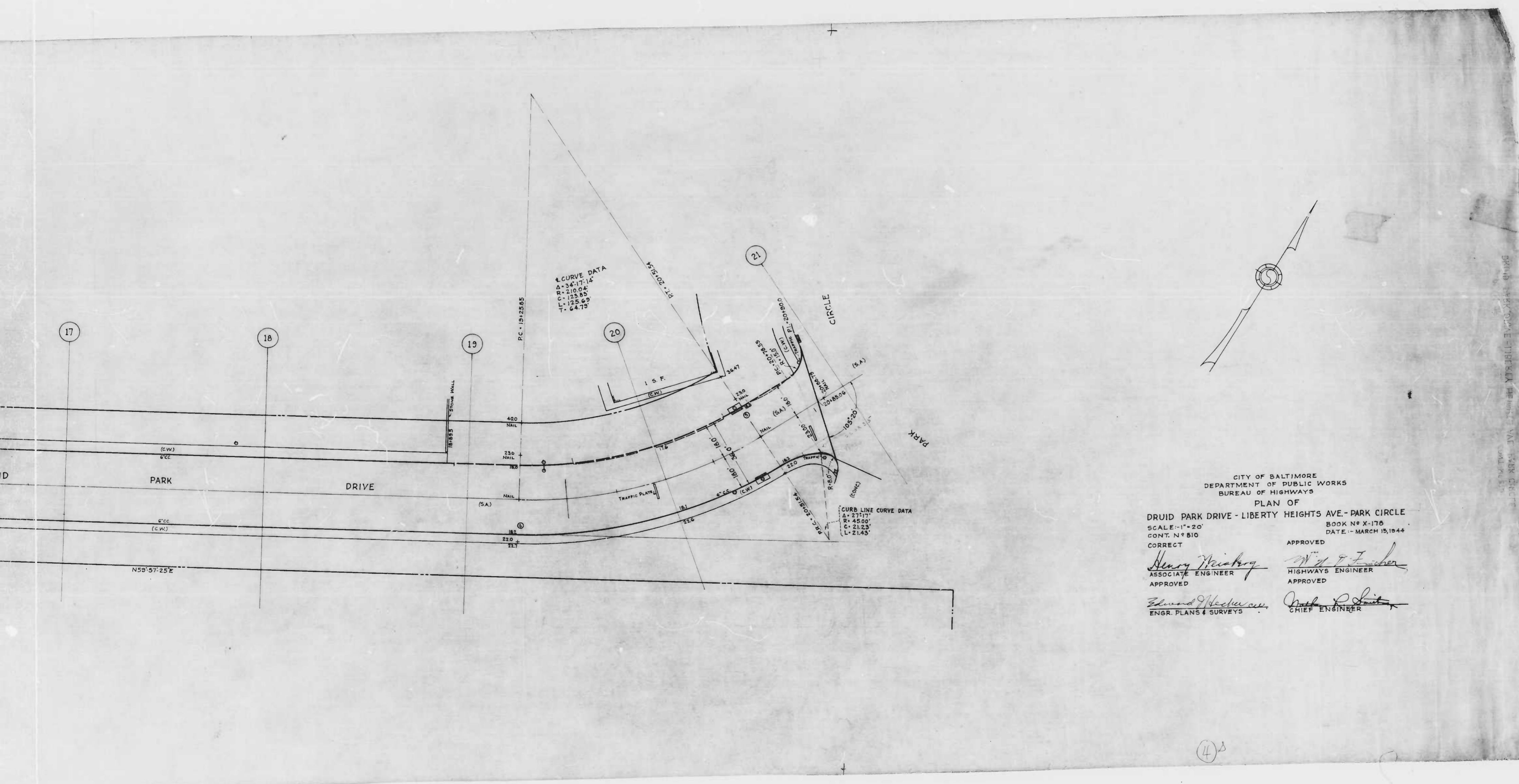

CITY OF BALTIMORE
 DEPARTMENT OF PUBLIC WORKS
 BUREAU OF HIGHWAYS
 PLAN OF
 DRUID PARK DRIVE - LIBERTY HEIGHTS AVE. - PARK CIRCLE
 SCALE: 1" = 20' BOOK NO. X-176
 CONT. NO. 810 DATE: MARCH 15, 1944

CORRECT APPROVED
Henry Heister *W. J. Fisher*
 ASSOCIATE ENGINEER HIGHWAYS ENGINEER
 APPROVED APPROVED
Edward Heister *Orville P. Smith*
 ENGR. PLANS & SURVEYS CHIEF ENGINEER

(4)

17 +50 18 +50 19 +50 20 +50 21

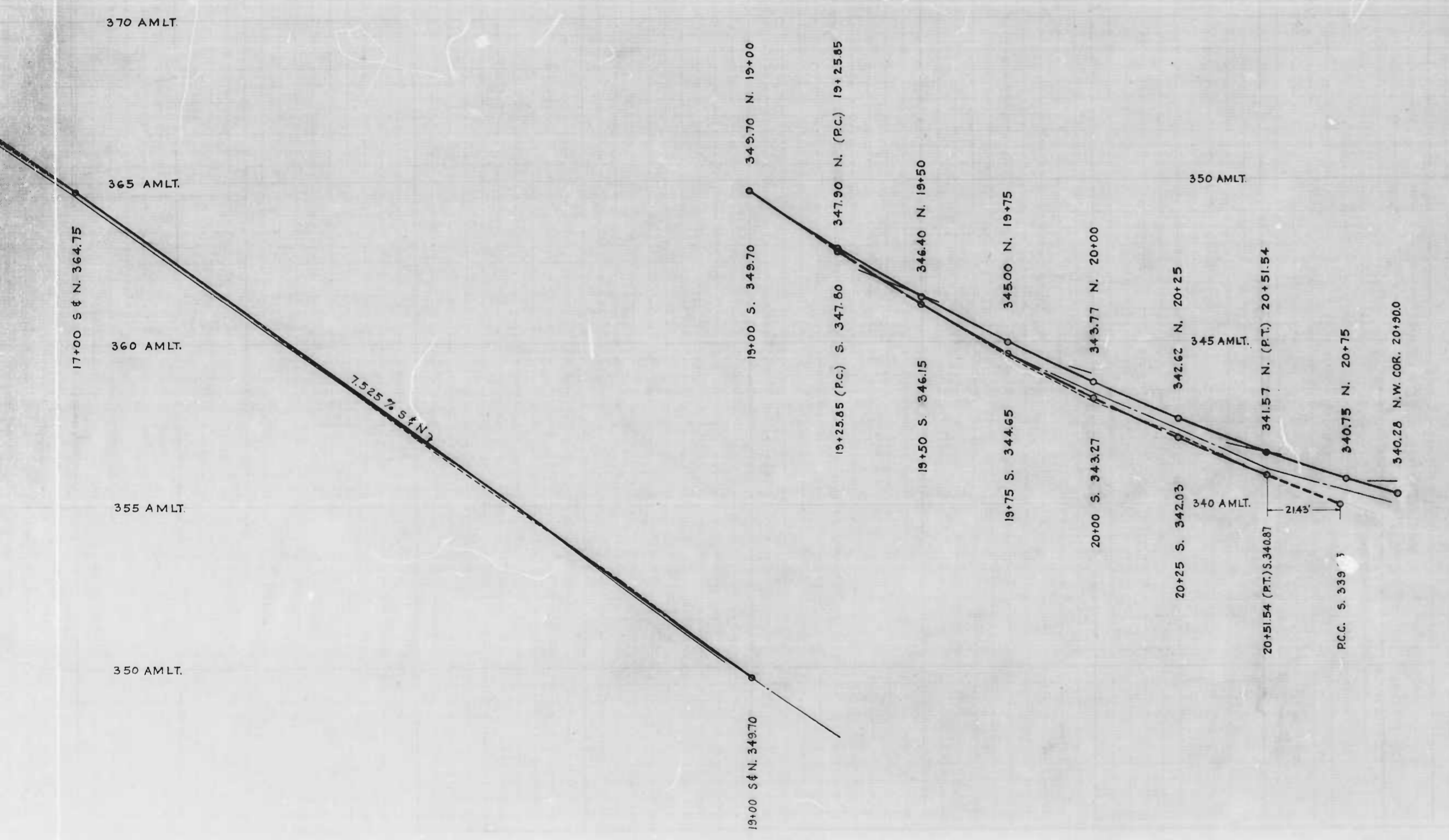

CITY OF BALTIMORE
DEPARTMENT OF PUBLIC WORKS
BUREAU OF HIGHWAYS
PROFILE OF
DRUID PARK DRIVE - LIBERTY HEIGHTS AVE. - PARK CIRCLE
SCALE - HOR. 1" = 20'
VER. 1" = 2'
BOOK N° X-178
DATE - MARCH 15, 1944
CONT. N° 810

CORRECTED - *Henry Weisberg*
ASSOCIATE ENGINEER
APPROVED - *Edward J. Madson*
ENGR. PLANS & SURVEYS

APPROVED - *W. J. F. ...*
HIGHWAYS ENGINEER
APPROVED - *Charles R. Smith*
CHIEF ENGINEER

DRUID PARK DRIVE - LIBERTY HEIGHTS AVE. - PARK CIRCLE
CONT. N° 810

32

44