

8Q5/806

RATIO - 24

1

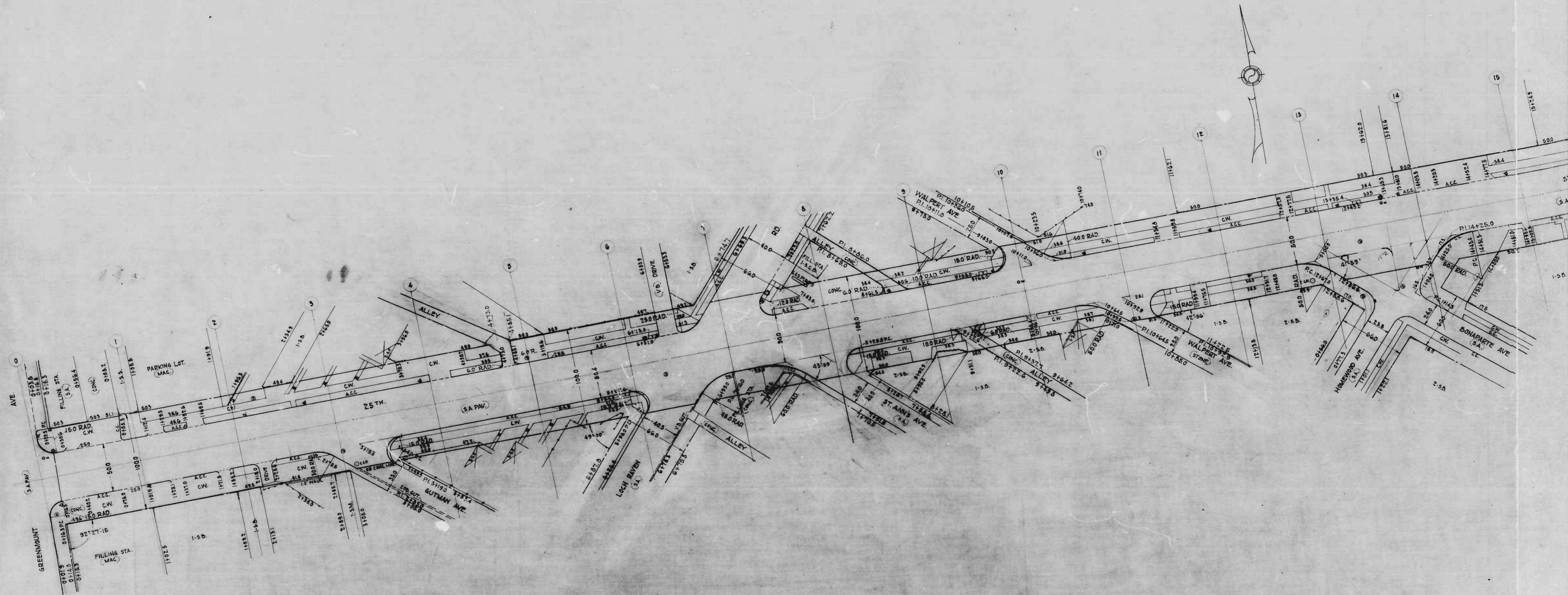

DESIGNED BY *J. J. [Signature]*
DRAWN BY *S. [Signature]*
CHECKED BY *[Signature]*

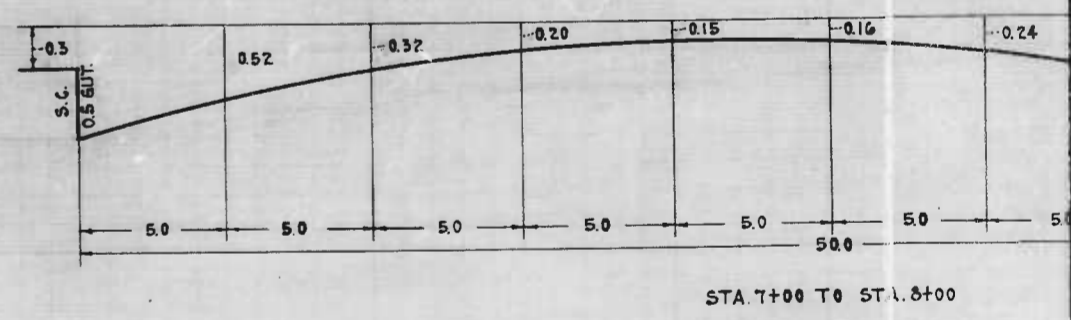
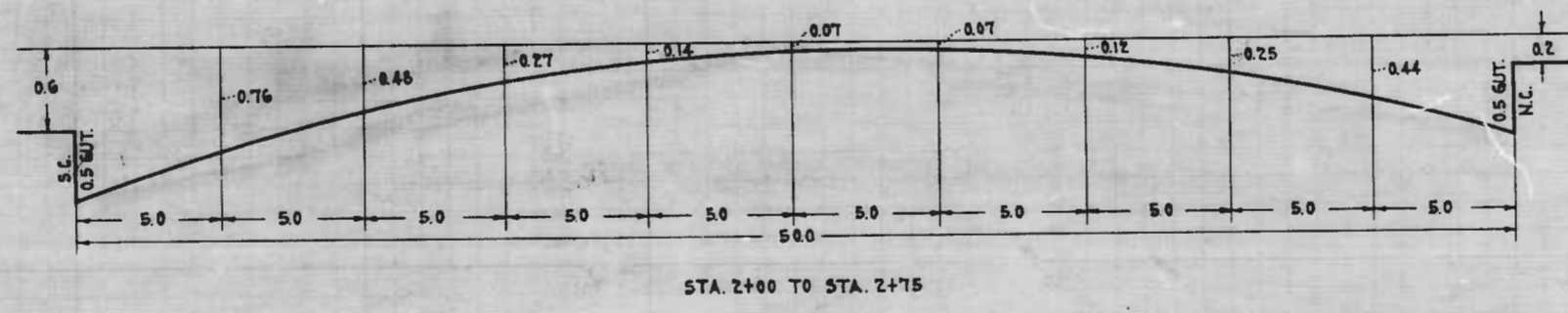
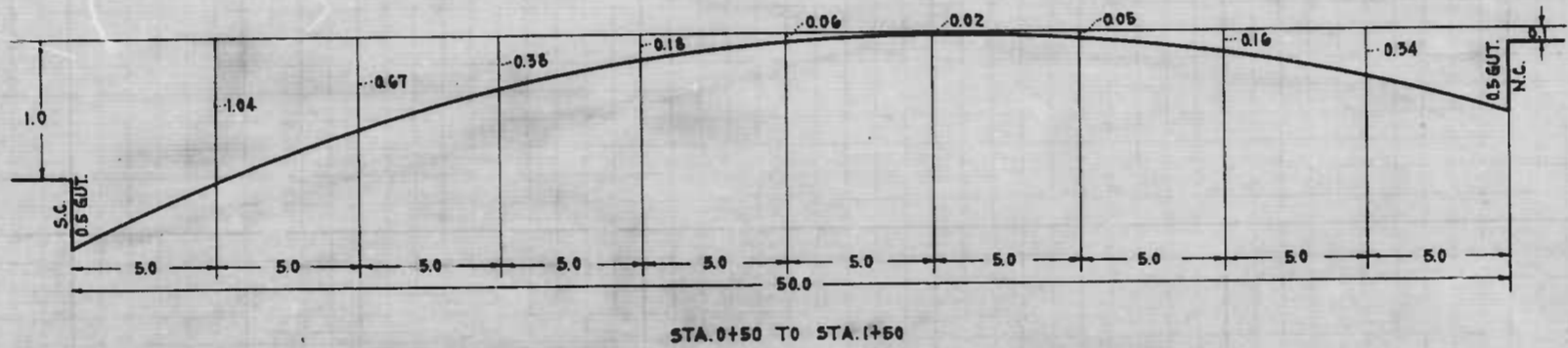
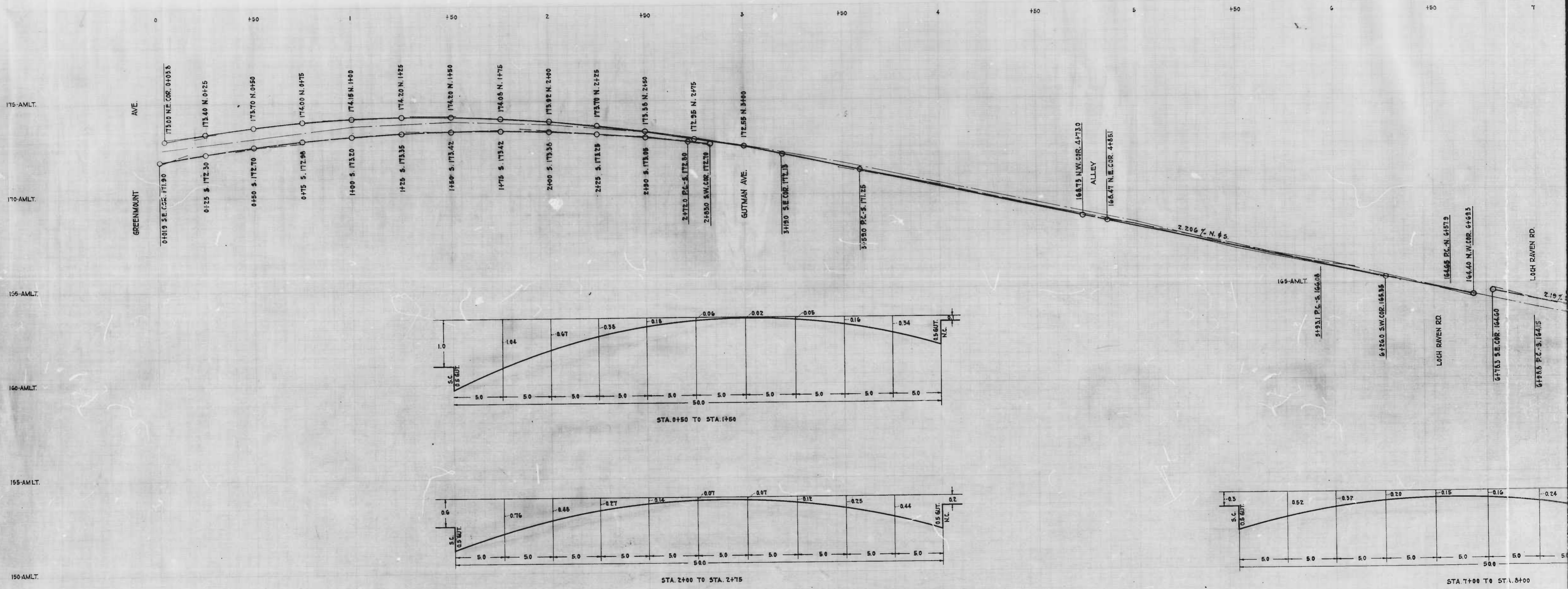

DRAWN BY: *J. J. H. H.*
 EXAMINED BY: *S. J. C. C.*
 ENGINEER IN CHARGE OF DRAWING

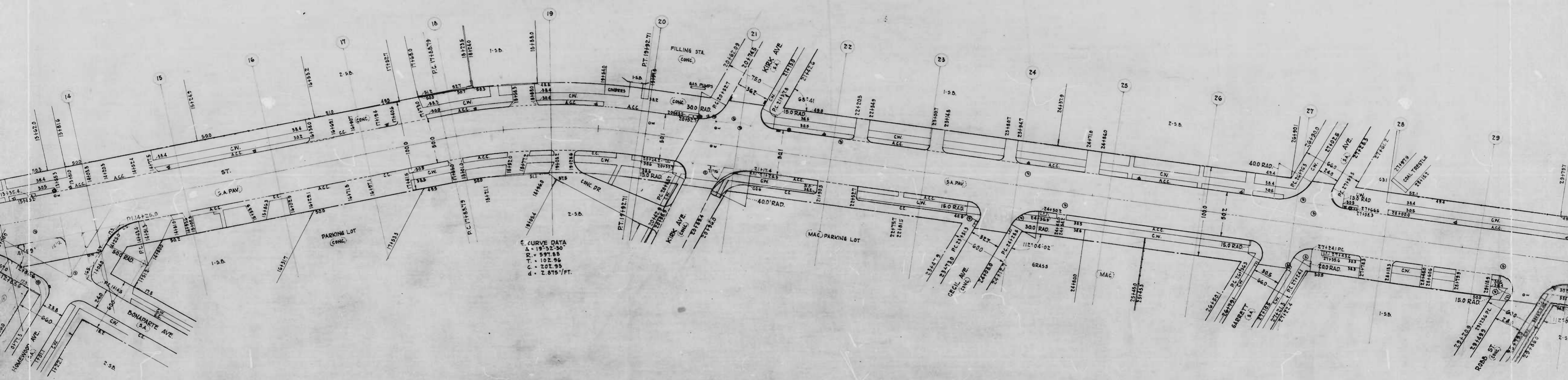

CITY OF BALTIMORE
 DEPARTMENT OF PUBLIC WORKS
 BUREAU OF HIGHWAYS
 LAYOUT OF
 TWENTY-FIFTH ST. - GREENMOUNT AVE. TO KIRK AVE.
 CONT. N° 806

SCALE - 1" = 400'
 APPROVED - *Henry Weathers*
 ASSOCIATE ENGINEER

500 N° X - 1177
 MARCH 14, 1946
 APPROVED - *W. J. [Signature]*
 HIGHWAYS ENGINEER

APPROVED - *Edward [Signature]*
 ENGR. - PLANS & SURVEYS

APPROVED - *Nathan [Signature]*
 CHIEF ENGINEER

DRAWN BY: J. J. HAYDEN
 EXAMINED BY: S. F. [Signature]
 ENGINEER IN CHARGE OF DRAWINGS

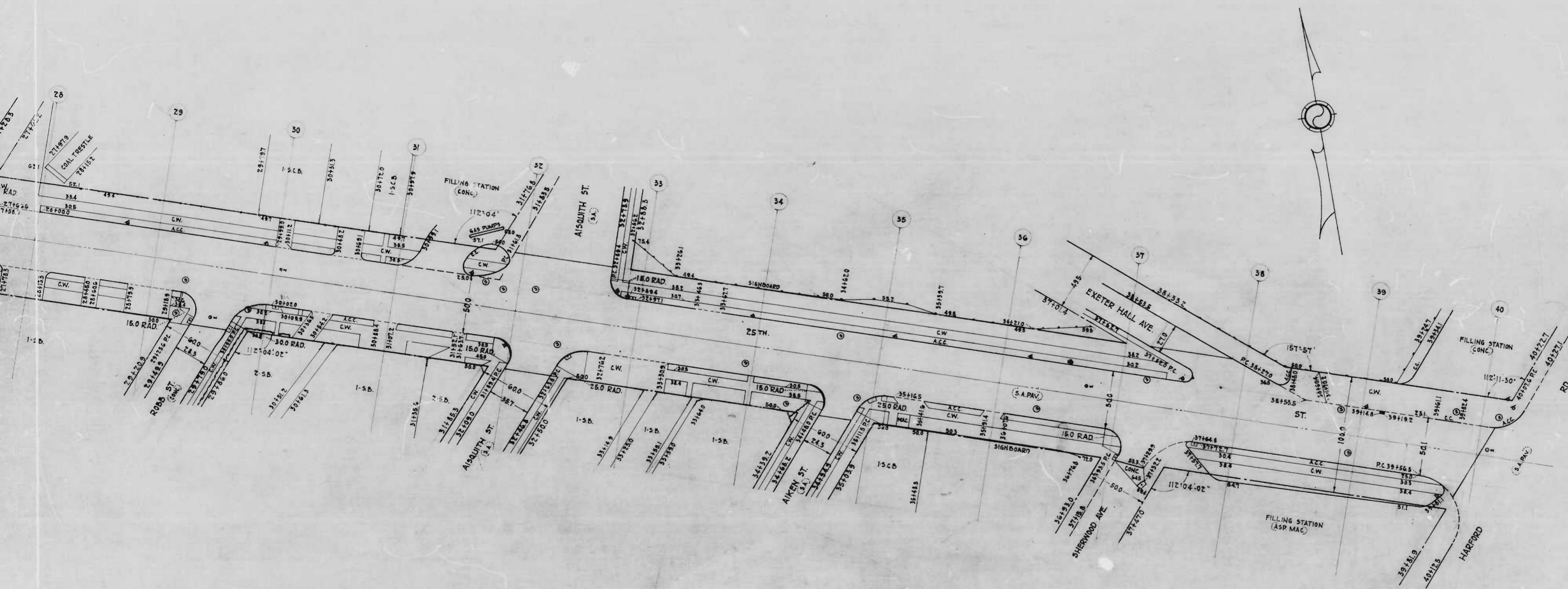

CITY OF BALTIMORE
 DEPARTMENT OF PUBLIC WORKS
 BUREAU OF HIGHWAYS
 LAYOUT OF
 TWENTY-FIFTH ST. - KIRK AVE. TO HARFORD RD.
 CONT. NO. 806 BOOK NO. X-111
 SCALE: 1"=400' MARCH 14, 1946

APPROVED - *Henry Weisberg* ASSOCIATE ENGINEER
 APPROVED - *Edward H. Flecker* ENGR. - PLANS & SURVEYS
 APPROVED - *W. J. [Signature]* HIGHWAYS ENGINEER
 APPROVED - *[Signature]* CHIEF ENGINEER

31

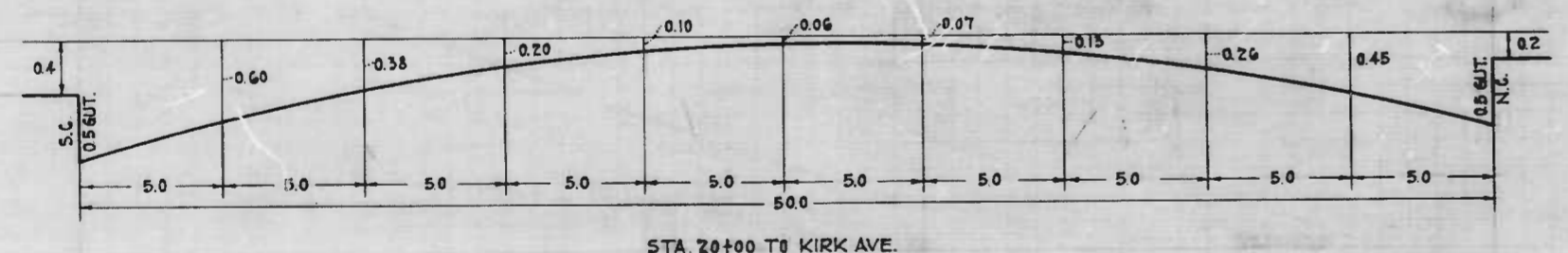
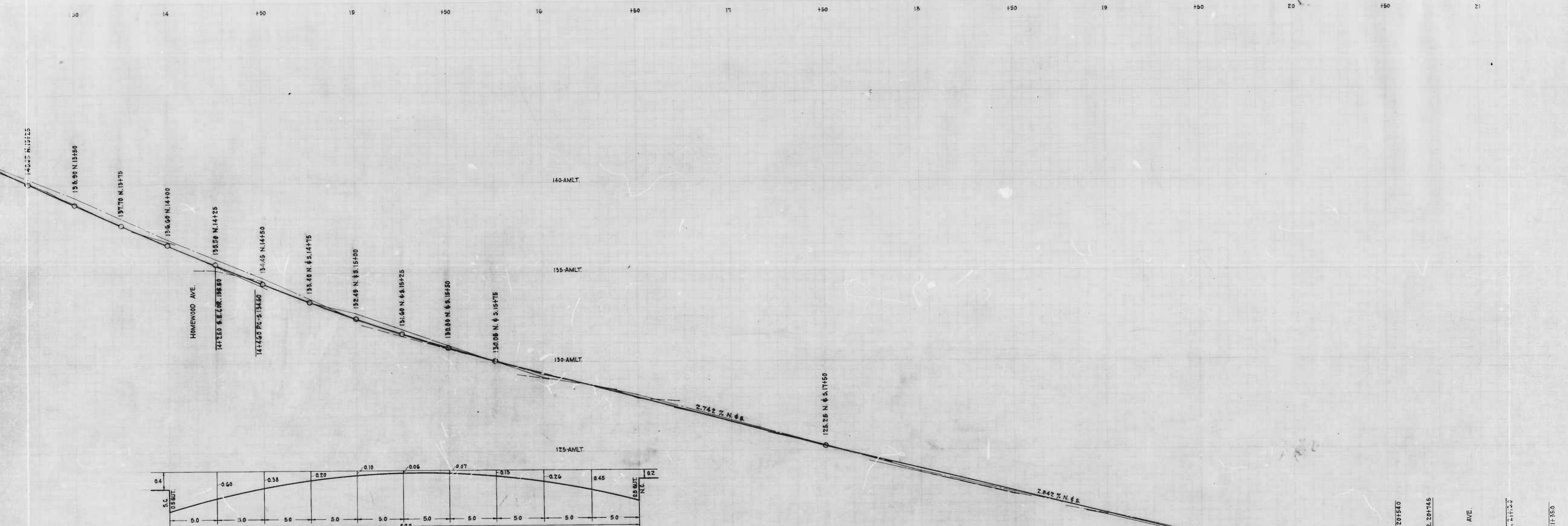

CITY OF BALTIMORE
 DEPARTMENT OF PUBLIC WORKS
 BUREAU OF HIGHWAYS
 PROFILE OF
 TWENTY-FIFTH ST. - GREENMOUNT AVE. TO KIRK AVE.
 CONT. N.E. 805

3000 N.A.X.-1177
 MARCH 14, 1946

APPROVED - *Henry Weisberg*
 ASSOCIATE ENGINEER

APPROVED - *W. P. Zwick*
 HIGHWAYS ENGINEER

APPROVED - *Edward J. Flecken*
 ENGR. PLANS & SURVEYS

APPROVED - *Walter P. Smith*
 CHIEF ENGINEER

+50 21 +50 22 +50 23 +50 24 +50 25 +50 26 +50 27 +50 28 +50

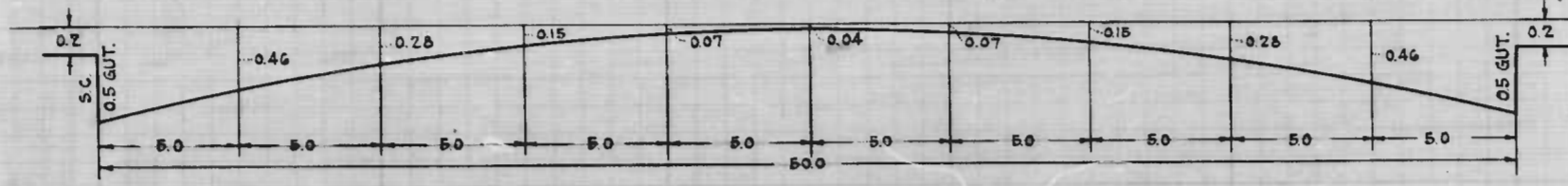

KIRK AVE. TO ROBB ST.
STA 21+50 TO SHERWOOD AVE

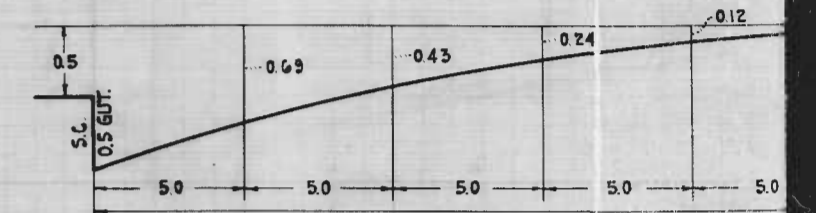

ROBB

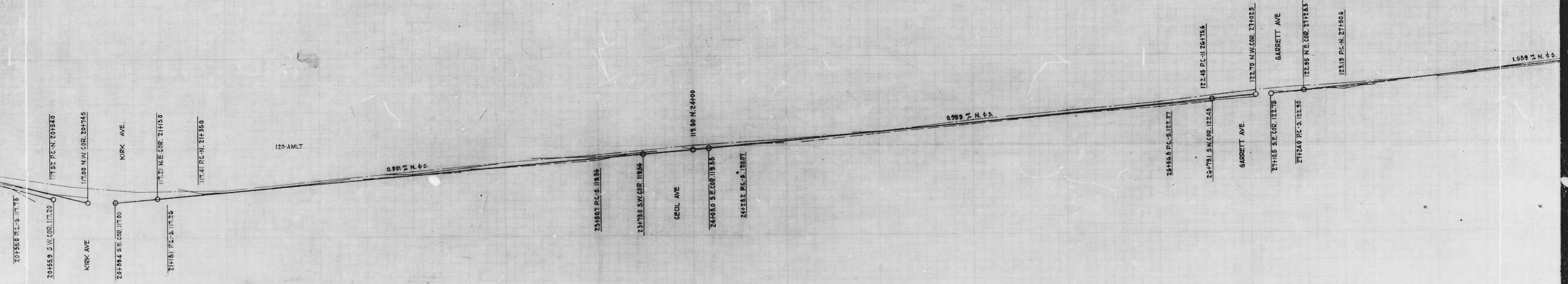

J.J. HAYDEN
S. L. Burns

43

150 25 +50 75 +50 30 +50 31 +50 32 +50 33 +50 34 +50 35 +50 150

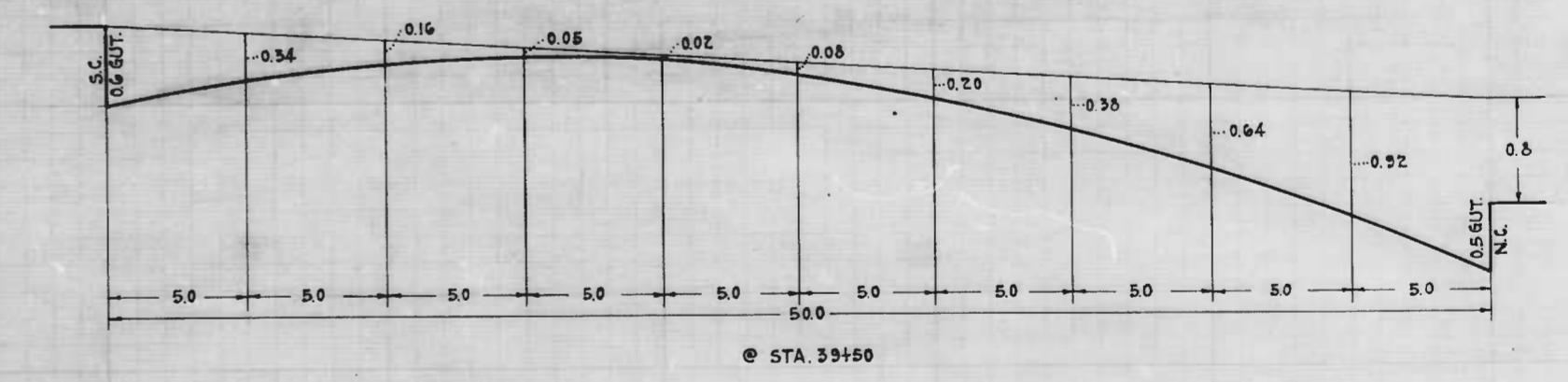
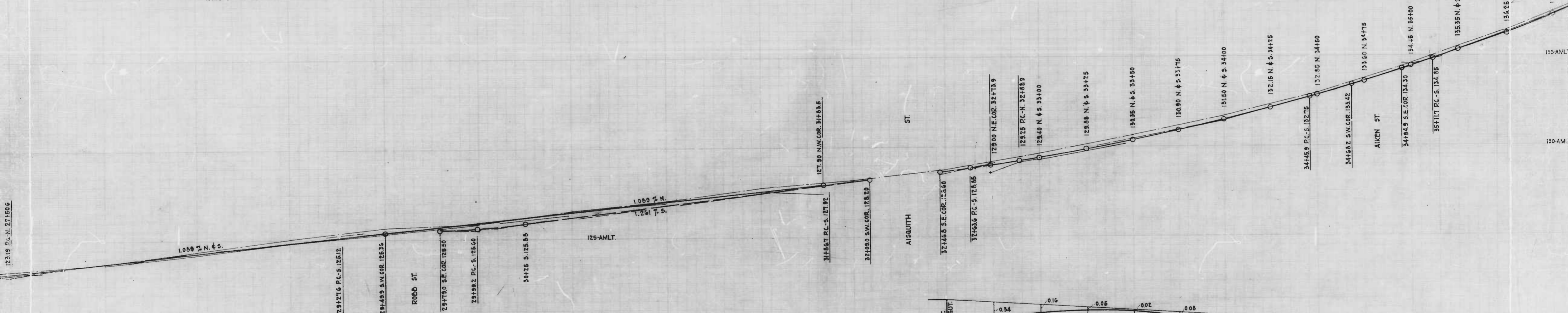
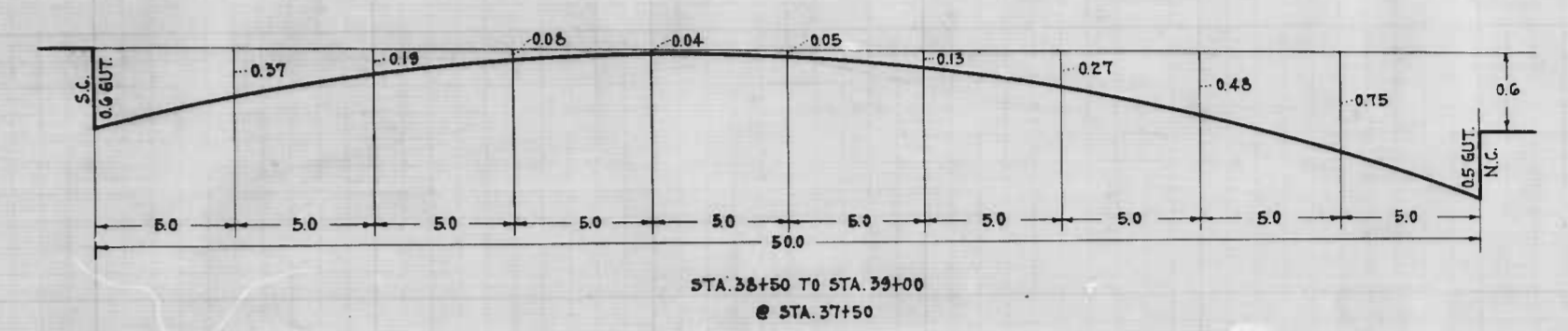
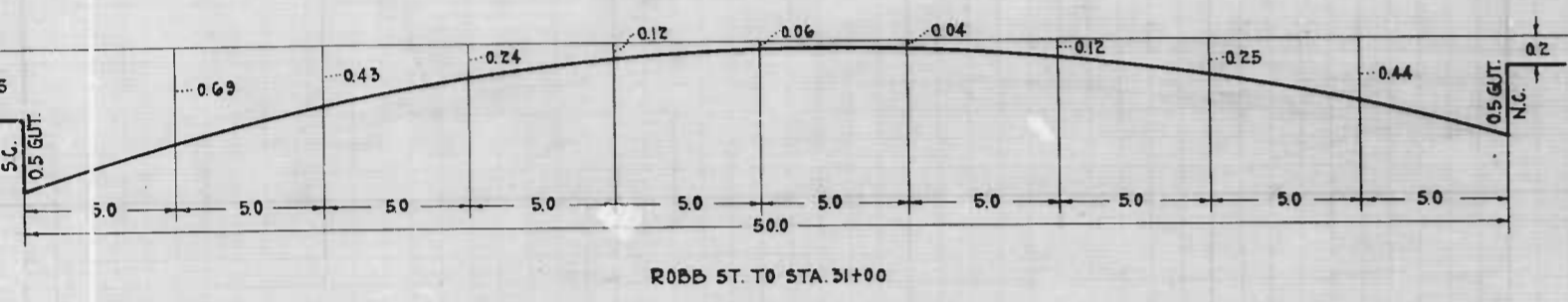

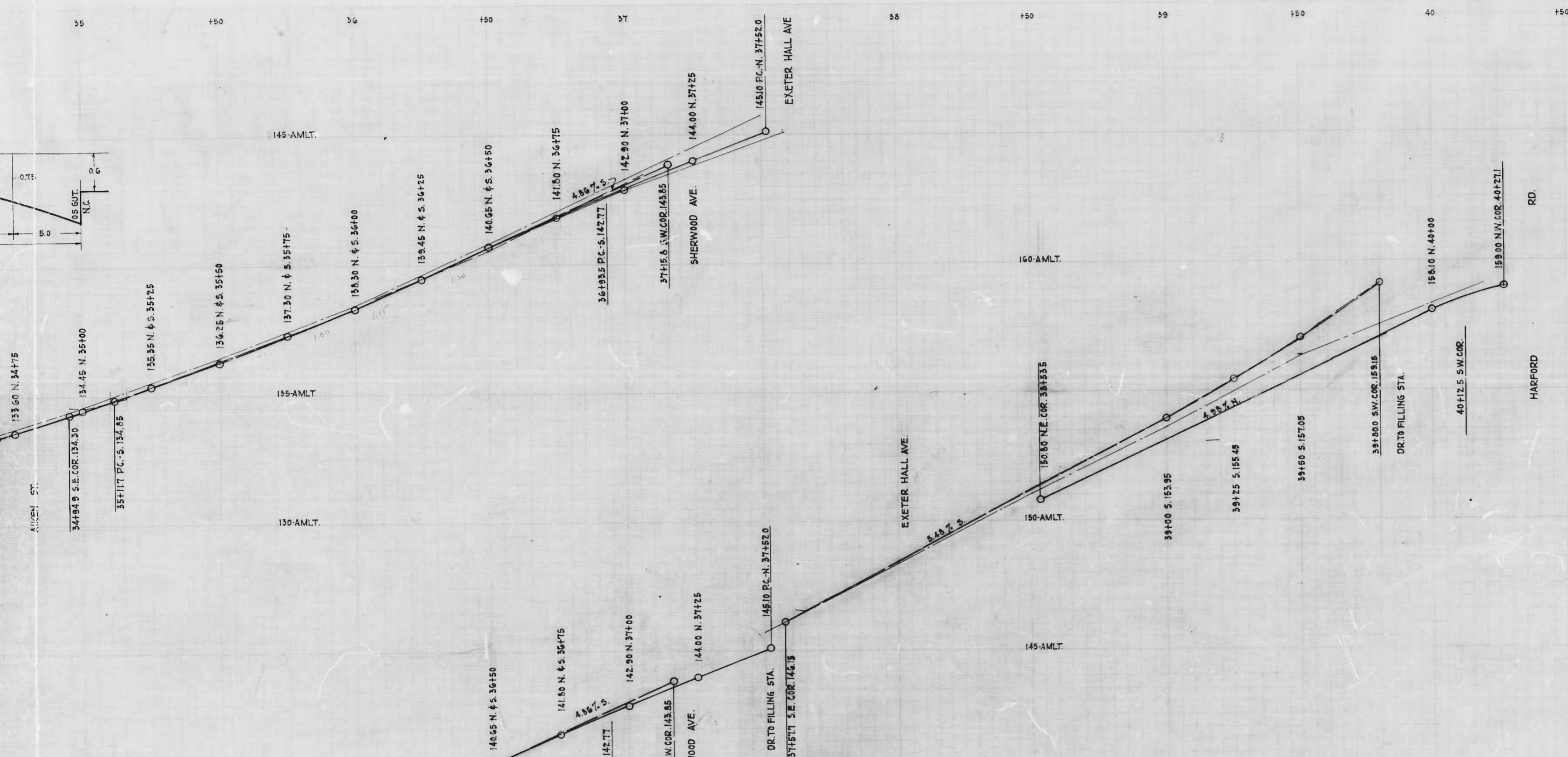

CITY OF BALTIMORE
 DEPARTMENT OF PUBLIC WORKS
 BUREAU OF HIGHWAYS
 PROFILE OF
 TWENTY-FIFTH ST. — KIRK AVE. — HARFORD RD.
 CONT. NO. 806
 HORIZ. SCALE: 1" = 20.0'
 VERT. SCALE: 1" = 2.0'
 BOOK NO. X-177
 MARCH 14, 1946

APPROVED: *Henry Weisberg*
 ASSOCIATE ENGINEER

APPROVED: *Edward J. Redman*
 ENGR. PLANS & SURVEYS

APPROVED: *W. J. Fisher*
 HIGHWAYS ENGINEER

APPROVED: *Walter J. ...*
 CHIEF ENGINEER

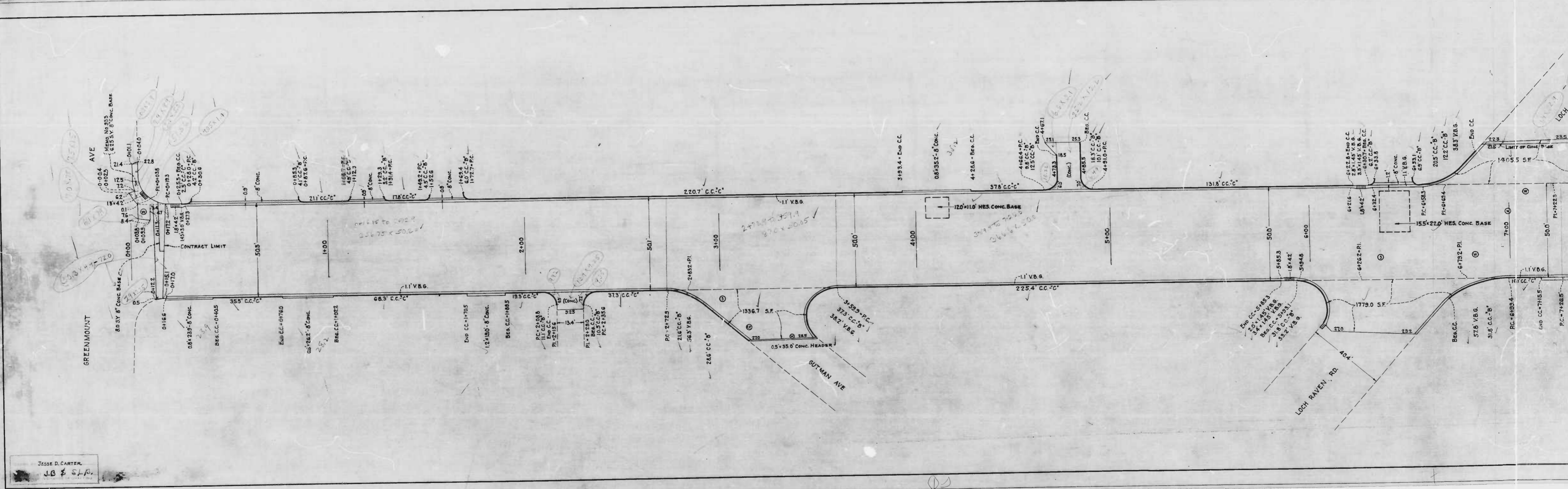

JESSE D. CARTER
 J.D. & S.L.R.

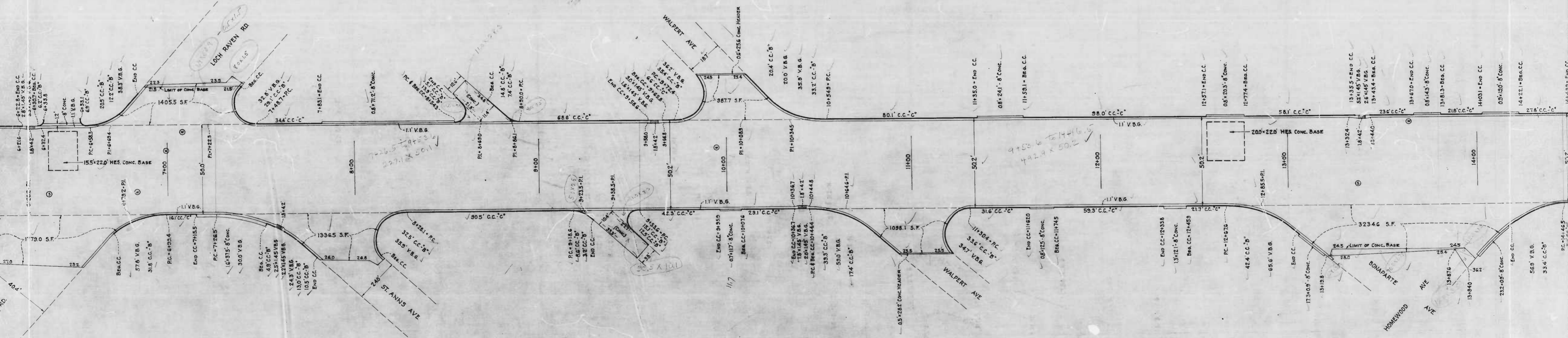

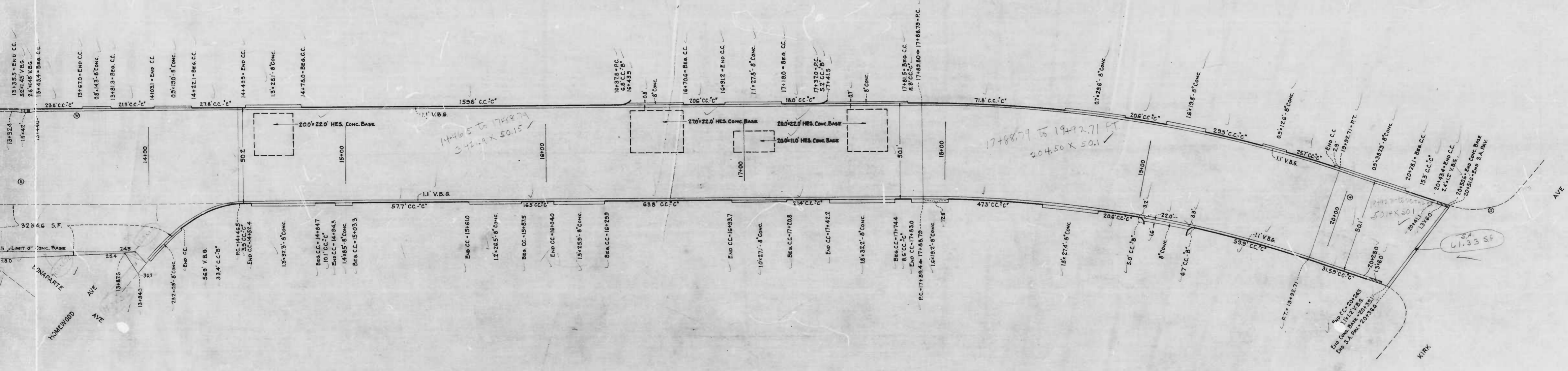

CIVIL
 DEPARTMENT
 SUPERVISOR

 TWE
 GREENMOUNT
 ST. ASPH. PAV. 1 1/2" WE
 NATIONAL PAV. & CO
 STARTED - 4-30-4
 SCALE - 1" = 20'

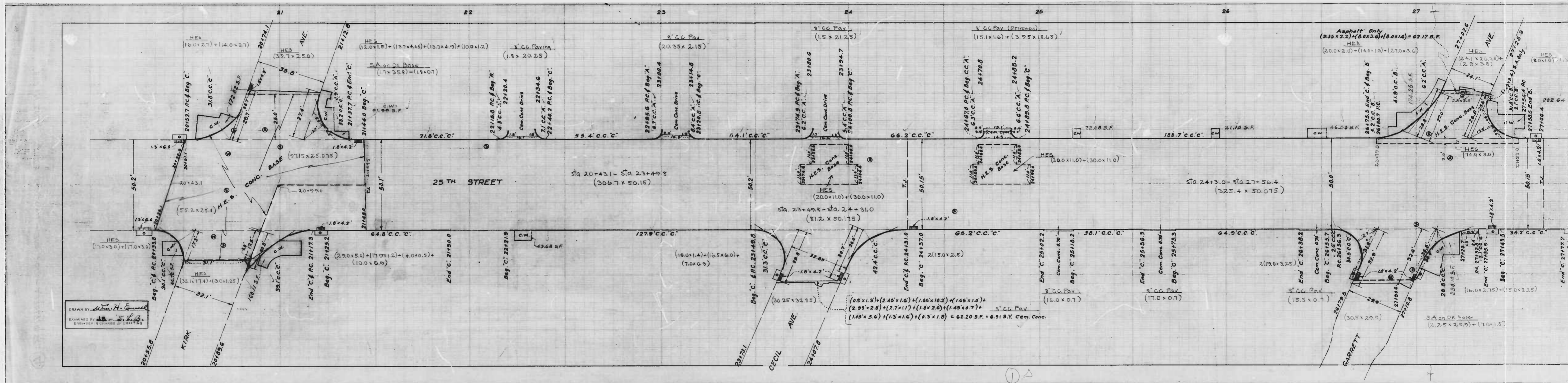

DRAWN BY *[Signature]*
EXAMINED BY *[Signature]*
ENR 1/10/50

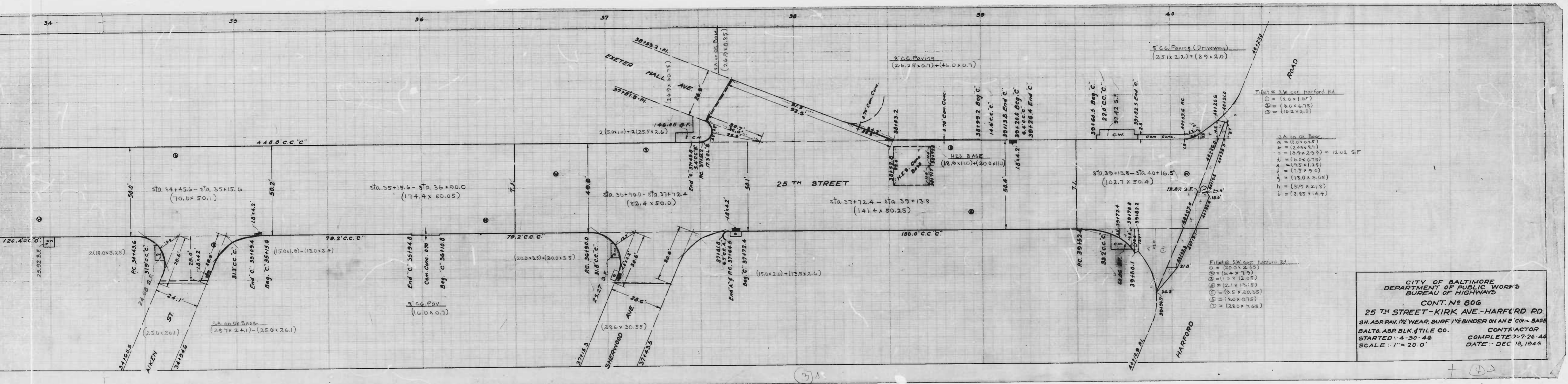

Notes for NW cor. Harford Rd.
 (1) = (8.0 x 1.67)
 (2) = (9.0 x 6.75)
 (3) = (10.2 x 2.0)

Notes for SW cor. Harford Rd.
 (1) = (2.0 x 0.25)
 (2) = (2.25 x 0.75)
 (3) = (3.0 x 2.0) - 12.02 SIF
 (4) = (6.0 x 0.75)
 (5) = (7.5 x 1.25)
 (6) = (1.5 x 0.5)
 (7) = (1.8 x 0.05)
 (8) = (5.0 x 2.0)
 (9) = (2.85 x 1.4)

CITY OF BALTIMORE
 DEPARTMENT OF PUBLIC WORKS
 BUREAU OF HIGHWAYS
 CONT. No. 806
 25 TH STREET - KIRK AVE - HARFORD RD.
 SH. ASP. PAV. 1 1/2" WEAR SURF 1 1/2" BINDER ON AN 8" CON. BASE
 BALTO. ASP. BLK. TILE CO. CONTRACTOR
 STARTED: 4-30-46 COMPLETE: 7-26-46
 SCALE: 1" = 20.0' DATE: DEC 10, 1946

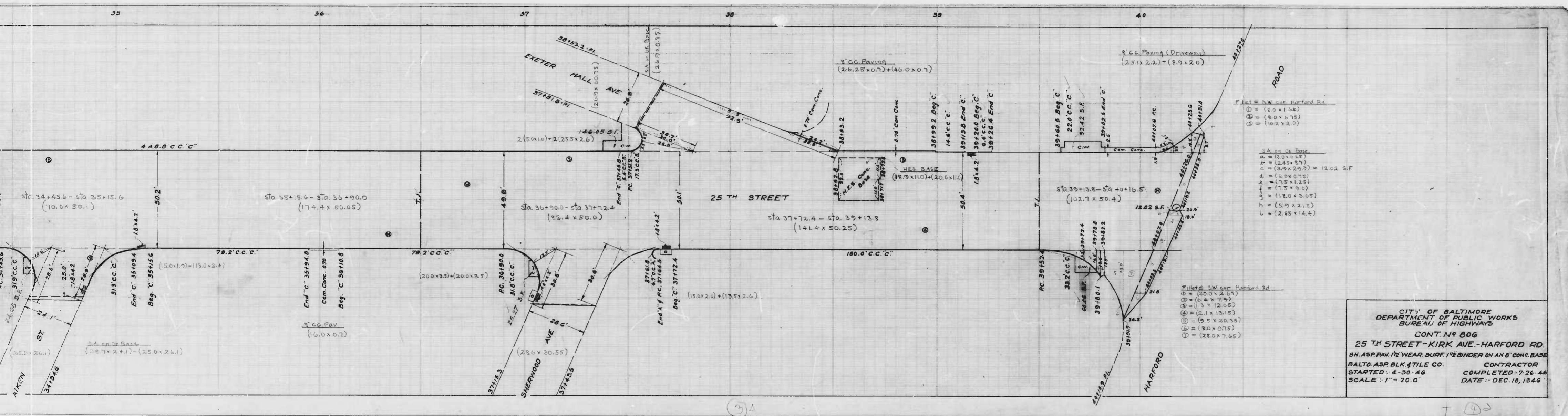

Fact = NW cor Harford Rd.
 (1) = (8.0 x 1.62)
 (2) = (9.0 x 1.73)
 (3) = (10.2 x 2.0)

SA on W Base
 P = (2.0 x 0.35)
 R = (2.4 x 0.37)
 C = (3.9 x 2.9)
 L = (1.0 x 0.75)
 T = (1.5 x 1.25)
 H = (1.8 x 0.65)
 L = (1.5 x 2.15)
 L = (2.45 x 1.4)

Files & SW cor Harford Rd.
 (1) = (2.0 x 2.4)
 (2) = (6.4 x 7.9)
 (3) = (1.3 x 12.05)
 (4) = (2.1 x 13.15)
 (5) = (5.5 x 20.35)
 (6) = (8.0 x 0.75)
 (7) = (28.0 x 7.65)

CITY OF BALTIMORE
 DEPARTMENT OF PUBLIC WORKS
 BUREAU OF HIGHWAYS
 CONT. N^o 806
 25 TH STREET - KIRK AVE. - HARFORD RD.
 SH. ASP. PAV. 1 1/2" WEAR SURF 1 1/2" BINDER ON AN 8" CONC. BASE
 BALTO. ASP. BLK. TILE CO. CONTRACTOR
 STARTED: 4-30-46 COMPLETED: 7-26-46
 SCALE: 1" = 20.0' DATE: DEC. 16, 1946