

796/797

RATIO - 24

5

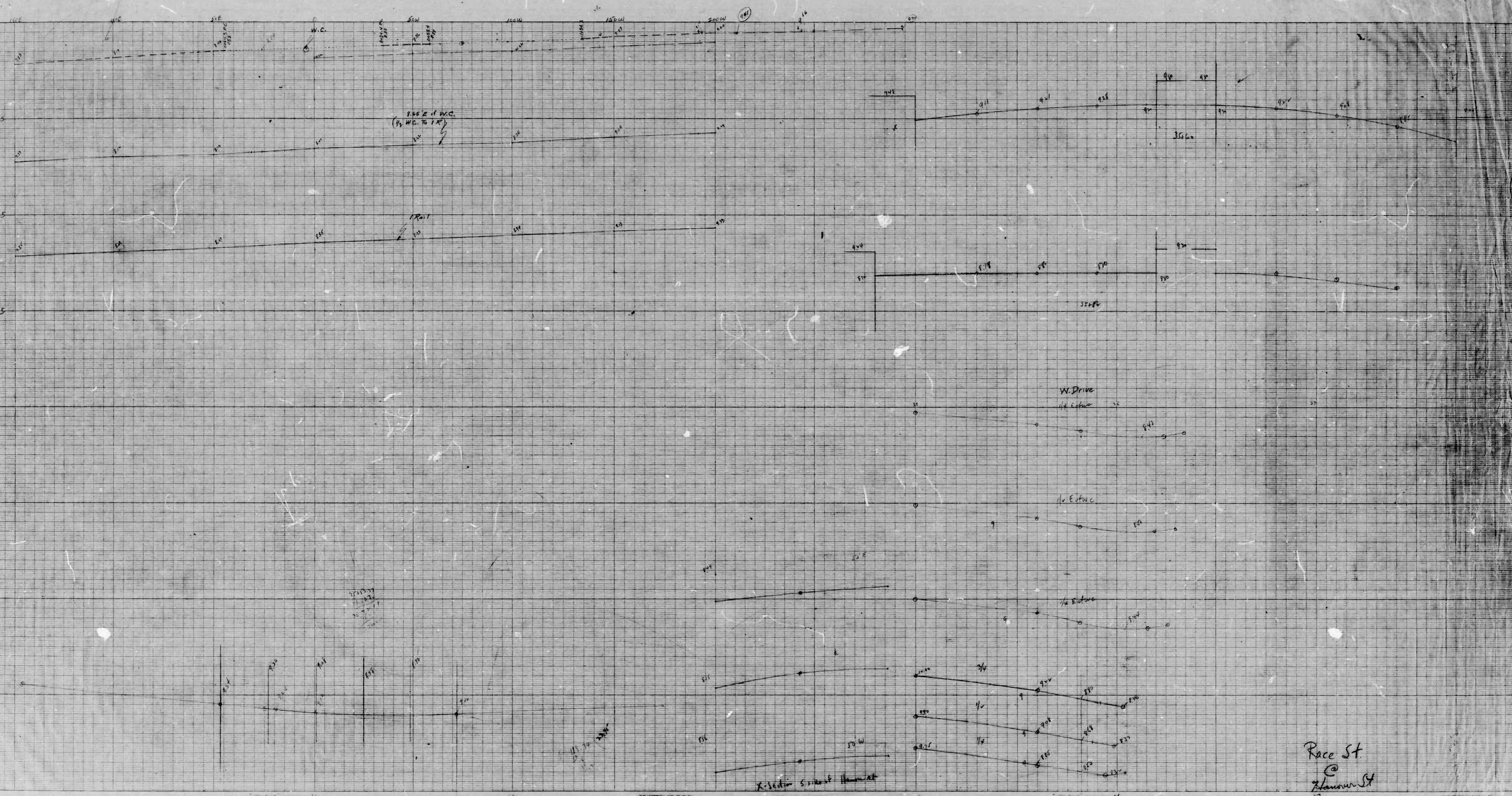

PRINTED IN U.S.A.
EUGENE DIEZEL CO.

PRINTED IN U.S.A.
ON 100% RAG PAPER MADE IN U.S.A.

E. Drive
PRINTED IN U.S.A.
EUGENE DIEZEL CO.

Race St.
@
Blair St.

PRINTED IN U.S.A.
ON 100% RAG PAPER MADE IN U.S.A.

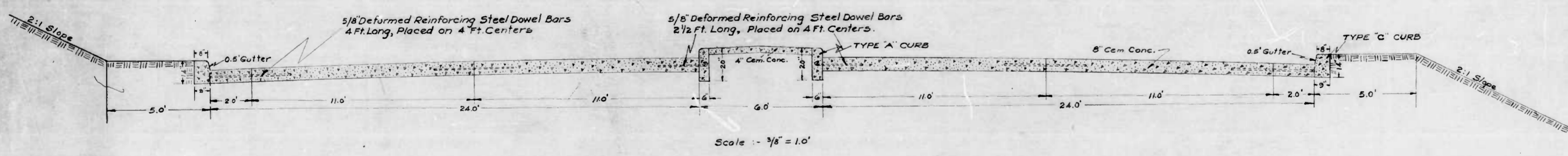
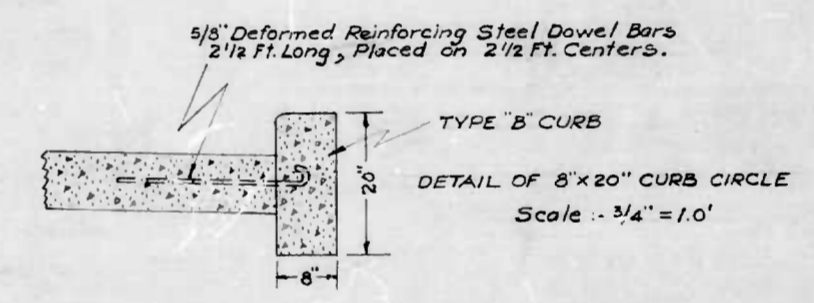
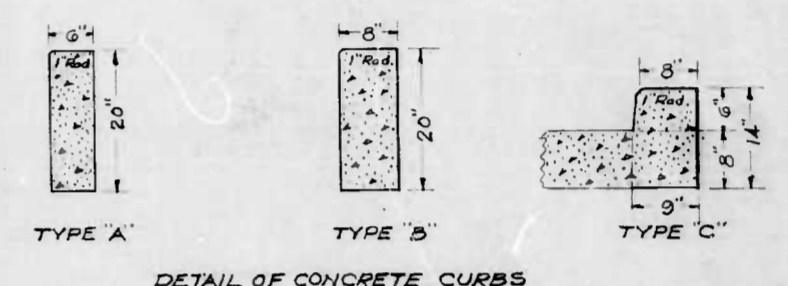
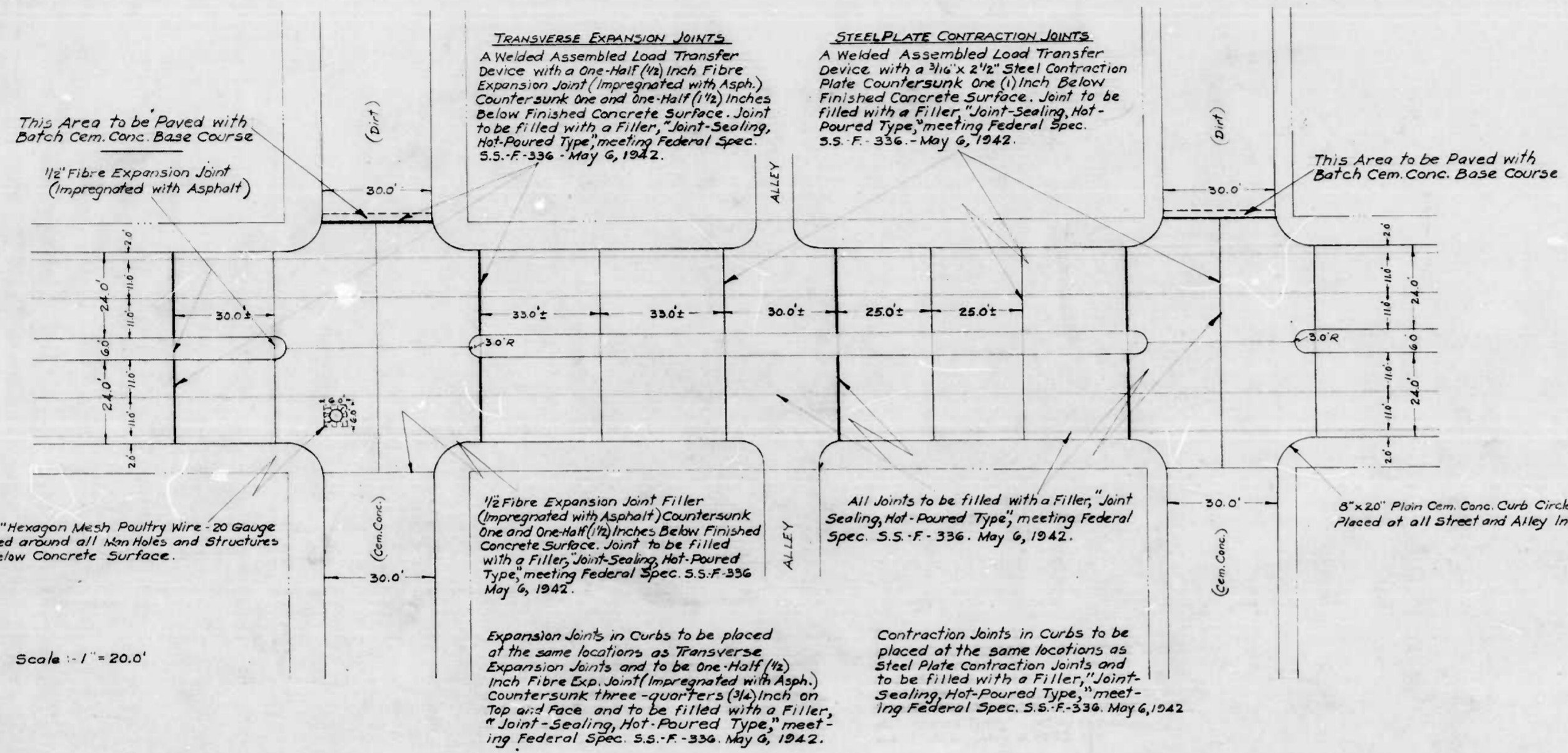

DESIGNED BY: W. H. Engel
 DRAWN BY: H. Weisberg
 CHECKED BY: H. Weisberg

CITY OF BALTIMORE
 DEPARTMENT OF PUBLIC WORKS
 BUREAU OF HIGHWAYS
 DETAIL PLAN
 POTEY ST. (RACE ST.) - PATAPSCO AVE. - HANOVER ST.
 CONT. NO. 797 DATE: APR. 12, 1945.
 APPROVED APPROVED
 W. J. Fisher HIGHWAYS ENGINEER
 Nelson L. Smith CHIEF ENGINEER

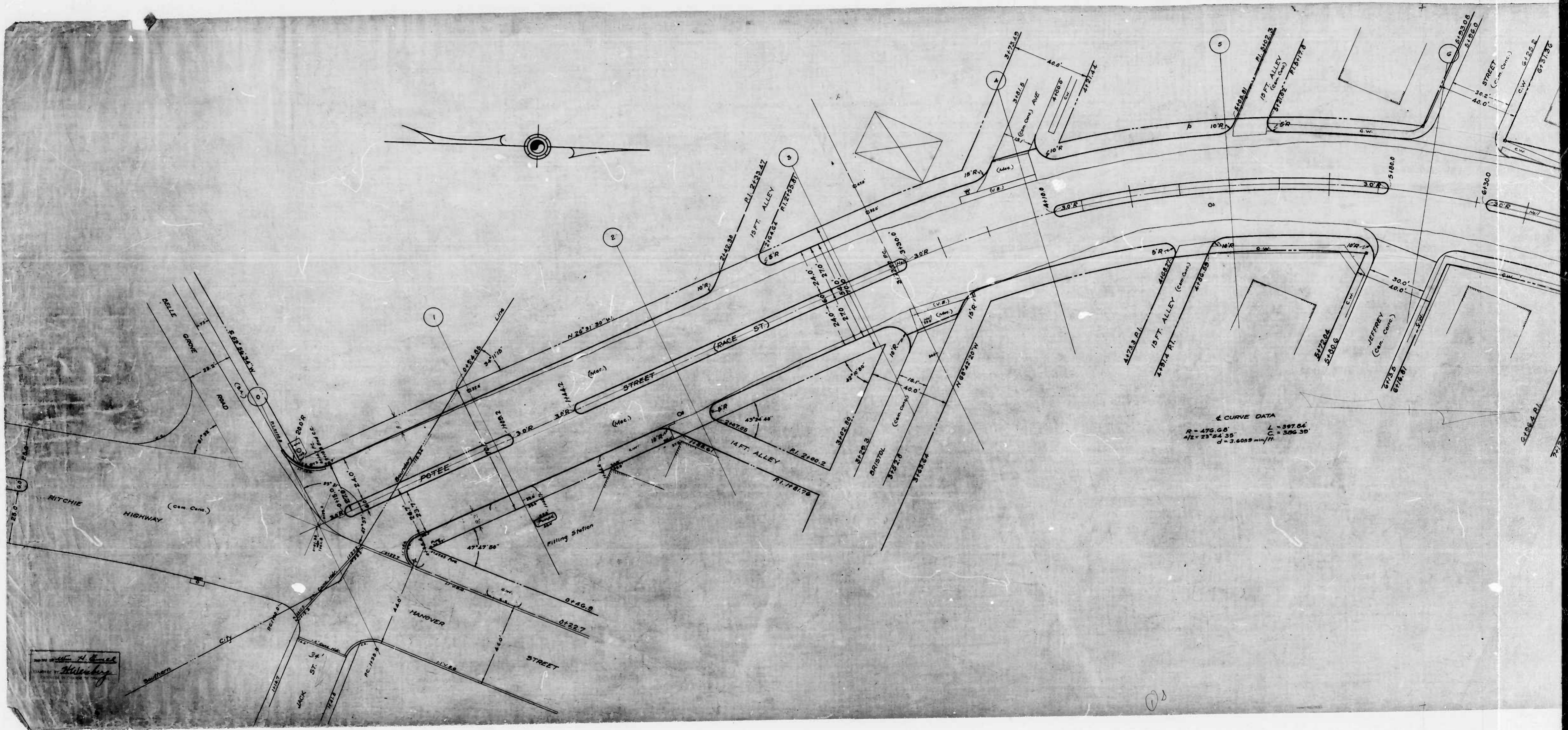

W. H. H. H. H.
ENGINEER
H. H. H. H. H.

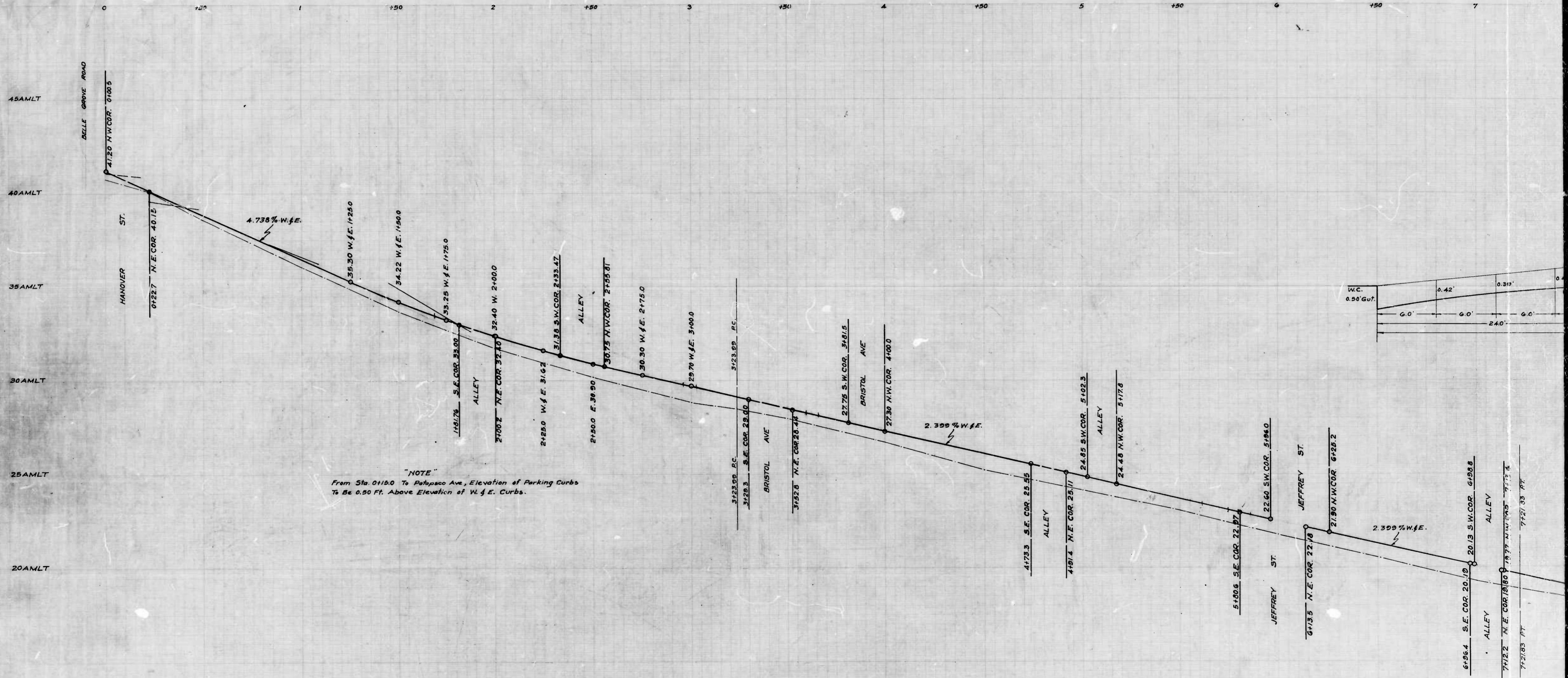

H. H. Emill
 H. H. Emill
 H. H. Emill

10

796/797

RATIO - 24

1

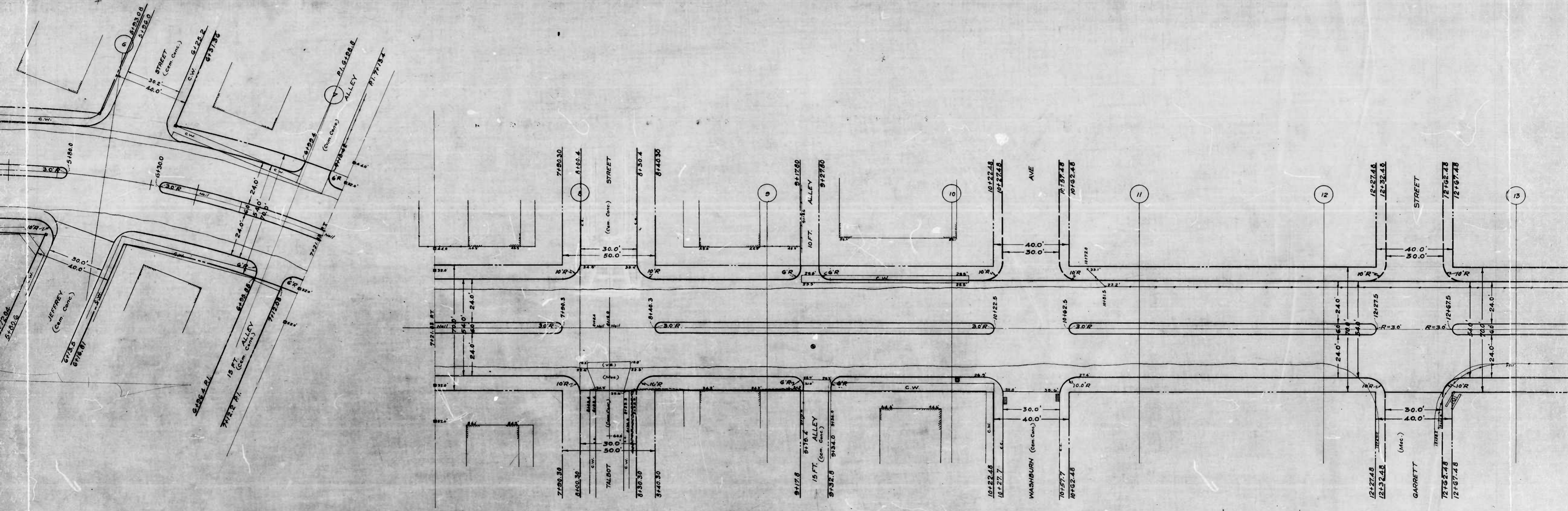

Notify R/W Division
re-location of
alley paving

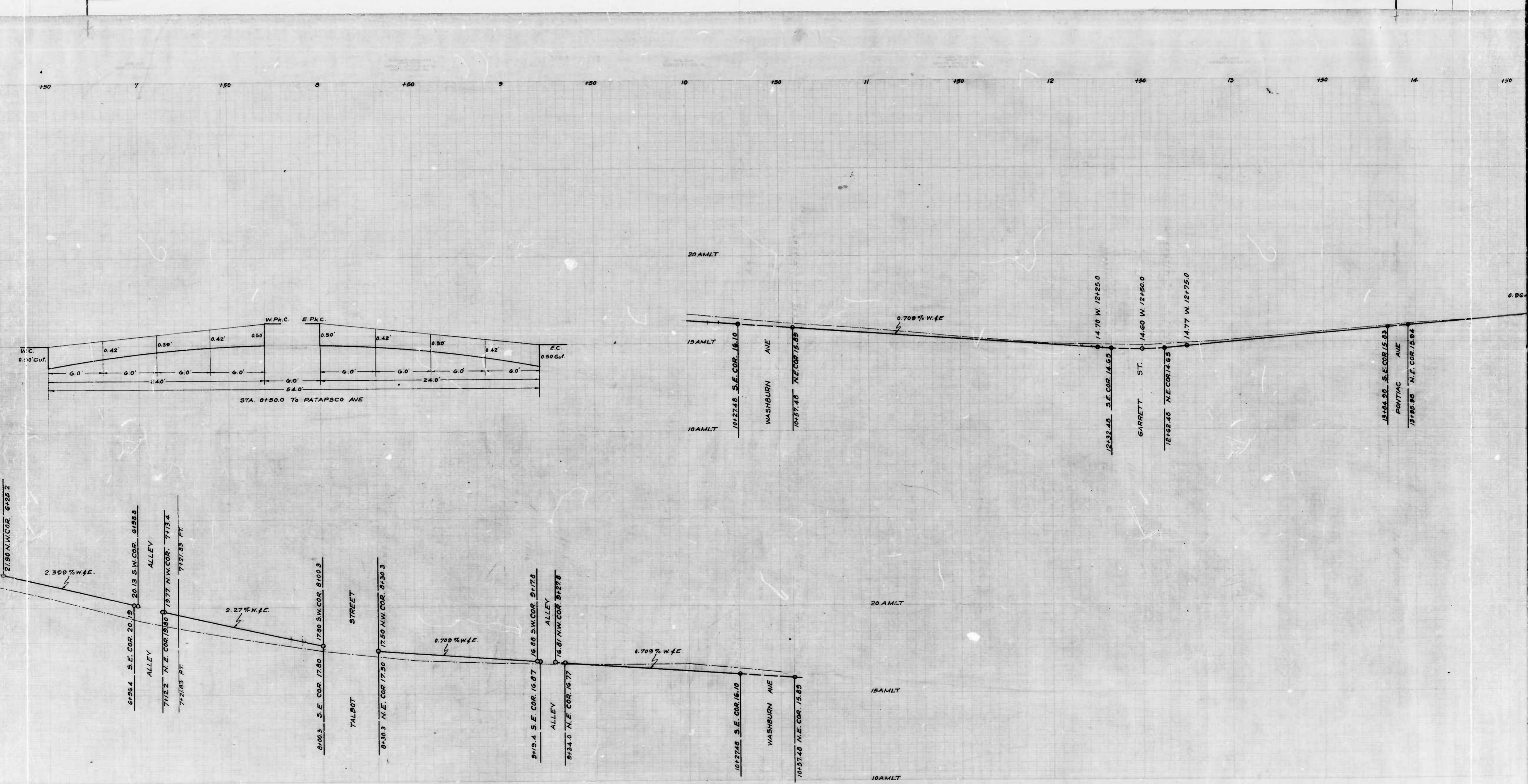

1027.44
 924.00
 103.44

796/797

RATIO - 24

1

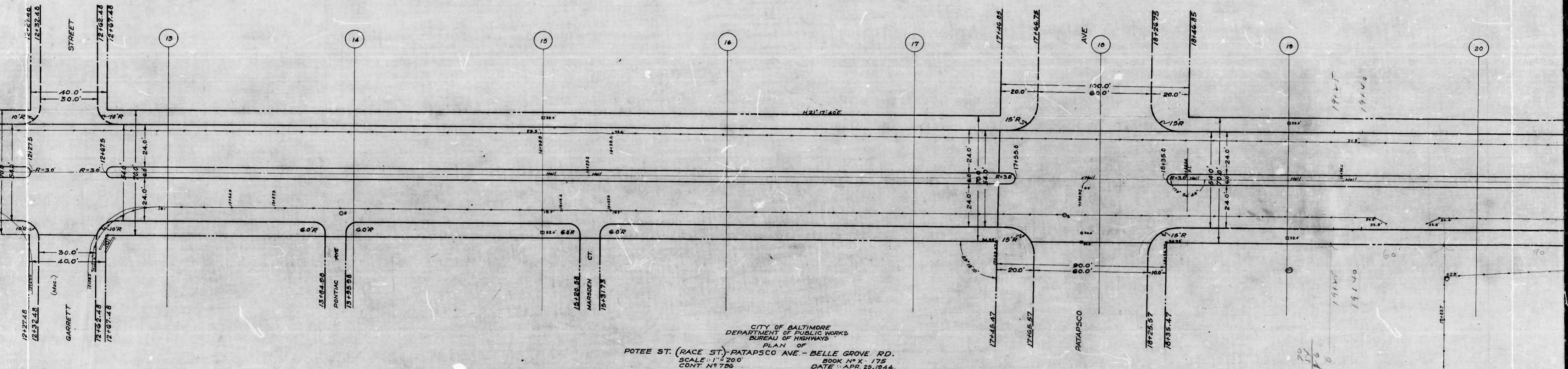
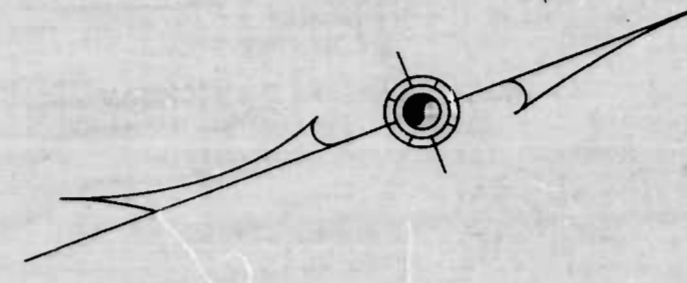

CITY OF BALTIMORE
 DEPARTMENT OF PUBLIC WORKS
 BUREAU OF HIGHWAYS
 PLAN OF
 POTEE ST. (RACE ST.) - PATAPSCO AVE. - BELLE GROVE RD.
 SCALE: 1" = 20.0' BOOK NO. X - 175
 CONT. NO. 796 DATE: APR. 25, 1944.

APPROVED *Frank Sweeney* ASSOCIATE ENGINEER
 APPROVED *W. A. Fisher* HIGHWAYS ENGINEER
 APPROVED *Edmond McKeown* ENGR. PLANS & SURVEYS
 APPROVED *Arthur R. Smith* CHIEF ENGINEER

796/797

RATIO - 24

6

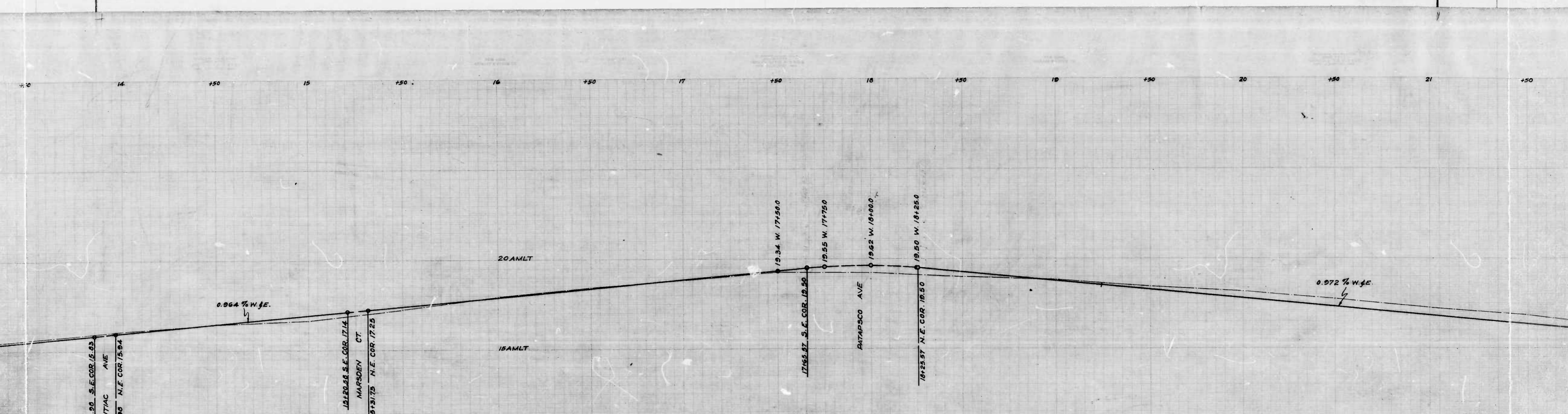

12.50
13.50
14.00

NOTE
From PatapSCO Ave. to Sta. 35+440, elevation of Parking Curbs to be 8.00 ft. above elevation of W.G.E. Curbs.

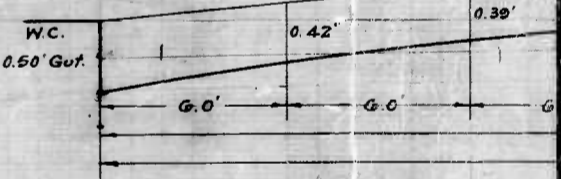

CITY OF BALTIMORE
 DEPARTMENT OF PUBLIC WORKS
 BUREAU OF HIGHWAYS
 PROFILE
 POTEY ST. (RACE ST) - PATAPSCO AVE - BELLE GROVE RD.
 SCALE: HOR: 1" = 20.0' BOOK N° X-175
 VER: 1" = 2.0' DATE: APR. 25, 1944.
 CONT. N° 796

APPROVED *Edward Hecker* ASSOCIATE ENGINEER
 APPROVED *W. A. T. Fisher* HIGHWAYS ENGINEER
 APPROVED *Edward Hecker* ENGR. PLANS & SURVEYS
 APPROVED *W. A. T. Fisher* CHIEF ENGINEER

(3)

796/797

RATIO - 24

1

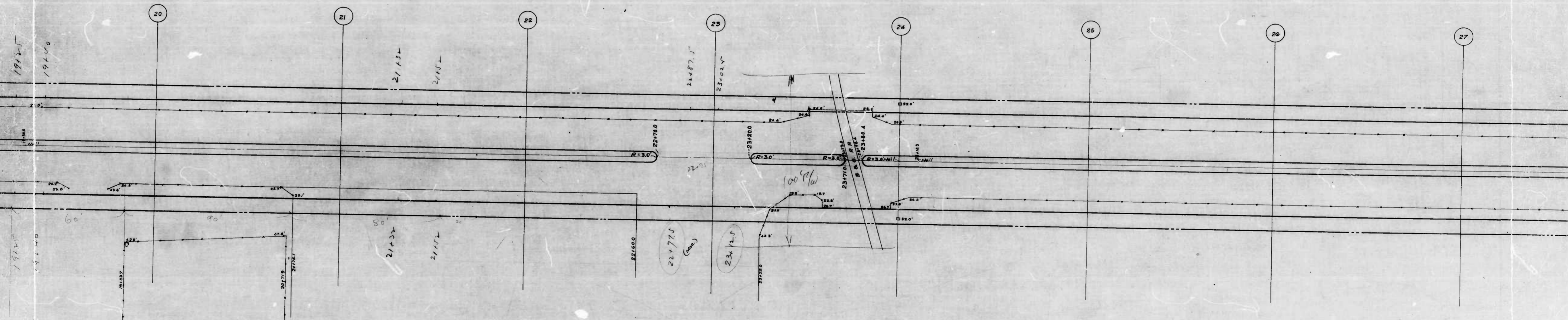

35 3
45 1
61 2

22477.5
(mm)

23412.5

35 3
45 1
61 2

②

796/797

RATIO - 24

6

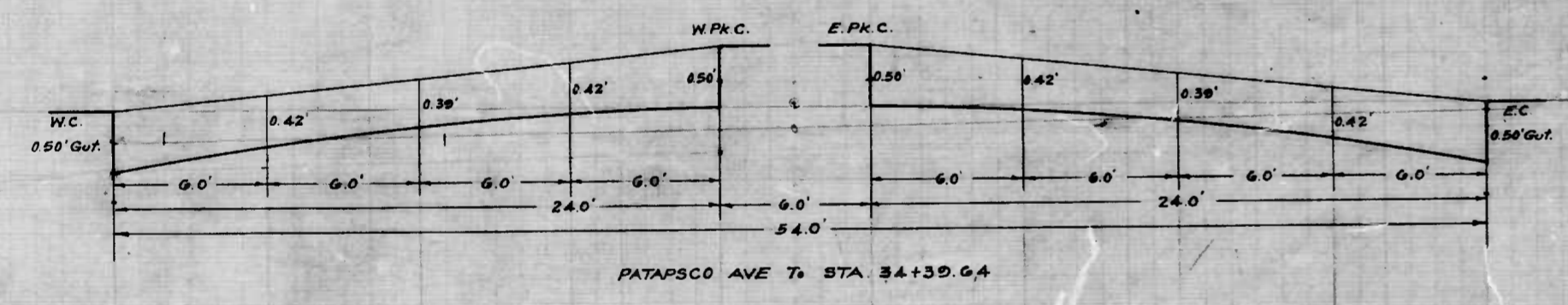
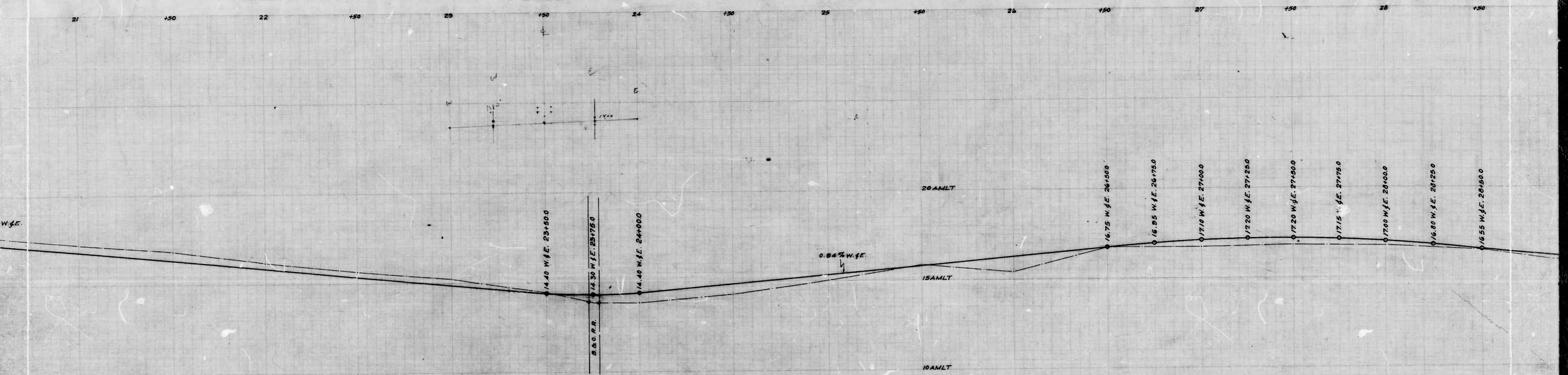

42

796/797

RATIO - 24

1

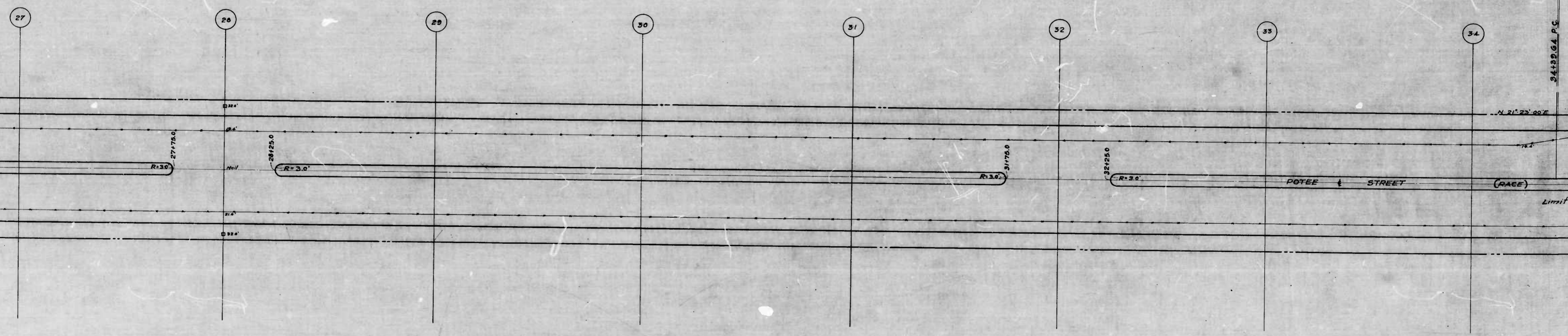

5

796/797

RATIO - 24

6

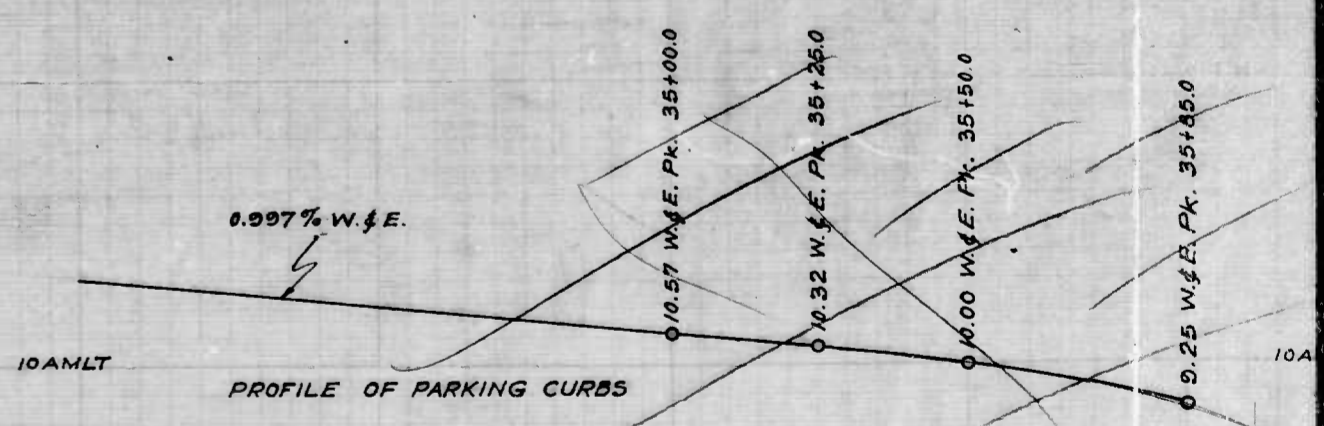
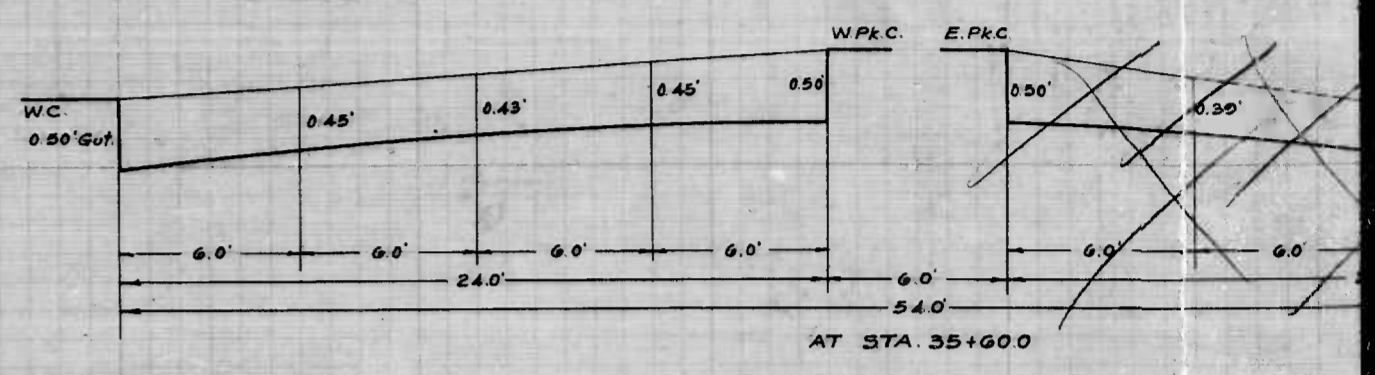
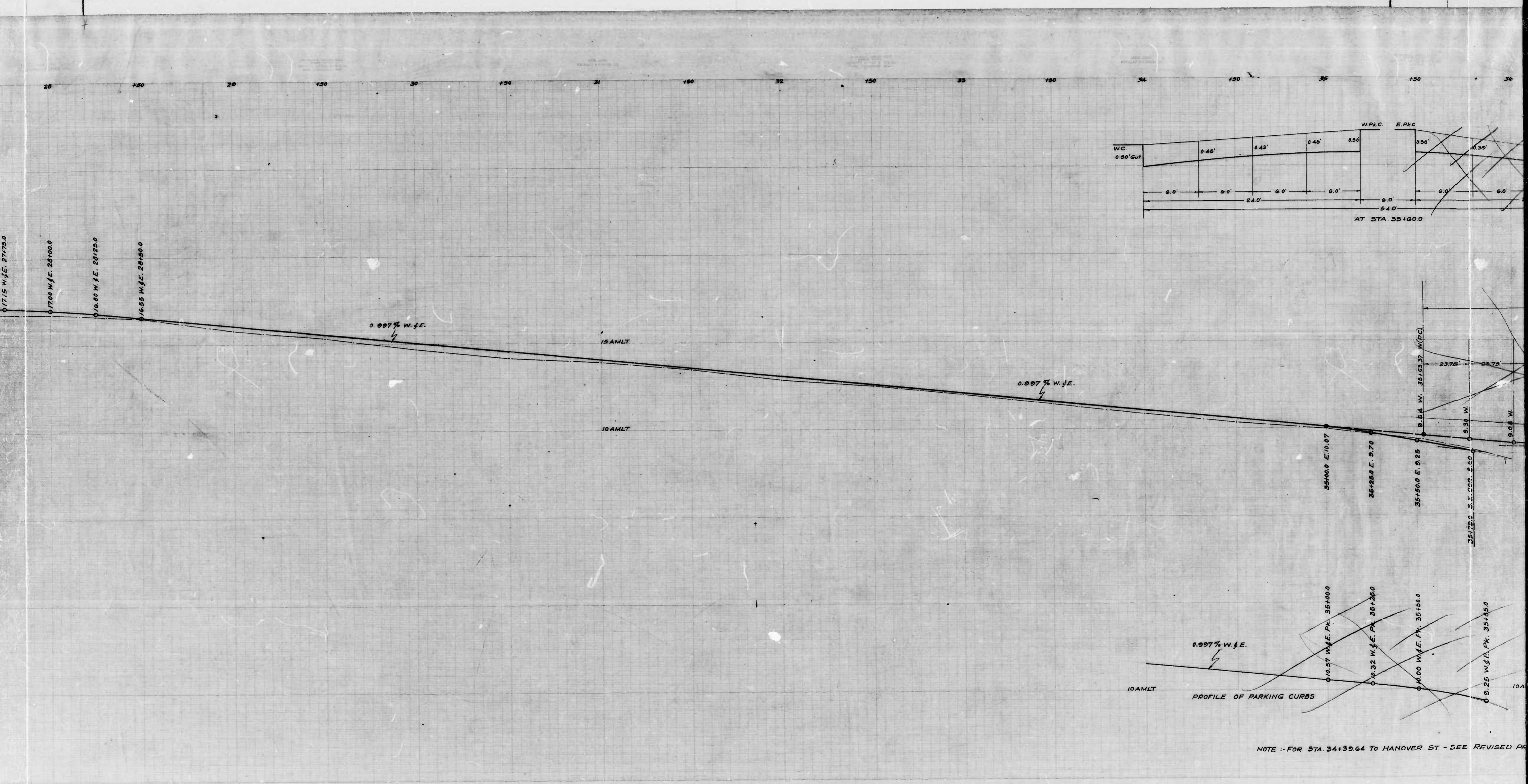

NOTE: FOR STA. 34+39.64 TO HANOVER ST. - SEE REVISED PLAN

(5)

796/797

RATIO - 24

1

W.C.L. DATA
 T = 178.0'
 R = 349.16' L = 328.82'
 Δ = 94° 25' 30" d = 4.96646 min per ft.

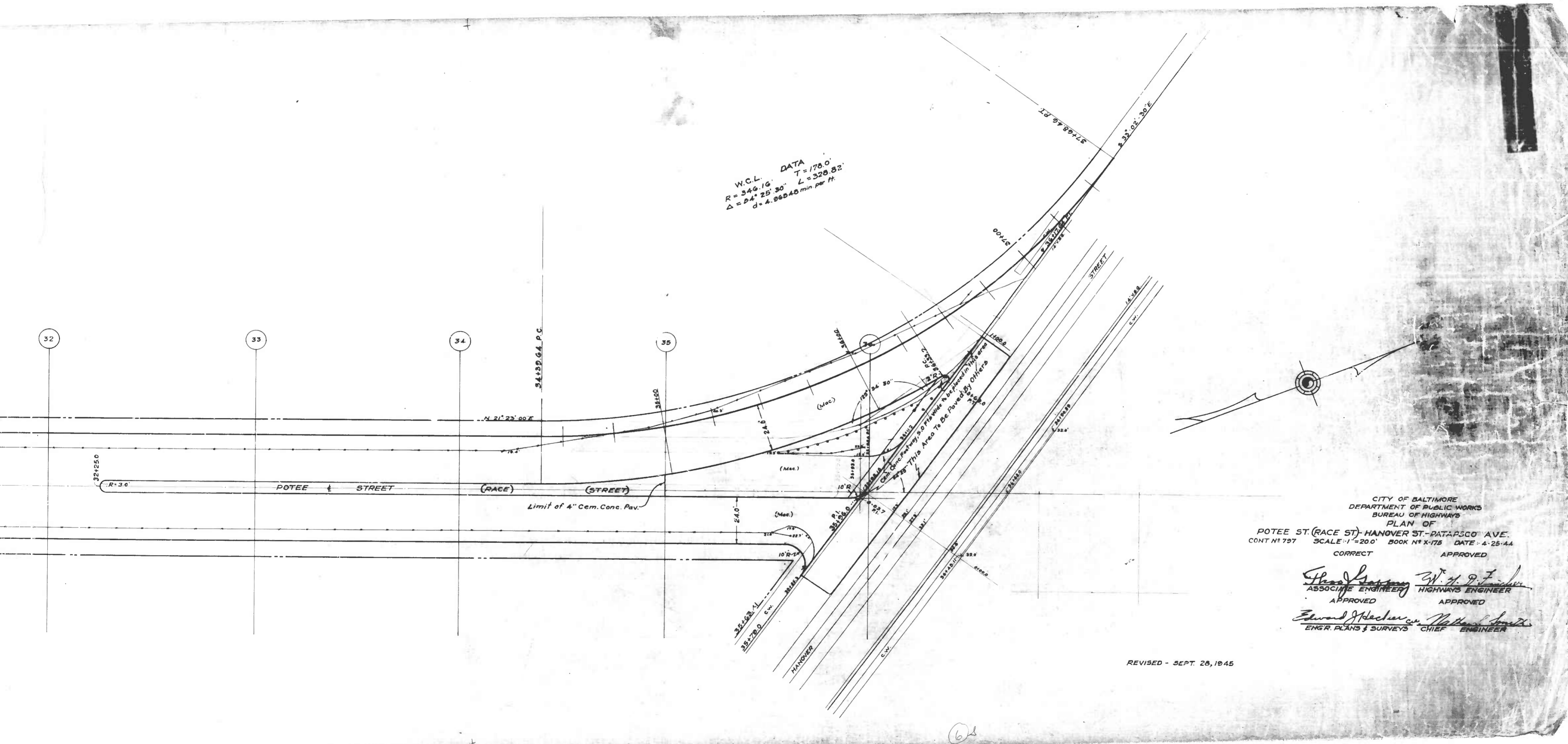

CITY OF BALTIMORE
 DEPARTMENT OF PUBLIC WORKS
 BUREAU OF HIGHWAYS
 PLAN OF
 POTEE ST. (RACE ST) - HANOVER ST. - PATAPSCO AVE.
 CONT. NO. 797 SCALE: 1" = 200' BOOK NO. X-175 DATE: 4-25-44

CORRECT APPROVED
Edward J. Hecker W. H. P. Fisher
 ASSOCIATE ENGINEER HIGHWAYS ENGINEER
 APPROVED APPROVED
Edward J. Hecker *William H. P. Fisher*
 ENGR. PLANS & SURVEYS CHIEF ENGINEER

REVISED - SEPT. 26, 1945

62

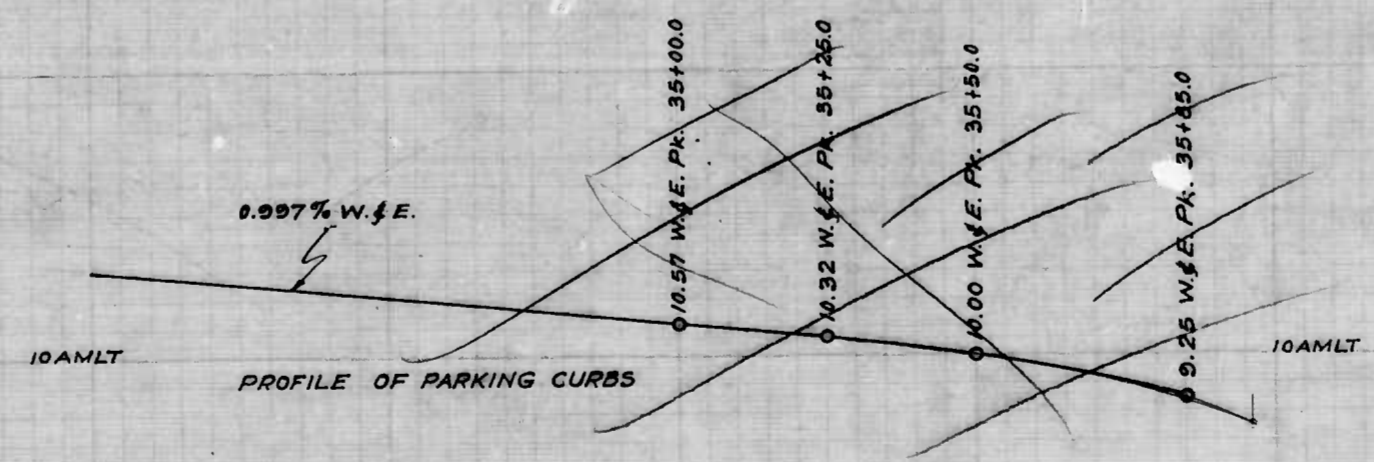
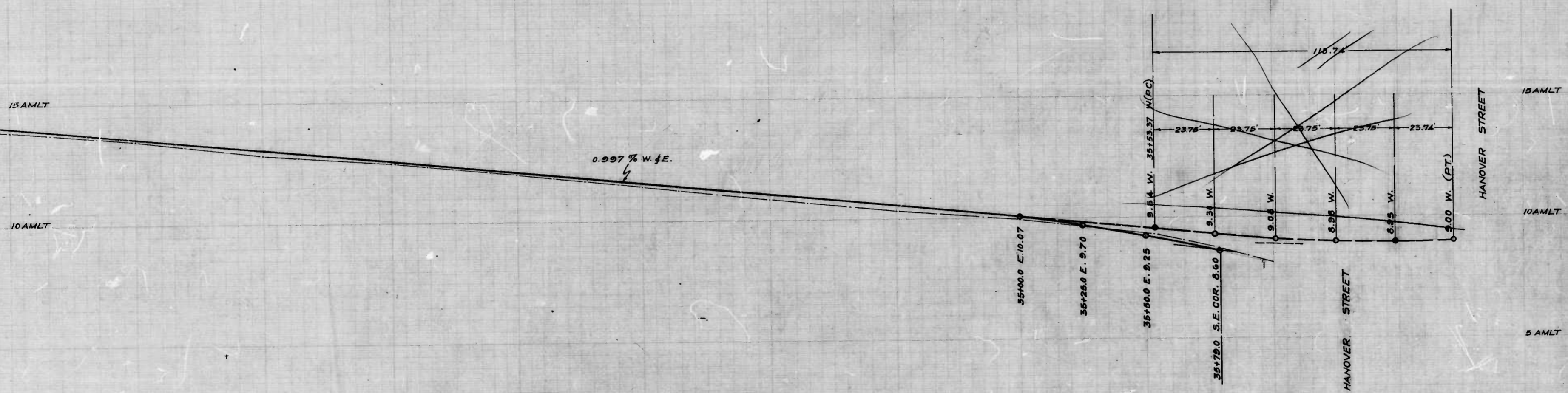
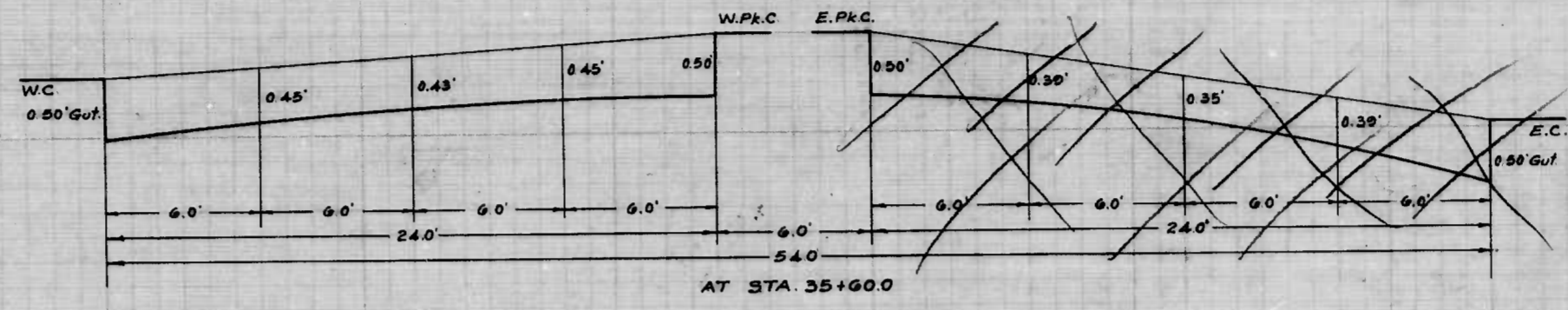

CITY OF BALTIMORE
 DEPARTMENT OF PUBLIC WORKS
 BUREAU OF HIGHWAYS
 PROFILE OF
 POTEE ST. (RACE ST.) - HANOVER ST. - PATAPSCO AVENUE
 SCALE: HOR: 1" = 20.0' VER: 1" = 2.0'
 BOOK N° X-175
 DATE: APR. 25, 1944
 CONT. N° 797

APPROVED
Edward Hedder
 ASSOCIATE ENGINEER

APPROVED
W. D. Fisher
 HIGHWAYS ENGINEER

APPROVED
Edward Hedder
 ENGR PLANS & SURVEYS

APPROVED
Walter B. Smith
 CHIEF ENGINEER

NOTE: FOR STA. 34+39.64 TO HANOVER ST. - SEE REVISED PROFILE - 9-28-45

(5)

(6)

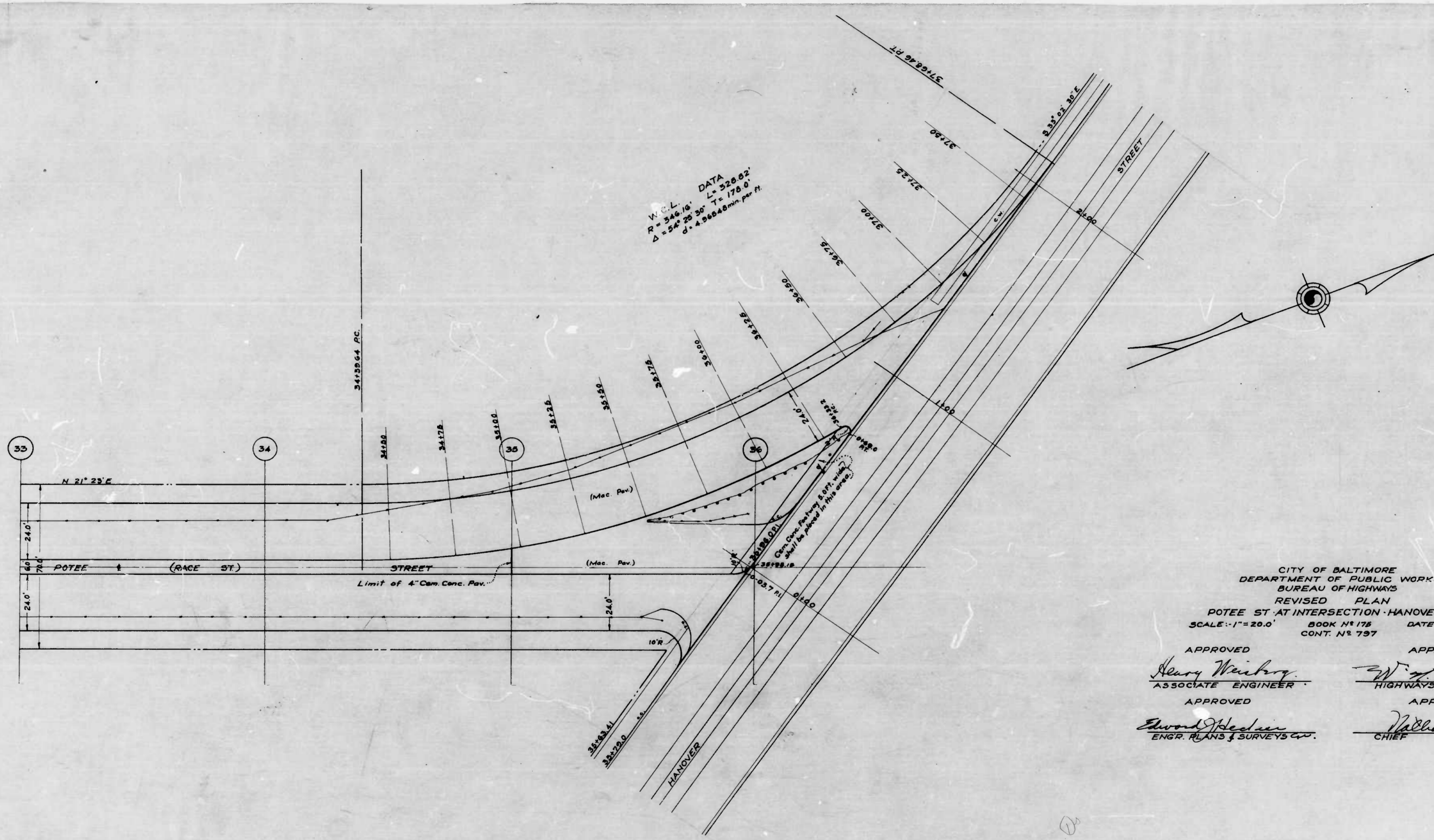

W.C.L. DATA
 R = 346.16' L = 328.82'
 Δ = 54° 28' 30" T = 178.0'
 d = 4.36648 min per ft.

CITY OF BALTIMORE
 DEPARTMENT OF PUBLIC WORKS
 BUREAU OF HIGHWAYS
 REVISED PLAN
 POTEE ST. AT INTERSECTION - HANOVER ST.
 SCALE: 1" = 20.0' BOOK N° 175 DATE: 9-28-45
 CONT. N° 797

APPROVED
Henry Weisberg
 ASSOCIATE ENGINEER

APPROVED
W. J. Fisher
 HIGHWAYS ENGINEER

APPROVED
Edward Hester
 ENGR. PLANS & SURVEYS CW.

APPROVED
Nathan Smith
 CHIEF ENGINEER

DESIGNED BY *Wm. H. Ewell*
 EXAMINED BY *E. J. Hester*

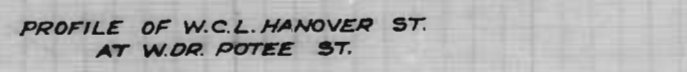
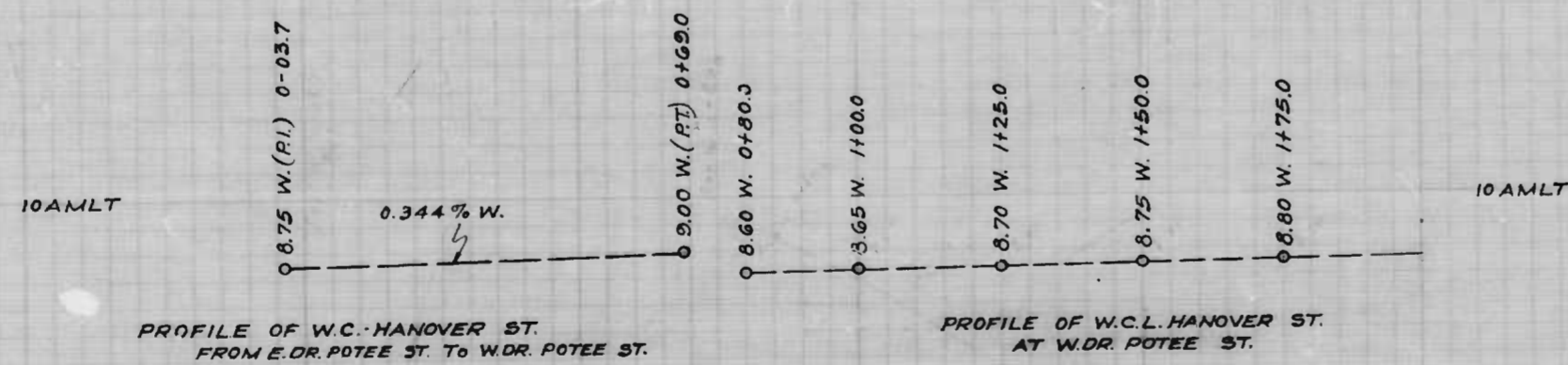
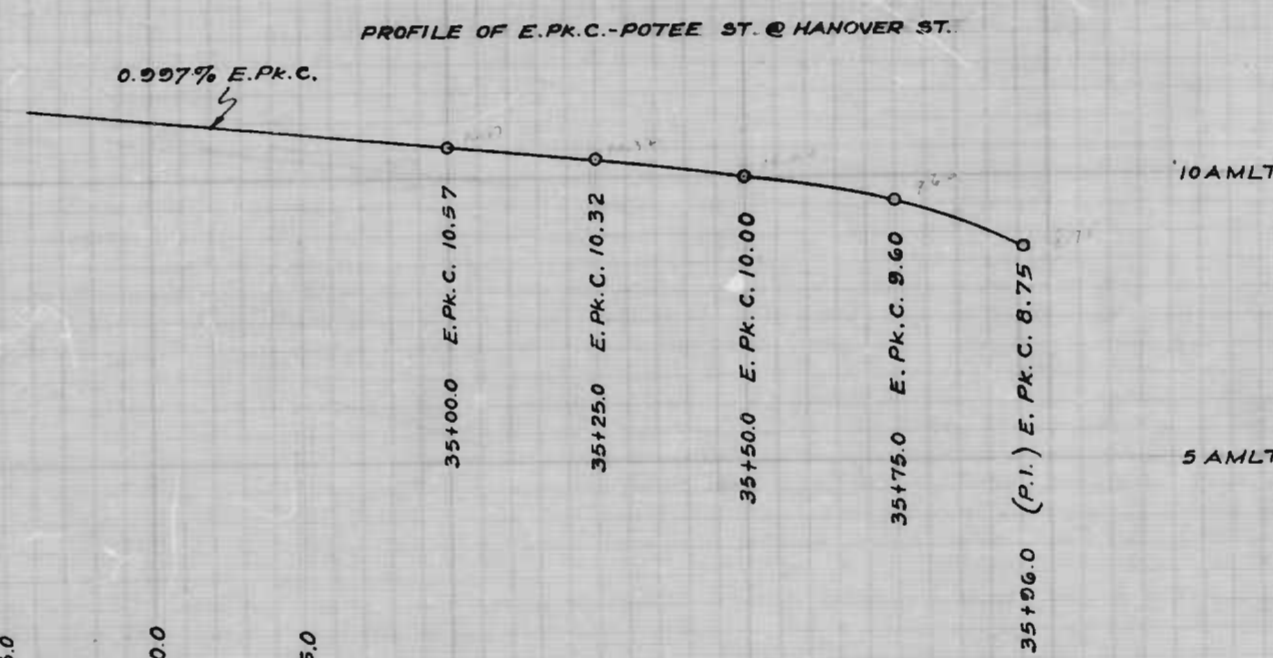
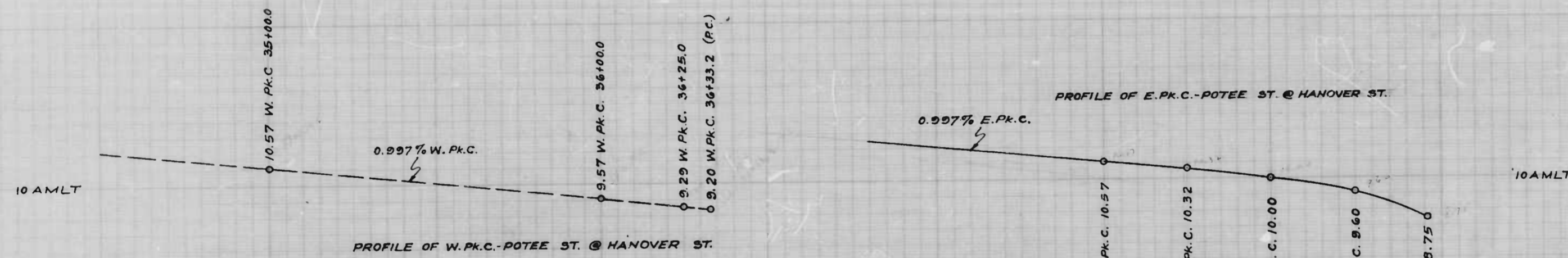
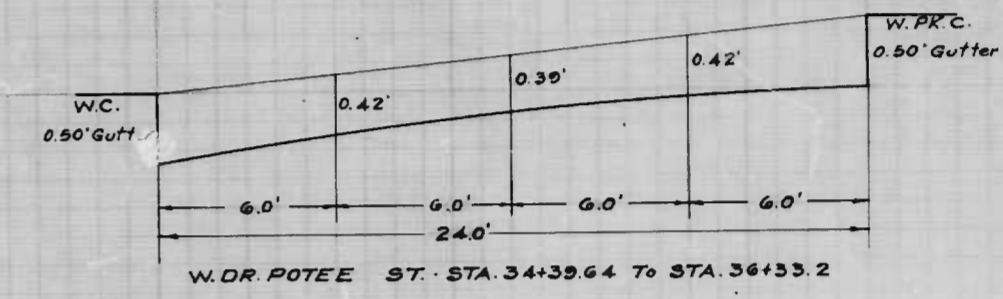
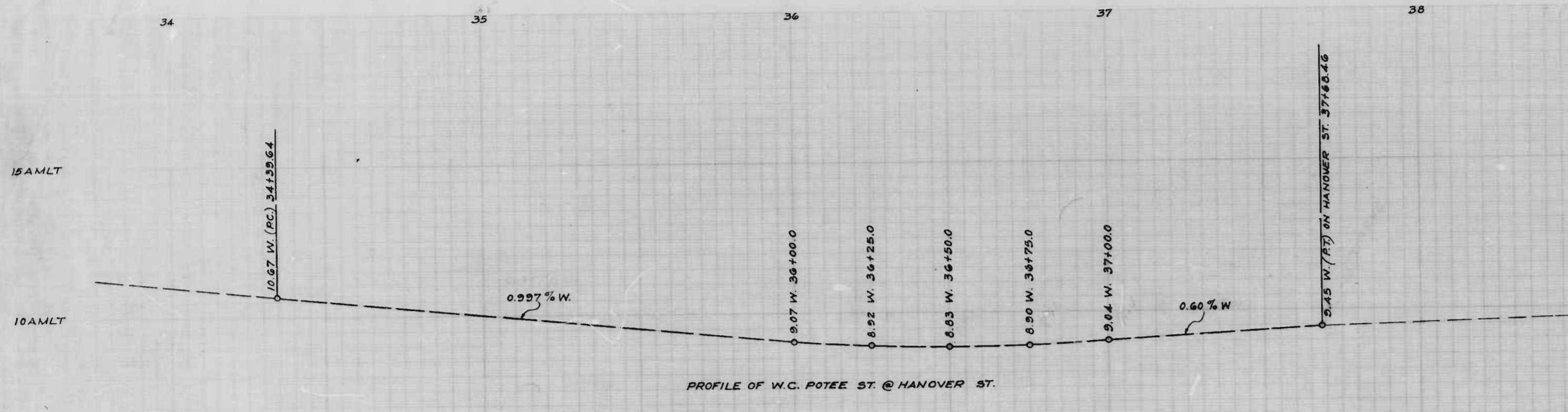

CITY OF BALTIMORE
DEPARTMENT OF PUBLIC WORKS
BUREAU OF HIGHWAYS
REVISED PROFILE
POTTEE ST. AT INTERSECTION HANOVER ST.
SCALE: HOR. 1" = 20.0' 800K N9X-175
VER. 1" = 2.0' DATE: SEPT. 28, 1945
CONT. N° 797

APPROVED APPROVED
Henry W. Wadsworth *W. D. Fisher*
ASSOCIATE ENGINEER HIGHWAYS ENGINEER

APPROVED APPROVED
Edward J. Hester *W. D. Fisher*
ENGR. PLANS & SURVEYS CHIEF ENGINEER

DESIGNED BY *Wm. H. Powell*
CHECKED BY *W. D. Fisher*

34

35

36

37

1067 W 34+89.64 (PC)

0.98% WZ

910 W 36+00

879 W 36+15

883 W 36+30

850 W 36+45

904 W 36+60

0.60% WZ

915 W 37+61.46

1067 WPC 36+00

0.997% WPCZ

972 WPC 36+15

977 WPC 36+30

970 WPC 36+45

Station - Hanover St
W. Side

893 WPC
0.0

890 WPC
0.0

904 WPC
0.0

914 WPC
0.0

934 WPC
0.0

894

897

900

913

924

894

897

900

913

924

894

897

900

913

924

1+00

1+18.7

1+43

1+67.5

1+92.6

Enter St @ Hanover St.

Free St

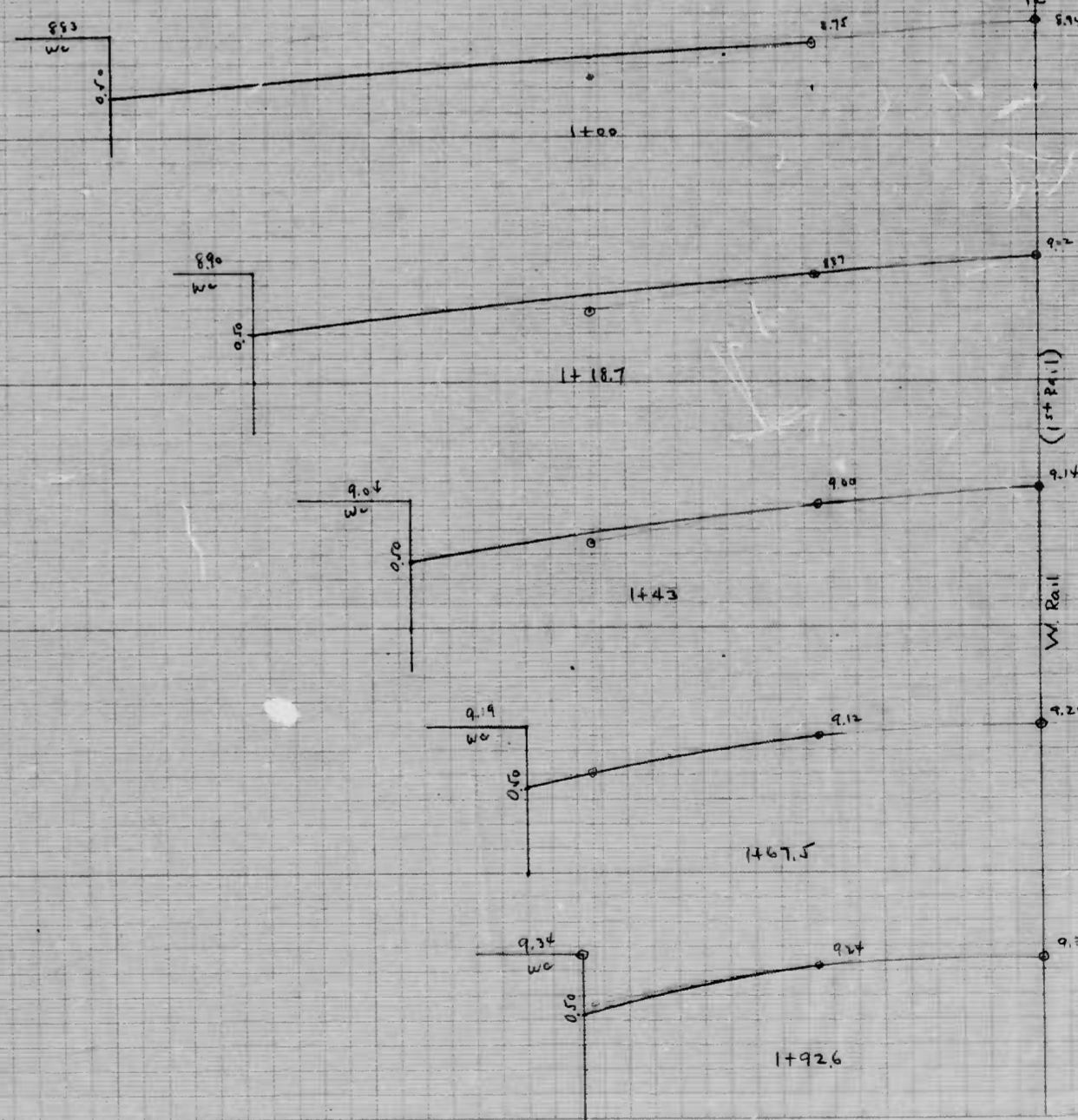
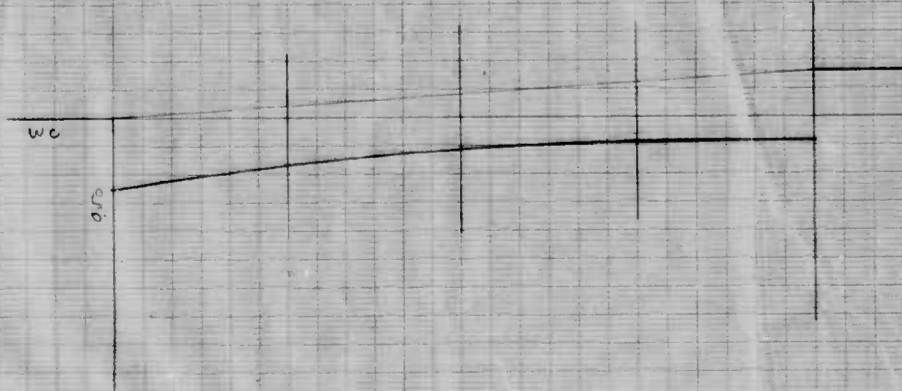

796/797

RATIO - 24

9

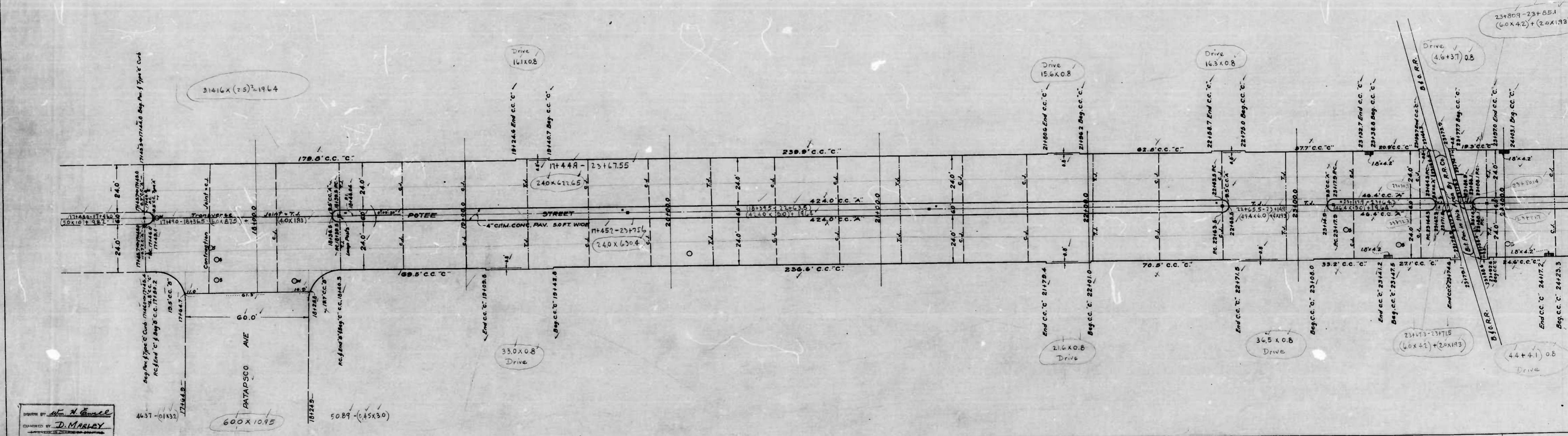

DESIGNED BY *H. N. GIBSON*
 ENGINEERED BY *D. MARLEY*

796/797

RATIO - 24

9

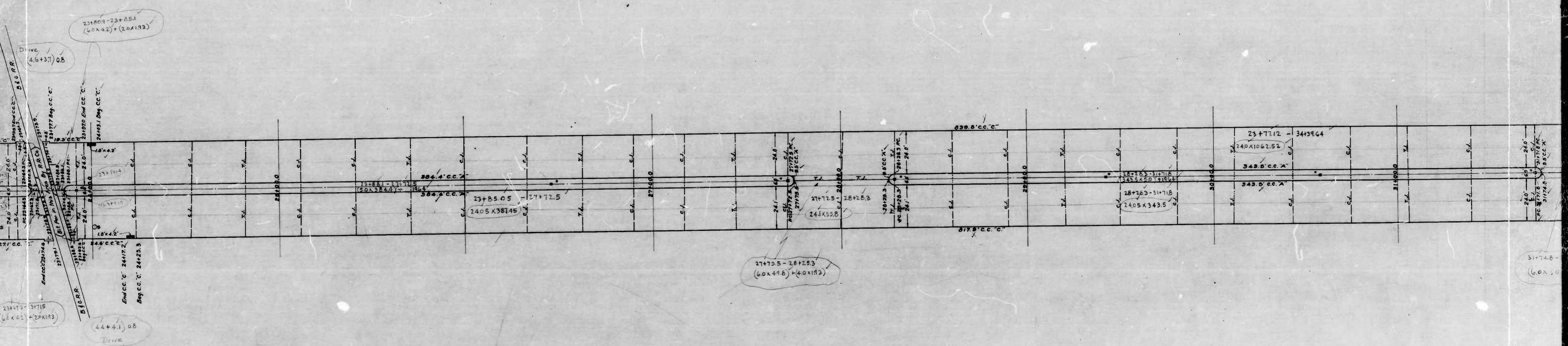

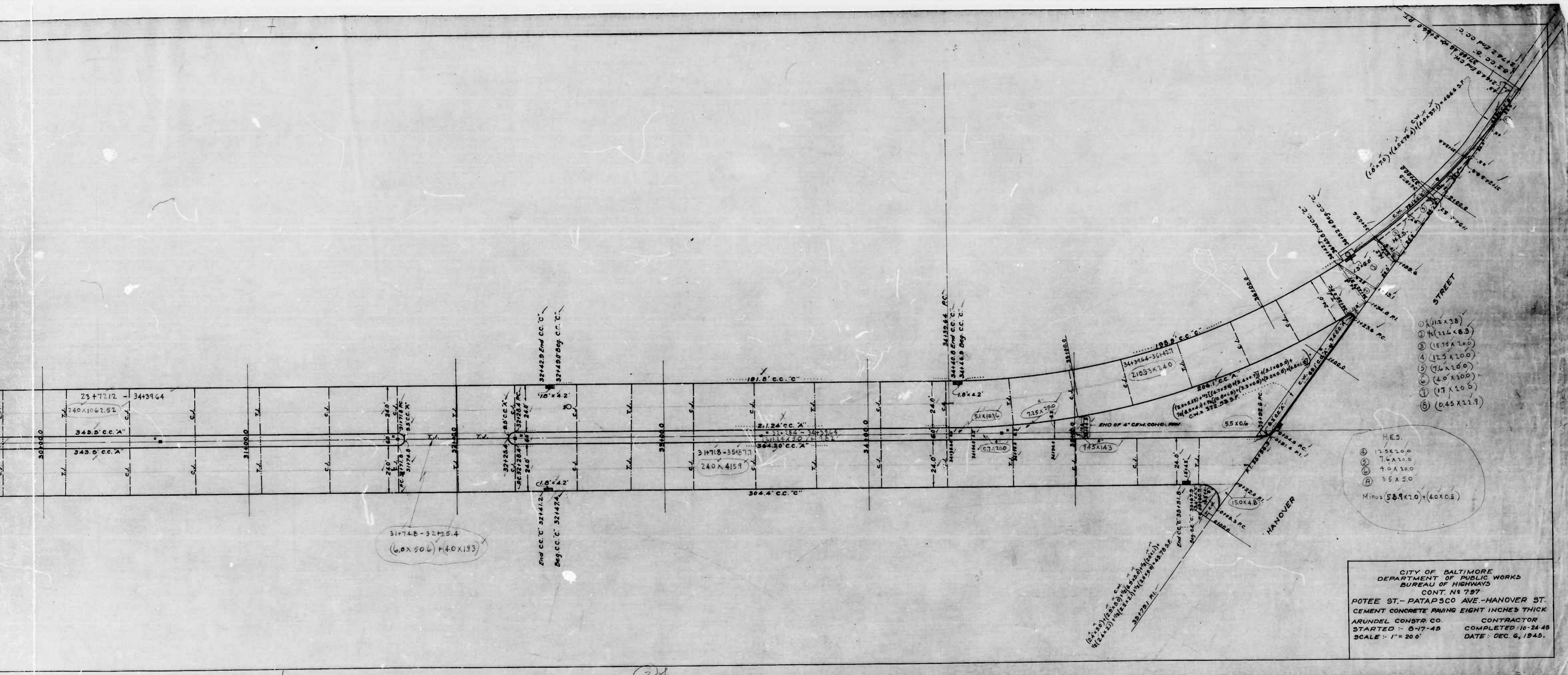

796/797

RATIO - 24

3

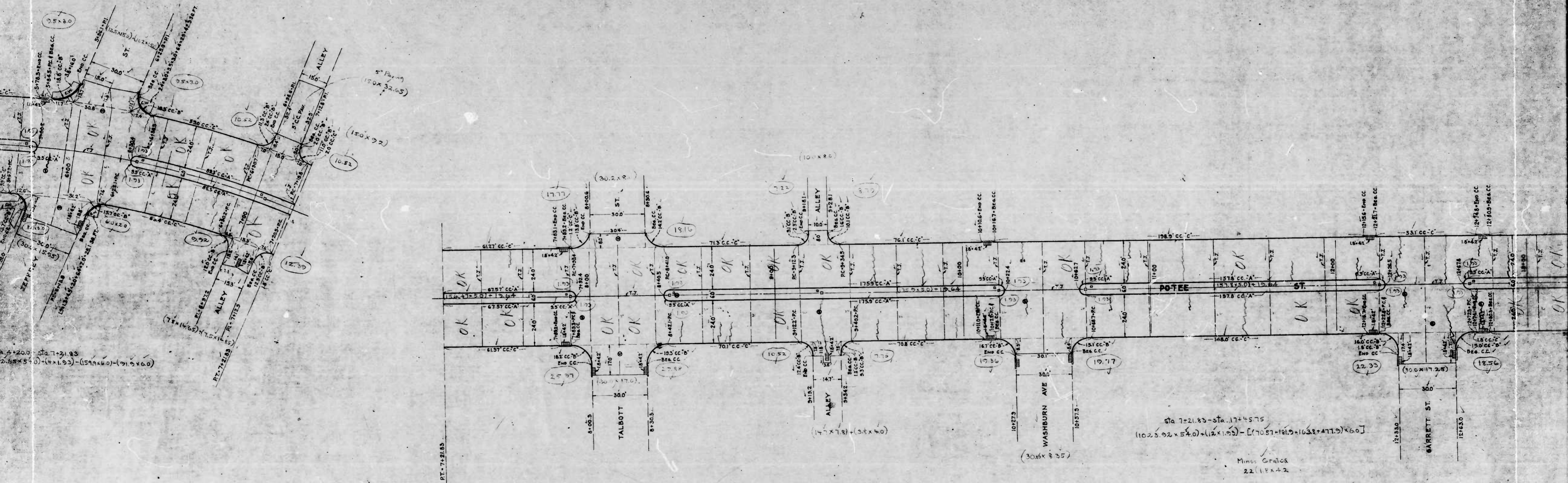

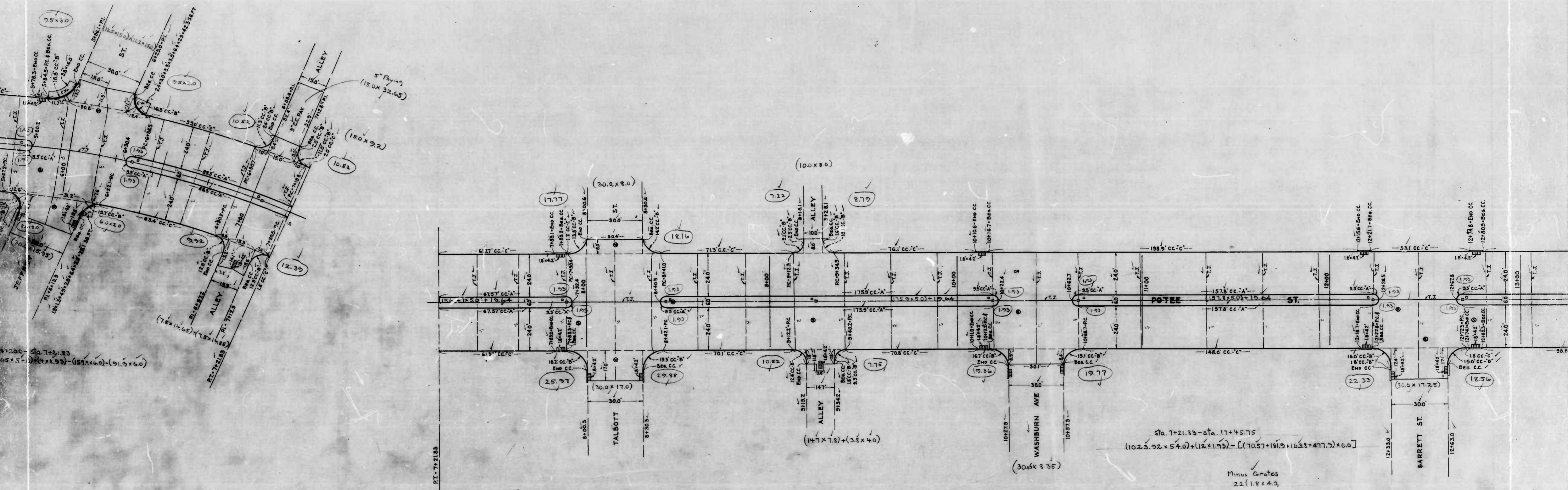

796/797

RATIO - 24

3

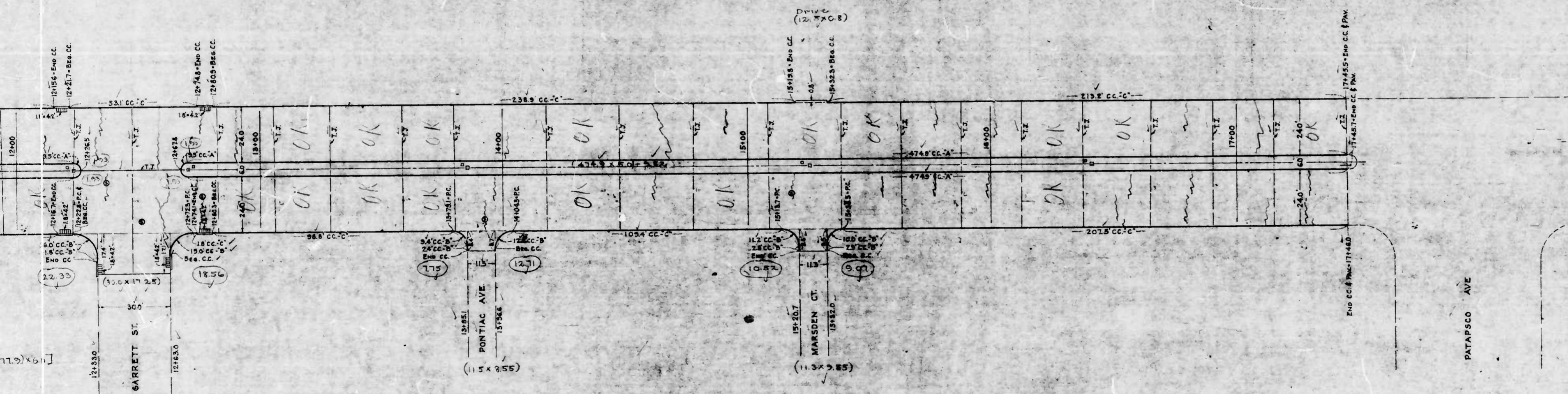

CITY OF BALTIMORE
 DEPARTMENT OF PUBLIC WORKS
 BUREAU OF HIGHWAYS
 CONT. No. 796
POTEE 57.
BELLE GROVE RD - PATAPSCO AVE
 CEMENT CONCRETE PAVING EIGHT INCHES THICK
 ARUNDEL CONSTRUCTION CO CONTRACTOR
 STARTED - 7-20-45 COMPLETED - 9-21-45
 SCALE - 1"=20' DATE - DEC 15, 1945

796/797

RATIO - 24

2

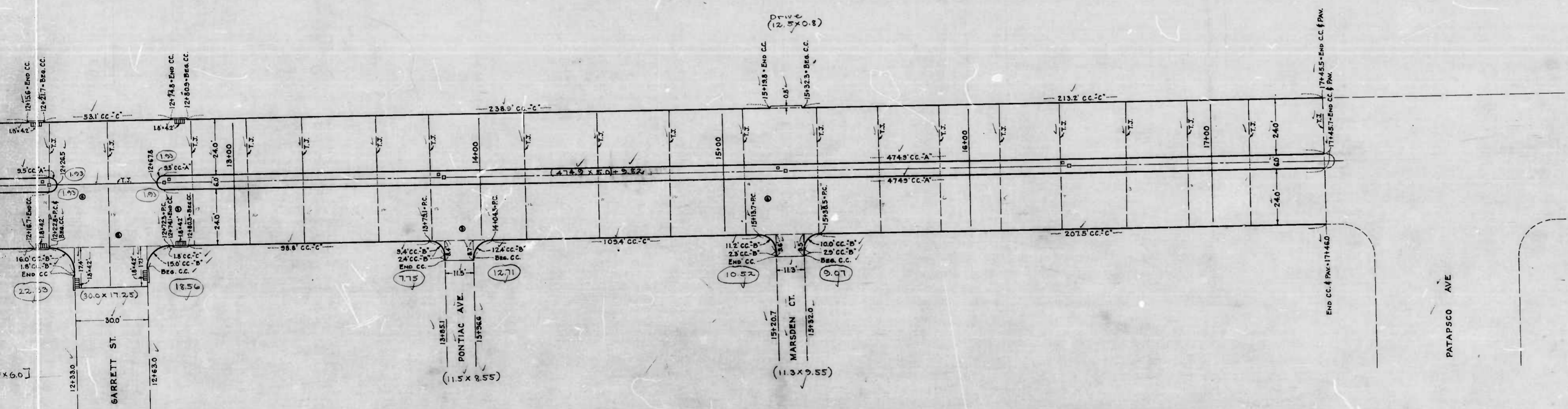

CITY OF BALTIMORE
 DEPARTMENT OF PUBLIC WORKS
 BUREAU OF HIGHWAYS
 CONT. No. 756
POTTEE ST.
BELLE GROVE RD - PATAPSCO AVE
 CEMENT CONCRETE PAVING EIGHT INCHES THICK
 ARUNDEL CONSTRUCTION CO. CONTRACTOR
 STARTED:- 7-20-45 COMPLETED:- 9-21-45
 SCALE:- 1"=20' DATE:- DEC 13, 1945

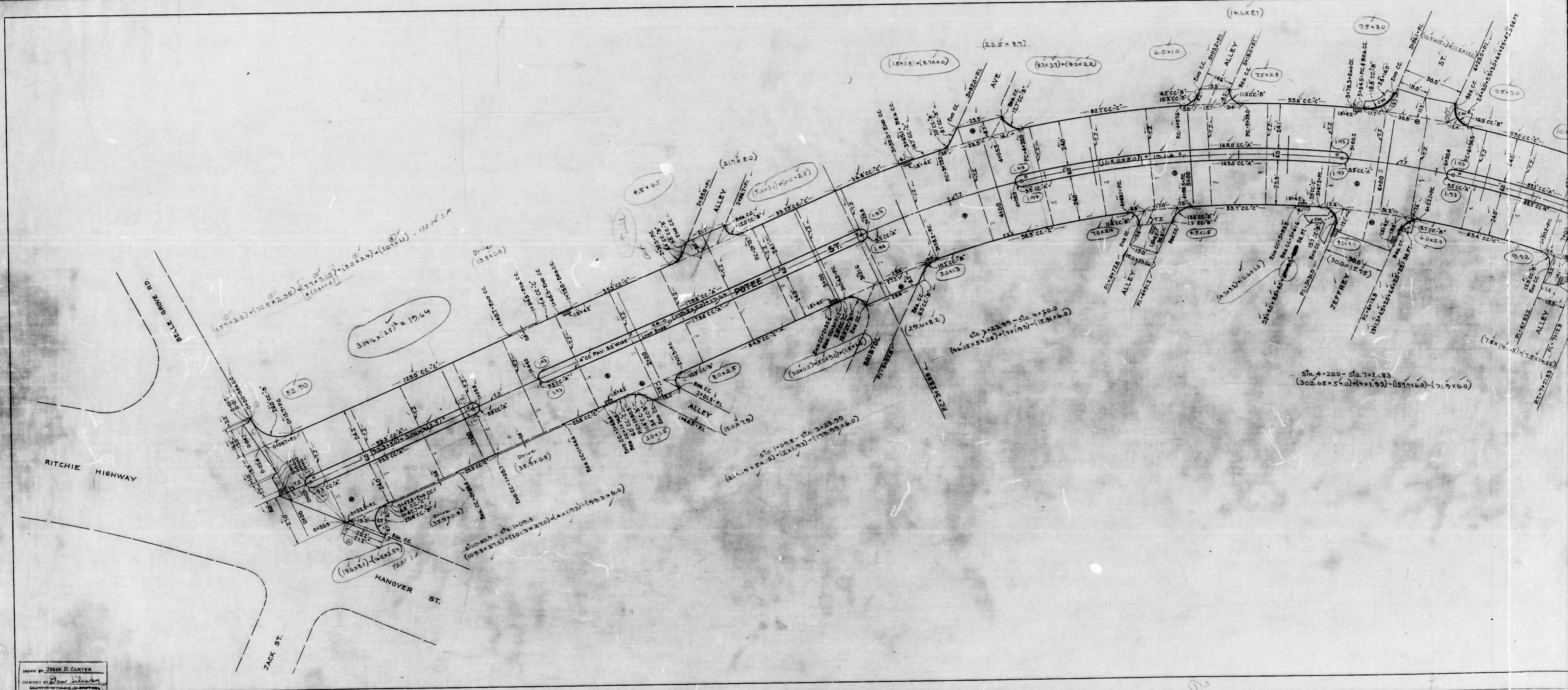

DRAWN BY JESSE D. CARTER
CHECKED BY Don Williams
ENGINEER IN CHARGE OF SURVEYING

796/797

RATIO - 24

12

ROUTE 21 - PATAPSCO AVE - HAYWARD ST COMD No 101X

79
65
12'40

W. H. Emell
L. Manley

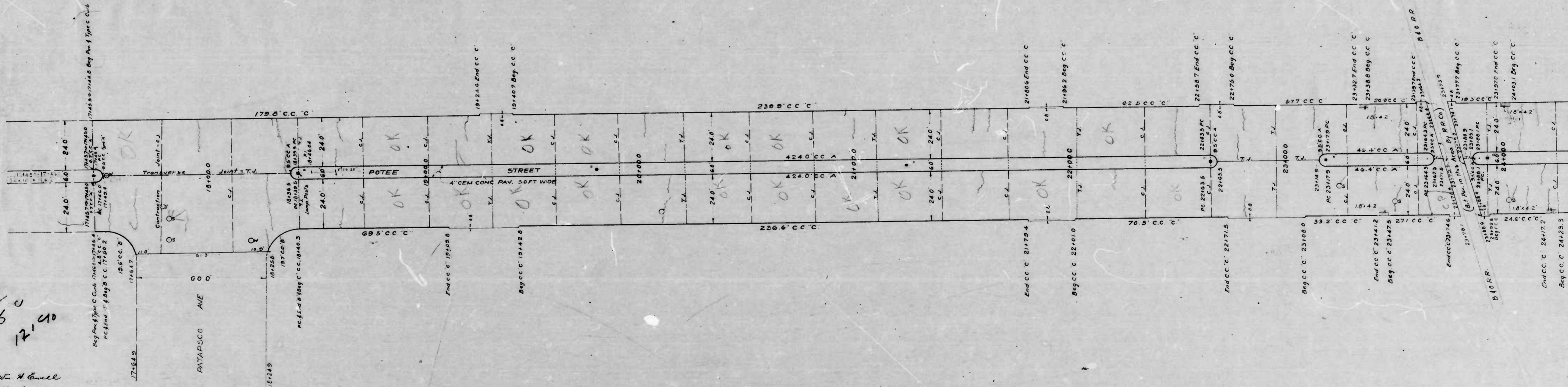

①

796/797

RATIO - 24

12

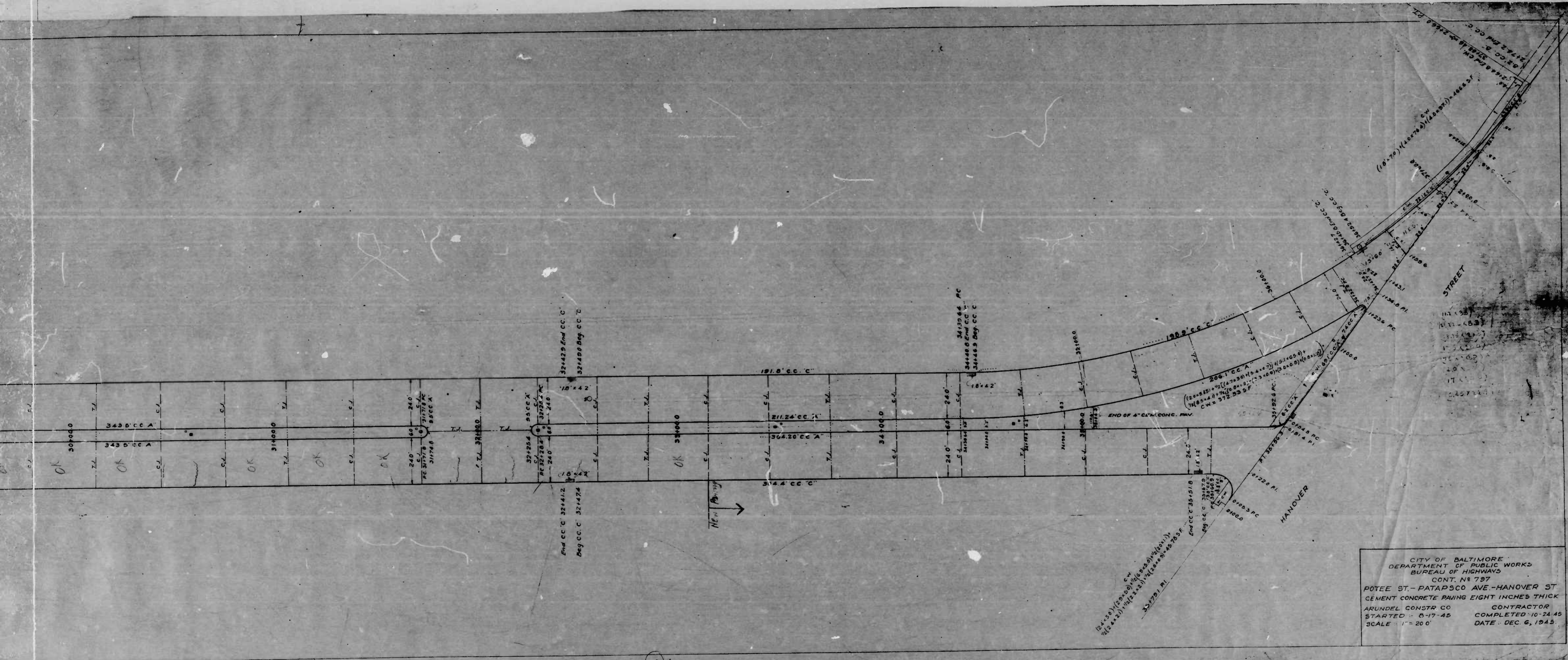

CITY OF BALTIMORE
 DEPARTMENT OF PUBLIC WORKS
 BUREAU OF HIGHWAYS
 CONT. NO. 797
 POTEY ST. - PATAPSCO AVE - HANOVER ST.
 CEMENT CONCRETE PAVING EIGHT INCHES THICK
 ARUNDEL CONSTR. CO. CONTRACTOR
 STARTED - 6-17-45 COMPLETED - 10-24-45
 SCALE - 1" = 20' DATE - DEC. 6, 1945

POTEY ST. - PATAPSCO AVE - HANOVER ST. CONT. NO. 797