

DESIGNED BY J. J. HAYDEN
DRAWN BY H. W. HAYDEN
ENGINEER IN CHARGE OF THE DISTRICT

10

ГОРЬБОВАЯ ЧАСТЬ ПЛАНА ОТ ВЕРХНЕГО КРАЯ

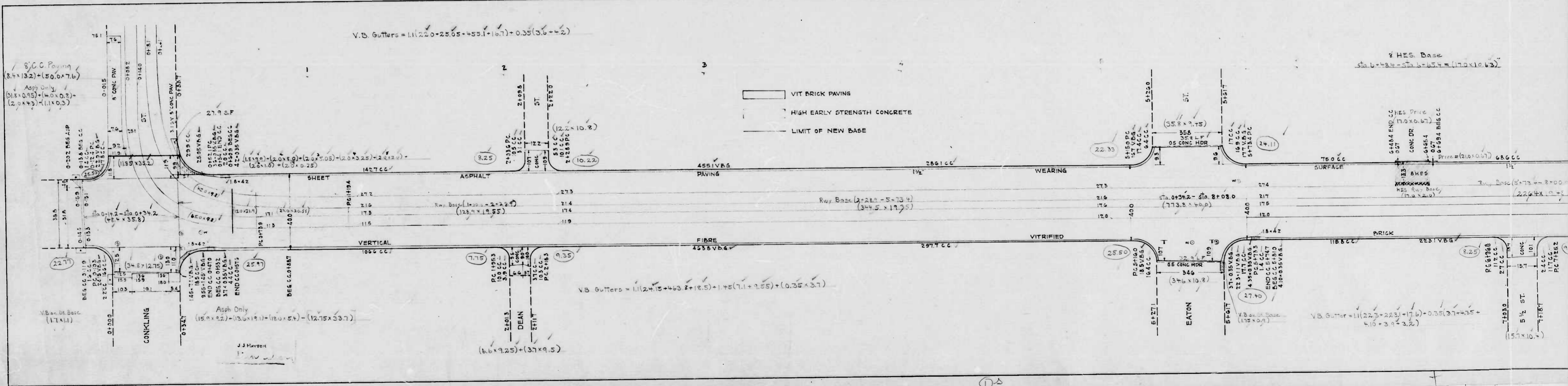

J.J. HAVERT

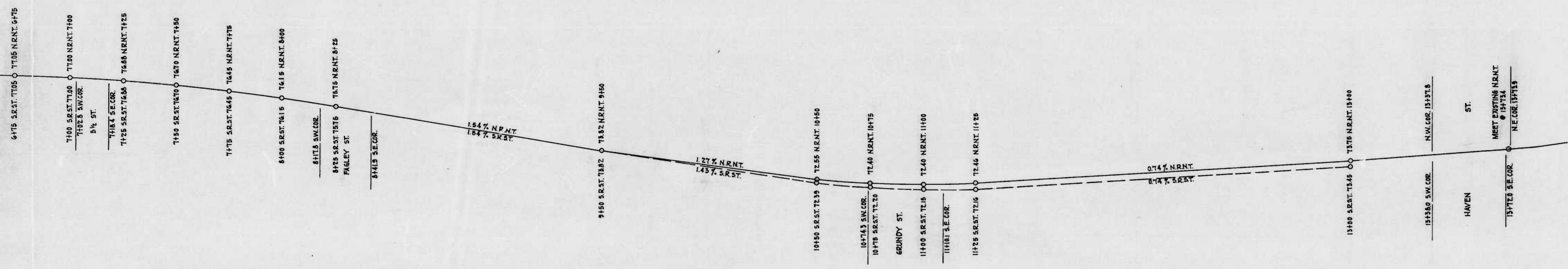

CITY OF BALTIMORE
 DEPARTMENT OF PUBLIC WORKS
 BUREAU OF HIGHWAYS
 PROFILE OF RAILWAY TRACKS
 LOMBARD ST. - CONKLING ST. TO HAVEN ST.
 CONT. NO. 734
 SCALES: HOR. - 1"=200' 5000' NO. X-94
 VER. - 1"=20' FEB. 28, 1944
 APPROVED: *Dr. J. J. [Signature]* APPROVED: *[Signature]*
 ASSOCIATE ENGINEER HIGHWAYS ENGINEER

BENCH MARKS
INTERSECTION STEP ENTR. TO DRUG STORE NW COR. CONKLINE ST. & LOMBARD ST. - ELEV. 73.65
N.W. COR. 6R. STEP SIDE ENTR. TO STORE ON N.E. COR. LOMBARD ST. & HAVEN ST. - ELEV. 76.44

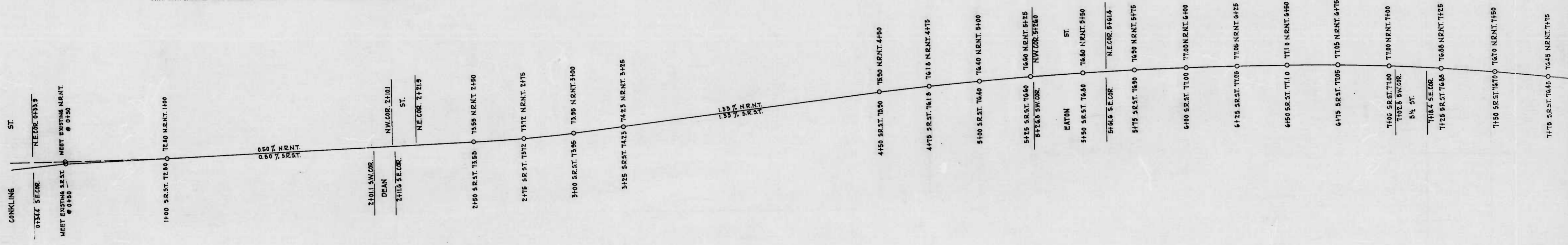

DRAWN BY J.J. HAYDEN
CHECKED BY H. W. HAYDEN
ENGINEER IN CHARGE OF DISTRICT

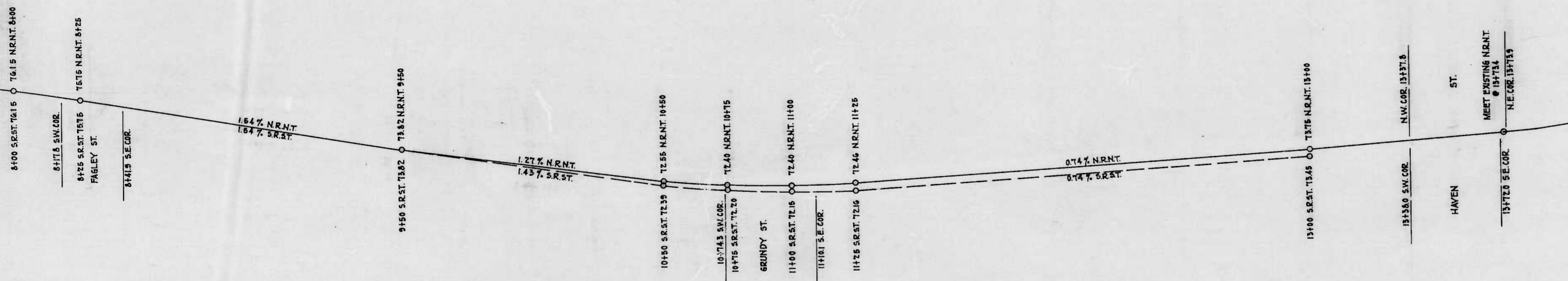

CITY OF BALTIMORE
 DEPARTMENT OF PUBLIC WORKS
 BUREAU OF HIGHWAYS
 PROFILE OF RAILWAY TRACKS
 LOMBARD ST. - CONKLING ST. TO HAVEN ST.
 CONT. NO. 784
 HOS. - 1"=20'
 VER. - 1"=2.0'
 BOOK NO. X-24
 FEB. 26, 1944

APPROVED: *W. G. Fisher*
 HIGHWAYS ENGINEER

APPROVED: *W. G. Fisher*
 ASSOCIATE ENGINEER

3

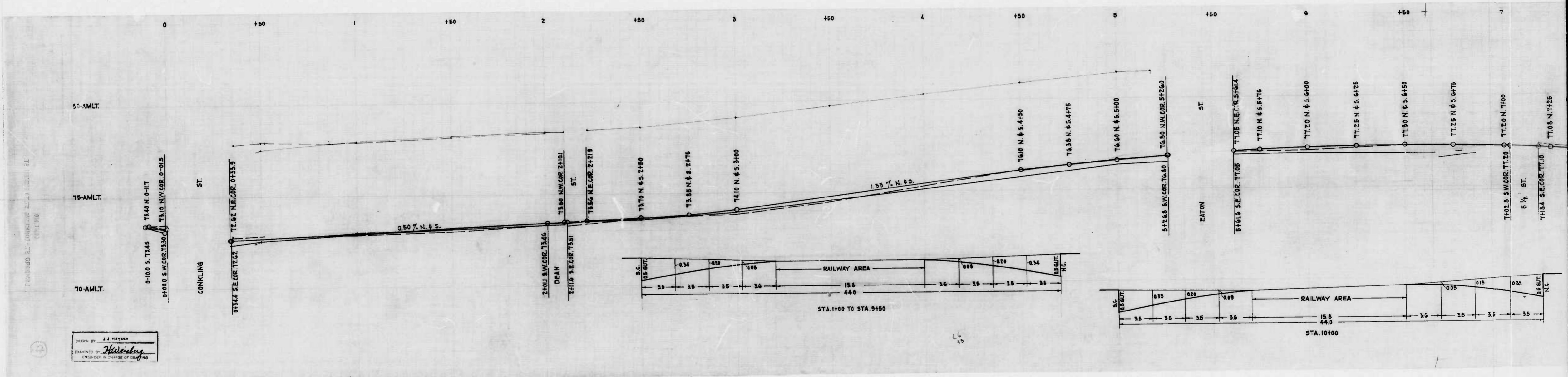

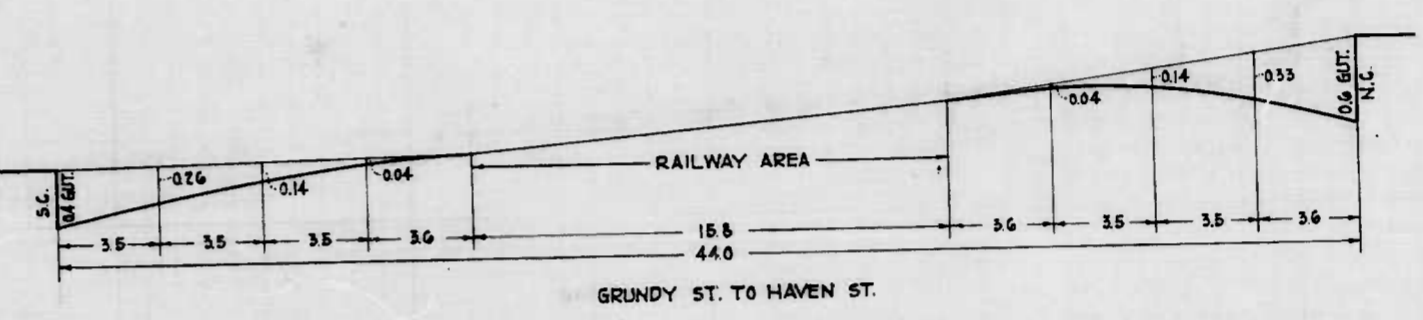
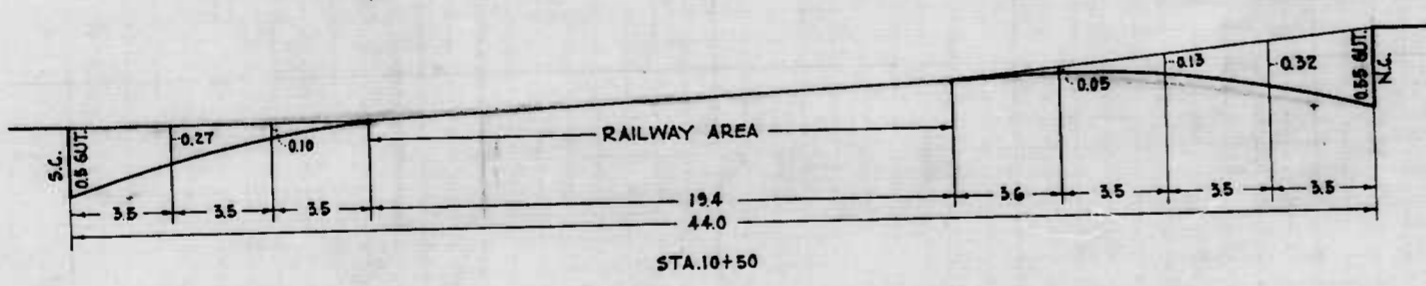
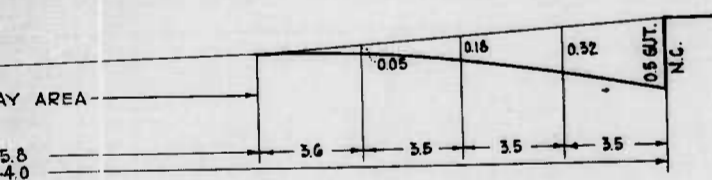
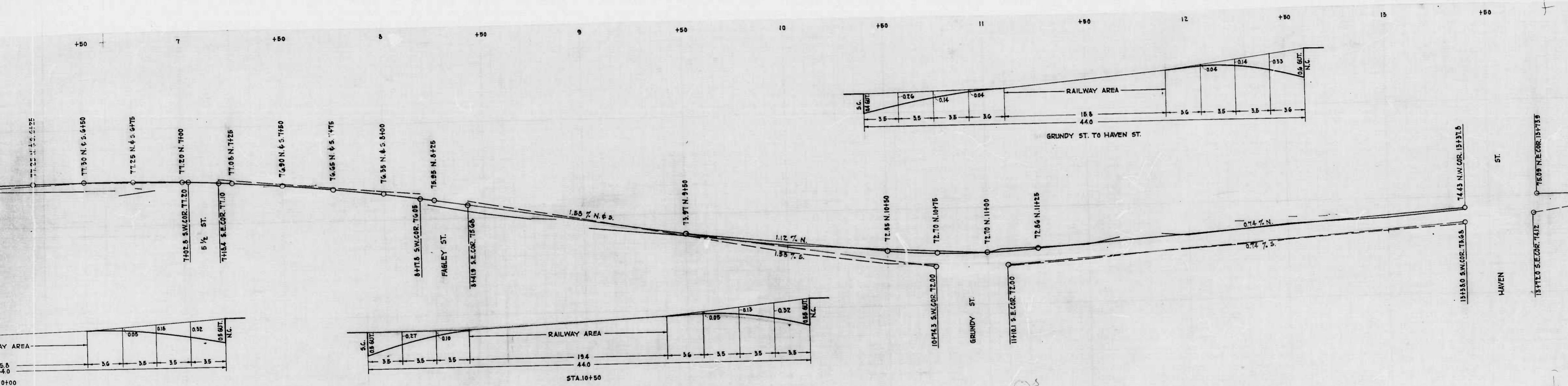

CITY OF PA
DEPARTMENT OF
BUREAU OF
ESTABLISHED
LOMEARD ST. - CONKLIN
APPROVED -
ASSOCIATE ENGINEER
APPROVED -
HIGHWAY ENGINEER

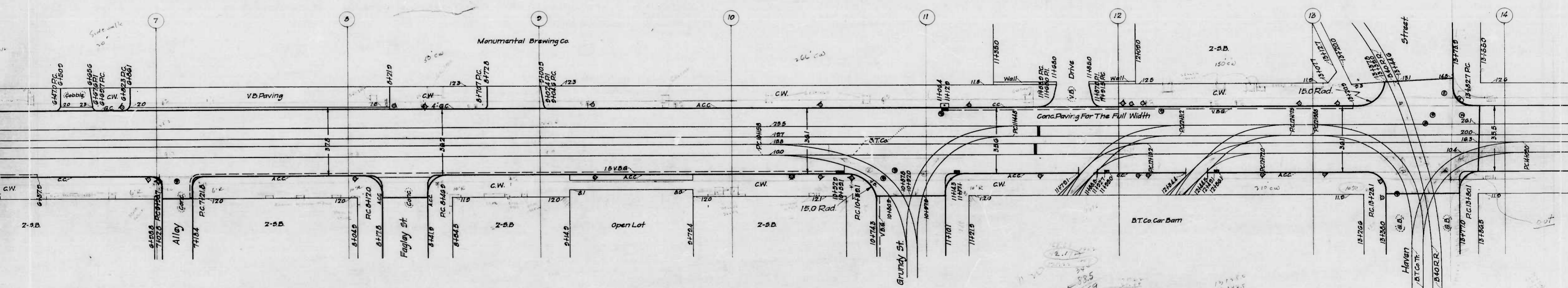

$13 \times 27.5 = 357.5$
 $357.5 \div 36.3 = 9.85$

$10 \times 27.5 = 275$
 $275 \div 236 = 1.165$

$10 \times 27.5 = 275$
 $275 \div 274 = 1.004$

$10 \times 27.5 = 275$
 $275 \div 272 = 1.011$

$13 \times 27.5 = 357.5$
 $357.5 \div 312 = 1.146$

$13 \times 27.5 = 357.5$
 $357.5 \div 312 = 1.146$

Appro
 Chief E

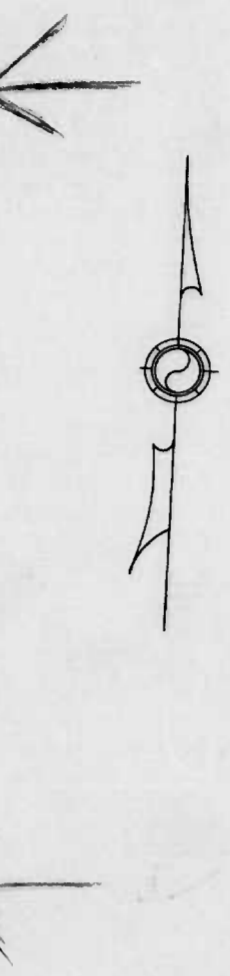
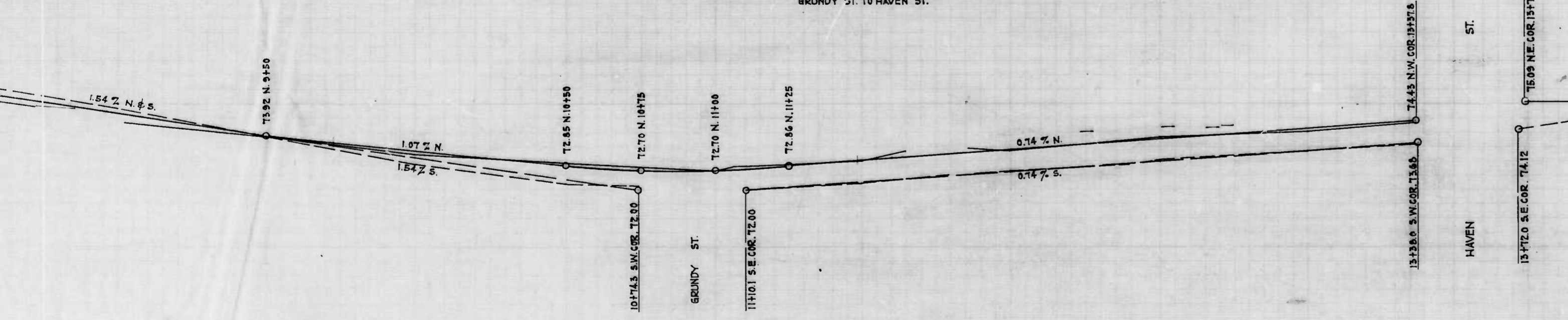
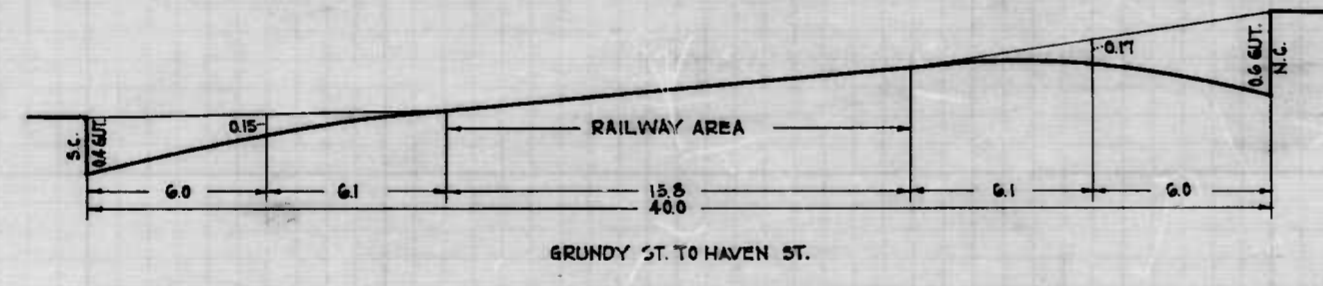
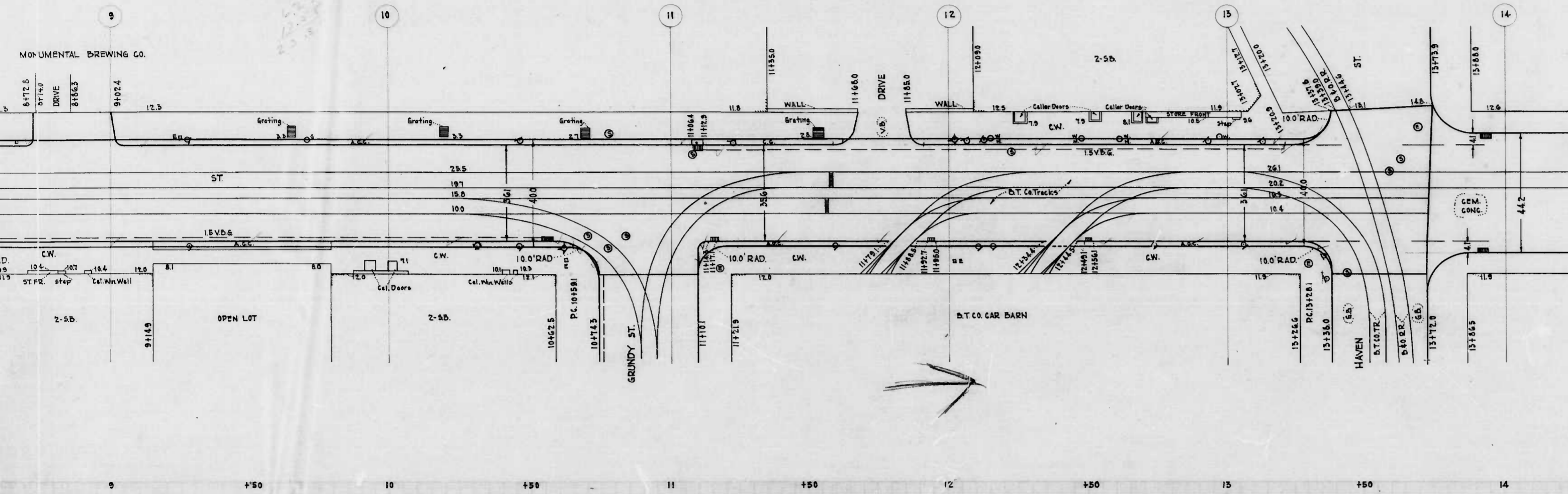

38

CITY OF BALTIMORE
 DEPARTMENT OF PUBLIC WORKS
 BUREAU OF HIGHWAYS
 PLAN & PROFILE
 LOMBARD ST. - CONKING ST. TO HAVEN ST.
 PLAN - 1"=200'
 SCALAS PROFILE - 1"=200'
 APRIL 30, 1944

APPROVED: *Philip H. ...*
 ASSOCIATE ENGINEER

APPROVED: *W. J. ...*
 HIGHWAYS ENGINEER

APPROVED: *...*
 ENGR. - PLANS & SURVEYS

APPROVED: *...*
 CHIEF ENGINEER

