

DRAWN BY: J. H. Hayden  
 EXAMINED BY: [Signature]  
 ENGINEER IN CHARGE OF DRAFTING

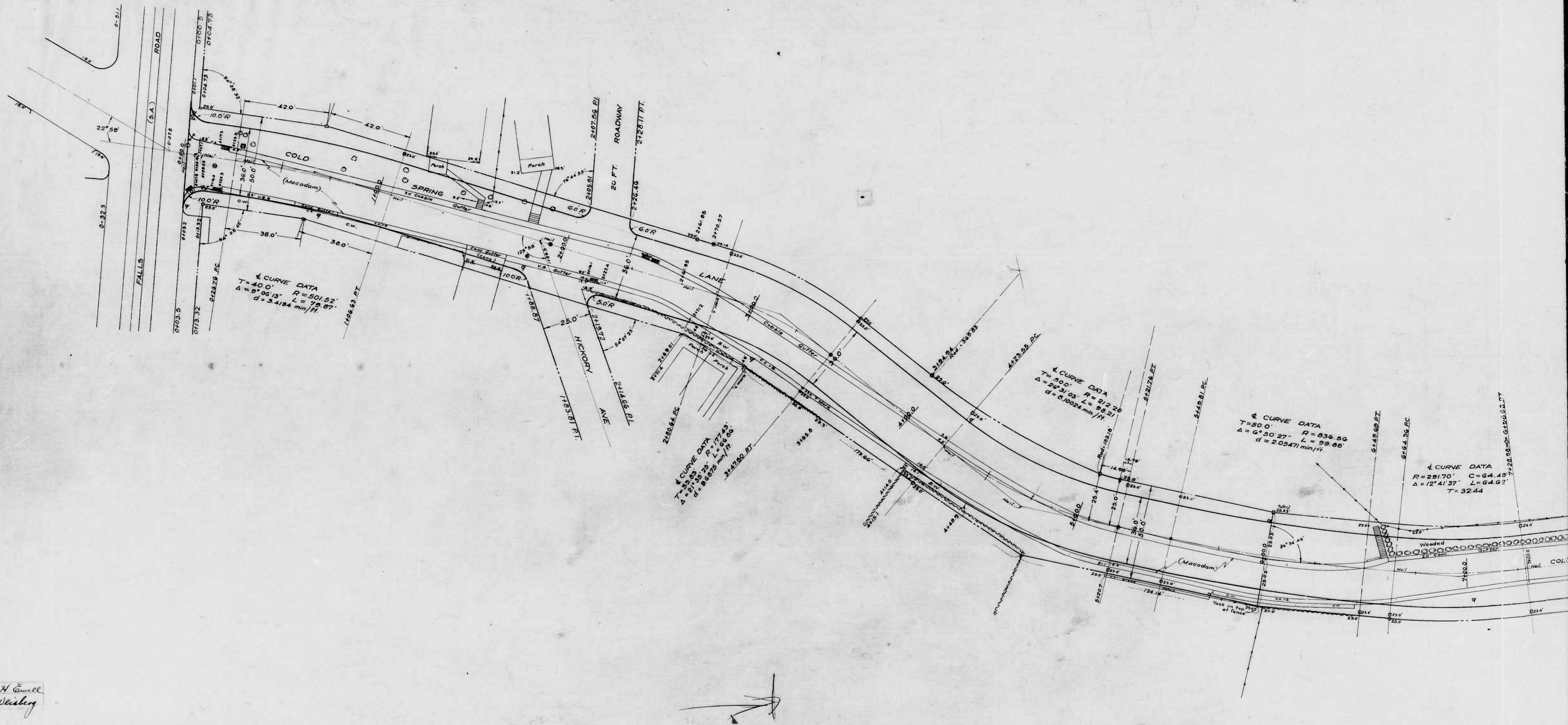

Wm. H. Conwell  
 H. Weisberg

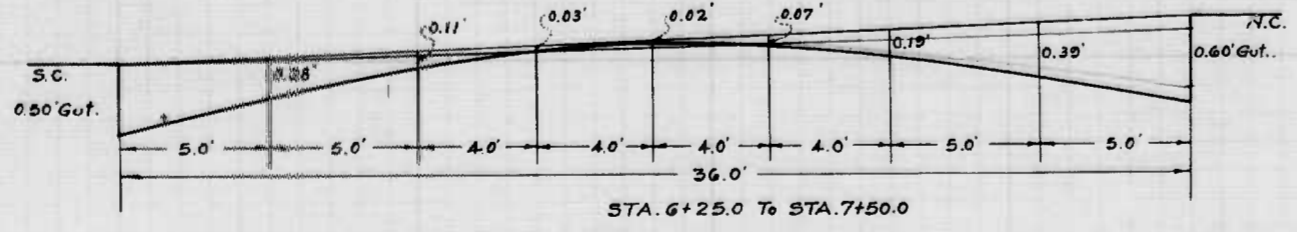
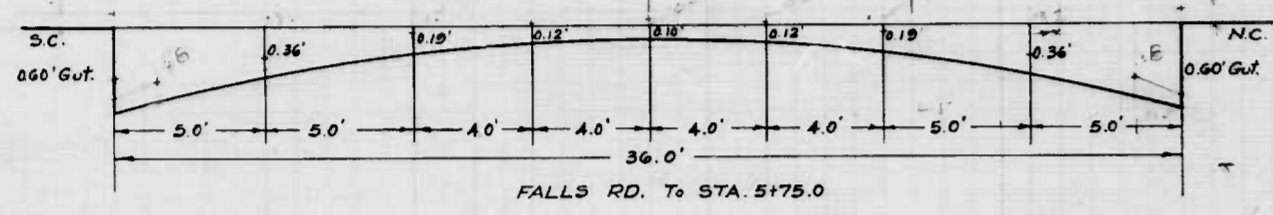
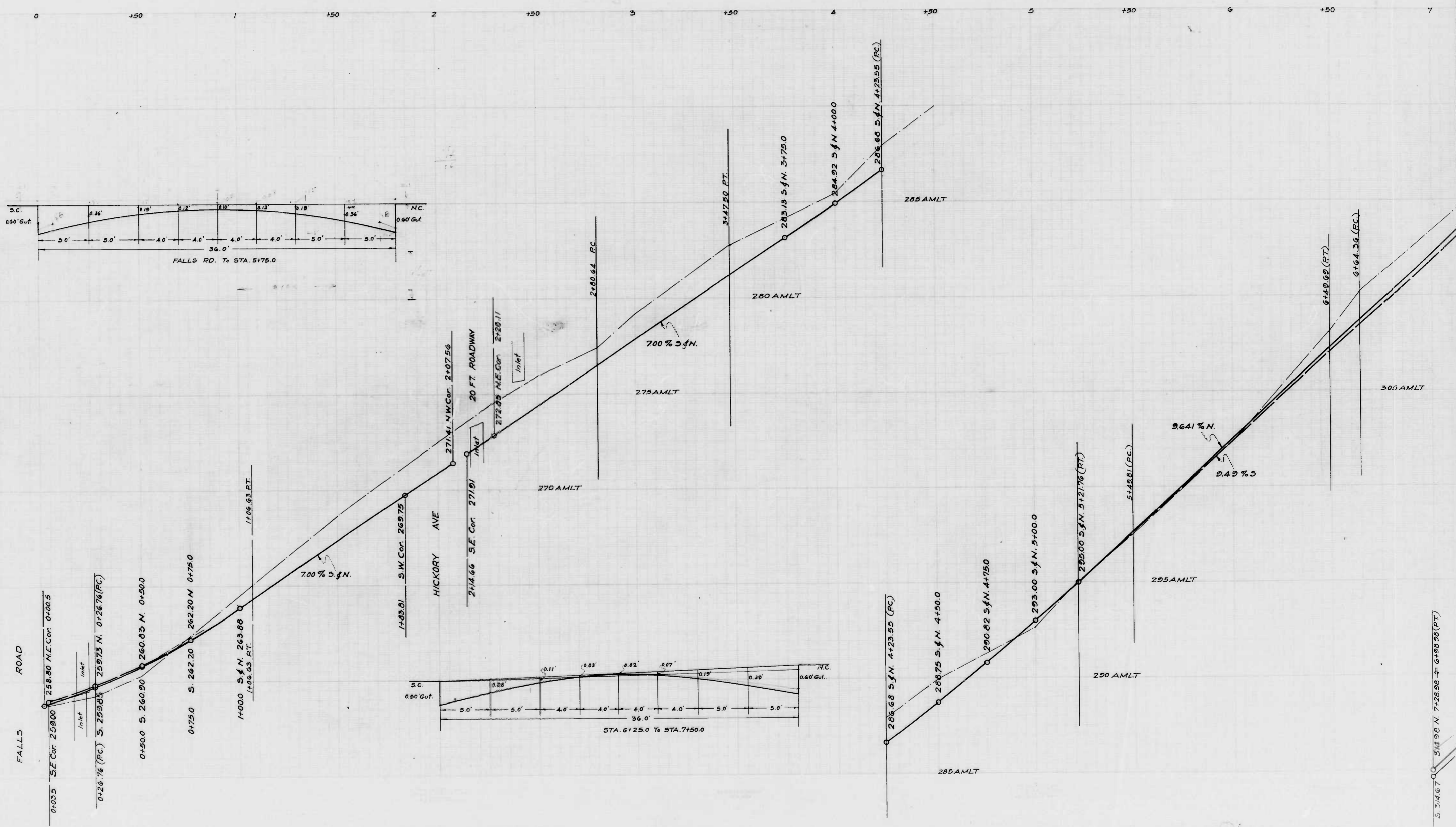

DRAWN BY *Wm. H. Cowell*  
 CHECKED BY *H. H. H. H.*  
 ENGINEER & SURVEYOR

S 3+146.7 3+149.8 N. 7+28.98 + 6+98.98 (PT)

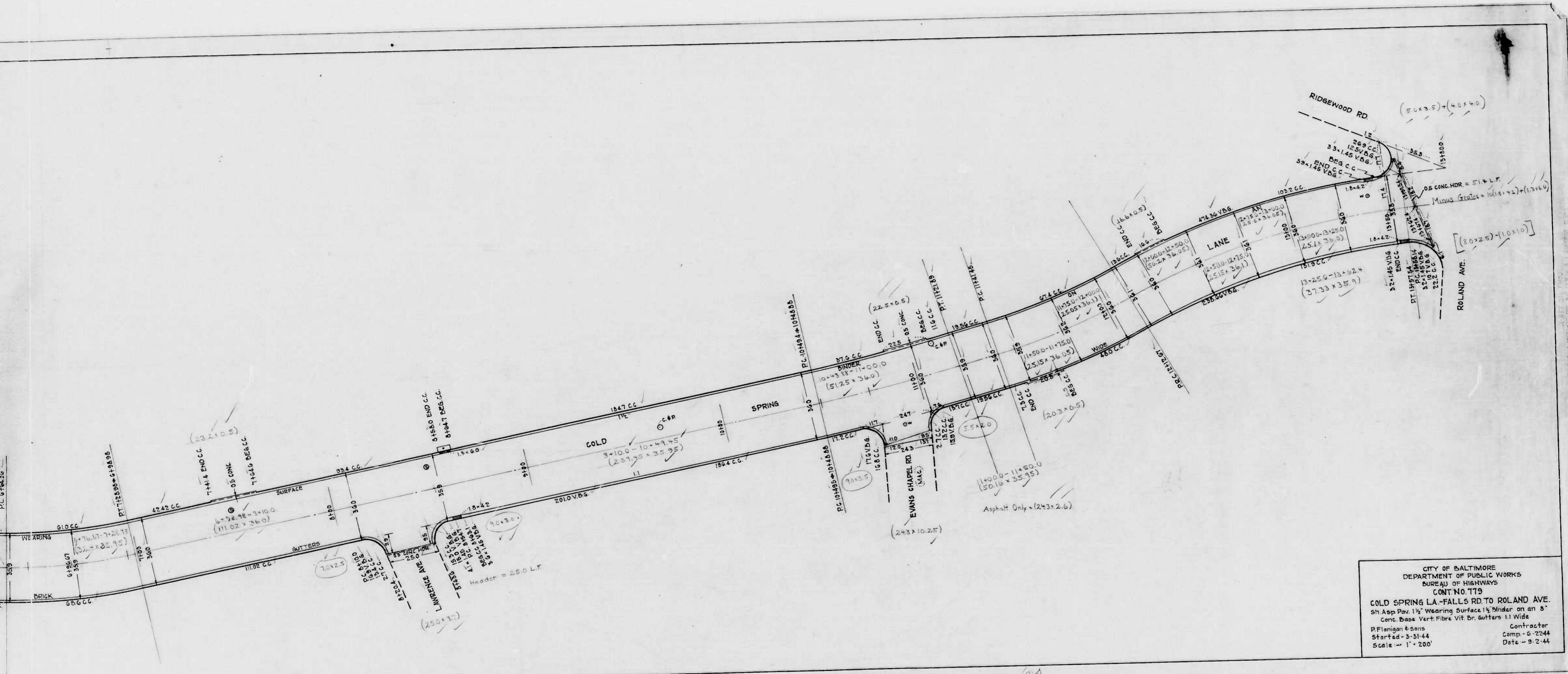

CITY OF BALTIMORE  
 DEPARTMENT OF PUBLIC WORKS  
 BUREAU OF HIGHWAYS  
 CONT. NO. 119  
 COLD SPRING LA. - FALLS RD. TO ROLAND AVE.  
 5 1/2" Asp Pav. 1 1/2" Wearing Surface 1 1/2" Binder on an 8"  
 Conc. Base Vert. Fibre Vit. Br. Gutters 11" Wide  
 P. Flanagan & Sons Contractor  
 Started - 3-31-44 Comp. - 6-22-44  
 Scale - 1" = 200' Date - 9-2-44

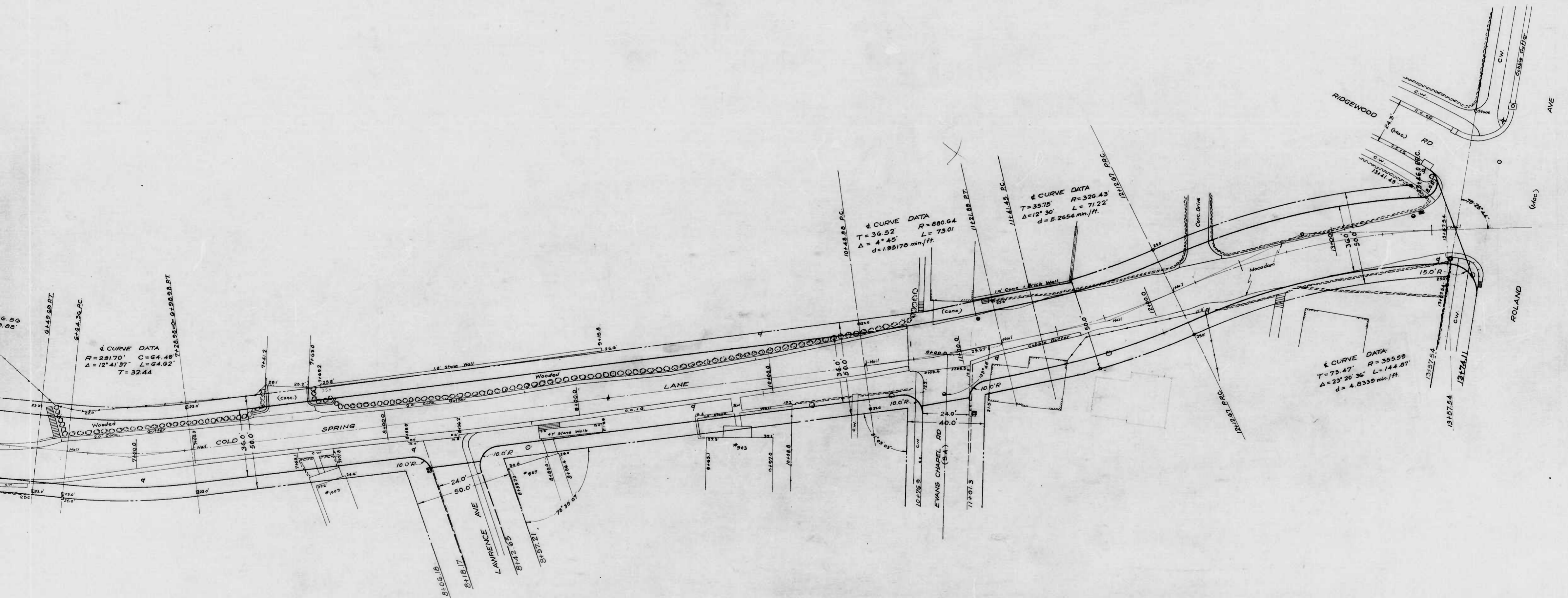



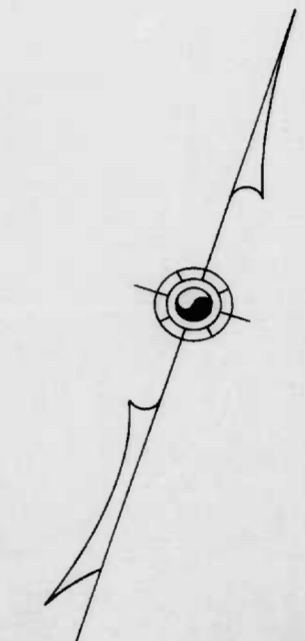
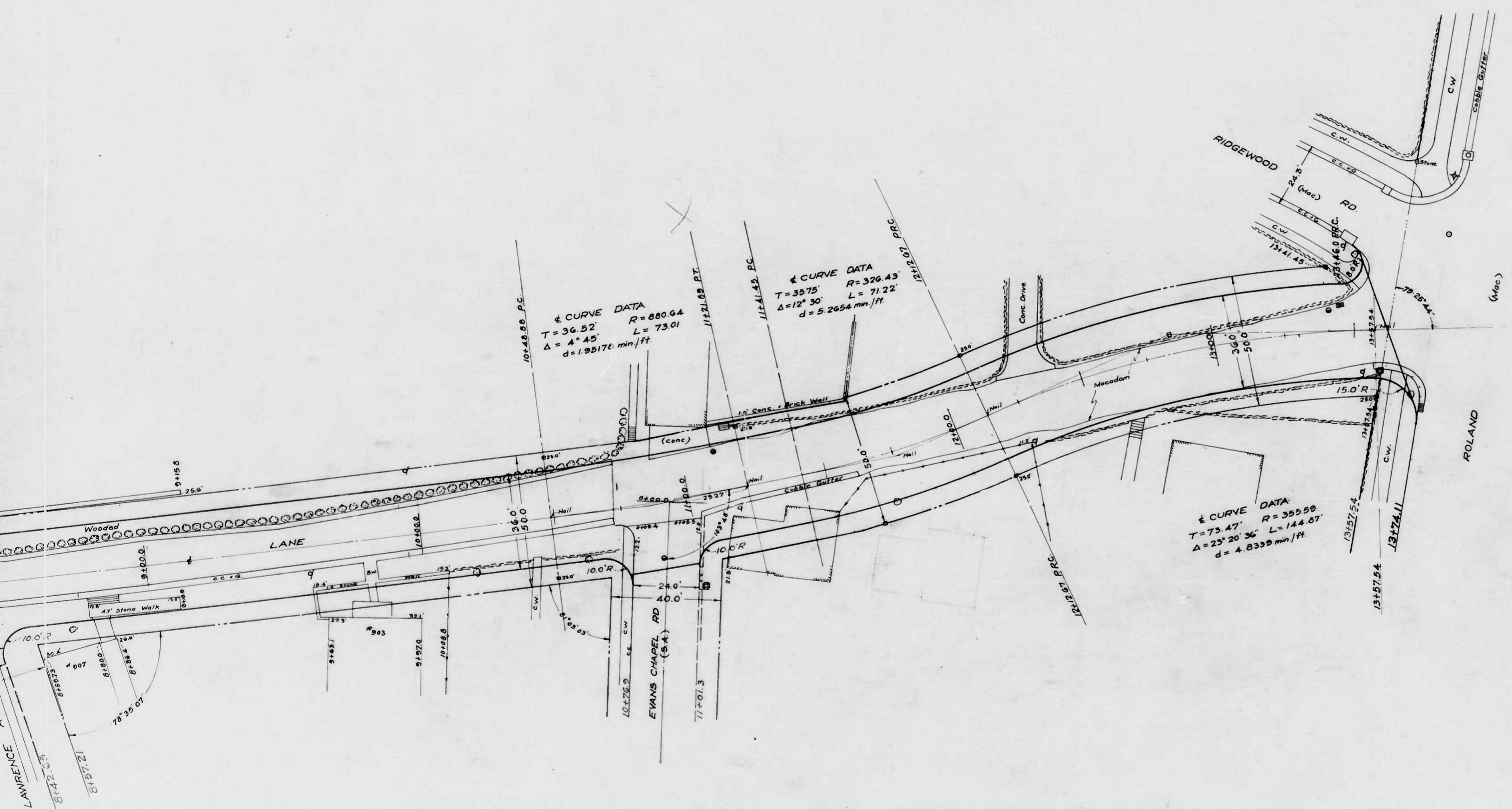

CITY OF BALTIMORE  
 DEPARTMENT OF PUBLIC WORKS  
 BUREAU OF HIGHWAYS  
 PLAN OF  
 COLD SPRING LANE-FALLS RD-ROLAND AVE.  
 SCALE: 1" = 200'  
 CONT. NO. 779  
 CORRECT  
 APPROVED

BOOK NO. X-146  
 DATE: NOV. 2, 1943  
 APPROVED

*Edward H. Chapman*  
 ASSOCIATE ENGINEER  
 APPROVED

*W. H. Z. ...*  
 HIGHWAYS ENGINEER  
 APPROVED

*Edward H. Chapman*  
 ENGR. PLANS & SURVEYS

*W. H. Z. ...*  
 CHIEF ENGINEER

33

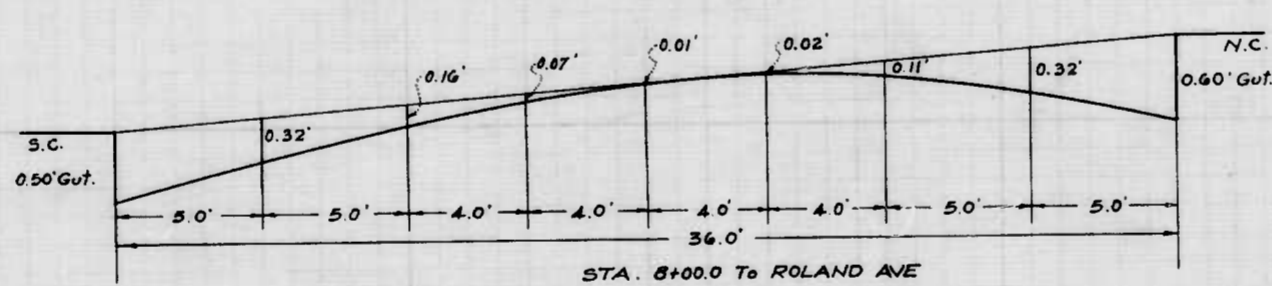
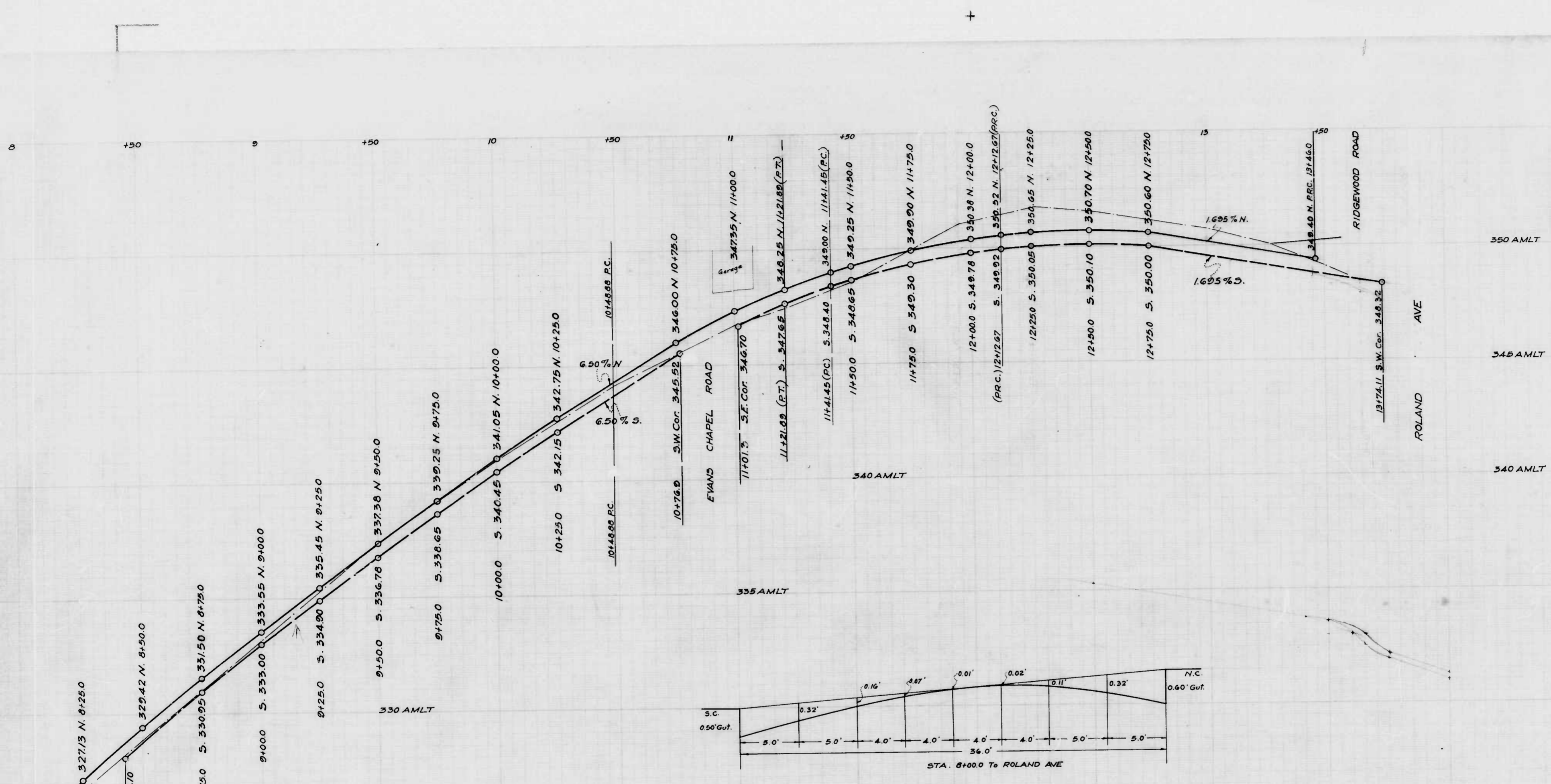

CITY OF BALTIMORE  
 DEPARTMENT OF PUBLIC WORKS  
 BUREAU OF HIGHWAYS  
 PROFILE OF  
 COLD SPRING LANE - FALLS RD-ROLAND AVE.  
 BOOK N° X-148  
 SCALE: HOR: 1" = 200' DATE: Nov. 2, 1943  
 VER: 1" = 2.0'  
 CONT. N° 779

CORRECT  
*Edward J. Hecker*  
 ASSOCIATE ENGINEER  
 APPROVED

APPROVED  
*W. H. D. Fischer*  
 HIGHWAYS ENGINEER  
 APPROVED

*Edward J. Hecker* c/o  
 ENGR. PLANS & SURVEYS

*Walter L. Smith*  
 CHIEF ENGINEER