

NOTE:- THE ISSUANCE OF THIS PROFILE DOES NOT COMMIT THE CITY TO THE ACCEPTANCE AND/OR IMPROVEMENT OF ANY THOROUGHFARES SHOWN THEREON.

DRAWN BY TESSE D. CARTER
 CHECKED BY *H. Weisberg*
 ENGINEER IN CHARGE

R

+50 1 +50 2 +50 3 +50 4 +50 5 +50 6 +50 7 +50 8

01853 D56CC&PW
D56 CC & PW 01853

3466 CC ✓
CEMENT
AUDREY
SEVEN
341.7 CC ✓

0+86.05 - 9+66.8
(882.75 X 30.1)

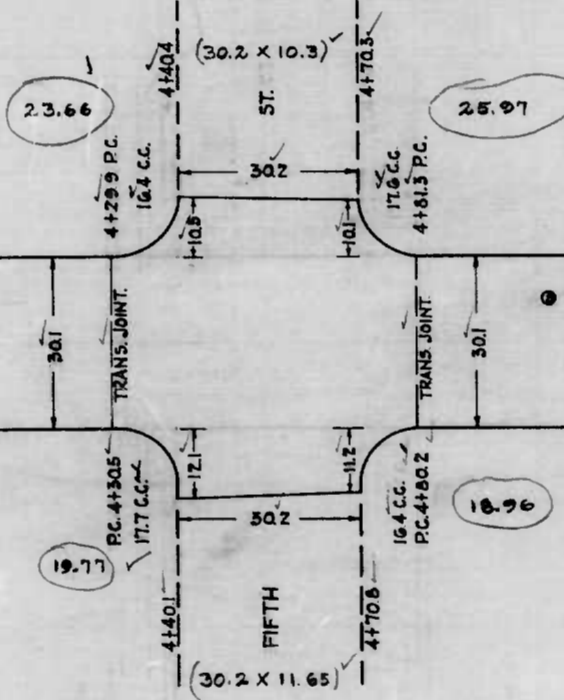

4875 CC ✓
CONCRETE
INCHES
489.7 CC ✓

CONCRETE
COLLECTOR

J. J. HAYDEN
DRAWN BY
Checked by Dan W. [Signature]
ENGINEER IN CHARGE

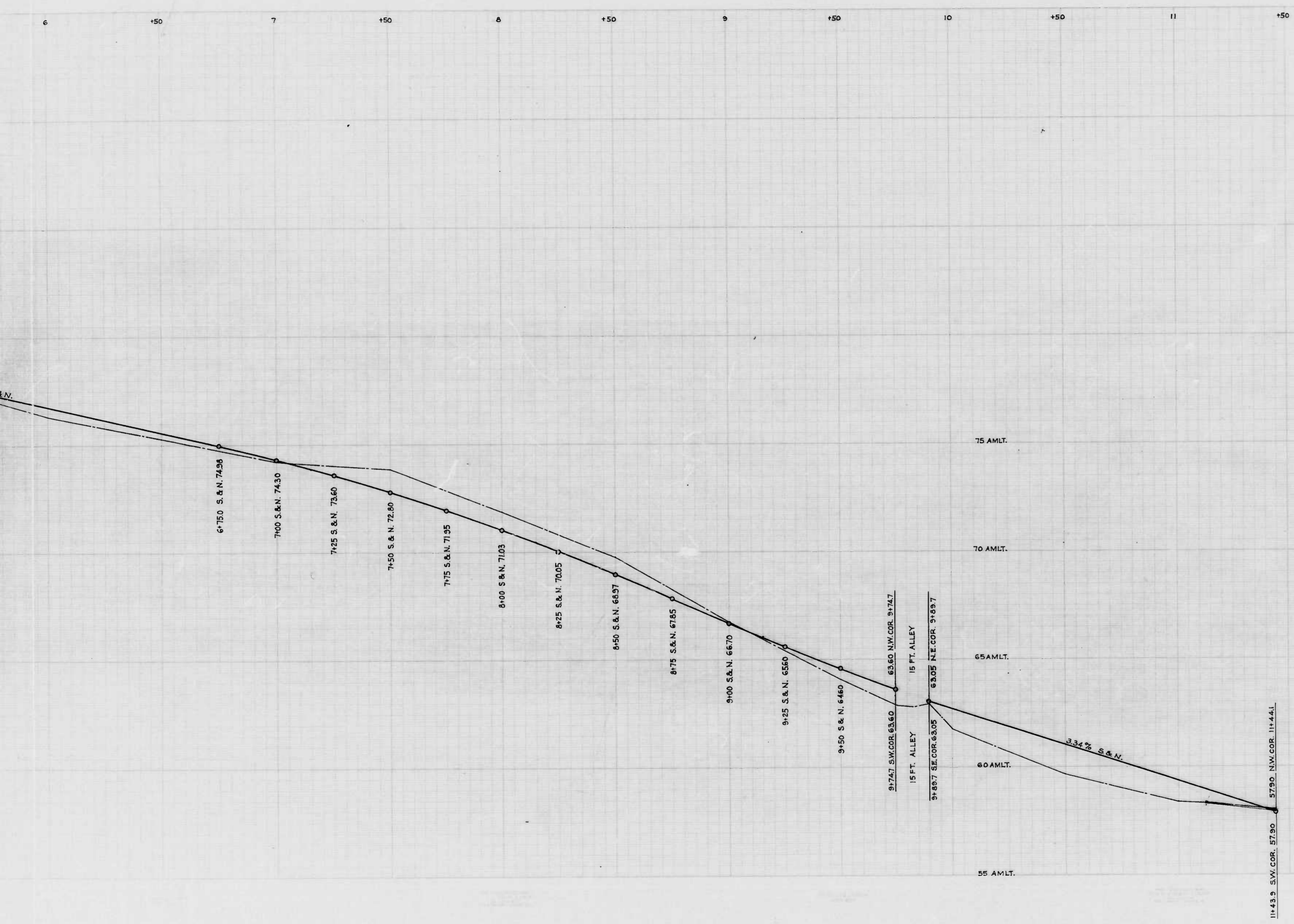

CITY OF BALTIMORE
 DEPARTMENT OF PUBLIC WORKS
 BUREAU OF HIGHWAYS
 ESTABLISHED GRADE OF
 AUDREY AVE. - SOUTH CITY LINE TO SIXTH ST.
 CONT. No. 776

SCALES: - HOR. 1" = 20'
 VER. 1" = 2'

BOOK No. X-169
 MAY 26, 1943

APPROVED: *John J. Gassman*
 ASSOCIATE ENGINEER

APPROVED: *Edward J. Haeberlein*
 ENGR. - PLANS & SURVEYS.

APPROVED: *James J. Kelly*
 HIGHWAYS ENGINEER

APPROVED: *James J. Kelly*
 CHIEF ENGINEER

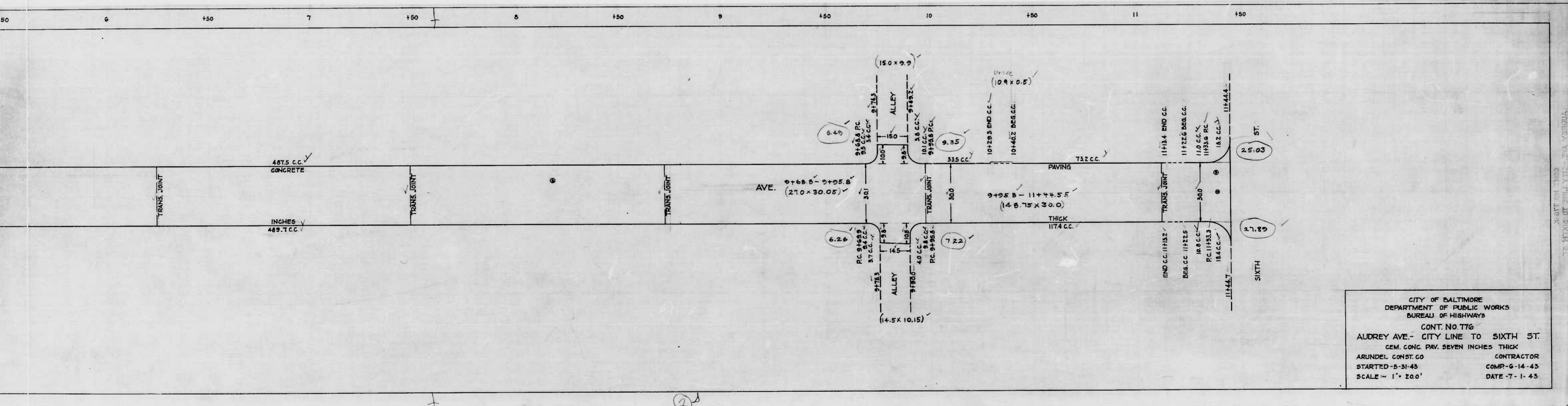

CITY OF BALTIMORE
 DEPARTMENT OF PUBLIC WORKS
 BUREAU OF HIGHWAYS

CONT. NO. 776
 AUDREY AVE. - CITY LINE TO SIXTH ST.
 CEM. CONC. PAV. SEVEN INCHES THICK

ARUNDEL CONST. CO. CONTRACTOR
 STARTED - 5-31-43 COMP. - 6-14-43
 SCALE - 1" = 20.0' DATE - 7-1-43

START ON THIS SIDE OF THE ROAD
 TO BEING OF THE CITY OF BALTIMORE

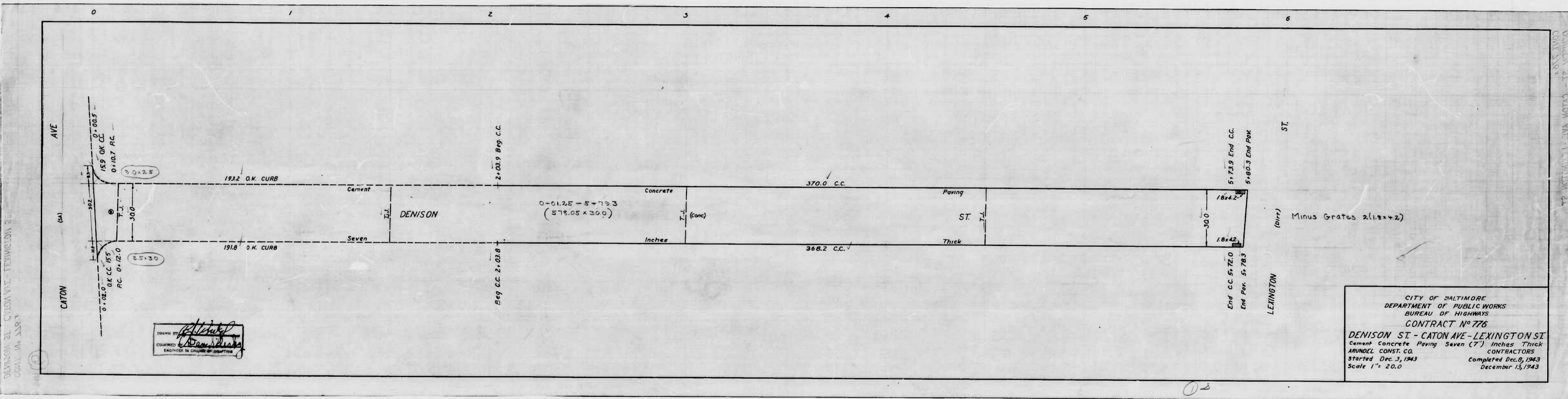

77.6

RATIO - 24

8

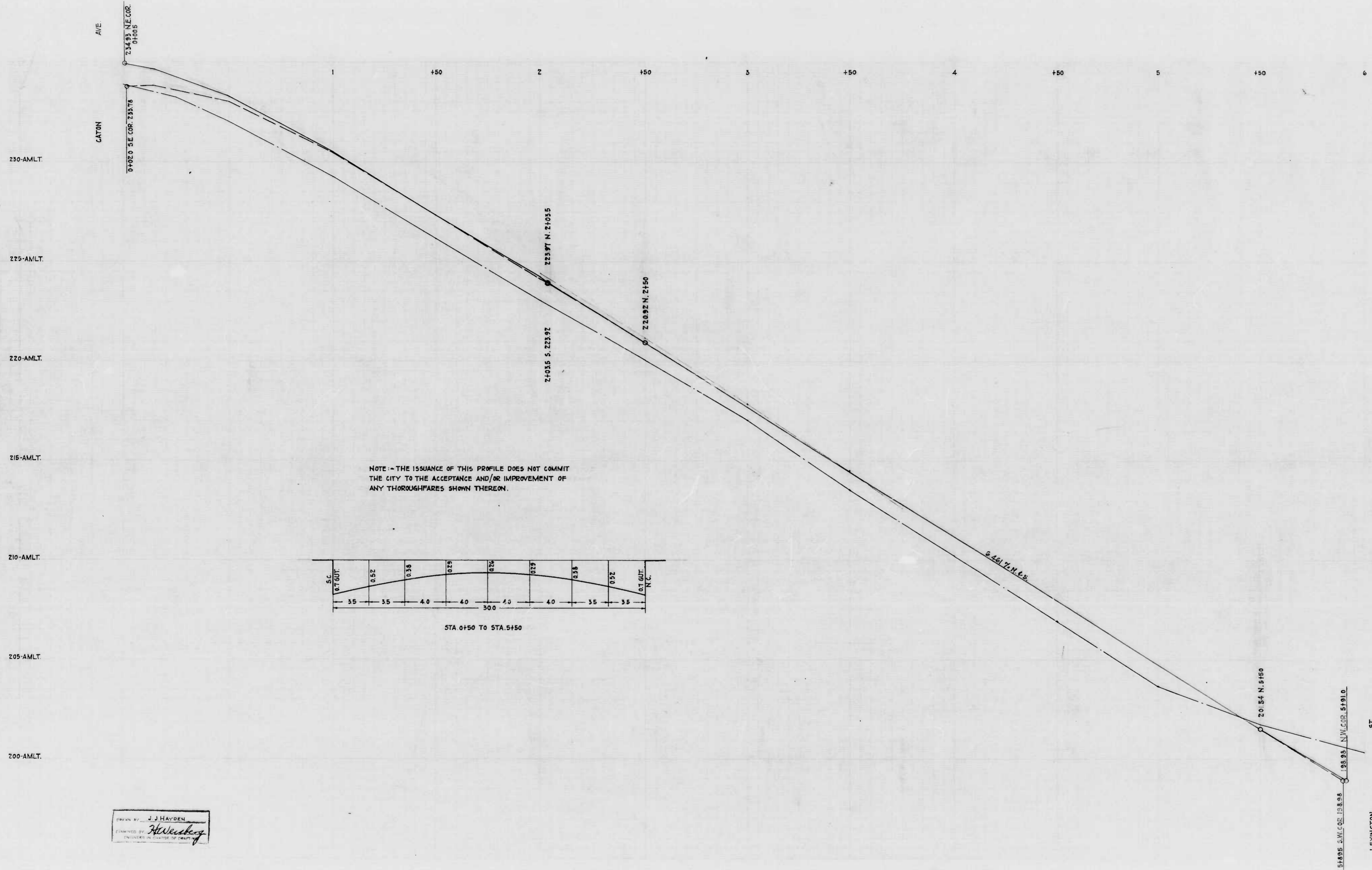

NOTE - THE ISSUANCE OF THIS PROFILE DOES NOT COMMIT THE CITY TO THE ACCEPTANCE AND/OR IMPROVEMENT OF ANY THOROUGHFARES SHOWN THEREON.

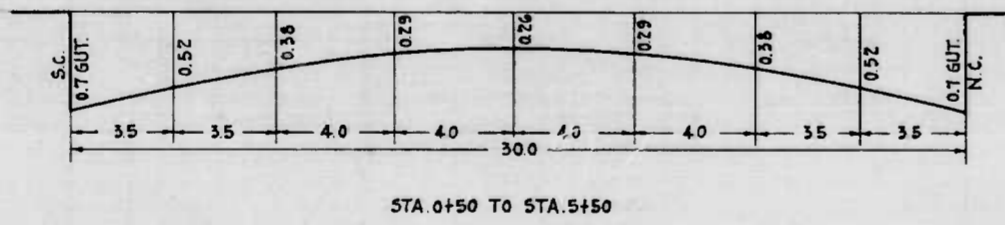

DRAWN BY J.J. HAYDEN
 CHECKED BY H. Weisberg
 ENGINEER IN CHARGE OF DEPT.

CITY OF DENVER
 DEPARTMENT OF PUBLIC WORKS
 BUREAU OF STREETS
 ESTABLISHED 1861
 DENISON ST. - CATON ST.
 SCALES - HOR. 1" = 200'
 VERT. 1" = 20'
 APPROVED
 H. Weisberg
 ASSOCIATE ENGINEER
 APPROVED
 W. H. Fisher
 HIGHWAYS ENGINEER

1 +50 2 +50 3 +50 4 +50 5 +50 6

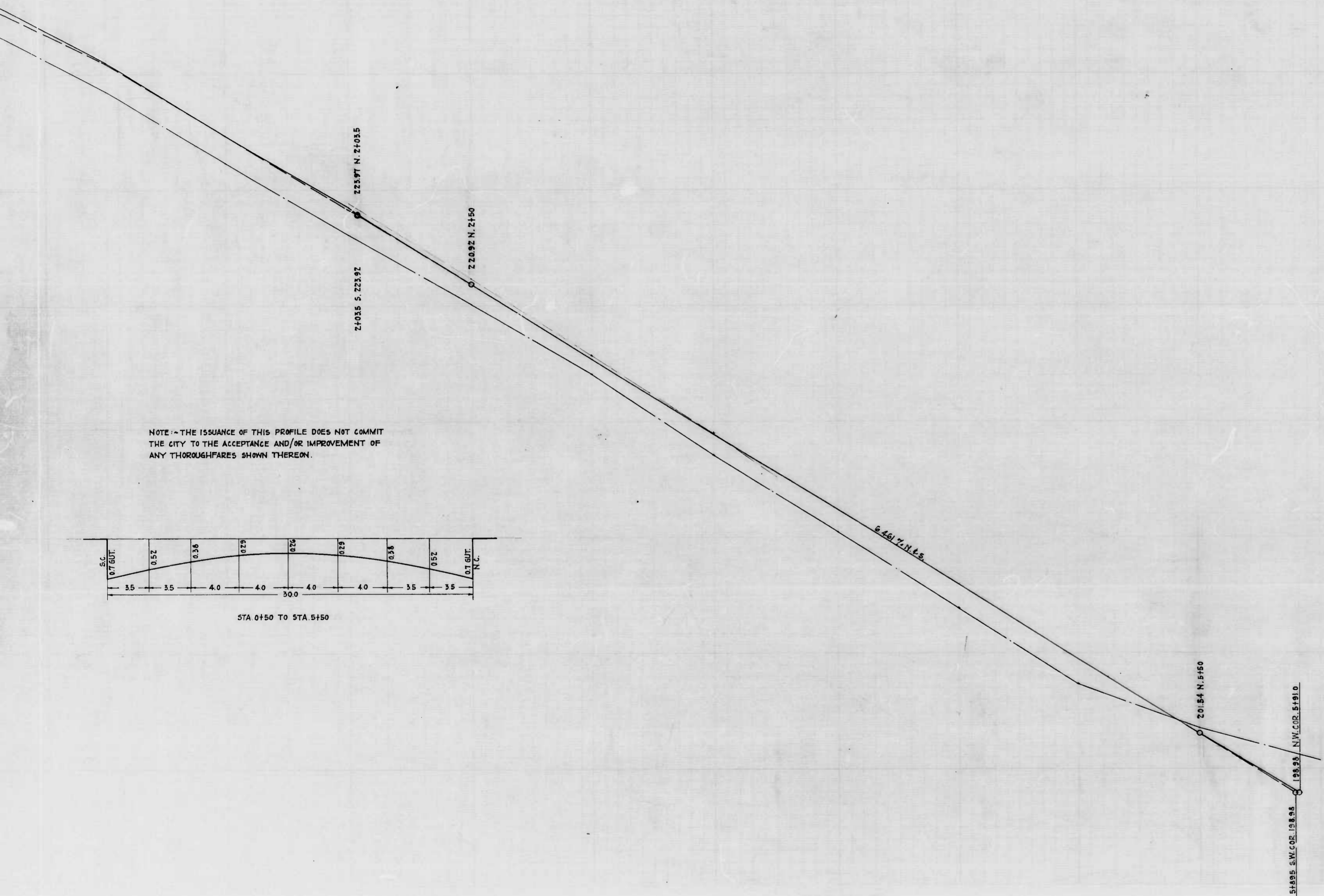

NOTE:- THE ISSUANCE OF THIS PROFILE DOES NOT COMMIT THE CITY TO THE ACCEPTANCE AND/OR IMPROVEMENT OF ANY THOROUGHFARES SHOWN THEREON.

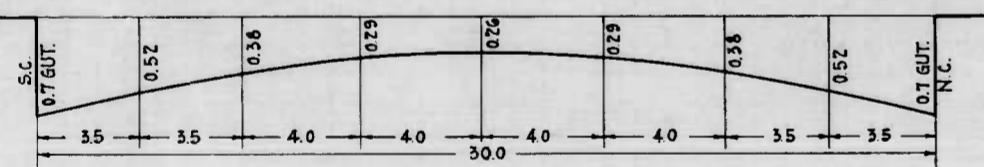

STA 0150 TO STA. 5150

CITY OF BALTIMORE
 DEPARTMENT OF PUBLIC WORKS
 BUREAU OF HIGHWAYS
 ESTABLISHED GRADE OF
 DENISON ST. - CATON AVE. TO LEXINGTON ST.
 CONT. NO. 176
 SCALES - HOR. - 1" = 200' BOOK NO. X-171
 VERT. - 1" = 2.0' NOV. 6, 1943
 APPROVED: *[Signature]* APPROVED: *[Signature]*
 ASSOCIATE ENGINEER ENGR. PLANS & SURVEYS
 APPROVED: *[Signature]* APPROVED: *[Signature]*
 HIGHWAYS ENGINEER CHIEF ENGINEER

THIS DRAWING IS THE PROPERTY OF THE CITY OF BALTIMORE AND IS NOT TO BE REPRODUCED WITHOUT THE WRITTEN PERMISSION OF THE ENGINEER IN CHARGE

+50 2 +50 3 +50 4 +50 5 +50 6

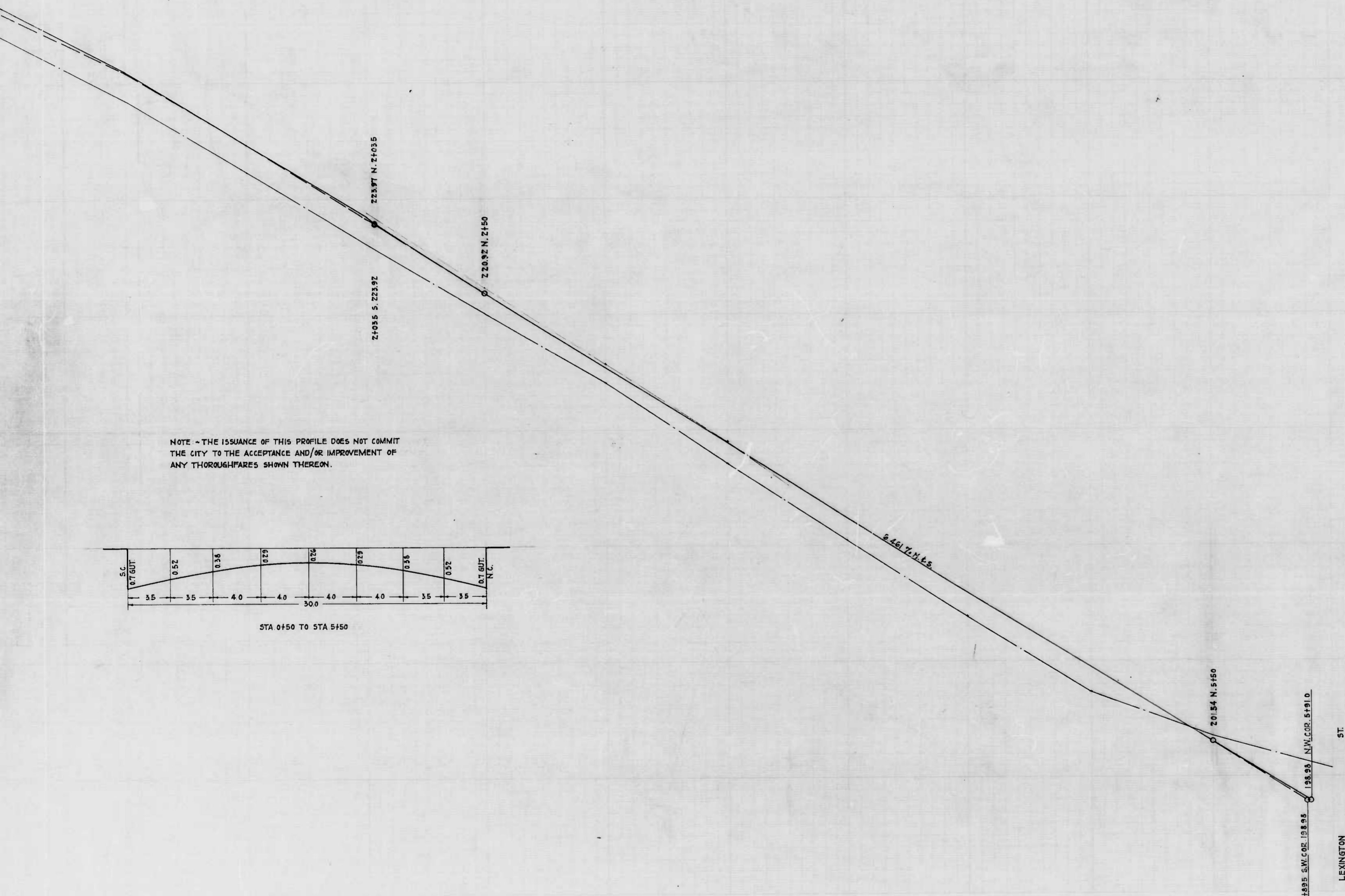

NOTE - THE ISSUANCE OF THIS PROFILE DOES NOT COMMIT THE CITY TO THE ACCEPTANCE AND/OR IMPROVEMENT OF ANY THOROUGHFARES SHOWN THEREON.

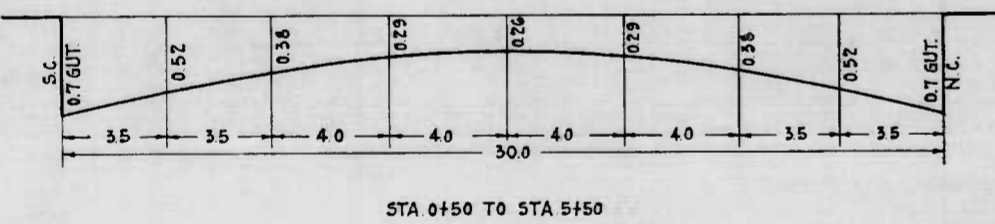

CITY OF BALTIMORE
 DEPARTMENT OF PUBLIC WORKS
 BUREAU OF HIGHWAYS
 ESTABLISHED GRADE OF
 DENISON ST. - CATON AVE. TO LEXINGTON ST.
 CONT. NO. 776
 SCALES - HOR. - 1" = 200' BOOK NO. X-171
 VER. - 1" = 2.0' NOV. 6, 1943
 APPROVED: *[Signature]* APPROVED: *[Signature]*
 ASSOCIATE ENGINEER ENGR. - PLANS & SURVEYS
 APPROVED: *[Signature]* APPROVED: *[Signature]*
 HIGHWAYS ENGINEER CHIEF ENGINEER

REPRODUCED FROM ORIGINAL DRAWING

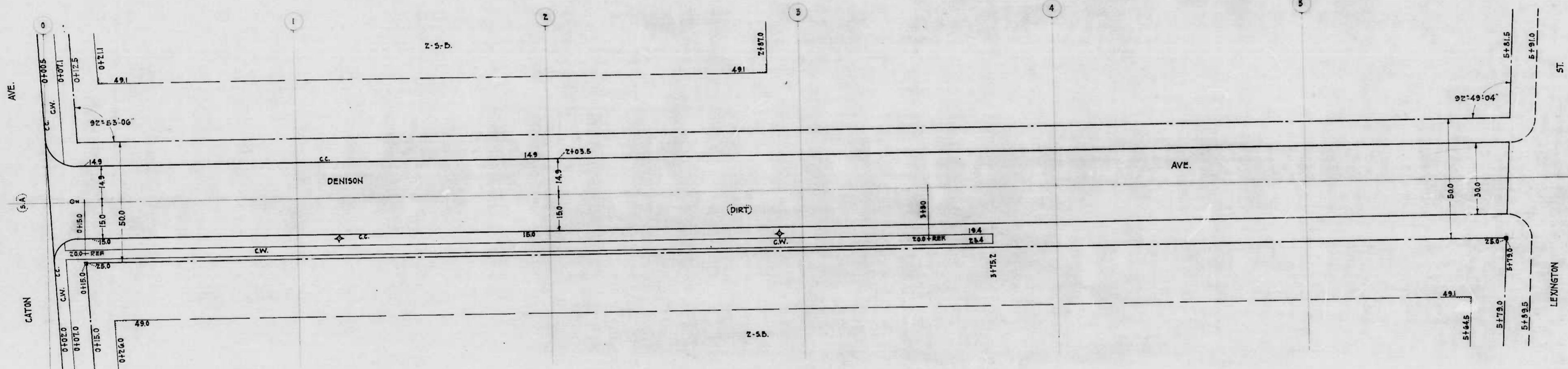

NOTE - THE ISSUANCE OF THIS PLAN DOES NOT COMMIT THE CITY TO THE ACCEPTANCE AND/OR IMPROVEMENT OF ANY THROUGHFARES SHOWN THEREON.

DESIGNED BY
J. J. HAYDEN
ENGINEER
J. J. Hayden

CITY OF BALTIMORE
DEPARTMENT OF PUBLIC WORKS
BUREAU OF HIGHWAYS
LAYOUT
DENISON ST. - CATON AVE. TO LEXINGTON ST.
CONT. NO. 776

SCALE - 1" = 200'
BOOK NO. X-171
NOV. 4, 1943

APPROVED: *[Signature]*
ASSOCIATE ENGINEER
APPROVED: *[Signature]*
ENGR. PLANS & SURVEYS
APPROVED: *[Signature]*
HIGHWAYS ENGINEER
APPROVED: *[Signature]*
CHIEF ENGINEER

04

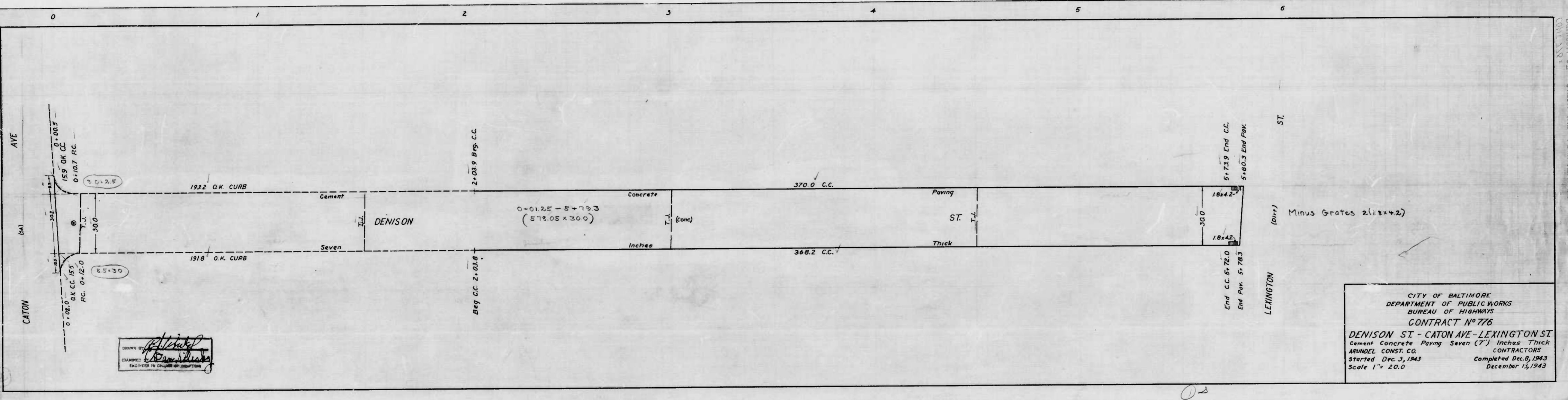

DRAWN BY
 CHECKED BY
 ENGINEER IN CHARGE OF DISTRICT

CITY OF BALTIMORE
 DEPARTMENT OF PUBLIC WORKS
 BUREAU OF HIGHWAYS
 CONTRACT No 776
 DENISON ST - CATON AVE - LEXINGTON ST
 Cement Concrete Paving Seven (7) Inches Thick
 ARUNDEL CONST. CO. CONTRACTORS
 Started Dec. 3, 1943 Completed Dec. 8, 1943
 Scale 1" = 20.0 December 13, 1943

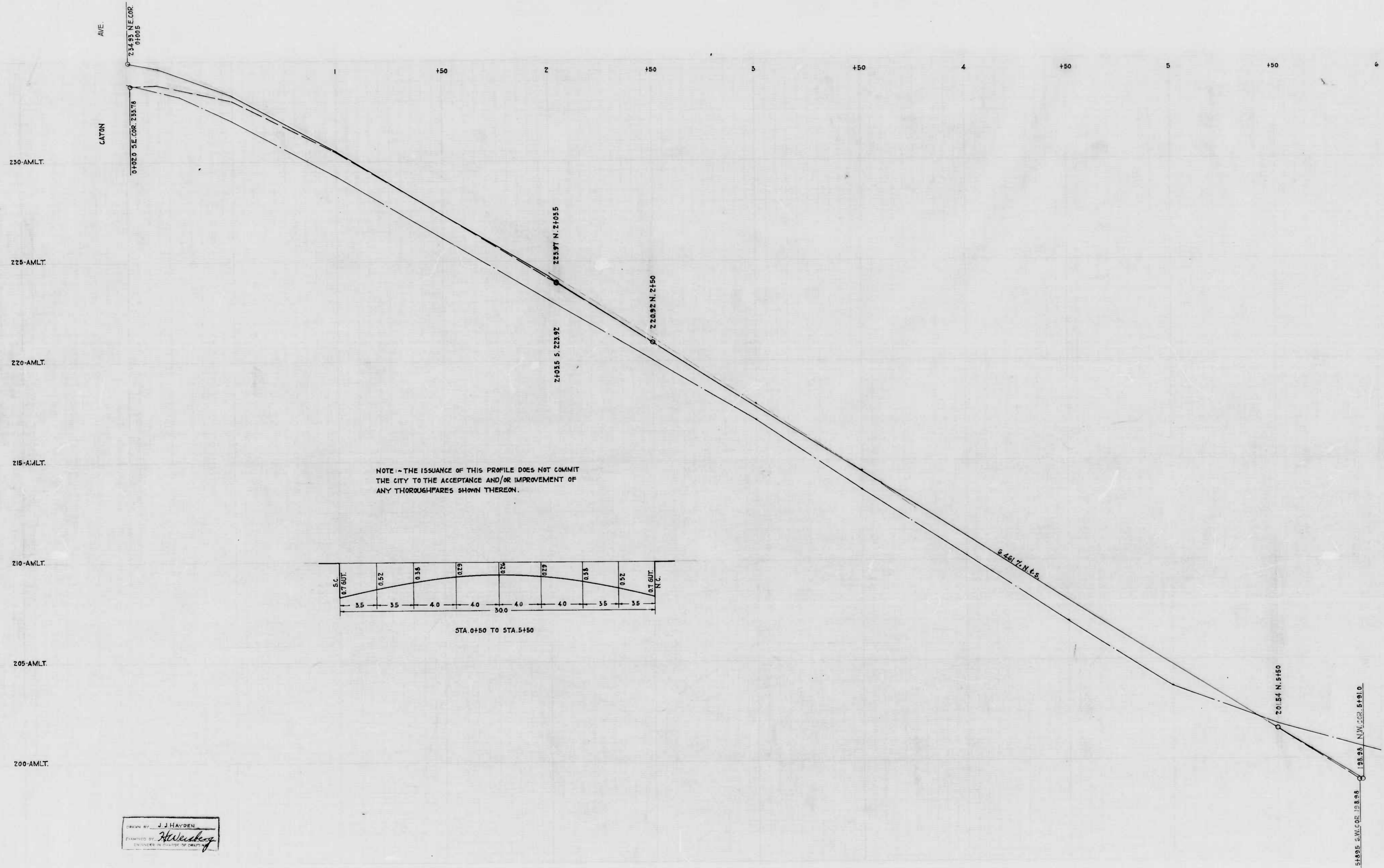

CITY OF LEXINGTON
 DEPARTMENT OF PUBLIC WORKS
 BUREAU OF ENGINEERING
 ESTABLISHED
 DENISON ST. - CATON
 CONT. N.
 SCALES - HOR. - 1" = 200'
 VER. - 1" = 20'
 APPROVED: [Signature]
 ASSOCIATE ENGINEER
 APPROVED: [Signature]
 HIGHWAYS ENGINEER

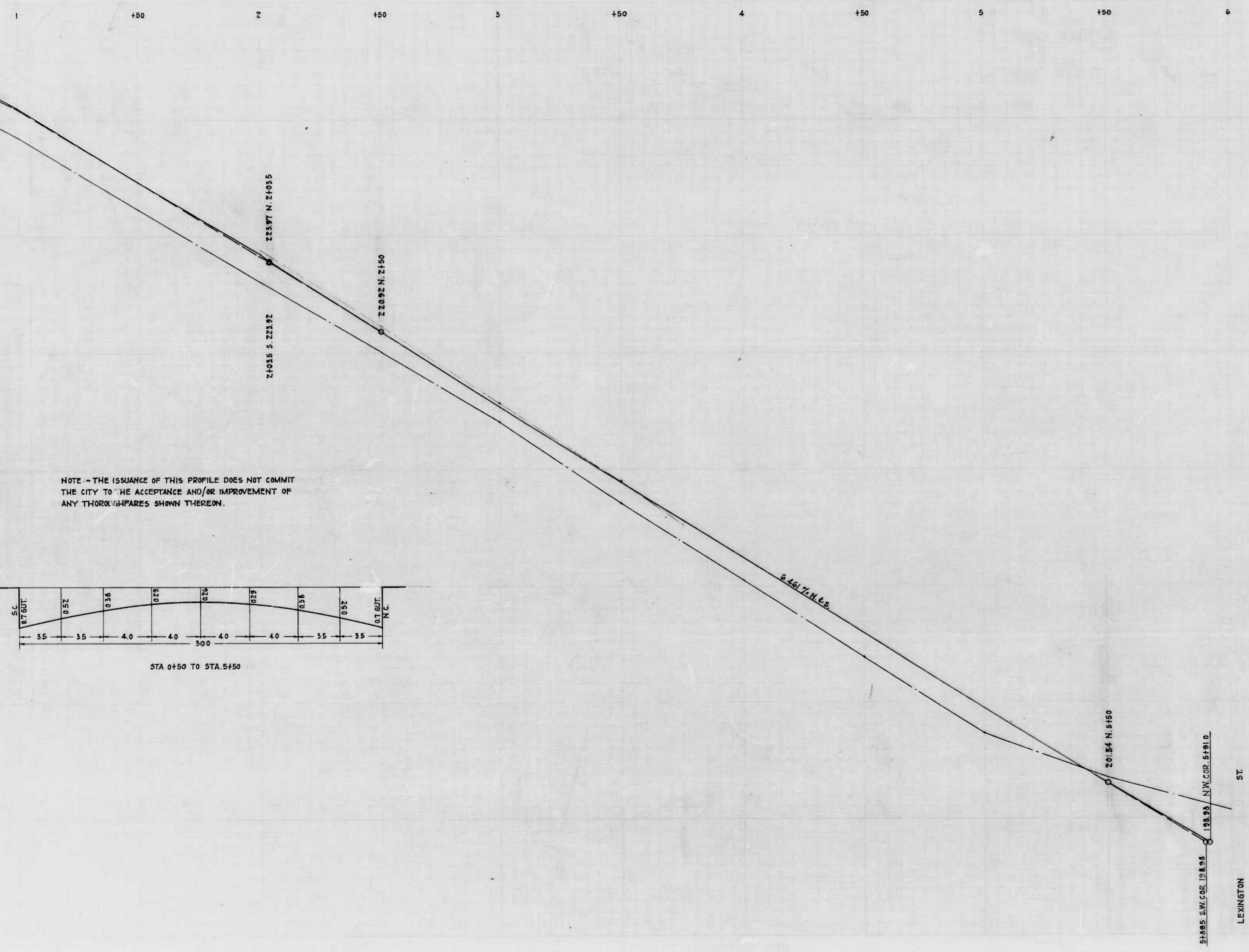

NOTE - THE ISSUANCE OF THIS PROFILE DOES NOT COMMIT THE CITY TO THE ACCEPTANCE AND/OR IMPROVEMENT OF ANY THOROUGHFARES SHOWN THEREON.

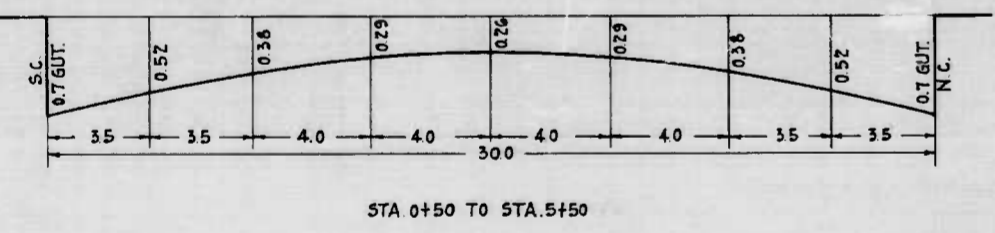

CITY OF BALTIMORE
 DEPARTMENT OF PUBLIC WORKS
 BUREAU OF HIGHWAYS
 ESTABLISHED GRADE OF
 DENISON ST. - CATON AVE TO LEXINGTON ST.
 CONT. NO. 176
 SCALES - HOR. - 1" = 200'
 VER. - 1" = 2.0'
 APPROVED: *[Signature]*
 ASSOCIATE ENGINEER
 APPROVED: *[Signature]*
 HIGHWAYS ENGINEER
 BOOK NO. X-171
 NOV. 6, 1943
 APPROVED: *[Signature]*
 ENGR.-PLANS & SURVEYS
 APPROVED: *[Signature]*
 CHIEF ENGINEER

DENISON ST. - CATON AVE TO LEXINGTON ST.

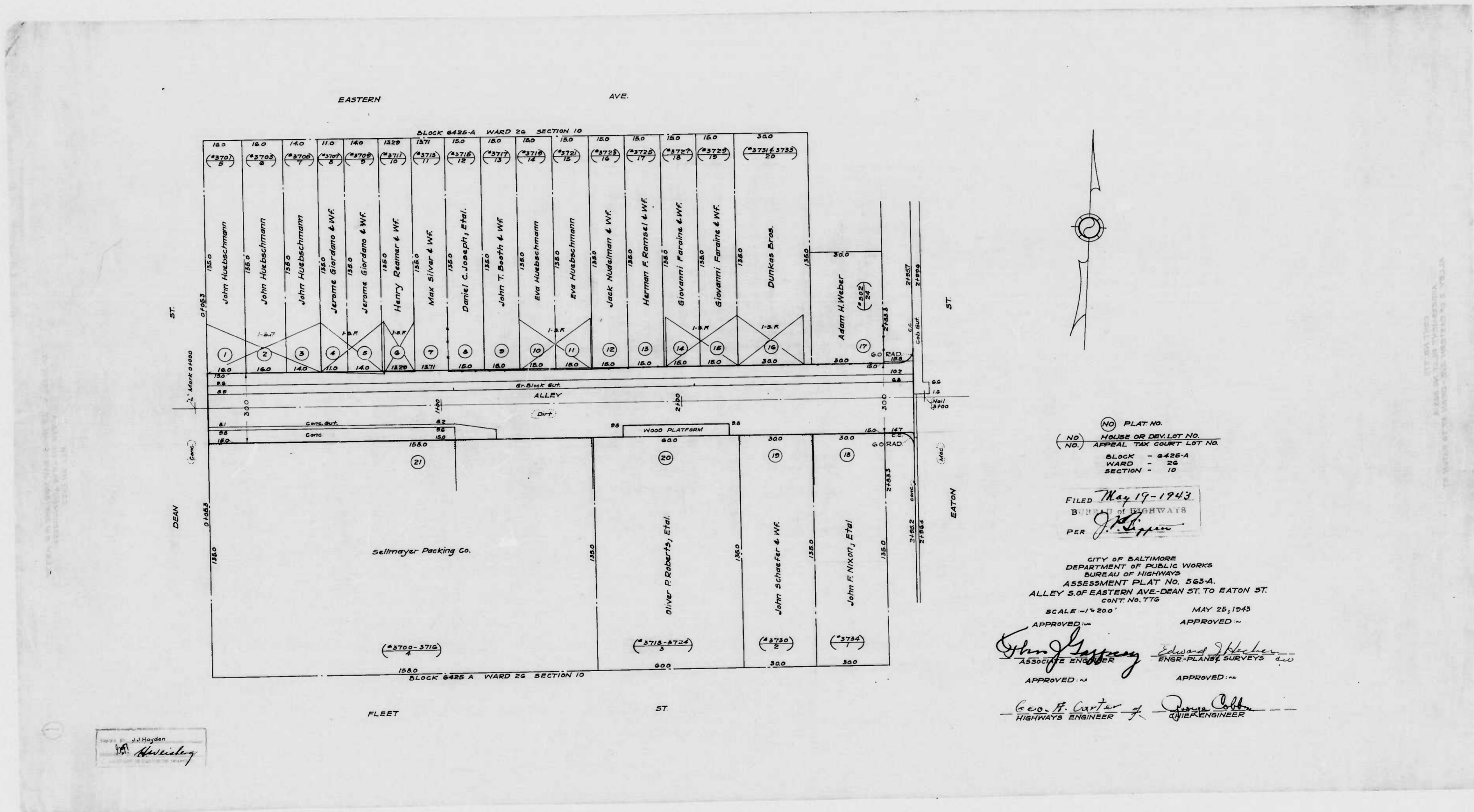

NO PLAT NO.
 (NO) HOUSE OR DEV. LOT NO.
 (NO) APPEAL TAX COURT LOT NO.
 BLOCK - 6425-A
 WARD - 26
 SECTION - 10

FILED May 19-1943
 BUREAU OF HIGHWAYS
 PER J. J. Lippert

CITY OF BALTIMORE
 DEPARTMENT OF PUBLIC WORKS
 BUREAU OF HIGHWAYS
 ASSESSMENT PLAT NO. 563-A
 ALLEY 5.0' OF EASTERN AVE-DEAN ST. TO EATON ST.
 CONT. No. 775

SCALE - 1" = 200' MAY 25, 1943

APPROVED: *John J. Lippert* APPROVED: *Edward J. Hecker*
 ASSOCIATE ENGINEER ENGR.-PLANS & SURVEYS C.E.O.

APPROVED: *Geo. H. Carter* APPROVED: *James C. O'Brien*
 HIGHWAYS ENGINEER CHIEF ENGINEER

PREPARED BY J. J. Hayden
J. J. Hayden

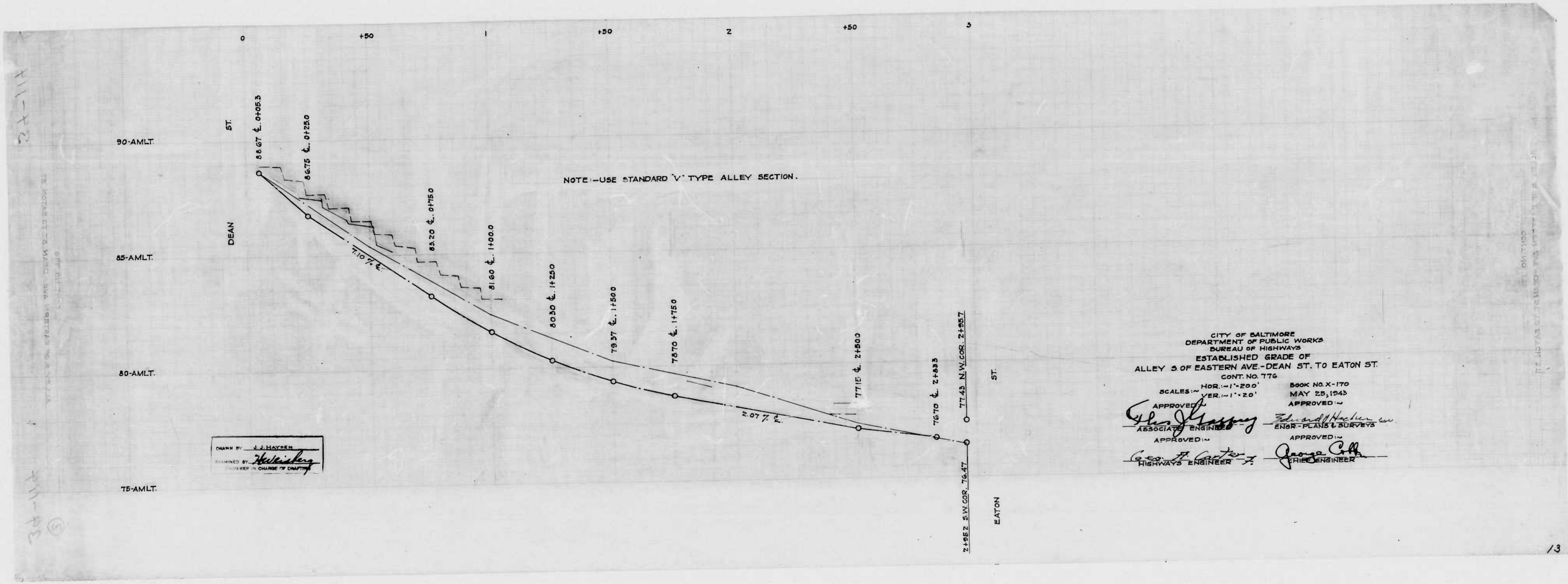

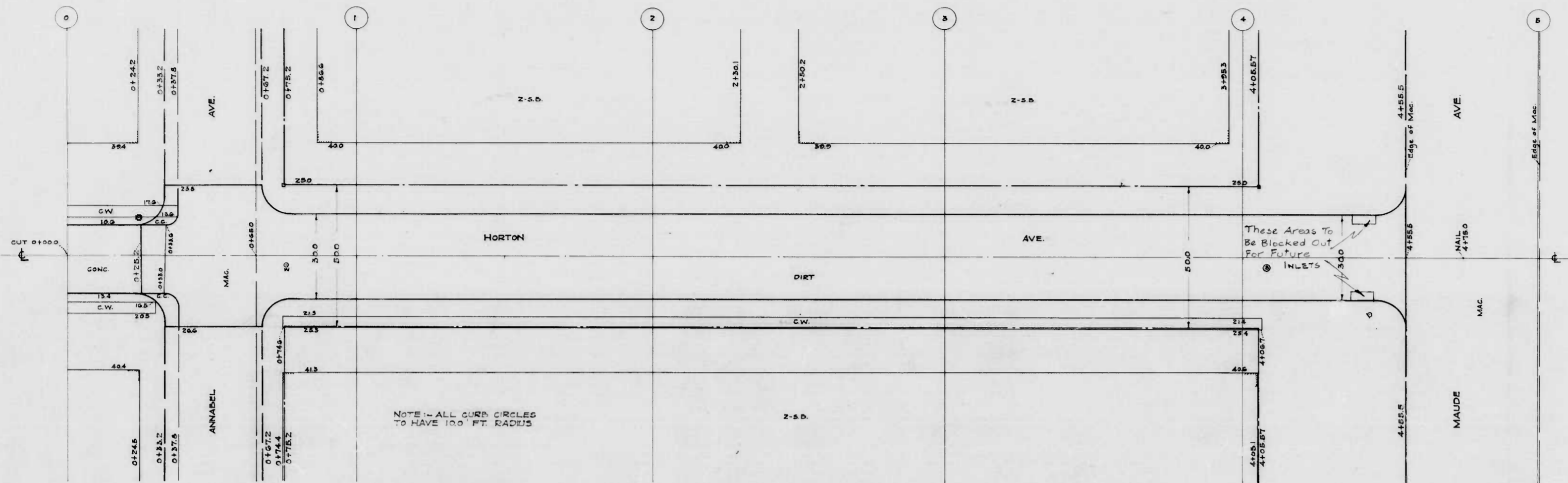

NOTE - ALL CURB CIRCLES TO HAVE 100' FT. RADIUS

NOTE - THE ISSUANCE OF THIS PLAN & PROFILE DOES NOT COMMIT THE CITY TO THE ACCEPTANCE AND/OR IMPROVEMENT OF ANY THOROUGHFARES SHOWN THEREON.

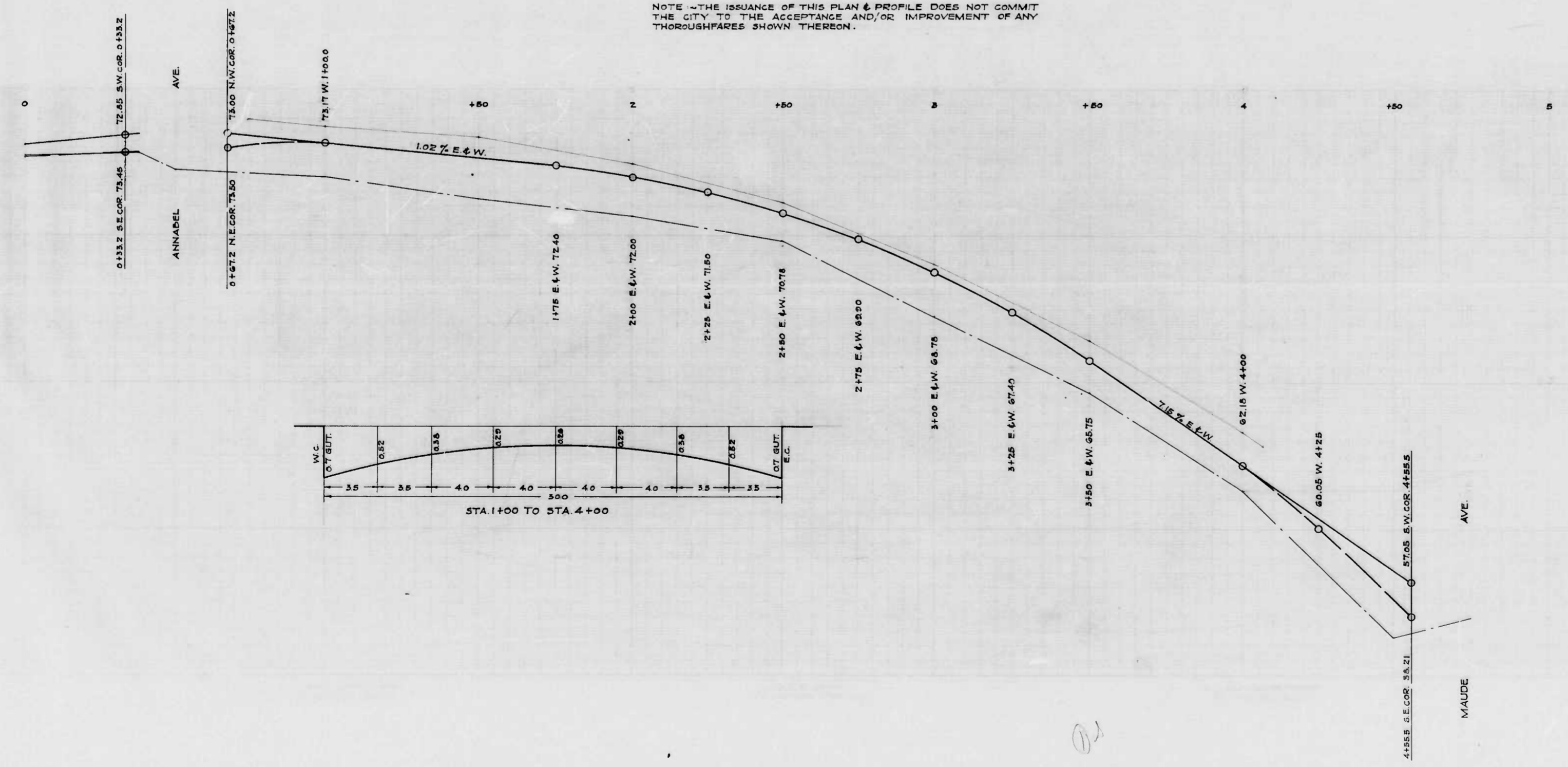

CITY OF BALTIMORE
 DEPARTMENT OF PUBLIC WORKS
 BUREAU OF HIGHWAYS
 PLAN & PROFILE
 HORTON AVE - ANNABEL AVE TO MAUDE AVE
 CONT. No. 776
 PLAN - 1" = 200' BOOK No. X-169
 SCALES - PROFILE - 1" = 200' APRIL 30, 1943
 VER. - 1" = 20'

APPROVED BY: *Edward J. Hayden* ASSOCIATE ENGINEER
 APPROVED BY: *Edmund H. Nielsen* ENGINEER IN CHARGE
 APPROVED BY: *Geo. A. Carter* HIGHWAYS ENGINEER
 APPROVED BY: *George J. Kelly* CHIEF ENGINEER

DESIGNED BY: *J. J. Hayden*
 DRAWN BY: *H. W. ...*

277

277

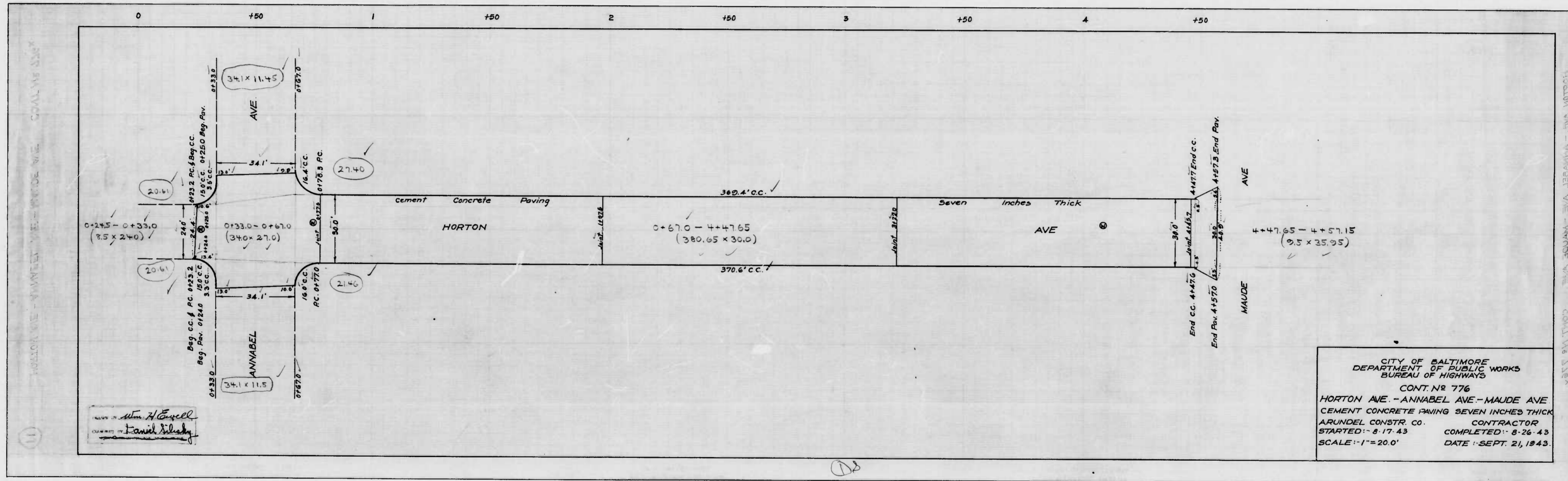

CITY OF BALTIMORE
 DEPARTMENT OF PUBLIC WORKS
 BUREAU OF HIGHWAYS
 CONT. NO 776
 HORTON AVE. - ANNABEL AVE. - MAUDE AVE
 CEMENT CONCRETE PAVING SEVEN INCHES THICK
 ARUNDEL CONSTR. CO. CONTRACTOR
 STARTED: 8-17-43 COMPLETED: 8-26-43
 SCALE: 1" = 20.0' DATE: SEPT. 21, 1943.

DESIGNED BY: *Sam H. Excel*
 CHECKED BY: *David S. Kelly*

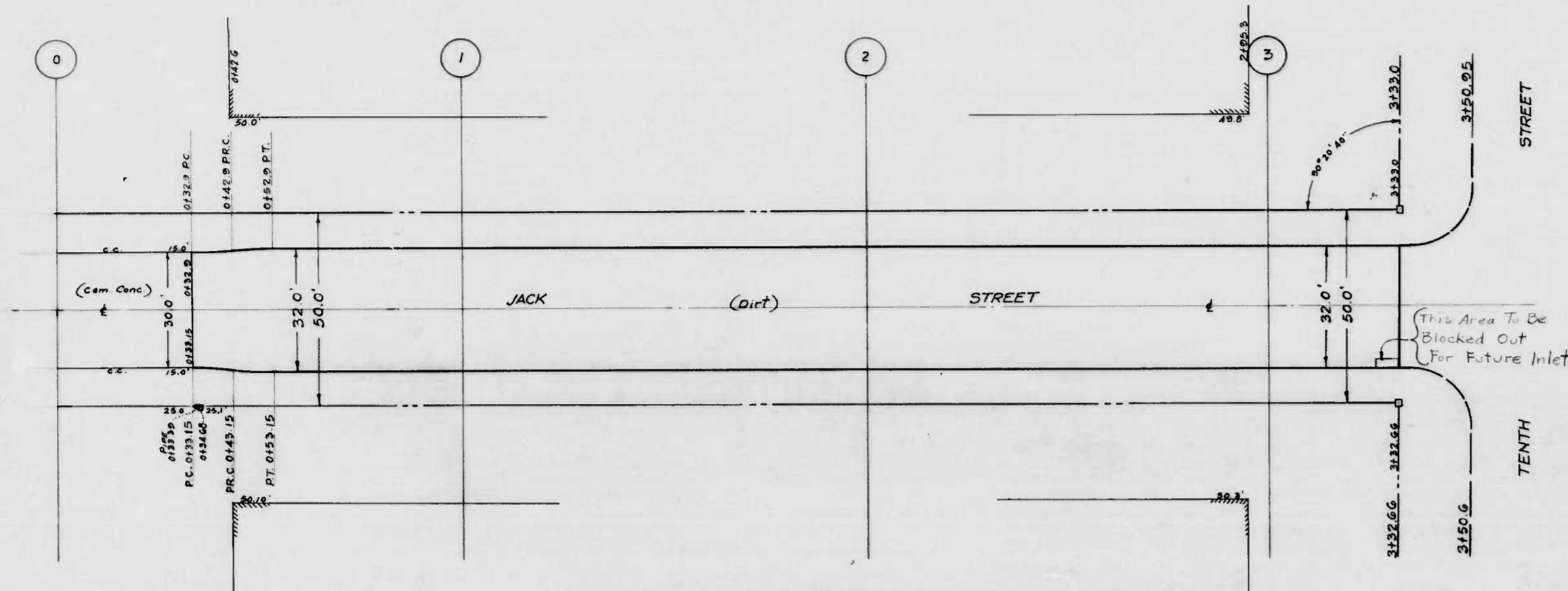

The issuance of this Plan & Profile does not commit the City to the Acceptance and/or Improvement of any Thoroughfares shown thereon.

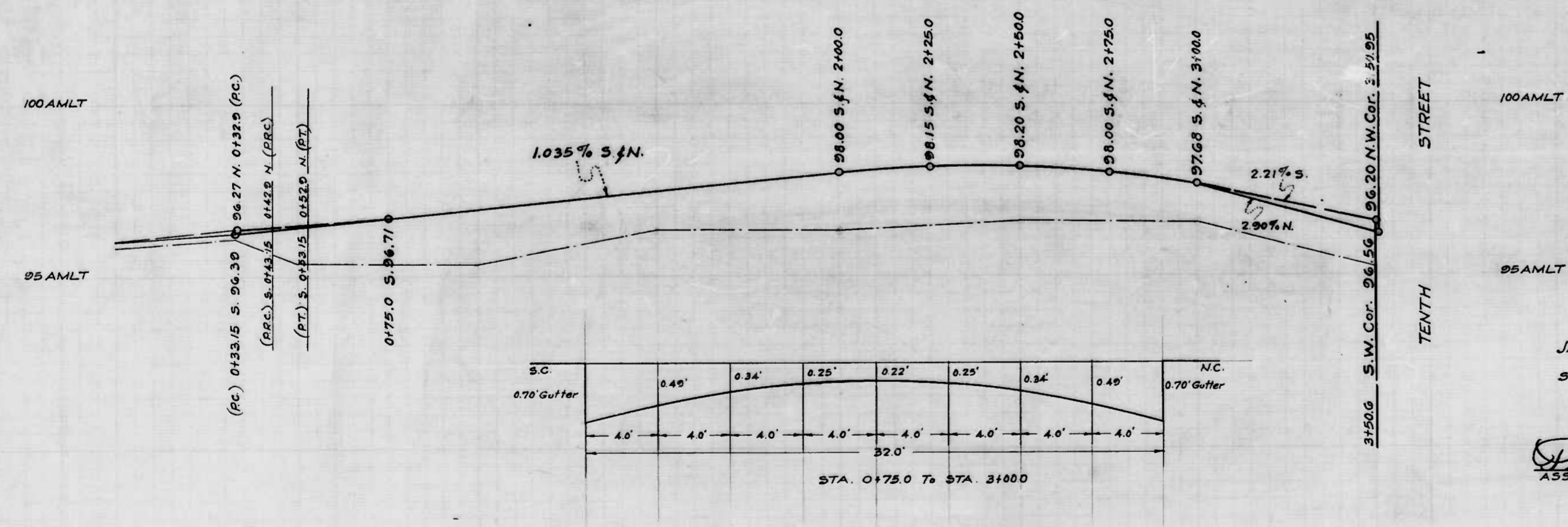
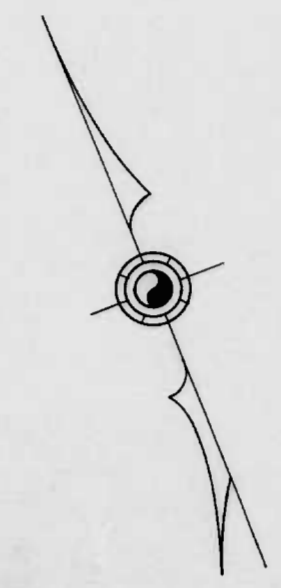

SC	0.40'	0.34'	0.25'	0.22'	0.25'	0.34'	0.40'	NC.
0.70' Gutter	4.0'	4.0'	4.0'	4.0'	4.0'	4.0'	4.0'	0.70' Gutter
32.0'								
STA. 0+75.0 To STA. 3+00.0								

CITY OF BALTIMORE
DEPARTMENT OF PUBLIC WORKS
BUREAU OF HIGHWAYS
PLAN & PROFILE
JACK ST. - TENTH ST. - 308' W. TENTH ST.
PLAN: 1" = 20.0' BOOK N° X-171.
SCALE: HOR. 1" = 20.0' DATE: 7-31-43
PROF. VER. 1" = 2.0' CONT. N° 776

APPROVED *Edward J. Gorman* ASSOCIATE ENGINEER
APPROVED *Geo. A. Carter* HIGHWAYS ENGINEER
APPROVED *Edward J. Hecker* ENGR. PLANS & SURVEYS
APPROVED *Nathan L. Smith* CHIEF ENGINEER

DESIGNED BY *Wm. H. Galloway*
DRAWN BY *W. H. Galloway*
CHECKED BY *W. H. Galloway*
ENGINEER & SURVEYOR

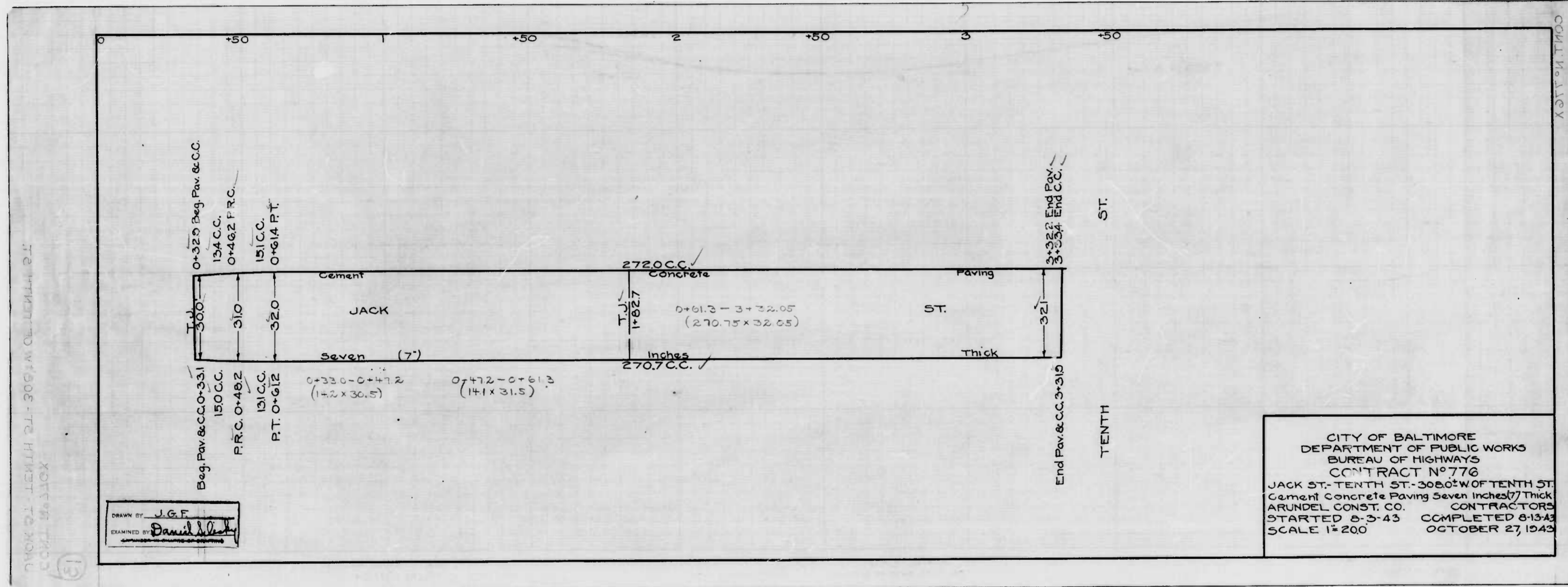

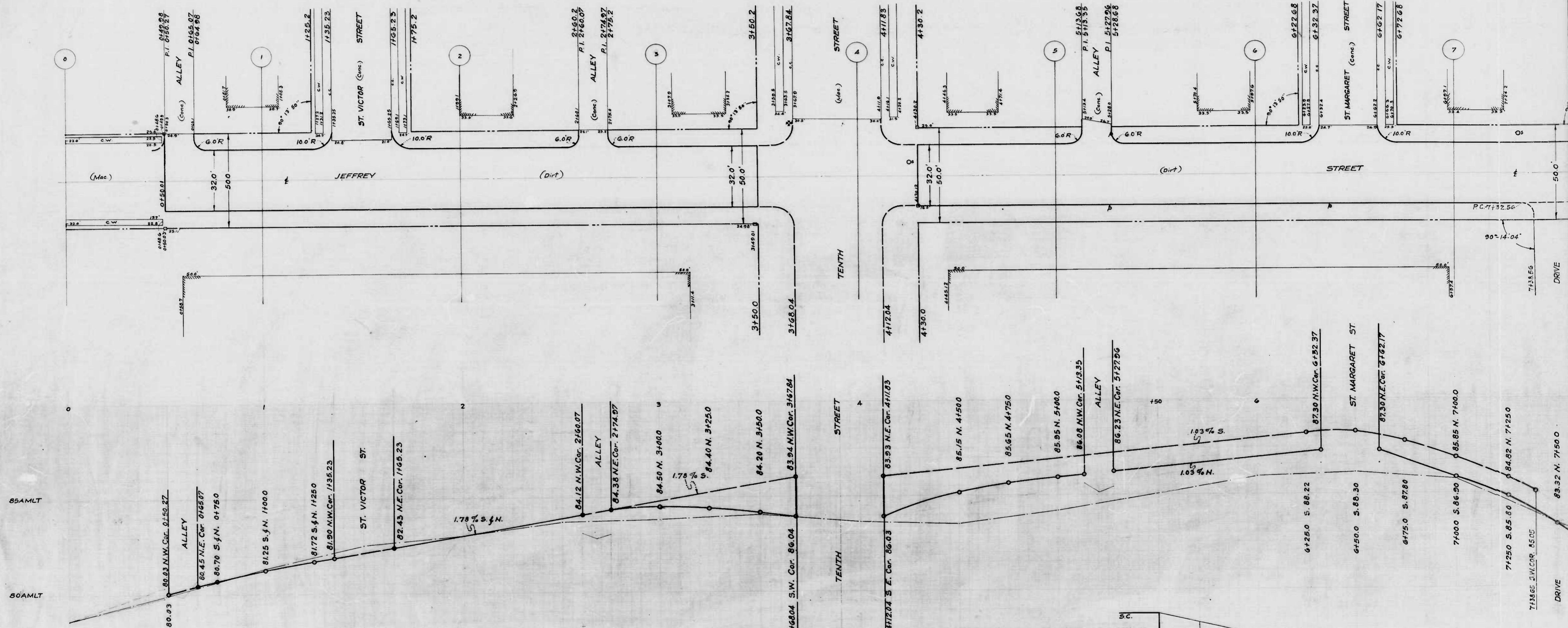

85 AMLT
80 AMLT
75 AMLT

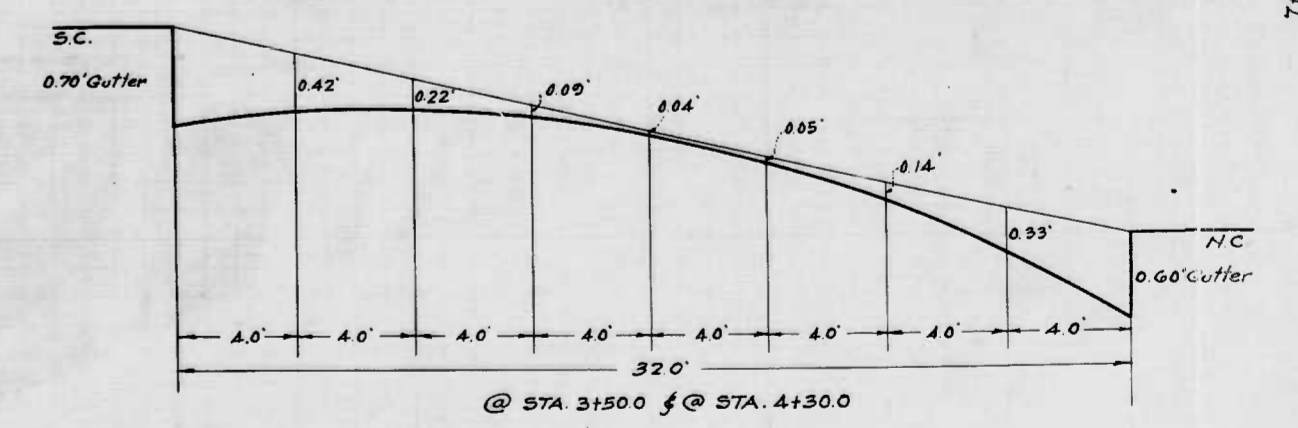
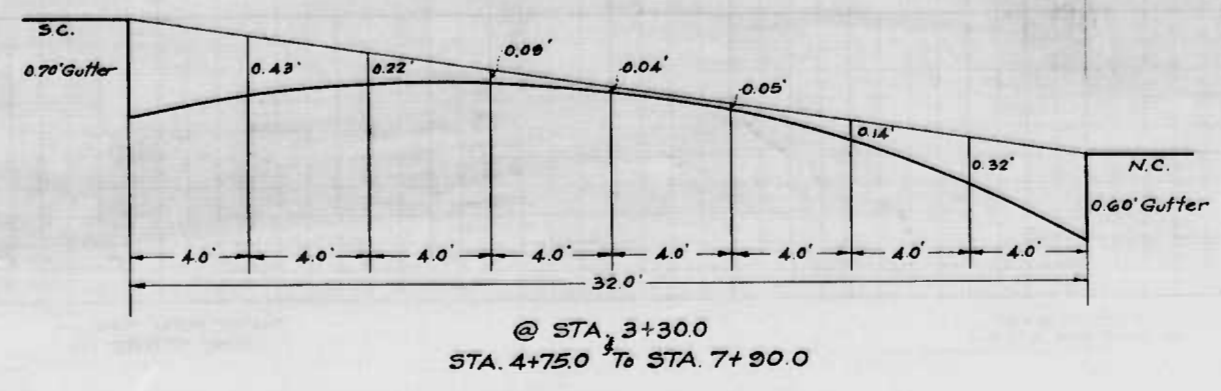
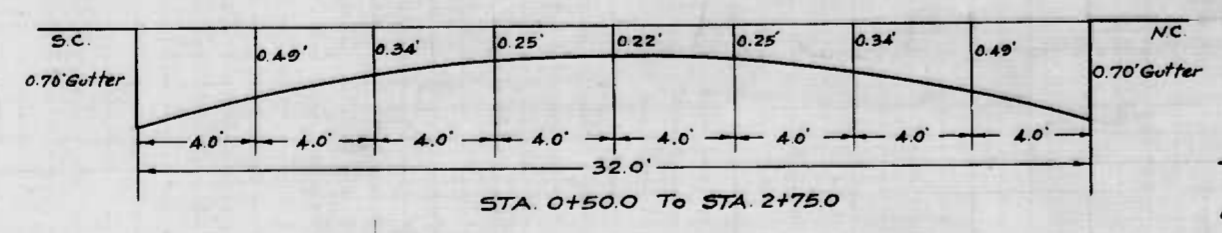

DESIGNED BY *Wm. H. Howell*
CHECKED BY *Howling*

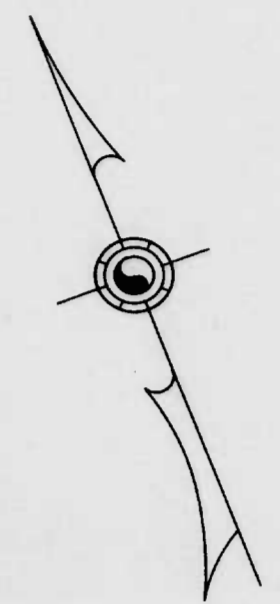
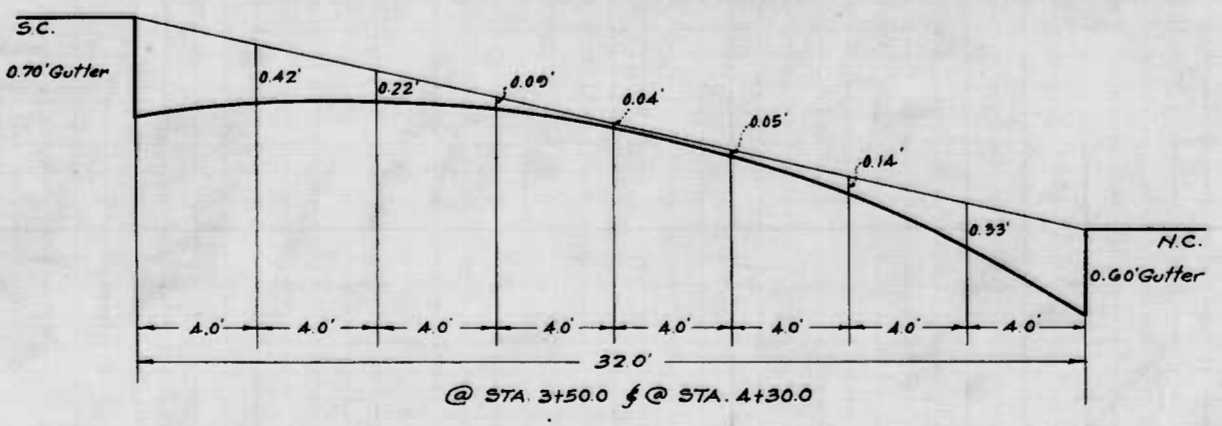
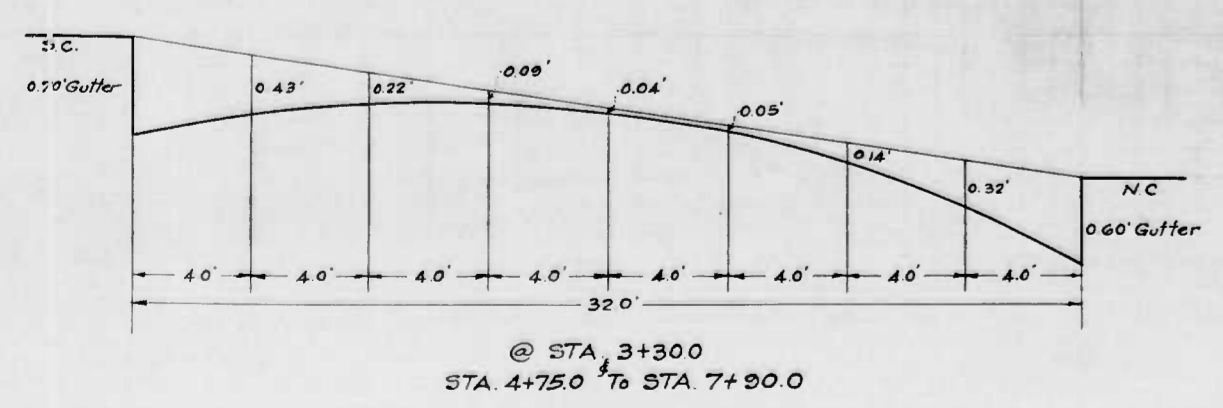
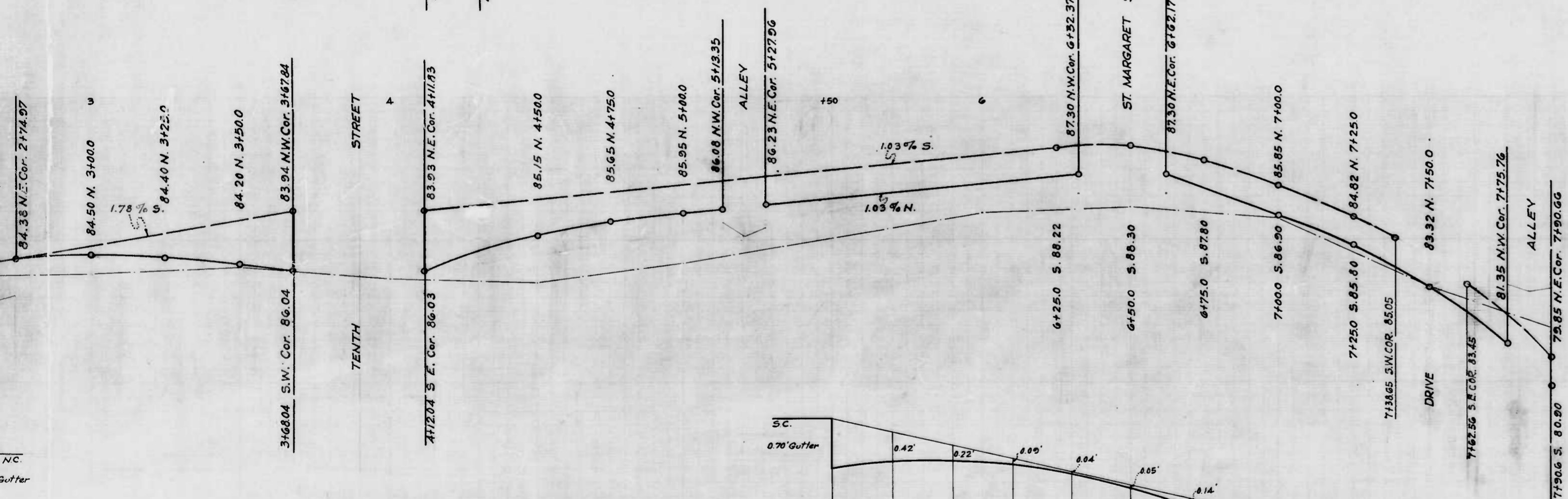
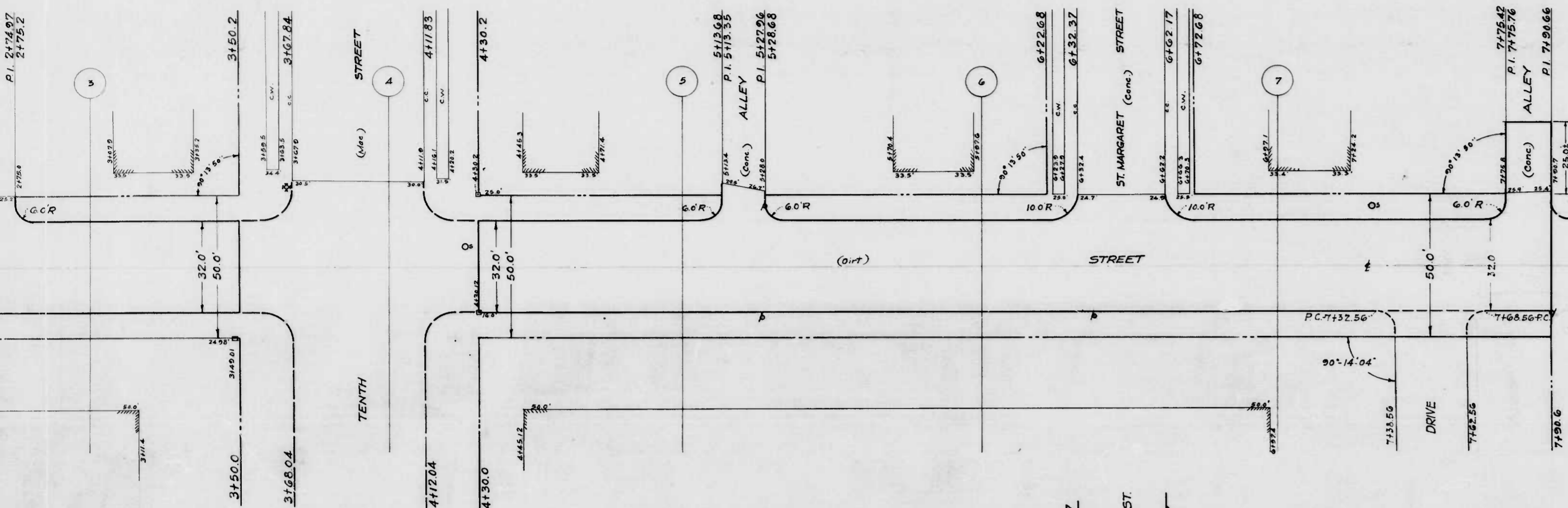

The issuance of this Plan & Profile does not Commit the City to the Acceptance and/or Improvement of any Thoroughfares shown thereon.

CITY OF BALTIMORE
 DEPARTMENT OF PUBLIC WORKS
 BUREAU OF HIGHWAYS
 PLAN & PROFILE
 JEFFREY ST. - 308' ± W. TENTH ST. - 371' ± E. TENTH ST.
 PLAN: 1" = 20.0' BOOK N° X - 171.
 SCALE: HOR: 1" = 200' DATE: AUG. 5, 1943
 PROF: VER: 1" = 2.0' CONT. N° 776

APPROVED: *W. J. [Signature]* ASSOCIATE ENGINEER
 APPROVED: *Geo. A. Carter* HIGHWAYS ENGINEER
 APPROVED: *[Signature]* ENGR. PLANS & SURVEYS
 APPROVED: *Nathan L. Smith* CHIEF ENGINEER

28-18

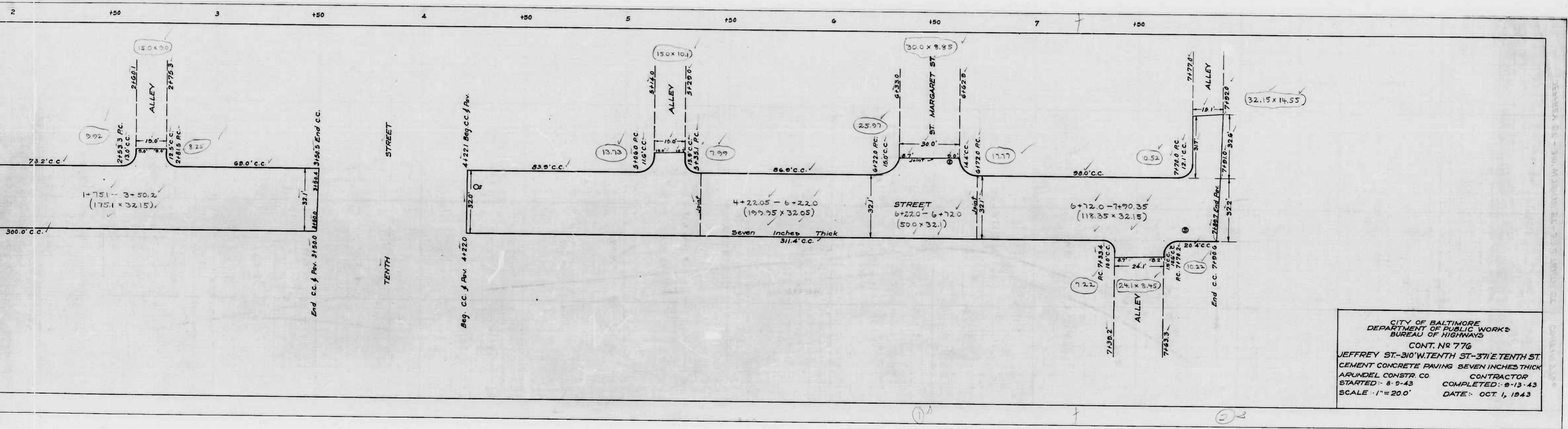

CITY OF BALTIMORE
 DEPARTMENT OF PUBLIC WORKS
 BUREAU OF HIGHWAYS
 CONT. NO. 776
 JEFFREY ST.-310' W. TENTH ST.-371' E. TENTH ST.
 CEMENT CONCRETE PAVING SEVEN INCHES THICK
 ARUNDEL CONSTR. CO. CONTRACTOR
 STARTED - 8-9-43 COMPLETED - 8-13-43
 SCALE - 1" = 20.0' DATE - OCT. 1, 1943

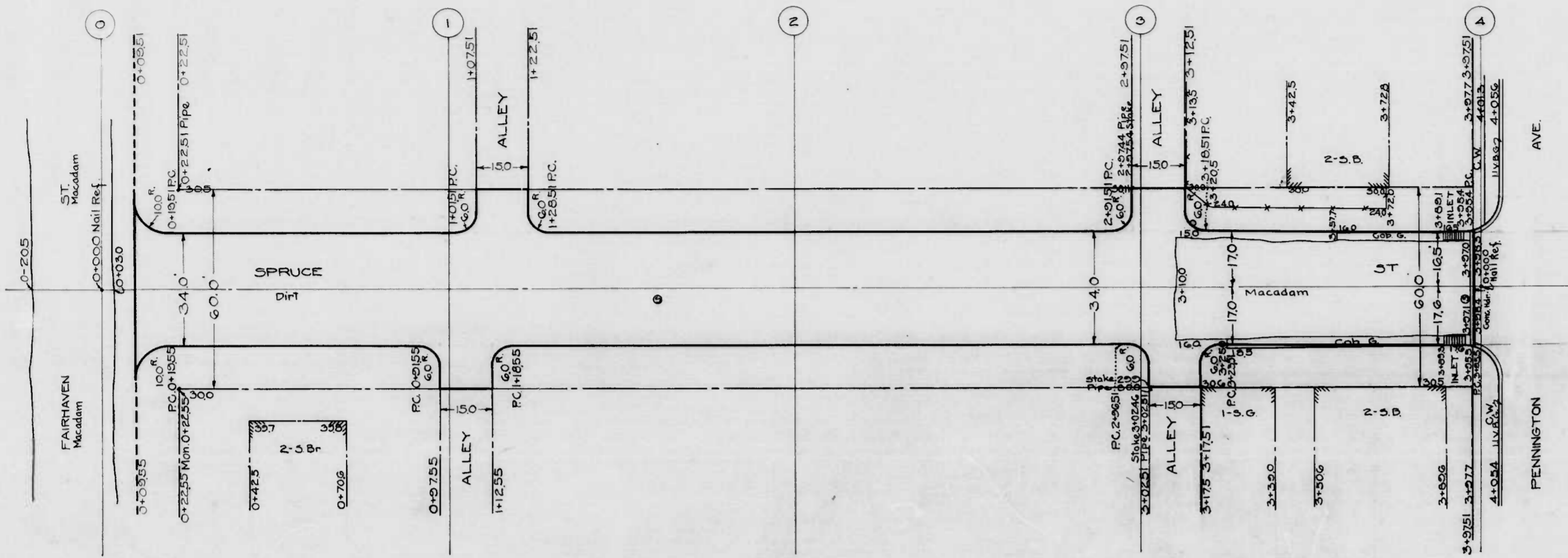

Note: The issuance of this Plan & Profile does not commit the City to the acceptance and/or improvement of any thoroughfare shown thereon.

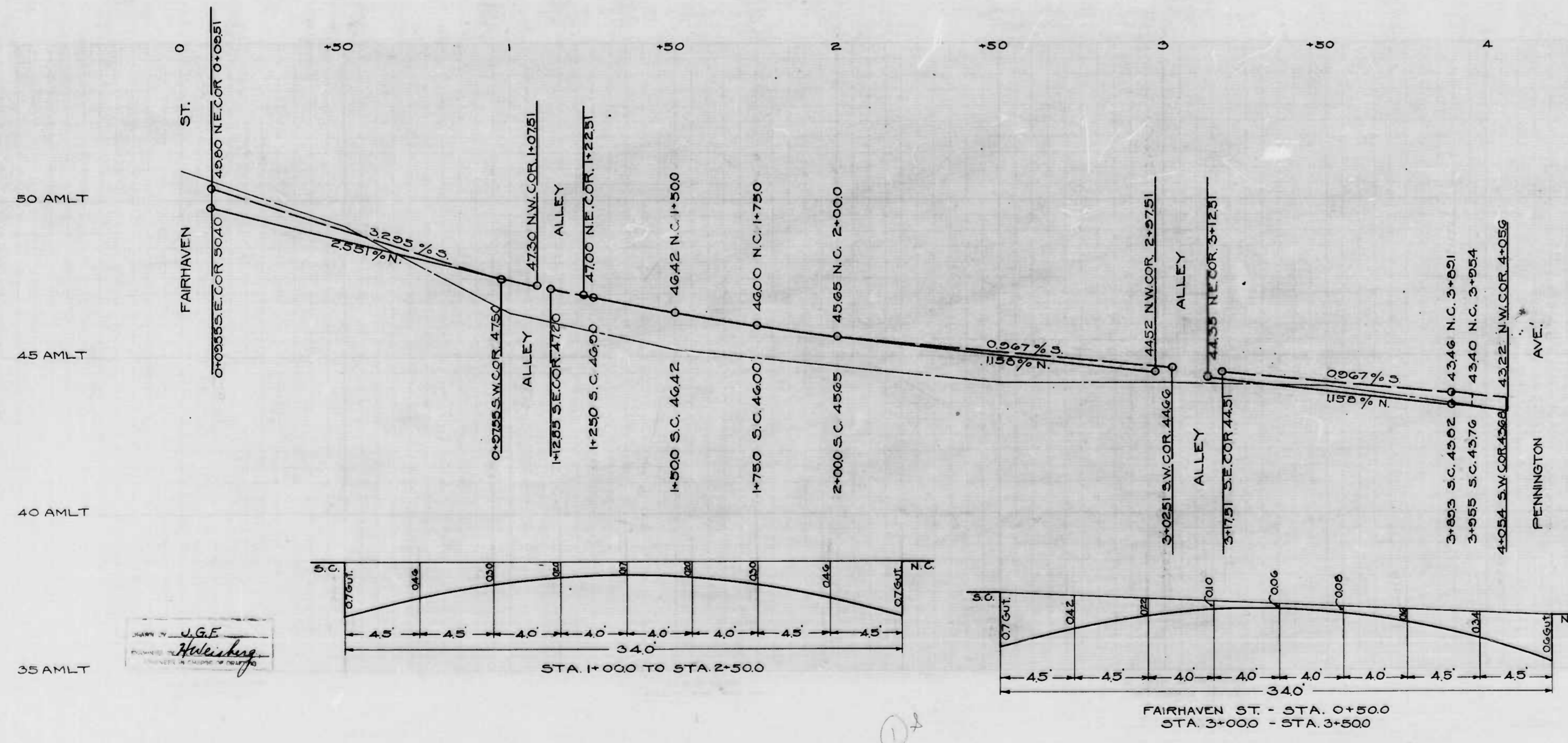

CITY OF BALTIMORE
 DEPARTMENT OF PUBLIC WORKS
 BUREAU OF HIGHWAYS
 CONTRACT NO. 776
 PLAN & PROFILE
 BOOK NO. 171

SPRUCE ST. - FAIRHAVEN ST. - PENNINGTON AVE.
 PROFILE HOR. 1"=200'
 SCALE VER. 1"=20'
 PLAN 1"=200'

MAY 15 1943

CORRECT
Edw. J. Gorman
 ASSOCIATE ENGINEER
 APPROVED

APPROVED
Gen. A. Carter
 HIGHWAYS ENGINEER
 APPROVED
James C. Call
 CHIEF ENGINEER

