

STA. 0+00 TO ELRINO ST.
 STA. 1+150 TO PUMPHREY ST.

DESIGNED BY **JESSE D. CARTER**
 DRAWN BY **H. W. HANSEN**

65 AMLT

Shot

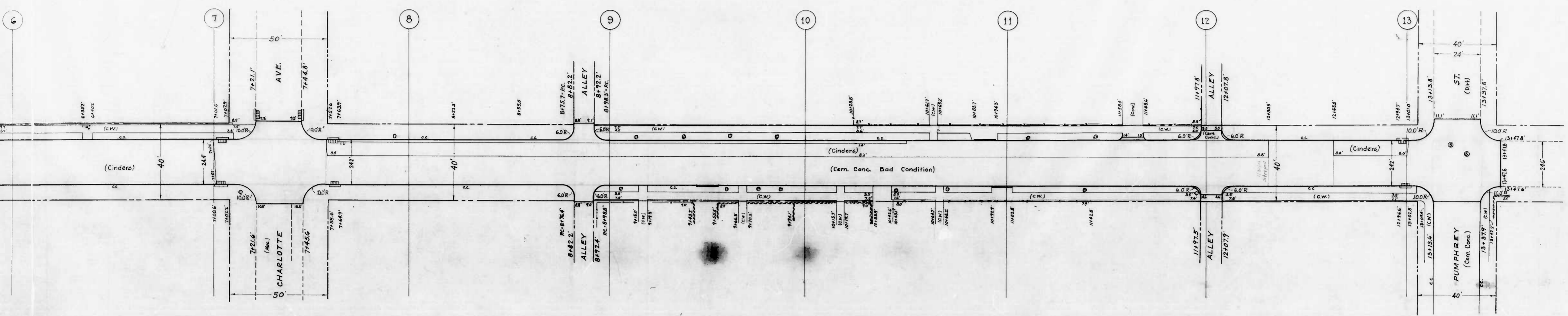

6 +50 7 +50 8 +50 9 +50 10 +50 11 +50 12 +50 13 +50

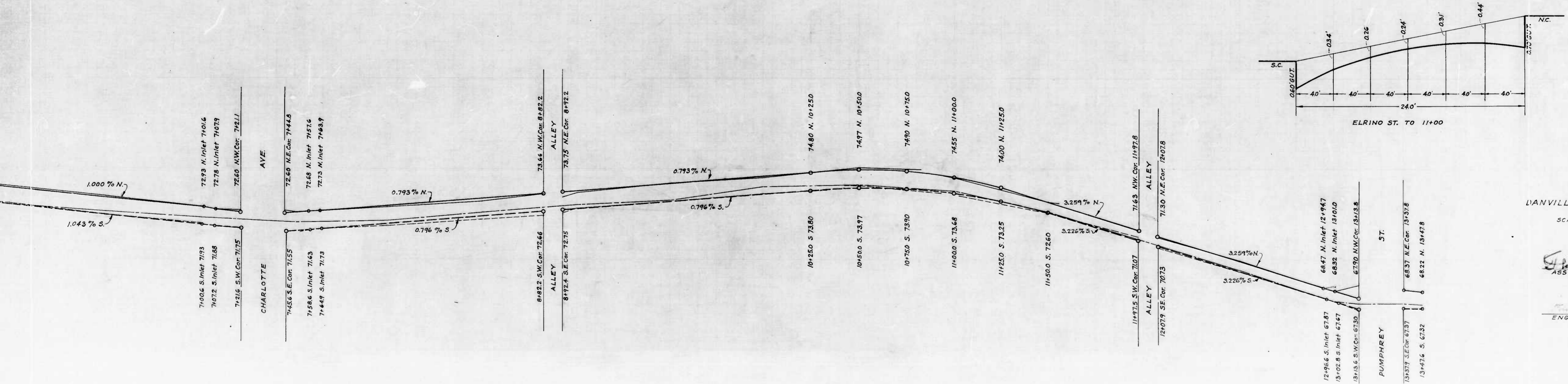

D'ANVILLE AVENUE
 SCALES
 ASSOCIATE
 ENGR-PL

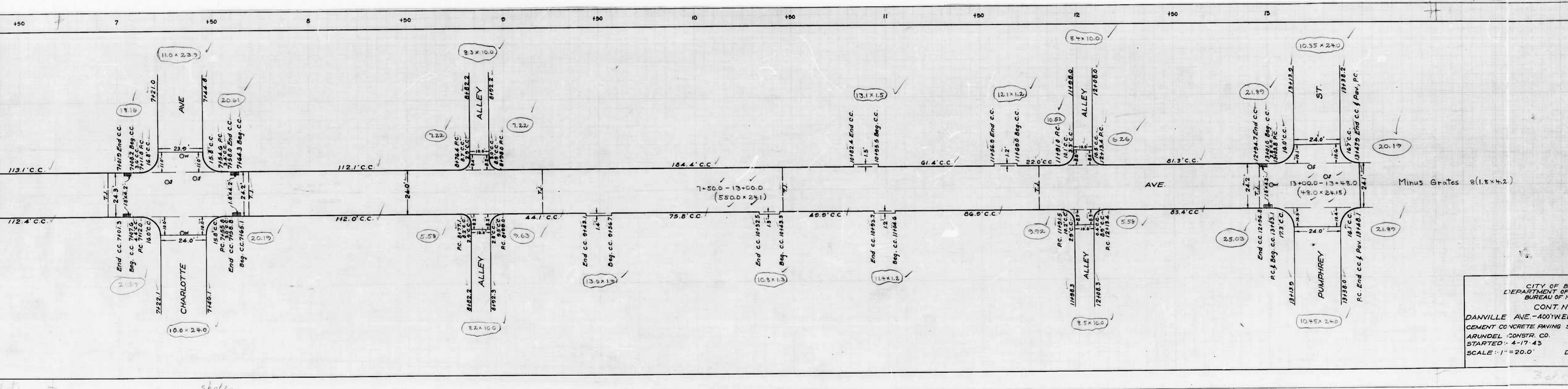

CITY OF BALTIMORE
 DEPARTMENT OF PUBLIC WORKS
 BUREAU OF HIGHWAYS
 CONT. NO. 1
 DANVILLE AVE. - 400' W. END
 CEMENT CONCRETE PAVING SE
 ARUNDEL CONSTR. CO.
 STARTED - 4-17-43
 SCALE - 1" = 20.0'

shot 2

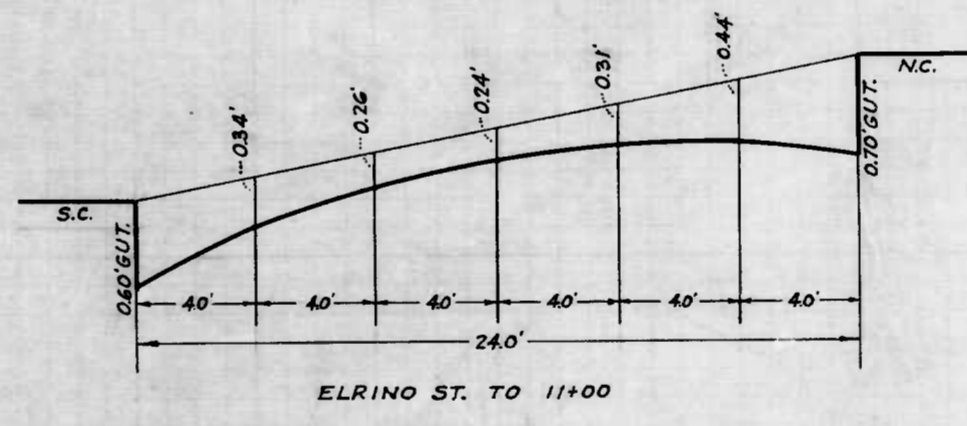
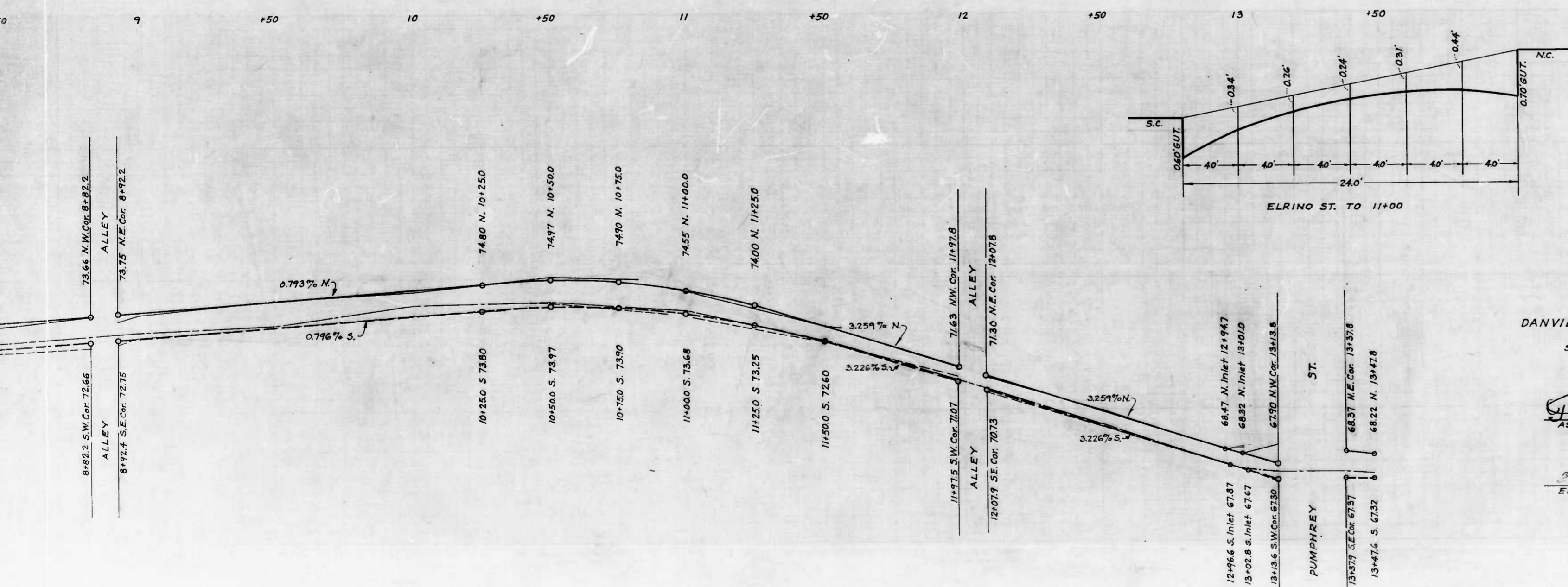
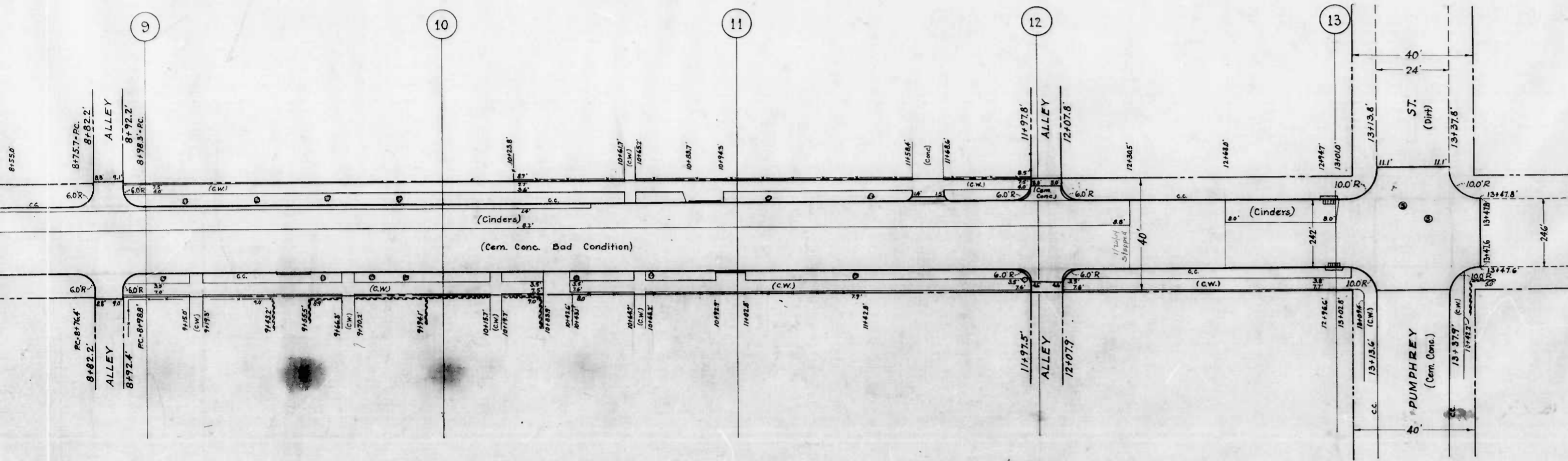

CITY OF BALTIMORE
 DEPARTMENT OF PUBLIC WORKS
 BUREAU OF HIGHWAYS
 PLAN & PROFILE
 DANVILLE AVE. - 400± W. OF ELRINO ST. - PUMPHREY ST.
 HOR. - 1" = 20'
 PROF. - VER. - 1" = 2'
 SCALES - PLAN - 1" = 20'
 BOOK NO. MISC. 52
 CONT. NO. 775
 DATE - OCT. 21, 1942

CORRECT -
Edward J. Hecker
 ASSOCIATE ENGINEER

APPROVED -
George A. Carter
 HIGHWAYS ENGINEER

APPROVED -
Edward J. Hecker
 ENGR. - PLANS & SURVEYS

APPROVED -
James Cobb
 CIVIL ENGINEER

+ shots

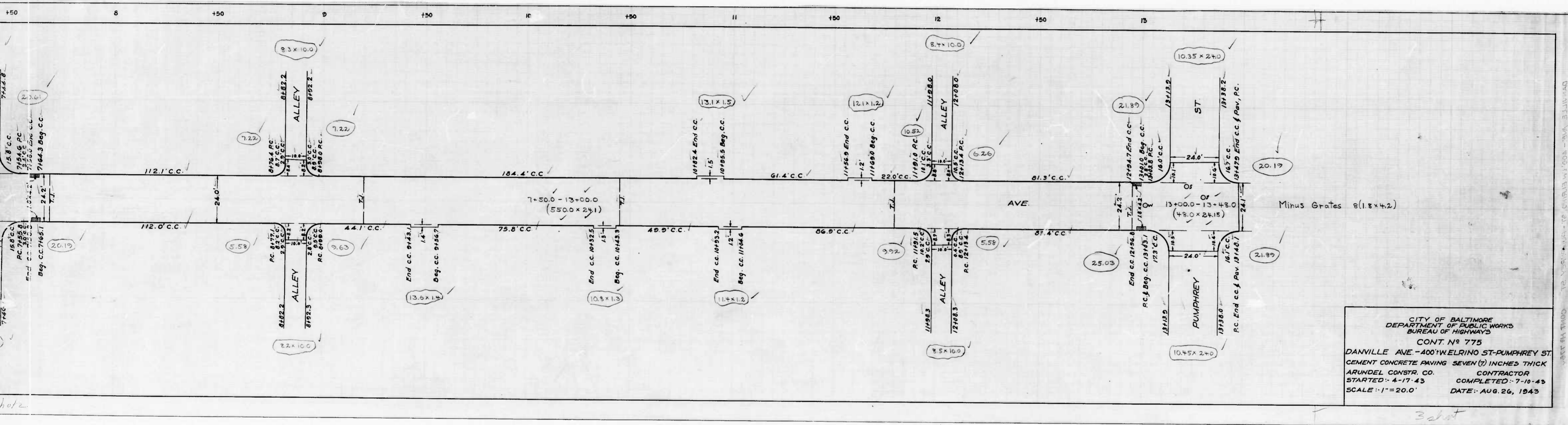

CITY OF BALTIMORE
 DEPARTMENT OF PUBLIC WORKS
 BUREAU OF HIGHWAYS
 CONT. No 775
 DANVILLE AVE. - 400' WELRINO ST-PUMPHREY ST.
 CEMENT CONCRETE PAVING SEVEN (7) INCHES THICK
 ARUNDEL CONSTR. CO. CONTRACTOR
 STARTED: 4-17-43 COMPLETED: 7-10-43
 SCALE: 1"=20.0' DATE: AUG. 26, 1943

3204

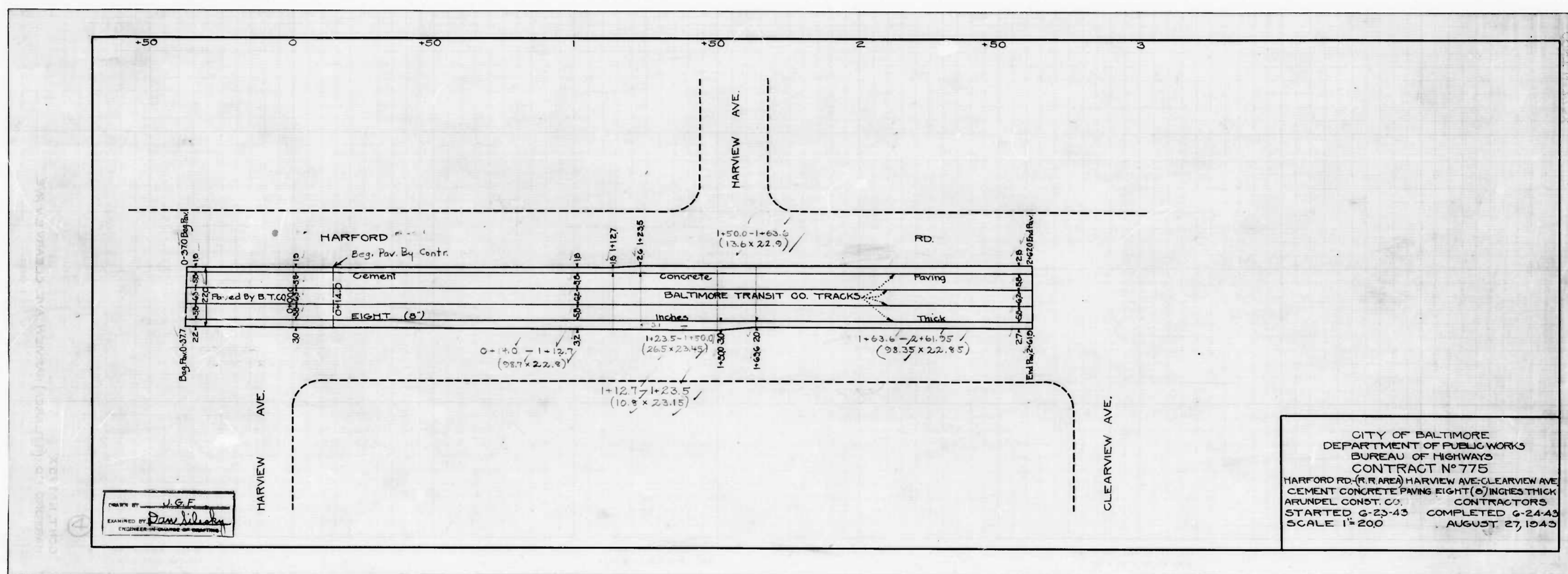

DESIGNED BY W.G.F.
 EXAMINED BY [Signature]
 ENGINEER IN CHARGE OF DISTRICT

CITY OF BALTIMORE
 DEPARTMENT OF PUBLIC WORKS
 BUREAU OF HIGHWAYS
 CONTRACT NO. 775
 HARFORD RD. (R.R. AREA) HARVIEW AVE-CLEARVIEW AVE
 CEMENT CONCRETE PAVING EIGHT (8) INCHES THICK
 ARUNDEL CONST. CO. CONTRACTORS
 STARTED 6-23-43 COMPLETED 6-24-43
 SCALE 1"=200 AUGUST 27, 1943