

NOTE - THE ISSUANCE OF THIS PLAN DOES NOT COMMIT THE CITY TO THE ACCEPTANCE AND/OR IMPROVEMENT OF ANY THOROUGHFARES SHOWN THEREON.

shot 1 + shot 2

+ shot 3

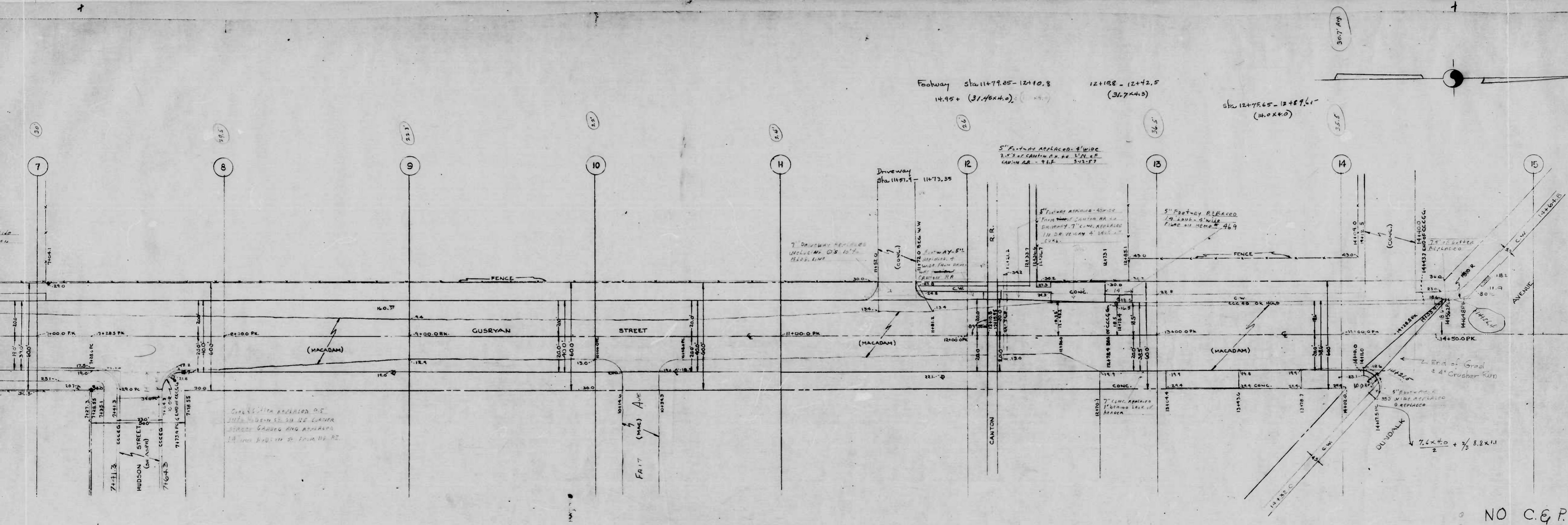

Footway Sta 11+79.85 - 12+10.8
 14.95 + (31.46x4.0)

12+10.8 - (2+42.5)
 (31.74x4.0)

Sta 12+75.65 - 12+87.61
 (14.0x4.0)

5" Footway R. PLACED 4" W/OC
 2.5" SAND
 CANON R.R. - 9.6E - 5.23-27

7" DRIVEWAY REPAIRED
 UNIFORM DS 10" W
 REPAIR LINE

5" Footway R. PLACED
 1.4" SAND - 9" W/OC
 FINE SAND MEMO # 469

Check with approval of
 the design to be done
 street grade and repairs
 in the radius of 100 ft.

- 0 NO C.E.P.
- 1 NO MECH. ELECT.
- 2 NO GAS CO
(GAS DUCT)

SEPT 17, 1956

shot + shot-

+ shots

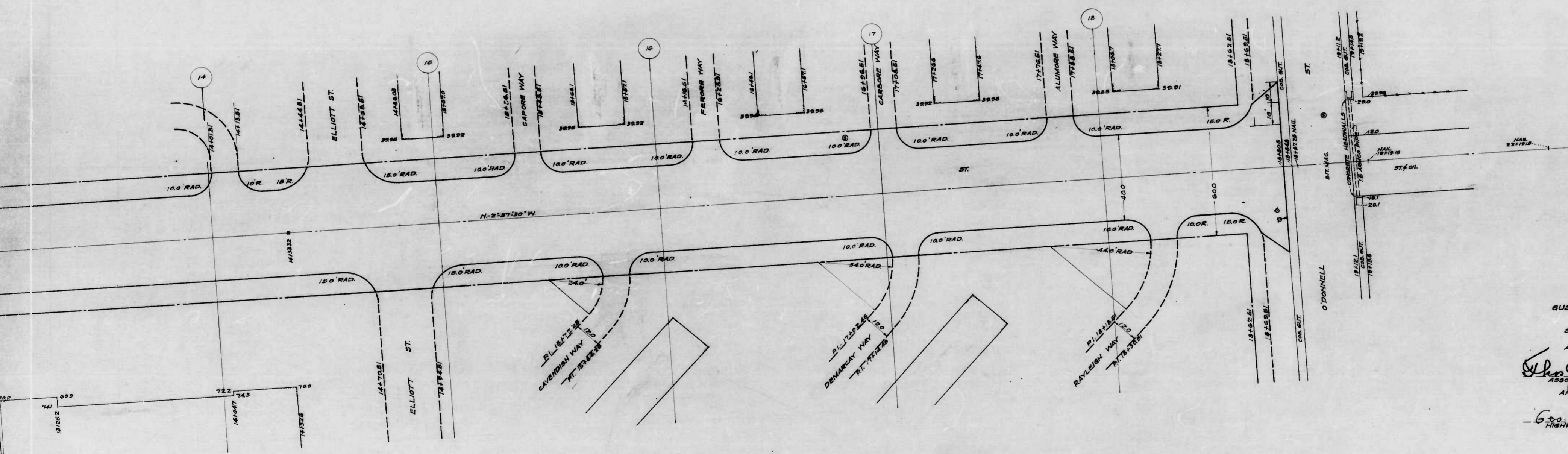
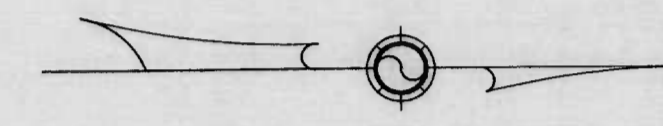

CITY OF BALTIMORE
 DEPARTMENT OF PUBLIC WORKS
 BUREAU OF HIGHWAYS
 LAYOUT OF
 GUSRYAN ST. - CARDIFF AVE. TO O'DONNELL ST.
 CONT. NO. 773

SCALE 1" = 200'

NOV. 12, 1942
 BOOK NO. 773

APPROVED: *Edw. J. Gorman* ASSOCIATE ENGINEER
 APPROVED: *Edward J. Hasner* ENGR. PLANS & SURVEYS

APPROVED: *Geo. H. Carter* HIGHWAYS ENGINEER
 APPROVED: *George Colby* CHIEF ENGINEER

+ shots

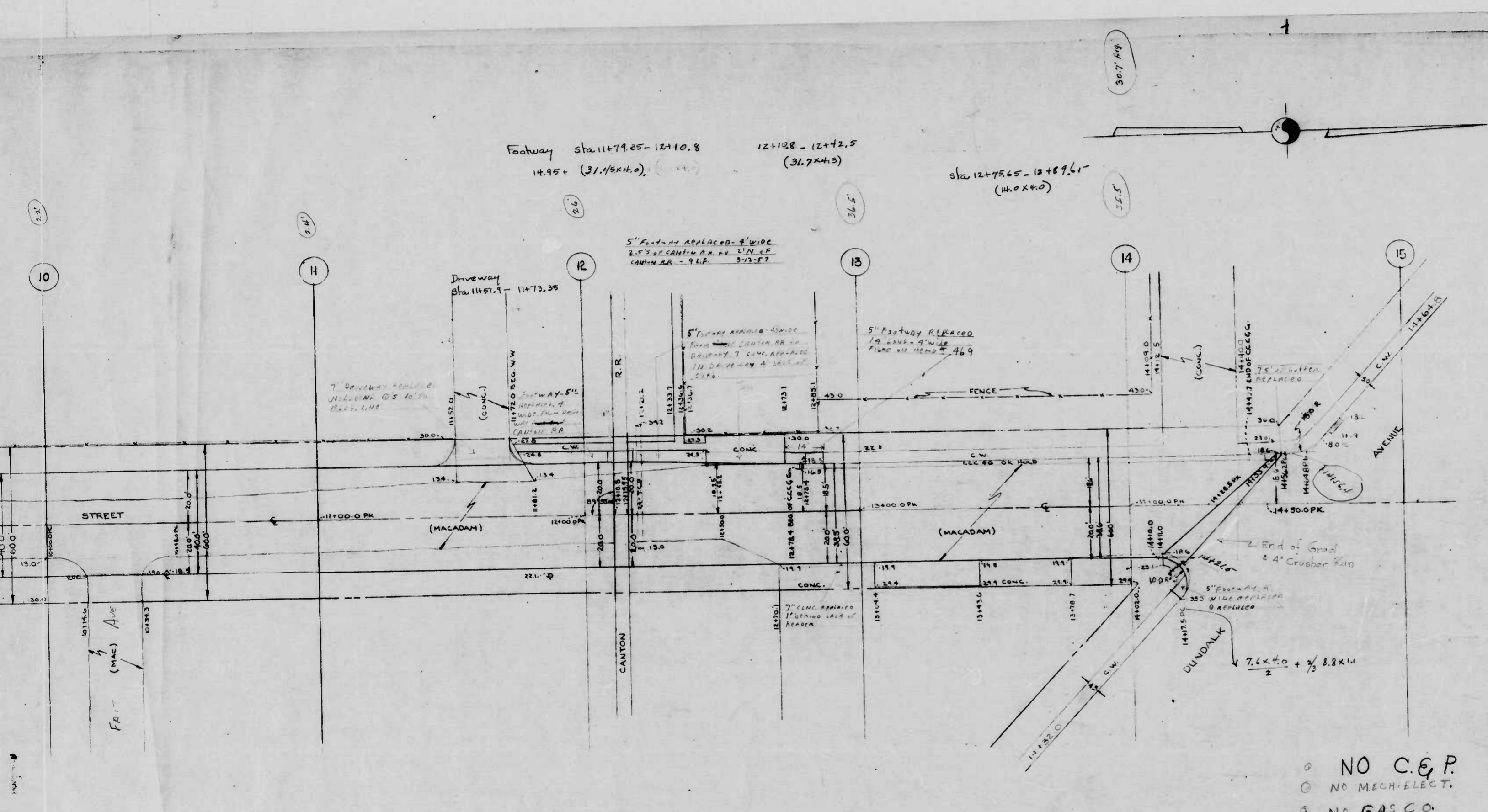

NOTE: OBSTRUCTIONS ARE SHOWN ON THIS DRAWING FOR THE CONVENIENCE OF THE CONTRACTOR ONLY, AND THE CITY DOES NOT WARRANT OR GUARANTEE THE CORRECTNESS OR THE EXHAUSTIVENESS OF THE INFORMATION GIVEN. THE CONTRACTOR MUST VERIFY ALL SUCH INFORMATION TO HIS OWN SATISFACTION.

NOTE: THE OFFSET DIMENSIONS SHOWN ON THIS PLAN ARE MEASURED FROM THE BASE LINE OR FROM THE CENTER LINE OF THE STREET TO THE NEAREST OUTSIDE EDGE OR FACE OF ALL STRUCTURES, TREES, POLES, LIGHTS, MANHOLES, FIRE HYDRANTS, ETC. UNLESS INDICATED OTHERWISE.

THE ISSUANCE OF THIS PLAN DOES NOT COMMIT THE CITY TO THE ACCEPTANCE AND OR IMPROVEMENT OF ANY THROUGHFARE SHOWN HEREON.

SHEET ASPHALT CONTRACT No 1418
 To be Sheet Asphalt Pavement, one (1) inch of Sheet Asphalt Wearing Surface, one (1) inch of Asphaltic Concrete Binder on a flexible type base consisting of a penetration macadam course three (3) inches in depth when compacted, on a water-bound macadam course four (4) inches in depth when compacted.

CITY OF BALTIMORE
 DEPARTMENT OF PUBLIC WORKS
 BUREAU OF HIGHWAYS
 PLAN
 GUSRYAN ST. - O'DONNELL ST. - DUNDALK AVE.

SCALE: 1" = 200'
 BOOK X-381
 CONT. 1418
 SEPT 3, 1956

- 0 NO C.E.P.
- 0 NO MECH. ELECT.
- 3 NO GAS CO. (GAIN DUCT)

SEPT 17, 1956

+ shots

APPROVED:
Henry Weisberg
 PRINCIPAL ENGINEER
 APPROVED:
James C. Hunt
 ENGR. OF SURVEYS

APPROVED:
 HIGHWAYS ENGINEER
 APPROVED:
George A. Carter
 DIRECTOR OF PUBLIC WORKS

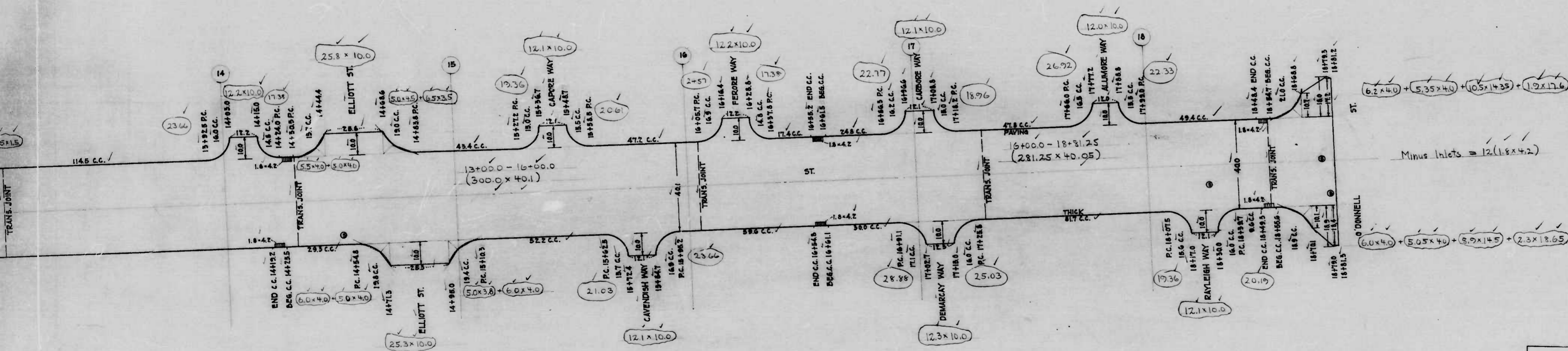

CITY OF BALTIMORE
 DEPARTMENT OF PUBLIC WORKS
 BUREAU OF HIGHWAYS
 CONT. NO. 773
 GUSRYAN ST. - CARDIFF AVE. TO O'DONNELL ST.
 CEM. CONC. PAV. EIGHT INCHES THICK
 PARAMOUNT CONST. CO., INC. CONTRACTOR
 STARTED - 6-12-45 COMP. - 9-13-45
 SCALE - 1" = 200' DATE - 10-1-45

GUSRYAN ST. - CARDIFF AVE. TO O'DONNELL ST.
 CONT. NO. 773

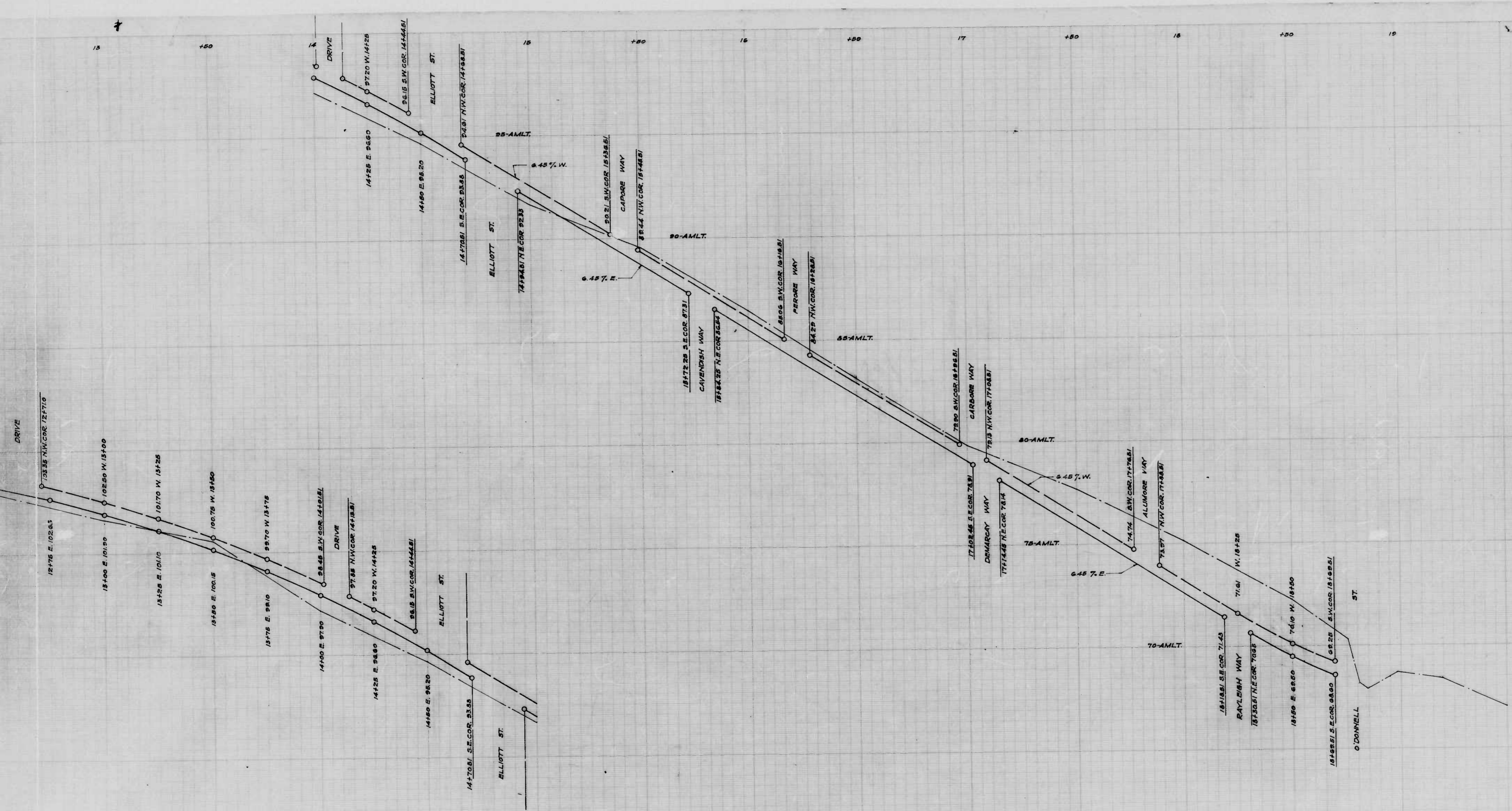

CITY OF BALTIMORE
 DEPARTMENT OF PUBLIC WORKS
 BUREAU OF HIGHWAYS
 ESTABLISHED GRADES OF
 GUBRYAN ST.- CARDIFF AVE. TO O'DONNELL ST.
 CONT. NO. 773
 SCALES - HOR. - 1" = 200'
 VER. - 1" = 20'
 NOV. 15, 1942
 BOOK NO. C-773
 APPROVED -
Edwin J. Keppeler
 ASSOCIATE ENGINEER
 APPROVED -
Edwin J. Keppeler
 CHIEF ENGINEER
 APPROVED -
Wm. A. Carter
 HIGHWAYS ENGINEER
 APPROVED -
Wm. A. Carter
 CHIEF ENGINEER

+ shot 3

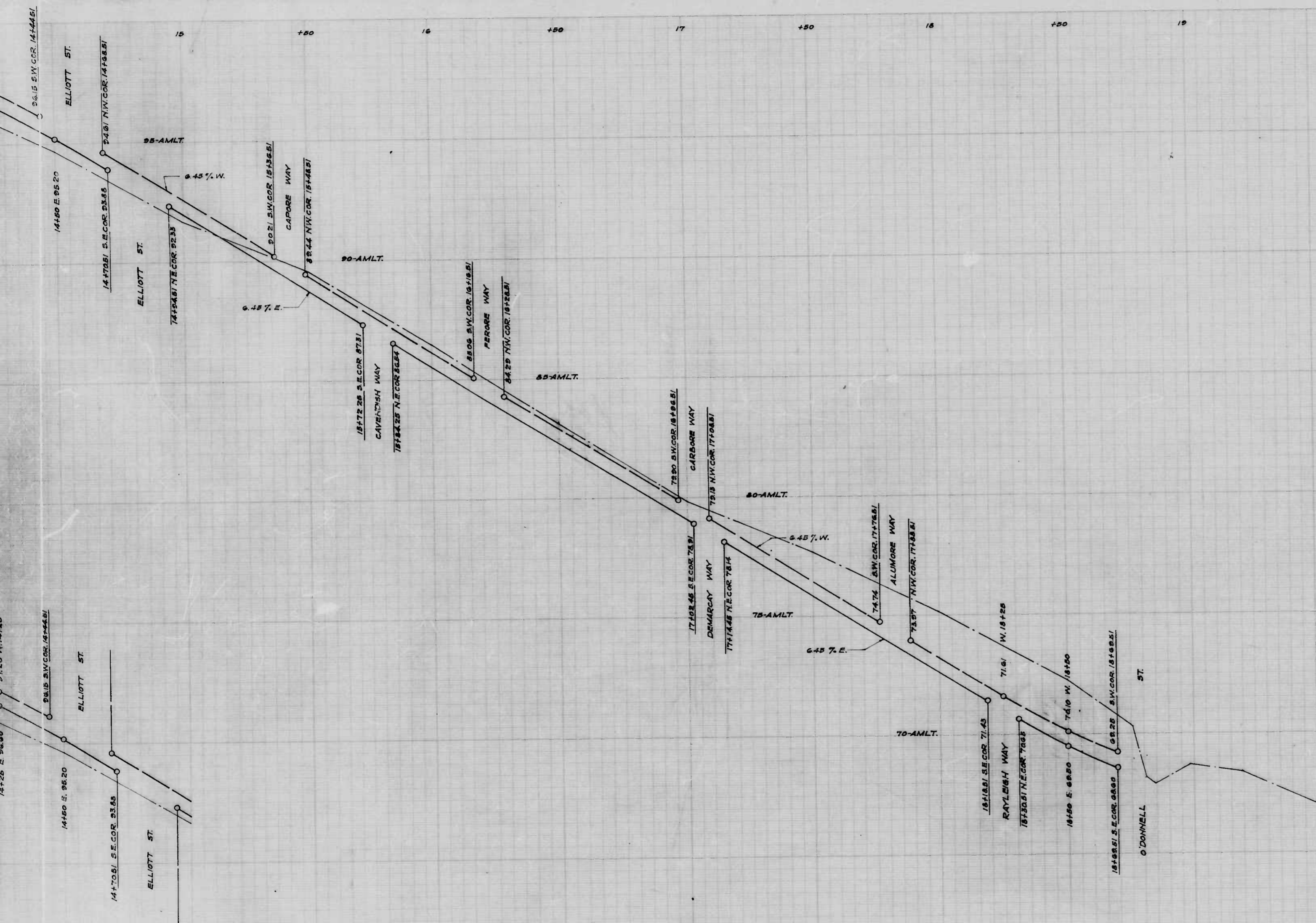

CITY OF BALTIMORE
 DEPARTMENT OF PUBLIC WORKS
 BUREAU OF HIGHWAYS
 ESTABLISHED GRADE OF
 GUBRYAN ST. - CARDIFF AVE. TO O'DONNELL ST.
 CONT. NO. 773
 HAY 16, 1942
 BOOK NO. C-773

APPROVED: *Edmund Stuckey* CHIEF ENGINEER
 ASSOCIATE ENGINEER
 APPROVED: *James Call* CHIEF ENGINEER
 ASSISTANT ENGINEER

4 sheets

1449 7

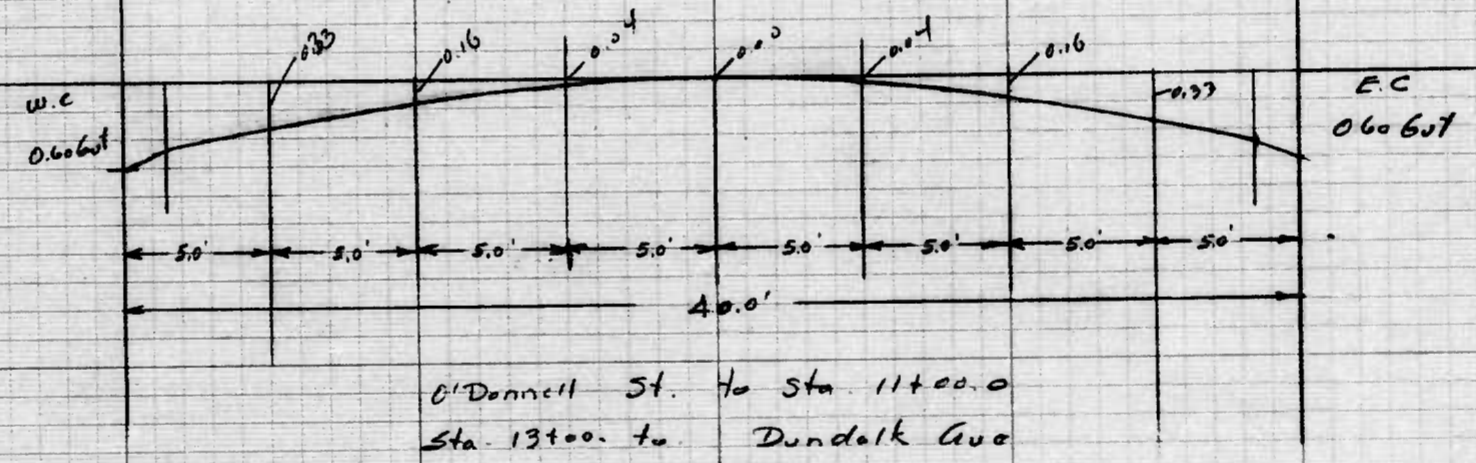
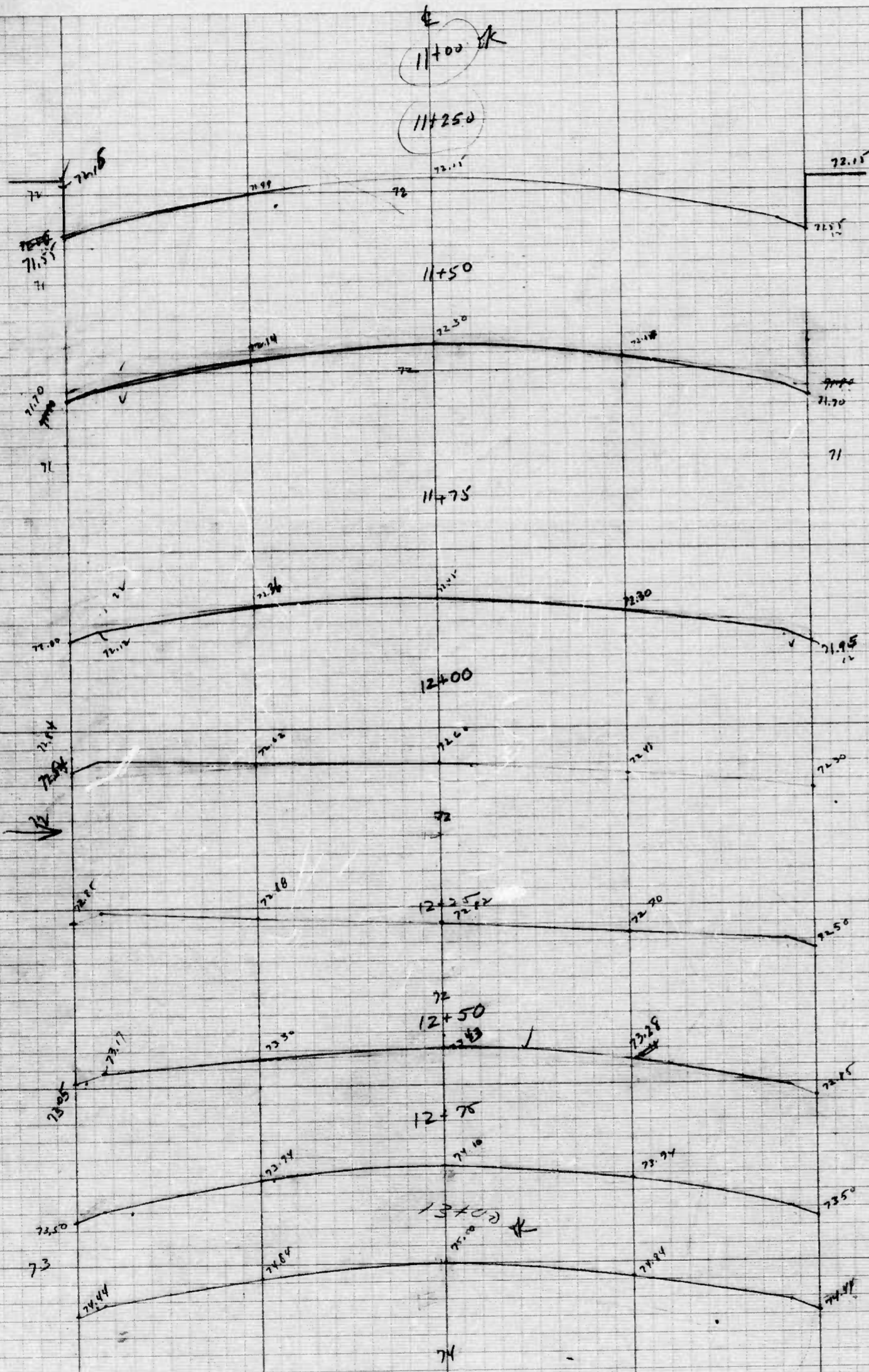

(Gosryan St)

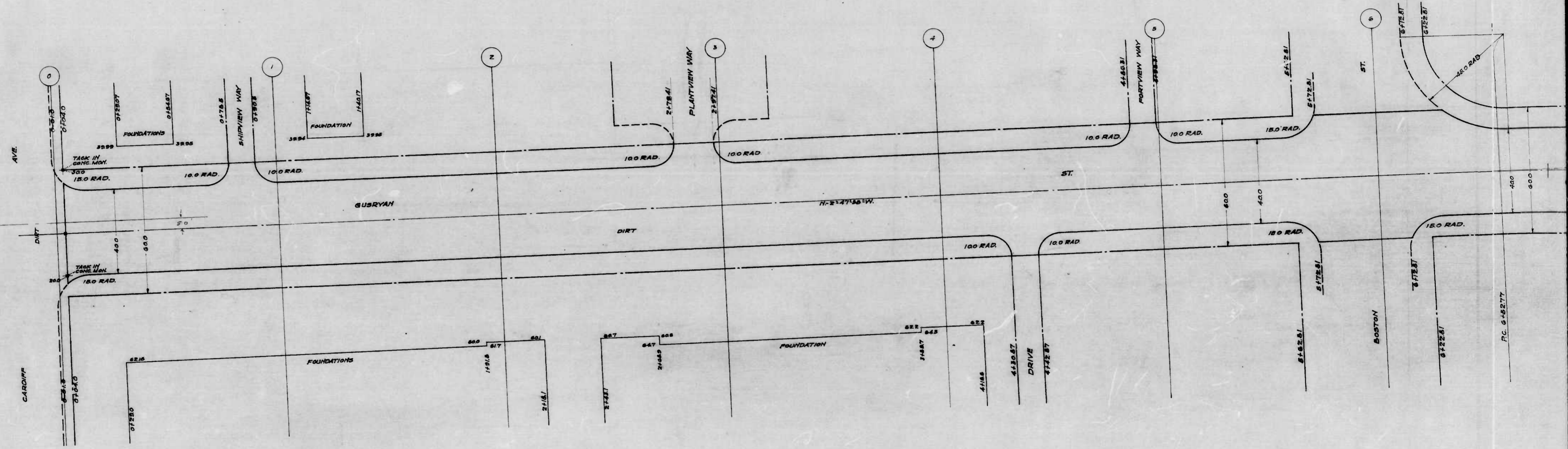

DESIGNED BY *J. H. HADEN*
DRAWN BY *H. H. HADEN*
ENGINEER IN CHARGE OF PROJECT

shot 1 + shot 2

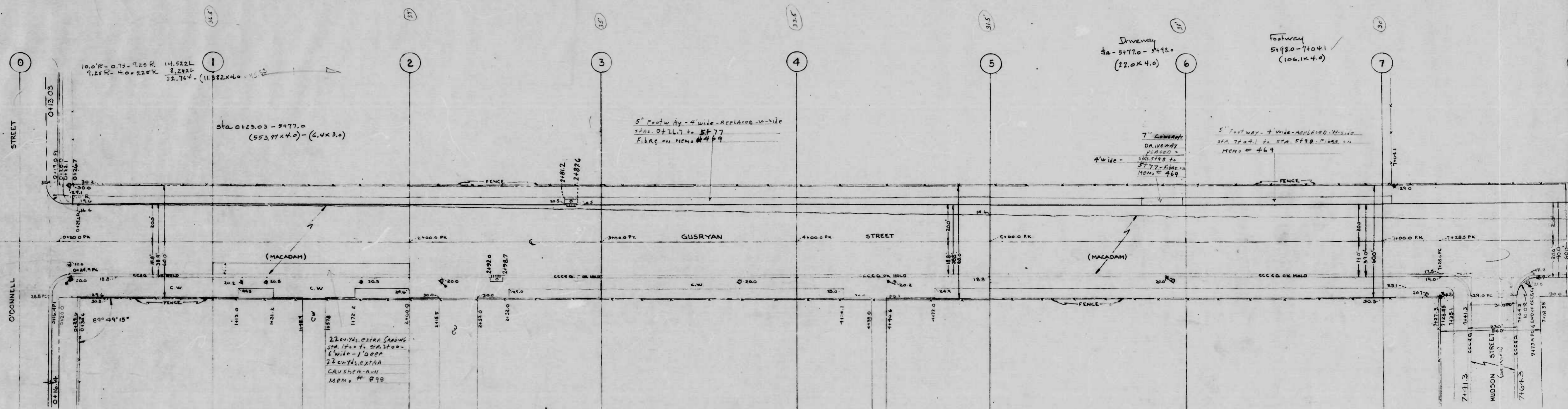

shot 1 + shot 2

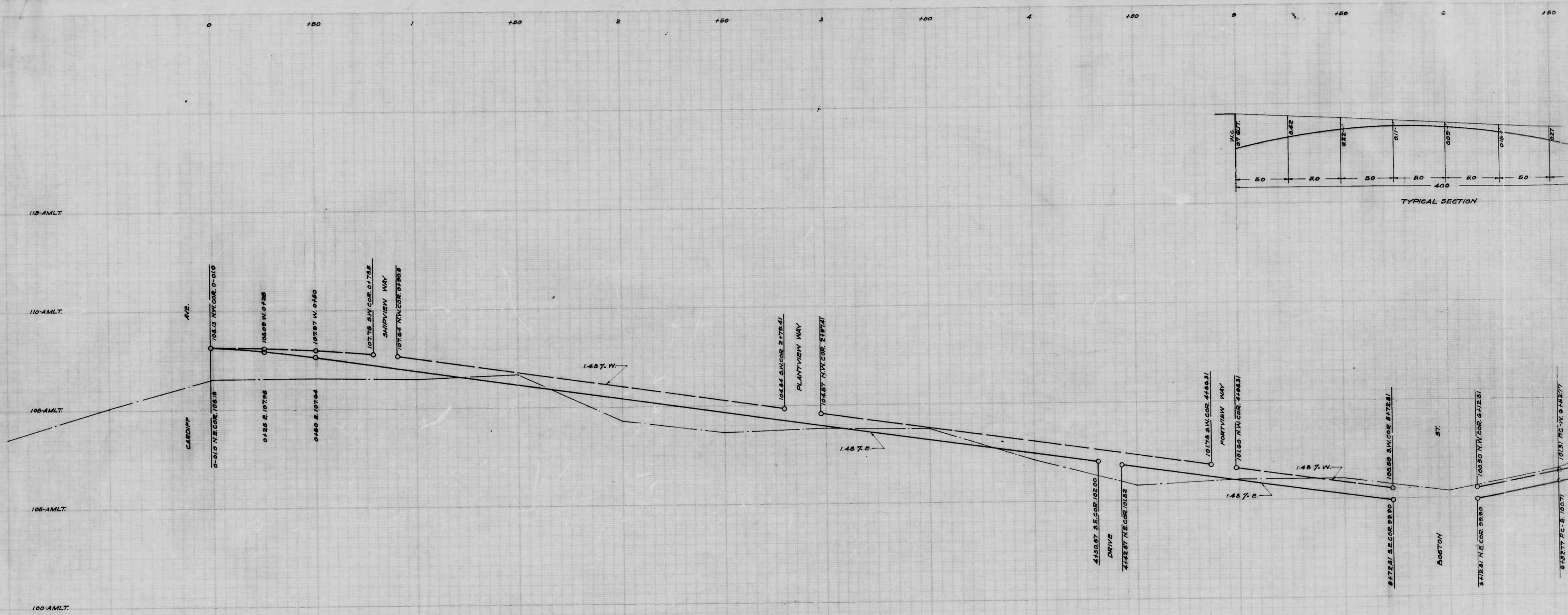

SHEETS 773-1 THROUGH 773-10

DRAWN BY *J. J. Hendricks*
 CHECKED BY *Stevenson*
 ENGINEER IN CHARGE OF SHEET

shot 1 + shot 2

+50 +60 +70 +80 +90 +100 +110 +120 +130 +140

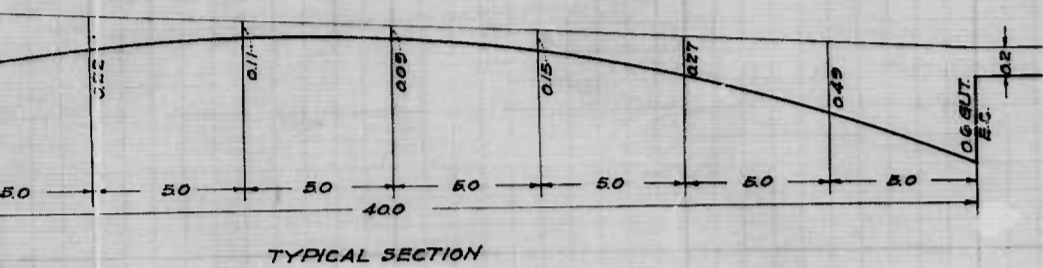

NOTE - THE ISSUANCE OF THIS PROFILE DOES NOT COMMIT THE CITY TO THE ACCEPTANCE AND/OR IMPROVEMENT OF ANY THOROUGHFARES SHOWN THEREON.

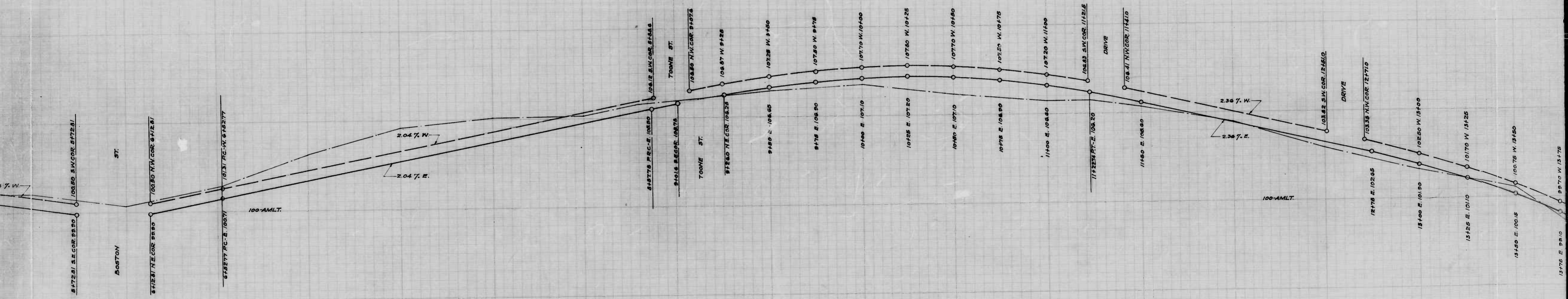

shot 3