

NOTE:-  
 THE ISSUANCE OF THIS PLAN DOES NOT  
 COMMIT THE CITY TO THE ACCEPTANCE AND/OR  
 IMPROVEMENT OF ANY THOROUGHFARE SHOWN  
 THEREON.

CITY OF BALTIMORE  
 DEPARTMENT OF PUBLIC WORKS  
 BUREAU OF HIGHWAYS  
 PLAN OF  
 41ST ST - ARGONNE DRIVE - ELLERSLIE AVE.  
 SCALE - 1"=200' AUG 11, 1942  
 BOOK N° X-146 CONT. N° 771

CORRECT:-  
*W. J. [Signature]*  
 ASSOCIATE ENGINEER

APPROVED:-  
*W. J. [Signature]*  
 ENGR PLANS & SURVEYS.

APPROVED:-  
*E. J. [Signature]*  
 HIGHWAYS ENGINEER

APPROVED:-  
*James C. [Signature]*  
 CHIEF ENGINEER.

Drawn by: Morley  
 Examined by: *[Signature]*  
 ENGINEER IN CHARGE OF CITY



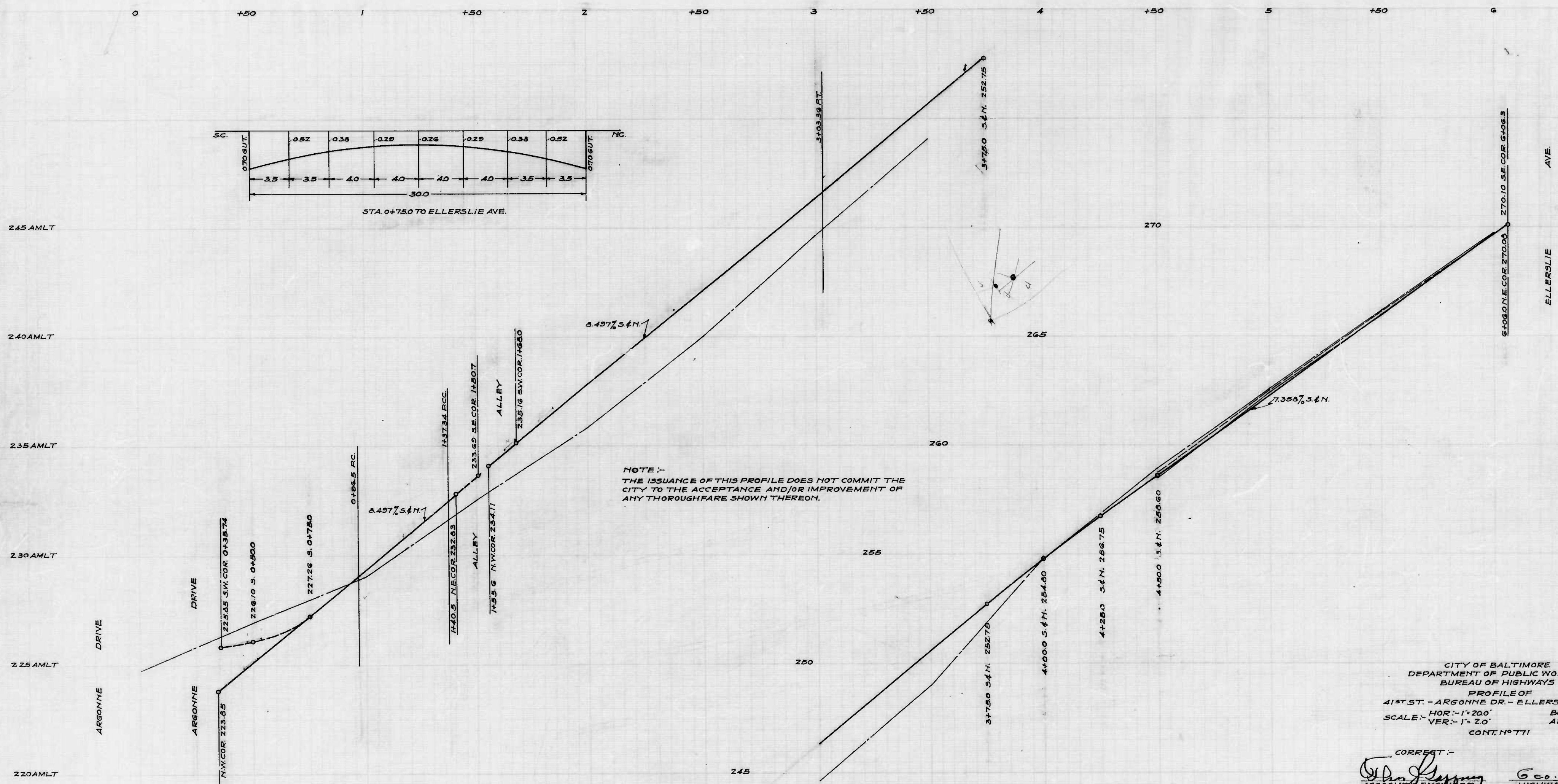

NOTE: -  
 THE ISSUANCE OF THIS PROFILE DOES NOT COMMIT THE  
 CITY TO THE ACCEPTANCE AND/OR IMPROVEMENT OF  
 ANY THOROUGHFARE SHOWN THEREON.

CITY OF BALTIMORE  
 DEPARTMENT OF PUBLIC WORKS  
 BUREAU OF HIGHWAYS  
 PROFILE OF  
 41<sup>ST</sup> ST. - ARGONNE DR. - ELLERSLIE AVE.  
 SCALE - HOR: - 1" = 20.0'      BOOK NO. X-146  
 VER: - 1" = 2.0'                      AUG. 27, 1942  
 CONT. NO. 771

CORRECT: -  
*W.D. Perry*  
 ASSOCIATE ENGINEER

APPROVED: -  
*Geo. F. Carter*  
 HIGHWAYS ENGINEER

APPROVED: -  
*Edward H. ...*  
 ENGR. - PLANS & SURVEYS

APPROVED: -  
*Raymond Collier*  
 CHIEF ENGINEER

DESIGNED BY: Marley  
 DRAWN BY: *W. ...*  
 ENGINEER IN CHARGE OF DIV.



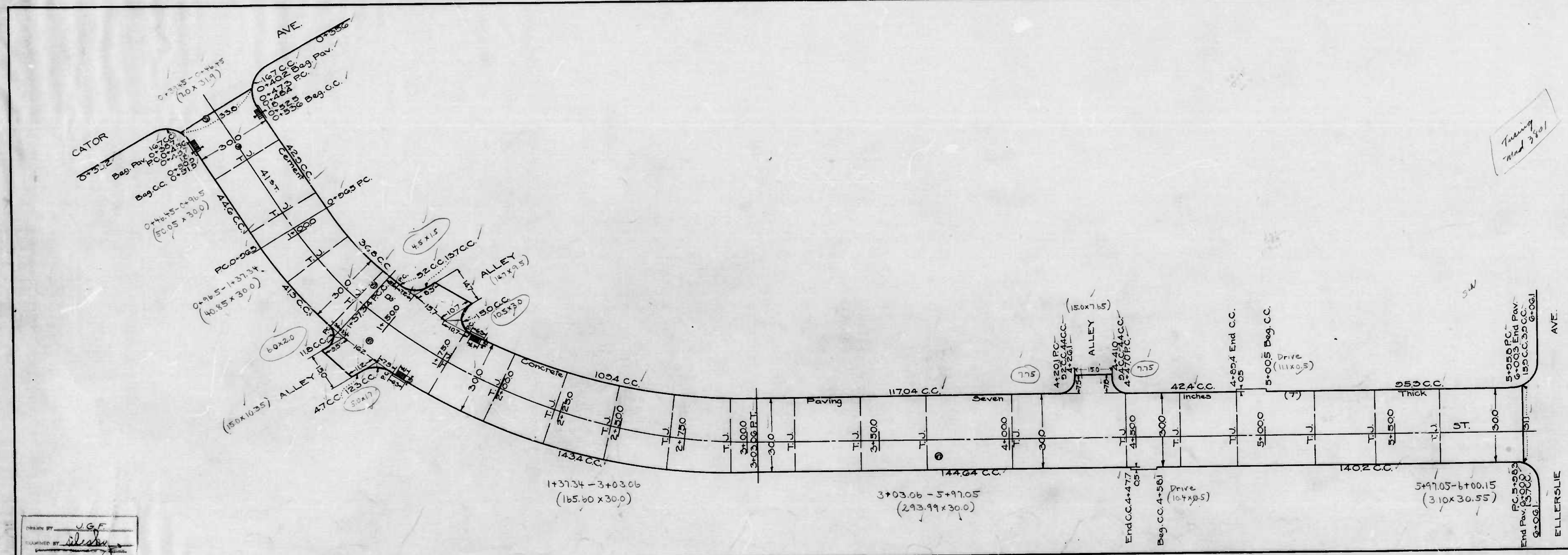

DRAWN BY J.G.F.  
 CHECKED BY [Signature]

CITY OF BALTIMORE  
 DEPARTMENT OF PUBLIC WORKS  
 BUREAU OF HIGHWAYS  
 CONTRACT NO. 771  
 41ST ST. - CATOR AVE. - ELLERSLIE AVE.  
 Cement Concrete Paving Seven Inches (7'') Thick  
 Started 10-10-42 Completed 10-25-42  
 ARUNDEL CONST. CO. CONTRACTORS  
 Scale 1" = 200 January 5, 1943



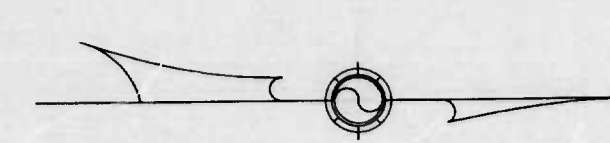
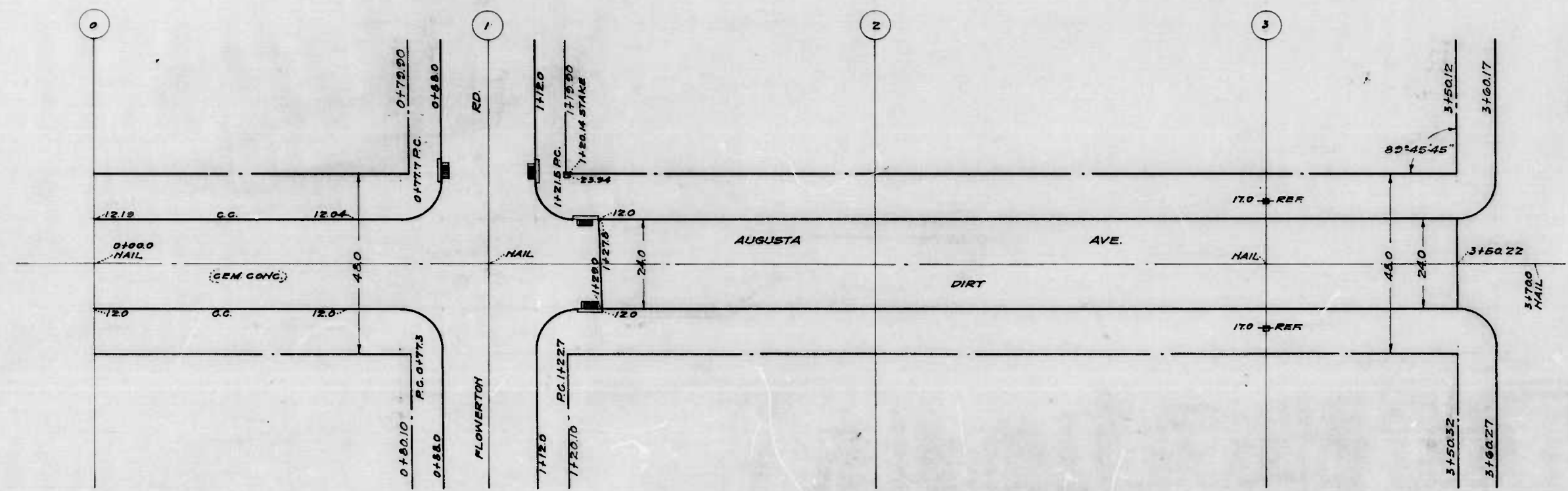

NOTE - THE ISSUANCE OF THIS PLAN & PROFILE DOES NOT COMMIT THE CITY TO THE ACCEPTANCE AND/OR IMPROVEMENT OF ANY THOROUGHFARES SHOWN THEREON.

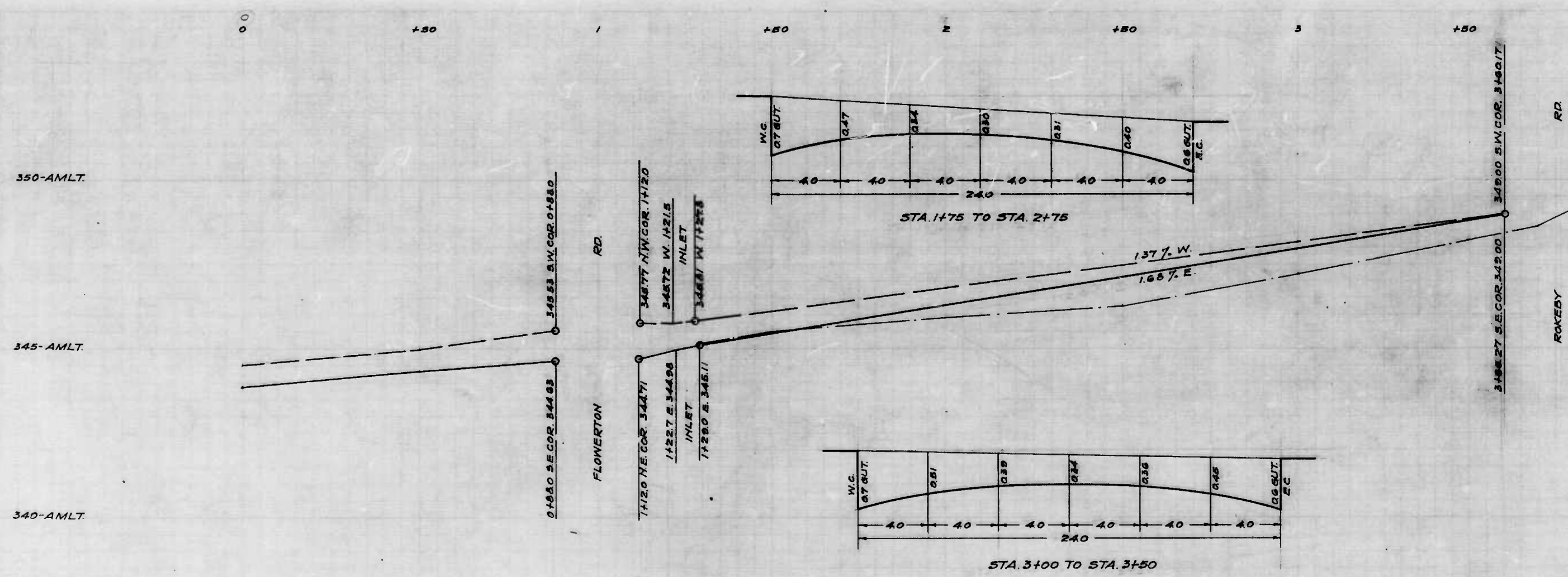

CITY OF BALTIMORE  
 DEPARTMENT OF PUBLIC WORKS  
 BUREAU OF HIGHWAYS  
 PLAN & PROFILE  
 AUGUSTA AVE. - FLOWERTON RD. TO ROKESBY RD.  
 CONT. NO. 771  
 PLAN - 1" = 200'  
 PROFILE - HOR. - 1" = 200'  
 VERT. - 1" = 20'  
 BOOK NO. 149  
 AUG. 24, 1942

APPROVED: *[Signature]*  
 ASSOCIATE ENGINEER

APPROVED: *[Signature]*  
 ENGR. - PLANS & SURVEYS

APPROVED: *[Signature]*  
 HIGHWAYS ENGINEER

APPROVED: *[Signature]*  
 CHIEF ENGINEER

DESIGNED BY: *[Signature]*  
 CHECKED BY: *[Signature]*  
 ENGINEER IN CHARGE OF DIVISION



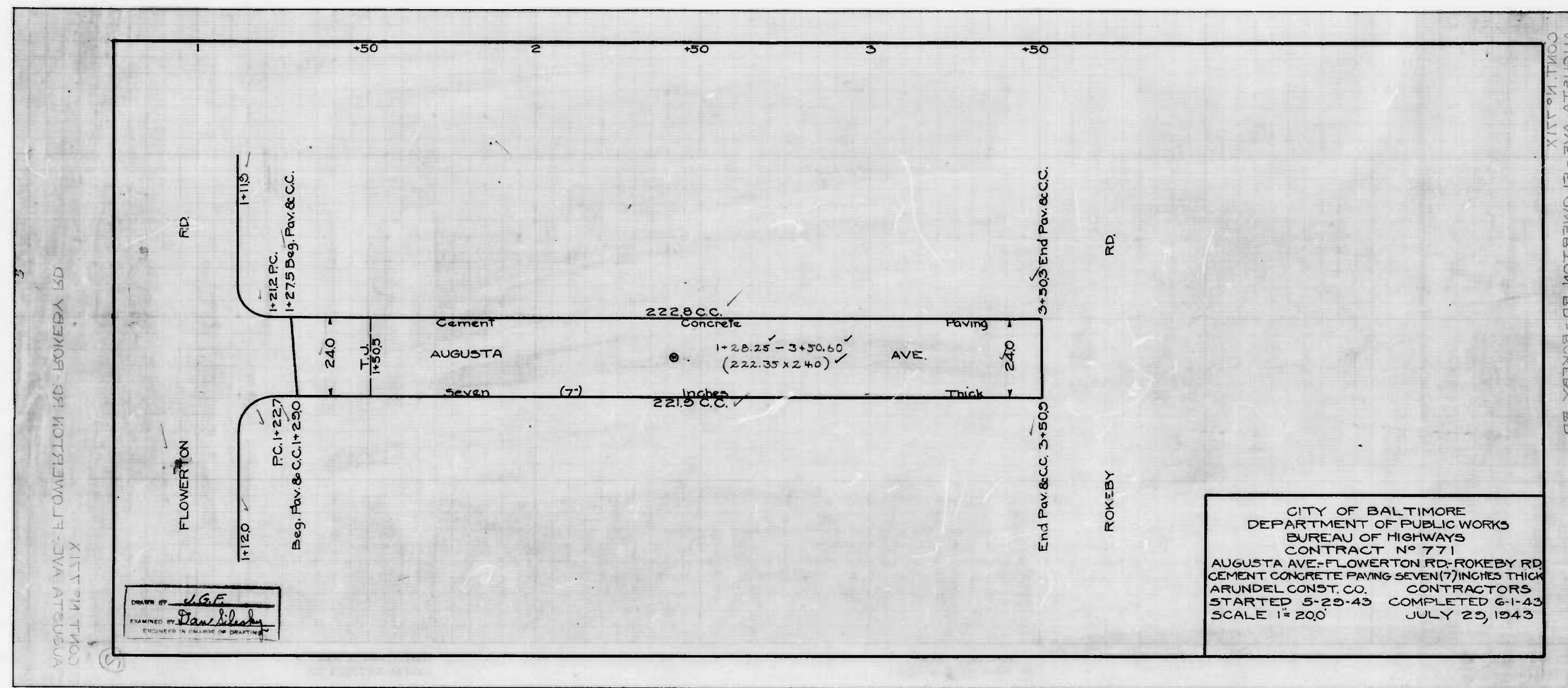

AUGUSTA AVE - FLOWERTON RD - ROKEBY RD  
CONTRACT No. 771

AUGUSTA AVE - FLOWERTON RD - ROKEBY RD  
CONTRACT No. 771

DRAWN BY U.G.F.  
EXAMINED BY [Signature]  
ENGINEER IN CHARGE OF DRAFTING

CITY OF BALTIMORE  
DEPARTMENT OF PUBLIC WORKS  
BUREAU OF HIGHWAYS  
CONTRACT NO. 771  
AUGUSTA AVE-FLOWERTON RD-ROKEBY RD  
CEMENT CONCRETE PAVING SEVEN (7) INCHES THICK  
ARUNDEL CONST. CO. CONTRACTORS  
STARTED 5-29-43 COMPLETED 6-1-43  
SCALE 1"=200 JULY 29, 1943

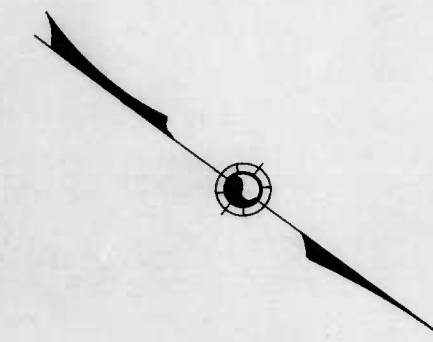
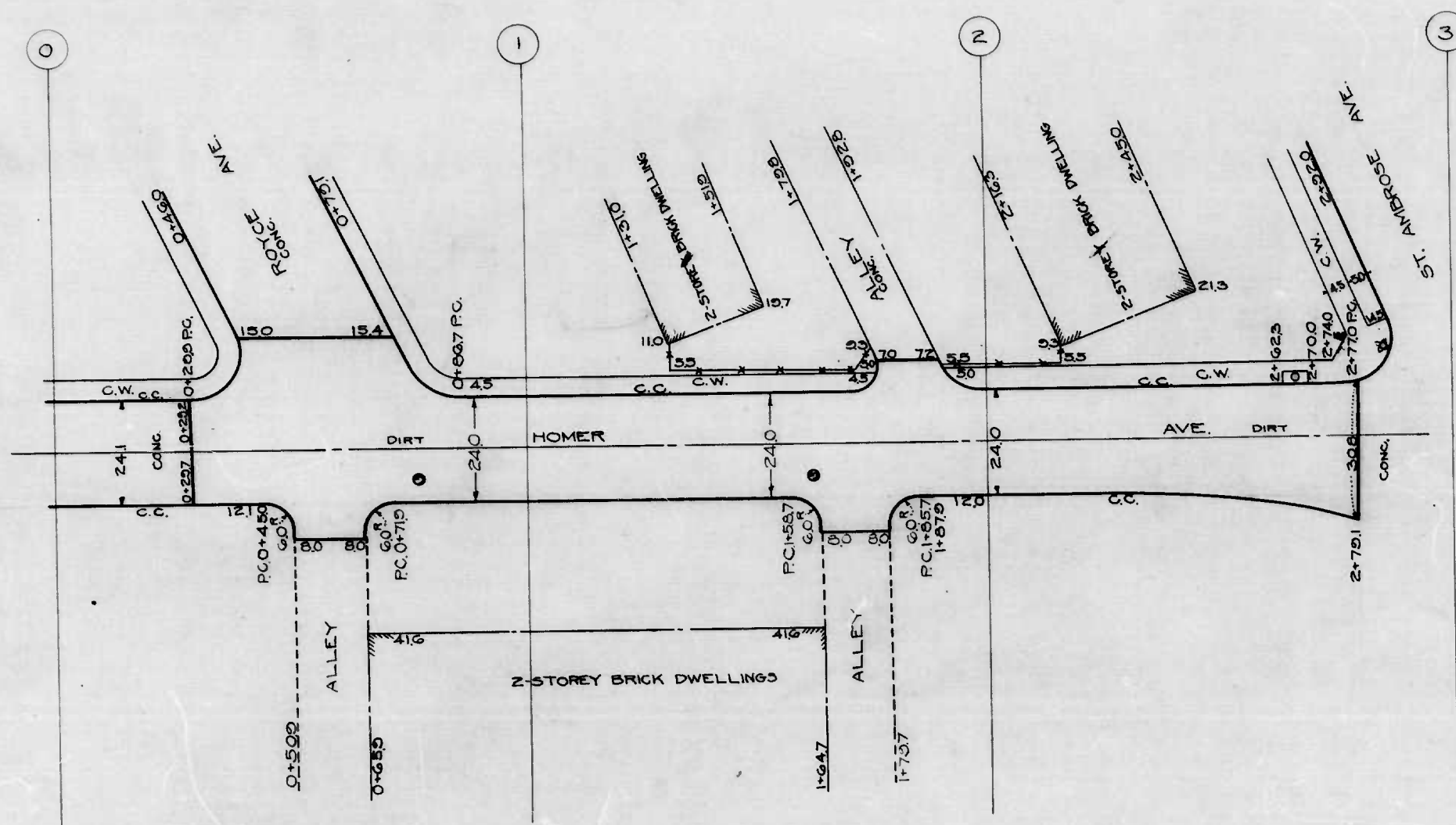

NOTE -  
The issuance of this Plan & Profile does not commit the City to the acceptance and/or improvement of any thoroughfare shown thereon.

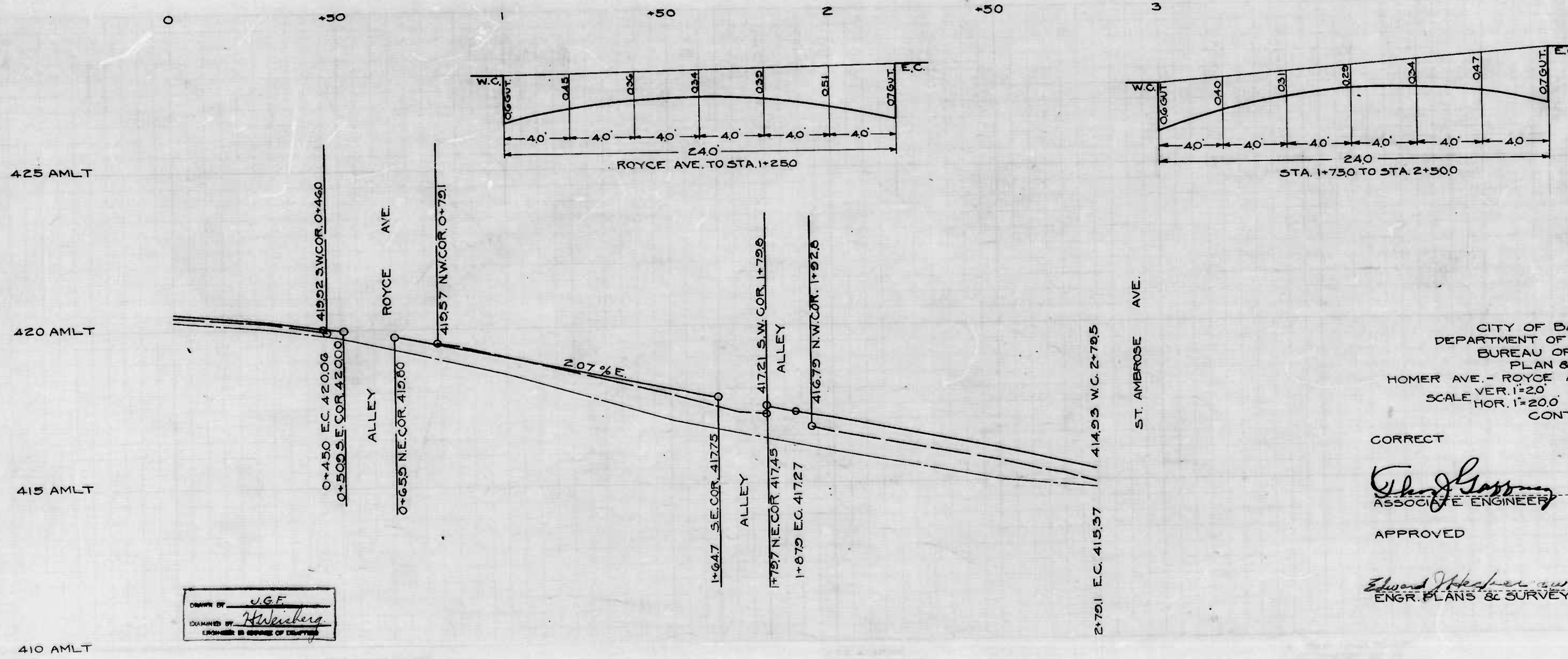

CITY OF BALTIMORE  
DEPARTMENT OF PUBLIC WORKS  
BUREAU OF HIGHWAYS  
PLAN & PROFILE  
HOMER AVE. - ROYCE AVE. - ST. AMBROSE AVE.  
SCALE VER. 1"=20'      AUGUST 11, 1942  
SCALE HOR. 1"=200'      BOOK NO. X170  
CONT. NO. 771

CORRECT      APPROVED

*Edward J. Ross*      *Geo. A. Carter*  
ASSOCIATE ENGINEER      HIGHWAYS ENGINEER

APPROVED      APPROVED

*Edward J. Ross*      *George Cobb*  
ENGR. PLANS & SURVEYS      CHIEF ENGINEER

OWNER BY: UGF  
DRAWN BY: *Hickberg*  
EXAMINED BY: *Hickberg*  
IN CHARGE OF DESIGN



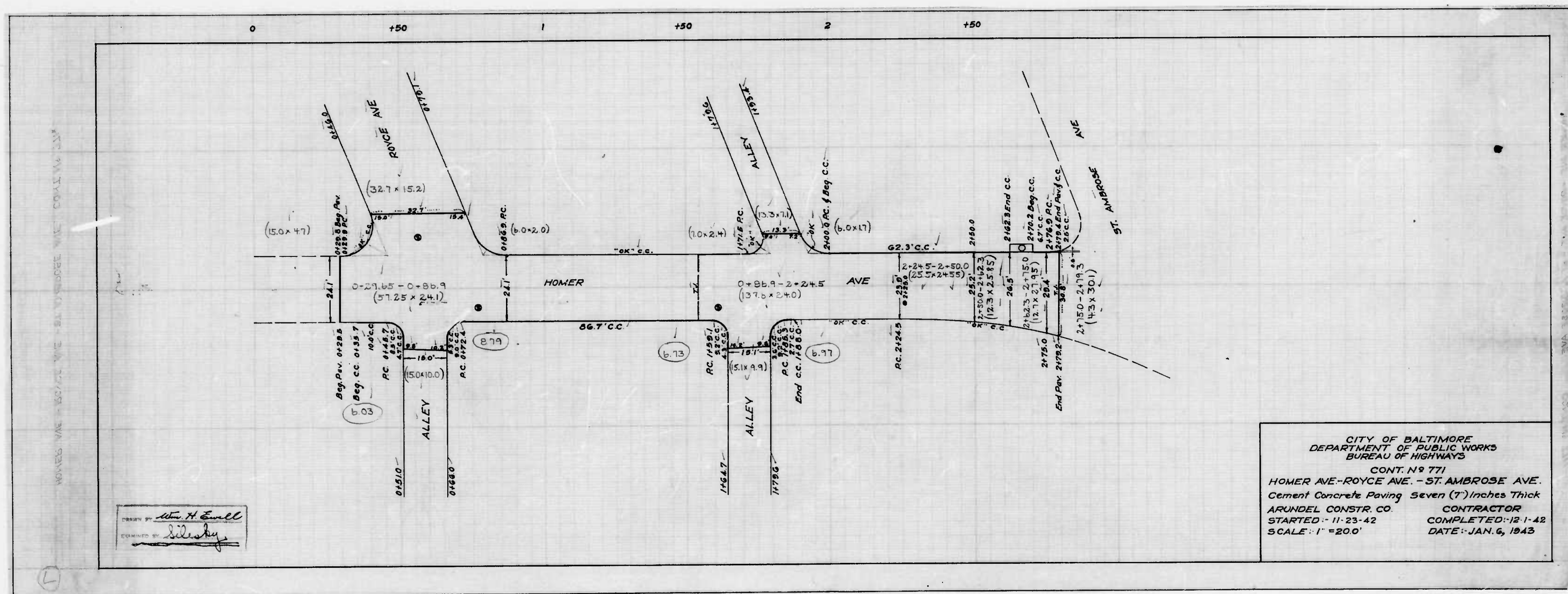

DESIGNED BY *Wm. H. Enell*  
 CHECKED BY *W. H. Enell*

CITY OF BALTIMORE  
 DEPARTMENT OF PUBLIC WORKS  
 BUREAU OF HIGHWAYS  
 CONT. NO. 771  
 HOMER AVE - ROYCE AVE. - ST. AMBROSE AVE.  
 Cement Concrete Paving Seven (7) Inches Thick  
 ARUNDEL CONSTR. CO. CONTRACTOR  
 STARTED - 11-23-42 COMPLETED - 12-1-42  
 SCALE - 1" = 200' DATE - JAN. 6, 1943



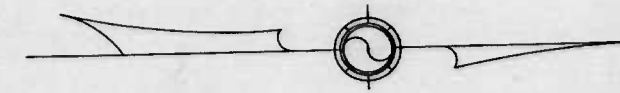
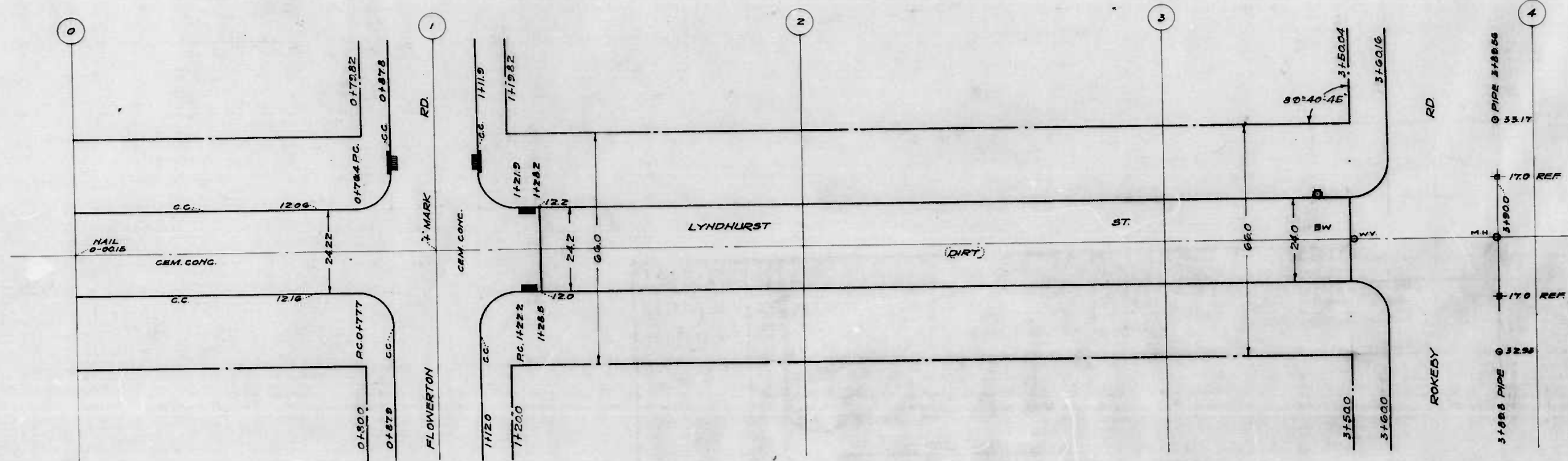

NOTE: THE ISSUANCE OF THIS PLAN & PROFILE DOES NOT COMMIT THE CITY TO THE ACCEPTANCE AND/OR IMPROVEMENT OF ANY THOROUGHFARES SHOWN THEREON.

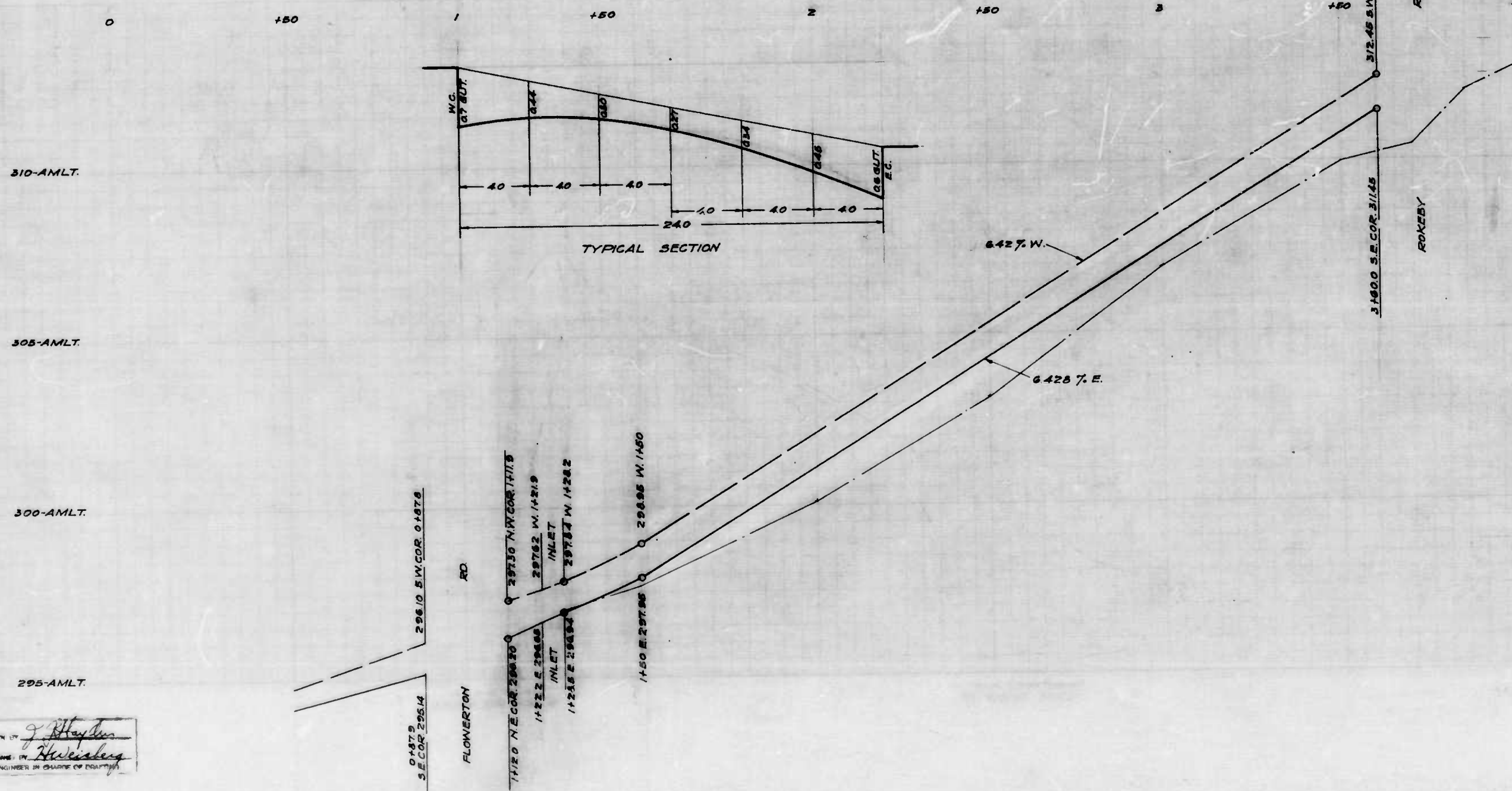

CITY OF BALTIMORE  
 DEPARTMENT OF PUBLIC WORKS  
 BUREAU OF HIGHWAYS  
 PLAN & PROFILE  
 LYNDHURST ST.-FLOWERTON RD. TO ROKEDY RD.  
 CONT. NO. 771  
 PLAN - 1" = 20.0' BOOK-X-149  
 PROFILE - HOR. - 1" = 20.0' AUG 17, 1942  
 VER. - 1" = 2.0'

APPROVED: *Edmund J. Heckler*  
 ENGR. - PLANS & SURVEYS  
 APPROVED: *George J. Conroy*  
 HIGHWAYS ENGINEER  
 APPROVED: *George C. Cobb*  
 CHIEF ENGINEER

APPROVED: *Edmund J. Heckler*  
 ENGINEER IN CHARGE OF PROJECT



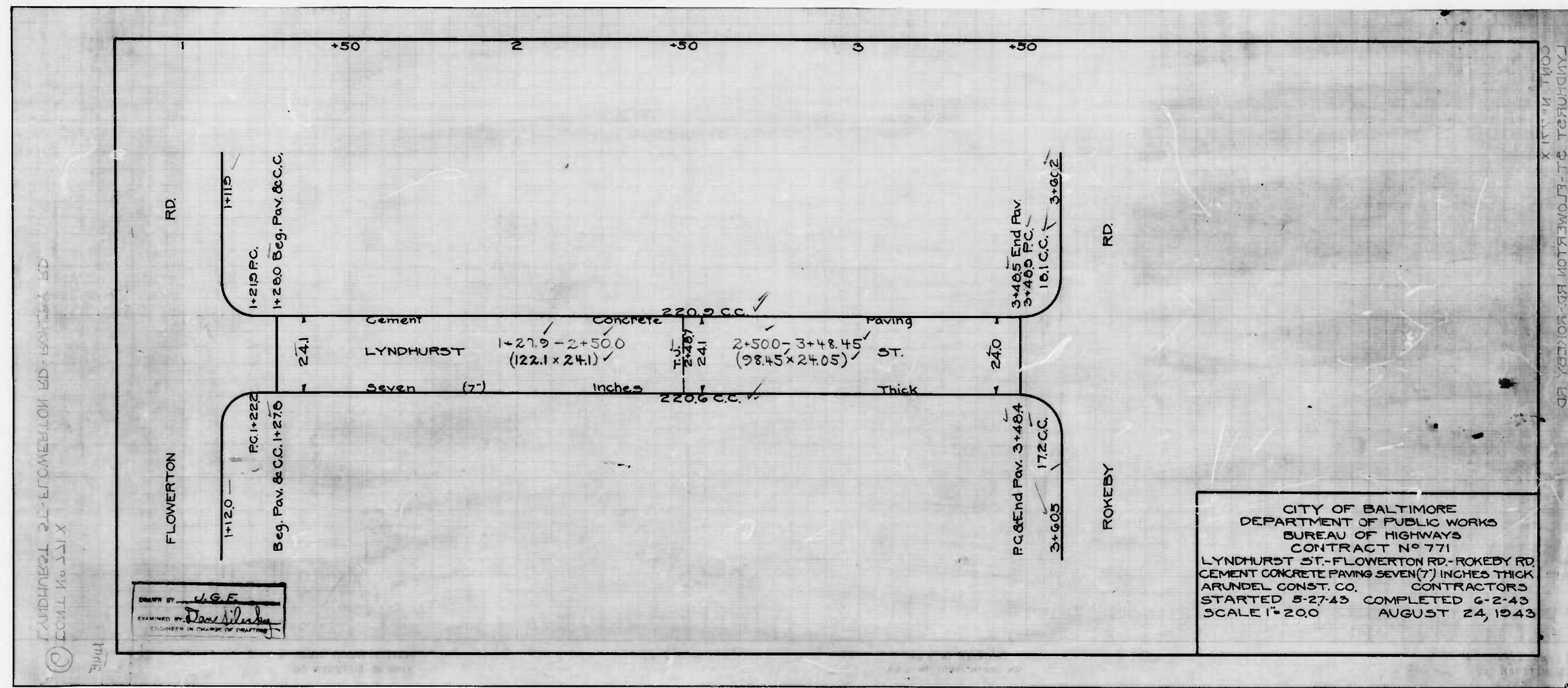

CITY OF BALTIMORE  
 DEPARTMENT OF PUBLIC WORKS  
 BUREAU OF HIGHWAYS  
 CONTRACT NO 771  
 LYNDHURST ST-FLOWERTON RD-ROKEBY RD  
 CEMENT CONCRETE PAVING SEVEN (7) INCHES THICK  
 ARUNDEL CONST. CO. CONTRACTORS  
 STARTED 5-27-43 COMPLETED 6-2-43  
 SCALE 1"=200 AUGUST 24, 1943

DRAWN BY U.S.F.  
 CHECKED BY D. J. [signature]  
 ENGINEER IN CHARGE OF DRAWING

© 1943 U.S.F. ENGINEERS  
 1211 X  
 3041