

DESIGNED BY: V.G.F.
 DRAWN BY: B.E. [Signature]

2/27/11

JTD, FREDERICK RD - MEDLEY RD LA THE 30.0 MCHWATER CELL 1
 2011 11 23

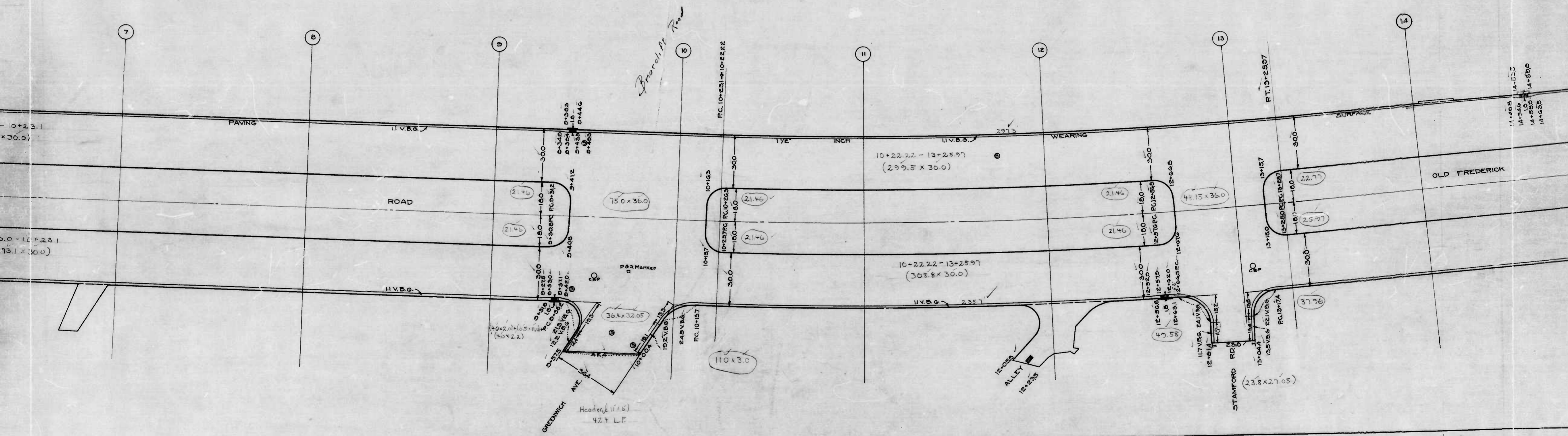

2142

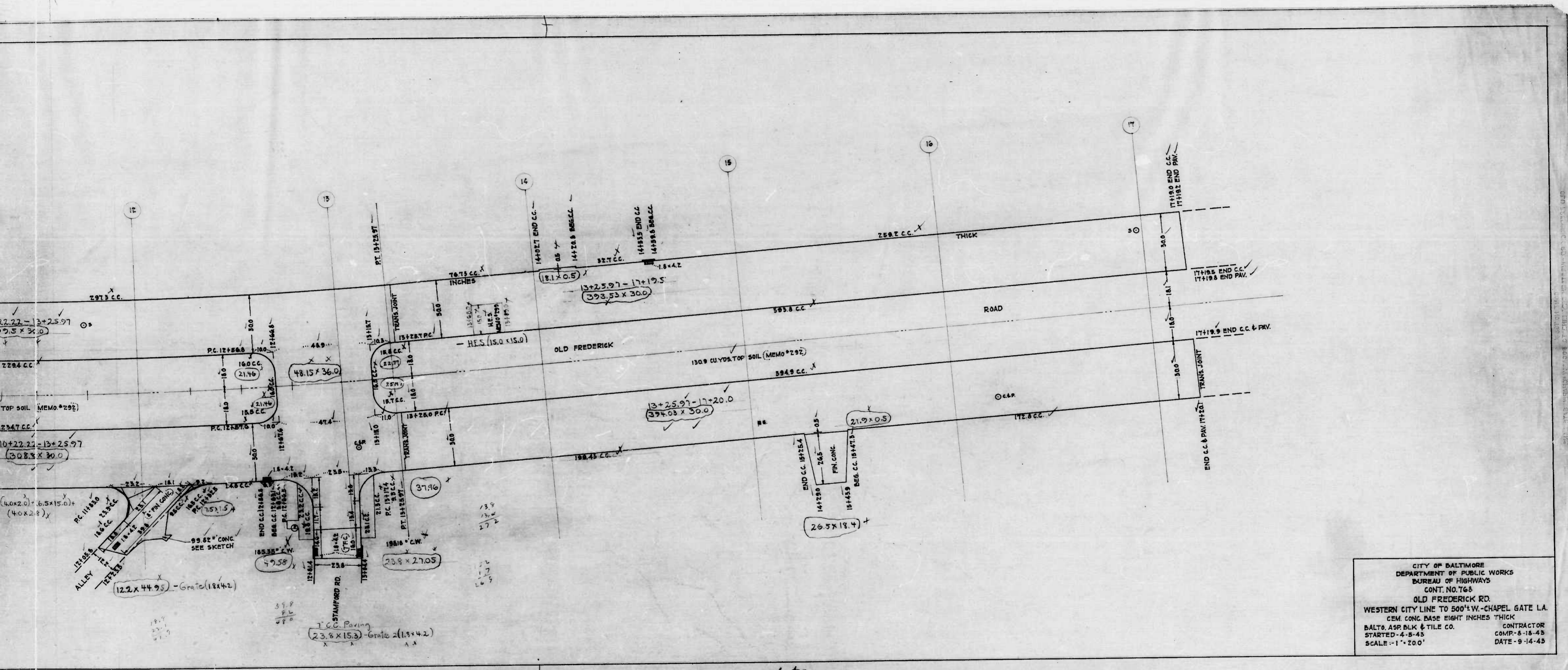

CITY OF BALTIMORE
 DEPARTMENT OF PUBLIC WORKS
 BUREAU OF HIGHWAYS
 CONT. NO. 768
 OLD FREDERICK RD.
 WESTERN CITY LINE TO 500' W. CHAPEL GATE L.A.
 CEM. CONC. BASE EIGHT INCHES THICK
 BALTO. ASP. BLK. & TILE CO. CONTRACTOR
 STARTED - 4-8-45 COMP. - 8-18-45
 SCALE - 1" = 200' DATE - 9-14-45

Sheet 3

CURVE DATA
 $T = 125.0'$ $R = 14732.82'$
 $C = 249.99'$ $L = 250.0'$
 $A = 0^\circ 58' 20''$

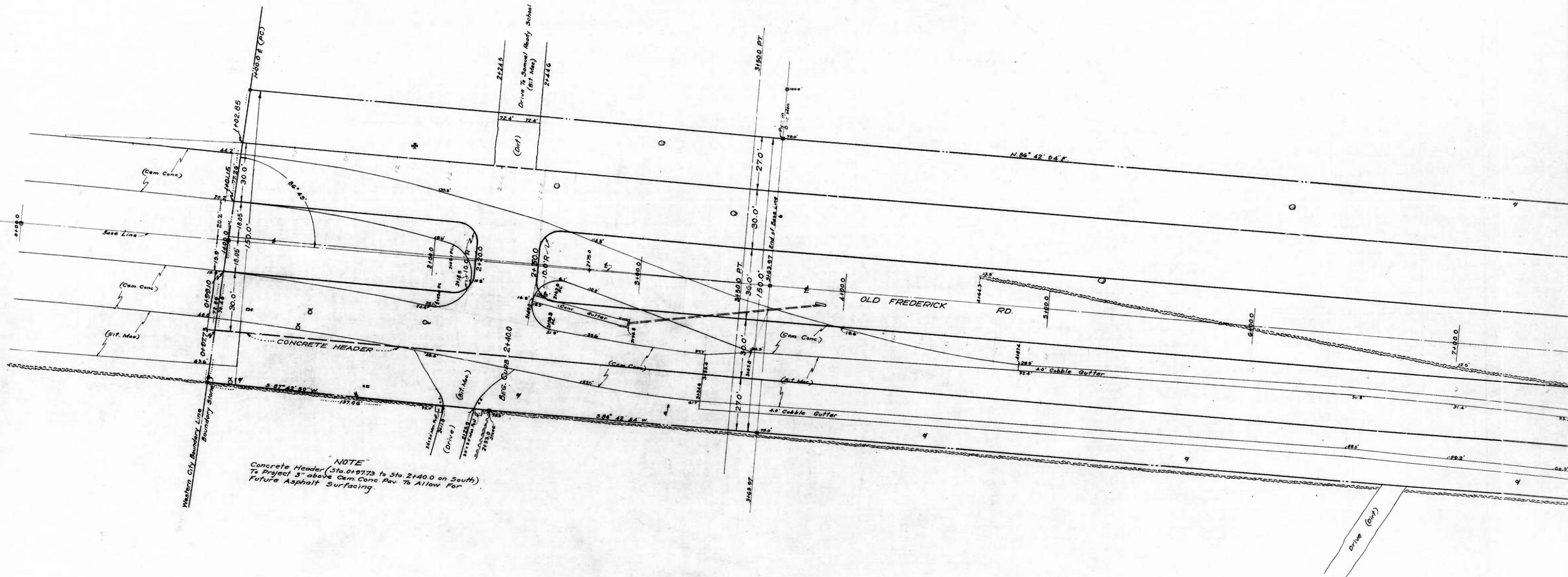

NOTE
 Concrete Header (Sta. 0+97.73 to Sta. 2+40.0 on South)
 To Project 3" above Cam Conc. Pav. To Allow For
 Future Asphalt Surfacing.

DESIGNED BY *Wm. H. Ennel*
 DRAWN BY *Halsberg*
 CHECKED BY *[Signature]*

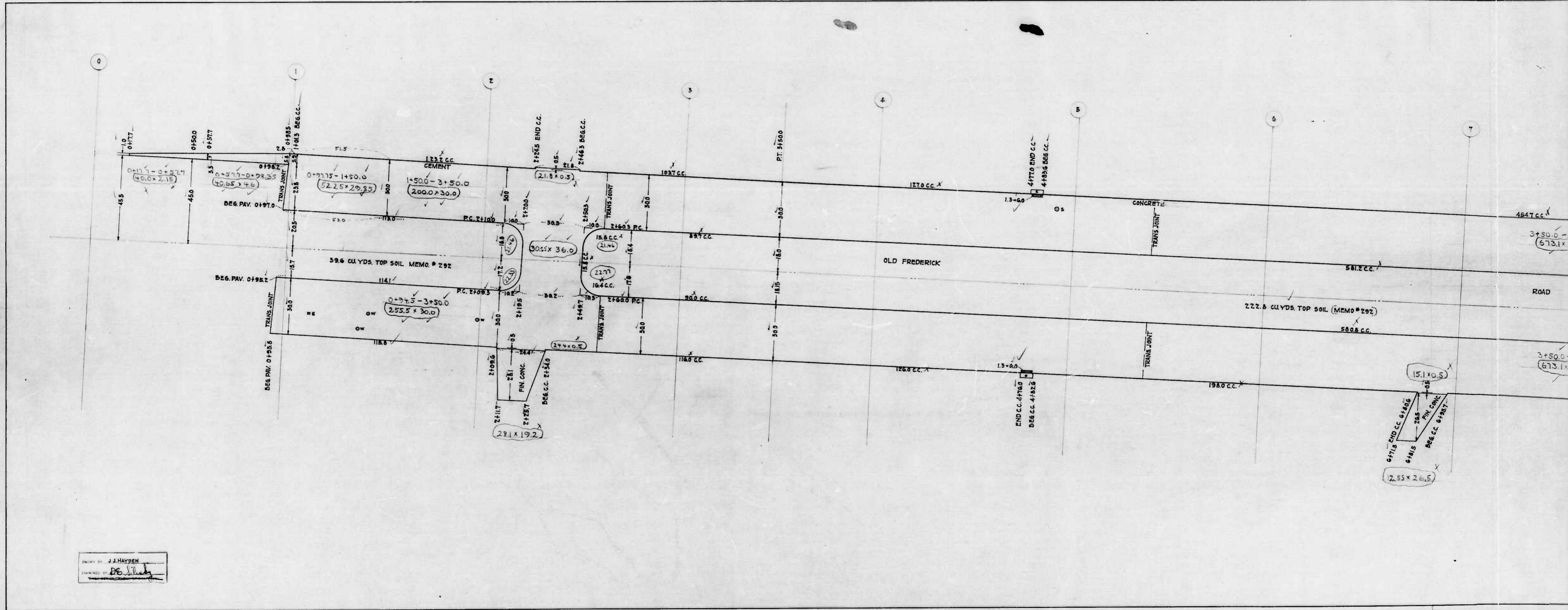

DRAWN BY J.J. HAYDEN
 ENGINEER BY *DE Hayden*

OK AT

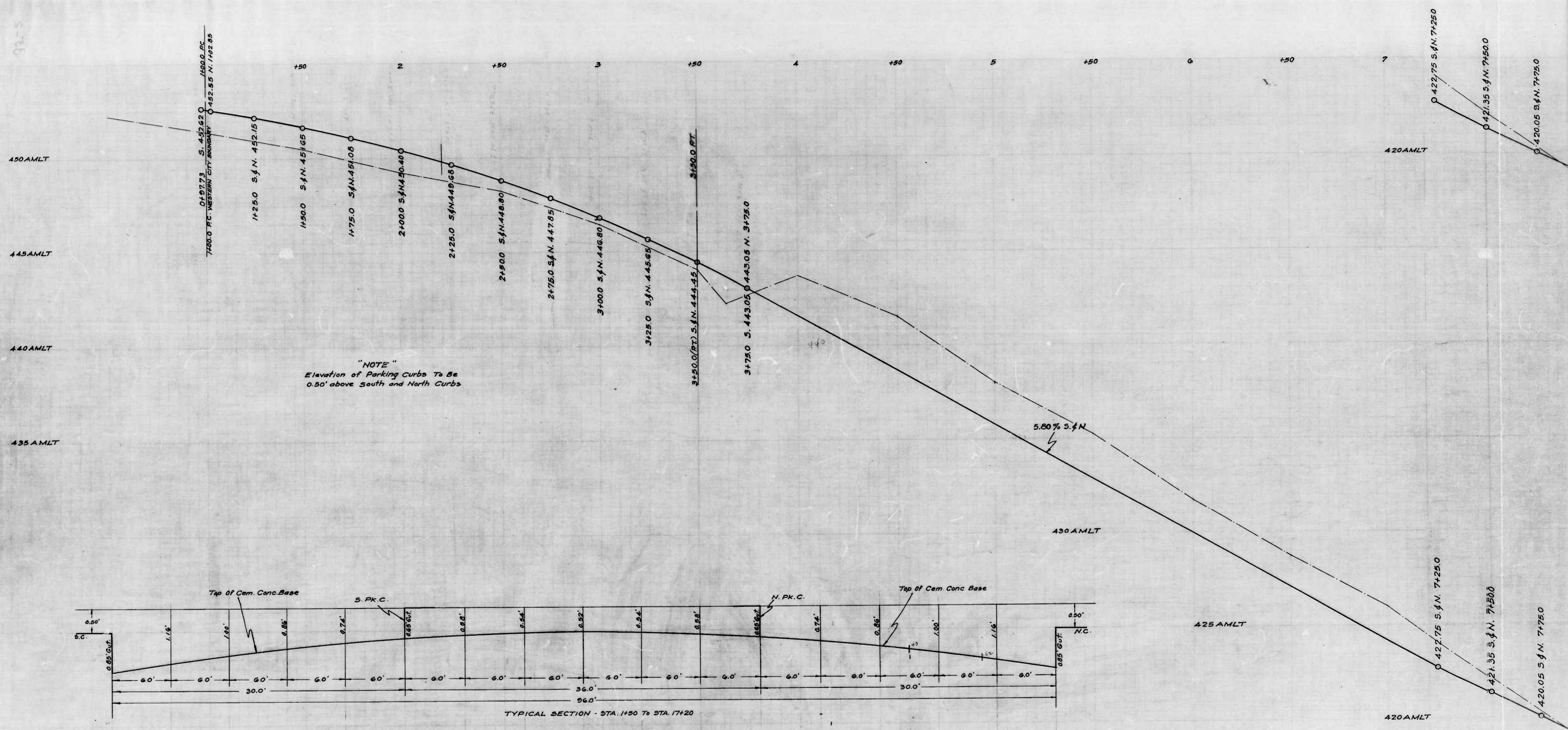

"NOTE"
Elevation of Parking Curbs To Be
0.50' above South and North Curbs

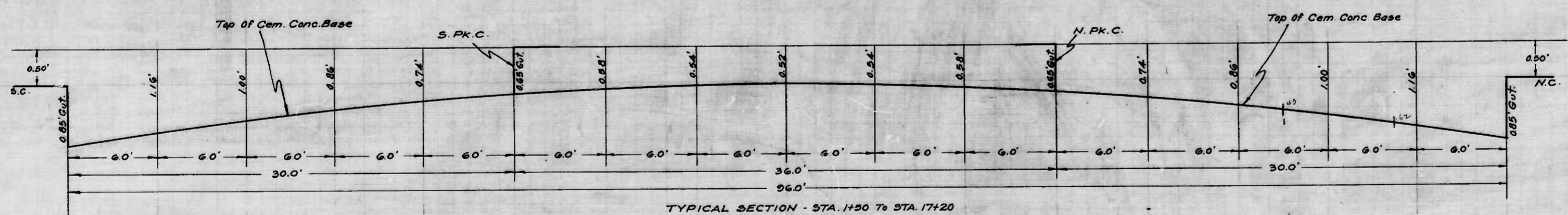

DESIGNED BY
Wm. H. Council
ENGINEER IN CHARGE OF DESIGN

sheet 1

Branch Rd.

± CURVE DATA
R = 2223.70' C = 303.51'
L = 303.75' Δ = 7°49'34"
d = 0.772349 m/m

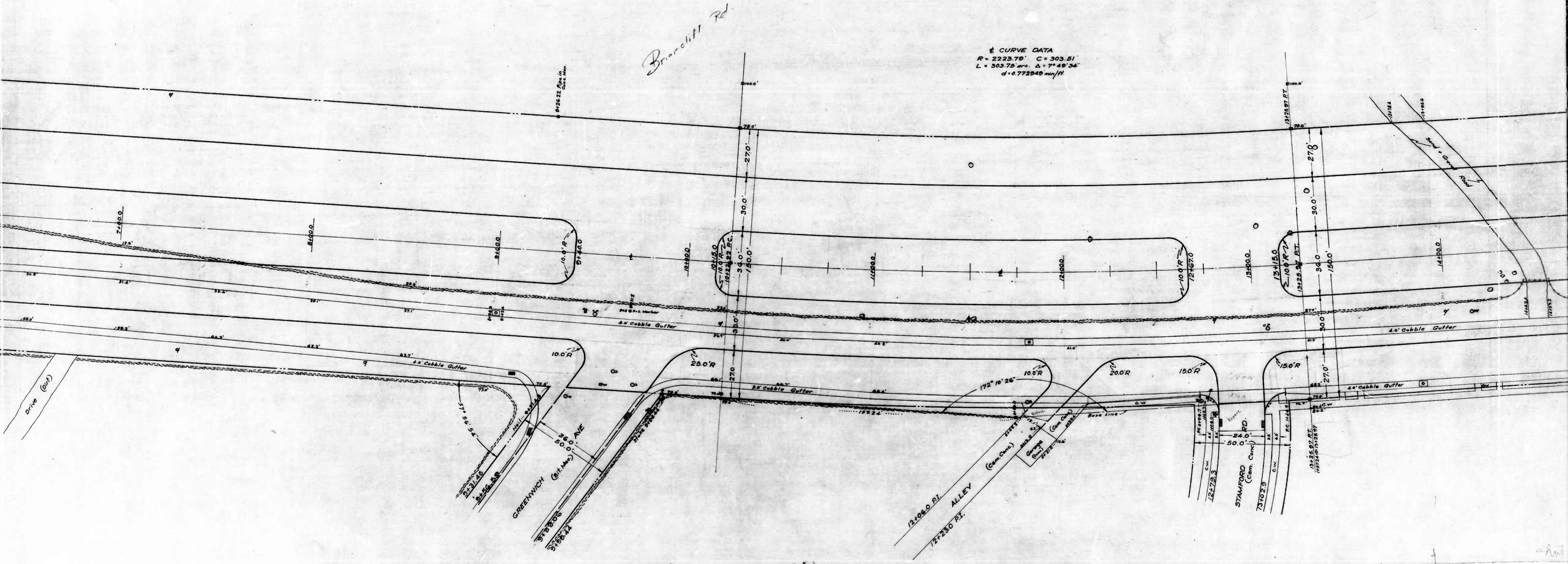

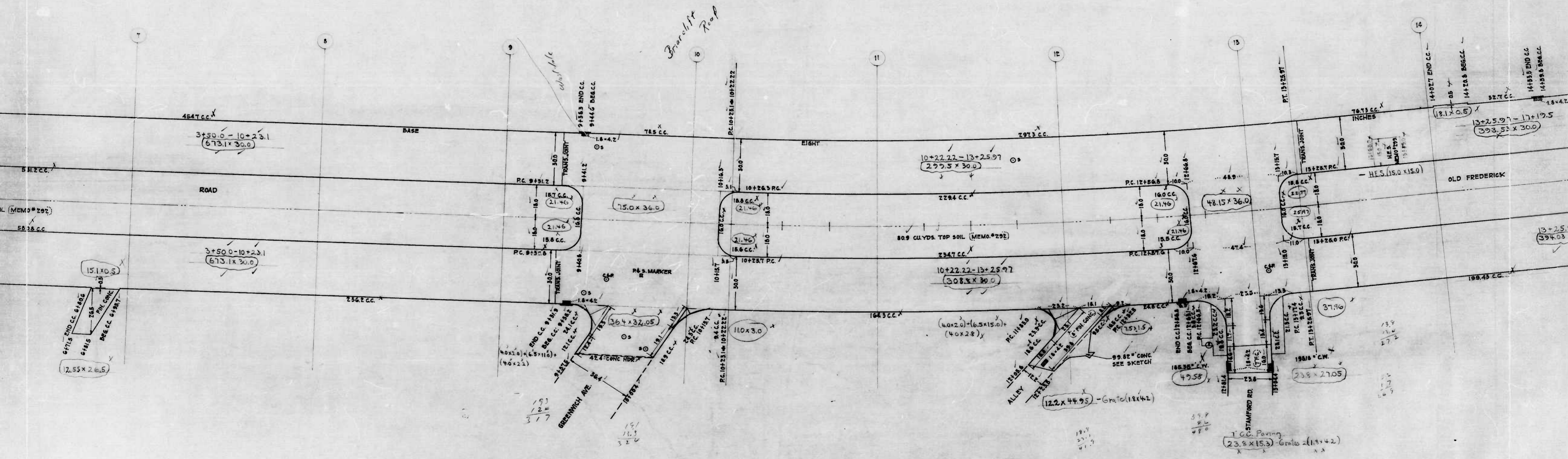

CHIT

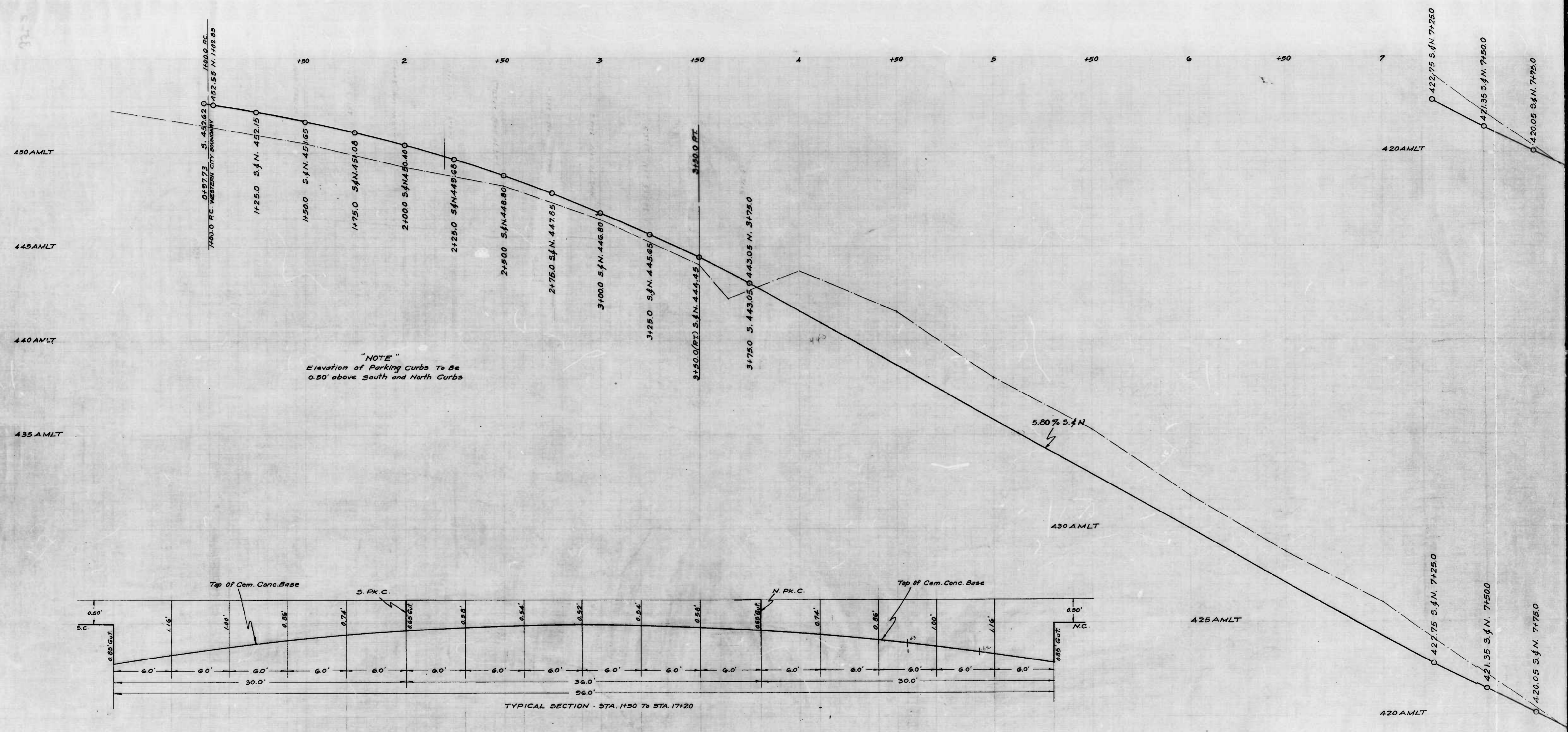

"NOTE"
Elevation of Parking Curbs To Be
0.50' above South and North Curbs

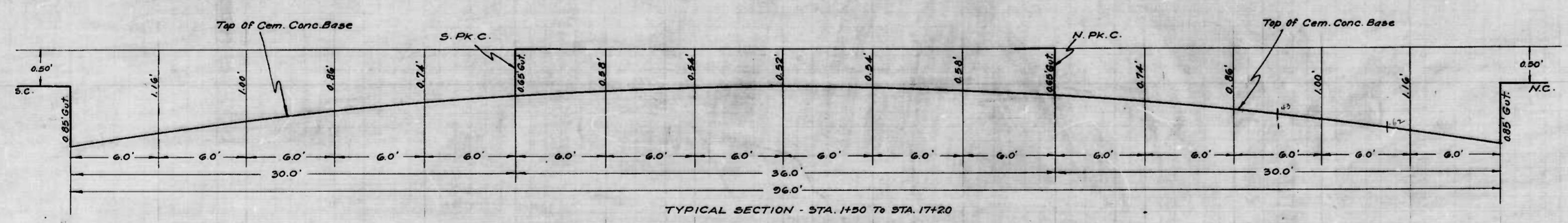

Checked by *Wm. H. Emswiler*
Engineered by *Hausberg*
Engineers in Charge of Design

shot 1

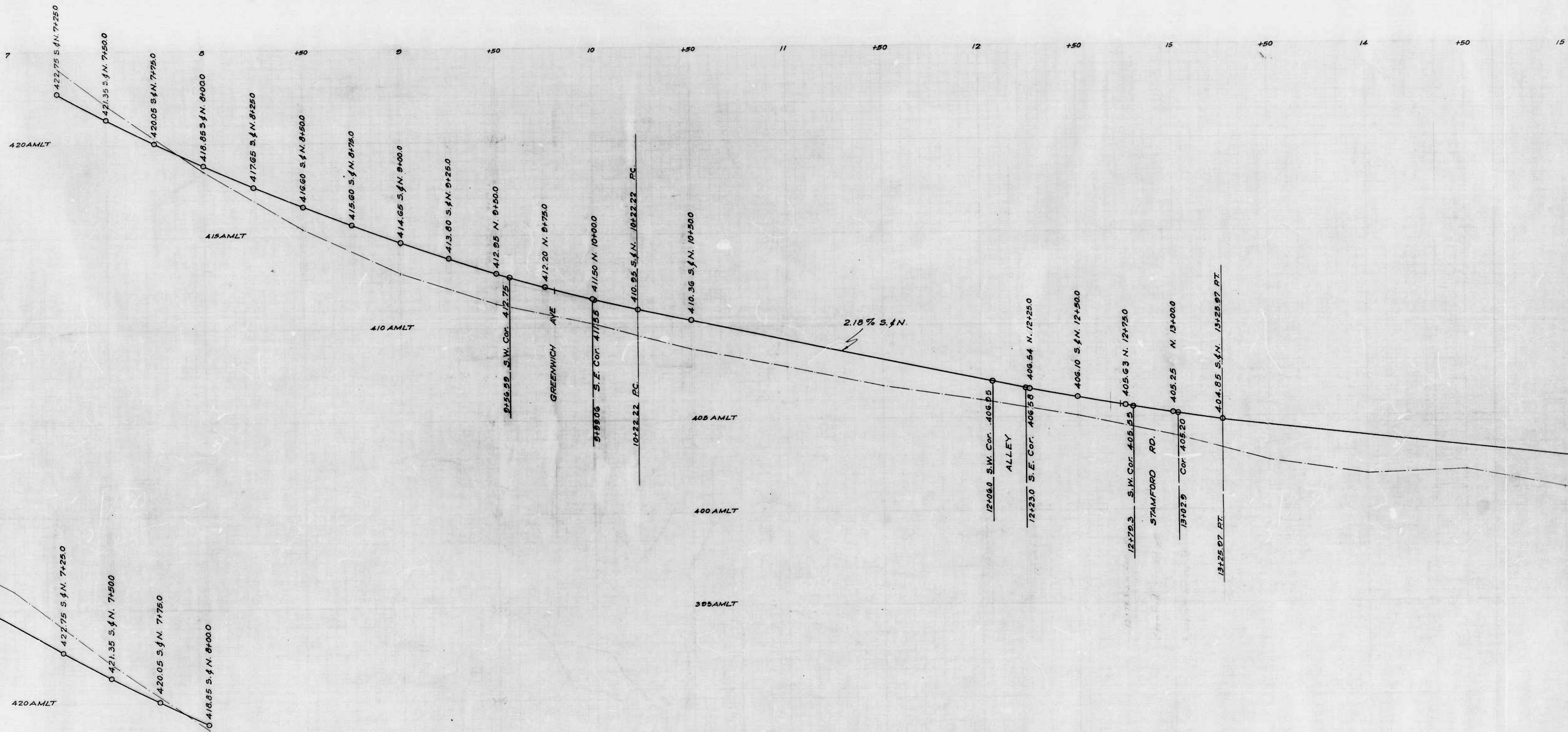

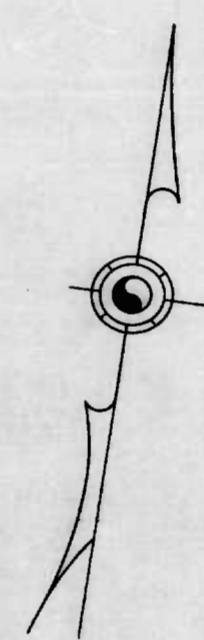
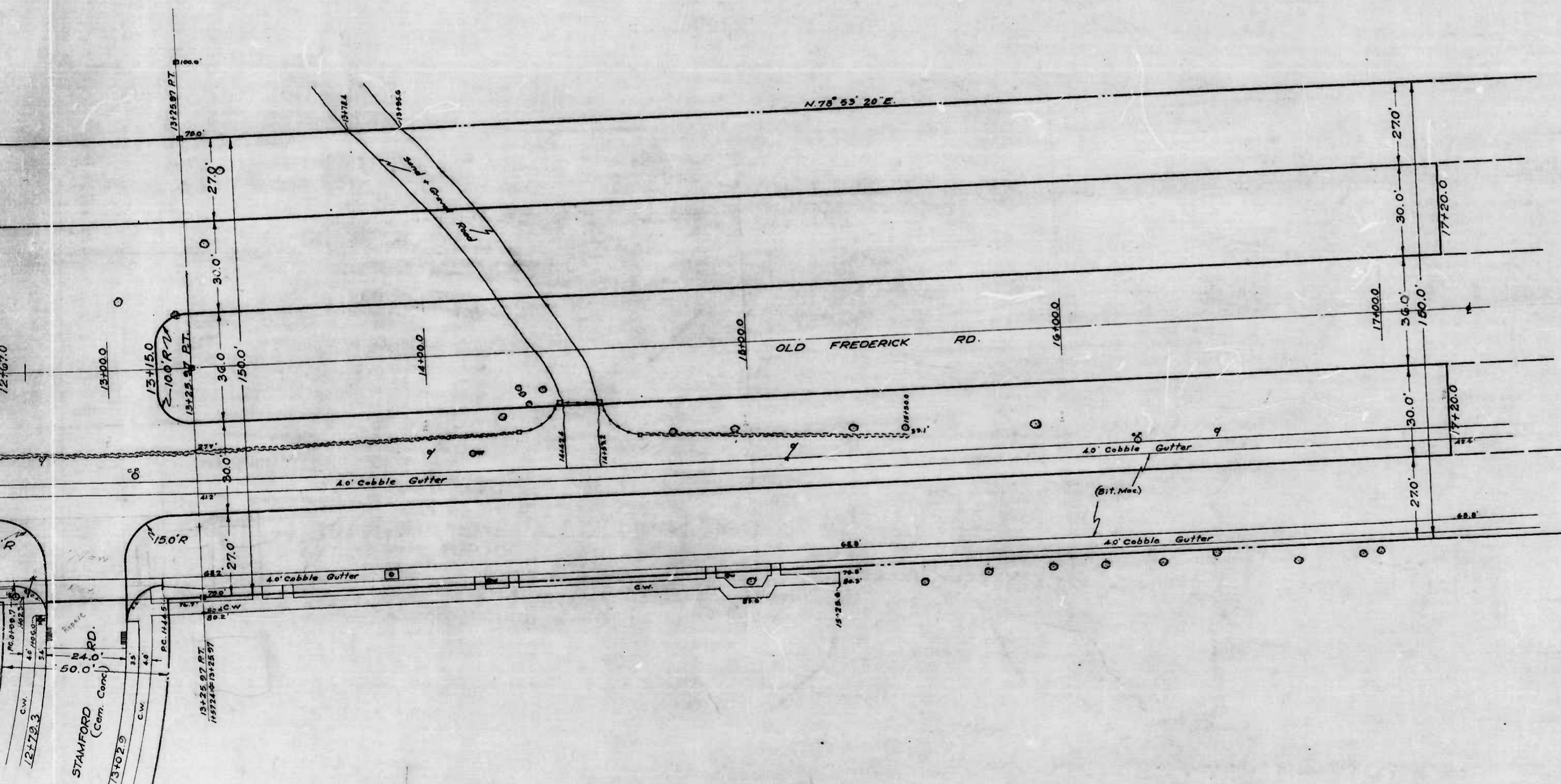

CITY OF BALTIMORE
 DEPARTMENT OF PUBLIC WORKS
 BUREAU OF HIGHWAYS
 PLAN OF
 OLD FREDERICK RD - 500' + W. CHAPEL GATE LA. - WESTERN CITY LINE
 SCALE - 1" = 20.0'
 CONT. N^o 768
 BOOK N^o X-164 & X-164A
 DATE - AUGUST 3, 1942

Edward Hecker
 ASSOCIATE ENGINEER
 APPROVED
 ENGR. PLANS & SURVEYS

George Colby
 HIGHWAYS ENGINEER
 APPROVED
 CHIEF ENGINEER

sheet 2

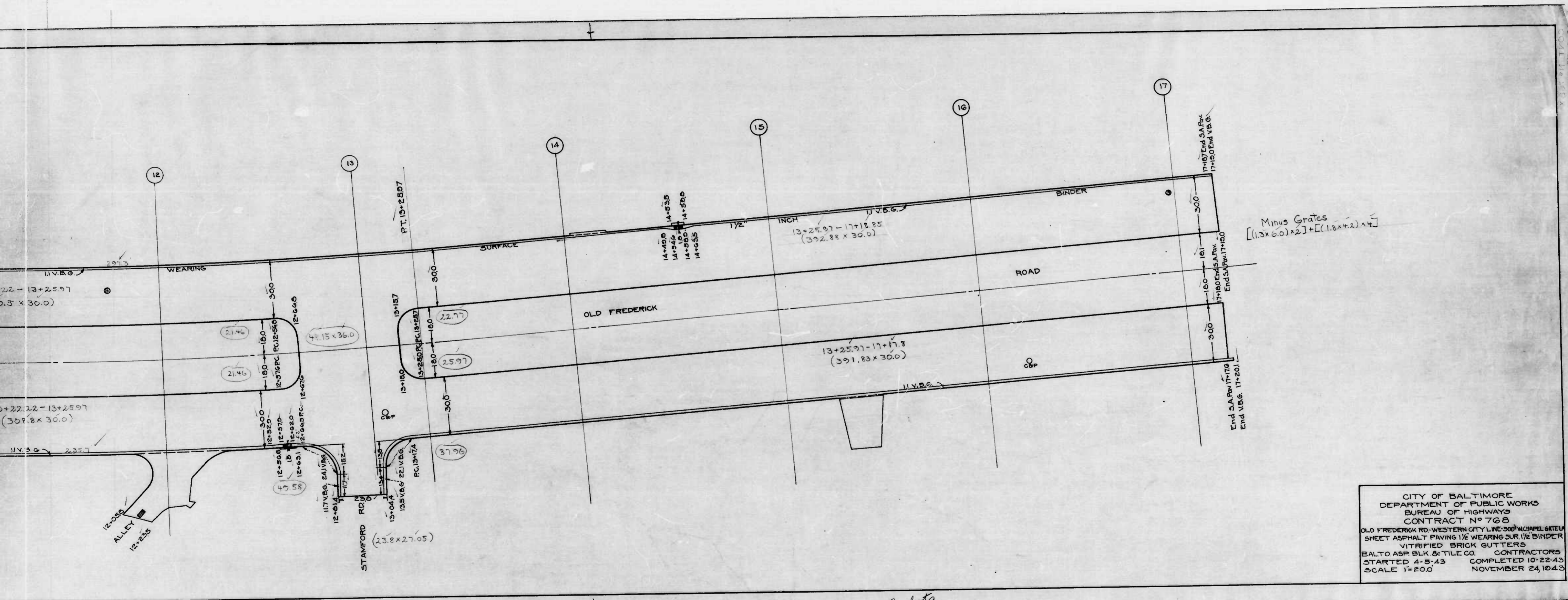

3 sheets

12 +50 13 +50 14 +50 15 +50 16 +50 17

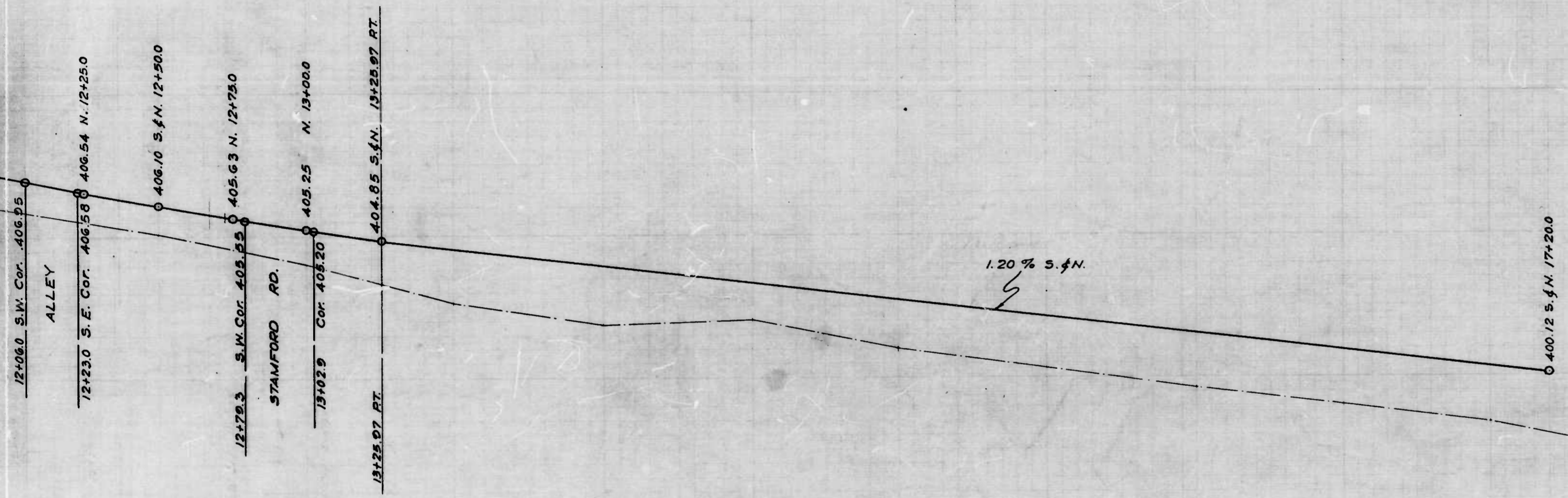

CITY OF BALTIMORE
 DEPARTMENT OF PUBLIC WORKS
 BUREAU OF HIGHWAYS
 PROFILE OF
 OLD FREDERICK RD - 500' W. CHAPEL GATE LA. - WESTERN CITY LINE
 SCALE: HOR: 1" = 20.0' BOOK N° X-164, & 164A
 VER: 1" = 2.0' DATE: AUGUST 4, 1942
 CONT. N° 768

CORRECT APPROVED APPROVED APPROVED
John J. Sweeney *Geo. F. Carter* *Edward J. Healy* *George Collier*
 ASSOCIATE ENGINEER HIGHWAYS ENGINEER ENGR. PLANS & SURVEYS CHIEF ENGINEER