

Wm. H. Cowell
Hensberg

sheet 1

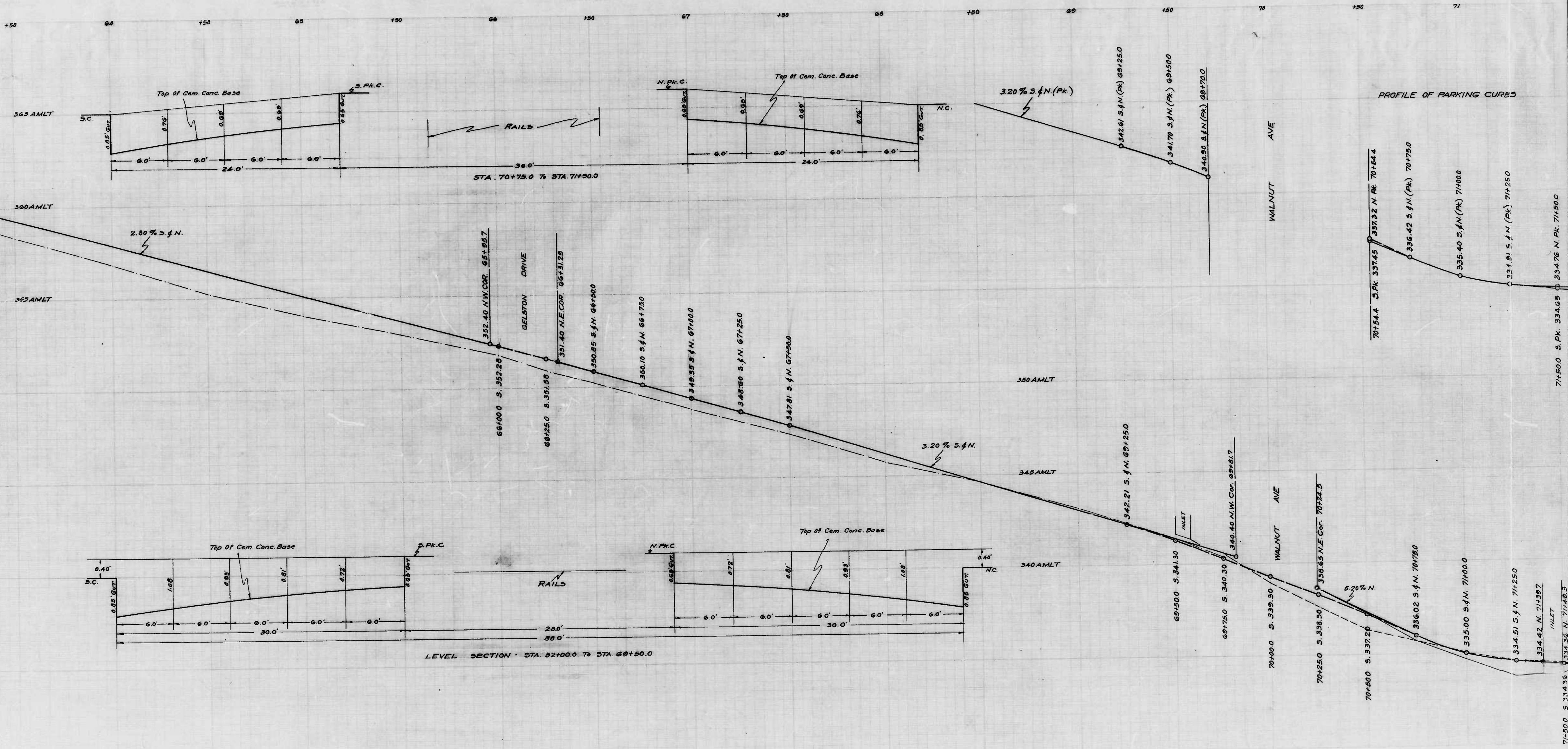

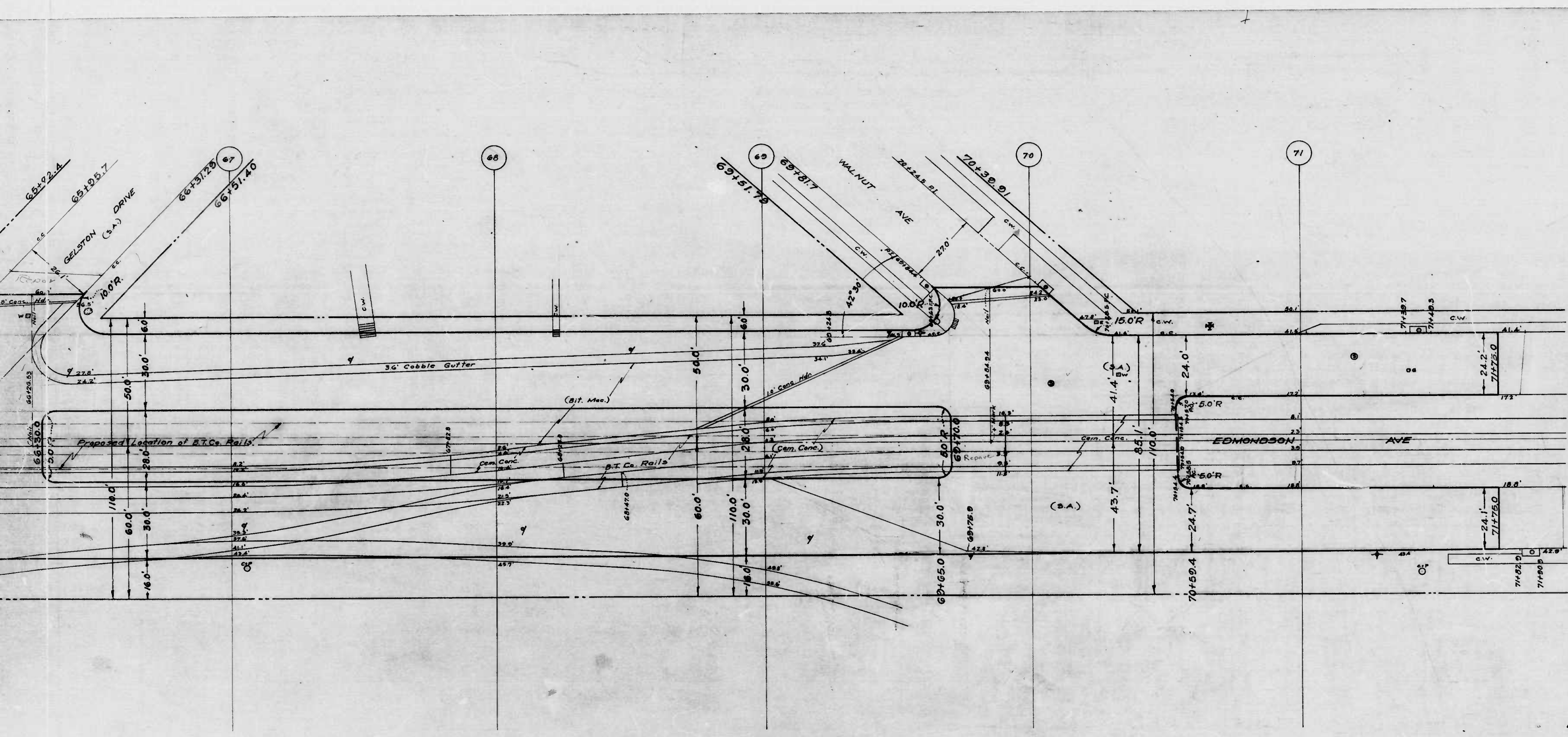

CITY OF BALTIMORE
 DEPARTMENT OF PUBLIC WORKS
 BUREAU OF HIGHWAYS
 PLAN OF
 EDMONDSON AVE. - SWANNI AVE. - 100'±E. WALNUT AVE

SCALE: 1" = 200'
 CONT. N° 764
 BOOK N° X-164 & X-164 A
 DATE: SEPT. 4, 1942.

APPROVED *[Signature]* ASSOCIATE ENGINEER
 APPROVED *[Signature]* HIGHWAYS ENGINEER
 APPROVED *[Signature]* ENGR. PLANS & SURVEYS
 APPROVED *[Signature]* CHIEF ENGINEER

Sheet 3

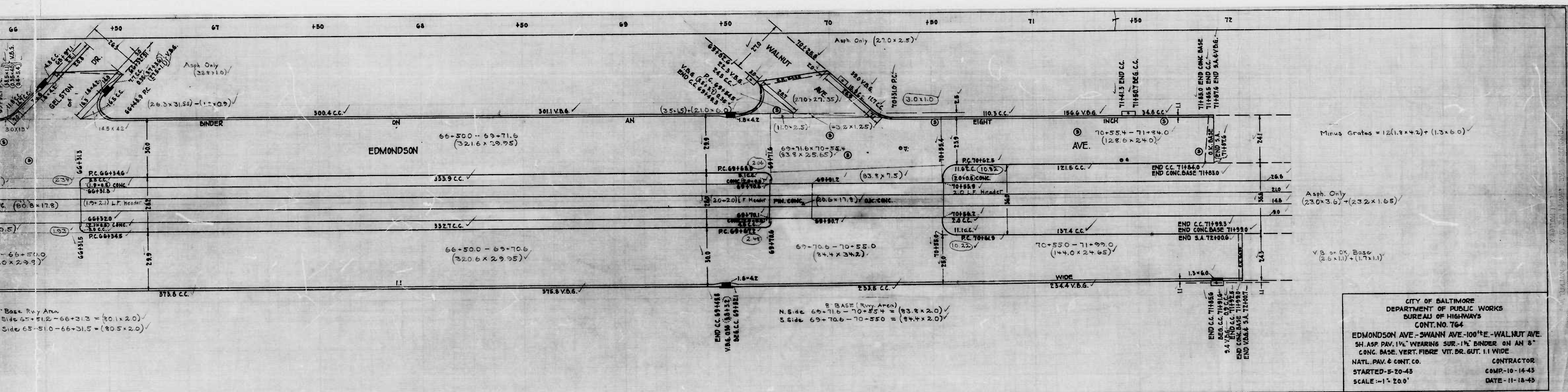

CITY OF BALTIMORE
 DEPARTMENT OF PUBLIC WORKS
 BUREAU OF HIGHWAYS
 CONT. NO. 764
 EDMONDSON AVE - SWANN AVE-100' E. - WALNUT AVE.
 5H. ASP. PAV. 1 1/2" WEARING SUR. 1 1/2" BINDER ON AN 8" CONC. BASE. VERT. FIBRE VIT. DR. GUT. 1.1 WIDE
 NATL. PAV. & CONT. CO. CONTRACTOR
 STARTED - 5-20-45 COMP. - 10-14-45
 SCALE - 1" = 20.0' DATE - 11-18-45

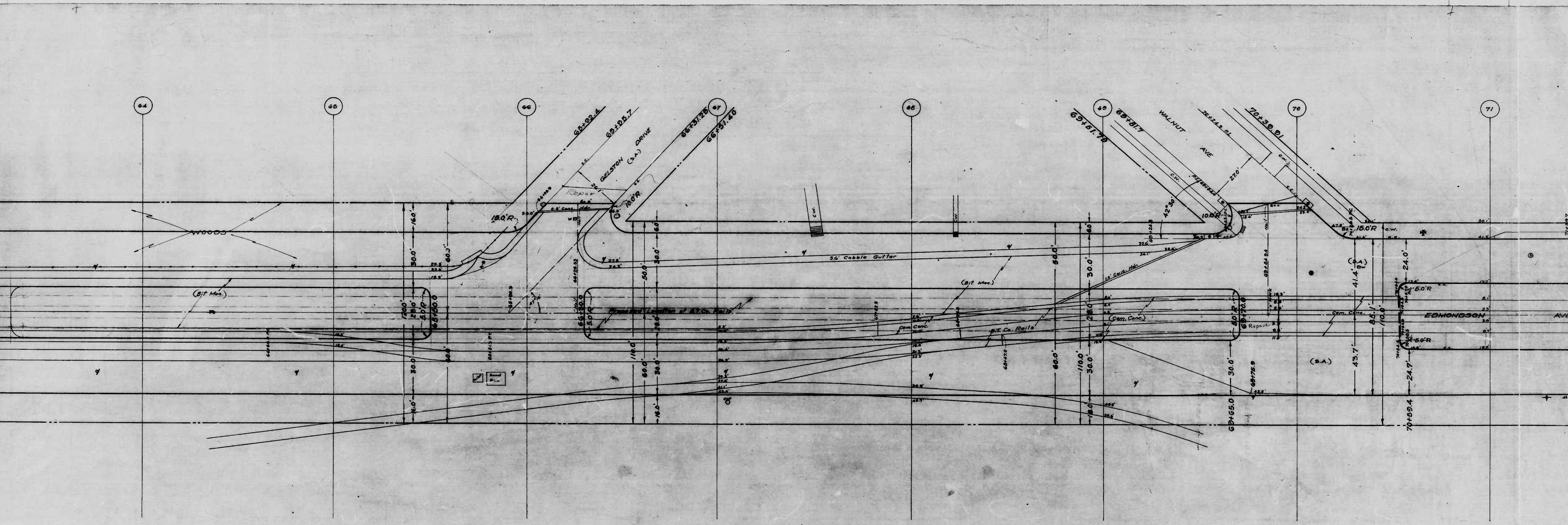

sheet 3

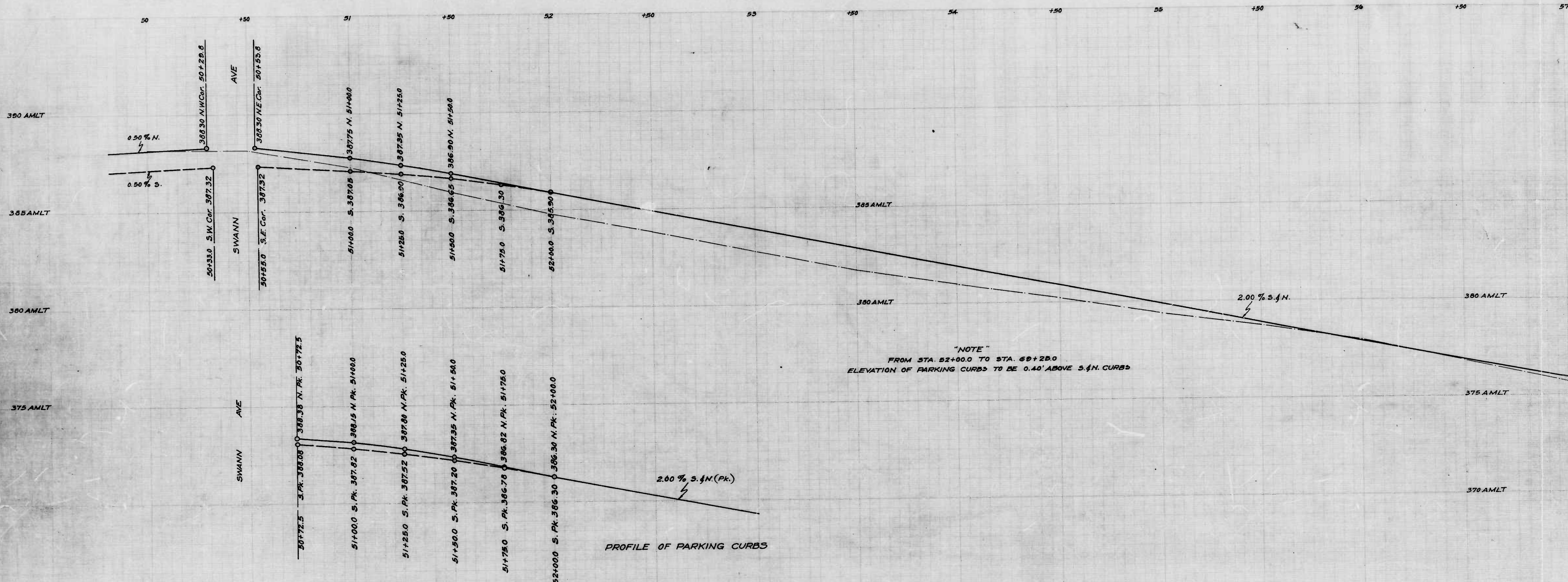

"NOTE"
 FROM STA. 52+00.0 TO STA. 60+25.0
 ELEVATION OF PARKING CURBS TO BE 0.40' ABOVE S. & N. CURBS

PROFILE OF PARKING CURBS

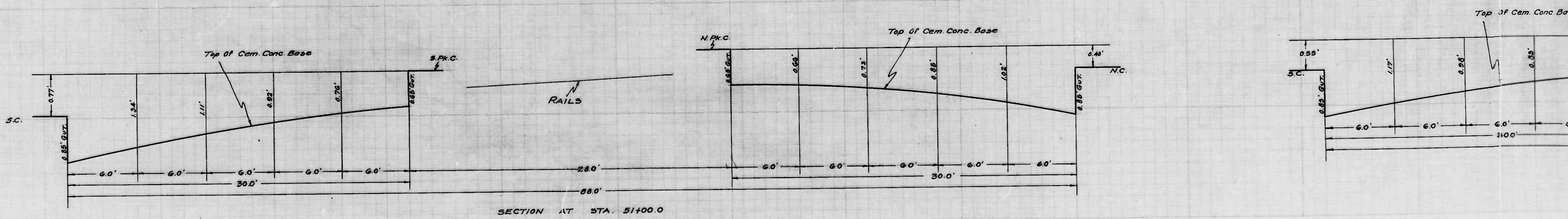

W. H. Cowell
 ENGINEER IN CHARGE OF DESIGN

Sheet 1

