

BALTIMORE ST. NW COR 07000

MEET EXISTING E.R.W.T. @ 04327

0450 E.R.W.T. 4182

0476 E.R.W.T. 4299

42.99 W.R.W.T. 0476

11326 S.E.COR. WILKES LA. NW COR 11327

5.475%

S.W. COR 14927 WILKES LA. NW COR 14927

2125 E.R.W.T. 5120

5120 W.R.W.T. 2125

MEET EXISTING E.R.W.T. @ 21566

21689 S.E.COR.

FAVETTE ST.

S.W. COR 31045

MEET EXISTING E.R.W.T. @ 31202

3460 E.R.W.T. 4825

4825 W.R.W.T. 3460

4100 E.R.W.T. 5182

5178 W.R.W.T. 4100

8.93%

5100 E.R.W.T. 6648

6641 W.R.W.T. 5100

S.W. COR 51417

5125 E.R.W.T. 6970

6966 W.R.W.T. 5125

S.E. COR

5150 E.R.W.T. 7065

7064 W.R.W.T. 5150

LEXINGTON

S.W. COR 51616

3.73%

6175 E.R.W.T. 7635

7631 W.R.W.T. 6175

7100 E.R.W.T. 7825

7821 W.R.W.T. 7100

7125 E.R.W.T. 7710

7706 W.R.W.T. 7125

3.36%

DRAWN BY: J. L. HAYDEN
OWNED BY: Heiseberg
ENGINEER IN CHARGE OF PARTY

BENCH MARKS
S.E.COR. BOTTOM GRANITE STEP ENTRANCE TO 5100
S.E.COR. BOTTOM GRANITE STEP ENTR. TO FIDELITY

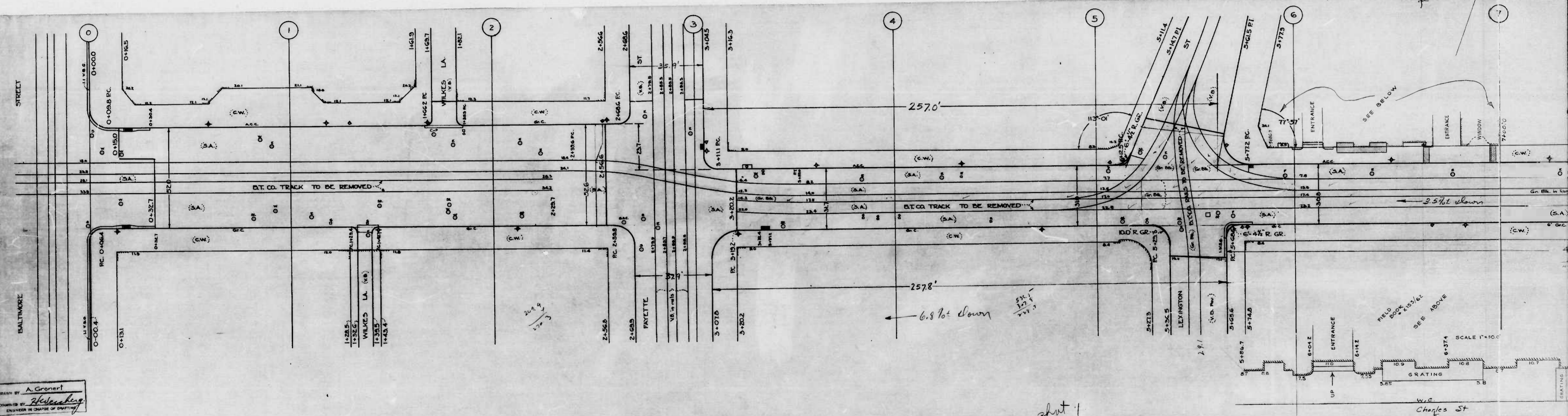

sheet 1

Charles St

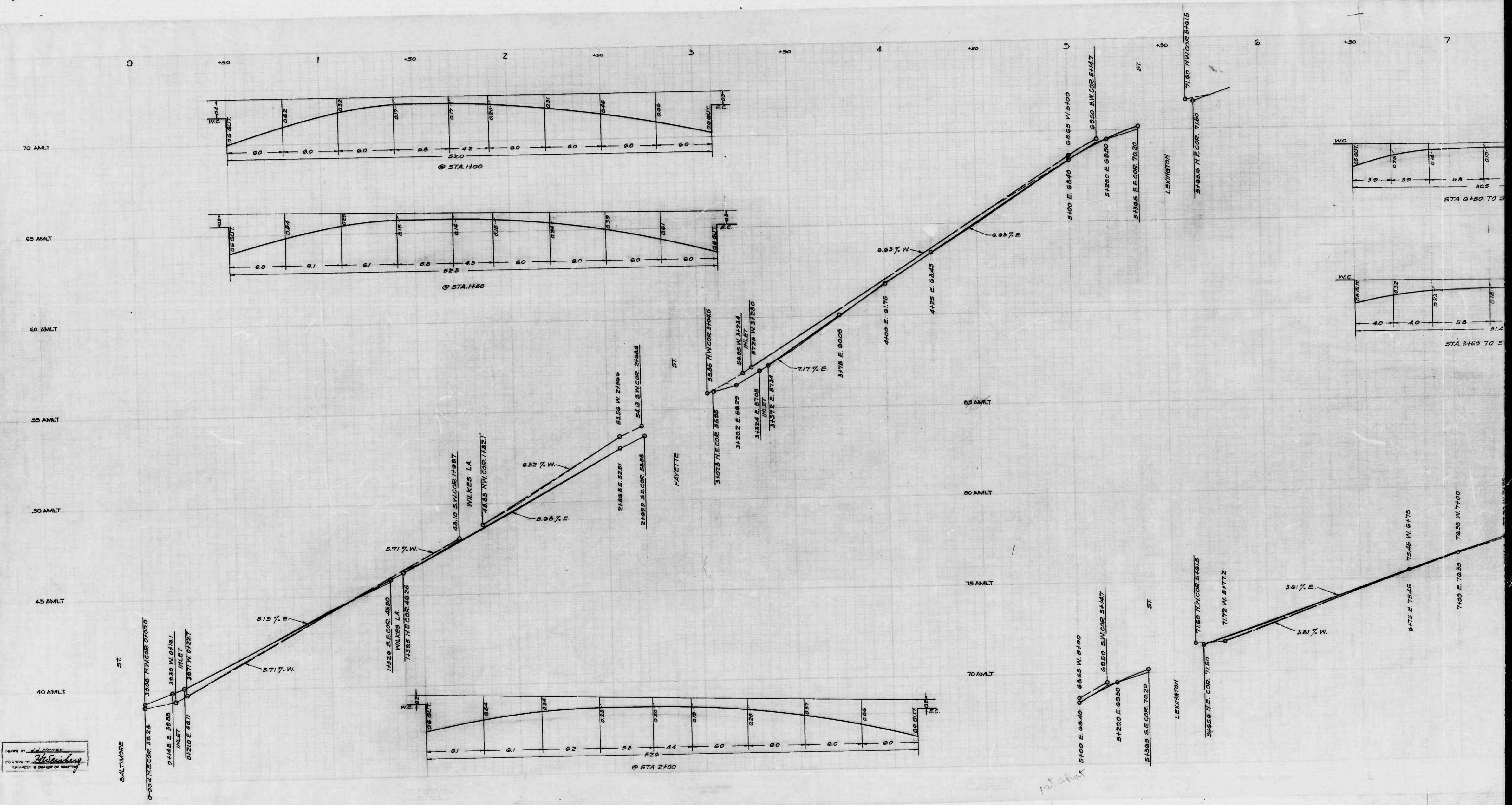

DESIGNED BY: *Ed. Hansen*
 DRAWN BY: *H. Hansen*
 CHECKED BY: *H. Hansen*
 APPROVED BY: *H. Hansen*

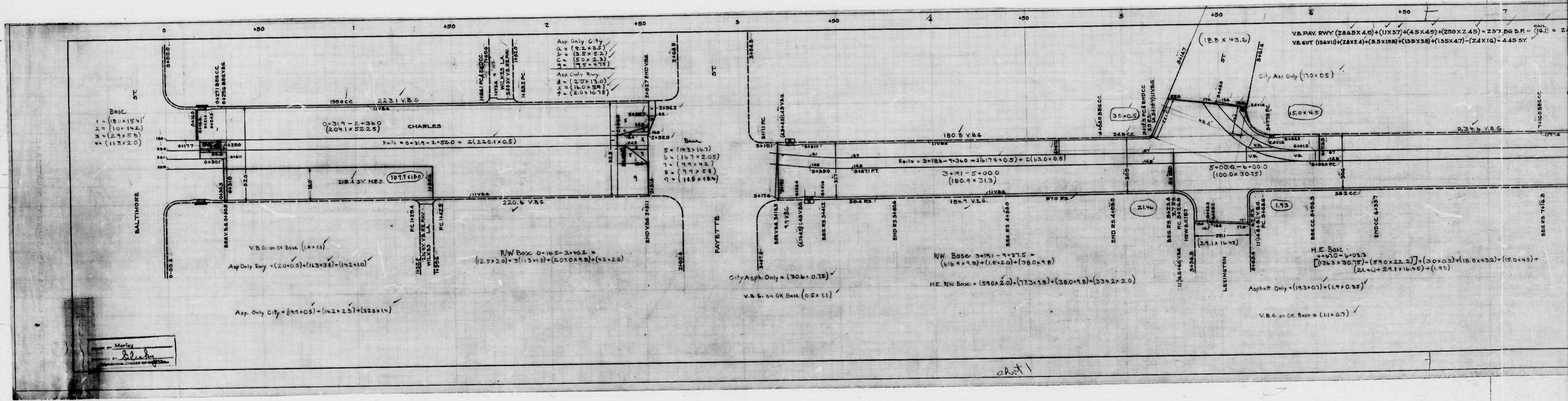

Drawn by: Marley
 Checked by: [Signature]
 Prepared by: [Signature]

Sheet 1

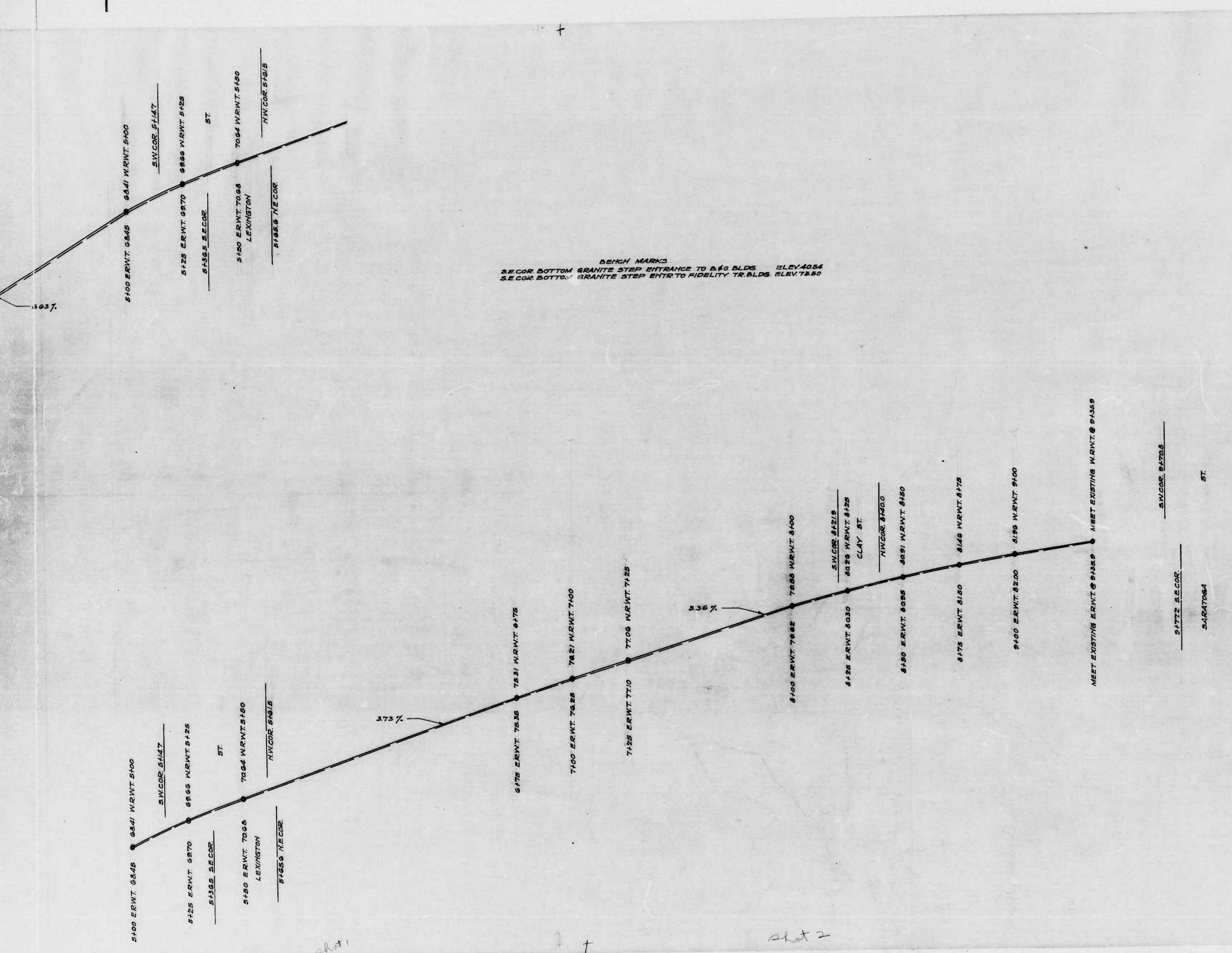

CITY OF BALTIMORE
 DEPARTMENT OF PUBLIC WORKS
 BUREAU OF HIGHWAYS
 PROFILE OF RAILWAY TRACKS
 CHARLES ST.-BALTIMORE ST. TO SARATOGA ST.
 CONT. NO. 793
 HOR. 1"=200' JUNE 11, 1942
 VER. 1"=20' BOOK NO. X153

APPROVED: *[Signature]* APPROVED: *[Signature]*
 ASSOCIATE ENGINEER HIGHWAYS ENGINEER

REPRODUCTION FROM ORIGINAL DRAWING
 BY THE ENGINEERING DEPARTMENT OF THE CITY OF BALTIMORE

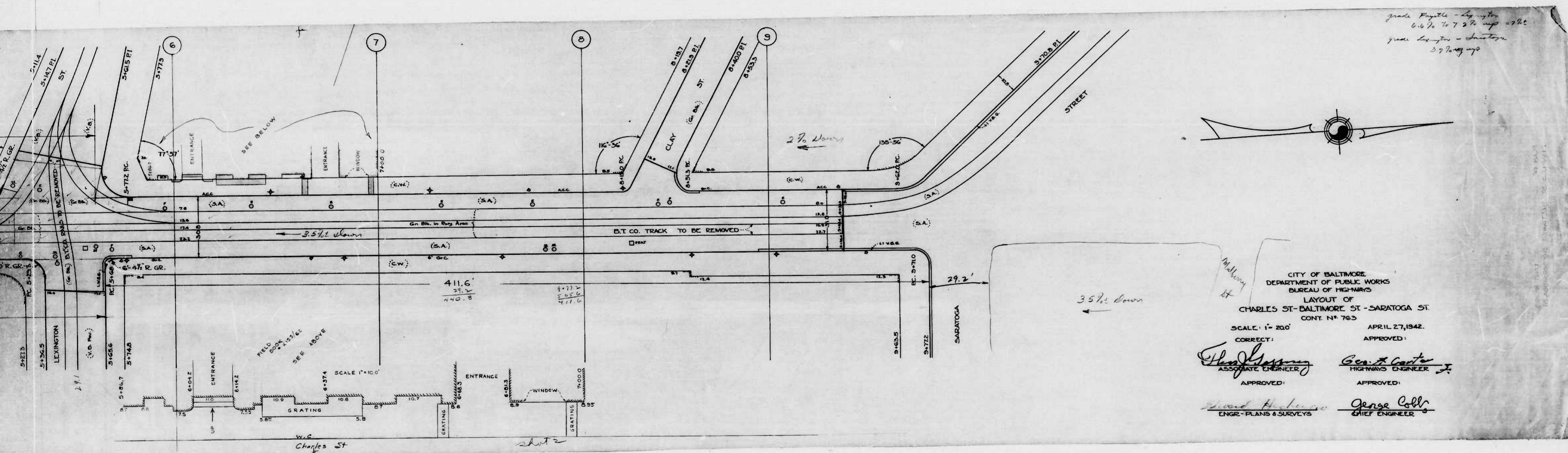

CITY OF BALTIMORE
DEPARTMENT OF PUBLIC WORKS
BUREAU OF HIGHWAYS
LAYOUT OF
CHARLES ST - BALTIMORE ST - SARATOGA ST.
CONT. N° 763

APRIL 27, 1942.

APPROVED:

APPROVED:

APPROVED:

APPROVED:

ASSOCIATE ENGINEER

HIGHWAYS ENGINEER

ENGR - PLANS & SURVEYS

CHIEF ENGINEER

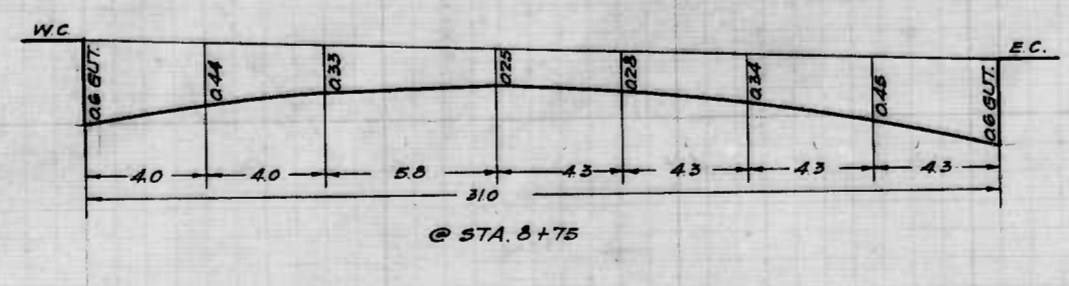
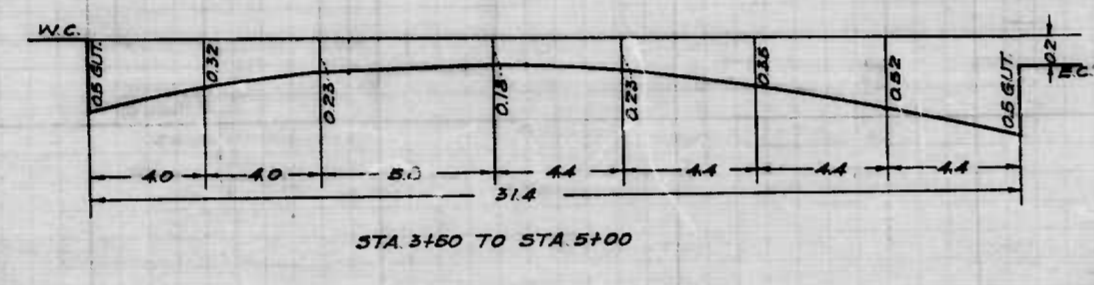
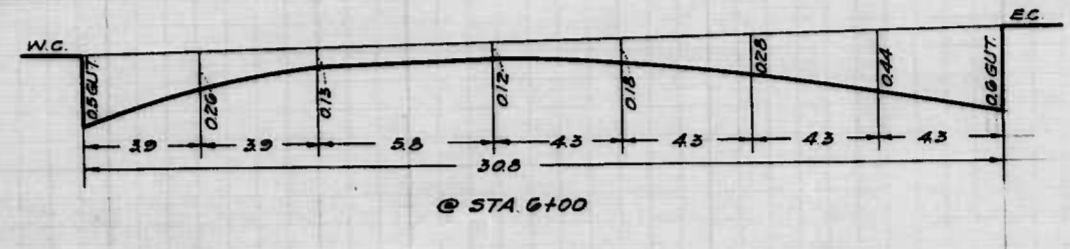
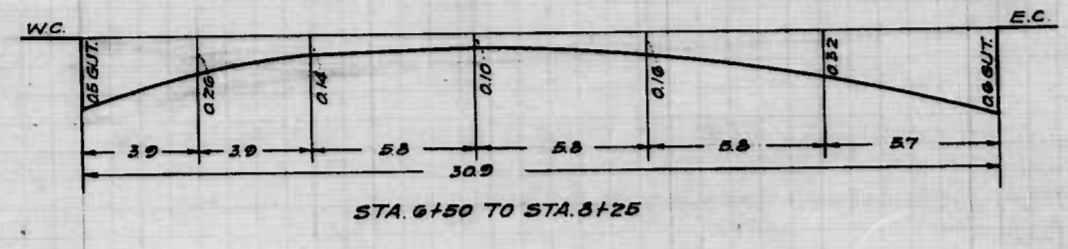
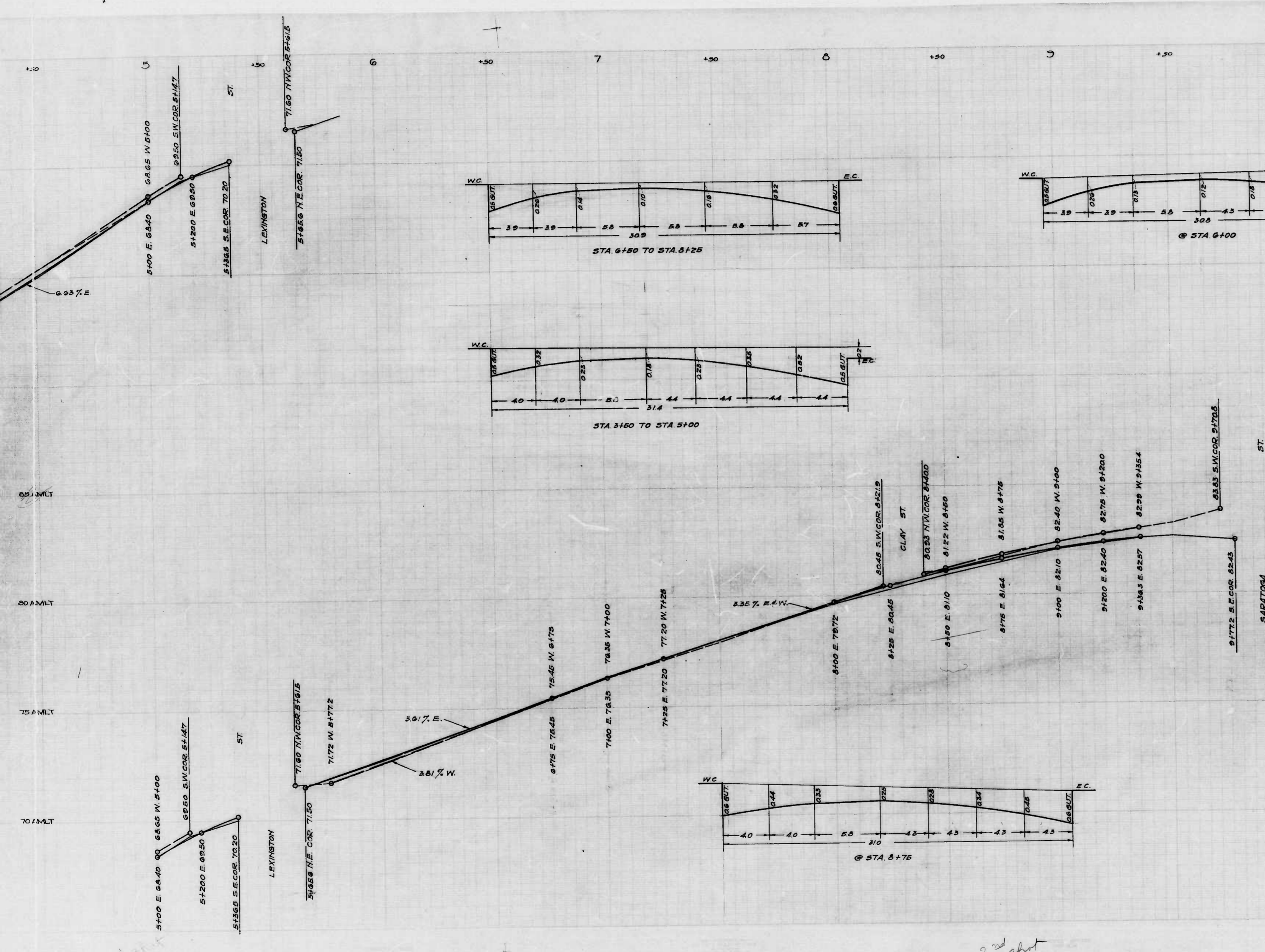

CITY OF BALTIMORE
 DEPARTMENT OF PUBLIC WORKS
 BUREAU OF HIGHWAYS
 PROFILE OF
 CHARLES ST. - BALTIMORE ST. - SARATOGA ST.
 CONT. NO. 763
 SCALE: HOR: 1" = 20.0' VERT: 1" = 2.0' BOOK: X-103 APRIL 30, 1942

CORRECT APPROVED
John J. Gaffney *Geo. F. Carter*
 ASSOCIATE ENGINEER HIGHWAYS ENGINEER

APPROVED APPROVED
 _____ *George Colli*
 ENGR. PLANS & SURVEYS CHIEF ENGINEER

2nd shot

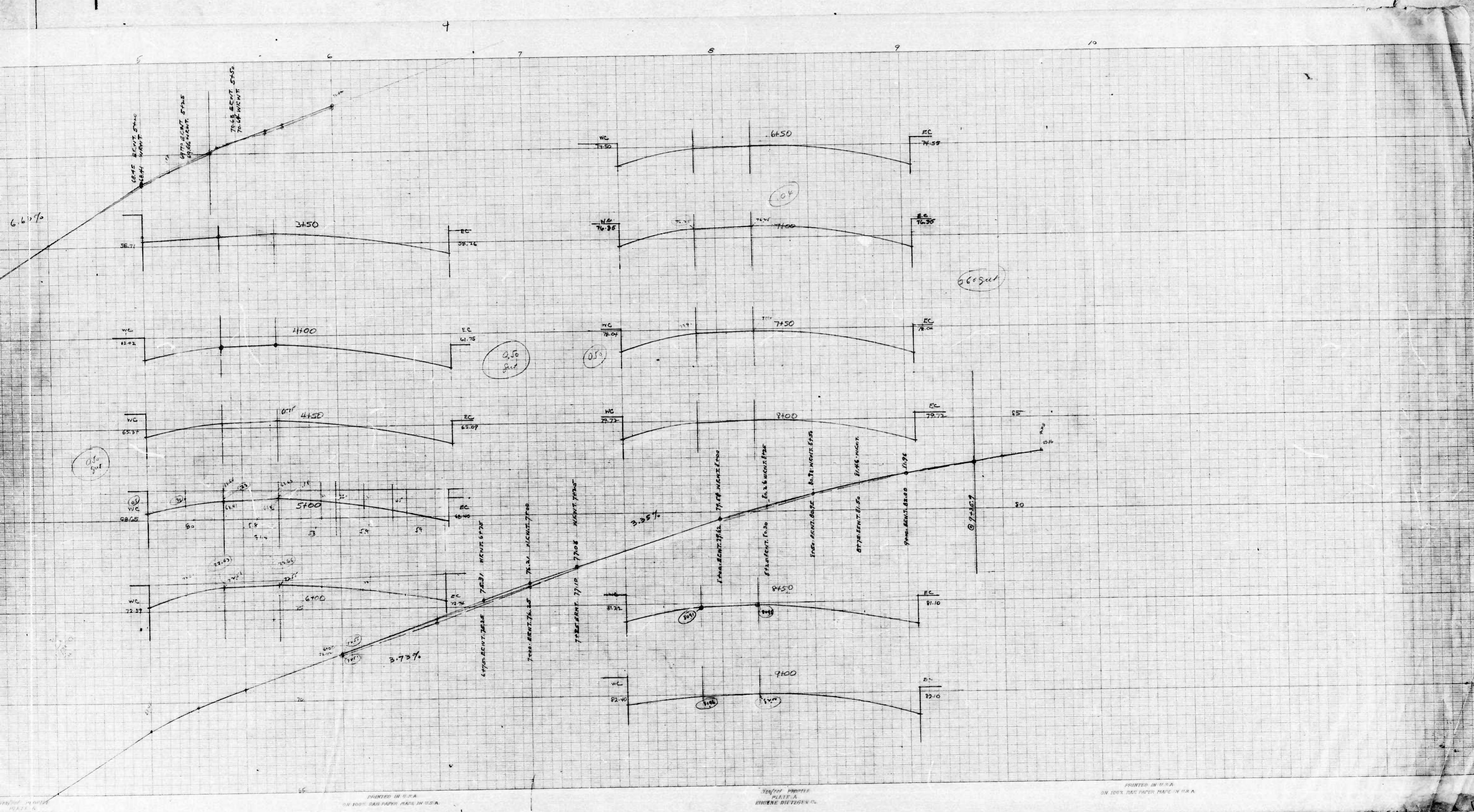

PRINTED IN U.S.A.
ON 100% RAG PAPER, MADE IN U.S.A.

ENGINEER
EUGENE DIETZGEN CO.

PRINTED IN U.S.A.
ON 100% RAG PAPER, MADE IN U.S.A.

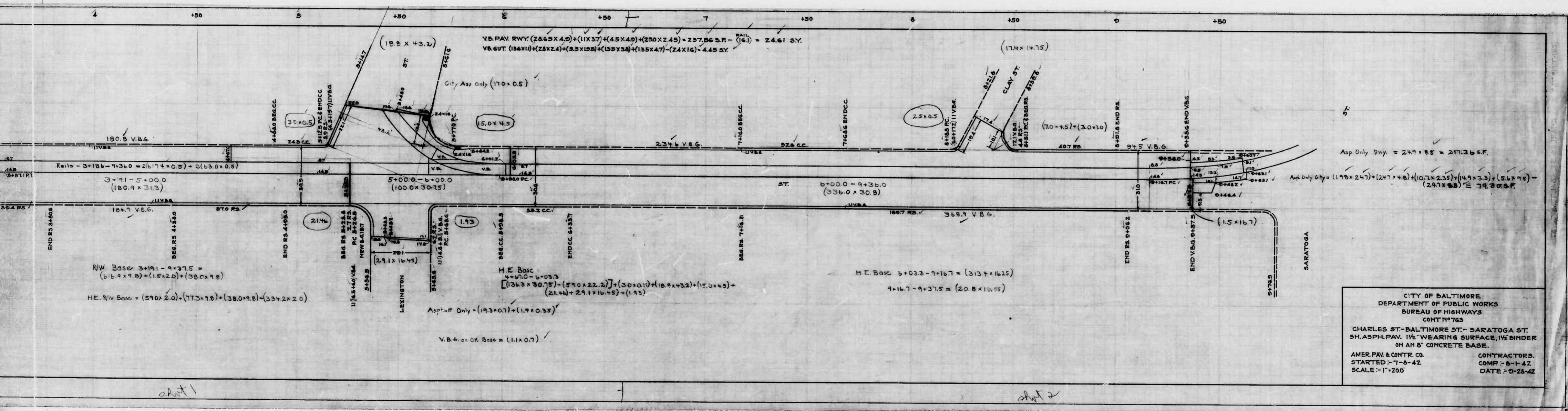

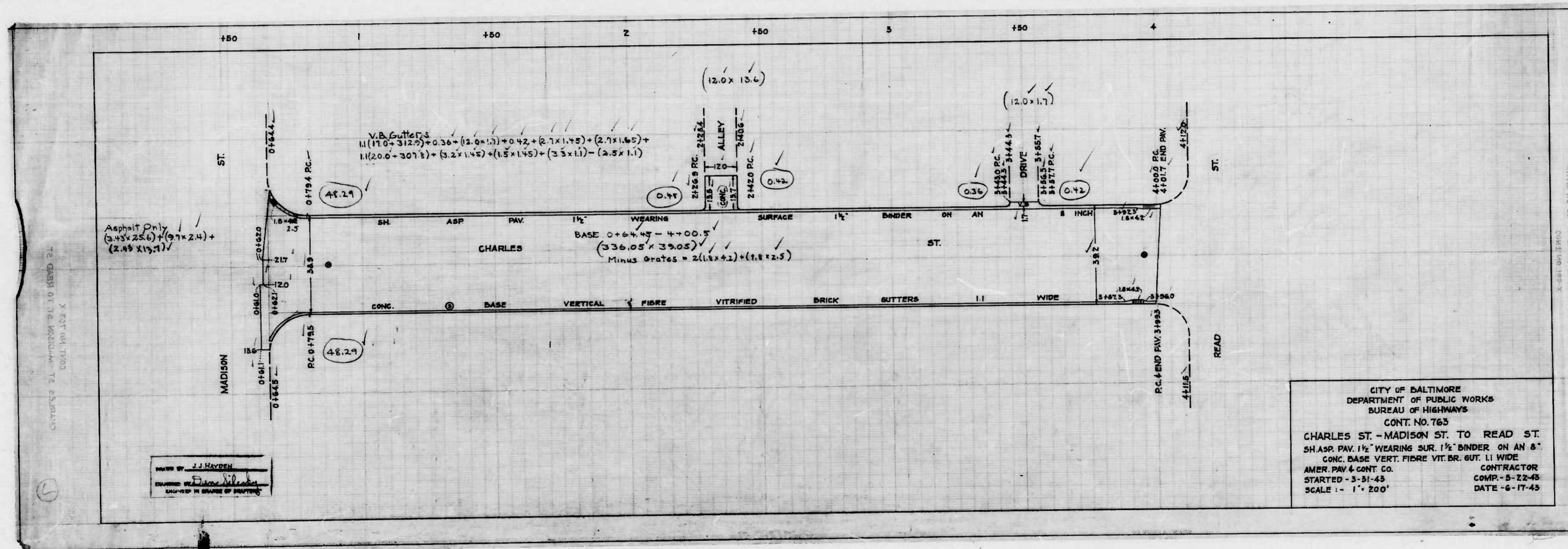

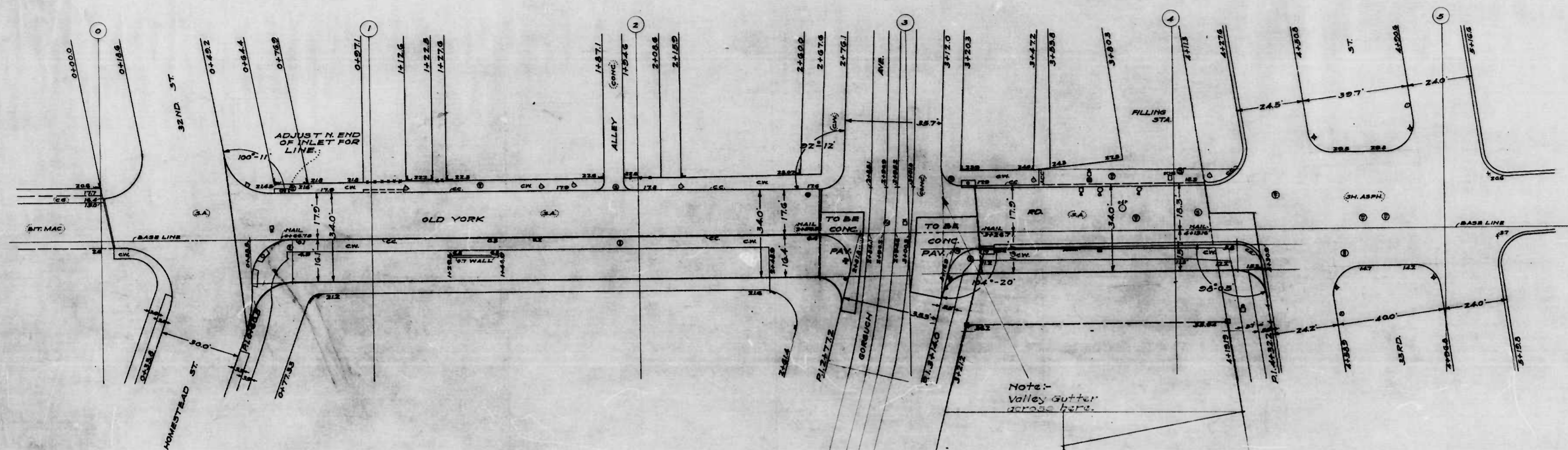

Note:-
Valley gutter
across here.

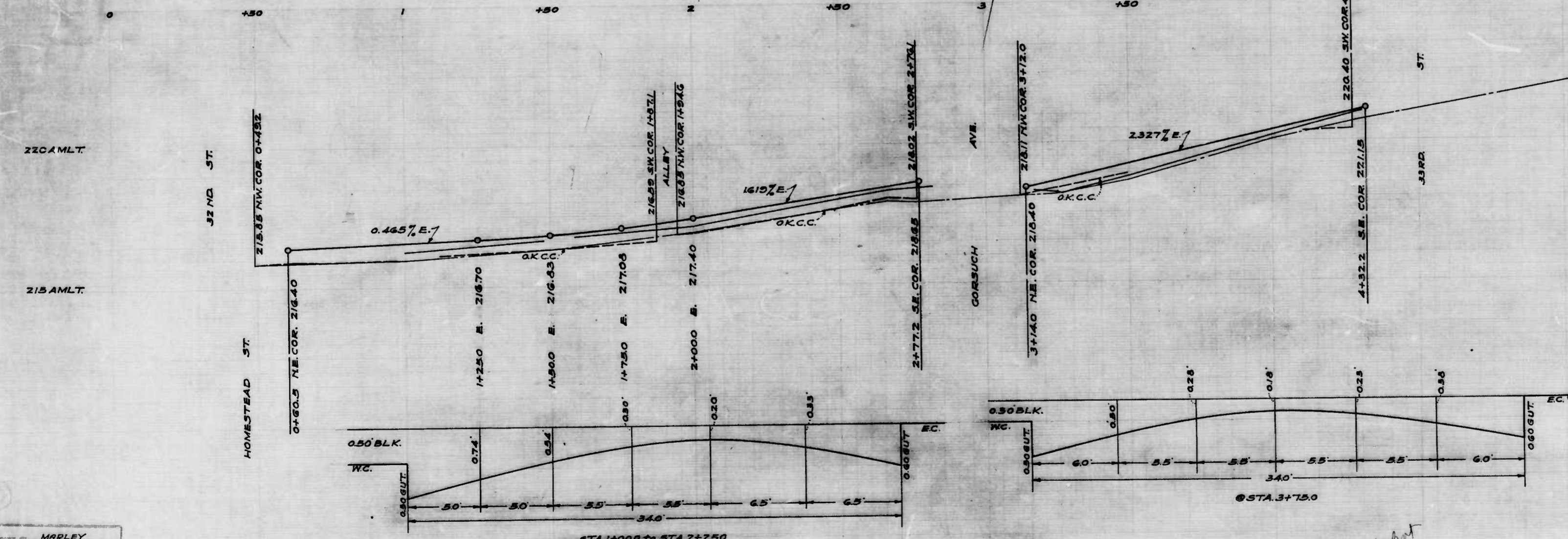

CITY OF BALTIMORE
DEPARTMENT OF PUBLIC WORKS
BUREAU OF HIGHWAYS
PLAN & PROFILE
OLD YORK RD - 32ND ST. - 33RD ST.
HOR: 1"=200
PROF: VER-1"=20
PLAN: 1"=200
BOOK NO X-149
CONT. NO 763
DATE: MAY 11, 1942

CORRECT: *[Signature]*
ASSOCIATE ENGINEER
APPROVED: *[Signature]*
HIGHWAYS ENGINEER
APPROVED: *[Signature]*
CHIEF ENGINEER

MARLEY
DRAWN BY
Heisberg

