

LAKEWOOD AVE. TO STA. 6+75.0
 STA. 9+50.0 TO STA. 14+00.0
 ELLWOOD AVE. TO STA. 17+00.0
 STA. 21+50.0 TO HIGHLAND AVE.

40 AMLT
 35 AMLT
 30 AMLT

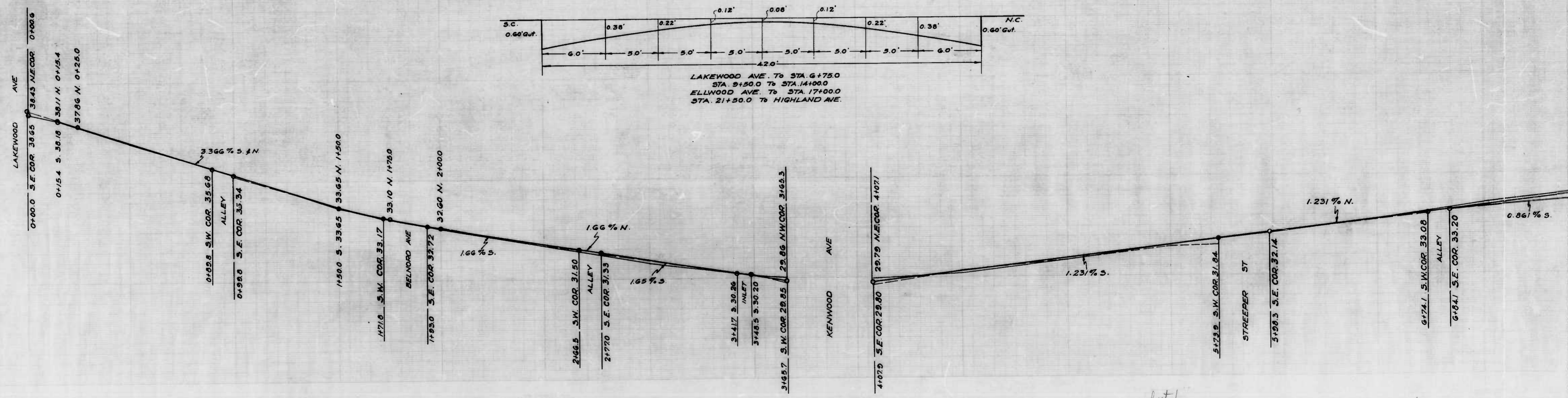

Prepared by H. H. Ewell
 Checked by H. H. Ewell
 Drawn by H. H. Ewell

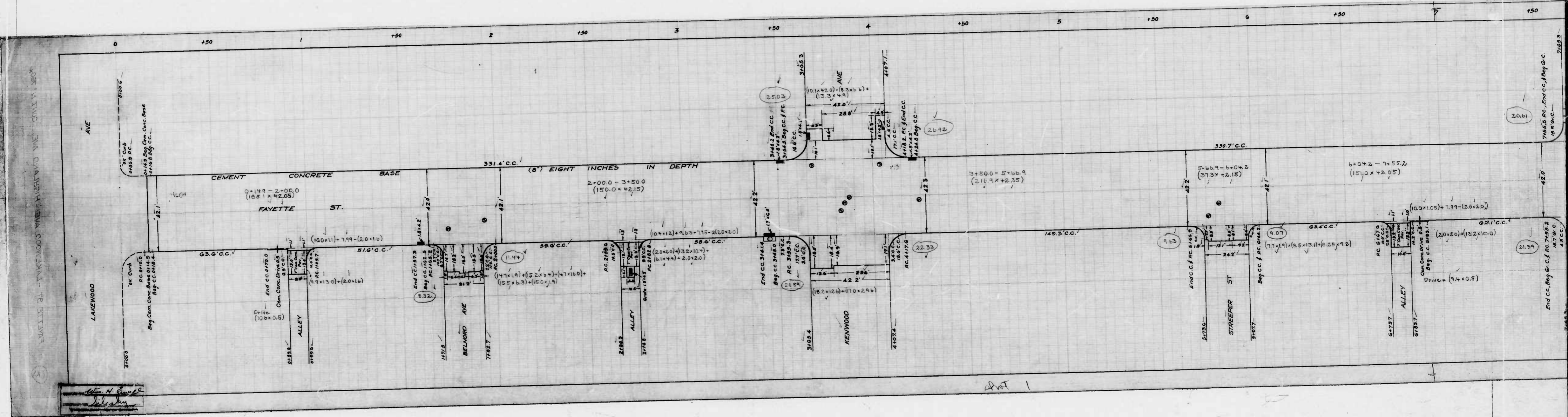

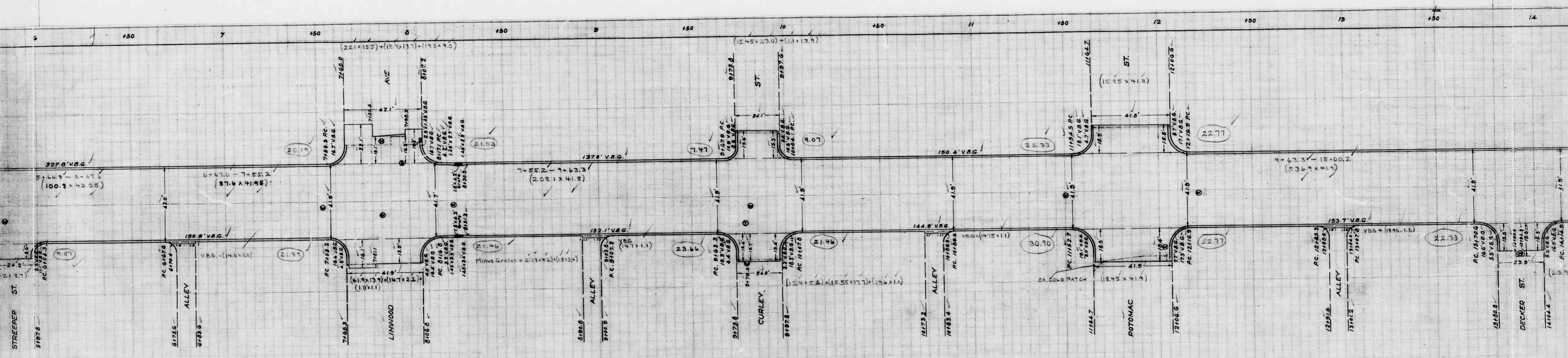

2

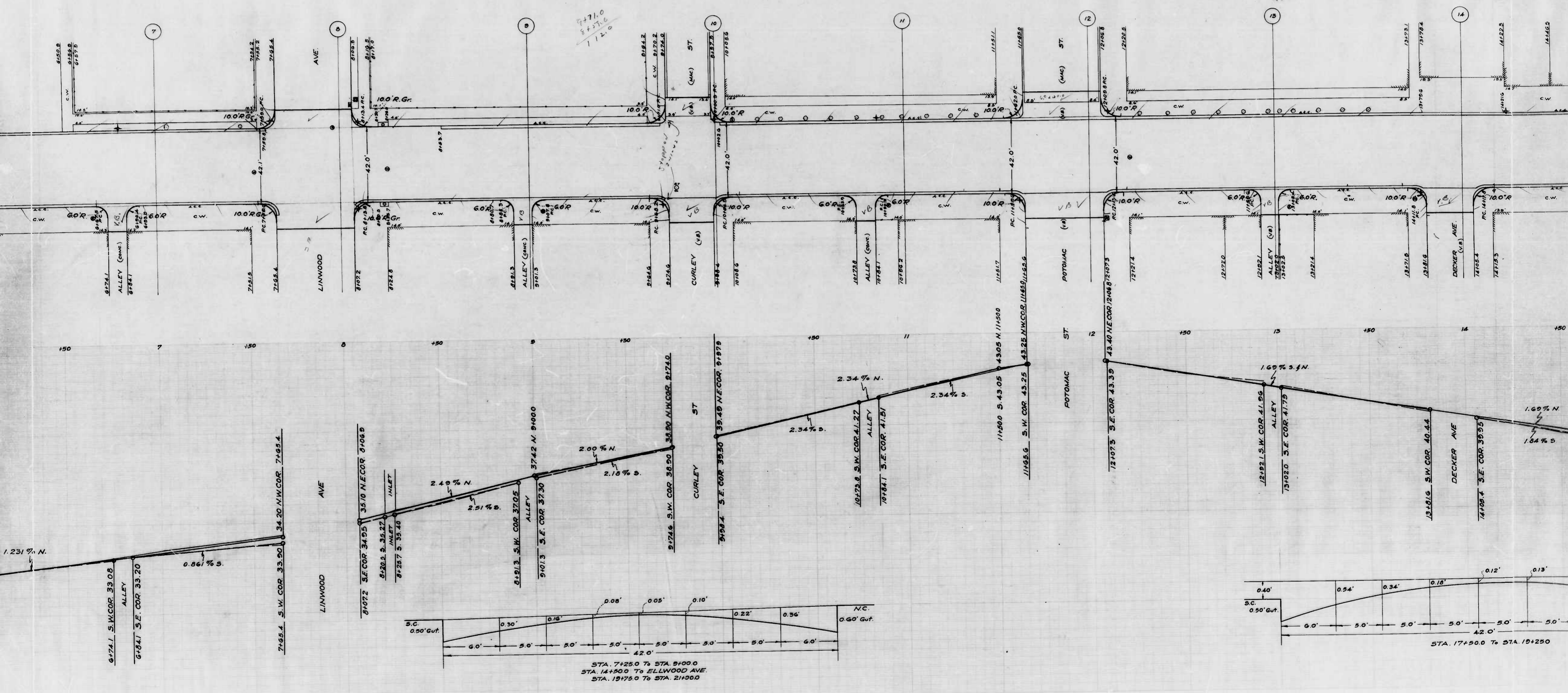

sheet

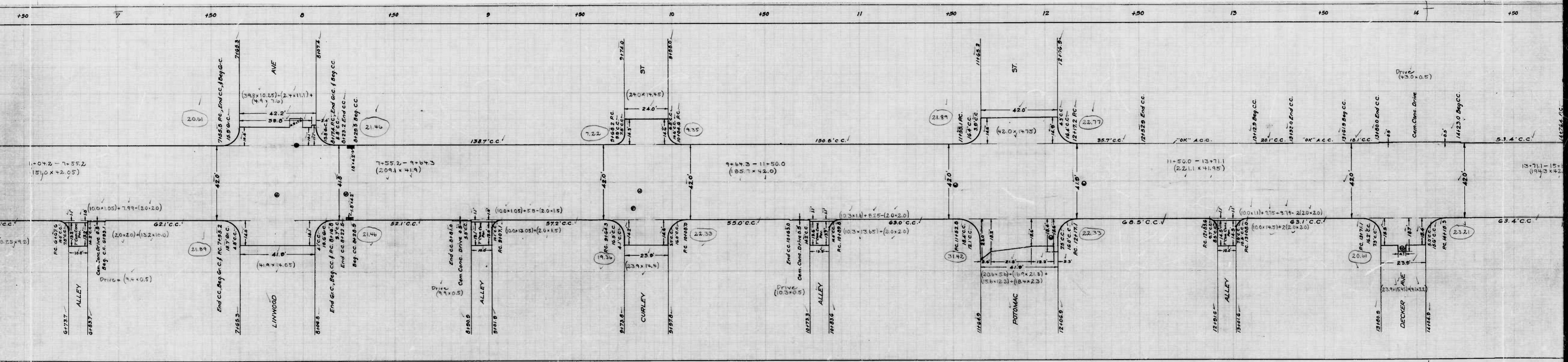

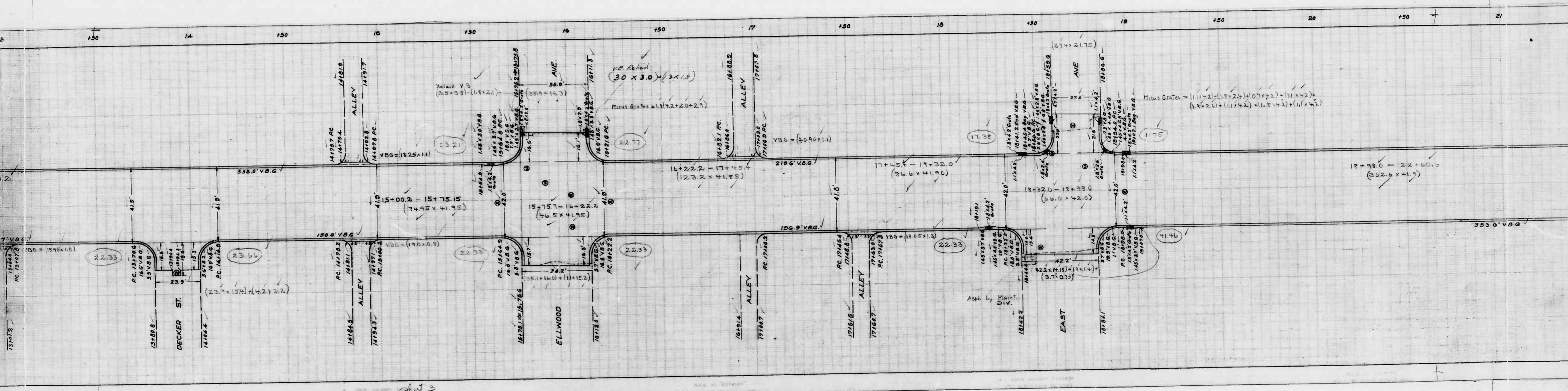
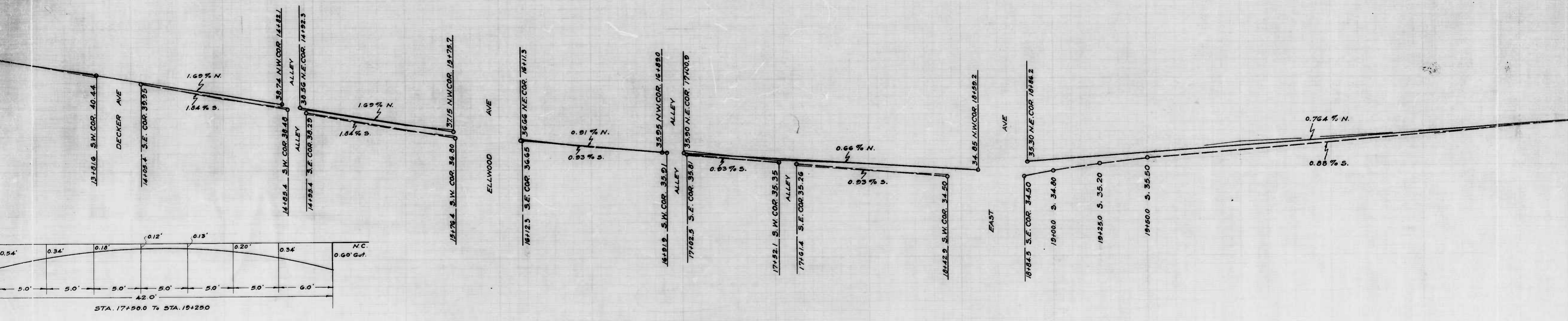
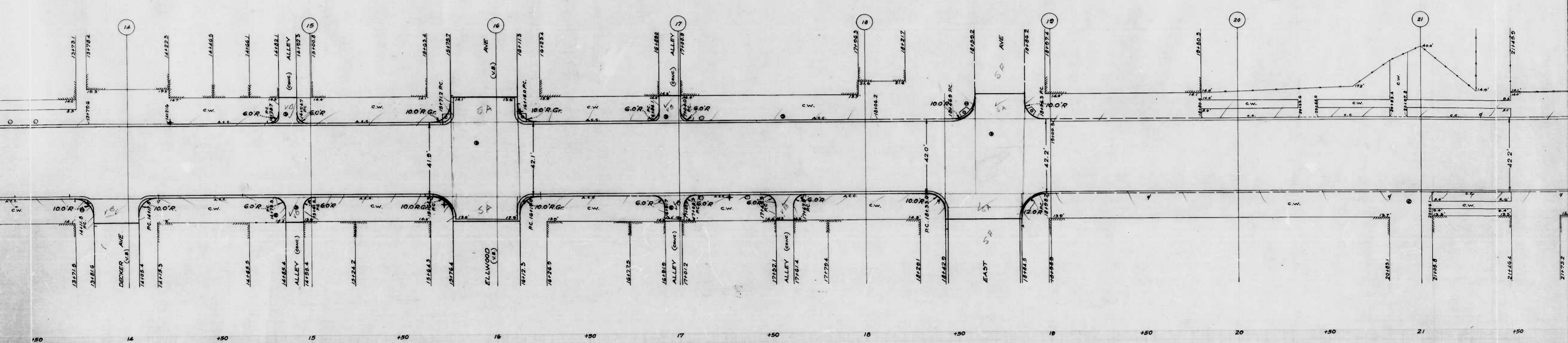
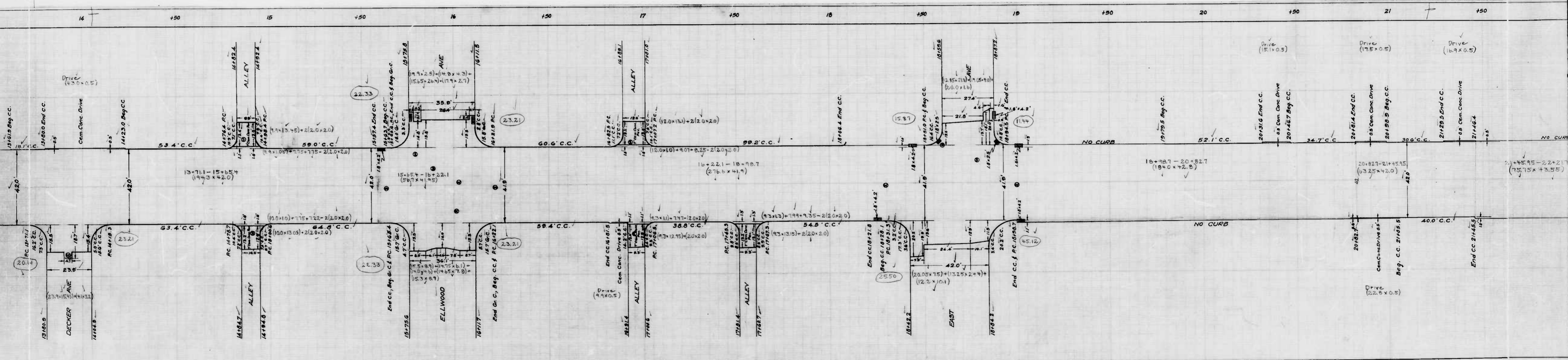
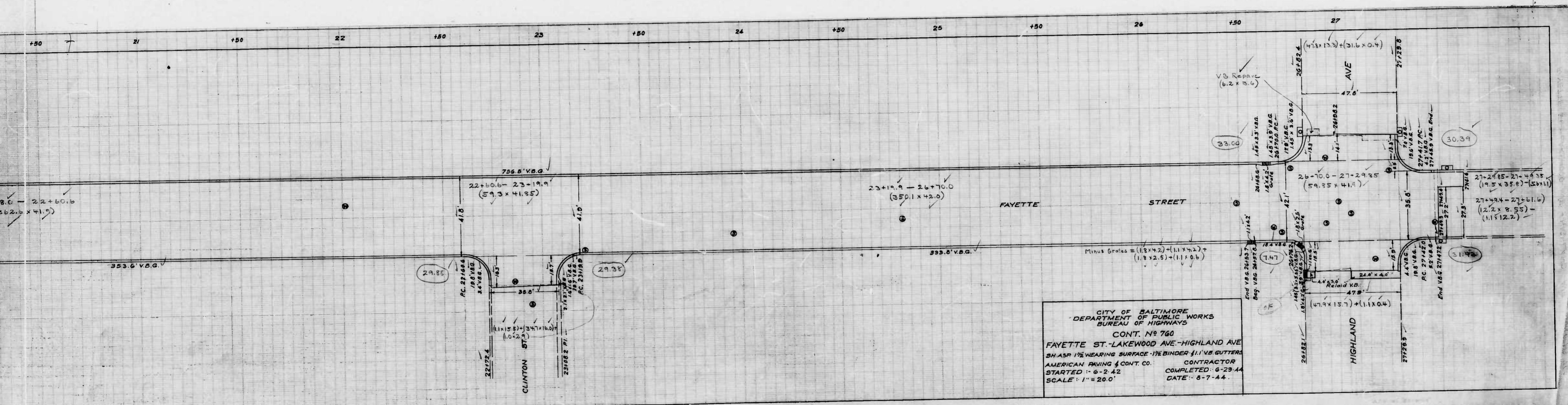

Chart 3



not 3





Sheet 4

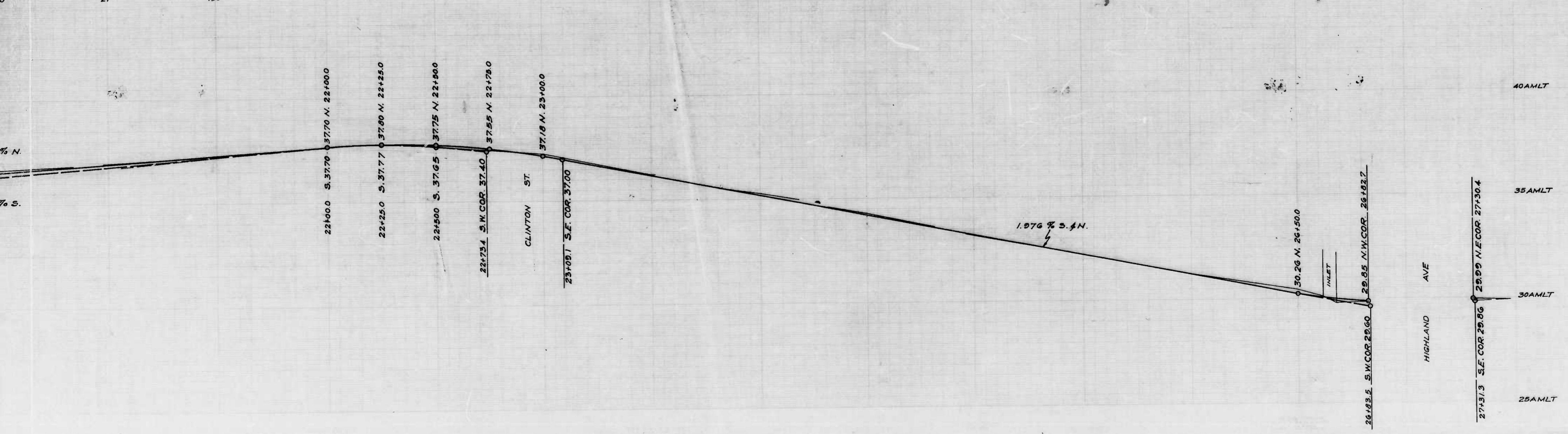
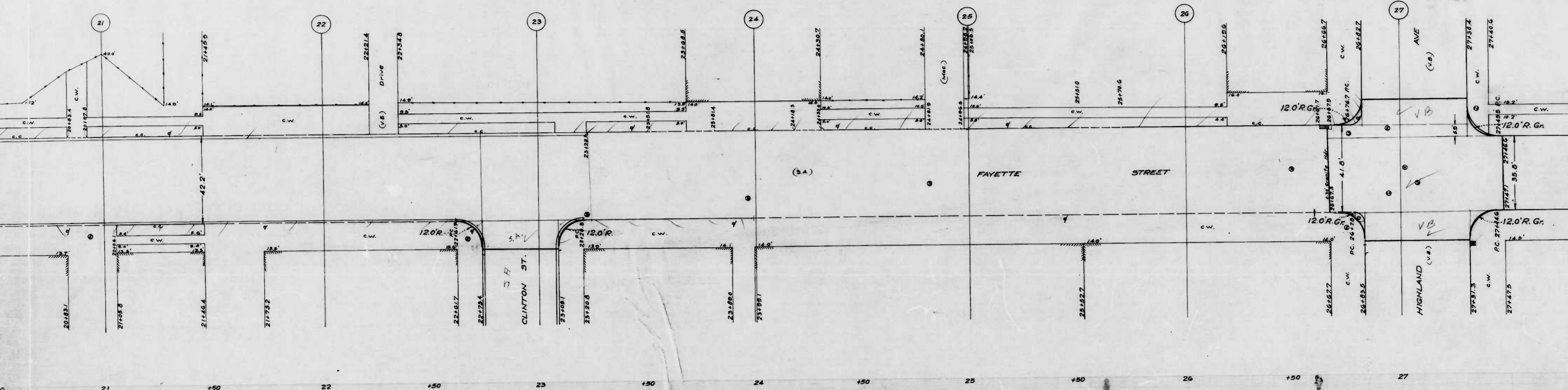

CITY OF BALTIMORE
 DEPARTMENT OF PUBLIC WORKS
 BUREAU OF HIGHWAYS
 PLAN & PROFILE
 FAYETTE ST. - LAKEWOOD AVE. - HIGHLAND AVE.
 PROF. HOR. 1" = 20.0'
 SCALE: VER. 1" = 2.0'
 PLAN 1" = 20.0'

CORRECT
[Signature]
 ASSOCIATE ENGINEER

APPROVED
[Signature]
 ENGR. PLANS & SURVEYS

DATE: APR 1954

APPROVED
[Signature]
 CHIEF

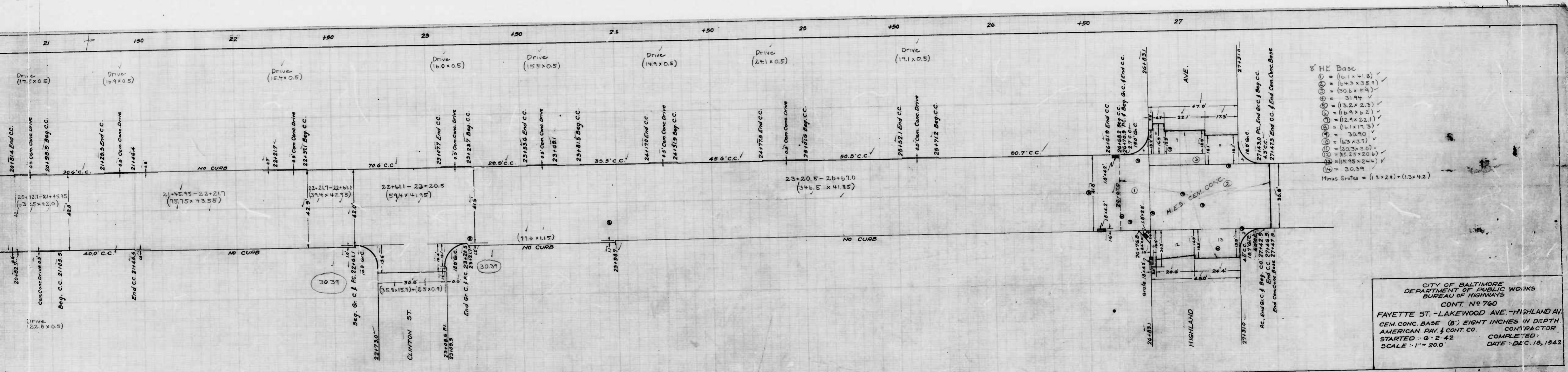

8" H.C. Base

1	6.1 x 4.8
2	6.3 x 3.8
3	6.5 x 2.9
4	3.14
5	13.2 x 2.3
6	12.9 x 2.1
7	16.1 x 1.3
8	30.40
9	13.3 x 3.7
10	12.3 x 3.0
11	15.25 x 2.0
12	15.35 x 2.4
13	30.39

Minus Grotes = (1.8 x 2.9) + (1.3 x 4.2)

CITY OF BALTIMORE
 DEPARTMENT OF PUBLIC WORKS
 BUREAU OF HIGHWAYS
 CONT. NO 760
 FAYETTE ST. - LAKEWOOD AVE. - HIGHLAND AV.
 CEM CONC. BASE (8" EIGHT INCHES IN DEPTH)
 AMERICAN PAV. & CONT. CO. CONTRACTOR
 STARTED - 9-2-42 COMPLETED -
 SCALE - 1" = 20.0' DATE - DEC. 16, 1942

part 4

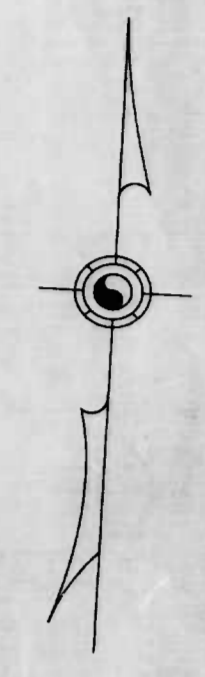
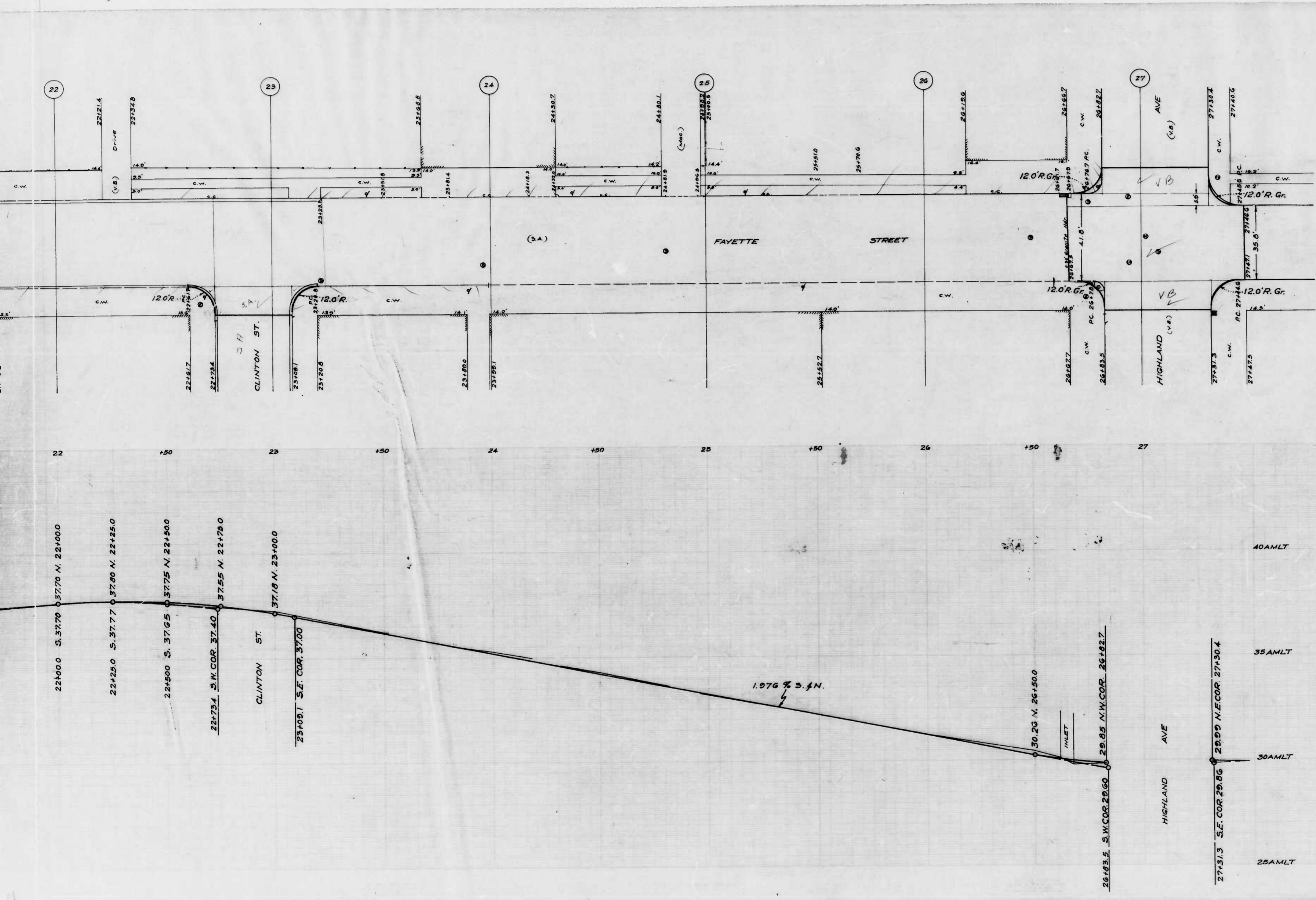

CITY OF BALTIMORE
 DEPARTMENT OF PUBLIC WORKS
 BUREAU OF HIGHWAYS

PLAN & PROFILE
 FAYETTE ST.- LAKEWOOD AVE.-HIGHLAND AVE.

PROF. HOR. 1" = 20.0'
 SCALE: VER. 1" = 20.0'
 PLAN 1" = 20.0'

BOOK N° X-163
 CONT. N° 760.
 DATE: APR. 10, 1942.

CORRECT
Edward J. Blecher
 ASSOCIATE ENGINEER

APPROVED
Geo. A. Carter
 HIGHWAYS ENGINEER

APPROVED
George Colby
 CHIEF ENGINEER

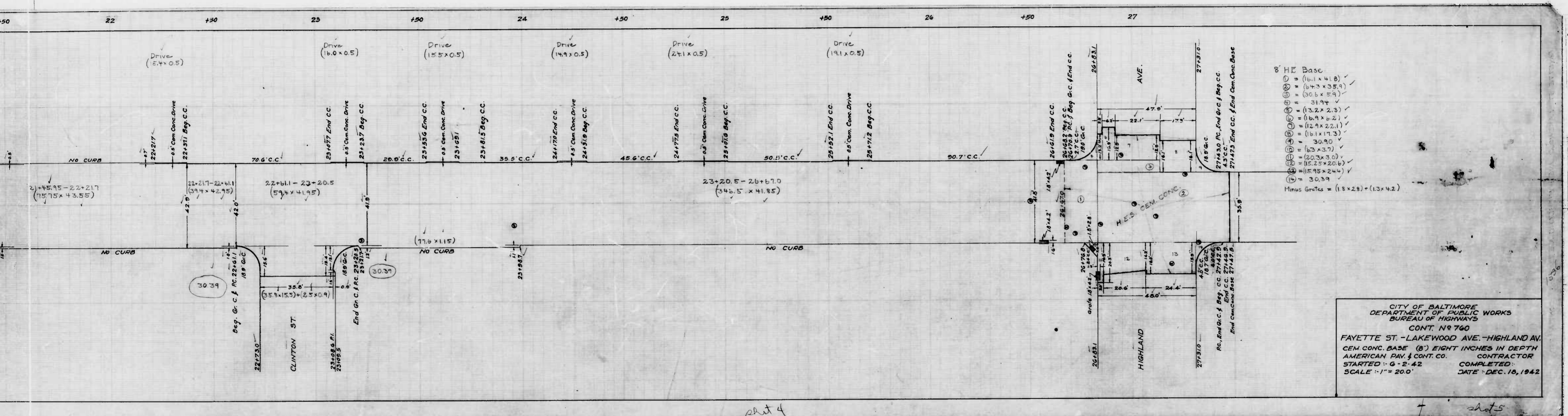

HE Base

1	(6.1 x 4.8)	✓
2	(4.3 x 3.5)	✓
3	(3.0 x 5.9)	✓
4	3.9	✓
5	(3.2 x 2.3)	✓
6	(6.9 x 2.2)	✓
7	(1.4 x 2.1)	✓
8	(1.1 x 1.3)	✓
9	3.0	✓
10	(3.3 x 3.7)	✓
11	(2.0 x 3.0)	✓
12	(1.5 x 2.0)	✓
13	(1.5 x 2.4)	✓
14	3.0	✓

Minus Grates = (1.8 x 2.8) + (1.3 x 4.2)

CITY OF BALTIMORE
 DEPARTMENT OF PUBLIC WORKS
 BUREAU OF HIGHWAYS
 CONT. No 760
 FAYETTE ST. - LAKEWOOD AVE. - HIGHLAND AV.
 CEM. CONC. BASE (8") EIGHT INCHES IN DEPTH
 AMERICAN PAV. & CONT. CO. CONTRACTOR
 STARTED 10-6-42 COMPLETED
 SCALE 1" = 20.0' DATE DEC. 16, 1942

shot 4

shots